

# SHEET INDEX

<b>GENERAL</b>	G000 COVER SHEET G001 ABBREVIATIONS
<b>CIVIL</b>	C100 CIVIL LEGENDS C101 SITE PLAN C102 SITE GRADING PLAN C103 SITE DRIVEWAY PLAN C104 YARD PIPING PLAN C105 WELL TO WTP YARD PLAN C106 WTP TO OFF-SITE YARD PIPING PLAN C107 LANDSCAPING PLAN C108 INITIAL EROSION CONTROL C109 FINAL EROSION CONTROL C500 CIVIL DETAILS C501 CIVIL DETAILS C502 CIVIL DETAILS
<b>STRUCTURAL</b>	S000 STRUCTURAL COVER SHEET S100 FIRST LEVEL FOUNDATION PLAN S101 MEZZANINE FRAMING PLAN S102 ROOF FRAMING PLAN S200 FOUNDATION DETAILS S201 FRAMING DETAILS S300 BUILDING SECTIONS S500 TYPICAL CONCRETE DETAILS S501 TYPICAL CONCRETE WALL / SLAB DETAILS S502 TYPICAL CONCRETE MISC (MEP & PROCESS) DETAILS S503 TYPICAL CONCRETE DETAILS S504 TYPICAL MASONRY DETAILS S505 TYPICAL MASONRY DETAILS S506 TYPICAL PRECAST DETAILS S507 TYPICAL BAR GRATE AND PLATFORM DETAILS
<b>ARCHITECTURAL</b>	A000 ARCHITECTURAL LEGENDS AND NOTES A100 ARCHITECTURAL PLANS A200 ARCHITECTURAL ELEVATIONS A300 ARCHITECTURAL SECTIONS A400 ARCHITECTURAL ENLARGED PLANS A500 ARCHITECTURAL DETAILS A600 ARCHITECTURAL SCHEDULES

<b>PLUMBING</b>	PL100 UNDERFLOOR PLUMBING PLAN PL101 FIRST FLOOR PLUMBING PLAN PL300 PLUMBING ISOMETRICS PL500 PLUMBING DETAILS & SCHEDULES
<b>PROCESS</b>	P000 PROCESS LEGEND P101 FIRST FLOOR PROCESS PLAN P300 PROCESS HIGH SERVICE AND FEED PUMP SECTIONS P301 PROCESS HYDROPNEUMATIC TANK SECTIONS P302 DUALATOR SECTIONS 1 OF 2 P303 DUALATOR SECTIONS 2 OF 2 P400 ENLARGED PROCESS PLAN 1 OF 2 P401 ENLARGED PROCESS PLAN 2 OF 2 P500 PROCESS DETAILS P600 PROCESS SCHEDULES
<b>MECHANICAL</b>	M000 MECHANICAL LEGEND M101 FIRST FLOOR HVAC PLAN M300 HVAC SECTIONS M500 MECHANICAL DETAILS & SCHEDULES
<b>ELECTRICAL</b>	E000 ELECTRICAL LEGEND E100 ELECTRICAL SITE PLAN E101 FIRST FLOOR POWER PLAN E102 FIRST FLOOR LIGHTING PLAN E500 ELECTRICAL DETAILS E501 ELECTRICAL ONE-LINE DIAGRAM E600 ELECTRICAL SCHEDULES E601 ELECTRICAL SCHEDULES
<b>INSTRUMENTATION &amp; CONTROL</b>	IC000 P&ID LEGEND IC500 P&ID - WELLS AND FILTRATION SYSTEM IC501 P&ID - TOWER & GROUND STORAGE RESERVOIR IC502 P&ID - LEGEND (TONKA) IC503 P&ID - WTP (TONKA) IC600 I&C - DETAILS & SCHEDULES
<b>TOTAL SHEETS: 69</b>	

# EL PASO COUNTY, COLORADO GRANDVIEW RESERVE DISTRICT WTP WELL WATER COLLECTION

D.R. HORTON  
COLORADO  
2024

## LOCATION MAP

GEC was submitted as a separate plan set, so this signature block can be removed.

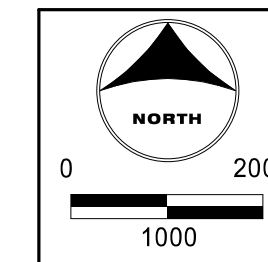

VICINITY MAP  
1"=2000'

**HORIZONTAL CONTROL**  
MODIFIED COORDINATE SYSTEM -  
SEE SHEETS IN DRAWINGS

**VERTICAL DATUM**  
NAVD88



1975 RESEARCH PARKWAY, SUITE 230 | COLORADO SPRINGS, CO 80920  
Phone: 719.300.4140 | Toll Free: 800.728.7805 | Fax: 713.965.0044 | HRGreen.com

### EL PASO COUNTY:

COUNTY PLAN REVIEW IS PROVIDED ONLY FOR GENERAL CONFORMANCE WITH COUNTY DESIGN CRITERIA. THE COUNTY IS NOT RESPONSIBLE FOR THE ACCURACY AND ADEQUACY OF THE DESIGN, DIMENSIONS, AND/OR ELEVATIONS WHICH SHALL BE CONFIRMED AT THE JOB SITE. THE COUNTY THROUGH THE APPROVAL OF THIS DOCUMENT ASSUMES NO RESPONSIBILITY FOR COMPLETENESS AND/OR ACCURACY OF THIS DOCUMENT.

FILED IN ACCORDANCE WITH THE REQUIREMENTS OF THE EL PASO COUNTY LAND DEVELOPMENT CODE, DRAINAGE CRITERIA MANUAL, VOLUMES 1 AND 2, AND ENGINEERING CRITERIA MANUAL AS AMENDED.

IN ACCORDANCE WITH ECM SECTION 1.12, THESE CONSTRUCTION DOCUMENTS WILL BE VALID FOR CONSTRUCTION FOR A PERIOD OF 2 YEARS FROM THE DATE SIGNED BY THE EL PASO COUNTY ENGINEER. IF CONSTRUCTION HAS NOT STARTED WITHIN THOSE 2 YEARS, THE PLANS WILL NEED TO BE RESUBMITTED FOR APPROVAL, INCLUDING PAYMENT OF REVIEW FEES AT THE PLANNING AND COMMUNITY DEVELOPMENT DIRECTORS DISCRETION.

JENNIFER IRVINE, P.E. \_\_\_\_\_ DATE \_\_\_\_\_  
COUNTY ENGINEER / ECM ADMINISTRATOR

### ENGINEER'S STATEMENT (FOR GEC PLAN WITHIN CONSTRUCTION DRAWING SET):

THESE DETAILED PLANS AND SPECIFICATIONS WERE PREPARED UNDER MY DIRECTION AND SUPERVISION. SAID PLANS AND SPECIFICATIONS HAVE BEEN PREPARED ACCORDING TO THE CRITERIA ESTABLISHED BY THE COUNTY FOR DETAILED ROADWAY, DRAINAGE, GRADING AND EROSION CONTROL PLANS AND SPECIFICATIONS, AND SAID PLANS AND SPECIFICATIONS ARE IN CONFORMITY WITH APPLICABLE MASTER DRAINAGE PLANS AND MASTER TRANSPORTATION PLANS. SAID PLANS AND SPECIFICATIONS MEET THE PURPOSES FOR WHICH THE PARTICULAR ROADWAY AND DRAINAGE FACILITIES ARE DESIGNED AND ARE CORRECT TO THE BEST OF MY KNOWLEDGE AND BELIEF. I ACCEPT RESPONSIBILITY FOR ANY LIABILITY CAUSED BY ANY NEGLIGENT ACTS, ERRORS OR OMISSIONS ON MY PART IN PREPARATION OF THESE DETAILED PLANS AND SPECIFICATIONS.

GREG PANZA, P.E. #37081 \_\_\_\_\_ DATE \_\_\_\_\_  
FOR AND ON BEHALF OF HR GREEN, INC.

### OWNER'S STATEMENT (FOR GEC PLAN WITHIN CONSTRUCTION DRAWING SET):

I, THE OWNER/DEVELOPER, HAVE READ AND WILL COMPLY WITH THE REQUIREMENTS OF THE GRADING AND EROSION CONTROL PLAN AND ALL OF THE REQUIREMENTS SPECIFIED IN THESE DETAILED PLANS AND SPECIFICATIONS.

OWNER'S SIGNATURE \_\_\_\_\_ DATE \_\_\_\_\_

### ENGINEERS STATEMENT:

THE DETAILED PLANS AND SPECIFICATIONS WERE PREPARED UNDER MY DIRECTION AND SUPERVISION. SAID DETAILS AND SPECIFICATIONS HAVE BEEN PREPARED ACCORDING TO THE CRITERIA ESTABLISHED BY THE STATE OF COLORADO.

GREG PANZA, P.E. #37081 \_\_\_\_\_ DATE \_\_\_\_\_  
FOR AND ON BEHALF OF HR GREEN, INC.

### PROJECT CONTACTS:

**OWNER/DEVELOPER**  
D.R. HORTON  
9555 S. KINGSTON COURT, SUITE 200  
ENGELWOOD, CO 80112  
TELE: (303) 488-0081  
ATTN: RILEY HILLEN, PE AND BRYAN REID, PE  
EMAIL: RHILLEN@DRHORTON.COM AND BAREID1@DRHORTON.COM

**APPLICANT**  
HR GREEN  
5613 DTC PARKWAY | SUITE 950  
GREENWOOD VILLAGE, CO 80111  
TELE: (720) 602-4999  
ATTN: GREGORY PANZA P.E.  
EMAIL: GPANZA@HRGREEN.COM

**CIVIL ENGINEER**  
HR GREEN  
5613 DTC PARKWAY | SUITE 950  
GREENWOOD VILLAGE, CO 80111  
TELE: (720) 602-4999  
ATTN: GREGORY PANZA P.E.  
EMAIL: GPANZA@HRGREEN.COM

**GEOTECHNICAL ENGINEER**  
COMPANY: CTL | THOMPSON  
ADDRESS: 5170 MARK DABLING BLVD  
COLORADO SPRINGS, CO 80918  
TELE: (719) 528-8300  
ATTN: JEFF JONES  
EMAIL: COLORADOSPRINGS@CTLTHOMPSON.COM

**TRAFFIC ENGINEER**  
LSC TRANSPORTATION CONSULTANTS INC.  
2504 EAST PIKES PEAK AVENUE, SUITE 304  
COLORADO SPRINGS, CO 80909  
TELE: &719) 633-2868  
ATTN: JEFFREY C. HODSON, P.E.  
EMAIL: LSC@LSCTRANS.COM

**SURVEYOR**  
EDWARD-JAMES SURVEYING, INC.  
926 ELKTON DRIVE  
COLORADO SPRINGS, CO 80907  
TELE: (719) 576-1216  
ATTN: JONATHAN W. TESSIN  
EMAIL: JTessin@EJSURVEYING.COM

### UTILITY CONTACTS:

**WATER**  
GRANDVIEW RESERVE METROPOLITAN DISTRICT  
1272 KELLY JOHNSON BLVD, SUITE 100  
COLORADO SPRINGS, CO 80921  
TELE: (719) 499-8416  
ATTN: PAUL HOWARD  
EMAIL: PAULINFINITY1@MSN.COM

**WASTEWATER / WATER**  
WOODMEN HILLS METRO DISTRICT  
8046 EASTONVILLE ROAD  
FALCON, CO 80831  
TELE: (719) 495-2500  
CONTACT: CODY RITTER  
EMAIL: CODY@WHMD.ORG

**ELECTRIC / FIBER**  
MOUNTAIN VIEW ELECTRIC ASSOCIATION  
11140 E. WOODMEN RD.  
FALCON, CO 80831  
TELE: (800) 388-9881  
ATTN: GINA PERRY  
EMAIL: GINA.P@MVEA.COOP

**NATURAL GAS**  
BLACK HILLS ENERGY  
198 COUNTY LINE RD.  
PALMER LAKE, CO 80133  
TELE: (719) 332-5856  
ATTN: BOB SWATEK  
EMAIL: BOB.SWATEK@BLACKHILLSCORP.COM

**FIRE**  
FALCON FIRE PROTECTION DISTRICT  
7030 OLD MERIDIAN RD.  
FALCON, CO 80831  
TELE: (719) 495-4050  
ATTN: TRENT HARWIG  
EMAIL: THARWIG@FALCONFIREPD.ORG

**COMMUNICATIONS**  
CENTURY LINK  
ZAYO  
USWEST

<p>I HEARBY CERTIFY THAT THIS ENGINEERING DOCUMENT WAS PREPARED BY ME OR UNDER MY DIRECT PERSONAL SUPERVISION AND THAT I AM A DULY LICENSED PROFESSIONAL ENGINEER UNDER THE LAWS OF THE STATE OF COLORADO.</p> <p>GREGORY LOUIS PANZA, P.E. _____ DATE: 00/00/0000 LICENSE NUMBER: 37081 MY LICENSE RENEWAL DATE IS OCTOBER 31, 2025. PAGES OR SHEETS COVERED BY THIS SEAL: - _____ - _____ - _____</p>
<p>I HEARBY CERTIFY THAT THIS ENGINEERING DOCUMENT WAS PREPARED BY ME OR UNDER MY DIRECT PERSONAL SUPERVISION AND THAT I AM A DULY LICENSED PROFESSIONAL ENGINEER UNDER THE LAWS OF THE STATE OF COLORADO.</p> <p>JEREMY D. MIRONAS, P.E. _____ DATE: 00/00/0000 LICENSE NUMBER: 47175 MY LICENSE RENEWAL DATE IS OCTOBER 31, 2025. PAGES OR SHEETS COVERED BY THIS SEAL: - _____ - _____ - _____</p>
<p>I HEARBY CERTIFY THAT THIS ENGINEERING DOCUMENT WAS PREPARED BY ME OR UNDER MY DIRECT PERSONAL SUPERVISION AND THAT I AM A DULY LICENSED PROFESSIONAL ENGINEER UNDER THE LAWS OF THE STATE OF COLORADO.</p> <p>DOUGLAS A. SULLIVAN, P.E. _____ DATE: 00/00/0000 LICENSE NUMBER: 57977 MY LICENSE RENEWAL DATE IS OCTOBER 31, 2025. PAGES OR SHEETS COVERED BY THIS SEAL: - _____ - _____ - _____</p>

<p>I HEARBY CERTIFY THAT THIS ENGINEERING DOCUMENT WAS PREPARED BY ME OR UNDER MY DIRECT PERSONAL SUPERVISION AND THAT I AM A DULY LICENSED PROFESSIONAL ENGINEER UNDER THE LAWS OF THE STATE OF COLORADO.</p> <p>KEVIN S. SPARROW, P.E. _____ DATE: 00/00/0000 LICENSE NUMBER: 47762 MY LICENSE RENEWAL DATE IS OCTOBER 31, 2025. PAGES OR SHEETS COVERED BY THIS SEAL: - _____ - _____ - _____</p>
<p>I HEARBY CERTIFY THAT THIS ENGINEERING DOCUMENT WAS PREPARED BY ME OR UNDER MY DIRECT PERSONAL SUPERVISION AND THAT I AM A DULY LICENSED PROFESSIONAL ENGINEER UNDER THE LAWS OF THE STATE OF COLORADO.</p> <p>NAME, P.E. _____ DATE: 00/00/0000 LICENSE NUMBER: 12345 MY LICENSE RENEWAL DATE IS DECEMBER 31, 2023. PAGES OR SHEETS COVERED BY THIS SEAL: - _____ - _____ - _____</p>
<p>I HEARBY CERTIFY THAT THIS ENGINEERING DOCUMENT WAS PREPARED BY ME OR UNDER MY DIRECT PERSONAL SUPERVISION AND THAT I AM A DULY LICENSED PROFESSIONAL ENGINEER UNDER THE LAWS OF THE STATE OF COLORADO.</p> <p>NAME, P.E. _____ DATE: 00/00/0000 LICENSE NUMBER: 12345 MY LICENSE RENEWAL DATE IS DECEMBER 31, 2023. PAGES OR SHEETS COVERED BY THIS SEAL: - _____ - _____ - _____</p>

DRAWN BY: Author	JOB DATE: 2024	BAR IS ONE INCH ON OFFICIAL DRAWINGS
APPROVED: Approver	JOB NUMBER: 201662.06	0 _____ 1"
CAD DATE: 7/8/2024 5:10:56 PM		IF NOT ONE INCH, ADJUST SCALE ACCORDINGLY
CAD FILE: C:\Users\kbargender\Documents\201662.06_MEP_v21_kbarg.rvt		

NO.	DATE	BY	REVISION DESCRIPTION

**HRGreen**  
HR GREEN - COLORADO SPRINGS  
1975 RESEARCH PARKWAY | SUITE 230  
COLORADO SPRINGS, CO 80920  
PHONE: 719.300.4140  
FAX: 713.965.0044

EL PASO COUNTY, COLORADO  
GRANDVIEW RESERVE DISTRICT  
D.R. HORTON  
COLORADO



GENERAL
COVER SHEET

SHEET
G000

PCD #: PPR-24-30



Provide El Paso county construction notes, metro district notes, etc

### LEGEND

	<b>EXISTING</b>	<b>PROPOSED</b>		<b>EXISTING</b>	<b>PROPOSED</b>
MATCH LINE			STORM SEWER		
PHASE LINE			MANHOLE		
SECTION LINE			STORM INLET		
PROPERTY LINE			FLARED END SECTION		
EASEMENT LINE			RIPRAP		
RIGHT OF WAY			SANITARY SEWER		
CENTERLINE			CLEAN OUT		
CHAIN LINK FENCE			MANHOLE		
WOODEN FENCE			PLUG		
ROD IRON FENCE			WATER		
GUARDRAIL			FIRE HYDRANT		
CABLE TV			FIRE DEPT. CONNECTION		
U.G. ELECTRIC			GATE VALVE		
OVERHEAD ELECTRIC			MANHOLE		
FIBER OPTIC			METER		
GAS MAIN			TEE		
SANITARY SEWER			REDUCER		
STORM DRAIN			DRY UTILITIES		
TELEPHONE			ELECTRIC METER		
WATER MAIN			ELECTRIC PEDESTAL		
SWALE			ELECTRICAL CABINET		
TRAIL			ELECTRIC VAULT		
CURB & GUTTER			FIBER OPTIC PULL BOX		
DRAINAGE BASIN			FIBER OPTIC MANHOLE		
INDEX CONTOUR			FIBER OPTIC PEDESTAL		
INTER. CONTOUR			FIBER OPTIC SIGN		
100-YR FLOODPLAIN			FIBER OPTIC VAULT		
FLOODWAY			GAS METER		
EDGE OF WETLANDS			GAS SIGN		
DRAINAGE			GAS VAULT		
DRAINAGE BASIN			TELEPHONE CABINET		
BASIN TAG			TELEPHONE MANHOLE		
DESIGN POINT			TELEPHONE SIGNAL/MAST		
			TELEPHONE SIGN		
			TELEPHONE PEDESTAL		
			TRANSFORMER		
			LIGHT POLE		
			FIBER OPTIC VAULT		
			MISCELLANEOUS		
			SIGN		
			BOLLARD		
			ACCESSIBLE PARKING		

### BMP LEGEND:

	CWA	CONCRETE WASHOUT AREA
	CF	CONSTRUCTION FENCE
	DD	DIVERSION DITCH
	IP	INLET PROTECTION
	OP	OUTLET PROTECTION
	SF	SILT FENCE
	VTC	VEHICLE TRACKING CONTROL
	SSA	STABILIZED STAGING AREA
	LOC	LIMITS OF CONSTRUCTION /DISTURBANCE
	CD	CHECK DAM
	SM	SEEDING AND MULCHING
	SB	SEDIMENT BASIN
	SR	SURFACE ROUGHENING
	ECB	EROSION CONTROL BLANKET
	CIP	CULVERT INLET PROTECTION
	RS	ROCK SOCK
	SBB	STRAW BALE BARRIER

Xref: xgt-1-dh01: Legend: Erosion\_Control\_Key

DRAWN BY: TAK      JOB DATE: \_\_\_\_\_  
 APPROVED: JAS      JOB NUMBER: \_\_\_\_\_  
 CAD DATE: 8/5/2024 1:40:50 PM  
 CAD FILE: J:\2020\201662.06\CAD\Dwgs\G\G003.dwg

BAR IS ONE INCH ON OFFICIAL DRAWINGS.  
 0" = 1"  
 IF NOT ONE INCH, ADJUST SCALE ACCORDINGLY.

NO.	DATE	BY	REVISION DESCRIPTION

**HRGreen**  
 HR GREEN - COLORADO SPRINGS  
 1975 RESEARCH PARKWAY | SUITE 230  
 COLORADO SPRINGS CO 80920  
 PHONE: 719.300.4140  
 FAX: 713.965.0044

EL PASO COUNTY, COLORADO  
 GRANDVIEW RESERVE DISTRICT  
 WTP WELL WATER COLLECTION  
 D.R. HORTON  
 COLORADO



CIVIL  
 CIVIL LEGENDS

SHEET  
 C100



























Xrefs: xg-1-d101: xc-design; DUP KEY: xv-dsgn\_662; xv-row-662; xv-uti\_662; xc-uti-F1-662; xc-dsgn-F1-662; xc-row-F1-662; xc-grid: xc-design-grid; xc-row\_662.08\_Eastonville; xc-dsgn-662.08\_Eastonville; xc-dsgn-uti; REVIT EXPORT\_FIRST FLOOR PROCESS PLAN

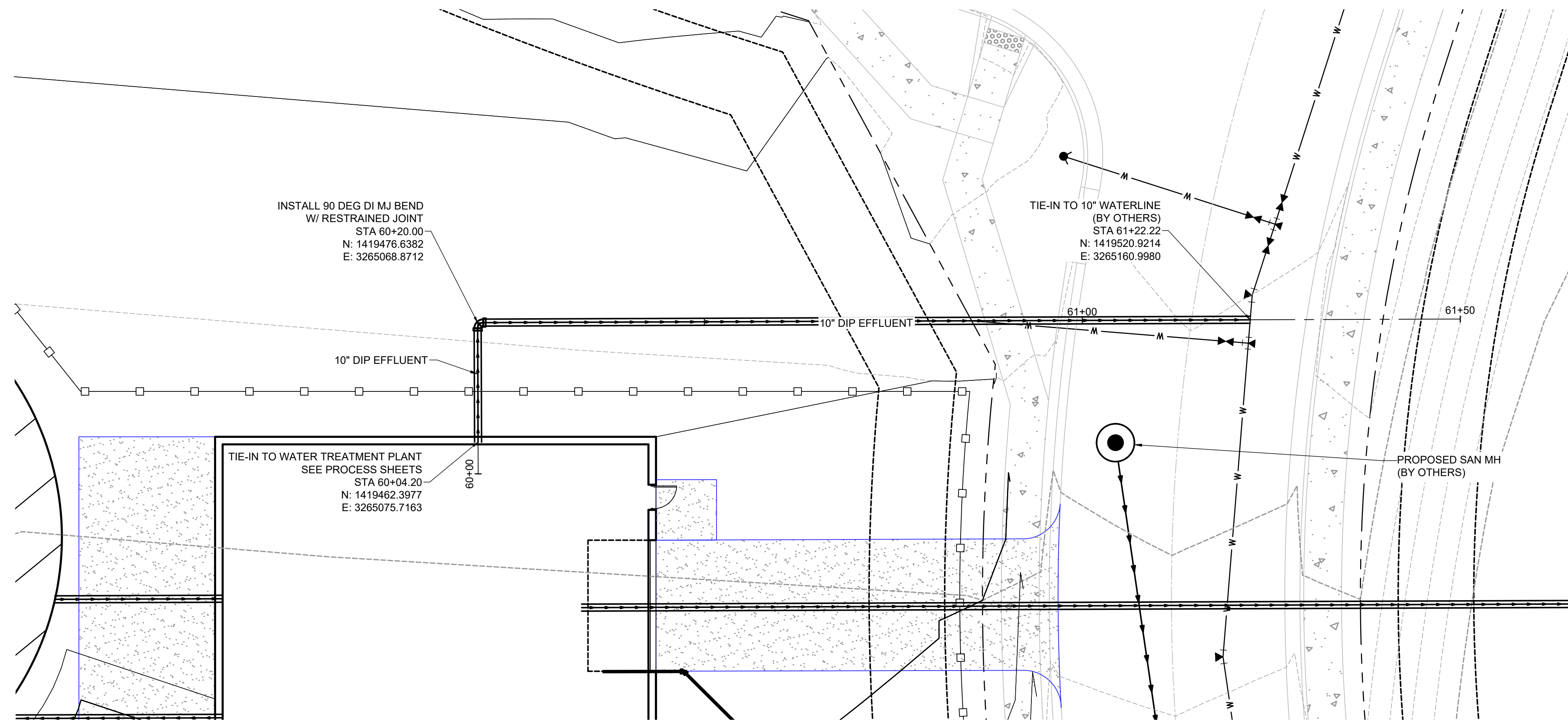

**GENERAL NOTES:**

- SEE G.XXX FOR XXXX WATER AND WASTEWATER SYSTEM STANDARDS AND INSTALLATION NOTES.
- SEE TECHNICAL SPECIFICATIONS FOR ADDITIONAL WATER AND WASTEWATER SPECIFICATIONS.

1 PLAN

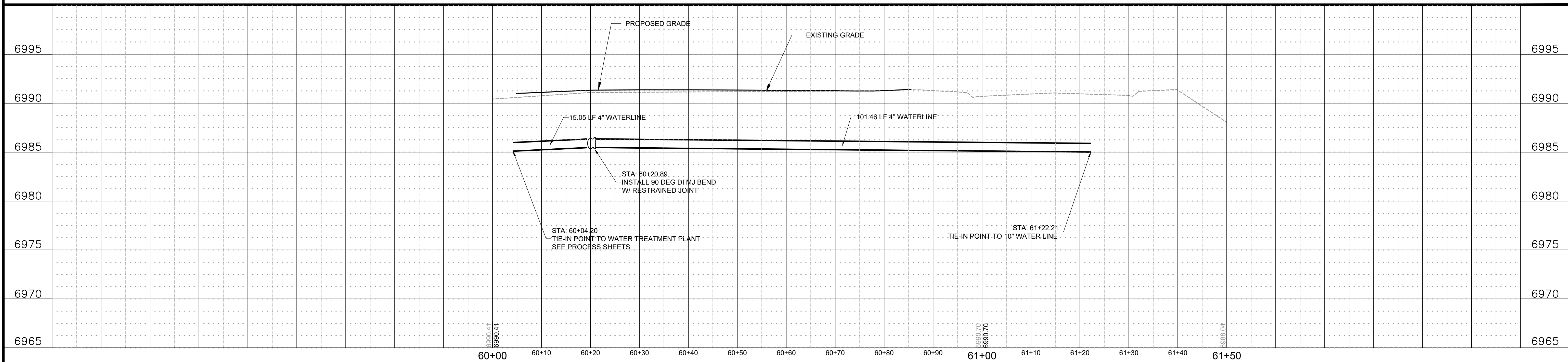
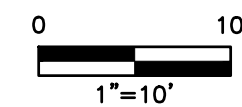

DRAWN BY: JAK JOB DATE: \_\_\_\_\_  
 APPROVED: JAS JOB NUMBER: \_\_\_\_\_  
 CAD DATE: 8/5/2024 3:10:08 PM  
 CAD FILE: J:\2020\201662.06\CAD\Dwgs\C\C104E-WTP EFFLUENT TO WATER SERVICE

BAR IS ONE INCH ON OFFICIAL DRAWINGS.  
 1" = 10'  
 IF NOT ONE INCH, ADJUST SCALE ACCORDINGLY.

NO.	DATE	BY	REVISION DESCRIPTION

**HRGreen**  
 HR GREEN - COLORADO SPRINGS  
 1975 RESEARCH PARKWAY | SUITE 230  
 COLORADO SPRINGS CO 80920  
 PHONE: 719.300.4140  
 FAX: 713.965.0044

EL PASO COUNTY, COLORADO  
 GRANDVIEW RESERVE DISTRICT  
 WTP WELL WATER COLLECTION  
 D.R. HORTON  
 COLORADO



CIVIL  
 10 INCH EFFLUENT TO WATER SERVICE PIPE  
 P&P

SHEET  
**C112**







