

# FALCON HWY

383'

OWNER - TUTHILL, DAVID + VALERIE  
 ADDRESS - 6405 E. BLANEY RD.  
 LEGAL - LOT 2, FAMILY OF FAITH SUB  
 ACRES - 5  
 SCHOOL - #49  
 PARCEL - 43170-04-032

148'

Released for Permit  
 11/19/2024 12:22:15 PM  
 Amy  
 ENUMERATION

SFD241066  
 PLAT 13299  
 RR-5

APPROVED  
 Plan Review  
 11/20/2024 12:51:07 PM  
 dsdrangel  
 EPC Planning & Community  
 Development Department

It is the owner's responsibility to  
 coordinate with easement holders  
 to avoid impact to utilities that  
 may be located in the easements.

ANY APPROVAL GIVEN BY  
 EL PASO COUNTY  
 DOES NOT OBTAIN THE NEED  
 TO COMPLY WITH APPLICABLE  
 FEDERAL, STATE, OR LOCAL  
 LAWS AND/OR REGULATION  
 Planning & Community Development Department  
 approval is contingent upon compliance with all  
 applicable notes on the recorded plat.  
 An access permit must be granted by the  
 Planning & Community Development Department  
 prior to the establishment of any driveway onto a  
 County road.  
 Diversion of blockage of any drainage way  
 is not permitted without approval of the  
 Planning & Community Development Department

APPROVED  
 BESQCP  
 11/20/2024 12:54:19 PM  
 dsdrangel  
 EPC Planning & Community  
 Development Department



273'

603'

197'

Proposed  
 Well

Proposed  
 modular  
 Home

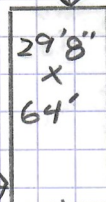

8'x16'  
 temporary  
 shed

265'

TP#2

1,000 Gal

TP#1



slope 80%

268'

BLANEY RD.

3 Bedroom House  
 1,000 GAL Septic Tank  
 630' Leach Field  
 3 Rows @ 55'  
 1 Row @ 45'

341'

# RESIDENTIAL



2023 PPRBC  
IECC: N/A

Address: 6405 E BLANEY RD, PEYTON

Plan Track #: 196274 

Received: 19-Nov-2024 (BRIANNAM)

Parcel: 4317004032



## Description:

**RES MFG HSG-IRC ON CRAWL**

Contractor: POULSON CONSTRUCTION, INC.

Type of Unit:

## Required PPRBD Departments (6)

<p><b>Enumeration</b> Released for Permit 11/19/2024 12:24:03 PM  Amy ENUMERATION</p>	<p><b>Floodplain</b>  (N/A) RBD GIS</p>
<p><b>Construction</b> Released for Permit 11/20/2024 11:49:53 AM  justinl CONSTRUCTION</p>	<p><b>Electrical</b></p>
<p><b>Mechanical</b></p>	<p><b>Plumbing</b></p>

Release of this plan does not preclude compliance with all applicable codes, ordinances and other pertinent regulations. This plan set must be present on the job site for every inspection.

# Required Outside Departments (1)

**County Zoning**

**APPROVED**

**Plan Review**

*11/20/2024 12:51:37 PM*

*dsdrangel*

**EPC Planning & Community  
Development Department**