

- Provide temporary sediment basins as appropriate.
- Show and label temporary and permanent seeding and mulching and other items highlighted in the FAE. Certain items may be labeled as "phase 2" or as otherwise appropriate.
- See comment letter.

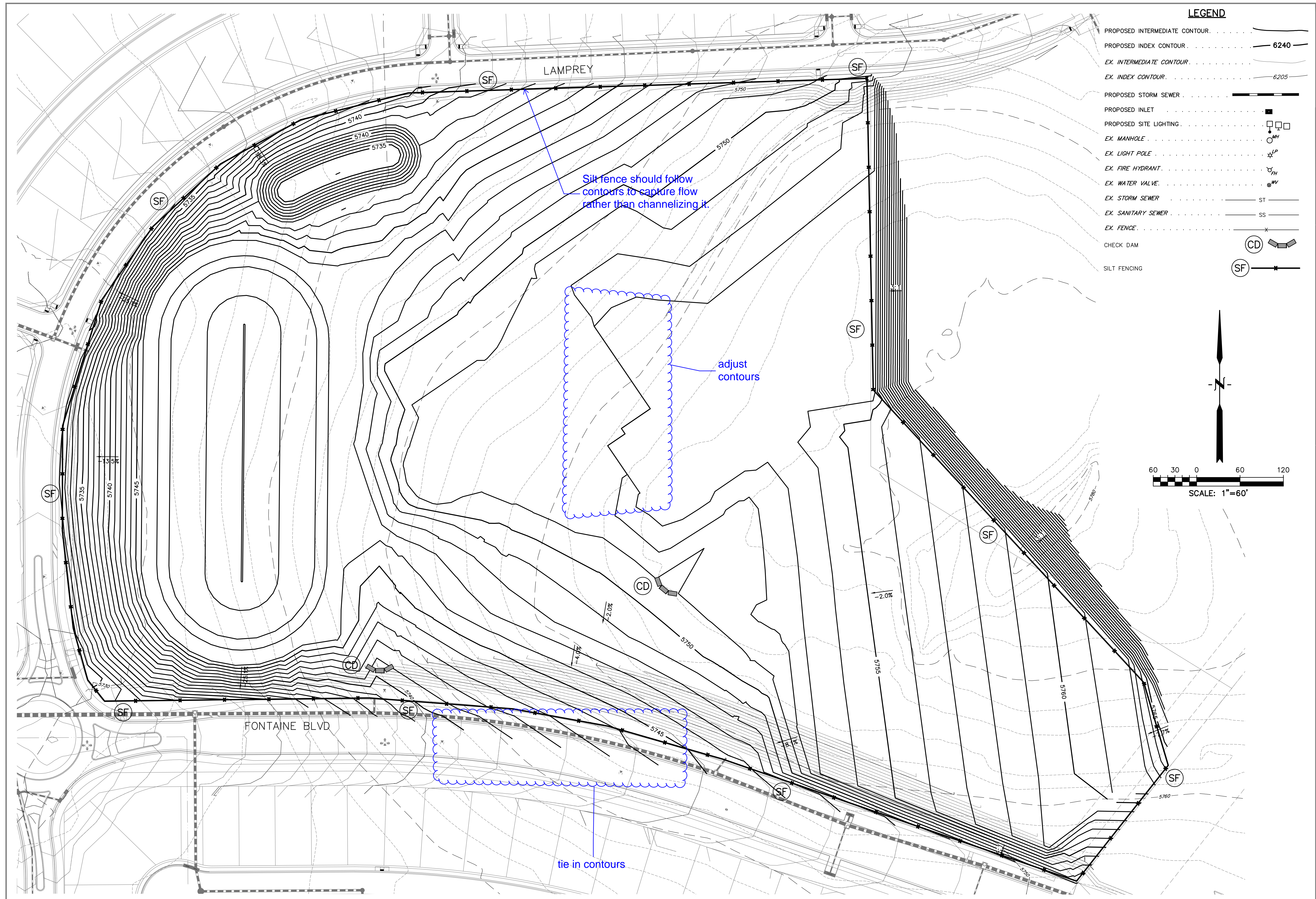

 DREXEL, BARRELL & CO. Engineers-Surveyors 3 SOUTH 7TH STREET COLORADO SPRINGS, COLORADO 80905 CONTACT: TIM D. MCCONNELL, P.E. (719)260-8887 BOULDER • COLORADO SPRINGS • GREELEY	
DATE	
DESCRIPTION	
NO.	
PROJECT	LORSON RANCH EAST
PREPARED FOR	LORSON RANCH EAST FONTAINE BLVD. - EAST TRIBUTARY EL PASO COUNTY, COLORADO
DRAWN	X
DESIGNED	X
CHECKED	X
LORSON RANCH EAST EARLY SITE GRADING OFFSITE BORROW AREA - SCHOOL SITE	
DATE	FEBRUARY 14, 2018
PROJECT NO.	100.040
SHEET NUMBER	C5.12
TOTAL SHEETS:	28

2016 Financial Assurance Estimate Form (with pre-plat construction)

Effective Date: 5/16/2016

Project Information	
NEW WIDEFIELD PK-8 SCHOOL	2/14/2018
Project Name	Date

Section 1 - Grading and Erosion Control BMPs	Quantity	Units	Price	Total	% Complete	Remaining
Earthwork*	150,000.00	CY	@ \$ 3	\$ 450,000.00		\$ 450,000.00 *
Permanent Seeding* (inc. noxious weed mgmnt.)		AC	@ \$ 582	\$ 0.00		\$ - *
Mulching*		AC	@ \$ 507	\$ 0.00		\$ - *
Permanent Erosion Control Blanket*		SY	@ \$ 6	\$ 0.00		\$ - *
Temporary Erosion Control Blanket		SY	@ \$ 3	\$ 0.00		\$ -
Vehicle Tracking Control		EA	@ \$ 1626	\$ 0.00		\$ -
Safety Fence		LF	@ \$ 3	\$ 0.00		\$ -
Silt Fence	4,426.00	LF	@ \$ 4	\$ 17,704.00		\$ 17,704.00
Temporary Seeding	25.00	AC	@ \$ 485	\$ 12,125.00		\$ 12,125.00
Temporary Mulch		AC	@ \$ 507	\$ 0.00		\$ -
Erosion Bales	6.00	EA	@ \$ 21	\$ 126.00		\$ 126.00
Erosion Logs		LF	@ \$ 21	\$ 0.00		\$ -
Rock Ditch Checks	2.00	EA	@ \$ 98	\$ 196.00		\$ 196.00
Inlet Protection		EA	@ \$ 153	\$ 0.00		\$ -
Sediment Basin		EA	@ \$ 1625	\$ 0.00		\$ -
Concrete Washout Basin		EA	@ \$ 776	\$ 0.00		\$ -
		@	\$	0.00		\$ -
* Subject to defect warranty financial assurance. DO NOT ENTER MORE THAN 80% COMPLETE. A minimum of 20% to be retained up to preliminary acceptance process						
Section 1 Subtotal				\$ 480,151.00		\$ 480,151.00

Section 2 - Public Improvements**	Quantity	Units	Price	Total	% Complete	Remaining
- Roadway Improvements				0.00		
Construction Traffic Control		LS	@ \$ 25000	\$ 0.00		\$ - *
Aggregate Base Course - 8"		Tons	@ \$ 18	\$ 0.00		\$ - *
Asphalt Pavement - 5"		Tons	@ \$ 65	\$ 0.00		\$ - *
Raised Median, Paved		SF	@ \$ 7	\$ 0.00		\$ - *
Electrical Conduit, Size =		LF	@ \$ 14	\$ 0.00		\$ - *
Traffic Signal, complete intersection		EA	@ \$ 250000	\$ 0.00		\$ - *
Regulatory Sign		EA	@ \$ 100	\$ 0.00		\$ - *
Advisory Sign		EA	@ \$ 100	\$ 0.00		\$ - *
Guide/Street Name Sign		EA	@ \$ 200	\$ 0.00		\$ - *
Epoxy Pavement Marking		SF	@ \$ 12	\$ 0.00		\$ - *
Thermoplastic Pavement Marking		SF	@ \$ 22	\$ 0.00		\$ - *
Barricade - Type 3		EA	@ \$ 115	\$ 0.00		\$ - *
Delineator (Type I)		EA	@ \$ 21	\$ 0.00		\$ - *
Curb and Gutter, Type C (Ramp)		LF	@ \$ 21	\$ 0.00		\$ - *
Curb and Gutter, Type A (6" Vertical)		LF	@ \$ 16	\$ 0.00		\$ - *
Curb and Gutter, Type B (Median)		LF	@ \$ 13	\$ 0.00		\$ - *
Pedestrian Ramp		SY	@ \$ 108	\$ 0.00		\$ - *
Cross Pan		SY	@ \$ 53	\$ 0.00		\$ - *
Curb Chase		EA	@ \$ 1300	\$ 0.00		\$ - *
Guardrail Type 3 (W-Beam)		LF	@ \$ 33	\$ 0.00		\$ - *
Guardrail Type 7 (Concrete)		LF	@ \$ 67	\$ 0.00		\$ - *
Guardrail End Anchorage		EA	@ \$ 1985	\$ 0.00		\$ - *
Guardrail Impact Attenuator		EA	@ \$ 3564	\$ 0.00		\$ - *
Sound Barrier Fence		LF	@ \$ 20772	\$ 0.00		\$ - *
4" Concrete Sidewalk (common areas)		SY	@ \$ 23	\$ 0.00		\$ -
5" Concrete Sidewalk (adjacent to roadways)		SY	@ \$ 58	\$ 0.00		\$ -
- Storm Drain Improvements						

Det ponds			@	\$ 50000	=	\$ 0.00	\$ -
			@	\$ 65000	=	\$ 0.00	\$ -
			@	\$ 20000	=	\$ 0.00	\$ -
- Storm Drain Improvements							
(Include any applicable items from above Public Improvements list, that are to be private and NOT maintained by El Paso County)			@	\$ 4	=	\$ 0.00	\$ -
			@	\$ 8000	=	\$ 0.00	\$ -
			@	\$ 3000	=	\$ 0.00	\$ -
			@	\$ 98	=	\$ 0.00	\$ -
			@	\$ 58	=	\$ 0.00	\$ -
			@	\$ 4000	=	\$ 0.00	\$ -
			@	\$ 10000	=	\$ 0.00	\$ -
- Water System Improvements							
Water Main Pipe (PVC), Size 8"		LF	@	\$ 94	=	\$ 0.00	\$ -
Water Main Pipe (PVC), Size 12"		LF	@	\$ 120	=	\$ 0.00	\$ -
Water Main Pipe (PVC), Size 16"		LF	@	\$ 135	=	\$ 0.00	\$ -
Gate Valves, 8"		EA	@	\$ 1852	=	\$ 0.00	\$ -
Gate Valves, 12"		EA	@	\$ 4951	=	\$ 0.00	\$ -
Gate Valves, 16"		EA	@	\$ 6448	=	\$ 0.00	\$ -
Fire Hydrant Assembly w/ all valves		EA	@	\$ 6430	=	\$ 0.00	\$ -
Fire Cistern Installation, complete		EA	@	\$ 1253	=	\$ 0.00	\$ -
- Sanitary Sewer Improvements							
Sewer Main Pipe (PVC), Size 8"		LF	@	\$ 94	=	\$ 0.00	\$ -
Sewer Main Pipe (PVC), Size 12"		LF	@	\$ 120	=	\$ 0.00	\$ -
Sewer Main Pipe (PVC), Size 15"		LF	@	\$ 135	=	\$ 0.00	\$ -
Sanitary Sewer Manhole, Depth < 15 feet		EA	@	\$ 4575	=	\$ 0.00	\$ -
Sanitary Sewer Lift Station, complete		EA	@	\$ 1516	=	\$ 0.00	\$ -
- Landscaping (If Applicable)							
(List landscaping line items and cost - usually only in case of subdivision specific condition of approval, or PUD)		EA	@	\$	=	\$ 0.00	\$ -
		EA	@	\$	=	\$ 0.00	\$ -
		SF	@	\$ 3.75	=	\$ 0.00	\$ -
		SY	@	\$ 2.50	=	\$ 0.00	\$ -
		EA	@	\$	=	\$ 0.00	\$ -
***items in this section are not subject to defect warranty financial assurance				Section 3 Subtotal		\$ 0.00	\$ -

Financial Assurance Totals	
As-built drawings - (FILL IN IF THERE ARE ANY PUBLICLY-MAINTAINED IMPROVEMENTS)	\$ \$ -
(Inc. survey to verify detention pond volumes.)	Total Construction Financial Assurance \$480,151.00
	(Sum of all section subtotals)
	Total Remaining Construction Financial Assurance 480,151.00
	(Sum of all section totals less credit for items complete)
	Total Defect Warranty Financial Assurance \$90,000.00
	(20% of all items identified as public improvements*). To be collateralized at time of preliminary acceptance)

Approvals

I hereby certify that this is an accurate and complete estimate of costs for the work as shown on the approved Construction Drawings associated with the Project.

Engineer _____ Date _____

(P.E. Seal)

Approved by Owner / Applicant

Date

Approved by El Paso County Engineer / ECM Administrator

Date