



DENVER, CO OFFICE
 1210 SOUTH JASON ST.
 DENVER, CO. 80223
 303.762.3537

LAS VEGAS, NV OFFICE
 6445 W. SUNSET RD. SUITE 124
 LAS VEGAS, NV. 89118
 702.497.1753

BELGRADE, MT OFFICE
 528 N. RIVER ROCK DR.
 BELGRADE, MT. 59714
 406.690.1204

CONTACT NAME MATT COLLINS
CONTACT EMAIL MCOLLINS@CT-LC.COM
CONTACT PHONE 303.505.6297

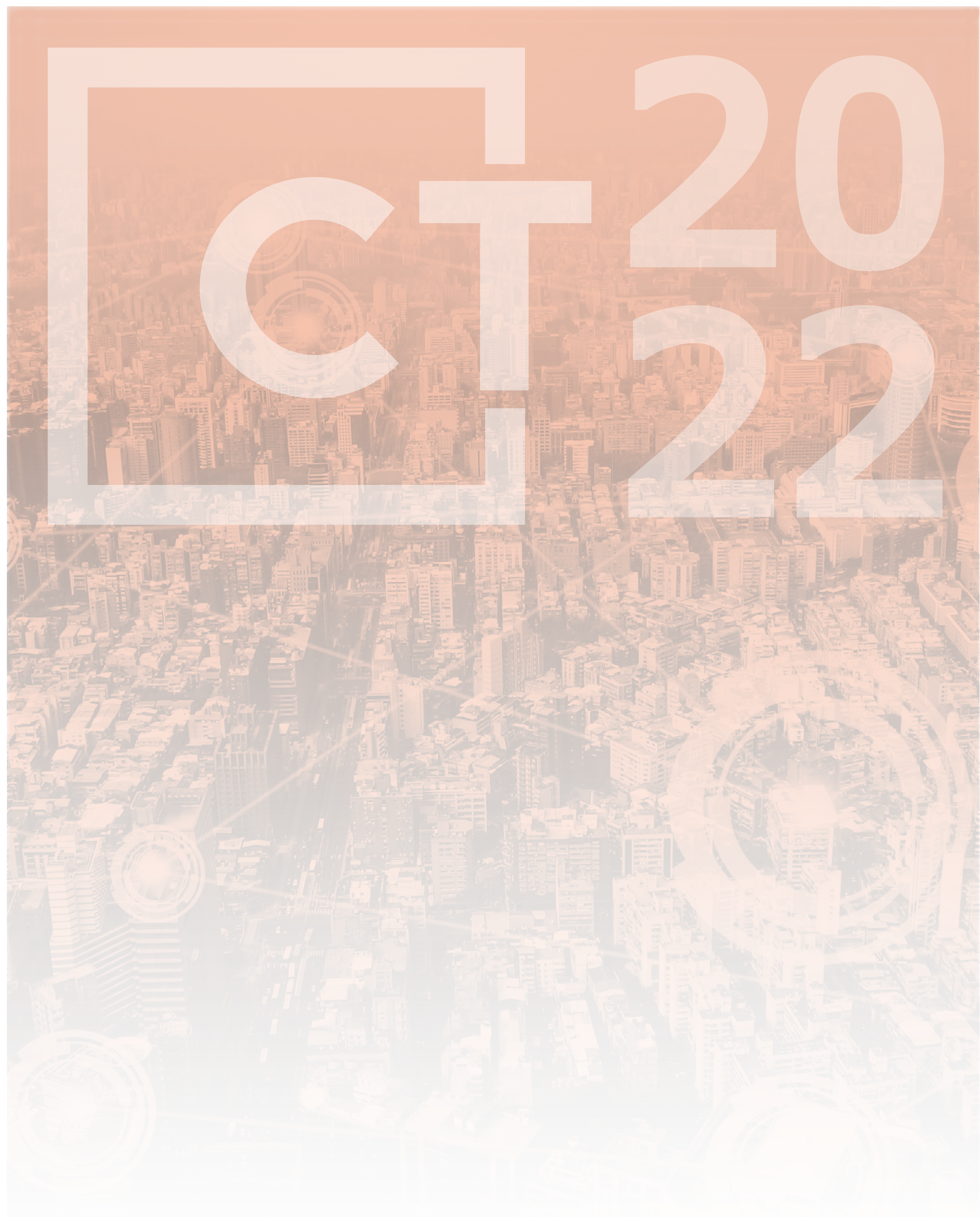

PROJECT

FUEL CHURCH EXTERIOR



LTG SUBMITTER_{CR}

LOCATION

DATE 1.25.22

CTRL CONTACT

CONTACT MATT COLLINS

RENDERINGS, SUMMARIES

Luminaire Schedule							
Label	Symbol	Qty	Description	Lum. Watts	No. Lamps	LLF	Lum. Lumens
A		3	C-AR-A-SL4-10L-40K-UL-3PC-DB	72.74	1	1.000	9914

Results generated by this tool are provided for informational purposes only, without any warranty as to accuracy, completeness, reliability or otherwise. The calculated results may be dependent on user provided data or data provided from publicly available sources, and do not take into account all factors and circumstances. Any photometric values have been calculated using methods recommended by the Illuminating Engineering Society of North America (IESNA) and/or standard industry practice. Photometric calculations performed using this tool are based on photometric data provided by the manufacturer, and the accuracy of the calculated photometric performance is dependent on the accuracy of the data provided. End-user environment and application (including, but not limited to, voltage variation and dirt accumulation) can cause actual photometric performance to differ from the performance calculated using the data provided by the manufacturer.

Calculation Summary								
Label	Units	Avg	Max	Min	Avg/Min	Max/Min	PtSpclr	PtSpctb
grass_1_Top	Fc	2.38	10.1	0.1	23.80	101.00	6	6
grass_Top	Fc	0.02	8.1	0.0	N.A.	N.A.	6	6
parking lot_Planar	Fc	0.63	6.3	0.0	N.A.	N.A.	6	6
PROPERTY LINE	Fc	0.01	0.1	0.0	N.A.	N.A.	6	N.A.
sidewalk_Top	Fc	3.34	9.9	0.3	11.13	33.00	6	6



PHOTOMETRICS: POINT BY POINT

ISOLINES

- 0.1 FC —
- 1 FC —
- 4 FC —
- 9 FC —

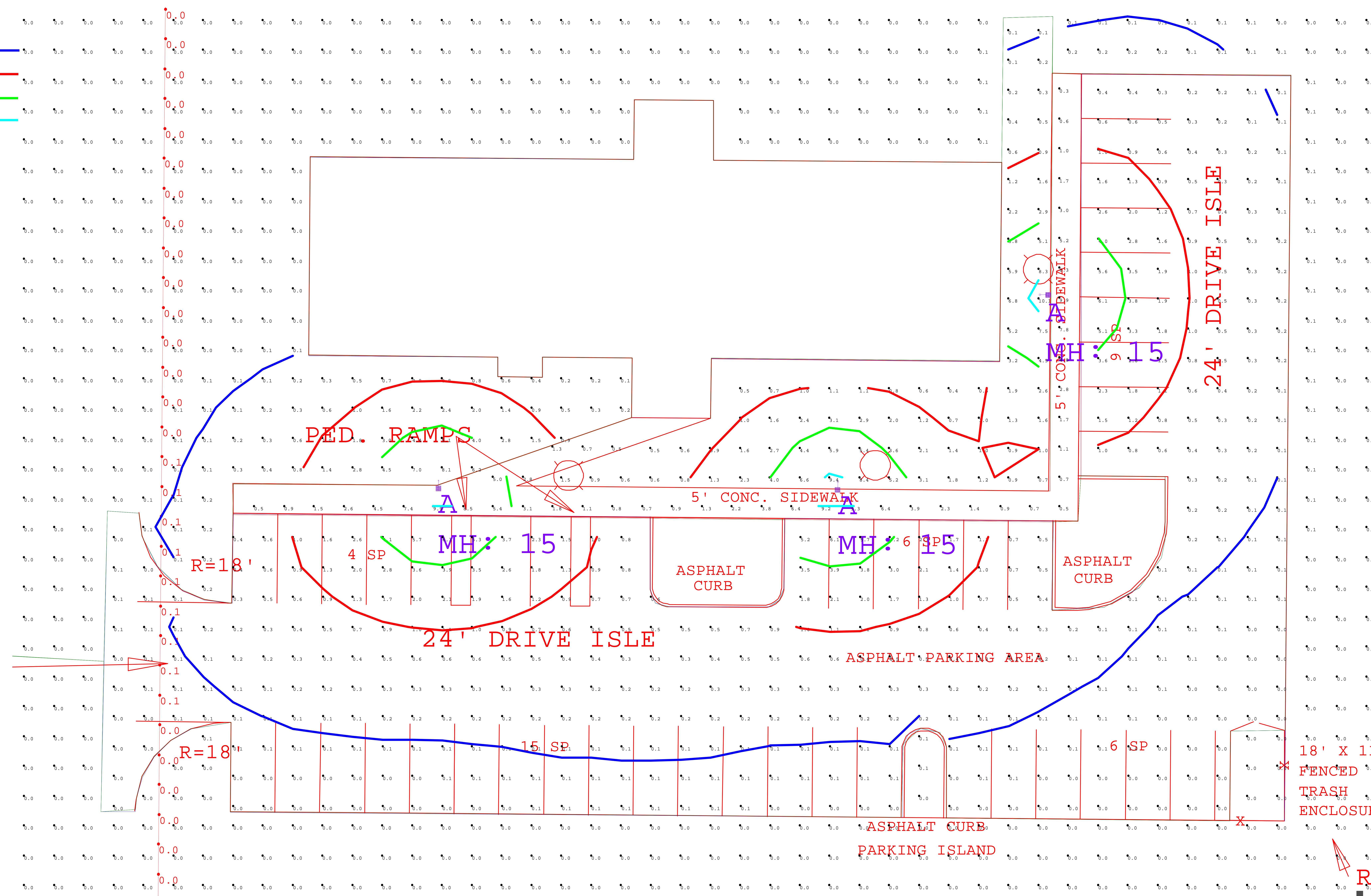

PROJECT FUEL CHURCH EXTERIOR	LOCATION	DATE 1.25.22	PG 3
LTG SUBMITTER CR	CTRL CONTACT	CONTACT Matt Collins	

C-AR-A-SL3/SL4/SL5-9L/10L Series

LED Area Light - Type III/Type IV/Type V
Replaces 250W MH



EXCEPTIONAL EFFICIENCY, EASY INSTALLATION, HIGH RELIABILITY.

Get big energy savings from this highly reliable LED area light at a great value price.



PRODUCT SPECIFICATIONS

OVERVIEW

- Initial Delivered Lumens: 9,200 - 10,100
- CRI: 80+
- CCT: 3000K, 4000K, 5000K
- Mounting: Sold Separately
- Input Power: 73 Watts
- Dimmable: (0-10V) Dimming to 10%
- Operating Temperature Range: -40°C (-40°F) - 40°C (104°F)
- Estimated L70 Lifetime @ 25°C: >100,000 hours
- Power Factor: > 0.9
- Total Harmonic Distortion: < 20%
- Limited Warranty: 5 Years*
- Replaces 250W MH

FEATURES	RECOMMENDED USE	INPUT VOLTAGE
<ul style="list-style-type: none"> • Exceptional rebate friendly efficiency up to 136 LPW • Light weight for easy installation • Enhanced 10kVA surge suppression for high reliability • Sleek, high performance design 	<ul style="list-style-type: none"> • Automobile Dealerships • Parking Lots • General Area Lighting 	<ul style="list-style-type: none"> • Universal (120V through 277V Operation)

ORDERING INFORMATION

Example: C-AR-A-SL3-9L-30K-UL-3PC-DB

C-AR-A				UL	3PC	DB
PRODUCT	TYPE	LUMEN PACKAGE	CCT	VOLTAGE	INCLUDED	COLOR
C-AR-A	SL3 Area Light Type III SL4 Area Light Type IV SL5 Area Light Type V	9L Type III: 9,200 Lumens, 73W, (30K) 9,400 Lumens, 73W, (40K) Type IV: 9,300 Lumens, 73W, (30K) 9,400 Lumens, 73W, (40K) Type V: 9,300 Lumens, 73W, (30K) 10L Type III: 9,900 Lumens, 73W, (50K) Type IV: 9,900 Lumens, 73W, (50K) Type V: 9,800 Lumens, 73W, (40K) 10,100 Lumens, 73W, (50K)	30K Warm White (3000K) 40K Neutral White (4000K) 50K Cool White (5000K)	UL 120V-277V	3PC 3-Pin Receptacle w/ Shorting Cap	DB Dark Bronze

CERTIFICATIONS:



C-AR-A-SL3/SL4/SL5-9L/10L Series

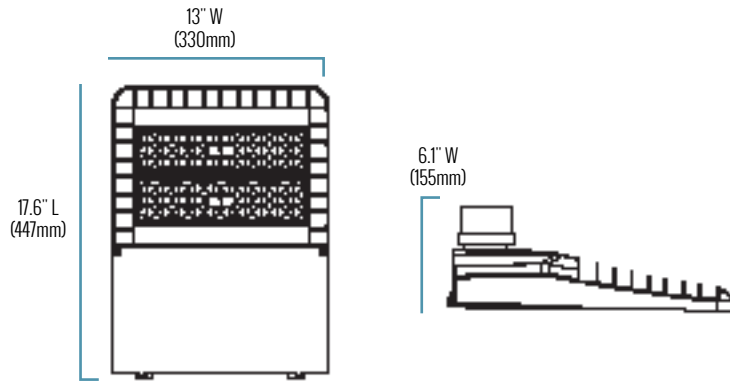

SERIES OVERVIEW

DIMENSIONS	PRODUCT WEIGHT	MOUNTING HEIGHT	SPACING
17.6" (447mm) L x 13" (330mm) W x 6.1" (155mm) H (with short cap)	10 lbs.	15-24 feet typical	4 to 5 times the mounting height to meet minimum security lighting

FIXTURE SPECIFICATIONS

HOUSING	Die-cast aluminum with hinged door for easy installation UV stabilized powder coat finish
LENS ASSEMBLY	Type III optics, Type IV optics, Type V optics
MOUNTING (SOLD SEPARATELY)	2" Slip Fitter for 2 3/8" O.D. tenon Trunnion Mount 8" direct arm pole mount Tilt up to 45° orientation only

ELECTRICAL PERFORMANCE

OPERATING TEMPERATURE RANGE	ESTIMATED L70 LIFETIME @ 25°C (77°F)	POWER FACTOR	TOTAL HARMONIC DISTORTION
-40°C (-40°F) - 40°C (104°F)	>100,000 Hours	>0.9	<20%

LUMEN PACKAGE	SYSTEM WATTS (120-277V)	CURRENT DRAW (AMPS)			
		120V	208V	240V	277V
9L/10L	73W	0.611A	0.353A	0.306A	0.282A

WARRANTY AND CERTIFICATIONS

WARRANTY	UL LISTED	DLC	INTERNATIONAL DARK SKY
5 Year Limited*	Wet Locations	DLC Premium Qualified. Please refer to www.designlights.org/QPL for most current information.	Dark Sky Friendly, IDA Approved when ordered with 30K CCT and direct pole mount only. Please refer to https://www.darksky.org/our-work/lighting/lighting-for-industry/fsa/fsa-products/ for most current information.

CA RESIDENTS WARNING: Cancer and Reproductive Harm - www.p65warnings.ca.gov

US- creelighting.com, e-conolight.com

Distribution/Sales- 855-617-2733 Customer Services- 888-243-9445

Rev. Date: V2 05/20/2020

For informational purposes only. Content is subject to change. *See lighting.cree.com/warranty for details



C-LITE
LED LIGHTING

C-AR-A-SL3/SL4/SL5-9L/10L Series

ACCESSORIES

	PHOTOCELL - NEMA 3-PIN STYLE
	SKU: C-ACC-A-PCELL-NEMA3-LV USE: Dusk to Dawn operation

MOUNTING OPTIONS

	8" DIRECT POLE MOUNT
	SKU: C-ACC-MTPL-AR-SL345-8IN-DB USE: Mounts to minimum 4" square poles. For use with C-AR-A-SL Series only
	TRUNNION MOUNT U BRACKET
	SKU: C-ACC-A-AUB-AR-SL345-3X5X6-DB USE: For wall mounting on C-AR-A-SL Series
	2" SLIP FITTER
	SKU: C-ACC-A-MTSL-2IN USE: 2" Slip fitter for pole mount 2 3/8" tenon

C-AR-A-SL3/SL4/SL5-9L/10L Series

LUMINAIRE EPA

Direct Pole Arm Mount - C-ACC-MTPL-AR-SL345-8IN-DB

LUMEN PACKAGE	SINGLE	2 @ 90°	2 @ 180°	3 @ 90°	3 @ 120°	4 @ 90°
9L/10L	0.69	1.02	1.38	1.71	N/A	2.04

Adjustable Arm Mount - C-ACC-A-MTSL-2IN

	SINGLE	2 @ 180°	2 @ 90°	3 @ 90°	3 @ 120°	3 @ 180°	4 @ 180°	4 @ 90°
Lumen Package	PB-1A*; PW-1A3**	PB-2A*; PD-2A4(180); PW-2A3**	PB-2A*; PD-2A4(90)	PB-3A*; PD-3A4(90)	PB-3A*	PB-3A*	PB-4A*(180)	PB-4A*(90) PD-4A4(90)

0° TILT								
All Lumen Packages	0.71	1.42	1.42	2.13	2.13	2.13	2.84	2.84
10° TILT								
All Lumen Packages	0.71	1.42	1.42	2.30	2.30	2.30	2.84	2.84
20° TILT								
All Lumen Packages	0.97	1.94	1.94	2.91	2.91	2.91	3.88	3.88
30° TILT								
All Lumen Packages	1.16	2.32	2.32	3.48	3.48	3.48	4.64	4.64
45° TILT								
All Lumen Packages	1.34	2.68	2.68	4.02	4.02	4.02	5.36	5.36

© 2020 Cree Lighting, A company of IDEAL INDUSTRIES. All rights reserved. For informational purposes only. Content is subject to change. Patent www.creelighting.com/patents. C-LITE® and the C-LITE logo are registered trademarks of Cree Lighting. The UL logo is a registered trademark of UL LLC. The DLC QPL logo is a registered trademark of Efficiency Forward, Inc.

US· creelighting.com, e-conolight.com

Distribution/Sales· 855-617-2733 Customer Services· 888-243-9445

Rev. Date: V2 05/20/2020

For informational purposes only. Content is subject to change. *See lighting.cree.com/warranty for details

C-LITE
LED LIGHTING