

M:\LAND PROJECTS\2016\160301 - Existing Conditions.dwg Jim Gill Tue, 05/19/16 2:05 PM

LEGEND

- BASIN DESIGNATION
- BASIN AREA, ACRES
- 5 YEAR STORM, CFS
- 100 YEAR STORM, CFS
- DESIGN POINT
- 5 YEAR ACCUMULATED FLOW, CFS
- 100 YEAR ACCUMULATED FLOW, CFS
- SUB-BASIN BOUNDARY
- DIRECTION OF DRAINAGE FLOW

TABLE 1 - EXISTING CONDITIONS		
Sub-Basin	Q5CFS	Q100 CFS
OS1	3.3	15.3
OS2	4	28
OS3	17.8	62
OS4	8.2	36.7
OS5	1.3	3.3
A1	2.2	16.5
A2	3.1	24
A3	1.1	5.3
B	0.2	1.6
DP1 (OS1 + OS2)	6.4	39
DP2 (DP1 + A2)	7.9	52.1
DP3 (OS3 + OS4)	24.8	94.8
DP4 (DP3+OS5 + A3)	23.3	89
DP5 (DP2 + DP4 + A1)	33.3	156.2

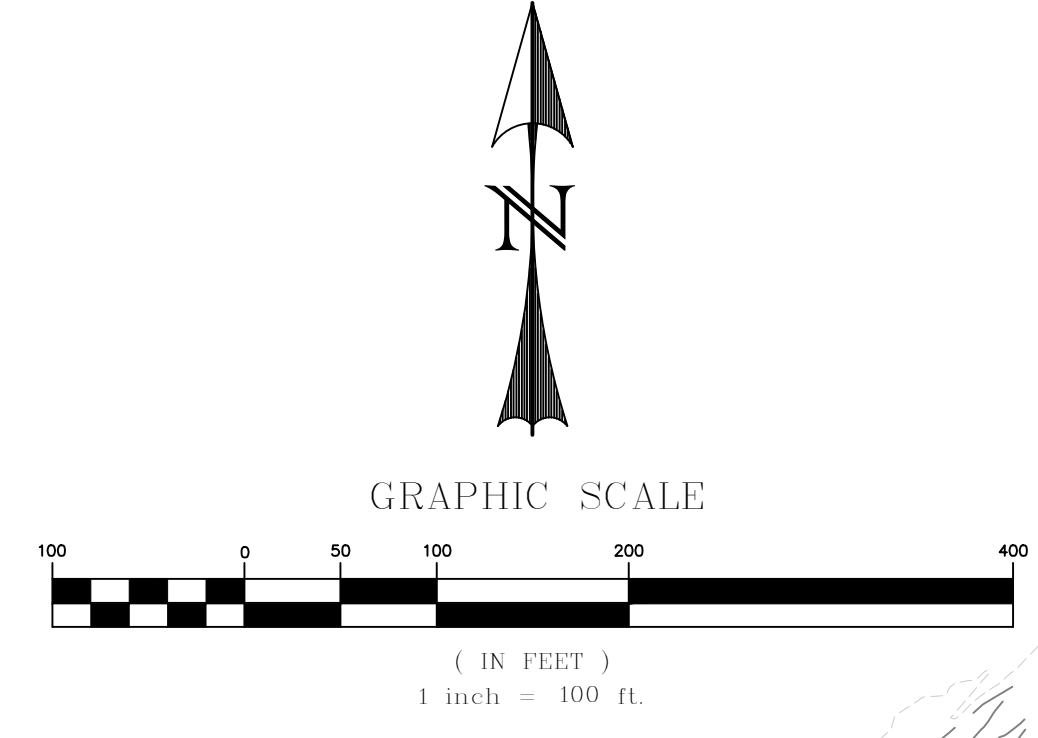
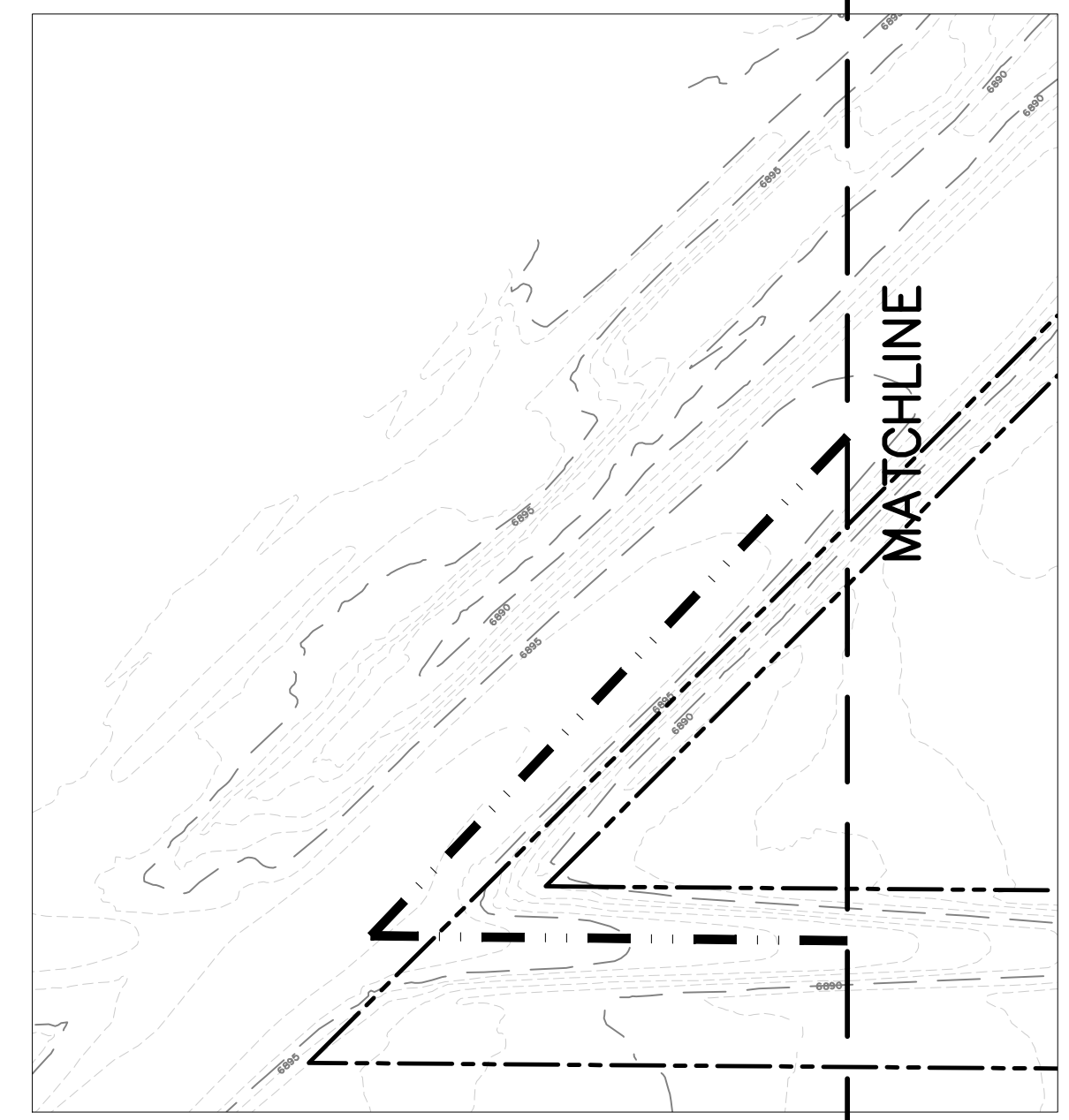

FOR CONTINUATION OF BASIN
SEE OFF-SITE MAP FOR O-1 IN
APPENDIX B

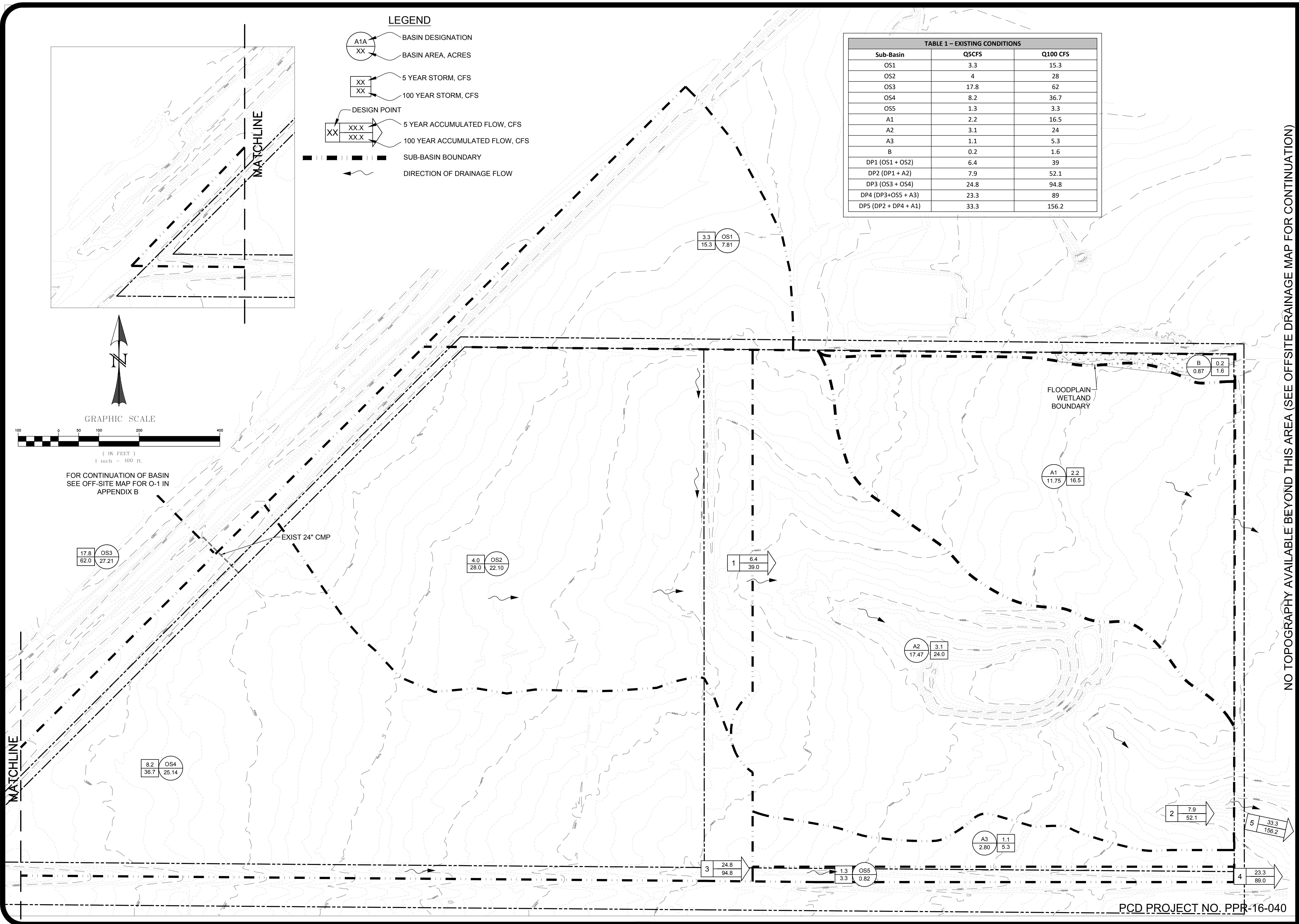

NO TOPOGRAPHY AVAILABLE BEYOND THIS AREA (SEE OFFSITE DRAINAGE MAP FOR CONTINUATION)

DESIGNED BY: MAB
PROJECT ENGINEER: MAB
JOB NO.: 160301
DATE: 6/20/16
PROJECT MANAGER: MAB
CAD FILE NO.: 160301-Existing Conditions.dwg
SCALE: 1" = 100'
DRAWN BY: HJG
VERT. 1" = 100'

PREPARED BY:

3520 Austin Bluffs Parkway Suite 102
Colorado Springs, CO 80918
(719) 266-5212
fax: (719) 266-5341

NO.	DATE	REVISION	BY

JUDGE ORR ROAD RV PARK & STORAGE
COLORADO SPRINGS, COLORADO
DRAINAGE - EXIST OVERALL CONDITIONS

SHEET
1 of 3