

Procedures Manual

Subject: DEVIATION REVIEW AND DECISION FORM

Date Issued: 12/31/07
Revision Issued: N/A
Rescinded: N/A

1.1. PURPOSE

The purpose of this resource is to provide a form for documenting the findings and decision by the ECM Administrator concerning a deviation request.

1.2. BACKGROUND

A deviation is a critical aspect of the review process and needs to be documented to ensure that the deviations granted are applied to a specific development application in conformance with the criteria for approval and that the action is documented as such requests can point to potential needed revisions to the ECM.

1.3. APPLICABLE STATUTES AND REGULATIONS

Section 5.9 of the ECM establishes a mechanism whereby an engineering design standard can be modified when if strictly adhered to, would cause unnecessary hardship or unsafe design because of topographical or other conditions particular to the site, and that a departure may be made without destroying the intent of such provision.

1.4. APPLICABILITY

All provisions of the ECM are subject to deviation by the ECM Administrator provided that one of the following conditions is met:

- The ECM standard is inapplicable to a particular situation.
- Topography, right-of-way, or other geographical conditions or impediments impose an undue hardship on the applicant, and an equivalent alternative that can accomplish the same design objective is available and does not compromise public safety or accessibility.
- A change to a standard is required to address a specific design or construction problem, and if not modified, the standard will impose an undue hardship on the applicant with little or no material benefit to the public.

1.5. TECHNICAL GUIDANCE

The review shall ensure all criteria for approval are adequately considered and that justification for the deviation is properly documented.

1.6. RELATED PROCEDURES

1.6.1. Governing Procedures

P-AR-063-07 Deviation

1.6.2. Other Related Procedures

P-AR-012-07 Administrative Relief

1.7. RESOURCE

Attached is the Deviation Review and Decision Form that is used by the applicant/engineer for requesting and justifying a deviation. The form is reviewed by the ECM Administrator and approved or denied. The form is used to document the review and decision concerning a requested deviation. The request and decision concerning each deviation from a specific section of the ECM shall be recorded on a separate form.



Development Services Department
 2880 International Circle
 Colorado Springs, Colorado 80910

Phone: 719.520.6300
 Fax: 719.520.6695
 Website www.elpasoco.com

**DEVIATION REVIEW
 AND DECISION FORM**

Procedure # R-FM-051-07
 Issue Date: 12/31/07
 Revision Issued: 00/00/00

DSD FILE NO.:

--	--	--	--	--	--	--	--

General Property Information:

Address of Subject Property (Street Number/Name): 14010 Judge Orr Road
 Tax Schedule ID(s) #: 4233000027
 Legal Description of Property: Tract located at SW4SW4 SEC 33-12-64 TOG WITH THE ELY 20.0 FT OF THE SE4SE4 SEC 32-12-64

Subdivision or Project Name:
 Judge Orr Road RV Park & Storage
 Development

Section of ECM from Which Deviation is Sought: ECM Chapter 3 Section 3.2.5.E Water Quality and MS4 Permit Section 4.a.i(G)
 Specific Criteria from Which a Deviation is Sought:
 Treatment of all stormwater from the project area.

Proposed Nature and Extent of Deviation:
 Two areas of the project area are not tributary to the water quality/detention basin:
 Basins A2B and A5 contain 2.49 acres of which 0.74 acres are developed.
 Basin B contains 0.87 acres of which none are developed.

Applicant Information:

Applicant: Guman & Associates
 Applicant is: Owner Consultant Contractor
 Mailing Address: 731 N. Weber St. Suite 10
 Telephone Number: 719-633-9700
 Email Address: bill@guman.net
 State: CO Postal Code: 80903
 Fax Number: _____

Engineer Information:

Engineer: Michael A. Bartusek, PE
 Company Name: Associated Design Professionals, Inc.
 Mailing Address: 3520 Austin Bluffs Pkwy., Suite 102
 Colorado Springs
 Registration Number: 23329
 Telephone Number: (719) 266-5212
 Email Address: mbartusek@adpcivil.com
 State: CO Postal Code: 80918
 State of Registration: Colorado
 Fax Number: (719) 266-5341

Explanation of Request (Attached diagrams, figures and other documentation to clarify request):

Section of ECM from Which Deviation is Sought: ECM Chapter 3 Section 3.2.5.E Water Quality and MS4 Permit Section 4.a.i(G)

Specific Criteria from Which a Deviation is Sought: Two areas of the project area are not tributary to the water quality/detention basin:
 Basins A2B and A5 contain 2.49 acres of which 0.74 acres are developed.
 Basin B contains 0.87 acres of which none are developed.

Proposed Nature and Extent of Deviation:
 Reason for the Requested Deviation: The MS4 Permit states that areas that are to remain undeveloped after the site
 El Paso County Procedures Manual
 Procedure # R-FM-051-07
 Issue Date: 12/31/07
 Revision Issued: 00/00/00

is developed may be excluded from providing water quality and only minimal disturbance is occurring in these areas.

Comparison of Proposed Deviation to ECM Standard: Minimal impacts to water quality will occur

Applicable Regional or National Standards used as Basis: _____

Application Consideration:

CHECK IF APPLICATION MEETS CRITERIA FOR CONSIDERATION

JUSTIFICATION

The ECM standard is inapplicable to a particular situation.

Topography, right-of-way, or other geographical conditions or impediments impose an undue hardship on the applicant, and an equivalent alternative that can accomplish the same design objective is available and does not compromise public safety or accessibility.

Basins A2B and A5 developed area of 0.74 acres cannot reach the water quality/detention basin due to topography

A change to a standard is required to address a specific design or construction problem, and if not modified, the standard will impose an undue hardship on the applicant with little or no material benefit to the public.

If at least one of the criteria listed above is not met, this application for deviation cannot be considered.

Criteria for Approval:

PLEASE EXPLAIN HOW EACH OF THE FOLLOWING CRITERIA HAVE BEEN SATISFIED BY THIS REQUEST

The request for a deviation is not based exclusively on financial considerations.

Request is needed due to topographical issues which prevent the flows from reaching the water quality basin.

The deviation will achieve the intended result with a comparable or superior design and quality of improvement.

The northeastern area will not be disturbed as a result of the site construction and the southern area only has two access roads crossing the area containing less than an acre of impervious area.

The deviation will not adversely affect safety or operations.

Since only minimal work will occur in the one area there will be no effect on safety or operation since.

The deviation will not adversely affect maintenance and its associated cost.

There will be no effect on maintenance.

The deviation will not adversely affect aesthetic appearance.

There will be no effect on appearance.

Owner, Applicant and Engineer Declaration:

El Paso County Procedures Manual
Procedure # R-FM-051-07
Issue Date: 12/31/07
Revision Issued: 00/00/00
DSD File No. _____

To the best of my knowledge, the information on this application and all additional or supplemental documentation is true, factual and complete. I am fully aware that any misrepresentation of any information on this application may be grounds for denial. I have familiarized myself with the rules, regulations and procedures with respect to preparing and filing this application. I also understand that an incorrect submittal will be cause to have the project removed from the agenda of the Planning Commission, Board of County Commissioners and/or Board of Adjustment or delay review, and that any approval of this application is based on the representations made in the application and may be revoked on any breach of representation or condition(s) of approval.

Andrea Munich _____ Date 6-18-19
Signature of owner (or authorized representative)

Signature of applicant (if different from owner) Date

[Signature] _____ Date 6/18/19
Signature of Engineer

Engineer's Seal

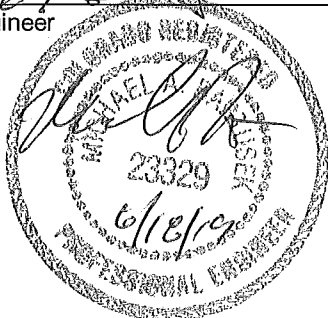

Review and Recommendation:
APPROVED by the ECM Administrator

Date
This request has been determined to have met the criteria for approval. A deviation from Section _____ of ECM is hereby granted based on the justification provided. Comments:

___ Additional comments or information are attached.

DENIED by the ECM Administrator

Date
This request has been determined not to have met criteria for approval. A deviation from Section _____ of ECM is hereby denied. Comments:

___ Additional comments or information are attached.

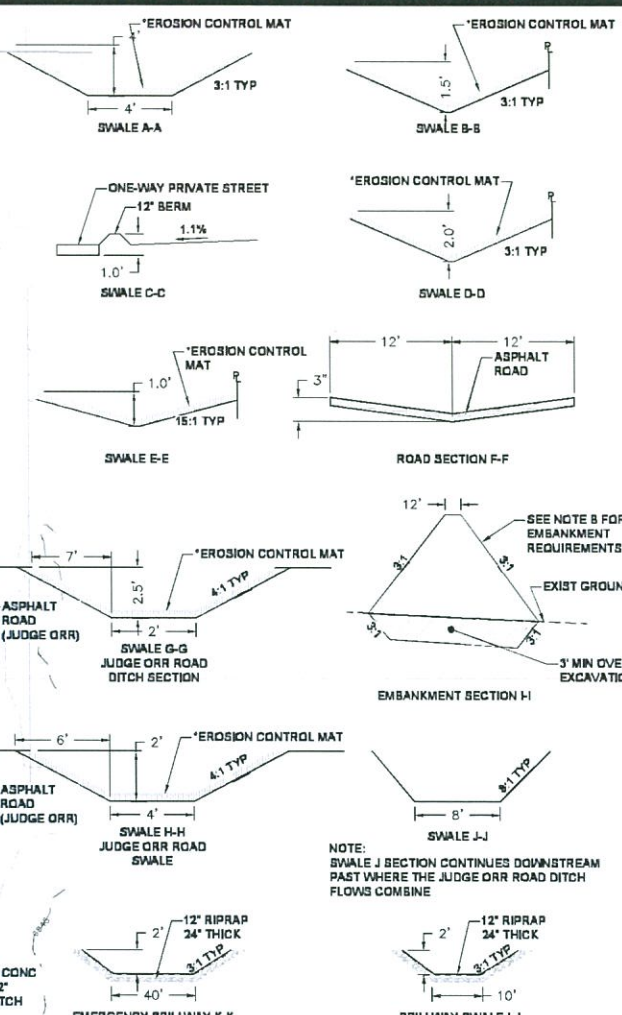
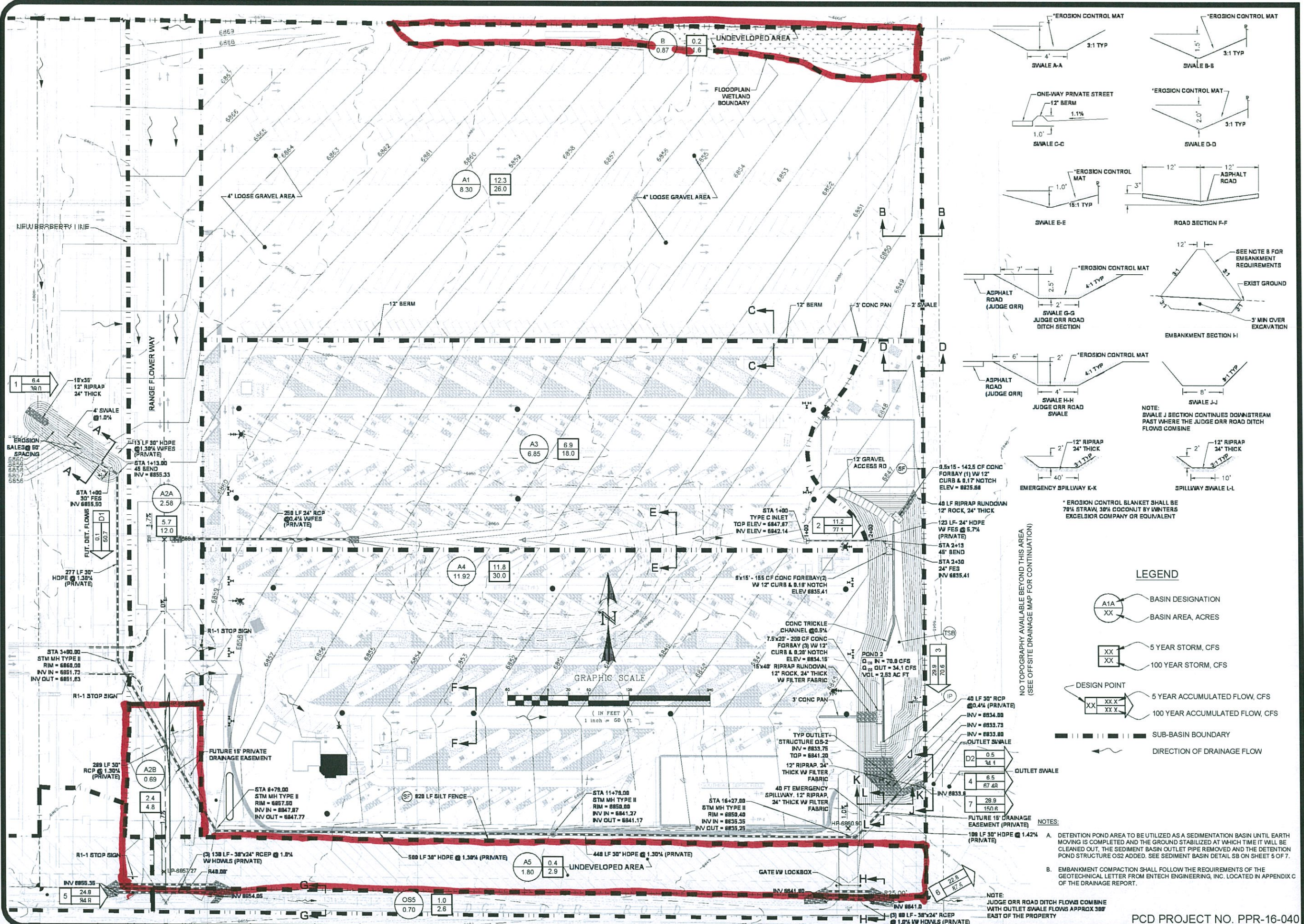

LEGEND

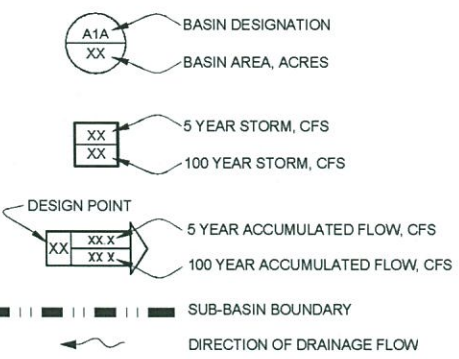

NO TOPOGRAPHY AVAILABLE BEYOND THIS AREA
(SEE OFFSITE DRAINAGE MAP FOR CONTINUATION)

- NOTES:
- A. DETENTION POND AREA TO BE UTILIZED AS A SEDIMENTATION BASIN UNTIL EARTH MOVING IS COMPLETED AND THE GROUND STABILIZED AT WHICH TIME IT WILL BE CLEANED OUT, THE SEDIMENT BASIN OUTLET PIPE REMOVED AND THE DETENTION POND STRUCTURE OS2 ADDED. SEE SEDIMENT BASIN DETAIL SB ON SHEET 5 OF 7.
 - B. EMBANKMENT COMPACTION SHALL FOLLOW THE REQUIREMENTS OF THE GEOTECHNICAL LETTER FROM ENTECH ENGINEERING, INC. LOCATED IN APPENDIX C OF THE DRAINAGE REPORT.

NOTE:
JUDGE ORR ROAD DITCH FLOWS COMBINE WITH OUTLET SWALE FLOWS APPROX 300' EAST OF THE PROPERTY

DESIGNED BY: MAB
PROJECT ENGINEER: MAB
JOB NO: 160301
DATE: 02/28/19
PROJECT MANAGER: MAB
CAD FILE NO: 160301-Dev-Corr
SCALE: 1" = 30'
DRAWN BY: HJO
CHECKED BY: HJO

PREPARED BY:

3520 Austin Bluffs Parkway
Suite 102
Colorado Springs, CO 80918
(719) 266-9212
fax: (719) 266-5341

NO.	DATE	REVISION

JUDGE ORR ROAD RV PARK & STORAGE
COLORADO SPRINGS, COLORADO
DRAINAGE - DEVELOPED CONDITIONS

SHEET

3 of 3