



39206 A ELEVATION 2 STOTY  
AVERAGE FINISH GRADE = (AFG)  
AFG = ( 82.8 )( 5 ) = 82.8  
( 5 )  
BUILDING HEIGHT = 22.0 + (TF - AFG) =  
BUILDING HEIGHT = 22.0 + ( 83.5 - 82.8 ) = 22.7 ✓

S130862  
SFD20868  
PLAT 14053  
ZONE PUD  
DIST 2



APPROVED  
Plan Review  
07/29/2020 4:29:20 PM  
dsdespinoza  
EPC Planning & Community  
Development Department

APPROVED  
BESQCP  
07/29/2020 4:29:27 PM  
dsdespinoza  
EPC Planning & Community  
Development Department

ANY APPROVAL GIVEN BY  
EL PASO COUNTY  
DOES NOT OBLIVATE THE NEED  
TO COMPLY WITH APPLICABLE  
FEDERAL, STATE, OR LOCAL  
LAWS AND/OR REGULATION  
Planning & Community Development Department  
approval is contingent upon compliance with all  
applicable notes on the recorded plat.  
An access permit must be granted by the  
Planning & Community Development Department  
prior to the establishment of any driveway onto a  
County road.  
Diversion of blockage of any drainage way  
is not permitted without approval of the  
Planning & Community Development Department

It is the owner's responsibility to  
coordinate with easement holders  
to avoid impact to utilities that  
may be located in the easements.

Released for Permit  
07/29/2020 1:13:15 PM  
REGIONAL  
Building Department  
amy  
ENUMERATION

LOT 39

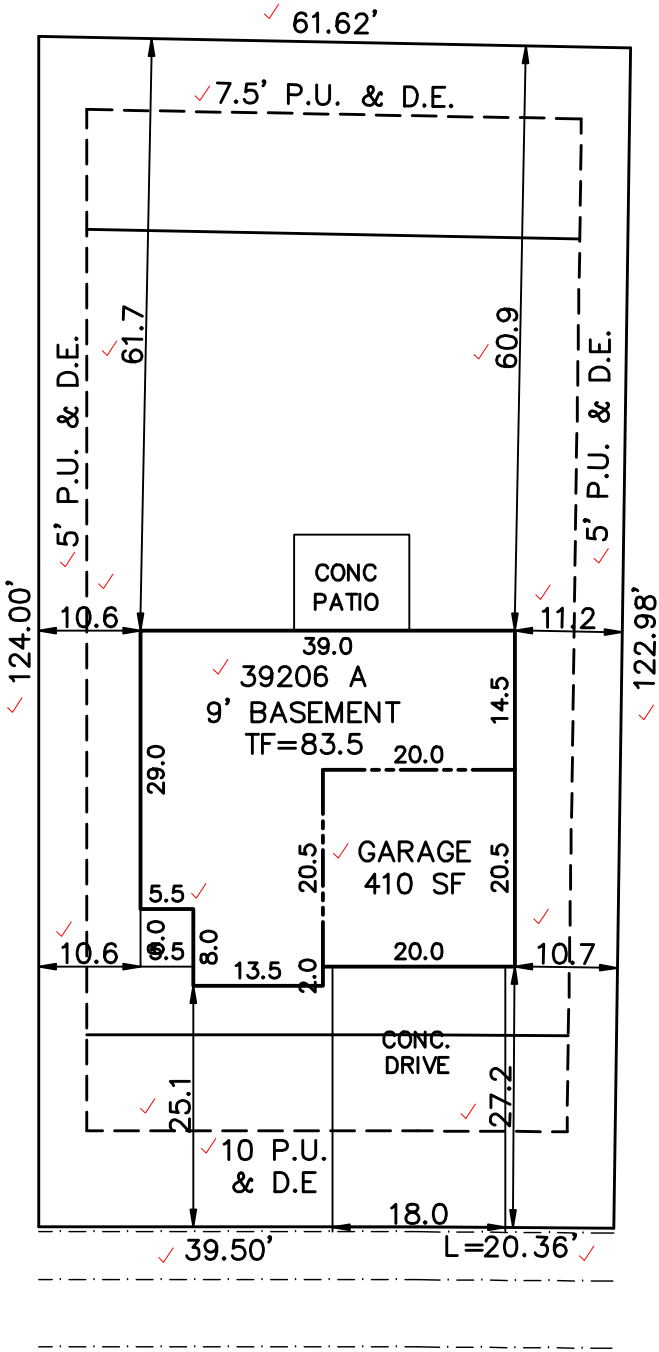

LOT 41

STONEY MEADOWS WAY  
(60' R.O.W.)

SITE DATA  
LOT SQ. FT.= 7497 ✓  
HOUSE SQ. FT.= 1392 ✓  
COVERAGE = 18.6% ✓  
BLDG. HEIGHT = 22.7 ✓

SCALE: ...1"=20'  
DRAWN BY: TAP ✓

SCHEDULE No. 4229216012 ✓

WARNING!

1. LOCATE UNDERGROUND UTILITIES PRIOR TO EXCAVATION.
2. THIS PLOT PLAN SHOWS IMPROVEMENTS AT GRADE ONLY. SEE FOUNDATION PLANS FOR STRUCTURAL INFOMATION

PLOT PLAN

LEGAL DESCRIPTION

LOT 40 ✓  
STONEBRIDGE FILING NO. 3 AT MERIDIAN RANCH  
EL PASO COUNTY, COLORADO

ADDRESS ✓

13218 STONEY MEADOWS WAY

✓ Century Communities  
9475 BRIAR VILLAGE POINT, STE 125  
COLORADO SPRINGS, COLORADO 8020

TITLE CO. FILE NO.

DATE

07-23-20

DRAWING NAME

S3-040

PROJECT NO.

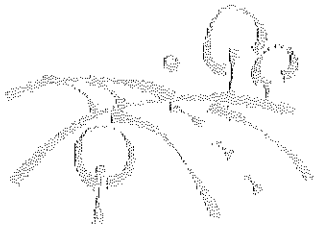

✓ **Woodmen Road  
Metropolitan District**

c/o Walker Schooler District Managers  
614 N. Tejon Street  
Colorado Springs, CO 80903

# Receipt

DATE	RECEIPT NO.
7/13/2020	4067 ✓

SOLD TO
Century Communities Colorado, LLC ✓ 8390 E. Crescent Parkway Ste 650 Greenwood Village, CO 80111

CHECK NO.	PAYMENT METHOD
00364437.	Check

DESCRIPTION	FILING	QTY	RATE	AMOUNT
Lot 40 - 13218 Stoney Meadows ✓  <i>dsdespinoza</i> <i>07/29/2020 4:28:10 PM</i>	Stonebridge 3 @ MR	1	550.00	550.00

AUTHORIZED SIGNATURE:

*Kalilah Anderson* ✓

**Total**

\$550.00

Phone #

(719) 447-1777

# SITE



2017 PPRBC

Address: 13218 STONEY MEADOWS WAY, PEYTON

Parcel: 4229216012

Plan Track #: 130862

Received: 09-Jul-2020 (BECKYA)

Map #: 552G

## Description:

### RESIDENCE

Type of Unit:

Garage	400	
Lower Level 2	867	
Main Level	959	
Upper Level 1	1278	
	3504	Total Square Feet

## Required PPRBD Departments (2)

Enumeration	Floodplain
APPROVED BECKYA 7/9/2020 8:48:06 AM	(N/A) RBD GIS

## Required Outside Departments (1)

County Zoning
APPROVED Plan Review 07/29/2020 4:31:29 PM dsdespinoza EPC Planning & Community Development Department

Release of this plan does not preclude compliance with all applicable codes, ordinances and other pertinent regulations. This plan set must be present on the job site for every inspection.