

PUD Development Plan - can include phasing if proposed_v1_Comment.pdf Markup Summary

1 (20)

SECTION DOCUMENTS BY EL PASO COUNTY OR PROMULGATED UNDER OR WITH RESPECT TO ACCESSIBILITY DURING CONSTRUCTION.
Update map number
LOCATED WITHIN A DESIGNATED FEMA FLOOD HAZARD AREA (FHA) EFFECTIVE DATE DEC 15, 2004 (100766).
NOTE

Subject: Callout
Page Index: 1
Date: 7/6/2022 9:11:42 AM
Author: CDurham
Color: ■
Layer:
Space:
Page Label: 1

Update map number

TOO PLAIN AS DETERMINED BY THE FLOOD HAZARD MAP OF EL PASO COUNTY, TEXAS, EFFECTIVE DATE FEBRUARY 7, 2018.
7
EL PASO COUNTY, COLORADO (RMG-ROI) IS PART OF THIS STUDY. THE EXISTING AND PROPOSED DEVELOPMENT ARE DESCRIBED IN SECTION XX OF THE REPORT WHERE AVOIDANCE IS NOT REQUIRED.

Subject: Callout
Page Index: 1
Date: 7/6/2022 9:12:25 AM
Author: CDurham
Color: ■
Layer:
Space:
Page Label: 1

7

GEOLOGY STUDY: FALCON HIGHLANDS, EL PASO COUNTY, COLORADO. THE STUDY AREA IS LOCATED WITHIN THE SUBJECT PROJECT. AS PART OF THE STUDY, GEOLOGIC HAZARDS AS DESCRIBED IN SECTION XX OF THE REPORT AND GEOLOGIC CONSTRAINTS AS DESCRIBED IN SECTION XX OF THE REPORT WERE IDENTIFIED. WHERE APPROPRIATE, SHALLOW GROUNDWATER, WHERE APPROPRIATE, AND EROSION AND CORROSION CONSTRAINTS CAN BE IDENTIFIED IN THE STUDY AREA. WHERE APPROPRIATE, SURFACE WATER SHOULD BE IDENTIFIED AND TAKEN INTO ACCOUNT. SURFACE WATER SHOULD BE IDENTIFIED AND TAKEN INTO ACCOUNT WITH THE SURFACE SOILS.
Update map number
THE STUDY AREA IS LOCATED WITHIN THE SUBJECT PROJECT. AS PART OF THE STUDY, GEOLOGIC HAZARDS AS DESCRIBED IN SECTION XX OF THE REPORT AND GEOLOGIC CONSTRAINTS AS DESCRIBED IN SECTION XX OF THE REPORT WERE IDENTIFIED. WHERE APPROPRIATE, SHALLOW GROUNDWATER, WHERE APPROPRIATE, AND EROSION AND CORROSION CONSTRAINTS CAN BE IDENTIFIED IN THE STUDY AREA. WHERE APPROPRIATE, SURFACE WATER SHOULD BE IDENTIFIED AND TAKEN INTO ACCOUNT. SURFACE WATER SHOULD BE IDENTIFIED AND TAKEN INTO ACCOUNT WITH THE SURFACE SOILS.
IN THIS DEVELOPMENT PROVIDE FOR LEVELS OF VEHICULAR CIRCULATION AND FOR ALL OTHERS AS APPLICABLE TO THE PROJECT.
THE STUDY AREA IS LOCATED WITHIN THE SUBJECT PROJECT. AS PART OF THE STUDY, GEOLOGIC HAZARDS AS DESCRIBED IN SECTION XX OF THE REPORT AND GEOLOGIC CONSTRAINTS AS DESCRIBED IN SECTION XX OF THE REPORT WERE IDENTIFIED. WHERE APPROPRIATE, SHALLOW GROUNDWATER, WHERE APPROPRIATE, AND EROSION AND CORROSION CONSTRAINTS CAN BE IDENTIFIED IN THE STUDY AREA. WHERE APPROPRIATE, SURFACE WATER SHOULD BE IDENTIFIED AND TAKEN INTO ACCOUNT. SURFACE WATER SHOULD BE IDENTIFIED AND TAKEN INTO ACCOUNT WITH THE SURFACE SOILS.

Subject: Callout
Page Index: 1
Date: 7/6/2022 9:14:32 AM
Author: CDurham
Color: ■
Layer:
Space:
Page Label: 1

Include all constraints:
undocumented fill, fault & seismicity, radon, flooding & surface drainage, erosion & corrosion, surface grading & drainage

NET BOOK
345.41 FEET
9.99 FEET

Subject:
Page Index: 1
Date: 7/11/2022 8:09:01 AM
Author: dsdrice
Color: ■
Layer:
Space:
Page Label: 1

41

SHEET 1 OF 31
CITY FILE NO.
County

Subject: Callout
Page Index: 1
Date: 7/11/2022 8:29:57 AM
Author: dsdrice
Color: ■
Layer:
Space:
Page Label: 1

County

SHEET 1 OF
NO.: **PUDSP-22-005**

Subject: Text Box
Page Index: 1
Date: 7/11/2022 8:30:14 AM
Author: dsdrice
Color: ■
Layer:
Space:
Page Label: 1

PUDSP-22-005



Subject: Callout
Page Index: 1
Date: 7/11/2022 6:06:28 PM
Author: dsdrice
Color: ■
Layer:
Space:
Page Label: 1

Add a note that an underdrain system will be provided and maintained by the FHMD and/or basement limitation lots.

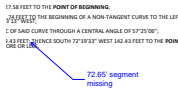

Subject: Callout
Page Index: 1
Date: 7/11/2022 10:22:33 AM
Author: dsdrice
Color: ■
Layer:
Space:
Page Label: 1

72.65' segment missing

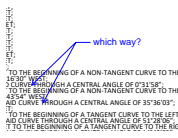

Subject: Callout
Page Index: 1
Date: 7/11/2022 10:23:34 AM
Author: dsdrice
Color: ■
Layer:
Space:
Page Label: 1

which way?

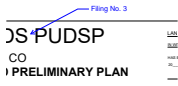

Subject: Callout
Page Index: 1
Date: 7/11/2022 10:26:35 AM
Author: dsdrice
Color: ■
Layer:
Space:
Page Label: 1

Filing No. 3



Subject: Architect
Page Index: 1
Date: 7/13/2022 3:17:21 PM
Author: Ryan Howser
Color: ■
Layer:
Space:
Page Label: 1

Woodmen Hills



Subject: Arrow
Page Index: 1
Date: 7/13/2022 3:17:33 PM
Author: Ryan Howser
Color: ■
Layer:
Space:
Page Label: 1

LOGO: PASC ROCKY MOUNTAIN GROUP, DATED 12/18/2021. A DEVELOPMENT PLAN (PUD) IS BEING SUBMITTED TO THE BOARD OF COUNTY COMMISSIONERS FOR APPROVAL. THE BOARD OF COUNTY COMMISSIONERS HAS THE AUTHORITY TO APPROVE OR DENY THE PUD. THE BOARD OF COUNTY COMMISSIONERS HAS THE AUTHORITY TO APPROVE OR DENY THE PUD. THE BOARD OF COUNTY COMMISSIONERS HAS THE AUTHORITY TO APPROVE OR DENY THE PUD.

7/13/2022 3:20:28 PM

Subject: Text Box
Page Index: 1
Date: 7/13/2022 3:20:28 PM
Author: Ryan Howser
Color: ■
Layer:
Space:
Page Label: 1

This note should also be updated to include which lots (or if all lots) are encumbered by geologic constraints

FUTURE FINAL DESIGN SHALL BE SUBMITTED AND SHALL BE SUBJECT TO THE BOARD OF COUNTY COMMISSIONERS FOR APPROVAL. THE BOARD OF COUNTY COMMISSIONERS HAS THE AUTHORITY TO APPROVE OR DENY THE PUD. THE BOARD OF COUNTY COMMISSIONERS HAS THE AUTHORITY TO APPROVE OR DENY THE PUD.

7/13/2022 3:20:57 PM

Subject: Architect
Page Index: 1
Date: 7/13/2022 3:20:57 PM
Author: Ryan Howser
Color: ■
Layer:
Space:
Page Label: 1

No landscaping in the right-of-way

EL PASO COUNTY PLANNED UNIT DEVELOPMENT A PORTION OF SECTION 12, TOWN SIXTH PRINCIPAL MERIDIAN, COLORADO

7/13/2022 3:29:44 PM

Subject: Architect
Page Index: 1
Date: 7/13/2022 3:29:44 PM
Author: Ryan Howser
Color: ■
Layer:
Space:
Page Label: 1

Also Section 11? Title block should also include 1/4 and 1/2 sections where applicable

STATEMENT OF INTENT: THE PURPOSE OF THIS PUD PLAN IS TO PROVIDE FOR THE DEVELOPMENT OF THE PUD PLAN. THE BOARD OF COUNTY COMMISSIONERS HAS THE AUTHORITY TO APPROVE OR DENY THE PUD. THE BOARD OF COUNTY COMMISSIONERS HAS THE AUTHORITY TO APPROVE OR DENY THE PUD.

7/13/2022 3:32:48 PM

Subject: BoCC Certification
Page Index: 1
Date: 7/13/2022 3:32:48 PM
Author: Ryan Howser
Color: ■
Layer:
Space:
Page Label: 1

Board of County Commissioners Certificate

This PUD Development Plan / Preliminary Plan for (name of subdivision) was approved for filing by the El Paso County, Colorado Board of County Commissioners on the _____ day of _____, 200__, subject to any notes specified hereon and any conditions included in the resolution of approval. The dedications of land to the public (streets, tracts, easements: list those applicable) are accepted, but public improvements thereon will not become the maintenance responsibility of El Paso County until preliminary acceptance of the public improvements in accordance with the requirements of the Land Development Code and Engineering Criteria Manual, and the Subdivision Improvements Agreement.

Chair, Board of County Commissioners
Date

Director, Planning and Community Development
Date

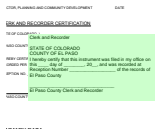

Subject: Clerk & Recorder
Page Index: 1
Date: 7/15/2022 10:21:20 AM
Author: Ryan Howser
Color: ■
Layer:
Space:
Page Label: 1

Clerk and Recorder

STATE OF COLORADO
 COUNTY OF EL PASO

I hereby certify that this instrument was filed in my office on this ____ day of _____, 20__, and was recorded at Reception Number _____ of the records of El Paso County

 El Paso County Clerk and Recorder



Subject: Architect
Page Index: 1
Date: 7/13/2022 3:39:06 PM
Author: Ryan Howser
Color: ■
Layer:
Space:
Page Label: 1

Please fill these out

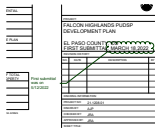

Subject: Architect
Page Index: 1
Date: 7/13/2022 3:45:43 PM
Author: Ryan Howser
Color: ■
Layer:
Space:
Page Label: 1

First submittal was on 5/12/2022

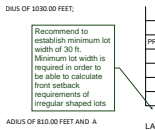

Subject: Callout
Page Index: 1
Date: 7/15/2022 8:59:53 AM
Author: Ryan Howser
Color: ■
Layer:
Space:
Page Label: 1

Recommend to establish minimum lot width of 30 ft. Minimum lot width is required in order to be able to calculate front setback requirements of irregular shaped lots

2 (7)

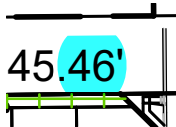

Subject:
Page Index: 2
Date: 7/11/2022 8:09:13 AM
Author: dsdrice
Color: ■
Layer:
Space:
Page Label: 2

46



Subject: Callout
Page Index: 2
Date: 7/11/2022 10:25:29 AM
Author: dsdrice
Color: ■
Layer:
Space:
Page Label: 2

Label all boundary segments

DATE	7/11/2022	10:46:10 AM
TIME	10:46:10 AM	
USER	dsdrice	
PROJECT	CON-HIGHLANDS METROPOLITAN DISTRICT	
DESCRIPTION	Keep park/trails option in Tract F?	

Subject: Callout
Page Index: 2
Date: 7/11/2022 10:46:10 AM
Author: dsdrice
Color: ■
Layer:
Space:
Page Label: 2

Keep park/trails option in Tract F?

DATE	7/11/2022	10:46:32 AM
TIME	10:46:32 AM	
USER	dsdrice	
PROJECT	CON-HIGHLANDS METROPOLITAN DISTRICT	
DESCRIPTION	and trails?	

Subject: Callout
Page Index: 2
Date: 7/11/2022 10:46:32 AM
Author: dsdrice
Color: ■
Layer:
Space:
Page Label: 2

and trails?



Subject: Architect
Page Index: 2
Date: 7/15/2022 8:50:14 AM
Author: Ryan Howser
Color: ■
Layer:
Space:
Page Label: 2

These lots are in the floodplain. Please revise.

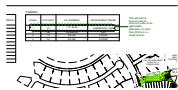

Subject: Architect
Page Index: 2
Date: 7/15/2022 8:44:11 AM
Author: Ryan Howser
Color: ■
Layer:
Space:
Page Label: 2

This will need a second point of access in order to be approvable; otherwise, no more than 25 lots on a single access

Generic comment throughout (it is noted on several lots but not all of them) - please ensure 30 feet of road frontage for each lot per LDC Chapter 8. Many of these lots do not meet the minimum frontage requirement for lot width. Waiver of this requirement is not likely to be considered. Several of the narrow, corner lots may not be buildable. I would recommend establishing a minimum lot width of 30 ft. To help alleviate this issue, but corner lots may also need to be wider to accommodate setbacks.

Subject: Text Box
Page Index: 2
Date: 7/15/2022 9:02:18 AM
Author: Ryan Howser
Color: ■
Layer:
Space:
Page Label: 2

Generic comment throughout (it is noted on several lots but not all of them) - please ensure 30 feet of road frontage for each lot per LDC Chapter 8. Many of these lots do not meet the minimum frontage requirement for lot width. Waiver of this requirement is not likely to be considered. Several of the narrow, corner lots may not be buildable. I would recommend establishing a minimum lot width of 30 ft. To help alleviate this issue but corner lots may also need to be wider to accommodate setbacks.

3 (7)

PRINCIPAL USES ARE SU
 COUNTY LAND DEVELOPM

Subject:
Page Index: 3
Date: 7/11/2022 8:12:51 AM
Author: dsdrice
Color: ■
Layer:
Space:
Page Label: 3

LORSON RANCH

OTHER FACILITIES, PARKING
SPACE IMPROVEMENTS, PARK
ING AND OTHER USES ALLOW
BY THE LAND DEVELOPMENT
CODE, AS AMENDED
SUBJECT TO THE REQUIREME
NTS OF THE LAND DEVELOP
MENT, AS AMENDED

Subject: LORSON RANCH
Page Index: 3
Date: 7/11/2022 8:12:57 AM
Author: dsdrice
Color: ■
Layer:
Space:
Page Label: 3

LORSON RANCH

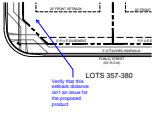

Subject: Callout
Page Index: 3
Date: 7/11/2022 9:57:19 AM
Author: dsdrice
Color: ■
Layer:
Space:
Page Label: 3

Verify that this setback distance isn't an issue for the proposed product

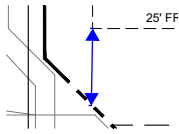

Subject: Dimension
Page Index: 3
Date: 7/11/2022 9:56:41 AM
Author: dsdrice
Color: ■
Layer:
Space:
Page Label: 3

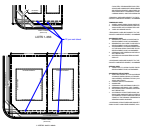

Subject: Callout
Page Index: 3
Date: 7/11/2022 9:58:36 AM
Author: dsdrice
Color: ■
Layer:
Space:
Page Label: 3

10' per next sheet

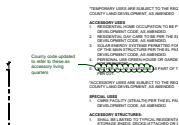

Subject: Architect
Page Index: 3
Date: 7/15/2022 10:02:52 AM
Author: Ryan Howser
Color: ■
Layer:
Space:
Page Label: 3

County code updated to refer to these as accessory living quarters

STRUCTURES ARE SUBJECT TO THE
LAND DEVELOPMENT CODE, AS AMENDED



Subject: Callout
Page Index: 3
Date: 7/15/2022 10:03:25 AM
Author: Ryan Howser
Color: ■
Layer:
Space:
Page Label: 3

Land Development Code

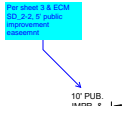

Subject: Callout
Page Index: 4
Date: 7/6/2022 9:15:57 AM
Author: CDurham
Color: ■
Layer:
Space:
Page Label: 4

Per sheet 3 & ECM SD_2-2, 5' public improvement easeemnt

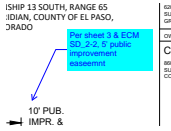

Subject: Callout
Page Index: 4
Date: 7/6/2022 9:16:11 AM
Author: CDurham
Color: ■
Layer:
Space:
Page Label: 4

Per sheet 3 & ECM SD_2-2, 5' public improvement easeemnt

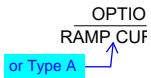

Subject: Callout
Page Index: 4
Date: 7/6/2022 9:16:45 AM
Author: CDurham
Color: ■
Layer:
Space:
Page Label: 4

or Type A

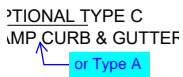

Subject: Callout
Page Index: 4
Date: 7/6/2022 9:17:00 AM
Author: CDurham
Color: ■
Layer:
Space:
Page Label: 4

or Type A



Subject: Text Box
Page Index: 4
Date: 7/6/2022 9:17:12 AM
Author: CDurham
Color: ■
Layer:
Space:
Page Label: 4

(See Plans)

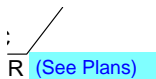

Subject: Text Box
Page Index: 4
Date: 7/6/2022 9:17:19 AM
Author: CDurham
Color: ■
Layer:
Space:
Page Label: 4

(See Plans)



Subject: Callout
Page Index: 4
Date: 7/11/2022 8:14:52 AM
Author: dsdrice
Color: ■
Layer:
Space:
Page Label: 4

Add road names that this cross-section applies to

5 (18)

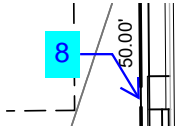

Subject: Callout
Page Index: 5
Date: 7/6/2022 9:19:01 AM
Author: CDurham
Color: ■
Layer:
Space:
Page Label: 5

8

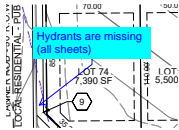

Subject: Callout
Page Index: 5
Date: 7/6/2022 9:18:09 AM
Author: CDurham
Color: ■
Layer:
Space:
Page Label: 5

Hydrants are missing (all sheets)

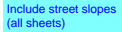

Subject: Text Box
Page Index: 5
Date: 7/6/2022 9:18:35 AM
Author: CDurham
Color: ■
Layer:
Space:
Page Label: 5

Include street slopes (all sheets)

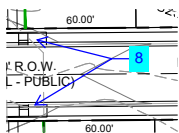

Subject: Callout
Page Index: 5
Date: 7/6/2022 9:19:13 AM
Author: CDurham
Color: ■
Layer:
Space:
Page Label: 5

8



Subject: Text Box
Page Index: 5
Date: 7/6/2022 9:26:02 AM
Author: CDurham
Color: ■
Layer:
Space:
Page Label: 5

Show and label cross pans

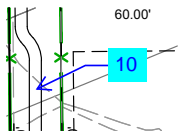

Subject: Callout
Page Index: 5
Date: 7/6/2022 9:26:41 AM
Author: CDurham
Color: ■
Layer:
Space:
Page Label: 5

10

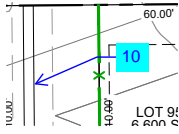

Subject: Callout
Page Index: 5
Date: 7/6/2022 9:26:49 AM
Author: CDurham
Color: ■
Layer:
Space:
Page Label: 5

10

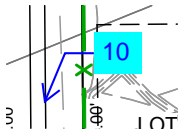

Subject: Callout
Page Index: 5
Date: 7/6/2022 9:27:05 AM
Author: CDurham
Color: ■
Layer:
Space:
Page Label: 5

10

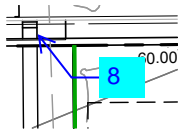

Subject: Callout
Page Index: 5
Date: 7/6/2022 9:27:26 AM
Author: CDurham
Color: ■
Layer:
Space:
Page Label: 5

8

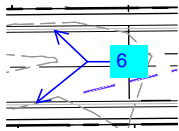

Subject: Callout
Page Index: 5
Date: 7/6/2022 9:28:02 AM
Author: CDurham
Color: ■
Layer:
Space:
Page Label: 5

6

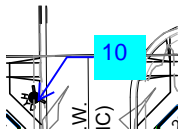

Subject: Callout
Page Index: 5
Date: 7/6/2022 9:28:29 AM
Author: CDurham
Color: ■
Layer:
Space:
Page Label: 5

10

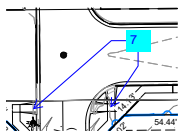

Subject: Callout
Page Index: 5
Date: 7/6/2022 9:28:45 AM
Author: CDurham
Color: ■
Layer:
Space:
Page Label: 5

7

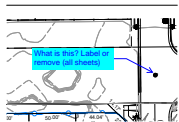

Subject: Callout
Page Index: 5
Date: 7/6/2022 9:29:08 AM
Author: CDurham
Color: ■
Layer:
Space:
Page Label: 5

What is this? Label or remove (all sheets)

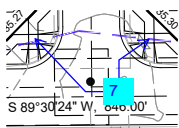

Subject: Callout
Page Index: 5
Date: 7/6/2022 9:29:39 AM
Author: CDurham
Color: ■
Layer:
Space:
Page Label: 5

7

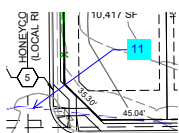

Subject: Callout
Page Index: 5
Date: 7/6/2022 9:29:53 AM
Author: CDurham
Color: ■
Layer:
Space:
Page Label: 5

11

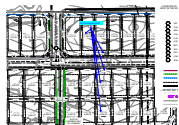

Subject: Callout
Page Index: 5
Date: 7/6/2022 9:31:04 AM
Author: CDurham
Color: ■
Layer:
Space:
Page Label: 5

Fix Overlapping text

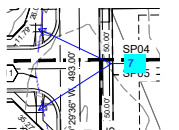

Subject: Callout
Page Index: 5
Date: 7/6/2022 9:31:41 AM
Author: CDurham
Color: ■
Layer:
Space:
Page Label: 5

7

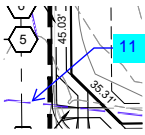

Subject: Callout
Page Index: 5
Date: 7/6/2022 9:32:15 AM
Author: CDurham
Color: ■
Layer:
Space:
Page Label: 5

11

6 (4)

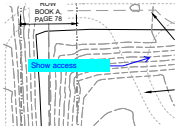

Subject: Callout
Page Index: 6
Date: 7/6/2022 9:32:54 AM
Author: CDurham
Color: ■
Layer:
Space:
Page Label: 6

Show access

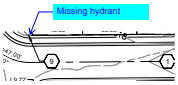

Subject: Callout
Page Index: 6
Date: 7/6/2022 9:33:15 AM
Author: CDurham
Color: ■
Layer:
Space:
Page Label: 6

Missing hydrant

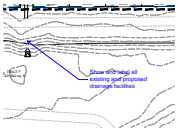

Subject: Callout
Page Index: 6
Date: 7/11/2022 8:16:32 AM
Author: dsdrice
Color: ■
Layer:
Space:
Page Label: 6

Show and label all existing and proposed drainage facilities



Subject: Callout
Page Index: 6
Date: 7/11/2022 8:17:08 AM
Author: dsdrice
Color: ■
Layer:
Space:
Page Label: 6

Existing or proposed?

7 (5)

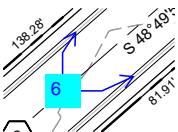

Subject: Callout
Page Index: 7
Date: 7/6/2022 9:33:49 AM
Author: CDurham
Color: ■
Layer:
Space:
Page Label: 7

6



Subject: Callout
Page Index: 7
Date: 7/6/2022 9:34:27 AM
Author: CDurham
Color: ■
Layer:
Space:
Page Label: 7

Missing hydrant

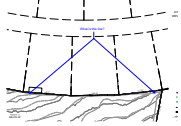

Subject: Callout
Page Index: 7
Date: 7/11/2022 8:18:23 AM
Author: dsdrice
Color: ■
Layer:
Space:
Page Label: 7

What is this line?



Subject: Callout
Page Index: 7
Date: 7/11/2022 8:19:23 AM
Author: dsdrice
Color: ■
Layer:
Space:
Page Label: 7

Label all ROW radii

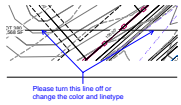

Subject: Callout
Page Index: 7
Date: 7/11/2022 8:20:47 AM
Author: dsdrice
Color: ■
Layer:
Space:
Page Label: 7

Please turn this line off or change the color and linetype

8 (16)

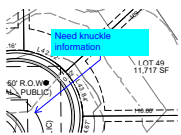

Subject: Callout
Page Index: 8
Date: 7/6/2022 9:36:32 AM
Author: CDurham
Color: ■
Layer:
Space:
Page Label: 8

Need knuckle information

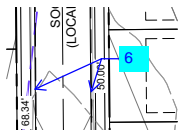

Subject: Callout
Page Index: 8
Date: 7/6/2022 9:37:47 AM
Author: CDurham
Color: ■
Layer:
Space:
Page Label: 8

6

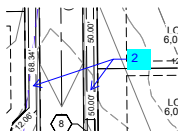

Subject: Callout
Page Index: 8
Date: 7/6/2022 9:37:33 AM
Author: CDurham
Color: ■
Layer:
Space:
Page Label: 8

2

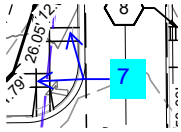

Subject: Callout
Page Index: 8
Date: 7/6/2022 9:37:14 AM
Author: CDurham
Color: ■
Layer:
Space:
Page Label: 8

7

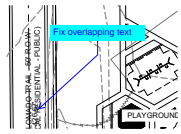

Subject: Callout
Page Index: 8
Date: 7/6/2022 9:38:06 AM
Author: CDurham
Color: ■
Layer:
Space:
Page Label: 8

Fix overlapping text



Subject: Callout
Page Index: 8
Date: 7/6/2022 9:38:51 AM
Author: CDurham
Color: ■
Layer:
Space:
Page Label: 8

Extend trail to sidewalk

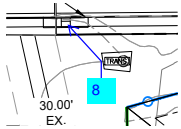

Subject: Callout
Page Index: 8
Date: 7/6/2022 9:39:13 AM
Author: CDurham
Color: ■
Layer:
Space:
Page Label: 8

8

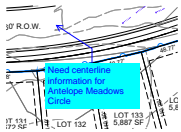

Subject: Callout
Page Index: 8
Date: 7/6/2022 9:39:42 AM
Author: CDurham
Color: ■
Layer:
Space:
Page Label: 8

Need centerline information for Antelope Meadows Circle

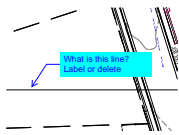

Subject: Callout
Page Index: 8
Date: 7/6/2022 9:40:08 AM
Author: CDurham
Color: ■
Layer:
Space:
Page Label: 8

What is this line? Label or delete

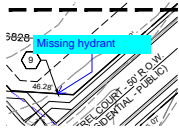

Subject: Callout
Page Index: 8
Date: 7/6/2022 9:40:24 AM
Author: CDurham
Color: ■
Layer:
Space:
Page Label: 8

Missing hydrant

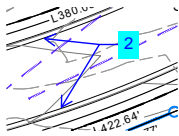

Subject: Callout
Page Index: 8
Date: 7/6/2022 9:41:21 AM
Author: CDurham
Color: ■
Layer:
Space:
Page Label: 8

2

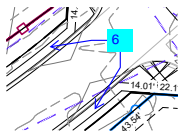

Subject: Callout
Page Index: 8
Date: 7/6/2022 9:41:47 AM
Author: CDurham
Color: ■
Layer:
Space:
Page Label: 8

6

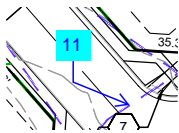

Subject: Callout
Page Index: 8
Date: 7/6/2022 9:42:08 AM
Author: CDurham
Color: ■
Layer:
Space:
Page Label: 8

11

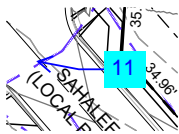

Subject: Callout
Page Index: 8
Date: 7/6/2022 9:43:03 AM
Author: CDurham
Color: ■
Layer:
Space:
Page Label: 8

11

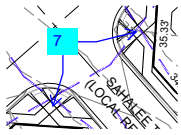

Subject: Callout
Page Index: 8
Date: 7/6/2022 9:43:06 AM
Author: CDurham
Color: ■
Layer:
Space:
Page Label: 8

7

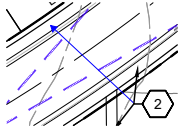

Subject: Arrow
Page Index: 8
Date: 7/6/2022 9:43:31 AM
Author: CDurham
Color: ■
Layer:
Space:
Page Label: 8

9 (7)



Subject: Callout
Page Index: 9
Date: 7/6/2022 9:47:04 AM
Author: CDurham
Color: ■
Layer:
Space:
Page Label: 9

Need ramp

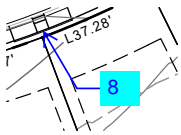

Subject: Callout
Page Index: 9
Date: 7/6/2022 9:47:18 AM
Author: CDurham
Color: ■
Layer:
Space:
Page Label: 9

8

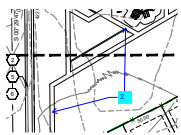

Subject: Callout
Page Index: 9
Date: 7/6/2022 9:49:00 AM
Author: CDurham
Color: ■
Layer:
Space:
Page Label: 9

2

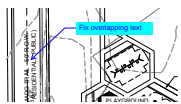

Subject: Callout
Page Index: 9
Date: 7/6/2022 9:49:21 AM
Author: CDurham
Color: ■
Layer:
Space:
Page Label: 9

Fix overlapping text

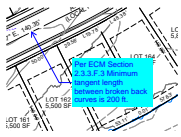

Subject: Callout
Page Index: 9
Date: 7/6/2022 9:50:16 AM
Author: CDurham
Color: ■
Layer:
Space:
Page Label: 9

Per ECM Section 2.3.3.F.3 Minimum tangent length between broken back curves is 200 ft.

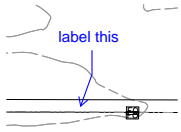

Subject: Callout
Page Index: 9
Date: 7/11/2022 8:24:17 AM
Author: dsdrice
Color: ■
Layer:
Space:
Page Label: 9

label this

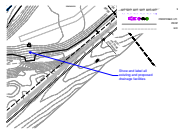

Subject: Callout
Page Index: 9
Date: 7/11/2022 8:25:28 AM
Author: dsdrice
Color: ■
Layer:
Space:
Page Label: 9

Show and label all existing and proposed drainage facilities

10 (13)

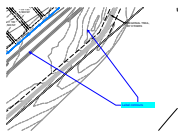

Subject: Callout
Page Index: 10
Date: 7/6/2022 9:50:58 AM
Author: CDurham
Color: ■
Layer:
Space:
Page Label: 10

Label contours

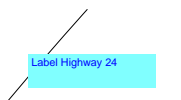

Subject: Text Box
Page Index: 10
Date: 7/6/2022 9:51:14 AM
Author: CDurham
Color: ■
Layer:
Space:
Page Label: 10

Label Highway 24



Subject: Callout
Page Index: 10
Date: 7/6/2022 9:51:29 AM
Author: CDurham
Color: ■
Layer:
Space:
Page Label: 10

Include linetype in legend

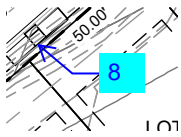

Subject: Callout
Page Index: 10
Date: 7/6/2022 9:52:51 AM
Author: CDurham
Color: ■
Layer:
Space:
Page Label: 10

8

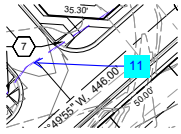

Subject: Callout
Page Index: 10
Date: 7/6/2022 9:53:03 AM
Author: CDurham
Color: ■
Layer:
Space:
Page Label: 10

11

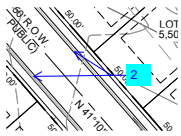

Subject: Callout
Page Index: 10
Date: 7/6/2022 9:53:23 AM
Author: CDurham
Color: ■
Layer:
Space:
Page Label: 10

2

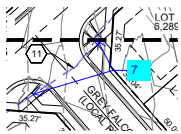

Subject: Callout
Page Index: 10
Date: 7/6/2022 9:53:40 AM
Author: CDurham
Color: ■
Layer:
Space:
Page Label: 10

7

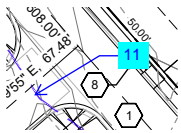

Subject: Callout
Page Index: 10
Date: 7/6/2022 9:53:56 AM
Author: CDurham
Color: ■
Layer:
Space:
Page Label: 10

11

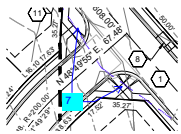

Subject: Callout
Page Index: 10
Date: 7/6/2022 9:54:15 AM
Author: CDurham
Color: ■
Layer:
Space:
Page Label: 10

7

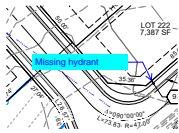

Subject: Callout
Page Index: 10
Date: 7/6/2022 9:54:41 AM
Author: CDurham
Color: ■
Layer:
Space:
Page Label: 10

Missing hydrant

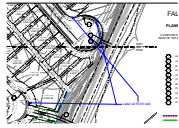

Subject: Callout
Page Index: 10
Date: 7/11/2022 8:27:19 AM
Author: dsdrice
Color: ■
Layer:
Space:
Page Label: 10

Label all ROW radii

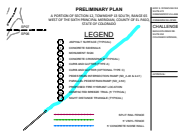

Subject:
Page Index: 10
Date: 7/11/2022 11:04:31 AM
Author: dsdrice
Color: ■
Layer:
Space:
Page Label: 10

Include this area

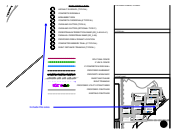

Subject: Callout
Page Index: 10
Date: 7/11/2022 11:05:06 AM
Author: dsdrice
Color: ■
Layer:
Space:
Page Label: 10

What is this line? Label or delete

11 (30)

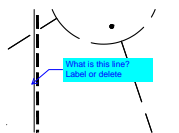

Subject: Callout
Page Index: 11
Date: 7/6/2022 9:55:22 AM
Author: CDurham
Color: ■
Layer:
Space:
Page Label: 11

Fix overlapping text



Subject: Callout
Page Index: 11
Date: 7/6/2022 9:55:41 AM
Author: CDurham
Color: ■
Layer:
Space:
Page Label: 11

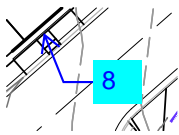

Subject: Callout
Page Index: 11
Date: 7/6/2022 9:55:54 AM
Author: CDurham
Color: ■
Layer:
Space:
Page Label: 11

8

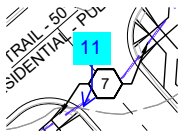

Subject: Callout
Page Index: 11
Date: 7/6/2022 9:57:03 AM
Author: CDurham
Color: ■
Layer:
Space:
Page Label: 11

11

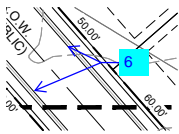

Subject: Callout
Page Index: 11
Date: 7/6/2022 9:56:52 AM
Author: CDurham
Color: ■
Layer:
Space:
Page Label: 11

6

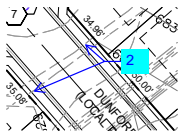

Subject: Callout
Page Index: 11
Date: 7/6/2022 9:57:21 AM
Author: CDurham
Color: ■
Layer:
Space:
Page Label: 11

2



Subject: Callout
Page Index: 11
Date: 7/6/2022 9:57:57 AM
Author: CDurham
Color: ■
Layer:
Space:
Page Label: 11

Fix overlapping text

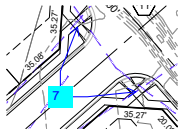

Subject: Callout
Page Index: 11
Date: 7/6/2022 9:58:20 AM
Author: CDurham
Color: ■
Layer:
Space:
Page Label: 11

7

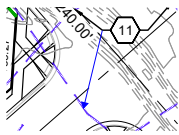

Subject: Arrow
Page Index: 11
Date: 7/6/2022 9:58:34 AM
Author: CDurham
Color: ■
Layer:
Space:
Page Label: 11



Subject: Arrow
Page Index: 11
Date: 7/6/2022 9:58:51 AM
Author: CDurham
Color: ■
Layer:
Space:
Page Label: 11



Subject: Callout
Page Index: 11
Date: 7/6/2022 9:59:16 AM
Author: CDurham
Color: ■
Layer:
Space:
Page Label: 11

7

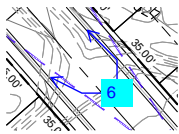

Subject: Callout
Page Index: 11
Date: 7/6/2022 10:00:07 AM
Author: CDurham
Color: ■
Layer:
Space:
Page Label: 11

6

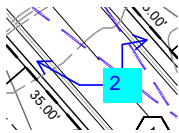

Subject: Callout
Page Index: 11
Date: 7/6/2022 9:59:49 AM
Author: CDurham
Color: ■
Layer:
Space:
Page Label: 11

2

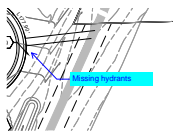

Subject: Callout
Page Index: 11
Date: 7/6/2022 10:00:27 AM
Author: CDurham
Color: ■
Layer:
Space:
Page Label: 11

Missing hydrants

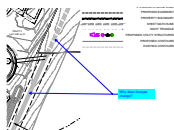

Subject: Callout
Page Index: 11
Date: 7/6/2022 10:01:02 AM
Author: CDurham
Color: ■
Layer:
Space:
Page Label: 11

Why does linetype change?

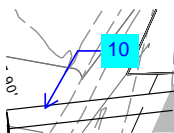

Subject: Callout
Page Index: 11
Date: 7/6/2022 10:01:16 AM
Author: CDurham
Color: ■
Layer:
Space:
Page Label: 11

10

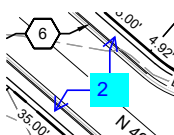

Subject: Callout
Page Index: 11
Date: 7/6/2022 10:01:47 AM
Author: CDurham
Color: ■
Layer:
Space:
Page Label: 11

2

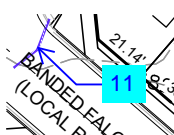

Subject: Callout
Page Index: 11
Date: 7/6/2022 10:02:11 AM
Author: CDurham
Color: ■
Layer:
Space:
Page Label: 11

11

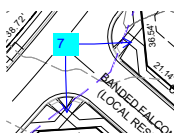

Subject: Callout
Page Index: 11
Date: 7/6/2022 10:02:39 AM
Author: CDurham
Color: ■
Layer:
Space:
Page Label: 11

7

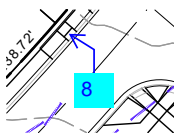

Subject: Callout
Page Index: 11
Date: 7/6/2022 10:02:55 AM
Author: CDurham
Color: ■
Layer:
Space:
Page Label: 11

8

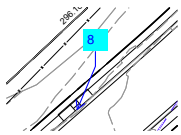

Subject: Callout
Page Index: 11
Date: 7/6/2022 10:03:15 AM
Author: CDurham
Color: ■
Layer:
Space:
Page Label: 11

8



Subject: Callout
Page Index: 11
Date: 7/6/2022 10:03:37 AM
Author: CDurham
Color: ■
Layer:
Space:
Page Label: 11

7

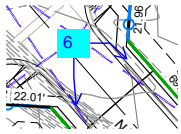

Subject: Callout
Page Index: 11
Date: 7/6/2022 10:04:05 AM
Author: CDurham
Color: ■
Layer:
Space:
Page Label: 11

6

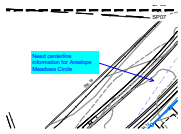

Subject: Callout
Page Index: 11
Date: 7/6/2022 10:04:38 AM
Author: CDurham
Color: ■
Layer:
Space:
Page Label: 11

Need centerline information for Antelope Meadows Circle

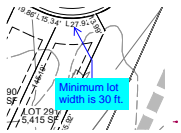

Subject: Callout
Page Index: 11
Date: 7/15/2022 3:37:43 PM
Author: CDurham
Color: ■
Layer:
Space:
Page Label: 11

Minimum lot width is 30 ft.

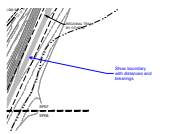

Subject: Callout
Page Index: 11
Date: 7/11/2022 11:03:10 AM
Author: dsdrice
Color: ■
Layer:
Space:
Page Label: 11

Show boundary with distances and bearings

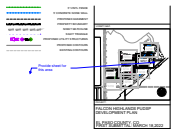

Subject: Callout
Page Index: 11
Date: 7/11/2022 11:03:48 AM
Author: dsdrice
Color: ■
Layer:
Space:
Page Label: 11

Provide sheet for this area

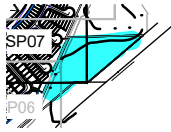

Subject:
Page Index: 11
Date: 7/11/2022 11:04:12 AM
Author: dsdrice
Color: ■
Layer:
Space:
Page Label: 11

Label wetlands mitigation area

Subject: Text Box
Page Index: 11
Date: 7/11/2022 11:06:14 AM
Author: dsdrice
Color: ■
Layer:
Space:
Page Label: 11

Label wetlands mitigation area

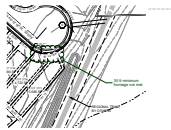

Subject: Architect
Page Index: 11
Date: 7/15/2022 8:53:50 AM
Author: Ryan Howser
Color: ■
Layer:
Space:
Page Label: 11

30 ft minimum frontage not met

12 (10)



Subject: Callout
Page Index: 12
Date: 7/6/2022 10:11:13 AM
Author: CDurham
Color: ■
Layer:
Space:
Page Label: 12

Fix overlapping text

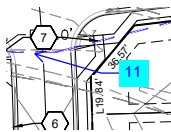

Subject: Callout
Page Index: 12
Date: 7/6/2022 10:13:17 AM
Author: CDurham
Color: ■
Layer:
Space:
Page Label: 12

11

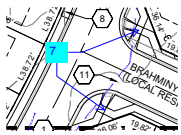

Subject: Callout
Page Index: 12
Date: 7/6/2022 10:13:35 AM
Author: CDurham
Color: ■
Layer:
Space:
Page Label: 12

7

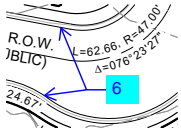

Subject: Callout
Page Index: 12
Date: 7/6/2022 10:13:58 AM
Author: CDurham
Color: ■
Layer:
Space:
Page Label: 12

6

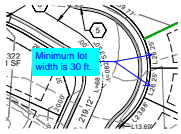

Subject: Callout
Page Index: 12
Date: 7/15/2022 3:38:15 PM
Author: CDurham
Color: ■
Layer:
Space:
Page Label: 12

Minimum lot width is 30 ft.

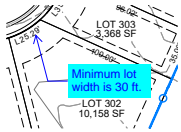

Subject: Callout
Page Index: 12
Date: 7/15/2022 3:38:07 PM
Author: CDurham
Color: ■
Layer:
Space:
Page Label: 12

Minimum lot width is 30 ft.



Subject: Callout
Page Index: 12
Date: 7/11/2022 9:38:33 AM
Author: dsdrice
Color: ■
Layer:
Space:
Page Label: 12

Label approximate centerline grades on all proposed roads

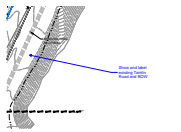

Subject: Callout
Page Index: 12
Date: 7/11/2022 1:53:17 PM
Author: dsdrice
Color: ■
Layer:
Space:
Page Label: 12

Show and label existing Tamlin Road and ROW



Subject: Architect
Page Index: 12
Date: 7/15/2022 8:50:42 AM
Author: Ryan Howser
Color: ■
Layer:
Space:
Page Label: 12

This is the floodplain boundary and the majority of these lots is encumbered. How is Lot 311 buildable? Please remove these lots 309-311 from the floodplain.



Subject: Architect
Page Index: 12
Date: 7/15/2022 8:52:38 AM
Author: Ryan Howser
Color: ■
Layer:
Space:
Page Label: 12

These lots don't meet the 30 ft minimum frontage

13 (9)



Subject: Callout
Page Index: 13
Date: 7/6/2022 10:17:03 AM
Author: CDurham
Color: ■
Layer:
Space:
Page Label: 13

2

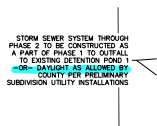

Subject:
Page Index: 13
Date: 7/11/2022 8:47:17 AM
Author: dsdrice
Color: ■
Layer:
Space:
Page Label: 13

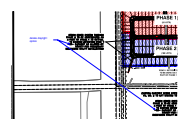

Subject: Callout
Page Index: 13
Date: 7/11/2022 8:47:42 AM
Author: dsdrice
Color: ■
Layer:
Space:
Page Label: 13

delete daylight option

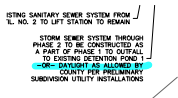

Subject:
Page Index: 13
Date: 7/11/2022 8:47:50 AM
Author: dsdrice
Color: ■
Layer:
Space:
Page Label: 13

R PHASES
ASE 2).
ENTION PC

Subject:
Page Index: 13
Date: 7/11/2022 8:48:58 AM
Author: dsdrice
Color: 
Layer:
Space:
Page Label: 13

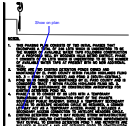

Subject: Callout
Page Index: 13
Date: 7/11/2022 8:49:44 AM
Author: dsdrice
Color: 
Layer:
Space:
Page Label: 13

Show on plan

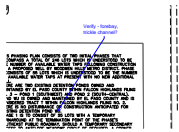

Subject: Callout
Page Index: 13
Date: 7/11/2022 8:50:25 AM
Author: dsdrice
Color: 
Layer:
Space:
Page Label: 13

Verify - forebay, trickle channel?

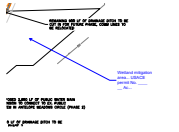

Subject: Callout
Page Index: 13
Date: 7/11/2022 1:53:53 PM
Author: dsdrice
Color: 
Layer:
Space:
Page Label: 13

Wetland mitigation area... USACE permit No. ____
__ Ac...



Subject: Text Box
Page Index: 13
Date: 7/15/2022 10:12:46 AM
Author: Ryan Howser
Color: 
Layer:
Space:
Page Label: 13

Future phases are identified as phases 3 and 4 elsewhere.

14 (13)

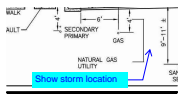

Subject: Callout
Page Index: 14
Date: 7/6/2022 10:18:38 AM
Author: CDurham
Color: 
Layer:
Space:
Page Label: [1] SITE 1

Show storm location

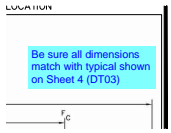

Subject: Text Box
Page Index: 14
Date: 7/6/2022 10:18:11 AM
Author: CDurham
Color: ■
Layer:
Space:
Page Label: [1] SITE 1

Be sure all dimensions match with typical shown on Sheet 4 (DT03)

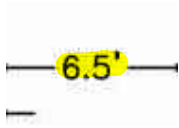

Subject: Highlight
Page Index: 14
Date: 7/6/2022 10:18:27 AM
Author: CDurham
Color: ■
Layer:
Space:
Page Label: [1] SITE 1



Subject: Highlight
Page Index: 14
Date: 7/6/2022 10:18:29 AM
Author: CDurham
Color: ■
Layer:
Space:
Page Label: [1] SITE 1

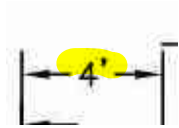

Subject: Highlight
Page Index: 14
Date: 7/6/2022 10:18:31 AM
Author: CDurham
Color: ■
Layer:
Space:
Page Label: [1] SITE 1

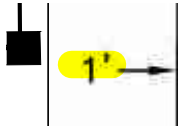

Subject: Highlight
Page Index: 14
Date: 7/6/2022 10:18:33 AM
Author: CDurham
Color: ■
Layer:
Space:
Page Label: [1] SITE 1

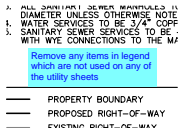

Subject: Text Box
Page Index: 14
Date: 7/6/2022 10:19:15 AM
Author: CDurham
Color: ■
Layer:
Space:
Page Label: [1] SITE 1

Remove any items in legend which are not used on any of the utility sheets

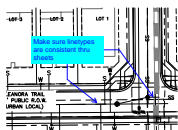

Subject: Callout
Page Index: 14
Date: 7/6/2022 10:20:04 AM
Author: CDurham
Color: ■
Layer:
Space:
Page Label: [1] SITE 1

Make sure linetypes are consistent thru sheets

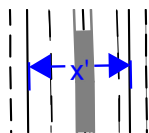

Subject: Dimension
Page Index: 14
Date: 7/6/2022 10:20:40 AM
Author: CDurham
Color: ■
Layer:
Space:
Page Label: [1] SITE 1

x'

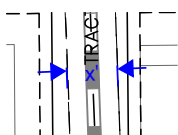

Subject: Dimension
Page Index: 14
Date: 7/6/2022 10:20:56 AM
Author: CDurham
Color: ■
Layer:
Space:
Page Label: [1] SITE 1

x'

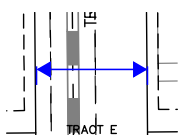

Subject: Dimension
Page Index: 14
Date: 7/6/2022 10:21:34 AM
Author: CDurham
Color: ■
Layer:
Space:
Page Label: [1] SITE 1

Include full name and area for all tracts



Subject: Callout
Page Index: 14
Date: 7/6/2022 10:22:39 AM
Author: CDurham
Color: ■
Layer:
Space:
Page Label: [1] SITE 1

Label all existing and proposed easements

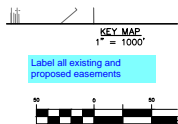

Subject: Text Box
Page Index: 14
Date: 7/6/2022 10:25:07 AM
Author: CDurham
Color: ■
Layer:
Space:
Page Label: [1] SITE 1

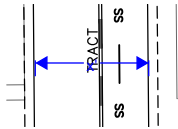

Subject: Dimension
Page Index: 15
Date: 7/6/2022 10:23:58 AM
Author: CDurham
Color: ■
Layer:
Space:
Page Label: 15

x'

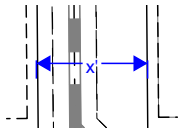

Subject: Dimension
Page Index: 15
Date: 7/6/2022 10:24:15 AM
Author: CDurham
Color: ■
Layer:
Space:
Page Label: 15

x'

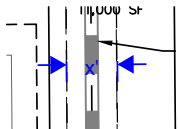

Subject: Dimension
Page Index: 15
Date: 7/6/2022 10:24:38 AM
Author: CDurham
Color: ■
Layer:
Space:
Page Label: 15

x'

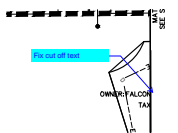

Subject: Callout
Page Index: 15
Date: 7/6/2022 10:25:24 AM
Author: CDurham
Color: ■
Layer:
Space:
Page Label: 15

Fix cut off text

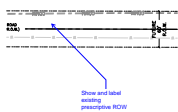

Subject: Callout
Page Index: 15
Date: 7/11/2022 8:43:58 AM
Author: dsdrice
Color: ■
Layer:
Space:
Page Label: 15

Show and label existing prescriptive ROW

Lot #

Subject: Text Box
Page Index: 16
Date: 7/6/2022 10:25:44 AM
Author: CDurham
Color: ■
Layer:
Space:
Page Label: 16

Lot #

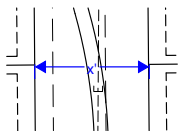

Subject: Dimension
Page Index: 16
Date: 7/6/2022 10:26:22 AM
Author: CDurham
Color: ■
Layer:
Space:
Page Label: 16

x'

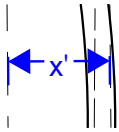

Subject: Dimension
Page Index: 16
Date: 7/6/2022 10:26:16 AM
Author: CDurham
Color: ■
Layer:
Space:
Page Label: 16

x'

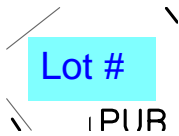

Subject: Text Box
Page Index: 16
Date: 7/6/2022 10:26:44 AM
Author: CDurham
Color: ■
Layer:
Space:
Page Label: 16

Lot #



Subject: Callout
Page Index: 16
Date: 7/6/2022 10:27:01 AM
Author: CDurham
Color: ■
Layer:
Space:
Page Label: 16

Fix overlapping text

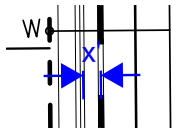

Subject: Dimension
Page Index: 16
Date: 7/6/2022 10:34:13 AM
Author: CDurham
Color: ■
Layer:
Space:
Page Label: 16

x'

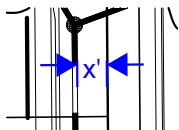

Subject: Dimension
Page Index: 16
Date: 7/6/2022 10:34:27 AM
Author: CDurham
Color: ■
Layer:
Space:
Page Label: 16

x'

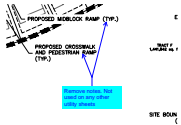

Subject: Callout
Page Index: 17
Date: 7/6/2022 10:27:39 AM
Author: CDurham
Color: ■
Layer:
Space:
Page Label: 17

Remove notes. Not used on any other utility sheets

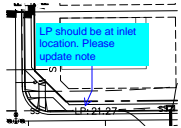

Subject: Callout
Page Index: 17
Date: 7/6/2022 10:28:11 AM
Author: CDurham
Color: ■
Layer:
Space:
Page Label: 17

LP should be at inlet location. Please update note

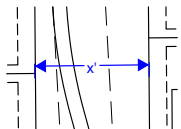

Subject: Dimension
Page Index: 17
Date: 7/6/2022 10:28:36 AM
Author: CDurham
Color: ■
Layer:
Space:
Page Label: 17

x'

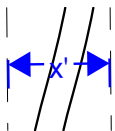

Subject: Dimension
Page Index: 17
Date: 7/6/2022 10:28:54 AM
Author: CDurham
Color: ■
Layer:
Space:
Page Label: 17

x'



Subject: Callout
Page Index: 17
Date: 7/11/2022 8:41:20 AM
Author: dsdrice
Color: ■
Layer:
Space:
Page Label: 17

Show all utilities

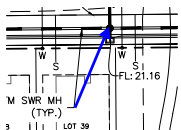

Subject: Arrow
Page Index: 17
Date: 7/11/2022 8:41:57 AM
Author: dsdrice
Color: ■
Layer:
Space:
Page Label: 17

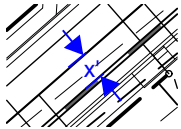

Subject: Dimension
Page Index: 18
Date: 7/6/2022 10:29:45 AM
Author: CDurham
Color: ■
Layer:
Space:
Page Label: 18

x'

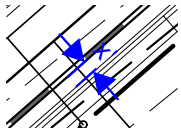

Subject: Dimension
Page Index: 18
Date: 7/6/2022 10:30:17 AM
Author: CDurham
Color: ■
Layer:
Space:
Page Label: 18

x'

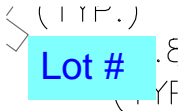

Subject: Text Box
Page Index: 18
Date: 7/6/2022 10:30:37 AM
Author: CDurham
Color: ■
Layer:
Space:
Page Label: 18

Lot #

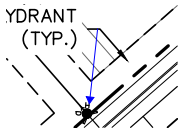

Subject: Arrow
Page Index: 18
Date: 7/6/2022 10:30:59 AM
Author: CDurham
Color: ■
Layer:
Space:
Page Label: 18

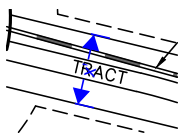

Subject: Dimension
Page Index: 18
Date: 7/6/2022 10:31:21 AM
Author: CDurham
Color: ■
Layer:
Space:
Page Label: 18

x'

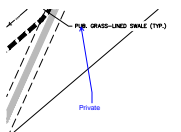

Subject: Callout
Page Index: 18
Date: 7/11/2022 8:40:11 AM
Author: dsdrice
Color: ■
Layer:
Space:
Page Label: 18

Private

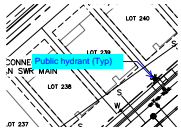

Subject: Callout
Page Index: 19
Date: 7/6/2022 10:37:01 AM
Author: CDurham
Color: ■
Layer:
Space:
Page Label: 19

Public hydrant (Typ)

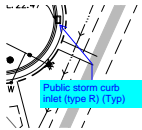

Subject: Callout
Page Index: 19
Date: 7/6/2022 10:37:36 AM
Author: CDurham
Color: ■
Layer:
Space:
Page Label: 19

Public storm curb inlet (type R) (Typ)

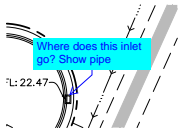

Subject: Callout
Page Index: 19
Date: 7/6/2022 10:38:00 AM
Author: CDurham
Color: ■
Layer:
Space:
Page Label: 19

Where does this inlet go? Show pipe

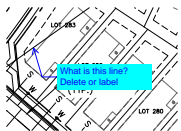

Subject: Callout
Page Index: 19
Date: 7/6/2022 10:38:25 AM
Author: CDurham
Color: ■
Layer:
Space:
Page Label: 19

What is this line? Delete or label



Subject: Callout
Page Index: 19
Date: 7/6/2022 10:38:40 AM
Author: CDurham
Color: ■
Layer:
Space:
Page Label: 19

Label all easements

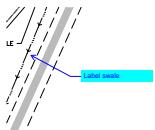

Subject: Callout
Page Index: 19
Date: 7/6/2022 10:41:13 AM
Author: CDurham
Color: ■
Layer:
Space:
Page Label: 19

Label swale

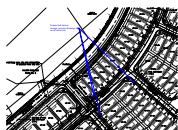

Subject: Callout
Page Index: 19
Date: 7/11/2022 8:39:00 AM
Author: dsdrice
Color: ■
Layer:
Space:
Page Label: 19

Ensure that there is enough room for driveways on all corner lots

20 (6)

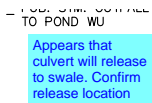

Subject: Text Box
Page Index: 20
Date: 7/6/2022 10:39:51 AM
Author: CDurham
Color: ■
Layer:
Space:
Page Label: 20

Appears that culvert will release to swale. Confirm release location

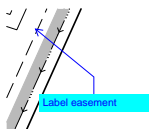

Subject: Callout
Page Index: 20
Date: 7/6/2022 10:40:03 AM
Author: CDurham
Color: ■
Layer:
Space:
Page Label: 20

Label easement

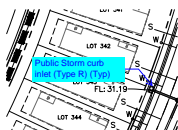

Subject: Callout
Page Index: 20
Date: 7/6/2022 10:40:32 AM
Author: CDurham
Color: ■
Layer:
Space:
Page Label: 20

Public Storm curb inlet (Type R) (Typ)

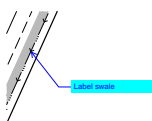

Subject: Callout
Page Index: 20
Date: 7/6/2022 10:41:25 AM
Author: CDurham
Color: ■
Layer:
Space:
Page Label: 20

Label swale

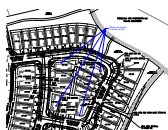

Subject: Callout
Page Index: 20
Date: 7/11/2022 8:35:39 AM
Author: dsdrice
Color: ■
Layer:
Space:
Page Label: 20

Where will access to these lots be?



Subject: Callout
Page Index: 20
Date: 7/15/2022 3:39:09 PM
Author: dsdrice
Color: ■
Layer:
Space:
Page Label: 20

Show and label floodplain and remove lots from the floodplain area.

21 (2)

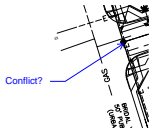

Subject: Callout
Page Index: 21
Date: 7/11/2022 8:32:54 AM
Author: dsdrice
Color: ■
Layer:
Space:
Page Label: 21

Conflict?

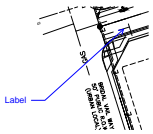

Subject: Callout
Page Index: 21
Date: 7/11/2022 8:33:06 AM
Author: dsdrice
Color: ■
Layer:
Space:
Page Label: 21

Label

23 (2)

LANDSCAPE CONTRACTOR TO
 AFTER PROVISIONAL ACCEPT
 SHALL WORK ON TREES TO REM
 ' THE CITY FORESTER
 THE CONTRACTOR SHALL PR
 AUTOMATIC IRRIGATION SYS
 MAINTAIN THE PLANT'S HEAL

Subject:
Page Index: 23
Date: 7/11/2022 8:30:38 AM
Author: dsdrice
Color: ■
Layer:
Space:
Page Label: 23

CITY FORESTER

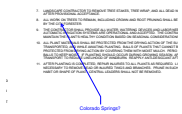

Subject: Callout
Page Index: 23
Date: 7/11/2022 8:31:00 AM
Author: dsdrice
Color: ■
Layer:
Space:
Page Label: 23

Colorado Springs?

24 (2)

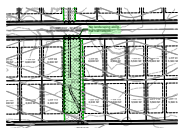

Subject: Architect
Page Index: 24
Date: 7/15/2022 10:18:56 AM
Author: Ryan Howser
Color: ■
Layer:
Space:
Page Label: 24

No landscaping along the trail network?

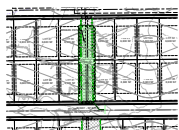

Subject: Architect
Page Index: 24
Date: 7/15/2022 10:19:23 AM
Author: Ryan Howser
Color: ■
Layer:
Space:
Page Label: 24

30 (1)

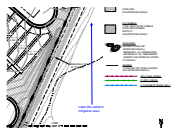

Subject: Callout
Page Index: 30
Date: 7/11/2022 10:37:21 AM
Author: dsdrice
Color: ■
Layer:
Space:
Page Label: 30

Label the wetland mitigation area