

V1_Site Development Plan_COMMENTS.pdf Markup Summary

eschoenheit (3)

OWNER OF HIMSELF AND ANY DEVELOPER OR BUILDERS THAT SUBMITTER AND/OR SAID TO SHALL BE REQUIRED TO PAY TRAFFIC IMPACT FEES IF:
1. FUND-COUNTY ROAD IMPACT FEE PROGRAM
2. FUND-COUNTY ROAD IMPACT FEE PROGRAM
3. FUND-COUNTY ROAD IMPACT FEE PROGRAM
4. FUND-COUNTY ROAD IMPACT FEE PROGRAM
5. FUND-COUNTY ROAD IMPACT FEE PROGRAM
6. FUND-COUNTY ROAD IMPACT FEE PROGRAM
7. FUND-COUNTY ROAD IMPACT FEE PROGRAM
8. FUND-COUNTY ROAD IMPACT FEE PROGRAM
9. FUND-COUNTY ROAD IMPACT FEE PROGRAM
10. FUND-COUNTY ROAD IMPACT FEE PROGRAM
11. FUND-COUNTY ROAD IMPACT FEE PROGRAM
12. FUND-COUNTY ROAD IMPACT FEE PROGRAM
13. FUND-COUNTY ROAD IMPACT FEE PROGRAM
14. FUND-COUNTY ROAD IMPACT FEE PROGRAM
15. FUND-COUNTY ROAD IMPACT FEE PROGRAM
16. FUND-COUNTY ROAD IMPACT FEE PROGRAM
17. FUND-COUNTY ROAD IMPACT FEE PROGRAM
18. FUND-COUNTY ROAD IMPACT FEE PROGRAM
19. FUND-COUNTY ROAD IMPACT FEE PROGRAM
20. FUND-COUNTY ROAD IMPACT FEE PROGRAM
21. FUND-COUNTY ROAD IMPACT FEE PROGRAM
22. FUND-COUNTY ROAD IMPACT FEE PROGRAM
23. FUND-COUNTY ROAD IMPACT FEE PROGRAM
24. FUND-COUNTY ROAD IMPACT FEE PROGRAM
25. FUND-COUNTY ROAD IMPACT FEE PROGRAM
26. FUND-COUNTY ROAD IMPACT FEE PROGRAM
27. FUND-COUNTY ROAD IMPACT FEE PROGRAM
28. FUND-COUNTY ROAD IMPACT FEE PROGRAM
29. FUND-COUNTY ROAD IMPACT FEE PROGRAM
30. FUND-COUNTY ROAD IMPACT FEE PROGRAM
31. FUND-COUNTY ROAD IMPACT FEE PROGRAM
32. FUND-COUNTY ROAD IMPACT FEE PROGRAM
33. FUND-COUNTY ROAD IMPACT FEE PROGRAM
34. FUND-COUNTY ROAD IMPACT FEE PROGRAM
35. FUND-COUNTY ROAD IMPACT FEE PROGRAM
36. FUND-COUNTY ROAD IMPACT FEE PROGRAM
37. FUND-COUNTY ROAD IMPACT FEE PROGRAM
38. FUND-COUNTY ROAD IMPACT FEE PROGRAM
39. FUND-COUNTY ROAD IMPACT FEE PROGRAM
40. FUND-COUNTY ROAD IMPACT FEE PROGRAM
41. FUND-COUNTY ROAD IMPACT FEE PROGRAM
42. FUND-COUNTY ROAD IMPACT FEE PROGRAM
43. FUND-COUNTY ROAD IMPACT FEE PROGRAM
44. FUND-COUNTY ROAD IMPACT FEE PROGRAM
45. FUND-COUNTY ROAD IMPACT FEE PROGRAM
46. FUND-COUNTY ROAD IMPACT FEE PROGRAM
47. FUND-COUNTY ROAD IMPACT FEE PROGRAM
48. FUND-COUNTY ROAD IMPACT FEE PROGRAM
49. FUND-COUNTY ROAD IMPACT FEE PROGRAM
50. FUND-COUNTY ROAD IMPACT FEE PROGRAM
51. FUND-COUNTY ROAD IMPACT FEE PROGRAM
52. FUND-COUNTY ROAD IMPACT FEE PROGRAM
53. FUND-COUNTY ROAD IMPACT FEE PROGRAM
54. FUND-COUNTY ROAD IMPACT FEE PROGRAM
55. FUND-COUNTY ROAD IMPACT FEE PROGRAM
56. FUND-COUNTY ROAD IMPACT FEE PROGRAM
57. FUND-COUNTY ROAD IMPACT FEE PROGRAM
58. FUND-COUNTY ROAD IMPACT FEE PROGRAM
59. FUND-COUNTY ROAD IMPACT FEE PROGRAM
60. FUND-COUNTY ROAD IMPACT FEE PROGRAM
61. FUND-COUNTY ROAD IMPACT FEE PROGRAM
62. FUND-COUNTY ROAD IMPACT FEE PROGRAM
63. FUND-COUNTY ROAD IMPACT FEE PROGRAM
64. FUND-COUNTY ROAD IMPACT FEE PROGRAM
65. FUND-COUNTY ROAD IMPACT FEE PROGRAM
66. FUND-COUNTY ROAD IMPACT FEE PROGRAM
67. FUND-COUNTY ROAD IMPACT FEE PROGRAM
68. FUND-COUNTY ROAD IMPACT FEE PROGRAM
69. FUND-COUNTY ROAD IMPACT FEE PROGRAM
70. FUND-COUNTY ROAD IMPACT FEE PROGRAM
71. FUND-COUNTY ROAD IMPACT FEE PROGRAM
72. FUND-COUNTY ROAD IMPACT FEE PROGRAM
73. FUND-COUNTY ROAD IMPACT FEE PROGRAM
74. FUND-COUNTY ROAD IMPACT FEE PROGRAM
75. FUND-COUNTY ROAD IMPACT FEE PROGRAM
76. FUND-COUNTY ROAD IMPACT FEE PROGRAM
77. FUND-COUNTY ROAD IMPACT FEE PROGRAM
78. FUND-COUNTY ROAD IMPACT FEE PROGRAM
79. FUND-COUNTY ROAD IMPACT FEE PROGRAM
80. FUND-COUNTY ROAD IMPACT FEE PROGRAM
81. FUND-COUNTY ROAD IMPACT FEE PROGRAM
82. FUND-COUNTY ROAD IMPACT FEE PROGRAM
83. FUND-COUNTY ROAD IMPACT FEE PROGRAM
84. FUND-COUNTY ROAD IMPACT FEE PROGRAM
85. FUND-COUNTY ROAD IMPACT FEE PROGRAM
86. FUND-COUNTY ROAD IMPACT FEE PROGRAM
87. FUND-COUNTY ROAD IMPACT FEE PROGRAM
88. FUND-COUNTY ROAD IMPACT FEE PROGRAM
89. FUND-COUNTY ROAD IMPACT FEE PROGRAM
90. FUND-COUNTY ROAD IMPACT FEE PROGRAM
91. FUND-COUNTY ROAD IMPACT FEE PROGRAM
92. FUND-COUNTY ROAD IMPACT FEE PROGRAM
93. FUND-COUNTY ROAD IMPACT FEE PROGRAM
94. FUND-COUNTY ROAD IMPACT FEE PROGRAM
95. FUND-COUNTY ROAD IMPACT FEE PROGRAM
96. FUND-COUNTY ROAD IMPACT FEE PROGRAM
97. FUND-COUNTY ROAD IMPACT FEE PROGRAM
98. FUND-COUNTY ROAD IMPACT FEE PROGRAM
99. FUND-COUNTY ROAD IMPACT FEE PROGRAM
100. FUND-COUNTY ROAD IMPACT FEE PROGRAM

Subject: Cloud+
Page Label: [1] 1 SITE DEVELOPMENT PLAN
Author: eschoenheit
Date: 4/9/2026 4:17:08 PM
Status:
Color: ■
Layer:
Space:

25-337

SMALL BE RELEV
PASO COUNTY
O. (19-471), C
PERMIT SUBMIT
ING, SHALL BE

Subject: Highlight
Page Label: [1] 1 SITE DEVELOPMENT PLAN
Author: eschoenheit
Date: 4/9/2026 4:17:10 PM
Status:
Color: ■
Layer:
Space:

Provide a sheet showing the demo plan and what buildings are being removed. Include GSF of each building being demo'd

Subject: Text Box
Page Label: [1] 1 SITE DEVELOPMENT PLAN
Author: eschoenheit
Date: 4/14/2026 9:35:57 AM
Status:
Color: ■
Layer:
Space:

Provide a sheet showing the demo plan and what buildings are being removed. Include GSF of each building being demo'd

MirandaBenson2 (7)

ECT INFO
): PPR2610
EDULE NO:
ITY ADDRESS

Subject: Planner
Page Label: [1] 1 SITE DEVELOPMENT PLAN
Author: MirandaBenson2
Date: 4/16/2026 2:58:49 PM
Status:
Color: ■
Layer:
Space:

PPR2610

ORMATION:
): 5500000164
S: 6155 FOUNTA
A-5, CAD-O(AN

Subject: Planner
Page Label: [1] 1 SITE DEVELOPMENT PLAN
Author: MirandaBenson2
Date: 4/16/2026 2:59:04 PM
Status:
Color: ■
Layer:
Space:

5500000164



Subject: Planner
Page Label: [1] 1 SITE DEVELOPMENT PLAN
Author: MirandaBenson2
Date: 4/17/2026 11:05:03 AM
Status:
Color: ■
Layer:
Space:

Please provide parking table, verification of parking space dimensional standards, ADA signage/stripping, and parking lot landscaping (islands) on a separate sheet.

Using this separate page to detail the traffic circulation in this area is highly encouraged. This will help address the Fire Protection District's comments and concerns.

For parking calculation, see EA Planning Checklist and LDC section 6.2.5.

If an alternative parking ratio or alternative design is requested, please specify and describe in the Letter of Intent.

PPR2610

Subject: Planner
Page Label: [1] 1 SITE DEVELOPMENT PLAN
Author: MirandaBenson2
Date: 4/16/2026 3:01:09 PM
Status:
Color: ■
Layer:
Space:

PPR2610

50 25 0 50
 SCALE: 1"=50'
 ALL LINEAL DIMENSIONS ARE IN U.S.

Please include a legend.

Subject: Planner
Page Label: [1] 1 SITE DEVELOPMENT PLAN
Author: MirandaBenson2
Date: 4/17/2026 10:57:19 AM
Status:
Color: ■
Layer:
Space:

Please include a legend.

ALL LINEAL DIMENSIONS ARE IN U.S. SURVEY FEET

Please identify the location of all garbage receptacles and the method of screening. (This can be provided on the Landscape Plan.)

Subject: Planner
Page Label: [1] 1 SITE DEVELOPMENT PLAN
Author: MirandaBenson2
Date: 4/17/2026 10:57:10 AM
Status:
Color: ■
Layer:
Space:

Please identify the location of all garbage receptacles and the method of screening. (This can be provided on the Landscape Plan.)

Under the "Property Area" line, please add calculations for:
 % open space,
 % landscaped, and
 % impermeable surface.
 (Unless provided on the Landscape Plan.)

Subject: Planner
Page Label: [1] 1 SITE DEVELOPMENT PLAN
Author: MirandaBenson2
Date: 4/17/2026 11:10:15 AM
Status:
Color: ■
Layer:
Space:

Under the "Property Area" line, please add calculations for:
 % open space,
 % landscaped, and
 % impermeable surface.

(Unless provided on the Landscape Plan.)

OWNER/APPLICANT:
 FOUNTAIN VALLEY SCHOOL
 6155 FOUNTAIN VALLEY SCHOOL ROAD
 COLORADO SPRINGS, COLORADO
 809011
 ATTN: DAVE MESKO
 719-391-5231

CIVIL ENGINEER:
 MARTIN/MARTIN INC.
 12499 W. COLFAX AVE.
 LAKEWOOD, COLORADO 80215
 ATTN: NICOLE KONTOUR, P.E.
 303-431-6100

ADDRESS:
 6155 FOUNTAIN VALLEY SCHOOL ROAD
 COLORADO SPRINGS, COLORADO 80911

PROJECT INFORMATION:
 PCD NO: PPR2610
 TAX SCHEDULE NO: 550000164
 PROPERTY ADDRESS: 6155 FOUNTAIN VALLEY SCHOOL ROAD
 CURRENT ZONING: A-5, CAD-O(ANAV)
 PROPOSED ZONING: A-5
 PROPOSED LAND USE: PRIVATE EDUCATIONAL INSTITUTION
 PROPOSED BUILDING(S) USE: ACADEMIC
 PROPERTY AREA: 9.37 AC

PARKING REQUIREMENTS:
 PARKING REQUIRED:
 PARKING PROVIDED:

Please provide parking table, verification of parking space dimensional standards, ADA signage/stripping, and parking lot landscaping (islands) on a separate sheet.

Using this separate page to detail the traffic circulation in this area is highly encouraged. This will help address the Fire Protection District's comments and concerns.

For parking calculation, see EA Planning Checklist and LDC section 6.2.5.

If an alternative parking ratio or alternative design is requested, please specify and describe in the Letter of Intent.

Under the "Property Area" line, please add calculations for:
 % open space,
 % landscaped, and
 % impermeable surface.

(Unless provided on the Landscape Plan.)

Provide a sheet showing the demo plan and what buildings are being removed. Include GSF of each building being demo'd

PLOT DATE: Friday, March 13, 2026 4:23 PM LAST SAVED BY: NKONTOUR
 DRAWING LOCATION: \\ymrcivil.martin.local\civil\BUCKLEY\23.0895-fountain_valley_school_academic_building\PLANS\SDP\SITE DEVELOPMENT PLAN.dwg

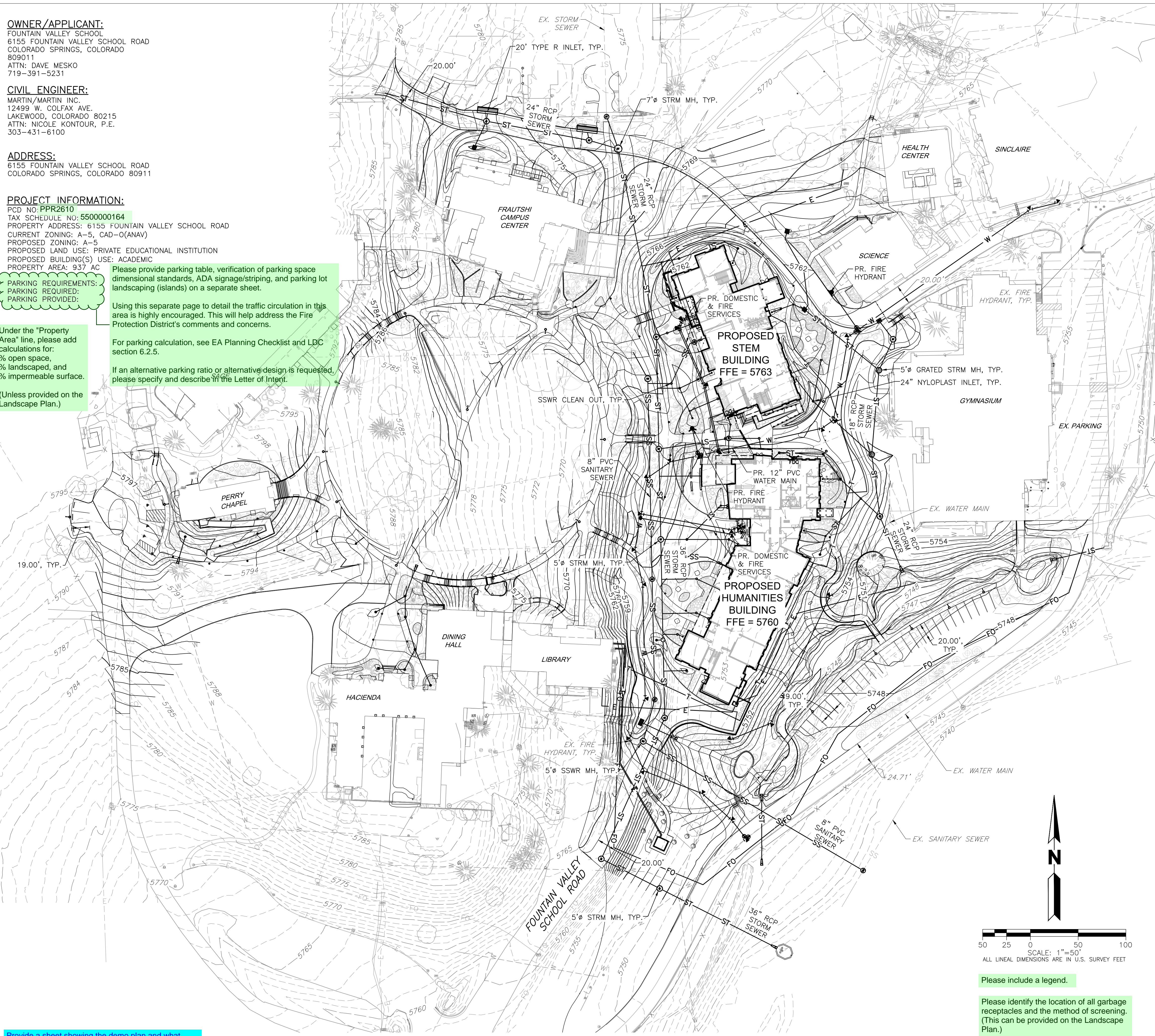

SUBJECT TO CHANGE
 PENDING JURISDICTIONAL APPROVAL



VICINITY MAP
 SCALE: 1"=500'



CALL 811 2-BUSINESS DAYS IN ADVANCE
 BEFORE YOU DIG, GRADE OR EXCAVATE FOR
 MARKING OF UNDERGROUND MEMBER UTILITIES

MARTIN/MARTIN ASSUMES NO RESPONSIBILITY FOR UTILITY LOCATIONS. UNLESS OTHERWISE NOTED, THE UTILITIES SHOWN ON THIS DRAWING ARE BASED ON INFORMATION PROVIDED BY OTHERS AND DEPICTED AS ASCE (38) QUALITY LEVEL D. IN ACCORDANCE WITH THE PROVISIONS OF COLORADO REVISED STATUTE, TITLE 9, IT IS THE CONTRACTOR'S RESPONSIBILITY TO CALL COLORADO 811 UTILITY LOCATE SERVICE FOR UTILITY LOCATES BEFORE DIGGING, AND FIELD VERIFY THE SIZE, MATERIAL, HORIZONTAL AND VERTICAL LOCATION OF ALL EXISTING UTILITIES (DEPICTED OR NOT DEPICTED) PRIOR TO THE COMMENCEMENT OF ANY CONSTRUCTION.

CONSTRUCTION SURVEY NOTE:
 ALL SIDEWALKS DESIGNED WITH A LONGITUDINAL SLOPE OF 4.50% OR GREATER SHALL HAVE THE CONCRETE FORMWORK SURVEYED PRIOR TO POURING CONCRETE TO ENSURE THAT THE SIDEWALK DOES NOT EXCEED THE MAXIMUM ALLOWABLE LONGITUDINAL SLOPE OF 5.0%. THE CROSS-SLOPE ON ALL SIDEWALKS SHALL NOT EXCEED 2.0%.

UTILITY NOTE:
 UTILITIES DEPICTED HEREON, DO NOT COMPLY WITH ASCE 38 UTILITY LOCATE STANDARD QUALITY LEVEL A OR B, UNLESS A SEPARATE PLAN SHEET ENTITLED "ASCE 38 UTILITY QUALITY LEVEL B PLAN (A&B)", STAMPED BY A COLORADO PE, IS INCLUDED IN THE PLAN SET. THE UTILITY LOCATES SHOWN HEREON REPRESENT ASCE QUALITY LEVEL D. THUS THE CONTRACTOR IS REQUIRED TO VERIFY THE ACTUAL LOCATION OF ALL UTILITIES PRIOR TO CONSTRUCTION. THE CONTRACTOR SHALL COMPLY WITH ALL THE PROVISIONS OF SENATE BILL 18-167 THAT REQUIRE NOTIFICATION OF THE NOTIFICATION ASSOCIATION AND COMPLIANCE WITH CURRENT 811 PROGRAM REQUIREMENTS.

FOR UNDERGROUND UTILITIES MARTIN/MARTIN INC. RELIED UPON LOCATIONS AND MARKINGS PROVIDED BY UNDERGROUND CONSULTING SOLUTIONS.

BASIS OF BEARING:
 BEARINGS ARE BASED ON THE COLORADO STATE PLANE CENTRAL ZONE NAD83 BEARING OF N89°11'31"E ALONG THE NORTHERLY LINE OF THE NORTHWEST QUARTER OF SECTION 5, T15S, R65W OF THE 6TH P.M. BEING MONUMENTED BY A FOUND 3-1/4" ALUMINUM CAP AT THE NORTHWEST CORNER AND A FOUND 3-1/4" ALUMINUM CAP PLS 17502 AT THE NORTH QUARTER CORNER.

BENCHMARK:
 ELEVATIONS ARE BASED NGS POINT HOWELLS, A NGS BRASS DISK SET IN CONCRETE ON THE SOUTH SIDE OF POWERS ROAD APPROXIMATELY 950 WEST OF THE INTERSECTION WITH PEAK INNOVATION PARKWAY
 ELEVATION = 5934.60 (NAVD1988) DATUM.

NOTE:
 THE OWNER AGREES ON BEHALF OF HIM/HERSELF AND ANY DEVELOPER OR BUILDER SUCCESSORS AND ASSIGNEES THAT SUBDIVIDER AND/OR SAID SUCCESSORS AND ASSIGNS SHALL BE REQUIRED TO PAY TRAFFIC IMPACT FEES IN ACCORDANCE WITH THE EL PASO COUNTY ROAD IMPACT FEE PROGRAM RESOLUTION (RESOLUTION NO. 19-471), OR ANY AMENDMENTS THERETO, AT OR PRIOR TO THE TIME OF BUILDING PERMIT SUBMITTALS. THE FEE OBLIGATION, IF NOT PAID AT FINAL PLAT RECORDING, SHALL BE DOCUMENTED ON ALL SALES DOCUMENTS AND ON PLAT NOTES TO ENSURE THAT A TITLE SEARCH WOULD FIND THE FEE OBLIGATION BEFORE SALE OF THE PROPERTY.

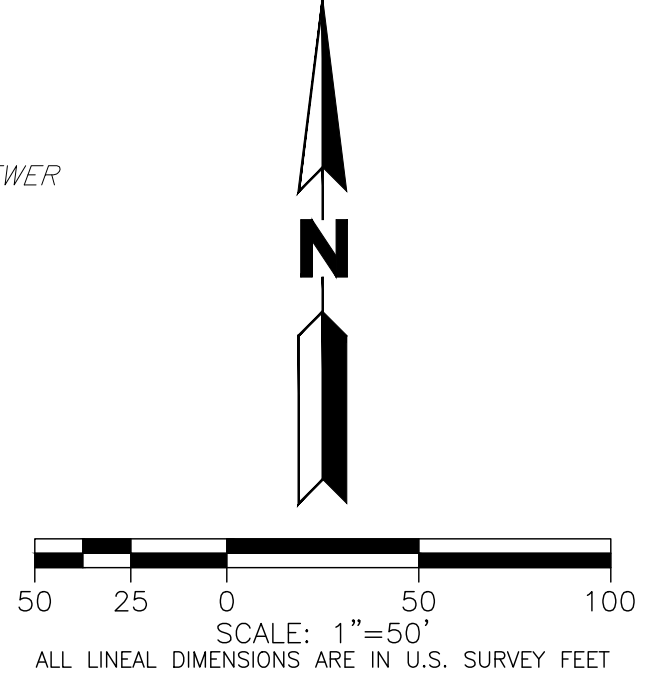

Please include a legend.
 Please identify the location of all garbage receptacles and the method of screening. (This can be provided on the Landscape Plan.)

PLANNING AND COMMUNITY DEVELOPMENT
 DIRECTOR APPROVAL:

 DIRECTOR DATE
 PCD FILE NO: PPR2610

FOUNTAIN VALLEY SCHOOL
 ACADEMIC CENTER

MARTIN/MARTIN
 CONSULTING ENGINEERS
 12499 WEST COLFAX AVENUE, LAKEWOOD, COLORADO 80215
 303.431.6100 MARTINMARTIN.COM

No.	Issue / Revision	Date	Name
1	1st SDP SUBMITTAL	03/13/26	NLK

Job Number 23-0895
 Project Manager N. KONTOUR
 Design By A. GUEVARA
 Drawn By J. DIAZ
 Principal In Charge P. BUCKLEY
THE DESIGN, SURVEY, MEASUREMENTS, AND TECHNICAL DRAWINGS ARE THE PROPERTY OF MARTIN/MARTIN CONSULTING ENGINEERS. NO PART OF THIS DOCUMENT CAN BE REPRODUCED, COPIED, OR OTHERWISE TRANSMITTED IN ANY FORM OR BY ANY MEANS, WITHOUT THE EXPRESS WRITTEN PERMISSION FROM MARTIN/MARTIN, INC.

Sheet Number:
 1

NOT FOR CONSTRUCTION

SITE DEVELOPMENT PLAN