

EAGLE WING DRIVE CENTERLINE DATA:
 BEGIN STA=1+00.00 N: 1,416,622.07 E: 3,229,893.71
 ① S 88°38'56" E 70.61'
 PROP LINE = STA=1+70.61 N: 1,416,620.40 E: 3,229,964.30
 ② N 89°50'22" E 46.40'
 PC = STA=2+16.96 N: 1,416,620.53 E: 3,230,010.65
 ③ L=927.63' A=141°43'53" R=375.00'
 CENTER CUL-DE-SAC = STA=11+44.59 N: 1,417,2907.60 E: 3,230,241.01'

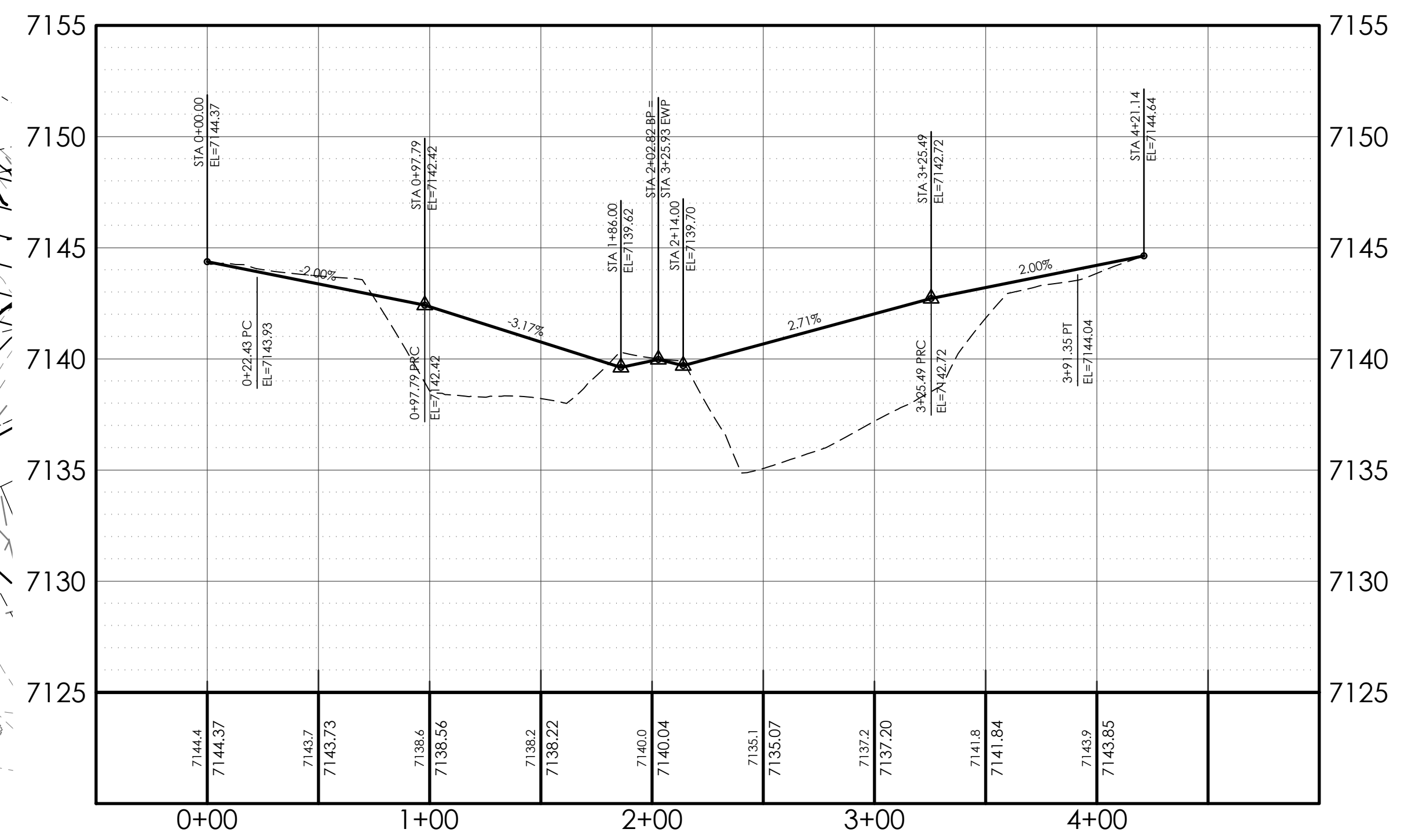

EAGLE WING DR (EWD) ENTRANCE BULB PROFILE (BP)
 SCALE: HORIZ-1"=50', VERT-1"=5'

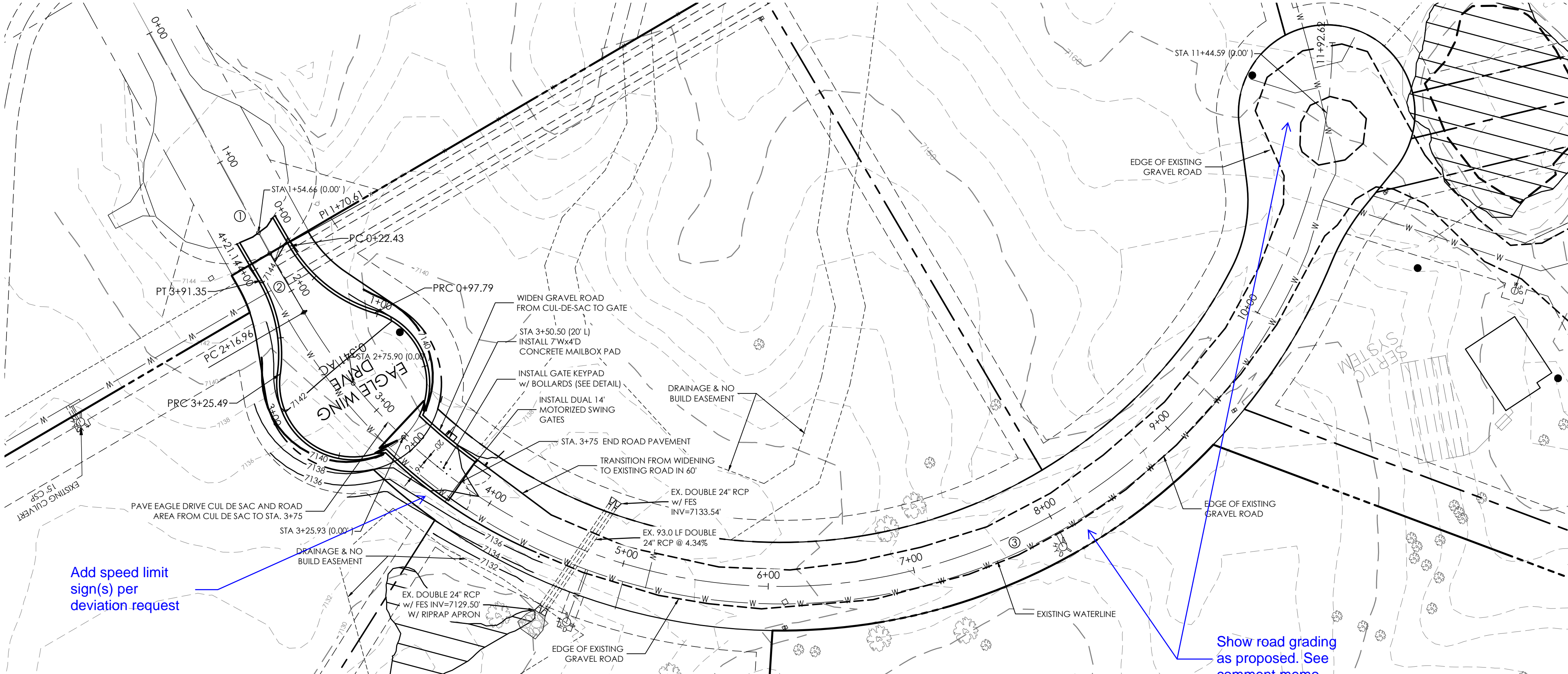
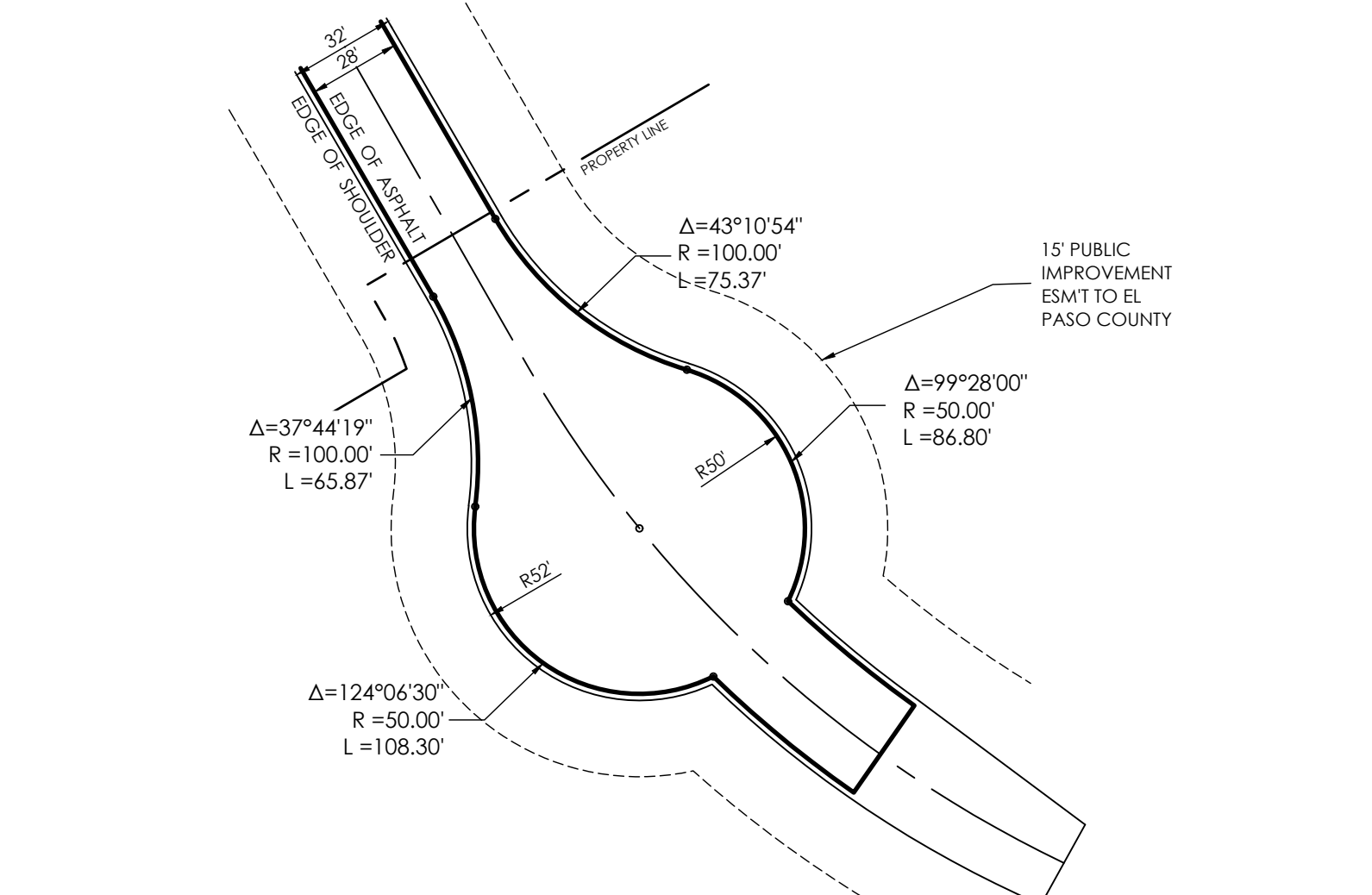
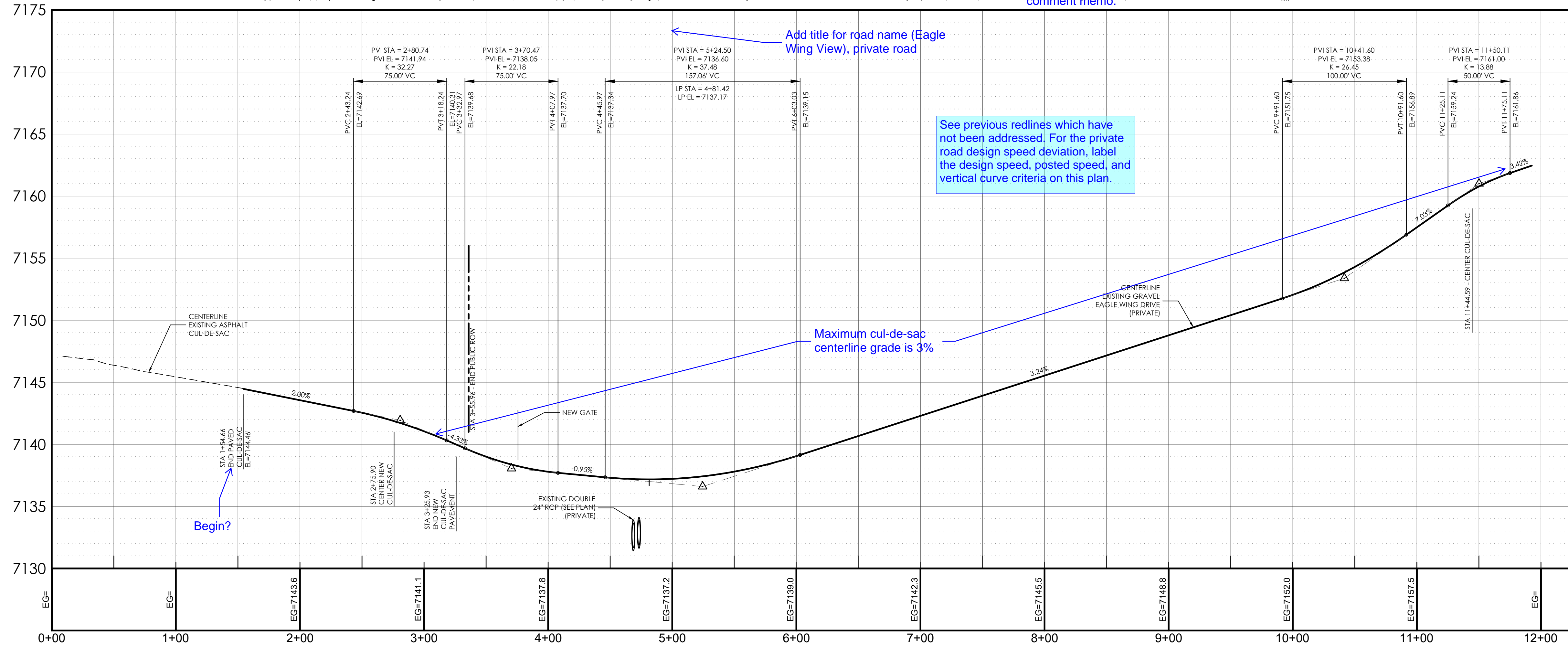

EAGLE WING DRIVE CUL-DE-SAC DETAIL
 SCALE: 1"=50'

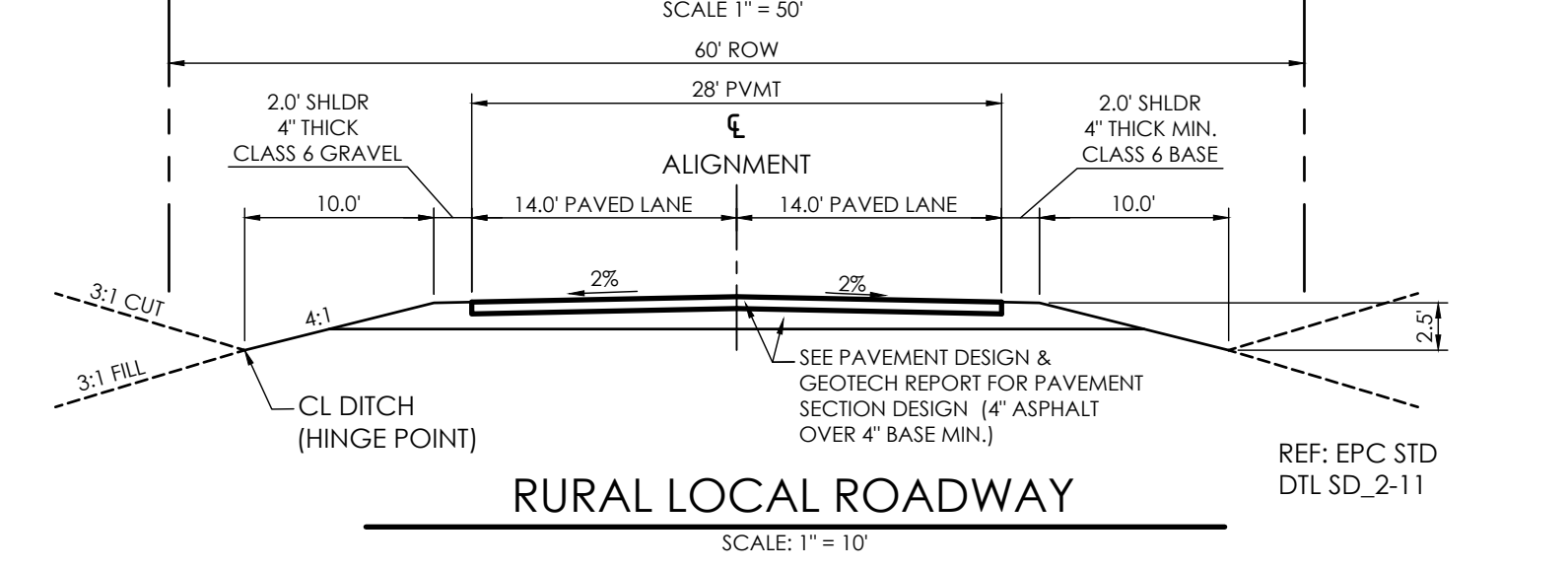

MODIFIED RURAL GRAVEL LOCAL ROADWAY
 SCALE: NOT TO SCALE

BENCHMARK:
 BASIS OF BEARINGS: BEARINGS ARE BASED ON THE WEST LINE OF THE SOUTHWEST QUARTER OF THE NORTHEAST QUARTER (SW 1/4 NE 1/4) OF SECTION 29, MONUMENTED AT THE NORTH WITH A 2 1/2 INCH ALUMINUM CAP STAMPED 'N 1/16 SEC. 29 2005 PLS 26965', AND THE AT THE SOUTH WITH A 3 1/4 INCH ALUMINUM CAP STAMPED '1997 T12S R63W C1/4 PLS 4842' AND IS ASSUMED TO BEAR N00°13'10"W A DISTANCE OF 1,324.32 FEET.

DESIGN DATA:
 SIDEWALKS: WIDTH N/A
 LOCATION: Attached Detached
 DESIGN SPEED 20 MPH / POSTED 15 MPH
 CURB TYPE: 8" 6" 4" 2"
 ROW WIDTH: 60' FL-FL N/A
 STREET TYPE: GRAVEL RURAL LOCAL
 PAVEMENT:
 TYPE: HMA PCC
 THICKNESS: _____
 COMPOSITE SECTION:
 HMA _____ BASE _____
 SUBGRADE STABILIZATION:
 CHEMICAL TYPE _____ MECHANICAL THICKNESS _____

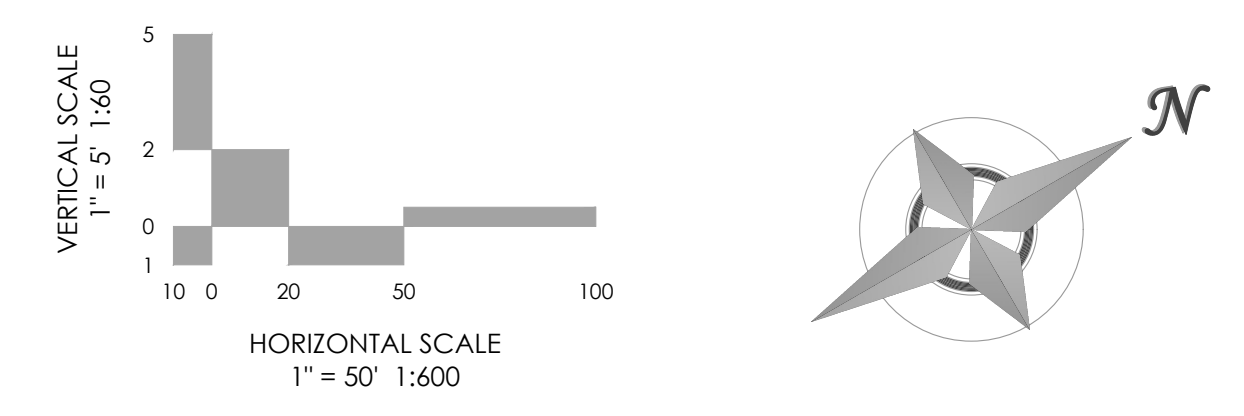

MVE, INC.
 ENGINEERS SURVEYORS
 1903 Irelary street
 colorado springs
 719.635.5736
 suite 200
 co 80909
 www.mvecivil.com

REVISIONS

MVE PROJECT 61145
 MVE DRAWING -CON-PP1
 SEPTEMBER 6, 2023
 DESIGNED BY CCC
 DRAWN BY WCG
 CHECKED BY _____
 AS-BUILT BY _____
 CHECKED BY _____
 EAGLE WING DRIVE AS-BUILT
 FROM STA 00+00.00 TO STA 11+44.59
 EAGLE RISING FILING NO. 1
 SHEET 2 OF 2