

Legal Description: TRACT IN SW4NE4 SEC 28-12-65 AS FOLS, COM AT NW COR OF SD SW4NE4, TH ELY 201.14 FT ALG N LN FOR POB, CONT ELY ALG SD N LN 345.72 FT, SLY PARA WITH W LN 660.0 FT, WLY PARA WITH N LN 345.72 FT, TH NLY 660.0 FT TO POB **CD=6/25/1971**

ADD2566

SITE PLAN

Not Required
BESQCP

02/20/2025 12:54:54 PM
dsdyounger

EPC Planning & Community
Development Department

APPROVED
Plan Review

02/20/2025 12:54:59 PM
dsdyounger

EPC Planning & Community
Development Department

It is the owner's responsibility to coordinate with easement holders to avoid impact to utilities that may be located in the easements.

ANY APPROVAL GIVEN BY EL PASO COUNTY DOES NOT OVIATE THE NEED TO COMPLY WITH APPLICABLE FEDERAL, STATE, OR LOCAL LAWS AND/OR REGULATION

Planning & Community Development Department approval is contingent upon compliance with all applicable notes on the recorded plat.

An access permit must be granted by the Planning & Community Development Department prior to the establishment of any driveway onto a County road.

Diversion of blockage of any drainage way is not permitted without approval of the Planning & Community Development Department

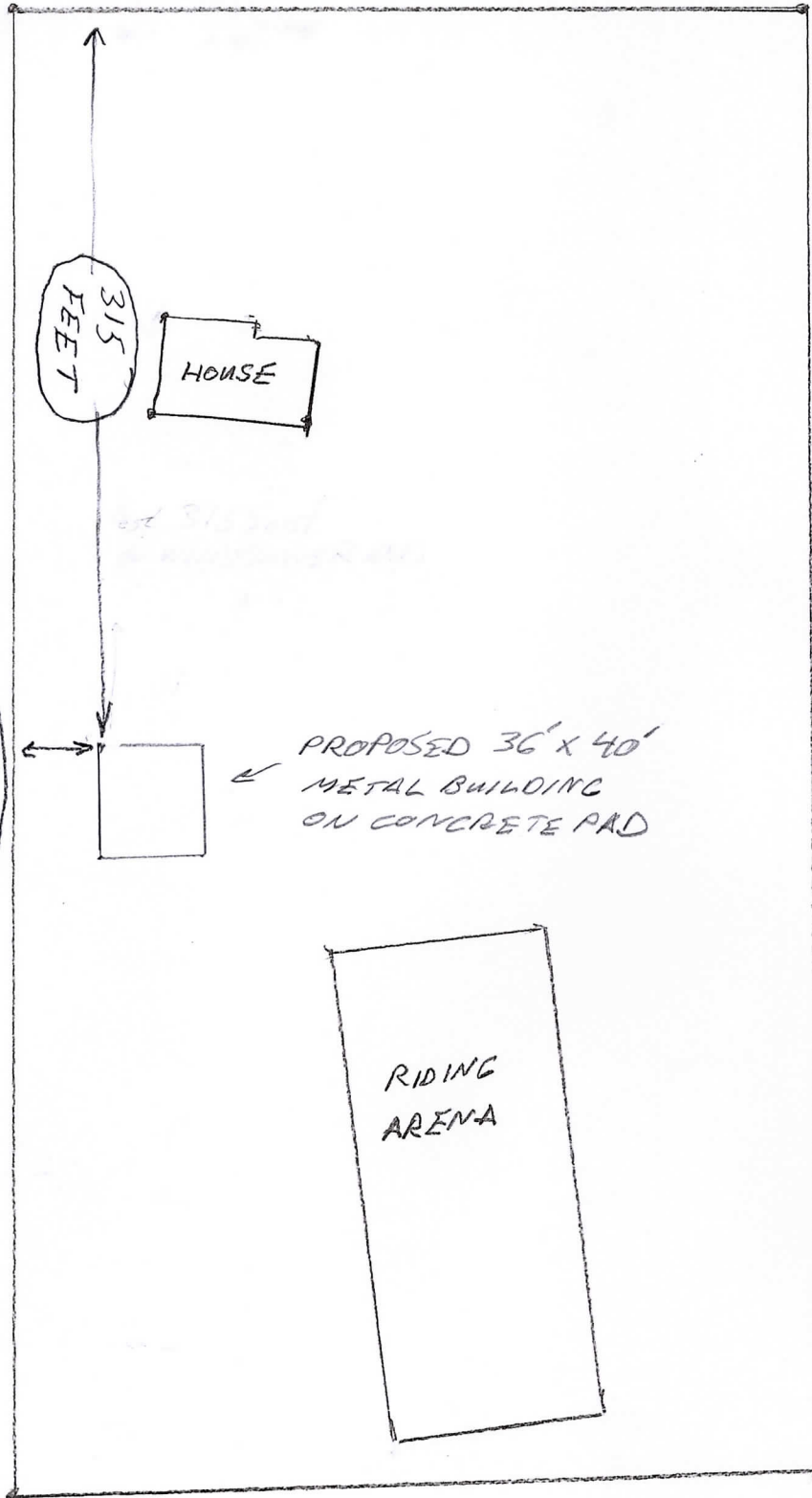

Demolished

PROPOSED METAL BUILDING WILL BE SITED 50 FEET EAST OF THE WEST PROPERTY LINE AND 315 FEET SOUTH OF THE NORTH PROPERTY LINE

RESIDENTIAL



2023 PPRBC
IECC: N/A

Address: 8335 WILDFLOWER RD, COLORADO SPRINGS

Parcel: 5228000004

Plan Track #: 198618 

Received: 18-Feb-2025 (BRIANNAM)

Description:

DETACHED GARAGE- POLE BARN

Contractor: HOMEOWNER

Type of Unit:

Required PPRBD Departments (3)

Floodplain

(N/A) RBD GIS

Construction

Mechanical

Required Outside Departments (1)

County Zoning

APPROVED
Plan Review
02/20/2025 12:55:49 PM
dsdyounger
EPC Planning & Community
Development Department

Release of this plan does not preclude compliance with all applicable codes, ordinances and other pertinent regulations. This plan set must be present on the job site for every inspection.