



STRUCTURAL DESIGN

FULLY OPEN (CARPORT) BUILDING

**MAXIMUM 30'-0" WIDE X 20'-0" EAVE HEIGHT- ~~BOX EAVE~~
~~FRAME AND BOW FRAME~~ 12x21x7**

15 October 2019

Revision 4

M&A Project No. 17149S/17335S/18285S/19214S/19302S

Prepared for:

**Coast to Coast Carports, Inc.
22425 I-40
Knoxville, Arkansas 72845**

Prepared by:

Moore and Associates Engineering and Consulting, Inc.

**1009 East Avenue
North Augusta, SC 29841**

**401 S. Main Street, Suite 200
Mount Airy, NC 27030**



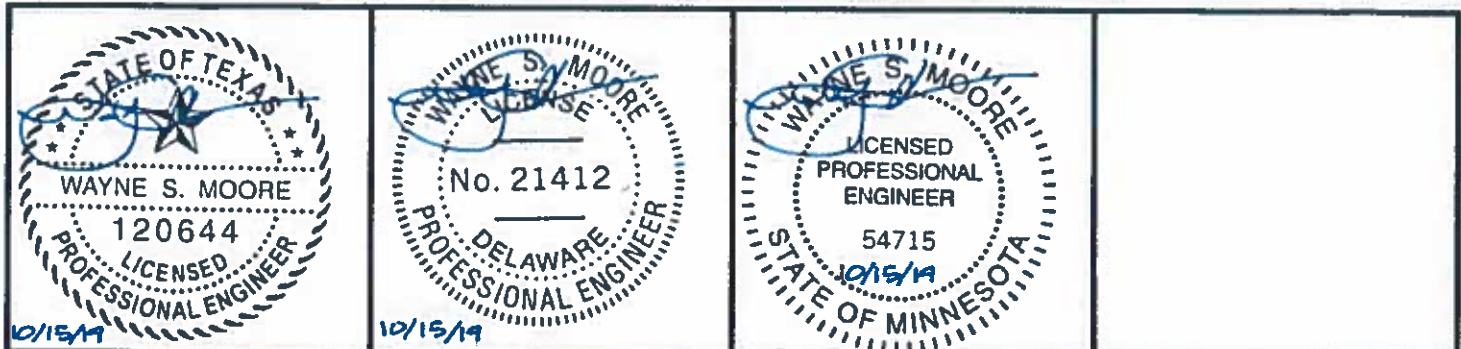

I hereby certify that this plan, specification, or report was prepared by me or under my direct supervision and that I am a duly Licensed Professional Engineer under the laws of the state of Minnesota.
 Signature:
 Typed or Printed Name: WAYNE S. MOORE
 Date: 10/15/19 License Number: 54715



I HAVE RESEARCHED THIS CHAPTER AND THE LOUISIANA STATE UNIFORM CONSTRUCTION CODE AND TO THE BEST OF MY KNOWLEDGE AND BELIEF, THESE DRAWINGS ARE IN COMPLIANCE THEREWITH. I TAKE FULL RESPONSIBILITY FOR THE CONTENTS OF THESE PLANS.



Professional Certification
 I hereby certify that these documents were prepared or approved by me, and that I am a duly licensed professional engineer under the laws of the State of Maryland, License No. 49744, Expiration Date 6/6/20

Released for Permit
 03/08/2021 10:48:23 AM

CONSTRUCTION

MOORE AND ASSOCIATES ENGINEERING AND CONSULTING, INC.		DRAWN BY: AST		COAST TO COAST CARPORTS, INC. 22525 I-40 KNOXVILLE, ARKANSAS 72845 30'-0"x20'-0" FULLY OPEN STRUCTURE	
		CHECKED BY: PDB			
THIS DOCUMENT IS THE PROPERTY OF MOORE AND ASSOCIATES ENGINEERING AND CONSULTING. THE UNAUTHORIZED REPRODUCTION, COPYING, OR OTHERWISE USE OF THIS DOCUMENT IS STRICTLY PROHIBITED AND ANY INFRINGEMENT THEREUPON MAY BE SUBJECT TO LEGAL ACTION.		PROJECT MGR: VSH	DATE: 10-15-19	SCALE: NTS	JOB NO: 173355/171495/ 182853/192145/193025
		CLIENT: COAST TO COAST	SHT. 2A	DWG. NO: SK-1	REV. 4

DRAWING INDEX

SHEET 1	PE SEAL COVER SHEET (1 OF 2)
SHEET 1A	PE SEAL COVER SHEET (2 OF 2)
SHEET 2	DRAWING INDEX
SHEET 3	INSTALLATION NOTES AND SPECIFICATIONS
SHEET 4	TYPICAL SIDE AND END ELEVATIONS
SHEET 5	TYPICAL RAFTER/COLUMN END AND SIDE FRAMING SECTIONS (BOX EAVE RAFTER) EXPOSURE B
SHEET 5A	TYPICAL RAFTER/COLUMN END AND SIDE FRAMING SECTION (BOX EAVE RAFTER) EXPOSURE B
SHEET 5B	TYPICAL RAFTER/COLUMN END AND SIDE FRAMING SECTION (BOX EAVE RAFTER) EXPOSURE B
SHEET 5C	TYPICAL RAFTER/COLUMN END AND SIDE FRAMING SECTION (BOX EAVE RAFTER) EXPOSURE C
SHEET 5D	TYPICAL RAFTER/COLUMN END AND SIDE FRAMING SECTION (BOX EAVE RAFTER) EXPOSURE C
SHEET 5E	TYPICAL RAFTER/COLUMN END AND SIDE FRAMING SECTION (BOX EAVE RAFTER) EXPOSURE C
SHEET 6	RAFTER/COLUMN CONNECTION DETAILS (BOX EAVE RAFTER) EXPOSURE B
SHEET 6A	RAFTER/COLUMN CONNECTION DETAILS (BOX EAVE RAFTER) EXPOSURE B
SHEET 6B	RAFTER/COLUMN CONNECTION DETAILS (BOX EAVE RAFTER) EXPOSURE B
SHEET 6C	RAFTER/COLUMN CONNECTION DETAILS (BOX EAVE RAFTER) EXPOSURE C
SHEET 6D	RAFTER/COLUMN CONNECTION DETAILS (BOX EAVE RAFTER) EXPOSURE C
SHEET 6E	RAFTER/COLUMN CONNECTION DETAILS (BOX EAVE RAFTER) EXPOSURE C
SHEET 7	TYPICAL RAFTER/COLUMN END AND SIDE FRAMING SECTION (BOW RAFTER) EXPOSURE B
SHEET 7A	TYPICAL RAFTER/COLUMN END AND SIDE FRAMING SECTION (BOW RAFTER) EXPOSURE B
SHEET 7B	TYPICAL RAFTER/COLUMN END AND SIDE FRAMING SECTION (BOW RAFTER) EXPOSURE B
SHEET 7C	TYPICAL RAFTER/COLUMN END FRAMING SECTION (BOW RAFTER) EXPOSURE C
SHEET 8	RAFTER/COLUMN CONNECTION DETAILS (BOW RAFTER) EXPOSURE B
SHEET 8A	RAFTER/COLUMN CONNECTION DETAILS (BOW RAFTER) EXPOSURE C
SHEET 9	OPTIONAL BASE RAIL ANCHORAGE
SHEET 10	CONNECTION DETAILS
SHEET 11	BOX EAVE RAFTER GABLE END OPTION
SHEET 12	BOW RAFTER GABLE END OPTION
SHEET 13	BOX EAVE RAFTER EXTRA SIDE PANEL OPTION
SHEET 14	BOW RAFTER EXTRA SIDE PANEL OPTION
SHEET 15	LEAN-TO OPTIONS (BOX EAVE RAFTER)
SHEET 16	LEAN-TO OPTIONS (BOW RAFTER)
SHEET 17	VERTICAL ROOF/SIDING OPTION

Released for Permit
03/08/2017 10:48:20 AM



CONSTRUCTION

MOORE AND ASSOCIATES ENGINEERING AND CONSULTING, INC.	DRAWN BY: AST	COAST TO COAST CARPORTS, INC. 22525 I-40 KNOXVILLE, ARKANSAS 72845 30'-0" x 20'-0" FULLY OPEN STRUCTURE		
	CHECKED BY: PJH	PROJECT MGR: VSM	DATE: 10-15-19	SCALE: NTS
THIS DOCUMENT IS THE PROPERTY OF MOORE AND ASSOCIATES ENGINEERING AND CONSULTING. THE UNAUTHORIZED REPRODUCTION, COPYING, OR OTHERWISE USE OF THIS DOCUMENT IS STRICTLY PROHIBITED AND ANY INFRINGEMENT THEREUPON MAY BE SUBJECT TO LEGAL ACTION.	CLIENT: COAST TO COAST	SHT. 2	DWG. NO: SK-1	JOB NO: 17335S/17149S/ 18265S/19214S/19302S REV: 4

INSTALLATION NOTES AND SPECIFICATIONS

- 1 DESIGN IS FOR MAXIMUM 30'-0" WIDE x 20'-0" EAVE HEIGHT OPEN CARPORT STRUCTURES.
- 2 DESIGN WAS DONE IN ACCORDANCE WITH THE 2018 NORTH CAROLINA BUILDING CODE, 2006 INTERNATIONAL BUILDING CODE (IBC), 2009 IBC, 2012 IBC, 2015 IBC AND 2018 IBC.
- 3 DESIGN LOADS ARE AS FOLLOWS:
 - A) DEAD LOAD = 1.5 PSF
 - B) LIVE LOAD = 12 PSF
 - C) GROUND SNOW LOAD = 30 PSF (≤ 24'-0") WITH U-CHANNEL RAFTER TIE
 = 35 PSF (≤ 30'-0") WITH WELDED RAFTER TIE
 = 65 PSF (≤ 30'-0") WITH WELDED RAFTER TIE @ 4'-0" O.C. SPACING, USING TS 2 1/4"x2 1/4"-12 GA.
- 4 UNBALANCED SNOW LOADS DUE TO DRIFTING HAS NOT BEEN ANALYZED.
- 5 LOW ULTIMATE WIND SPEED (LW) 105 TO 140 MPH (NOMINAL WIND SPEED 81 TO 109 MPH) MAXIMUM RAFTER/POST AND END POST SPACING = 50 FEET
- 6 END WALL POSTS ARE EQUIVALENT TO SIDE WALL POSTS UNLESS NOTED OTHERWISE.
- 7 HAZARD RISK CATEGORY I.
- 8 WIND EXPOSURE CATEGORY B OR C.
- 9 SPECIFICATIONS APPLICABLE TO 29 GAUGE METAL PANELS FASTENED DIRECTLY TO 2 1/2"x2 1/2"-14 GAUGE TUBE STEEL (TS) FRAMING MEMBERS (UNLESS NOTED OTHERWISE)
- 10 AVERAGE FASTENER SPACING ON-CENTERS ALONG RAFTERS OR HAT CHANNELS, AND COLUMNS (INTERIOR OR END) = 8" O.C. (MAX.) LW.
- 11 FASTENERS CONSIST OF #12-14x3/4" SELF-DRILLING FASTENER (SDF). USE CONTROL SEAL WASHER WITH EXTERIOR FASTENERS. SPECIFICATIONS APPLICABLE ONLY FOR MEAN ROOF HEIGHT OF 20 FEET OR LESS, AND ROOF SLOPES OF 14" (3:12 PITCH) OR LESS SPACING REQUIREMENTS FOR OTHER ROOF HEIGHTS AND/OR SLOPES MAY VARY.
- 12 ANCHORS SHALL BE INSTALLED THROUGH BASE RAIL WITHIN 6' OF EACH RAFTER COLUMN ALONG SIDES.
- 13 STANDARD GROUND ANCHORS (SOIL NAILS) CONSIST OF #4 REBAR W/ WELDED NUT x 30' LONG AND MAY BE USED IN SUITABLE SOIL CONDITIONS. OPTIONAL ANCHORAGE MAY BE USED IN SUITABLE SOILS AND MUST BE USED IN UNSUITABLE SOILS AS NOTED.
- 14 WIND FORCES GOVERN OVER SEISMIC FORCES. SEISMIC PARAMETERS ANALYZED ARE:
 SOIL SITE CLASS = D
 RISK CATEGORY I/II/III
 R = 3.25 I_e = 1.0
 S_{DS} = 2039 g V = C_sW
 S_{D1} = 1258 g

Released for Permit
03/08/2024 10:48:15 AM



CONSTRUCTION

**MOORE AND ASSOCIATES
ENGINEERING AND CONSULTING, INC.**

DRAWN BY: AST

CHECKED BY: PZH

PROJECT MGR: WSH

CLIENT: COAST TO COAST

COAST TO COAST CARPORTS, INC.
22525 I-40
KNOXVILLE, ARKANSAS 72845
30'-0"x20'-0" FULLY OPEN STRUCTURE

DATE: 10-15-19

SCALE: NTS

**JOB NO: 17335S/17149S/
18265S/19214S/19302S**

SHT. 3

DWG. NO: SK-1

REV: 4

THIS DOCUMENT IS THE PROPERTY OF MOORE AND ASSOCIATES ENGINEERING AND CONSULTING. THE UNAUTHORIZED REPRODUCTION, COPYING, OR OTHERWISE USE OF THIS DOCUMENT IS STRICTLY PROHIBITED AND ANY INFRINGEMENT THEREUPON MAY BE SUBJECT TO LEGAL ACTION.

BOX EAVE FRAME RAFTER STRUCTURE (Sheets 5, 5A, 5B, 5C, 5D, 5E, 6, 6A, 6B, 6C, 6D, 6E, 9, 10, 11, 13, 15 AND 17)

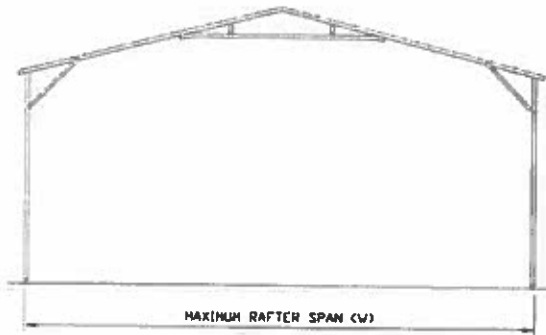

TYPICAL END ELEVATION
SCALE: NTS

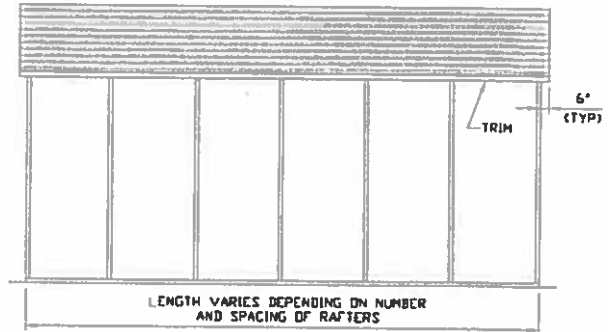

TYPICAL SIDE ELEVATION
SCALE: NTS

BDW FRAME RAFTER STRUCTURE (Sheets 7, 7A, 7B, 7C, 8, 8A, 9, 10, 12, 14, AND 16)

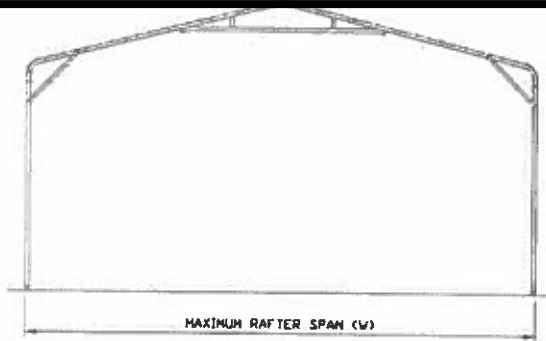

TYPICAL END ELEVATION
SCALE: NTS

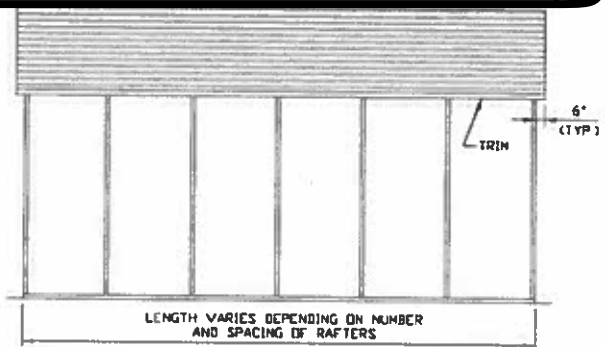

TYPICAL SIDE ELEVATION
SCALE: NTS

Released for Permit
03/08/2024 10:47:52 AM



**MOORE AND ASSOCIATES
ENGINEERING AND CONSULTING, INC.**

DRAWN BY: AST

CHECKED BY: PDH

PROJECT MGR: VSH

CLIENT: COAST TO COAST

COAST TO COAST CARPORTS, INC.
22525 I-40
KNOXVILLE, ARKANSAS 72845
30'-0" x 20'-0" FULLY OPEN STRUCTURE

DATE: 10-15-19

SCALE: NTS

DWG. NO SK-1

JOB NO: 17335S/17149S/
18283S/19214S/19302S

REV: 4

THIS DOCUMENT IS THE PROPERTY OF MOORE AND ASSOCIATES ENGINEERING AND CONSULTING. THE UNAUTHORIZED REPRODUCTION, COPYING, OR OTHERWISE USE OF THIS DOCUMENT IS STRICTLY PROHIBITED AND ANY INFRINGEMENT THEREUPON MAY BE SUBJECT TO LEGAL ACTION.

EXPOSURE C

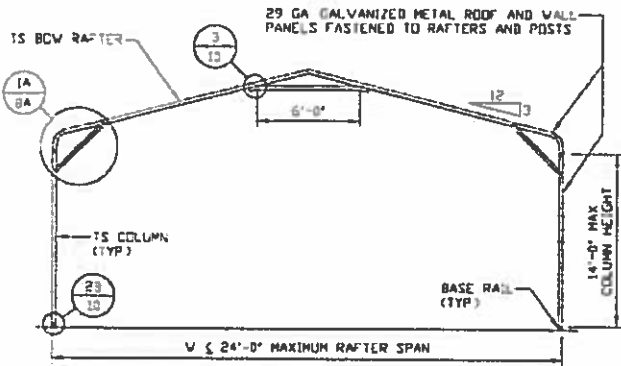

TYPICAL RAFTER/COLUMN END FRAME SECTION

SCALE: NTS

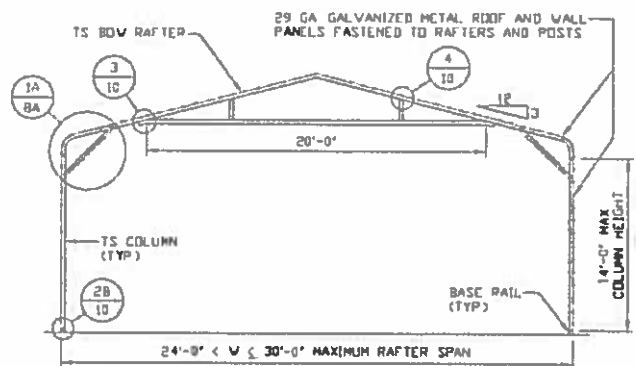

TYPICAL RAFTER/COLUMN END FRAME SECTION

SCALE: NTS

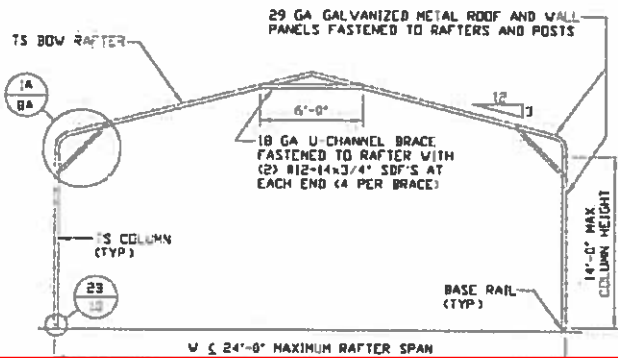

TYPICAL RAFTER/COLUMN END FRAME SECTION

SCALE: NTS

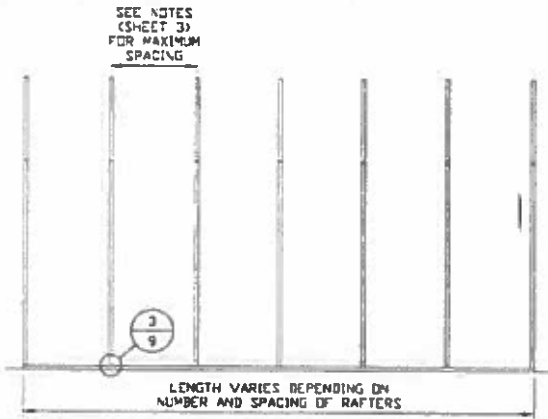

TYPICAL RAFTER/COLUMN SIDE FRAMING SECTION

SCALE: NTS

Released for Permit
03/08/2019 10:47:47 AM
Pikes Peak
REGIONAL
Building Department
DENVER
CONSTRUCTION

**MOORE AND ASSOCIATES
ENGINEERING AND CONSULTING, INC.**

DRAWN BY: AST

CHECKED BY: PJM

PROJECT NO: VSM

CLIENT: COAST TO COAST

COAST TO COAST CARPORTS, INC.
22525 I-40
KNOXVILLE, ARKANSAS 72845
30'-0"x20'-0" FULLY OPEN STRUCTURE

DATE: 10-15-19

SCALE: NTS

DWG. NO: SK-1

JOB NO: 173333/171495/
182833/192143/193025

REV: 4

THIS DOCUMENT IS THE PROPERTY OF MOORE AND ASSOCIATES ENGINEERING AND CONSULTING. THE UNAUTHORIZED REPRODUCTION, COPYING, OR OTHERWISE USE OF THIS DOCUMENT IS STRICTLY PROHIBITED AND ANY INFRINGEMENT THEREUPON MAY BE SUBJECT TO LEGAL ACTION.

EXPOSURE C

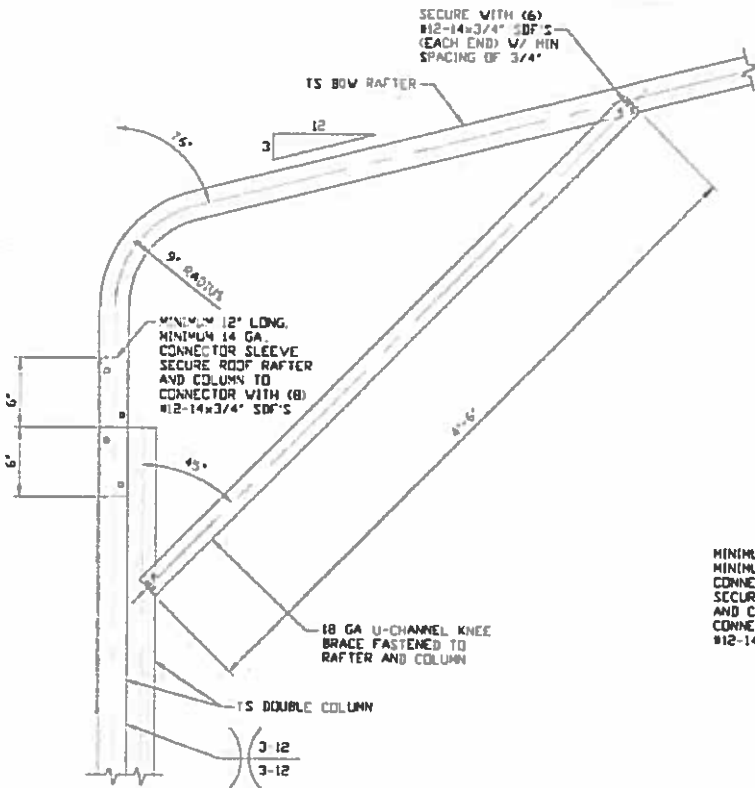

1
BOX EAVE RAFTER COLUMN CONNECTION DETAIL FOR HEIGHTS 14'-0" < TO <= 16'-0"
 SCALE: NTS

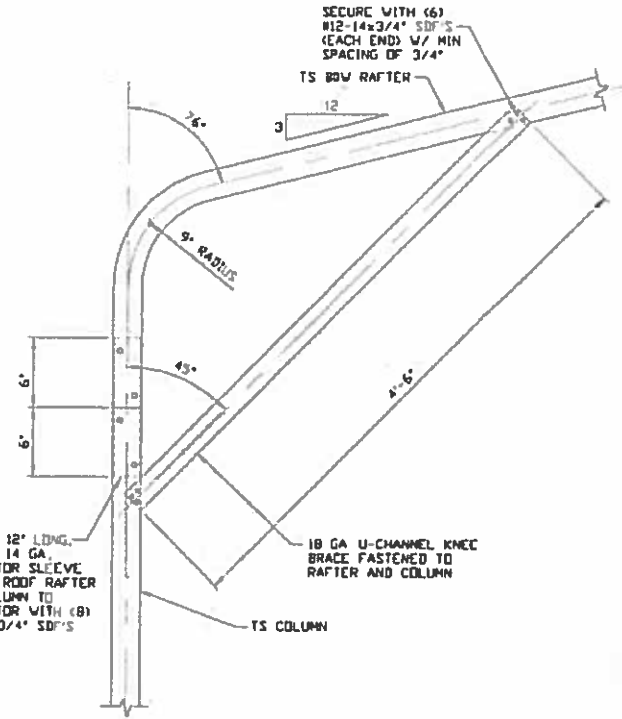

1A
BOX EAVE RAFTER COLUMN CONNECTION DETAIL FOR HEIGHTS 12'-0" < TO <= 14'-0"
 SCALE: NTS

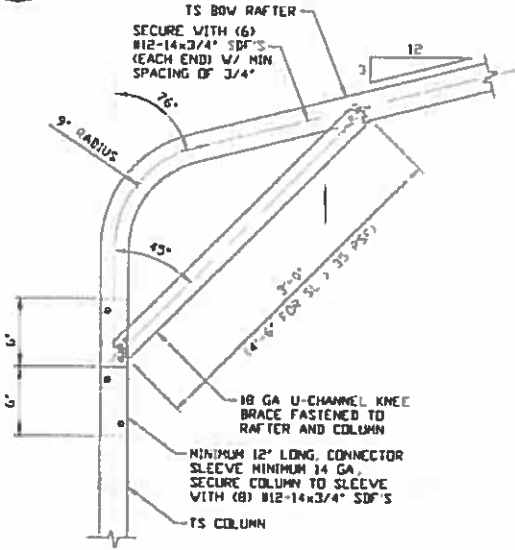

1B
BOX EAVE RAFTER COLUMN CONNECTION DETAIL FOR HEIGHTS <= 12'-0"
 SCALE: NTS

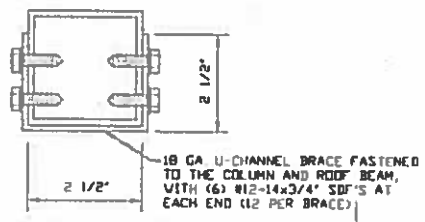

BRACE SECTION
 SCALE: NTS

Released for Permit
 03/08/2014 10:47:44 AM
 Pikes Peak REGIONAL Building Department
 CONSTRUCTION

MOORE AND ASSOCIATES ENGINEERING AND CONSULTING, INC.

DRAWN BY: AST
 CHECKED BY: PMH

COAST TO COAST CARPORTS, INC.
 22525 I-40
 KNOXVILLE, ARKANSAS 72845
 30'-0" x 20'-0" FULLY OPEN STRUCTURE

THIS DOCUMENT IS THE PROPERTY OF MOORE AND ASSOCIATES ENGINEERING AND CONSULTING. THE UNAUTHORIZED REPRODUCTION, COPYING, OR OTHERWISE USE OF THIS DOCUMENT IS STRICTLY PROHIBITED AND ANY INFRINGEMENT THEREUPON MAY BE SUBJECT TO LEGAL ACTION.

PROJECT: MGR VSM
 DATE: 10-15-19
 SCALE: NTS
 CLIENT: COAST TO COAST
 SHT. 0A
 JOB NO: 17335S/17149S/18283S/19214S/19302S
 DVG. NO: SK-1
 REV: 4

OPTIONAL BASE RAIL ANCHORAGE

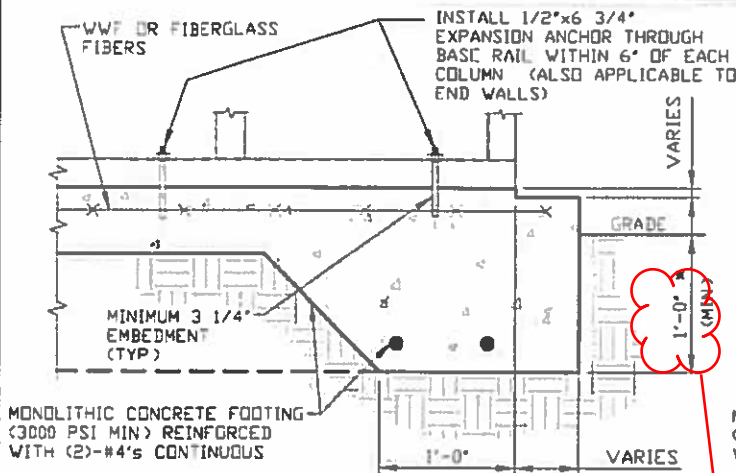

3A CONCRETE MONOLITHIC SLAB BASE RAIL ANCHORAGE
 SCALE: NTS
 (MINIMUM ANCHOR EDGE DISTANCE IS 4")
 ■ COORDINATE WITH LOCAL CODES/ORD

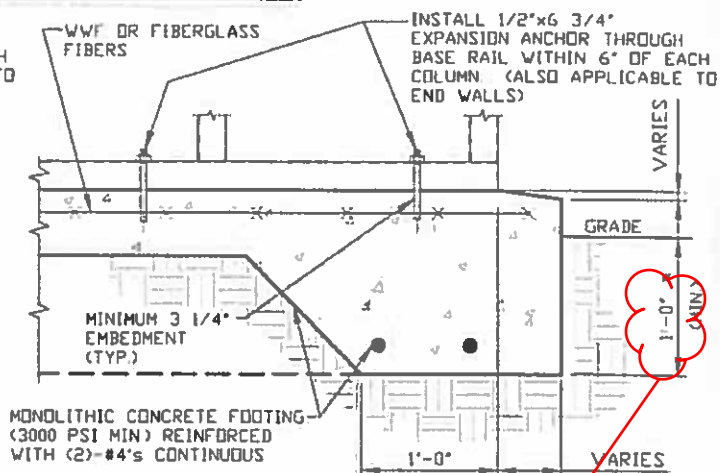

3B CONCRETE MONOLITHIC SLAB BASE RAIL ANCHORAGE
 SCALE: NTS
 (MINIMUM ANCHOR EDGE DISTANCE IS 4")
 ■ COORDINATE WITH LOCAL CODES/ORD

GENERAL NOTES

NOTE CONCRETE MONOLITHIC SLAB DESIGN BASED ON MINIMUM SOIL BEARING CAPACITY OF 1,500 PSF

CONCRETE:

CONCRETE SHALL HAVE A MINIMUM SPECIFIED COMPRESSIVE STRENGTH OF 3,000 PSI AT 28 DAYS

COVER OVER REINFORCING STEEL:

FOR FOUNDATIONS, MINIMUM CONCRETE COVER OVER REINFORCING BARS SHALL BE PER ACI-318:

3" IN FOUNDATIONS WHERE THE CONCRETE IS CAST AGAINST AND PERMANENTLY IN CONTACT WITH THE EARTH OR EXPOSED TO THE EARTH OR WEATHER, AND 1 1/2" ELSEWHERE

REINFORCING STEEL:

THE TURNDOWN REINFORCING STEEL SHALL BE ASTM A615 GRADE 60 THE SLAB REINFORCEMENT SHALL BE WELDED WIRE FABRIC MEETING ASTM A185 OR FIBERGLASS FIBER REINFORCEMENT

REINFORCEMENT MAY BE BENT IN THE SHOP OR THE FIELD PROVIDED:

- 1 REINFORCEMENT IS BENT COLD
- 2 THE DIAMETER OF THE BEND, MEASURED ON THE INSIDE OF THE BAR, IS NOT LESS THAN SIX-BAR DIAMETERS.
- 3 REINFORCEMENT PARTIALLY EMBEDDED IN CONCRETE SHALL NOT BE FIELD BENT

HELIX ANCHOR NOTES:

- 1 FOR VERY DENSE AND/OR CEMENTED SANDS, COARSE GRAVEL AND COBBLES, CALICHE, PRELOADED SILTS AND CLAYS, USE MINIMUM (2) 4" HELICES WITH MINIMUM 30" EMBEDMENT OR SINGLE 6" HELIX WITH MINIMUM 50" EMBEDMENT
- 2 FOR CORAL USE MINIMUM (2) 4" HELICES WITH MINIMUM 30" EMBEDMENT OR SINGLE 6" HELIX WITH MINIMUM 50" EMBEDMENT
- 3 FOR MEDIUM DENSE COARSE SANDS, SANDY GRAVELS, VERY STIFF SILTS, AND CLAYS USE MINIMUM (2) 4" HELICES WITH MINIMUM 30 INCH EMBEDMENT OR SINGLE 6" HELIX WITH MINIMUM 30" EMBEDMENT
- 4 FOR LOOSE TO MEDIUM DENSE SANDS, FIRM TO STIFF CLAYS AND SILTS ALLUVIAL FILL, USE MINIMUM (2) 6" HELICES WITH MINIMUM 50" EMBEDMENT
- 5 FOR VERY LOSE TO MEDIUM DENSE SANDS, FIRM TO STIFFER CLAYS AND SILTS, ALLUVIAL FILL, USE MINIMUM (2) 8" HELICES WITH MINIMUM 60" EMBEDMENT.

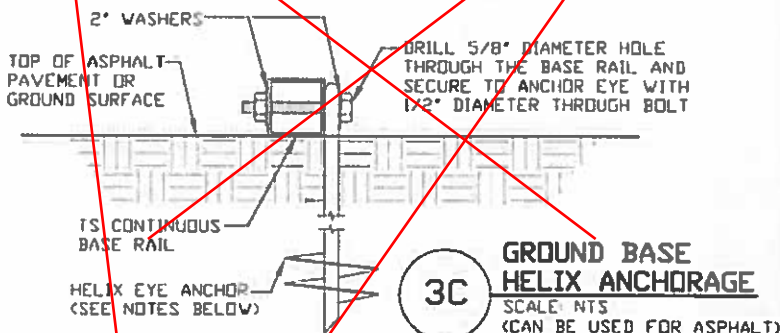

3C GROUND BASE HELIX ANCHORAGE
 SCALE: NTS
 (CAN BE USED FOR ASPHALT)

Minimum depth 30" below grade.

Released for Permit
 03/08/2024 4:47:40 AM



MOORE AND ASSOCIATES ENGINEERING AND CONSULTING, INC.

DRAWN BY: AST
CHECKED BY: PDM
PROJECT MGR: WSM
CLIENT: COAST TO COAST

COAST TO COAST CARPORTS, INC. 22525 I-40 KNOXVILLE, ARKANSAS 72845 30'-0" x 20'-0" FULLY OPEN STRUCTURE	
DATE: 10-15-19	JOB NO: 173355/171495/182835/192145/193025
SCALE: NTS	REV: 4
DWG. NO: SK-1	SHT. 9

THIS DOCUMENT IS THE PROPERTY OF MOORE AND ASSOCIATES ENGINEERING AND CONSULTING. THE UNAUTHORIZED REPRODUCTION, COPYING, OR OTHERWISE USE OF THIS DOCUMENT IS STRICTLY PROHIBITED AND ANY INFRINGEMENT THEREUPON MAY BE SUBJECT TO LEGAL ACTION.

CONNECTION DETAILS

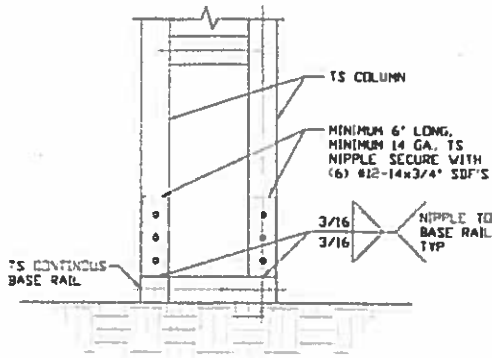

2 COLUMN/BASE RAIL CONNECTION DETAIL
SCALE: NTS

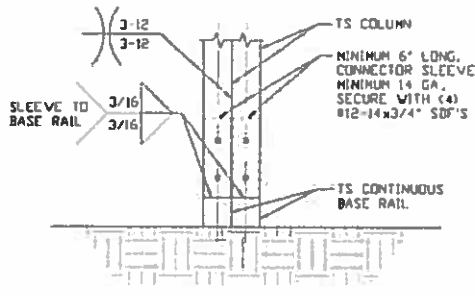

2A COLUMN/BASE RAIL CONNECTION DETAIL
SCALE: NTS

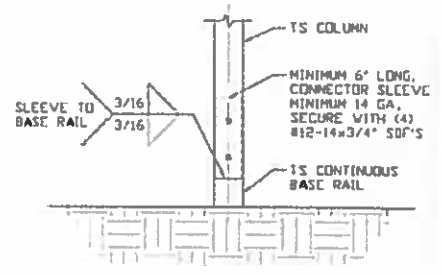

2B COLUMN/BASE RAIL CONNECTION DETAIL
SCALE: NTS

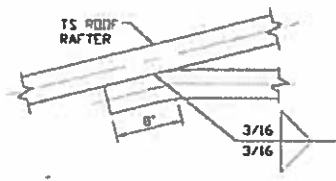

3 COLLAR TIE CONNECTION DETAIL
SCALE: NTS

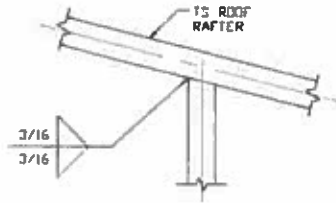

4 RAFTER TO CHORD CONNECTION DETAIL
SCALE: NTS

Released for Permit
03/08/2019 10:47:37 AM

CONSTRUCTION

MOORE AND ASSOCIATES ENGINEERING AND CONSULTING, INC.	DRAWN BY: AST	COAST TO COAST CARPORTS, INC. 22525 I-40 KNOXVILLE, ARKANSAS 72845 30'-0" x 20'-0" FULLY OPEN STRUCTURE		
	CHECKED BY: PDH	PROJECT MGR: VSM	DATE: 10-15-19	SCALE: NTS
THIS DOCUMENT IS THE PROPERTY OF MOORE AND ASSOCIATES ENGINEERING AND CONSULTING. THE UNAUTHORIZED REPRODUCTION, COPYING, OR OTHERWISE USE OF THIS DOCUMENT IS STRICTLY PROHIBITED AND ANY INFRINGEMENT THEREUPON MAY BE SUBJECT TO LEGAL ACTION.	CLIENT: COAST TO COAST	SHT. 10	DWG. NO. SK-1	JOB NO. 173335/171495/ 182855/19E145/193025 REV: 4

BOW RAFTER EXTRA SIDE PANEL OPTION

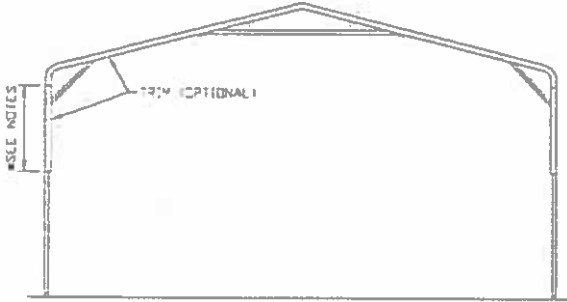

**TYPICAL END ELEVATION
EXTRA SIDE PANELS**

SCALE: NTS

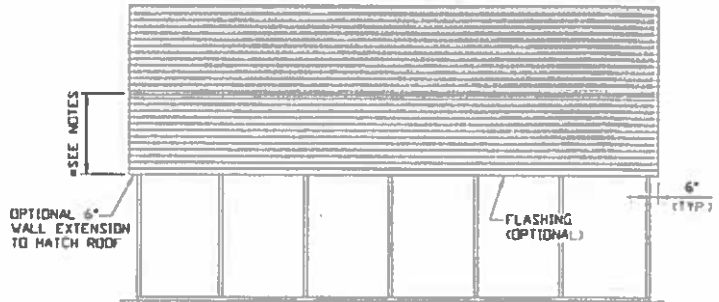

**TYPICAL END ELEVATION
EXTRA SIDE PANELS**

SCALE: NTS

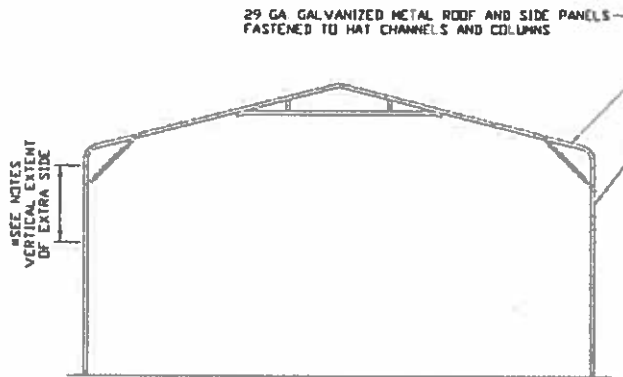

TYPICAL RAFTER/COLUMN FRAME SECTION - EXTRA SIDE PANELS

SCALE: NTS

NOTES: (EXPOSURE B)

- 15'-0" MAXIMUM (FOR EAVE HEIGHT ≤ 20'-0")
- 12'-0" MAXIMUM (FOR EAVE HEIGHT ≤ 16'-0")
- 3'-0" MAXIMUM (FOR EAVE HEIGHT ≤ 14'-0")

(EXPOSURE C)

- 15'-0" MAXIMUM (FOR EAVE HEIGHT ≤ 20'-0")
- 5'-0" MAXIMUM (FOR EAVE HEIGHT ≤ 16'-0")
- NO SIDING (FOR EAVE HEIGHT ≤ 14'-0")

Released for Permit

03/08/2019 10:47:32 AM



MOORE AND ASSOCIATES ENGINEERING AND CONSULTING, INC.	DRAWN BY: AST	COAST TO COAST CARPORTS, INC. 22525 I-40 KNOXVILLE, ARKANSAS 72845 30'-0"x20'-0" FULLY OPEN STRUCTURE		
	CHECKED BY: PBH	PROJECT MGR: WSM	DATE: 10-15-19	SCALE: NTS
THIS DOCUMENT IS THE PROPERTY OF MOORE AND ASSOCIATES ENGINEERING AND CONSULTING. THE UNAUTHORIZED REPRODUCTION, COPYING, OR OTHERWISE USE OF THIS DOCUMENT IS STRICTLY PROHIBITED AND ANY INFRINGEMENT THEREUPON MAY BE SUBJECT TO LEGAL ACTION.	CLIENT: COAST TO COAST	SHT. 14	DWG. NO: SK-1	REV. 4