

GENERAL NOTES

1. PROJECT DESCRIPTION: PROPOSED 800 S.F. STORAGE BUILDING ON LOT WITH EXISTING LIQUOR STORE
2. SEE ELEVATIONS FOR NEW WINDOW + DR. HD. HTS. ALL WINDOWS AND DOORS TO BE CENTERED IN ROOM UNO.
3. ALL SUB-CONTRACTORS SHALL CONFIRM THE LOCATION OF ALL EXIST. UTILITIES AND CO-ORDINATE THE INSTALLATION OF ALL NEW UTILITIES AND METER LOCATIONS WITH THE UTILITY COMPANY OR GOVERNMENT AUTHORITY HAVING JURISDICTION OVER THE PROJECT.
4. INSTALL MOISTURE RESISTANT GYP. BD. AT ALL WALLS IN ROOMS WITH HIGH MOISTURE CONDITIONS
5. THE SUBCONTRACTORS SHALL COORDINATE ALL FINISHES, MATERIALS AND COLORS WITH THE OWNER.
6. VERIFY ALL DOOR / CABINET/ CASEWORK HARDWARE AND LOCK LOCATIONS W/ OWNER, TYP.

TYPICAL ROOF PLAN SHEET NOTES

ALL ROOFING SHALL BE INSTALLED TO FORM A WEATHERTIGHT ASSEMBLY. PROVIDE ALL FLASHING, TRIM, ACCESSORIES, ETC. PER MANUFACTURERS SPECIFICATIONS & APPLICABLE CODES.

SIZE AND QUANTITY OF DOWNSPOUTS/SCUPPERS PER IPC CODE & PLUMBING DRAWINGS

FLASHING SHALL BE INSTALLED IN SUCH A MANNER SO AS TO PREVENT MOISTURE ENTERING THE WALL AND ROOF THROUGH JOINTS IN COPINGS, THROUGH MOISTURE PERMEABLE MATERIALS AND AT INTERSECTIONS WITH PARAPET WALLS AND OTHER PENETRATIONS THROUGH THE ROOF PLANE, TYP.

ROOF DRAINAGE SHALL COMPLY WITH SECTION 1503 AND IPC.

CRICKETS/SADDLES SHALL BE INSTALLED ON THE RIDGE SIDE OF ALL PENETRATIONS GREATER THAN 30 INCHES WIDE PER 09 IBC, SECT. 1503.6

BASE & CAP FLASHING SHALL BE INSTALLED PER MFG. SPECS PER SECT. 1507.2.9.1

DRIP EDGE SHALL BE PROVIDED PER SECT. 1507.2.9.3

PROVIDE FLASHING PER MFG. SPECS & SECT. 1507.3.9

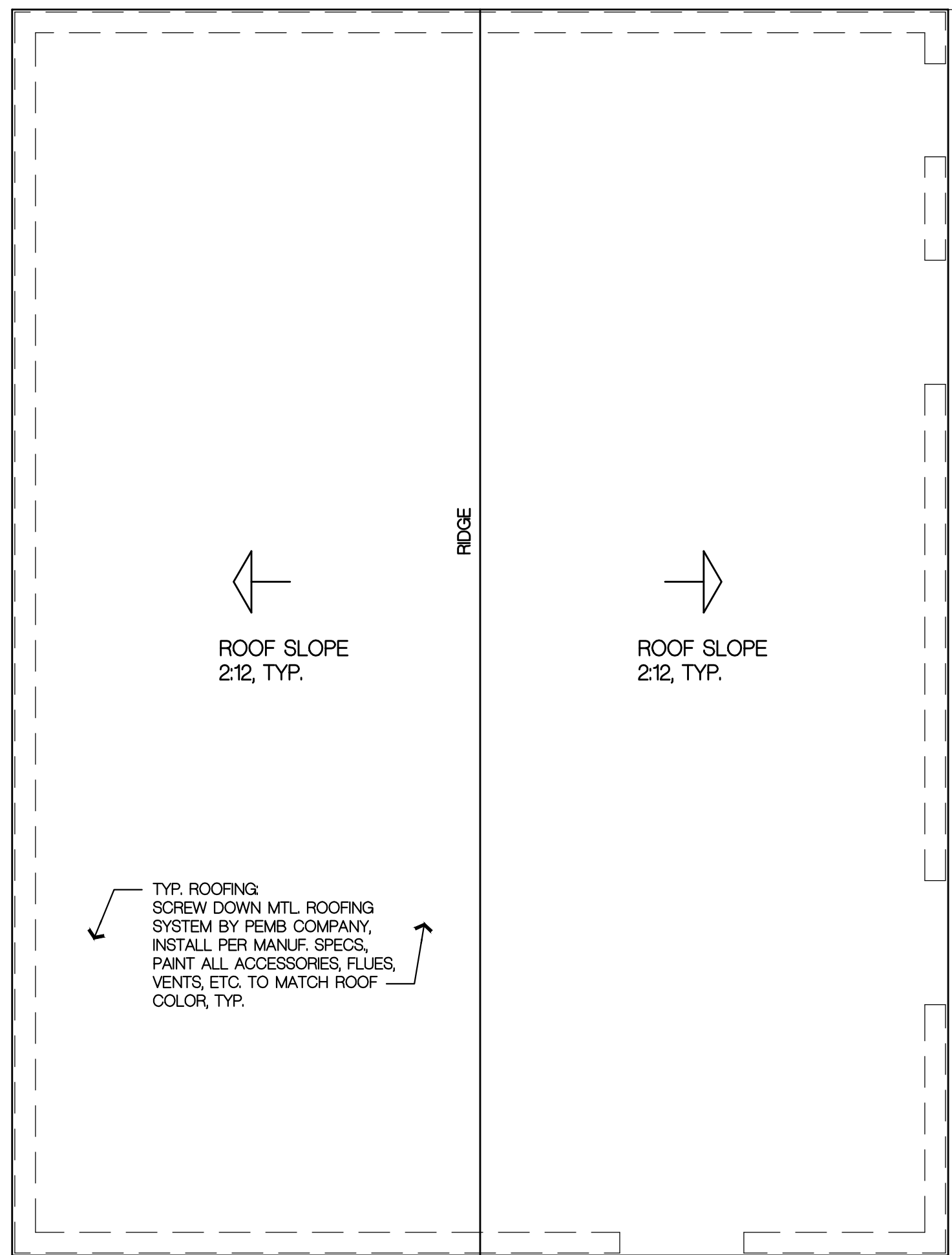
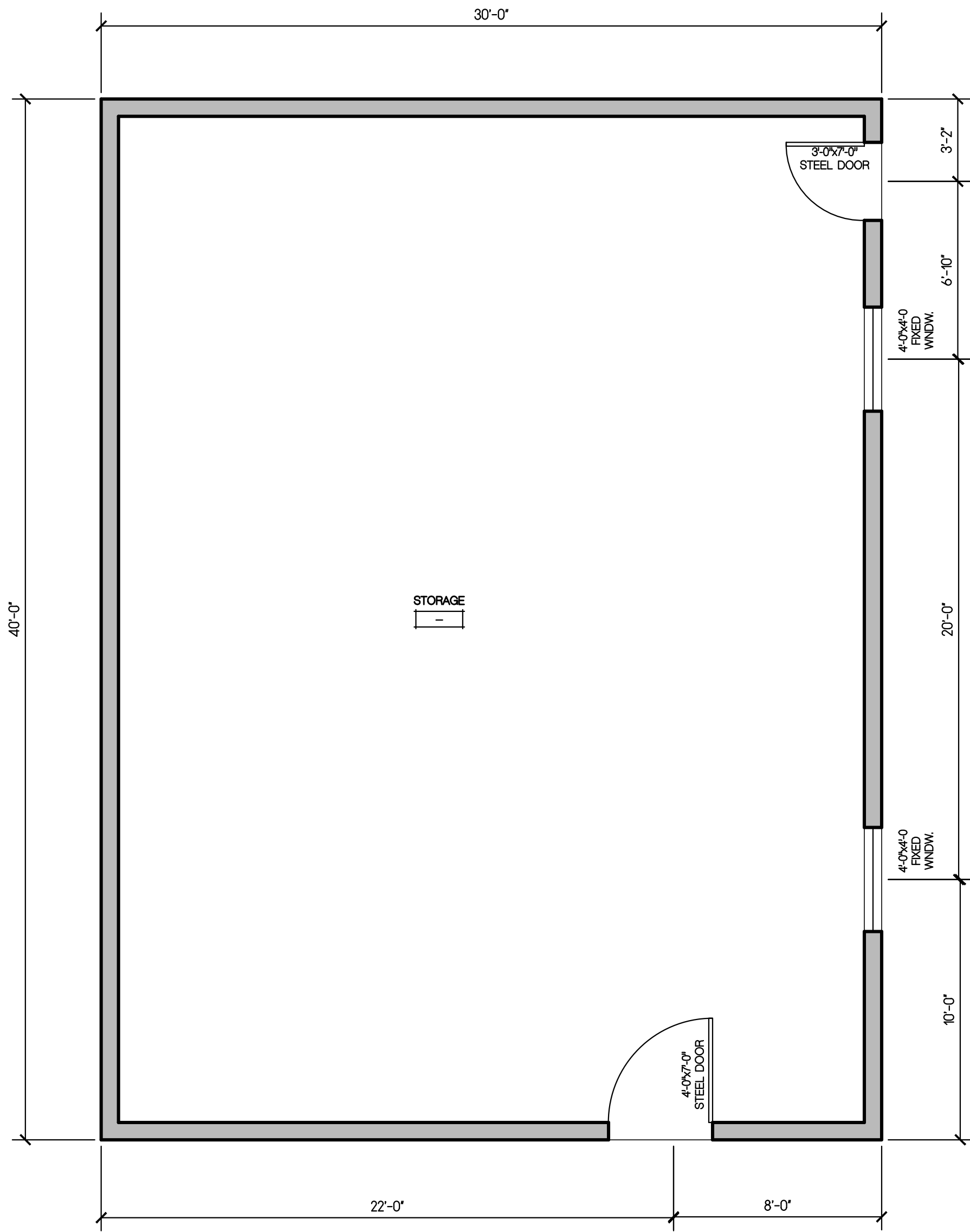

Copyright © 2021

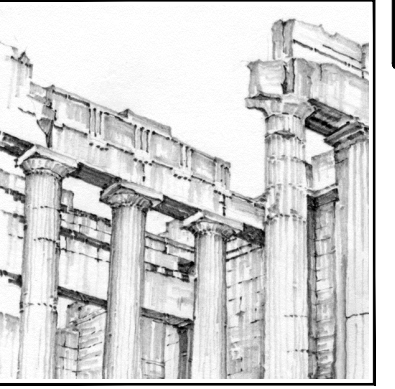

BUCHER
DESIGN STUDIO
architecture+planning

12325 Oracle Blvd, Suite 111
Colorado Springs, CO 80921
(719) 484-0480

Brian K. Bucher, AIA
Architect
CO license no. C-4889
CA license no. C 23506

**A PROPOSED
STORAGE
BUILDING FOR**

**R & R
LIQUOR**

**1845 MAIN STREET
COLORADO SPRINGS, CO**

Sheet Title:
**PROPOSED
FLOOR &
ROOF PLANS**

Drawing Status:
CD SET

Revisions:

No.	Description	By	Date
1			

All ideas, designs, arrangements and plans indicated or represented by this drawing are owned by and the property of BUCHER DESIGN STUDIO and were created, evolved and developed for use on, and in conjunction with, the specified project. None of such ideas, designs, arrangements or plans shall be used by, or disclosed to any person, firm or corporation for any purpose whatsoever without the written permission of BUCHER DESIGN STUDIO.

Date:

1/14/21

Drawn by:

Checked by:

Scale:

AS NOTED

Job No.:

Sheet No.:

A1.1
Of