

C:\ACC\ACCDocs\Kimley-Horn\196013001 WHMD Expansion Study\Project Files\DWG\PlanSheets\Stormwater Improvements\Plansheets\Construction Documents\CD_EX.dwg Olesen, Maria (Langer) 6/22/2026 5:30 PM



LEGEND

	PROPERTY LINE
	EXISTING LOT LINE
	EXISTING EASEMENT LINE
	EXISTING SITE FENCE
	EXISTING WATER MAIN
	EXISTING SANITARY SEWER MAIN
	EXISTING GAS LINE
	EXISTING ELECTRIC LINE
	EXISTING STORM SEWER
	DEMO EXISTING UTILITY LINE
	DEMO EXISTING GRAVEL

- NOTES**
1. ALL EXISTING UTILITIES TO REMAIN AND BE PROTECTED IN PLACE UNLESS OTHERWISE NOTED.
 2. UTILITIES TO BE REMOVED ARE TO BE CAPPED IN PLACE IN ACCORDANCE WITH WOODMEN HILL METRO STANDARDS AND OVERSIGHT

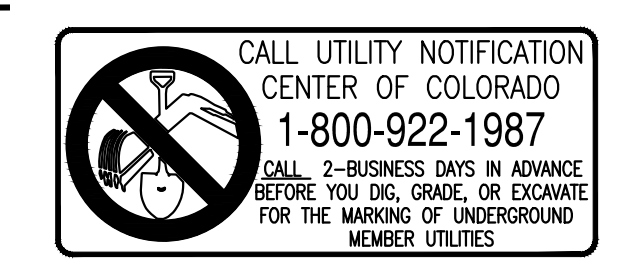
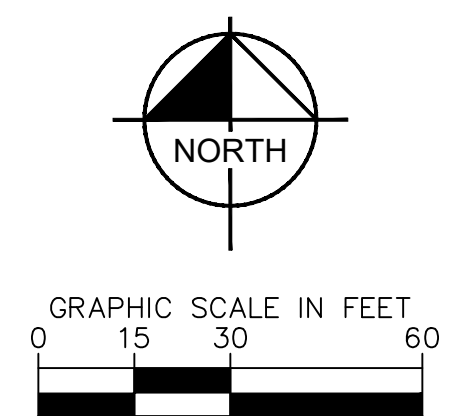

NO.	REVISION	BY	DATE	APPR

Kimley»Horn
 2026 KIMLEY-HORN AND ASSOCIATES, INC.
 2 North Nevada Avenue, Suite 900
 Colorado Springs, Colorado 80903 (719) 453-0180

DESIGNED BY: MEO
 DRAWN BY: MEO
 CHECKED BY: KRK
 DATE: 6/22/26

WHMD RWRF STORM IMPROVEMENTS
 EL PASO COUNTY, COLORADO
 CONSTRUCTION DOCUMENTS
EX. CONDITIONS & DEMO PLAN

PRELIMINARY
 FOR REVIEW ONLY
 NOT FOR
 CONSTRUCTION

 Kimley-Horn and Associates, Inc.

PROJECT NO.
196013004
 SHEET
C1.2

C:\ACC\ACCDocs\Kimley-Horn\196013001 WHMD Expansion Study\Project Files\DWG\PlanSheets\Stormwater Improvements\Plansheets\Construction Documents\CD_SP.dwg Olesen, Maria (Langer) 6/22/2026 5:30 PM

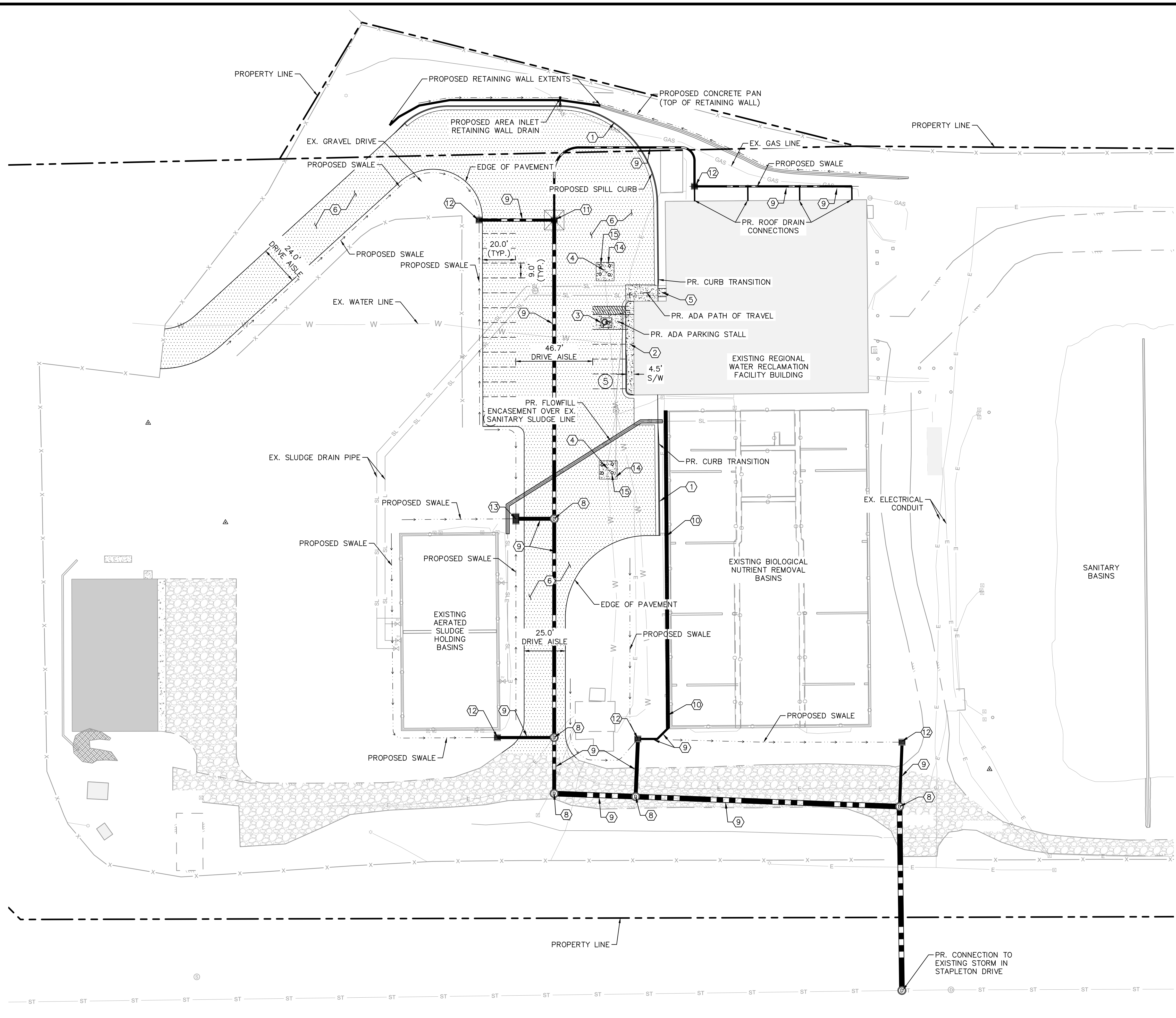

LEGEND

- PROPOSED SPILL CURB & GUTTER
- - - PROPOSED SWALE (REF. GRADING PLANS)
- PROPOSED MSE BLOCK RETAINING WALL
- - - PROPERTY LINE
- PROPOSED LANDSCAPING
- ▨ EXISTING CONCRETE SIDEWALK
- ▨ PROPOSED CONCRETE SIDEWALK
- ▨ PROPOSED CONCRETE PAD
- ▨ PROPOSED ASPHALT DRIVE AREA
- ▨ EXISTING GRAVEL DRIVE
- ▨ PROPOSED FLOWFILL ENCASEMENT

KEYNOTES:

- ① PROPOSED EPC TYPE A SPILL CURB AND GUTTER PER EL PASO COUNTY STANDARD DRAWING 2-20 (REF SHEET C1.12 FOR DETAIL)
- ② PROPOSED CONCRETE SIDEWALK PER COLORADO SPRINGS STANDARD DRAWING D-18, DIMENSIONED PER PLAN
- ③ PROPOSED ADA PARKING (REF. SHEET C1.13 FOR DETAIL)
- ④ EXISTING HYDRANT TO BE RESET TO FINISHED GRADE
- ⑤ PROPOSED TYPE 1 SIDEWALK CURB RAMP PER CITY OF COLORADO SPRINGS DRAWING D-8D (REF. SHEET C1.12 FOR DETAIL)
- ⑥ PROPOSED ASPHALT PAVEMENT
- ⑧ PROPOSED STORM SEWER MANHOLE
- ⑨ PROPOSED STORM SEWER PIPE
- ⑩ PROPOSED FRENCH DRAIN (REF. SHEET C1.13 FOR DETAIL)
- ⑪ PROPOSED CDOT TYPE C INLET WITH CONCRETE APRON (REF. SHEET C1.12 FOR DETAIL)
- ⑫ PROPOSED CDOT TYPE C AREA INLET (REF. SHEET C1.12 FOR DETAIL)
- ⑬ PROPOSED CDOT TYPE D AREA INLET (REF. SHEET C1.12 FOR DETAIL)
- ⑭ PROPOSED CONCRETE PAD.
- ⑮ PROPOSED RETAINING WALL (REF. GRADING PLAN FOR DETAILS)
- ⑯ PROPOSED BOLLARD

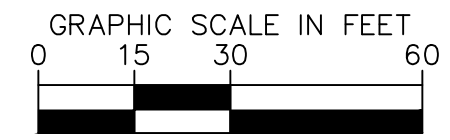
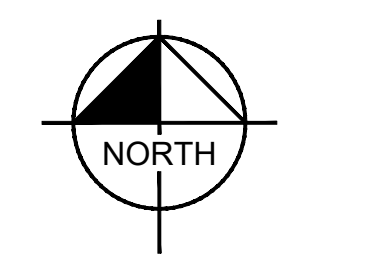

CALL UTILITY NOTIFICATION
CENTER OF COLORADO
1-800-922-1987
CALL 2-BUSINESS DAYS IN ADVANCE
BEFORE YOU DIG, SHOVE, OR EXCAVATE
FOR THE MARKING OF UNDERGROUND
MEMBER UTILITIES



NO.	REVISION	BY	DATE	APPR

Kimley-Horn
2026 KIMLEY-HORN AND ASSOCIATES, INC.
2 North Nevada Avenue, Suite 900
Colorado Springs, Colorado 80903 (719) 453-0180

DESIGNED BY: MEO
DRAWN BY: MEO
CHECKED BY: KRK
DATE: 6/22/26

WHMD RWRF STORM IMPROVEMENTS
EL PASO COUNTY, COLORADO
CONSTRUCTION DOCUMENTS
SITE PLAN

PRELIMINARY
FOR REVIEW ONLY
NOT FOR
CONSTRUCTION

PROJECT NO.
196013004

SHEET
C1.3

C:\ACC\ACCDocs\Kimley-Horn\196013001 WHMD Expansion Study\Project Files\DWG\PlanSheets\Stormwater Improvements\Plansheets\Construction Documents\CD_PV.dwg Olesen, Maria (Langer) 6/22/2026 5:30 PM

MERIDIAN RANCH GOLF COURSE LLC
MERIDIAN RANCH BLVD.
PID: 4230312027

MERIDIAN RANCH GOLF COURSE LLC
MERIDIAN RANCH BLVD.
PID: 4230312026

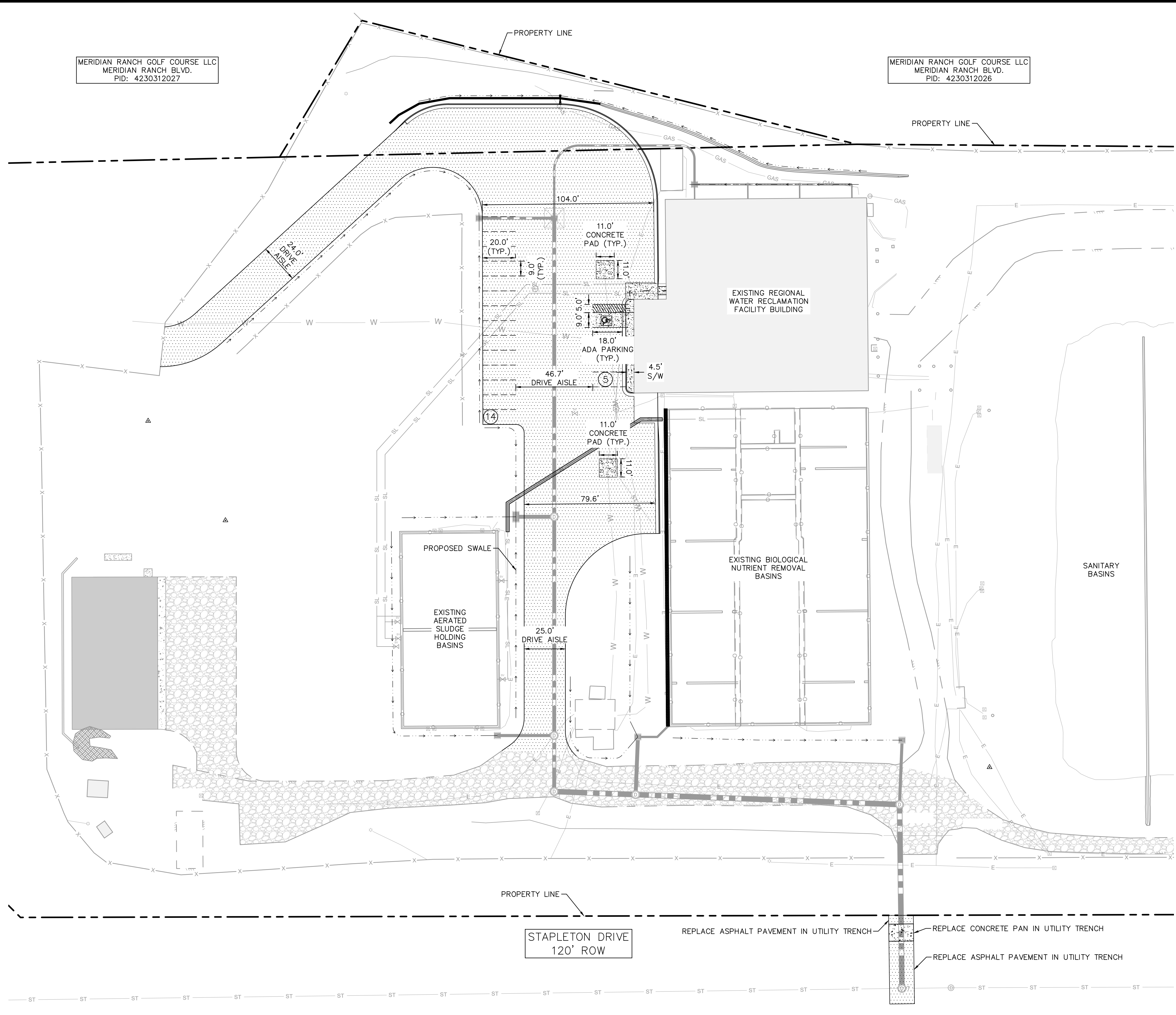

LEGEND

	PROPOSED SPILL CURB & GUTTER
	PROPOSED SWALE (REF. GRADING PLANS)
	PROPOSED MSE BLOCK RETAINING WALL
	PROPERTY LINE
	PROPOSED LANDSCAPING
	EXISTING CONCRETE SIDEWALK
	PROPOSED CONCRETE SIDEWALK
	PROPOSED CONCRETE PAD
	PROPOSED ASPHALT DRIVE AREA
	EXISTING GRAVEL DRIVE
	PROPOSED CONCRETE PAN REPLACEMENT

*PAVEMENT SECTIONS TO BE ADDED ONCE GEOTECH REPORT IS FINALIZED

NO.	REVISION	BY	DATE	APPR

Kimley»Horn
2026 KIMLEY-HORN AND ASSOCIATES, INC.
2 North Nevada Avenue, Suite 900
Colorado Springs, Colorado 80903 (719) 453-0180

DESIGNED BY: MEO
DRAWN BY: MEO
CHECKED BY: KRK
DATE: 6/22/26

WHMD RWRF STORM IMPROVEMENTS
EL PASO COUNTY, COLORADO
CONSTRUCTION DOCUMENTS
PAVING PLAN

PRELIMINARY
FOR REVIEW ONLY
NOT FOR
CONSTRUCTION

PROJECT NO.
196013004

SHEET

C1.4

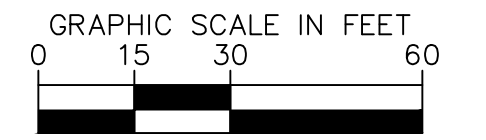
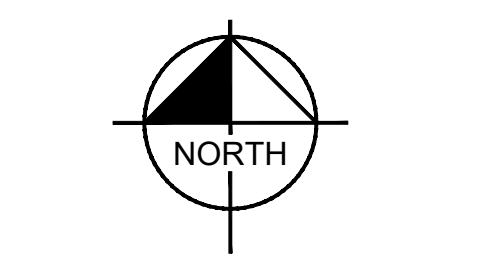

C:\ACC\CDoc\Kimley-Horn\196013001 WHMD Expansion Study\Project Files\DWG\PlanSheets\Stormwater Improvements\PlanSheets\Construction Documents\CD_CD.dwg Olesen, Maria (Langer) 6/22/2026 5:31 PM

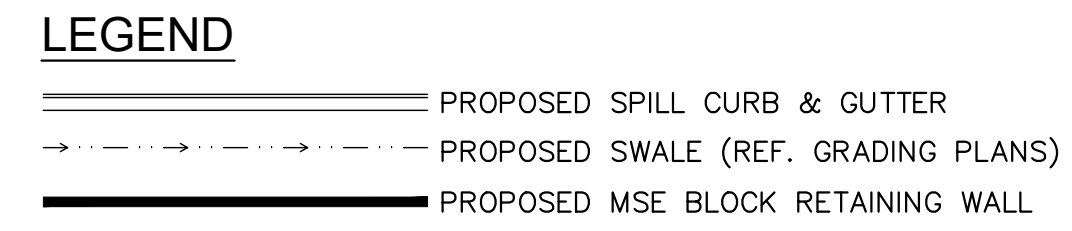
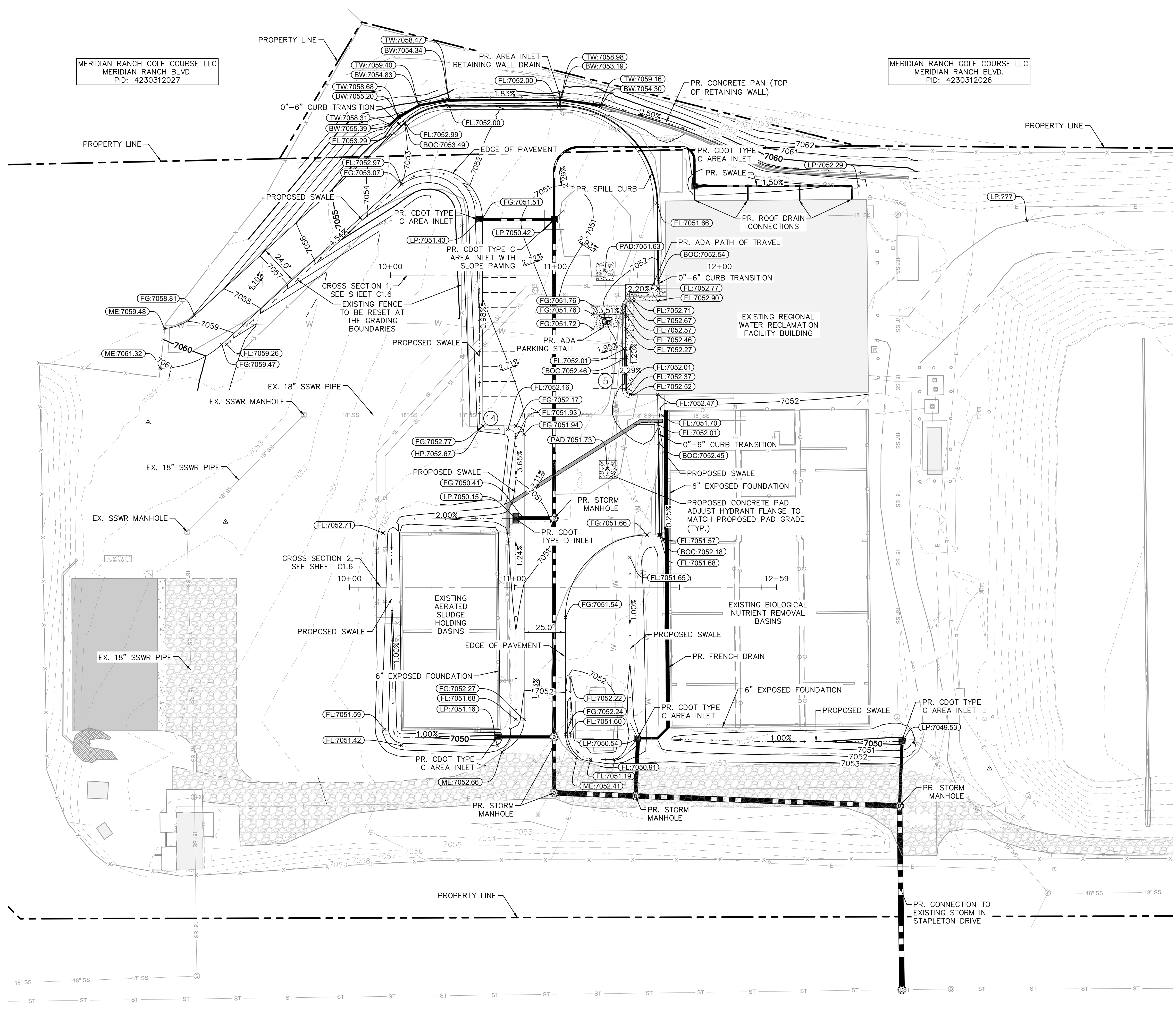

ABBREVIATION LEGEND

BW	BOTTOM OF WALL AT FINISHED GRADE
TW	TOP OF WALL AT FINISHED GRADE
FG	FINISHED GRADE
FL	FLOWLINE
LP	LOW POINT
HP	HIGH POINT
ME	MATCH EXISTING
BOC	BACK OF CURB

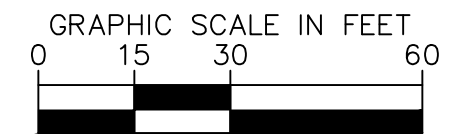

NO.	REVISION	BY	DATE	APPR

Kimley»Horn
 2026 KIMLEY-HORN AND ASSOCIATES, INC.
 2 North Nevada Avenue, Suite 900
 Colorado Springs, Colorado 80903 (719) 453-0180

DESIGNED BY: MEO
 DRAWN BY: MEO
 CHECKED BY: KRK
 DATE: 6/22/26

WHMD RWRF STORM IMPROVEMENTS
 EL PASO COUNTY, COLORADO
 CONSTRUCTION DOCUMENTS
 GRADING PLAN

PRELIMINARY
 FOR REVIEW ONLY
 NOT FOR
 CONSTRUCTION

 Kimley-Horn and Associates, Inc.

PROJECT NO.
 196013004
 SHEET
C1.5

C:\ACC\ACCDocs\Kimley-Horn\196013001 WHMD Expansion Study\Project Files\DWG\PlanSheets\Stormwater Improvements\Plansheets\Construction Documents\CD_ST_P&P.dwg Olesen, Maria (Langer) 6/22/2026 5:31 PM

MATCHLINE - SEE SHEET C1.8 FOR CONTINUATION

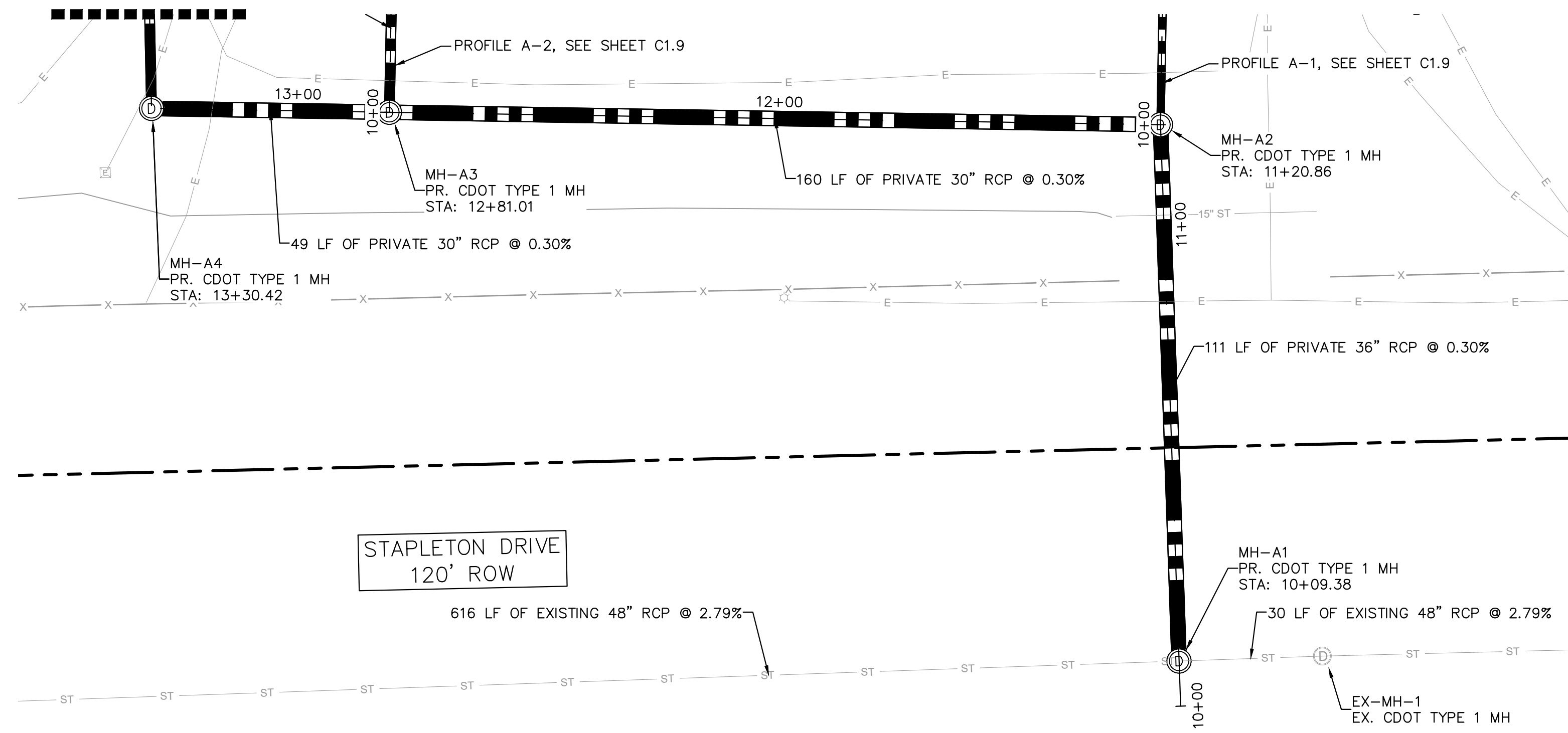

STORM LINE A - PLAN VIEW (STA: 10+00 - 13+50)

LEGEND

- PROPERTY LINE
- EASEMENT LINE
- SETBACK LINE
- PROPOSED SANITARY LINE
- PROPOSED STORM LINE
- PROPOSED WATER LINE
- PROPOSED FIRE LINE
- EXISTING GAS LINE
- EXISTING WATER LINE
- EXISTING ELECTRIC LINE
- EXISTING STORM LINE
- 5-YR DESIGN STORM HGL
- 100-YR DESIGN STORM HGL

NOTES

1. ALL PROPOSED STORM INFRASTRUCTURE IS TO BE CONSIDERED PRIVATE UNLESS OTHERWISE NOTED.

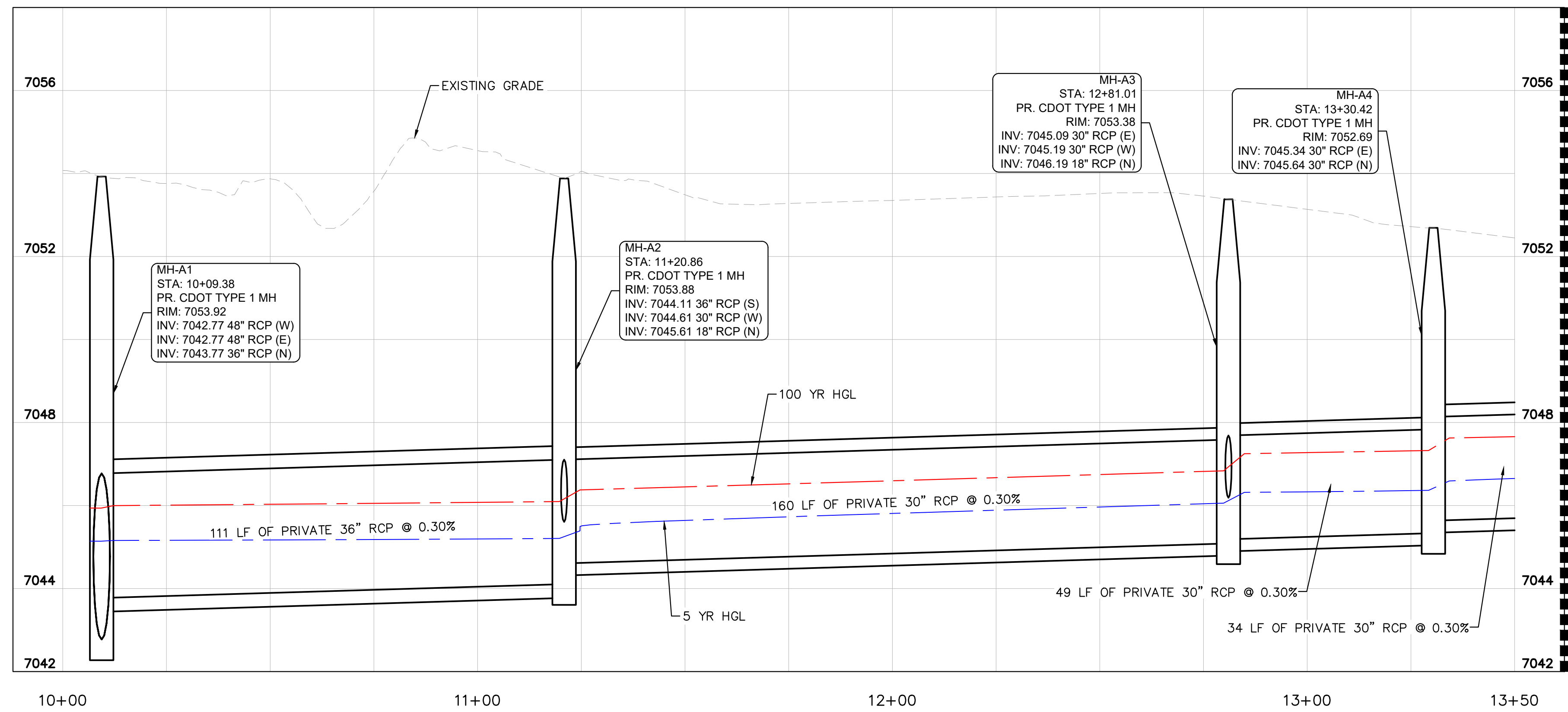

STORM LINE A - PROFILE VIEW (STA: 10+00 - 13+50)

NO.	REVISION	BY	DATE	APPR

Kimley-Horn
 2026 KIMLEY-HORN AND ASSOCIATES, INC.
 2 North Nevada Avenue, Suite 900
 Colorado Springs, Colorado 80903 (719) 453-0180

DESIGNED BY: MEO
 DRAWN BY: MEO
 CHECKED BY: KKK
 DATE: 6/22/26

WHMD RWRF STORM IMPROVEMENTS
 EL PASO COUNTY, COLORADO
 CONSTRUCTION DOCUMENTS
 STORM PLAN AND PROFILE

PRELIMINARY
 FOR REVIEW ONLY
 NOT FOR
 CONSTRUCTION

 Kimley-Horn and Associates, Inc.

PROJECT NO.
 196013004
 SHEET
C1.7



C:\ACC\ACCDocs\Kimley-Horn\196013001 WHMD Expansion Study\Project Files\DWG\PlanSheets\Stormwater Improvements\Plansheets\Construction Documents\CD_ST_P&P.dwg Olesen, Maria (Langer) 6/22/2026 5:31 PM

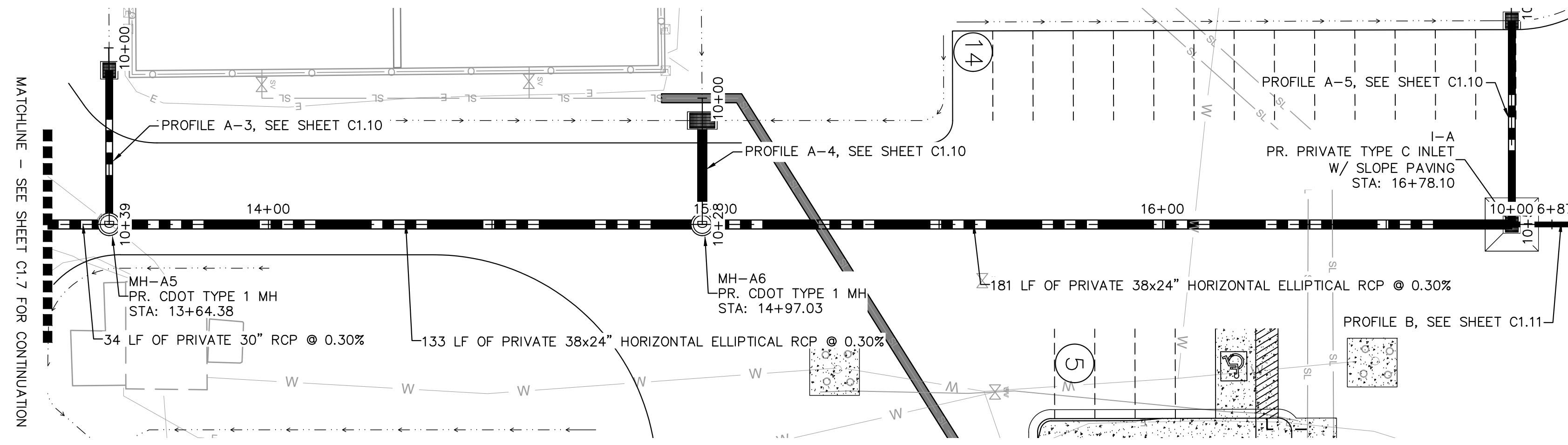

STORM LINE A - PLAN VIEW

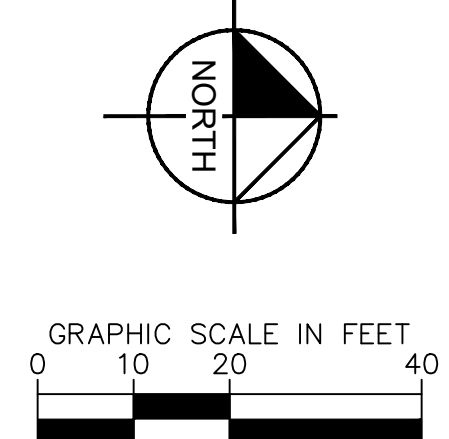

LEGEND

	PROPERTY LINE
	EASEMENT LINE
	SETBACK LINE
	PROPOSED SANITARY LINE
	PROPOSED STORM LINE
	PROPOSED WATER LINE
	PROPOSED FIRE LINE
	EXISTING GAS LINE
	EXISTING WATER LINE
	EXISTING ELECTRIC LINE
	EXISTING STORM LINE
	5-YR DESIGN STORM HGL
	100-YR DESIGN STORM HGL

NOTES
 1. ALL PROPOSED STORM INFRASTRUCTURE IS TO BE CONSIDERED PRIVATE UNLESS OTHERWISE NOTED.

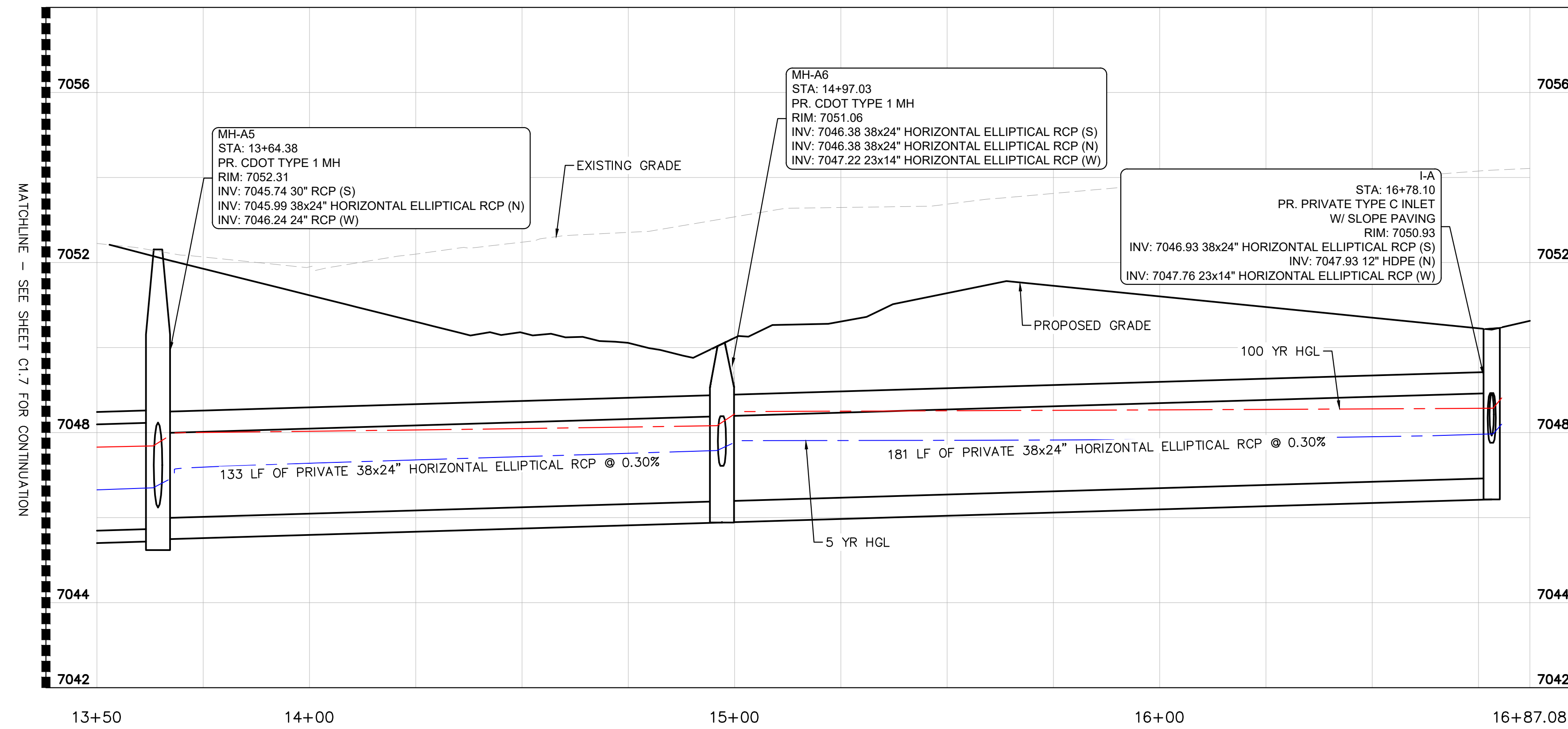

STORM LINE A - PROFILE VIEW

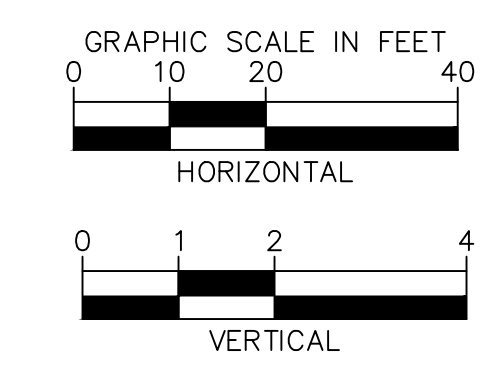

NO.	REVISION	BY	DATE	APPR

Kimley-Horn
 2026 KIMLEY-HORN AND ASSOCIATES, INC.
 2 North Nevada Avenue, Suite 900
 Colorado Springs, Colorado 80903 (719) 453-0180

DESIGNED BY: MEO
 DRAWN BY: MEO
 CHECKED BY: KRK
 DATE: 6/22/26

WHMD RWRF STORM IMPROVEMENTS
 EL PASO COUNTY, COLORADO
 CONSTRUCTION DOCUMENTS
 STORM PLAN AND PROFILE

PRELIMINARY
 FOR REVIEW ONLY
 NOT FOR
 CONSTRUCTION

 Kimley-Horn and Associates, Inc.

PROJECT NO.
196013004
 SHEET
C1.8



C:\ACC\ACCDocs\Kimley-Horn\196013001 WHMD Expansion Study\Project Files\DWG\PlanSheets\Stormwater Improvements\Plansheets\Construction Documents\CD_ST_P&P.dwg Olesen, Maria 6/22/2026 5:31 PM

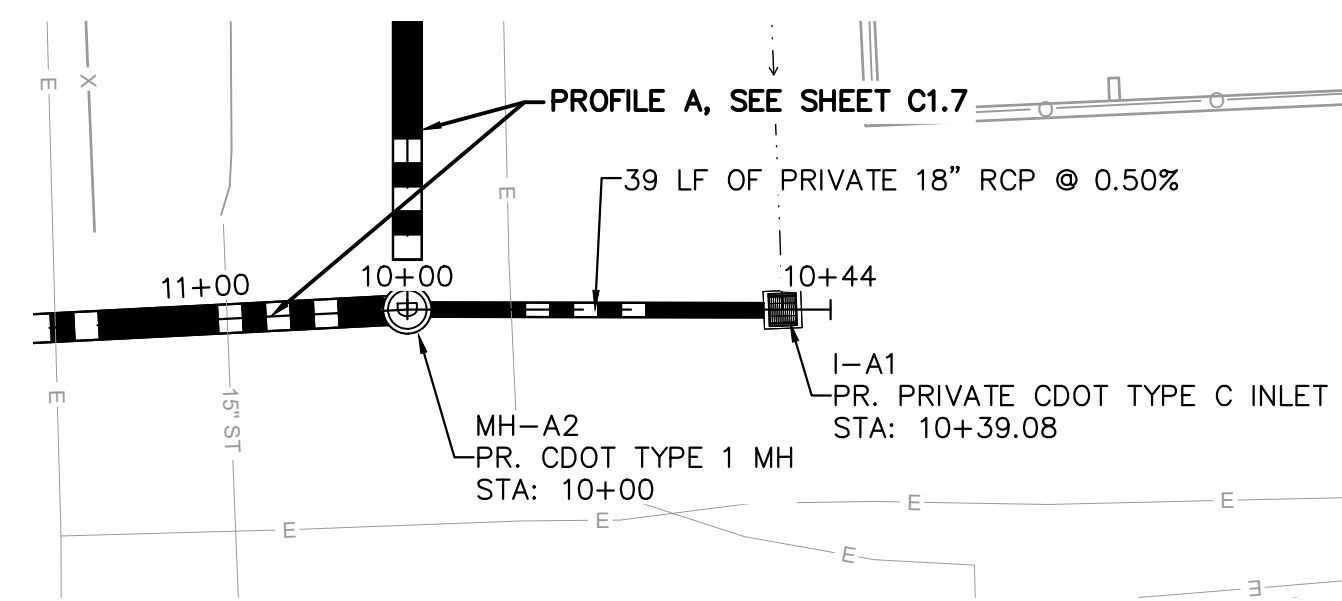

STORM LINE A.1 - PLAN VIEW

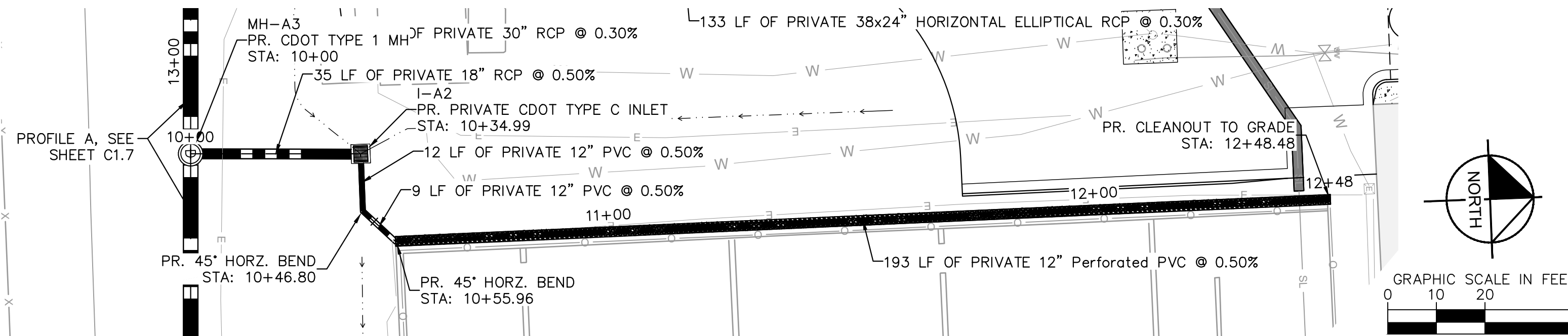

STORM LINE A.2 - PLAN VIEW

LEGEND

	PROPERTY LINE
	EASEMENT LINE
	SETBACK LINE
	PROPOSED SANITARY LINE
	PROPOSED STORM LINE
	PROPOSED FIRE LINE
	EXISTING WATER LINE
	EXISTING GAS LINE
	EXISTING ELECTRIC LINE
	EXISTING STORM LINE
	5-YR DESIGN STORM HGL
	100-YR DESIGN STORM HGL

NOTES

- ALL PROPOSED STORM INFRASTRUCTURE IS TO BE CONSIDERED PRIVATE UNLESS OTHERWISE NOTED.

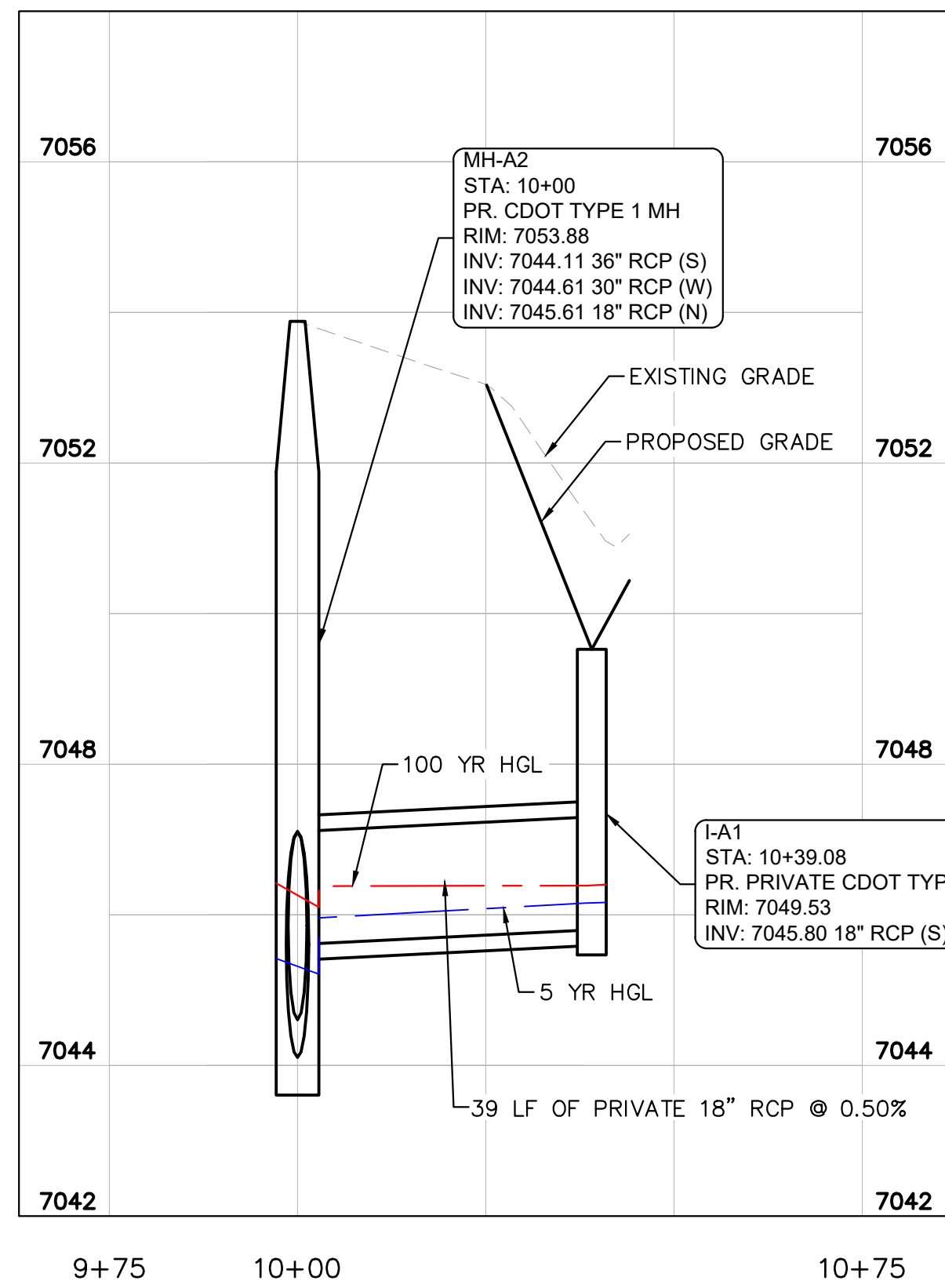

STORM LINE A.1 - PROFILE VIEW

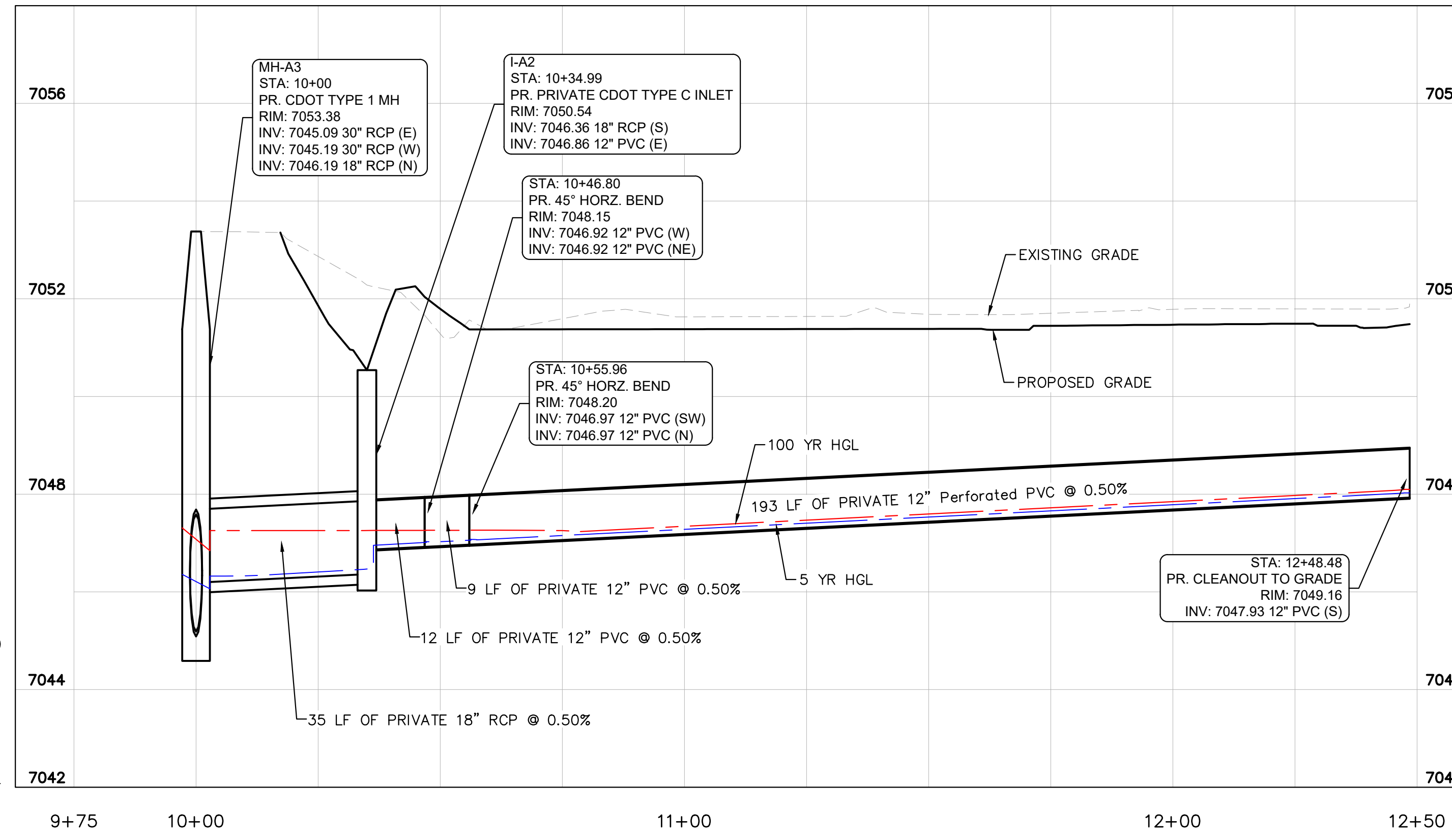

STORM LINE A.2 - PROFILE VIEW

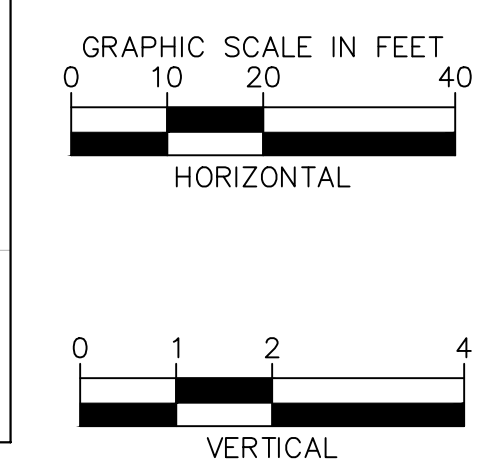

NO.	REVISION	BY	DATE	APPR

Kimley-Horn
 2026 KIMLEY-HORN AND ASSOCIATES, INC.
 2 North Nevada Avenue, Suite 900
 Colorado Springs, Colorado 80903 (719) 453-0180

DESIGNED BY: MEO
 DRAWN BY: MEO
 CHECKED BY: KKK
 DATE: 6/22/26

WHMD RWRF STORM IMPROVEMENTS
 EL PASO COUNTY, COLORADO
 CONSTRUCTION DOCUMENTS
 STORM PLAN AND PROFILE

PRELIMINARY
 FOR REVIEW ONLY
 NOT FOR
 CONSTRUCTION

 Kimley-Horn and Associates, Inc.

PROJECT NO.
 196013004
 SHEET

C1.9



C:\ACC\ACCDocs\Kimley-Horn\196013001 WHMD Expansion Study\Project Files\DWG\PlanSheets\Stormwater Improvements\PlanSheets\Construction Documents\CD_ST_P&P.dwg Olesen, Maria (Langer) 6/22/2026 5:32 PM

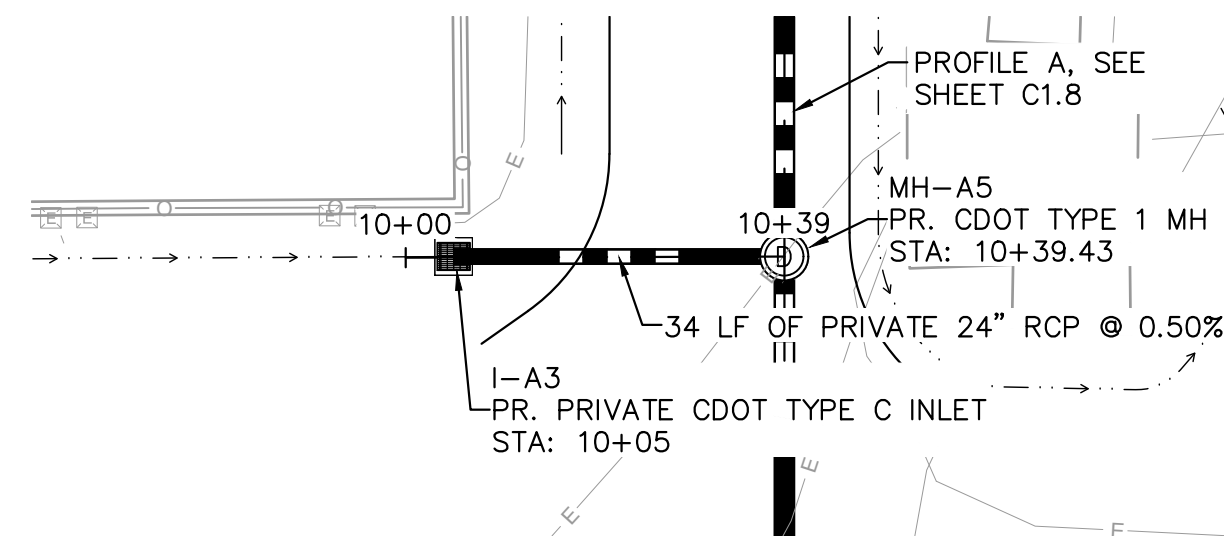

STORM LINE A.3 - PLAN VIEW

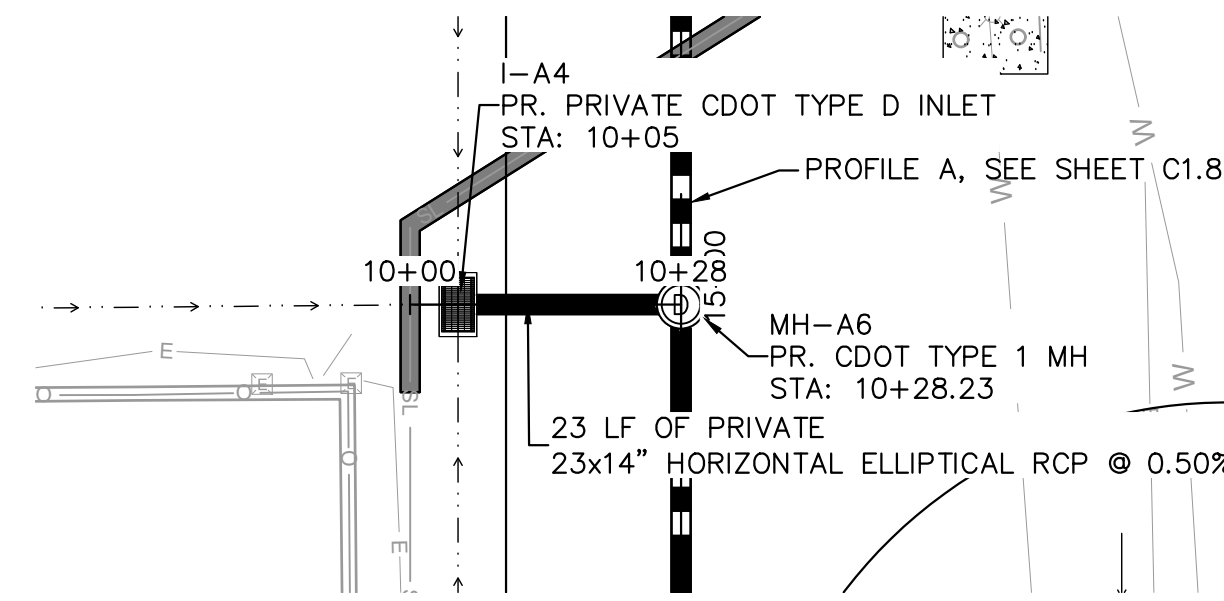

STORM LINE A.4 - PLAN VIEW

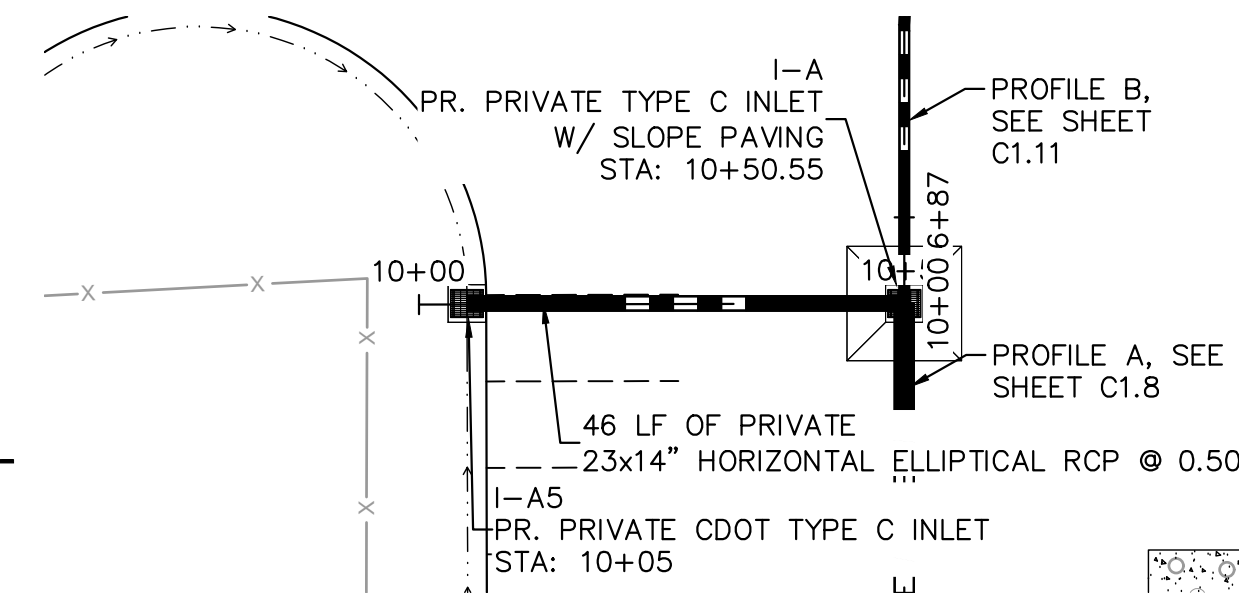

STORM LINE A.5 - PLAN VIEW

- LEGEND**
- PROPERTY LINE
 - - - EASEMENT LINE
 - - - SETBACK LINE
 - - - PROPOSED SANITARY LINE
 - - - PROPOSED STORM LINE
 - - - PROPOSED FIRE LINE
 - - - PROPOSED WATER LINE
 - EXISTING GAS LINE
 - EXISTING WATER LINE
 - EXISTING ELECTRIC LINE
 - EXISTING STORM LINE
 - - - 5-YR DESIGN STORM HGL
 - - - 100-YR DESIGN STORM HGL

NOTES

1. ALL PROPOSED STORM INFRASTRUCTURE IS TO BE CONSIDERED PRIVATE UNLESS OTHERWISE NOTED.

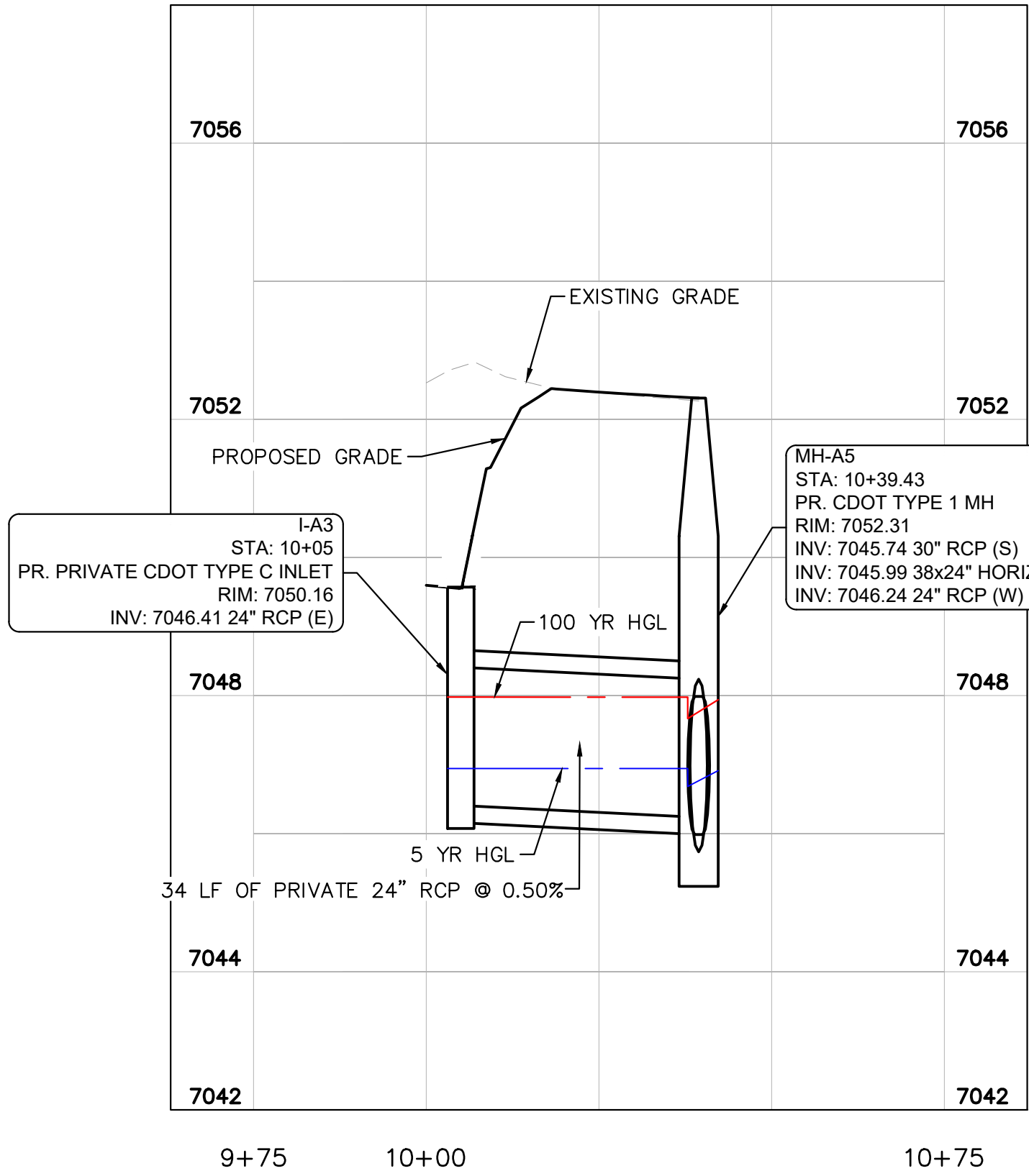

STORM LINE A.3 - PROFILE VIEW

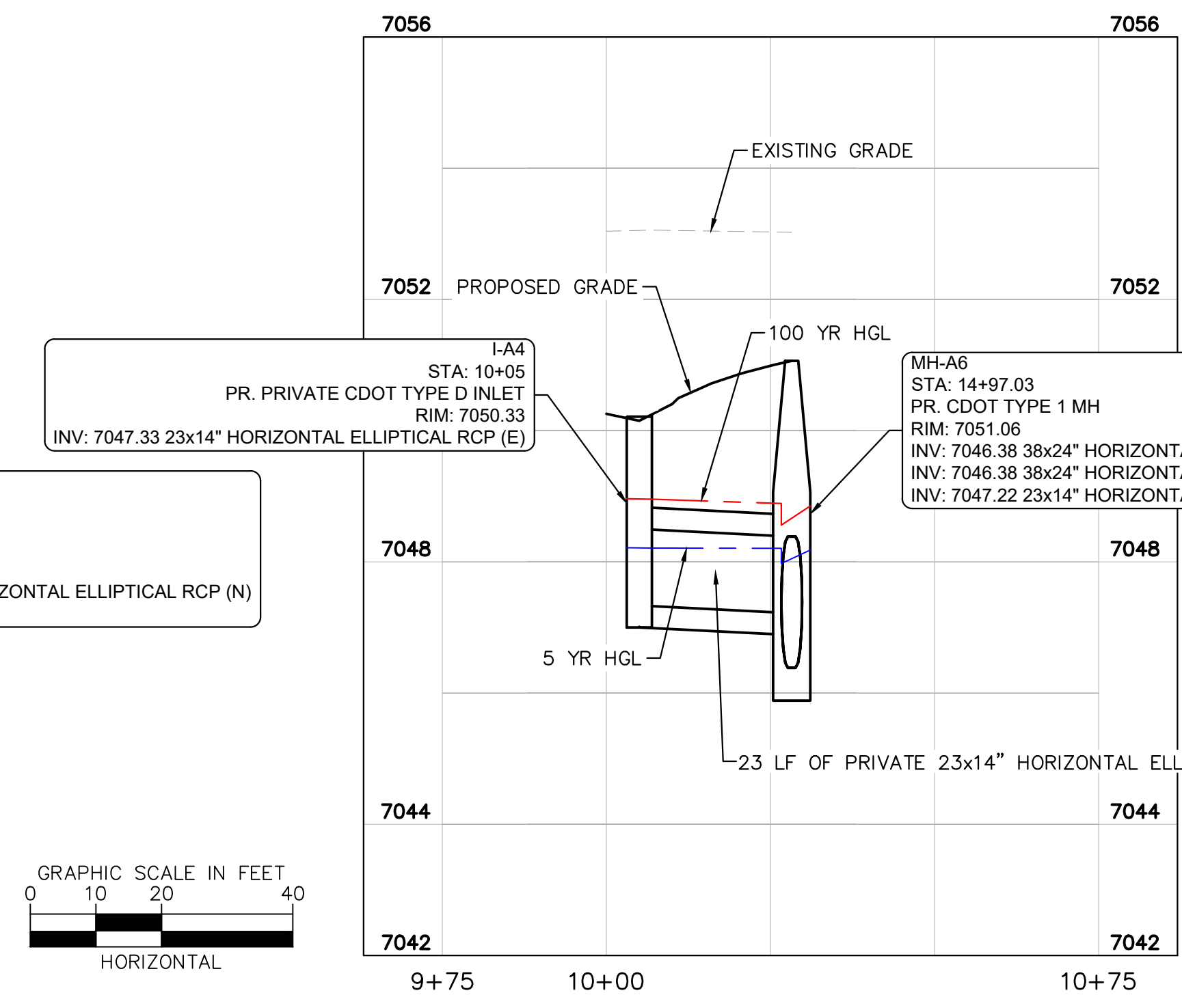

STORM LINE A.4 - PROFILE VIEW

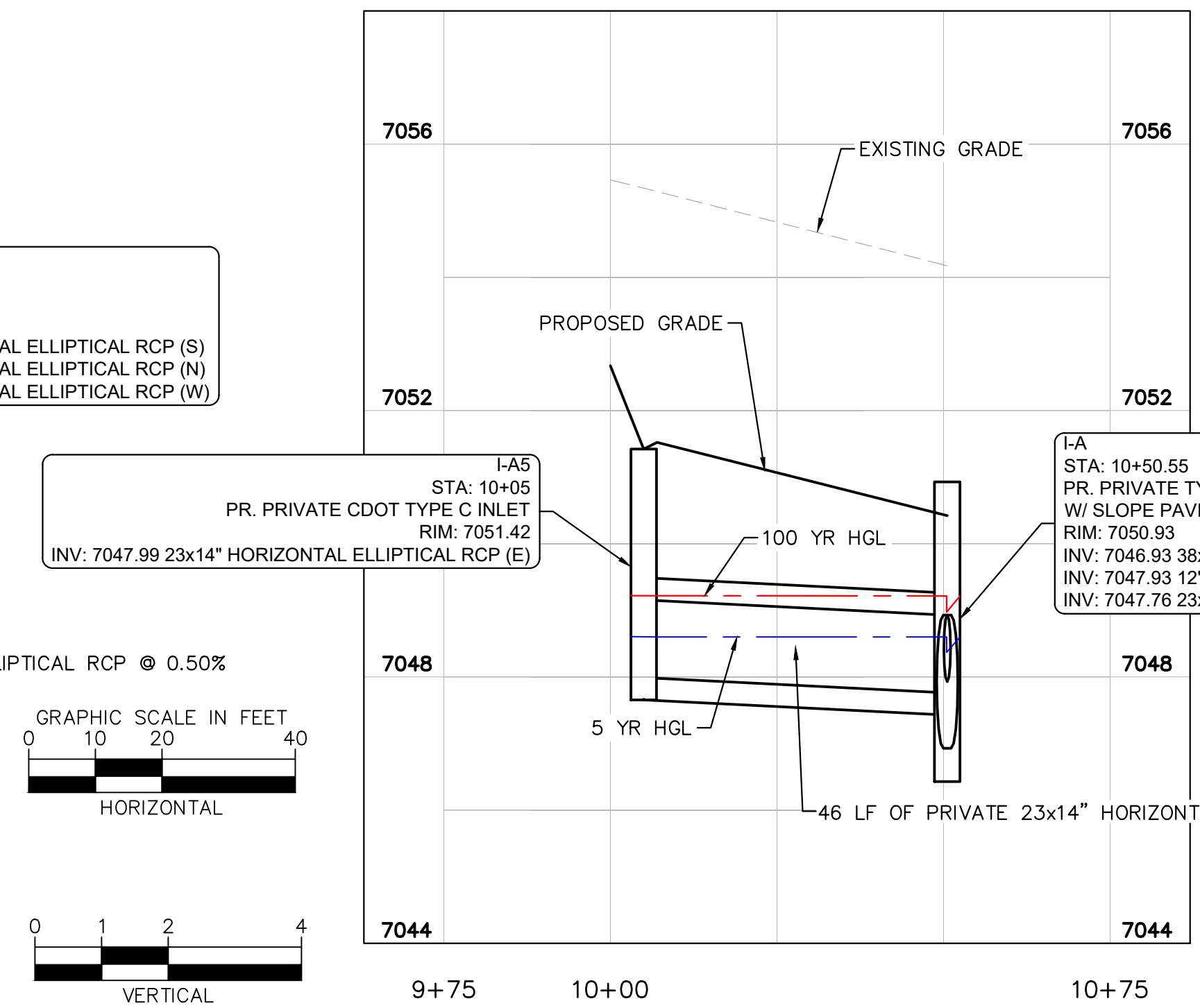

STORM LINE A.5 - PROFILE VIEW

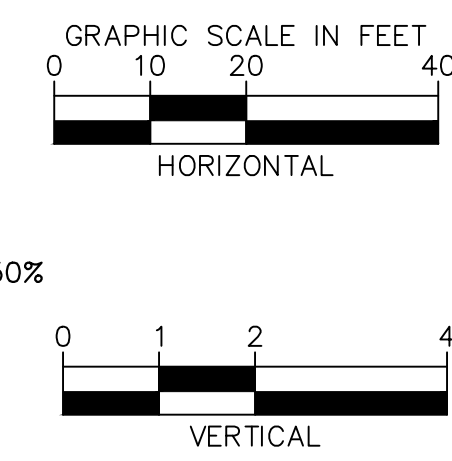
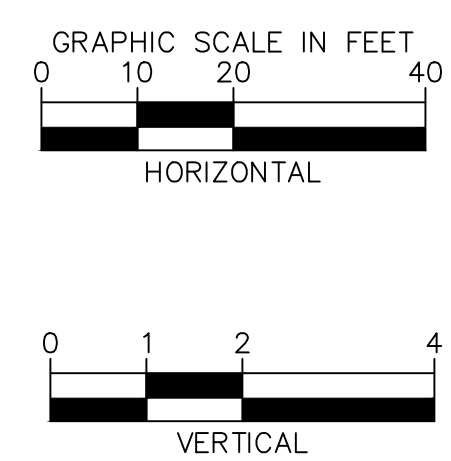
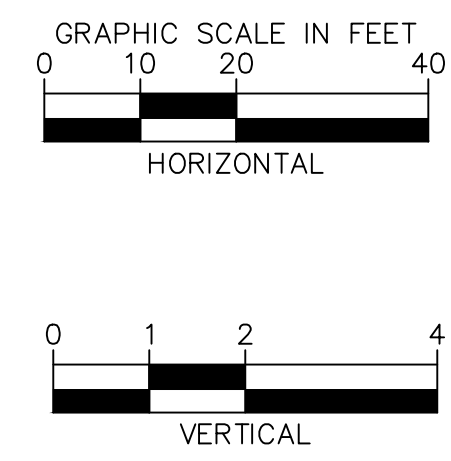

NO.	REVISION	BY	DATE	APPR

Kimley-Horn
 2026 KIMLEY-HORN AND ASSOCIATES, INC.
 2 North Nevada Avenue, Suite 900
 Colorado Springs, Colorado 80903 (719) 453-0180

DESIGNED BY: MEO
 DRAWN BY: MEO
 CHECKED BY: KRK
 DATE: 6/22/26

WHMD RWRF STORM IMPROVEMENTS
 EL PASO COUNTY, COLORADO
 CONSTRUCTION DOCUMENTS
 STORM PLAN AND PROFILE

PRELIMINARY
 FOR REVIEW ONLY
 NOT FOR
 CONSTRUCTION

 Kimley-Horn and Associates, Inc.

PROJECT NO.
 196013004
 SHEET
C1.10



C:\ACC\ACCDocs\Kimley-Horn\196013001 WHMD Expansion Study\Project Files\DWG\PlanSheets\Stormwater Improvements\Plansheets\Construction Documents\CD_ST_P&P.dwg Olesen, Maria (Langer) 6/22/2026 5:32 PM

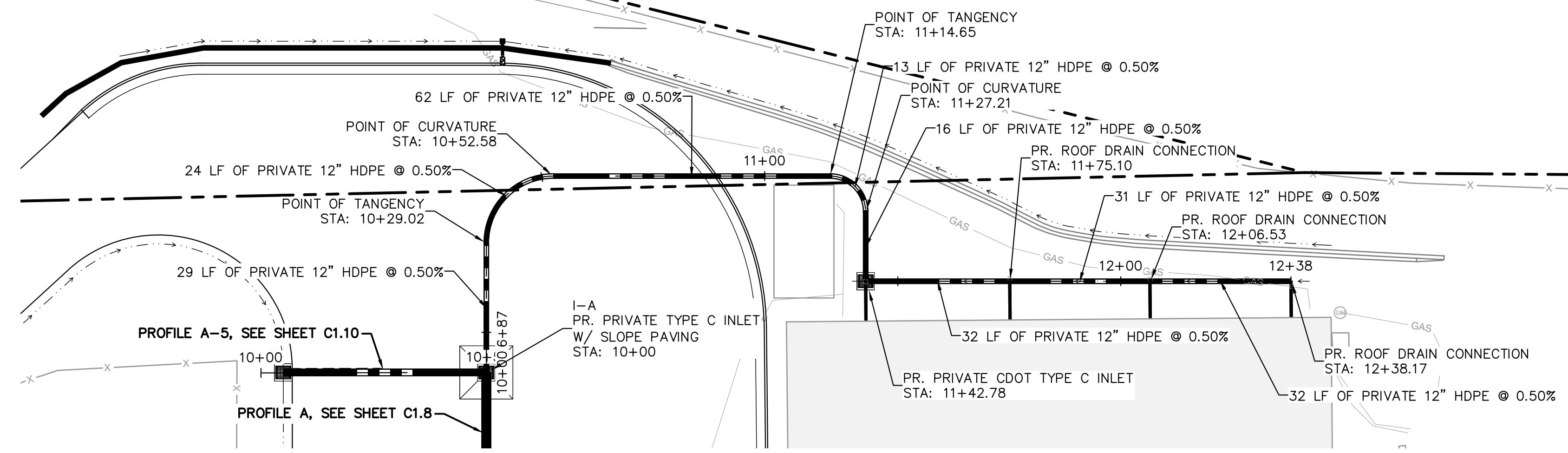

STORM LINE B - PLAN VIEW

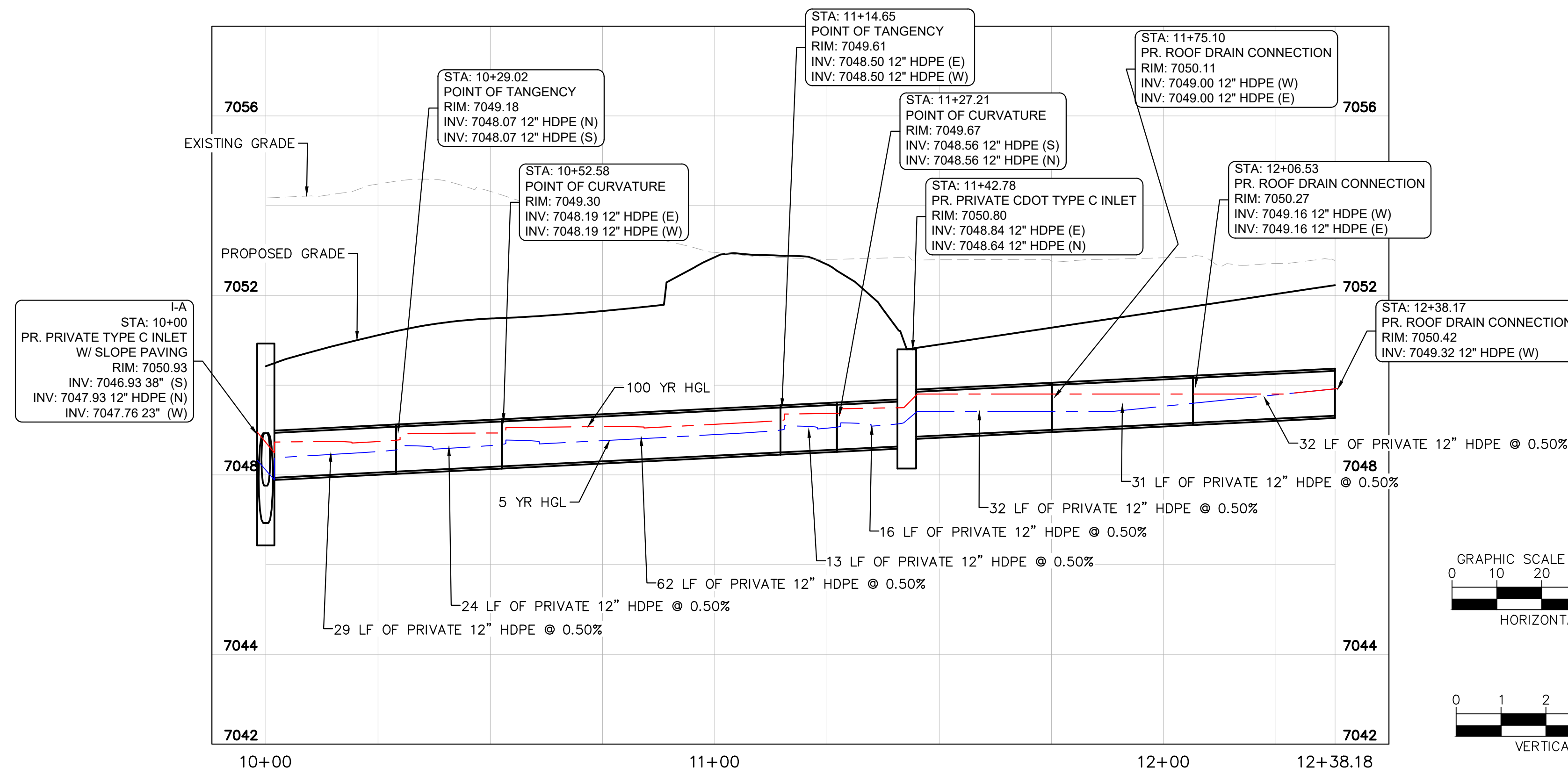

STORM LINE B - PROFILE VIEW

LEGEND

- PROPERTY LINE
- EASEMENT LINE
- SETBACK LINE
- PROPOSED SANITARY LINE
- PROPOSED STORM LINE
- PROPOSED FIRE LINE
- PROPOSED WATER LINE
- EXISTING GAS LINE
- EXISTING WATER LINE
- EXISTING ELECTRIC LINE
- EXISTING STORM LINE
- 5-YR DESIGN STORM HGL
- 100-YR DESIGN STORM HGL

NOTES

1. ALL PROPOSED STORM INFRASTRUCTURE IS TO BE CONSIDERED PRIVATE UNLESS OTHERWISE NOTED.

NO.	REVISION	BY	DATE	APPR

Kimley-Horn
 2026 KIMLEY-HORN AND ASSOCIATES, INC.
 2 North Nevada Avenue, Suite 900
 Colorado Springs, Colorado 80903 (719) 453-0180

DESIGNED BY: MEO
 DRAWN BY: MEO
 CHECKED BY: KKK
 DATE: 6/22/26

WHMD RWRF STORM IMPROVEMENTS
 EL PASO COUNTY, COLORADO
 CONSTRUCTION DOCUMENTS
 STORM PLAN & PROFILE

PRELIMINARY
 FOR REVIEW ONLY
 NOT FOR
 CONSTRUCTION

 Kimley-Horn and Associates, Inc.

PROJECT NO.
 196013004
 SHEET
C1.11



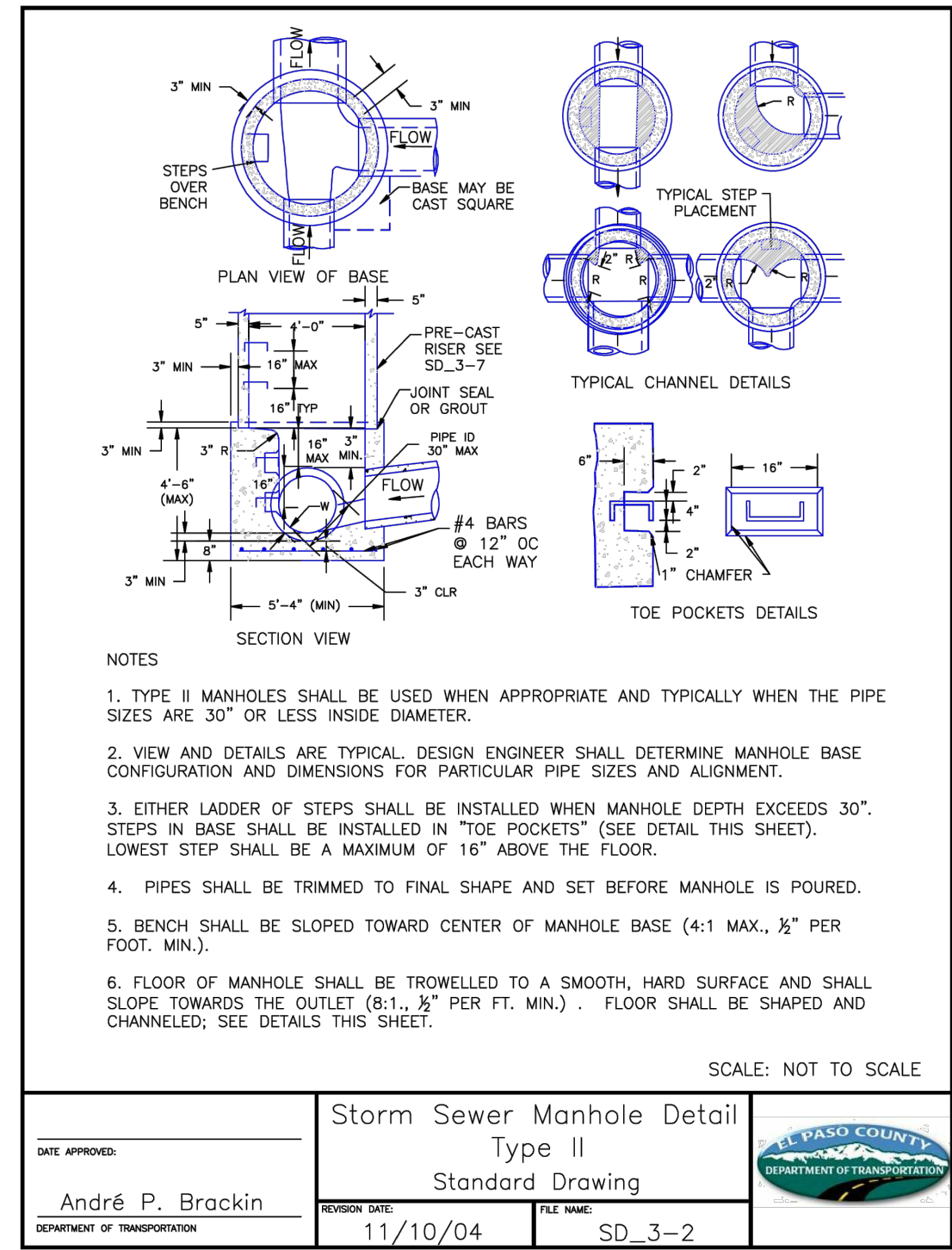
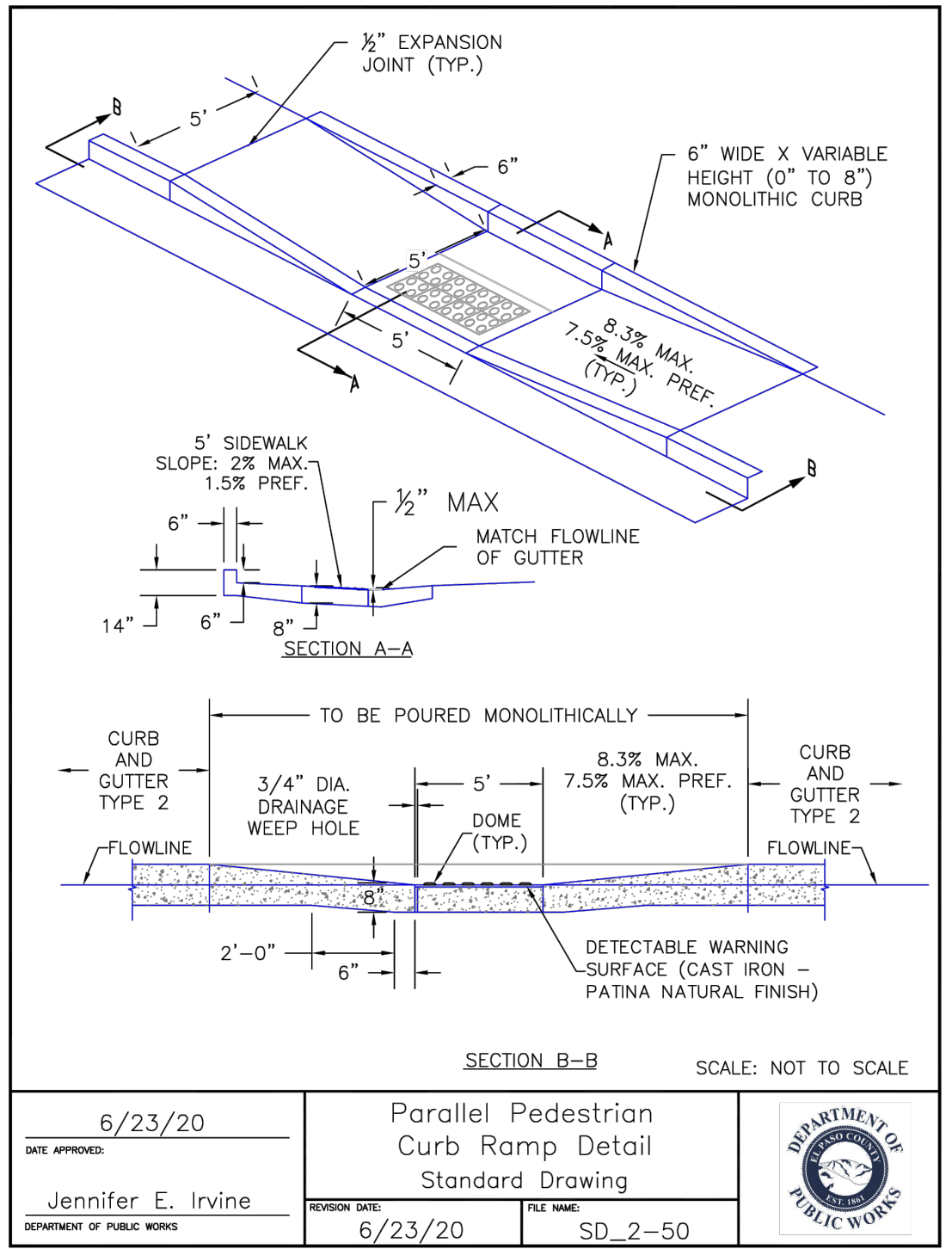
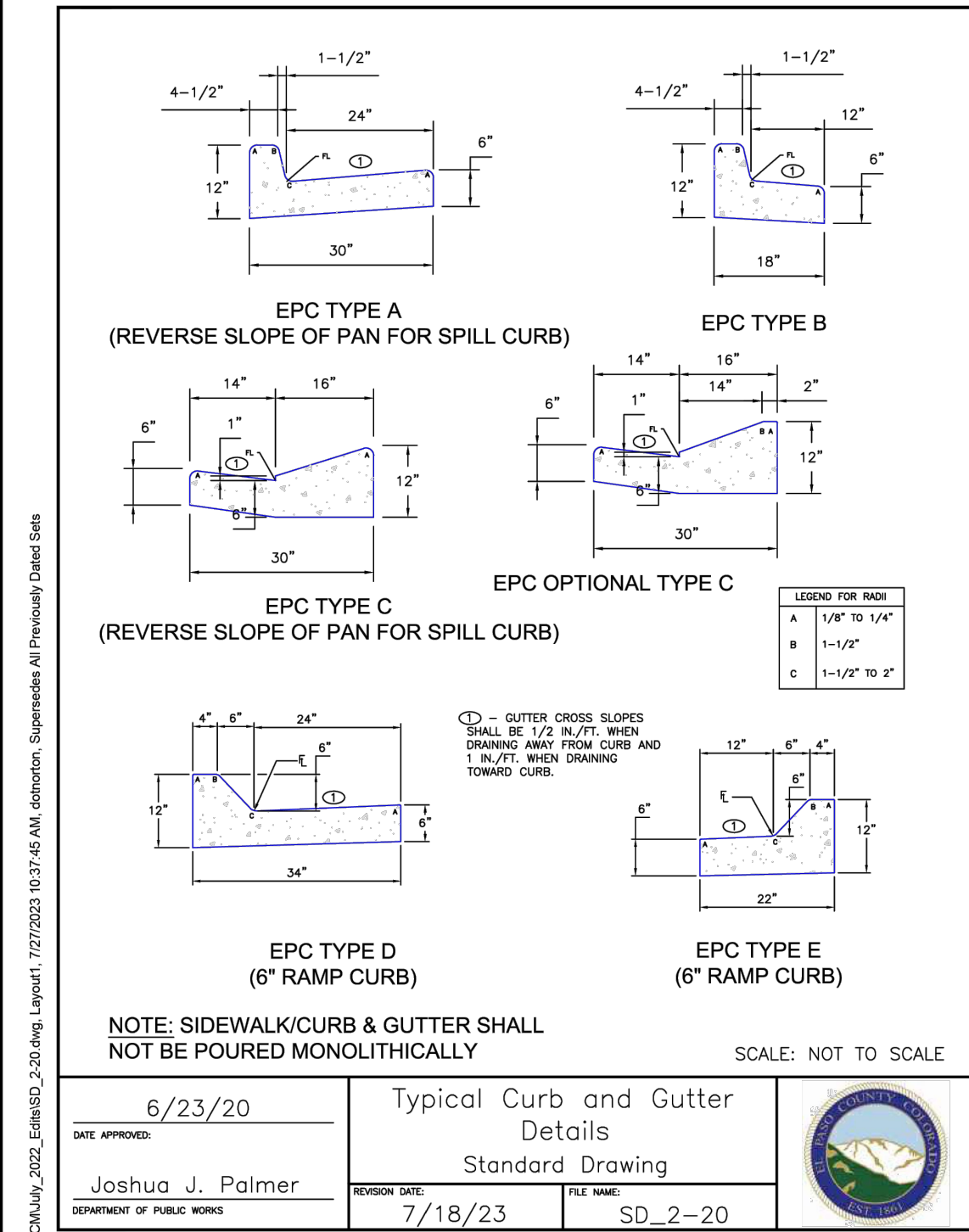

REINFORCED CONCRETE PIPE

PIPE SIZE (IN)	VERTICAL ELEVATION		HORIZONTAL ELEVATION	
	MIN. HEIGHT	MAX. HEIGHT	MIN. WIDTH	MAX. WIDTH
18	1.5	2.0	1.5	2.0
24	2.0	2.5	2.0	2.5
30	2.5	3.0	2.5	3.0
36	3.0	3.5	3.0	3.5
42	3.5	4.0	3.5	4.0
48	4.0	4.5	4.0	4.5
54	4.5	5.0	4.5	5.0
60	5.0	5.5	5.0	5.5
66	5.5	6.0	5.5	6.0
72	6.0	6.5	6.0	6.5
78	6.5	7.0	6.5	7.0
84	7.0	7.5	7.0	7.5
90	7.5	8.0	7.5	8.0
96	8.0	8.5	8.0	8.5
102	8.5	9.0	8.5	9.0
108	9.0	9.5	9.0	9.5
114	9.5	10.0	9.5	10.0
120	10.0	10.5	10.0	10.5
126	10.5	11.0	10.5	11.0
132	11.0	11.5	11.0	11.5
138	11.5	12.0	11.5	12.0
144	12.0	12.5	12.0	12.5
150	12.5	13.0	12.5	13.0
156	13.0	13.5	13.0	13.5
162	13.5	14.0	13.5	14.0
168	14.0	14.5	14.0	14.5
174	14.5	15.0	14.5	15.0
180	15.0	15.5	15.0	15.5
186	15.5	16.0	15.5	16.0
192	16.0	16.5	16.0	16.5
198	16.5	17.0	16.5	17.0
204	17.0	17.5	17.0	17.5
210	17.5	18.0	17.5	18.0
216	18.0	18.5	18.0	18.5
222	18.5	19.0	18.5	19.0
228	19.0	19.5	19.0	19.5
234	19.5	20.0	19.5	20.0
240	20.0	20.5	20.0	20.5
246	20.5	21.0	20.5	21.0
252	21.0	21.5	21.0	21.5
258	21.5	22.0	21.5	22.0
264	22.0	22.5	22.0	22.5
270	22.5	23.0	22.5	23.0
276	23.0	23.5	23.0	23.5
282	23.5	24.0	23.5	24.0
288	24.0	24.5	24.0	24.5
294	24.5	25.0	24.5	25.0
300	25.0	25.5	25.0	25.5

CONCRETE PIPE WITH END SECTIONS

CONCRETE PIPE WITHOUT END SECTIONS

CONSTRUCTION MINIMUM COVER FOR RIGID PIPE

ALLOWABLE RANGE OF HEIGHTS FOR FILL OVER REINFORCED CONCRETE PIPE

REINFORCED CONCRETE PIPE

GENERAL NOTES

NONREINFORCED CONCRETE PIPE

ALLOWABLE RANGE OF HEIGHTS FOR FILL OVER NONREINFORCED CONCRETE PIPE

QUANTITIES FOR ONE INLET

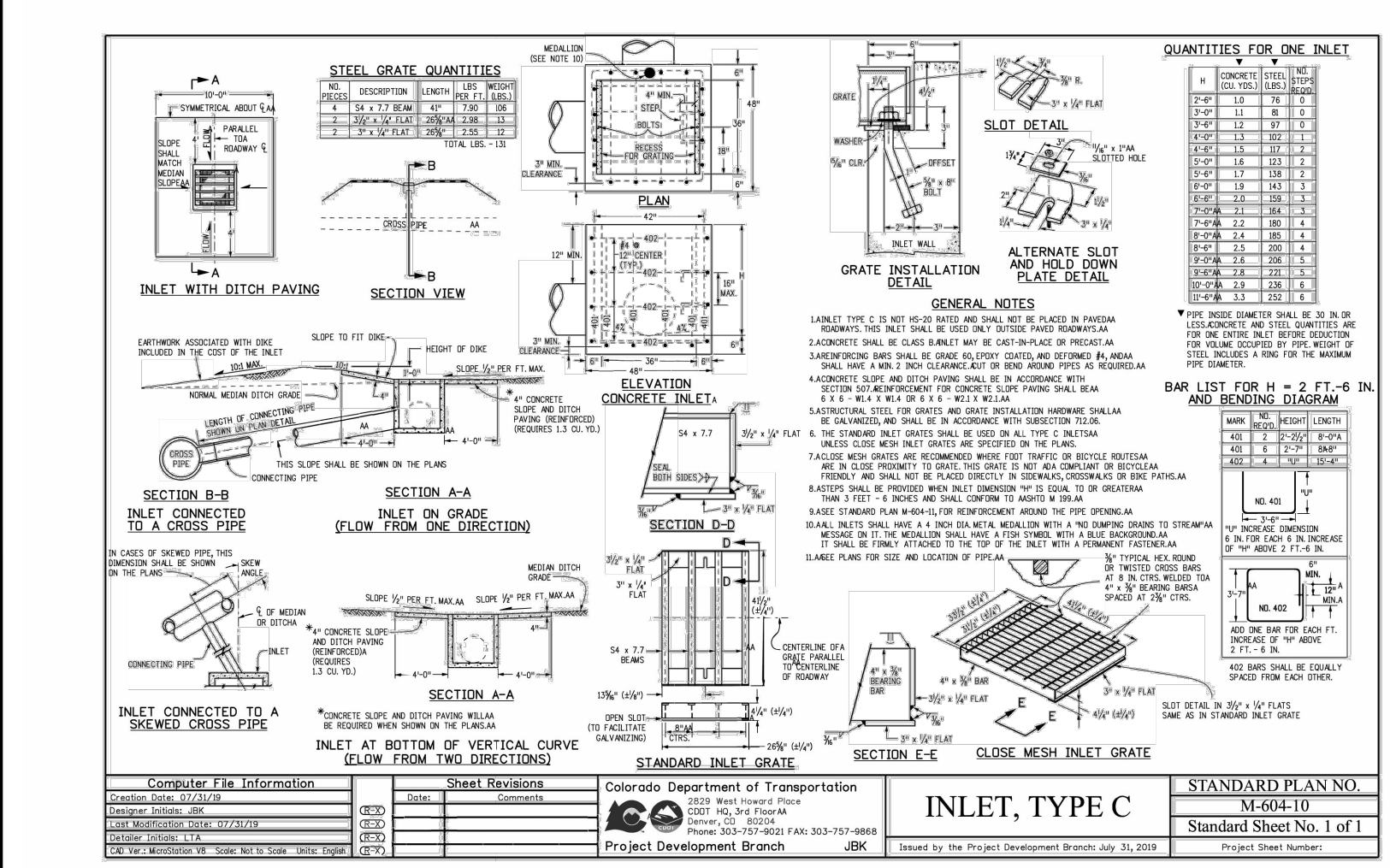
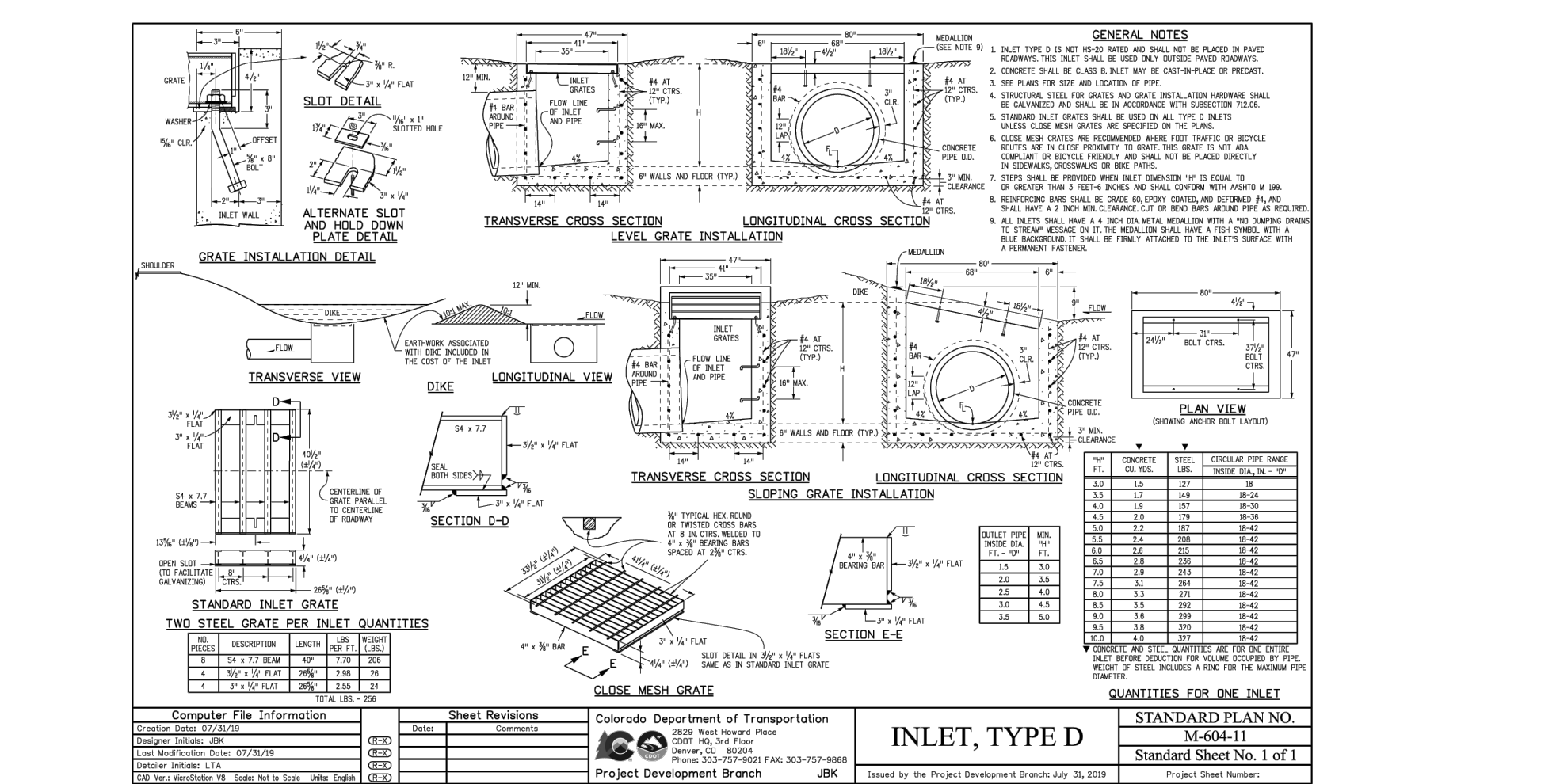

Kimley-Horn
 2026 KIMLEY-HORN AND ASSOCIATES, INC.
 2 North Nevada Avenue, Suite 900
 Colorado Springs, Colorado 80903 (719) 453-0180

DESIGNED BY: MEO
 DRAWN BY: MEO
 CHECKED BY: KRK
 DATE: 6/22/26

WHMD RWRF STORM IMPROVEMENTS
 EL PASO COUNTY, COLORADO
 CONSTRUCTION DOCUMENTS
 DETAIL SHEET

PRELIMINARY
 FOR REVIEW ONLY
 NOT FOR
 CONSTRUCTION

PROJECT NO.
 196013004

SHEET
 C1.12

NO. BY DATE
 REVISION

