

## El Paso County Parcel Information

PARCEL	NAME
5212002021	RONALD G OHOLENDT &

File Name: AL-22-006

Zone Map No.: --

ADDRESS	CITY	STATE
12643 FULFORD CT	COLORADO SPRINGS	CO

ZIP	ZIPLUS
80908	4191

Date: May 2, 2022

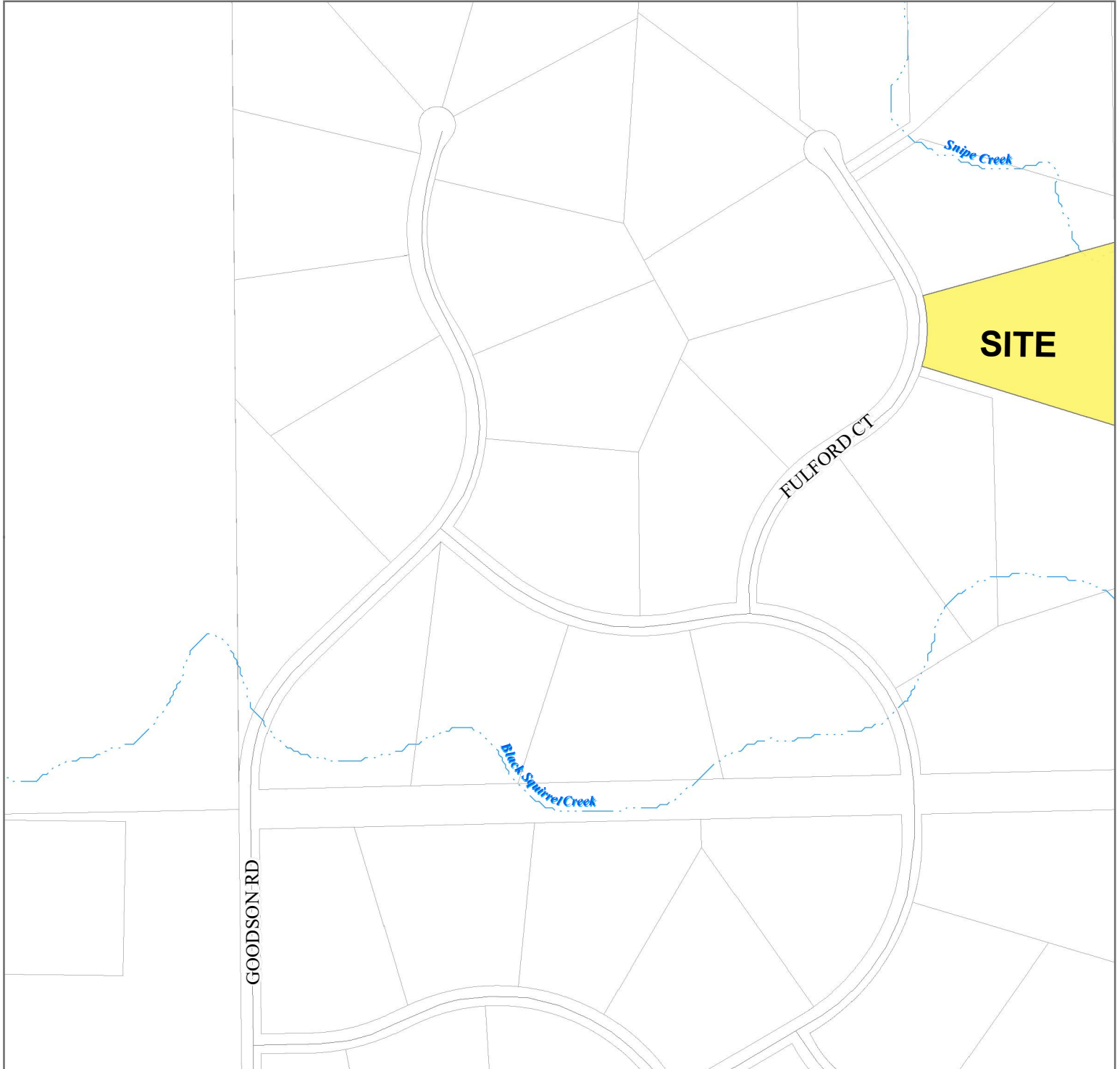

Please report any parcel discrepancies to:  
El Paso County Assessor  
1675 W. Garden of the Gods Rd.  
Colorado Springs, CO 80907  
(719) 520-6600



COPYRIGHT 2018 by the Board of County Commissioners, El Paso County, Colorado. All rights reserved. No part of this document or data contained hereon may be reproduced; used to prepare derivative products; or distributed without the specific written approval of the Board of County Commissioners, El Paso County, Colorado. This document was prepared from the best data available at the time of printing. El Paso County, Colorado, makes no claim as to the completeness or accuracy of the data contained hereon.