

EL PASO COUNTY DEPARTMENT OF HEALTH AND ENVIRONMENT
INDIVIDUAL SEWAGE DISPOSAL SYSTEM INSPECTION FORM

Permit # 0N0003494
Date 11-30-2001



APPROVED: YES NO #521 2002021 ENVIRONMENTALIST Brad Wallace

Address 12643 Fullford Court Owner Ron Oholendt

Legal Description LOT 21, Filing # 2, Sylvan Meadows
Residence , # of bedrooms 3; Commercial ; System Installer Alan Havens

SEPTIC TANK:
Commercial ; Noncommercial , L , W , WD
Construction Material Pre-cast Concrete, capacity 1,500 gallons.

DISPOSAL FIELD:
Rock Systems:
Trench: depth , width , total length , sq. feet
Bed: depth 2', length 70', width 15.3', sq. feet 1071 FT²
Rock type 1/2" - 1 1/4", depth 12", under PVC 6", over PVC 2"
Seepage Pits: # of pits , total # of rings , working depth(s)
size of pit(s) L X W , lining material , total sq. feet

Rockless Systems:
Chamber: Type , number of chambers , bed , trench
sq. ft./section , reduction allowed %, sq. ft required
total sq. ft. installed , depth of installation
Engineer Design or N, Designing Engineer Front Range Geotechnical
Approval letter provided? or N
Well 50 feet from tank Y or N 100 feet from leach field Y or N
Well installed at time of septic system inspection Y or N Public Water
*Approval will be revoked if in the future the well is found to be within 50 feet of the septic tank and/or 100 feet of the disposal field.

NOTES: Septic Tank meets requirement for 4 bedroom house.

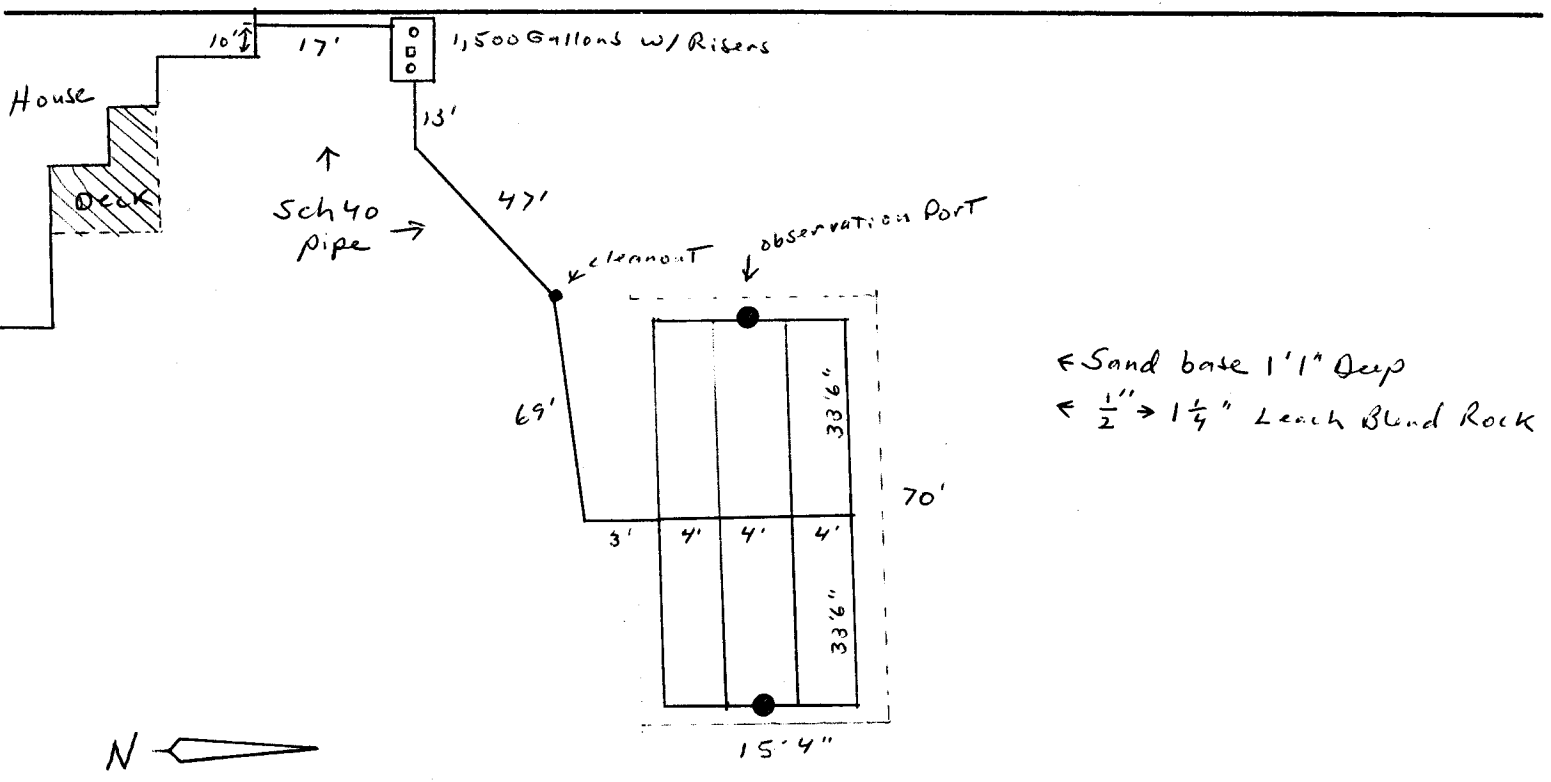

EL PASO COUNTY
DEPARTMENT OF HEALTH AND ENVIRONMENT
301 S Union Blvd, Colorado Springs, Colorado 719-578-3199

INDIVIDUAL SEWAGE DISPOSAL SYSTEM PERMIT

OWNER NAME: RON OHOLENDT PERMIT NUMBER: ON0003494
ADDRESS: 12643 FULFORD CT
CITY, STATE, ZIP COLORADO SPRINGS CO 80908 DATE PERMITTED: 8/31/01
INSTALLED BY: KUNAU [Kunau Drilling] PHONE NUMBER 7196371436

This permit is issued in accordance with 25-10-107 Colorado Revised Statutes. PERMIT EXPIRES upon completion-installation of sewage-disposal system or at the end of twelve (12) months from date of issue- whichever occurs first-(unless work is in progress). If both a building and an ISDS permit are issued for the same property and construction has not commenced prior to the expiration date of the building permit, the ISDS permit shall expire at the same time as the building permit. This permit is revokable if all stated requirements are not met. Sewage disposal system to be installed by an El Paso County Licensed System Contractor or the property owner.

THIS PERMIT DOES NOT DENOTE APPROVAL OF ZONING AND ACREAGE REQUIREMENTS.

John Dower

DIRECTOR, EL PASO COUNTY DEPARTMENT OF HEALTH AND ENVIRONMENT

PERMIT EXPIRATION DATE :
Expires twelve months from date of issue

Brad A. Wallaw 578-3127
ENVIRONMENTALIST / PHONE NUMBER

NOTE: 48 HOUR ADVANCE NOTICE REQUIRED
LEAVE THE ENTIRE SEWAGE DISPOSAL SYSTEM UNCOVERED FOR FINAL INSPECTION.

WATER SOURCE: WELL

MINIMUM SEPTIC TANK SIZE : 1,250 GALLONS MINIMUM ABSORPTION AREA REQUIRED _____ SQ FT

PLANNING DEPARTMENT [redacted] ENUMERATION [redacted] FLOOD PLAIN [redacted] WASTEWATER [redacted]

COMMENTS:

HEALTH DEPARTMENT INSPECTION IS NEEDED BEFORE BACK FILLING. ENGINEERS APPROVAL LETTER MUST BE RECEIVED BEFORE FINAL APPROVAL CAN BE GIVEN.

The Health Office shall assume no responsibility in case of failure or inadequacy of a sewage-disposal system, beyond consulting in good faith with the property owner or representative. Free access to the property shall be authorized at reasonable time for the purpose of making such inspections as are necessary to determine compliance with requirements of this law.

FOR ADMINISTRATIVE USE ONLY

Permit Ready: _____ Called 9-5-01 Mailed 11:15 AM
Final Inspection Requested: BY: Allen Haven / Havens excavating Date Called In: 11-29-01
Phone # 495-8619 Septic Site will be ready: 11-30-01

CALCULATIONS:

3 BEDROOMS
 PERC RATE 22.5 MIN/INCH
 $Q = \# \text{ BEDROOMS} * 150$
 $A = \frac{(1.5) Q \sqrt{T}}{5}$
 $A = \frac{(1.6)(1.5)(3)(150) \sqrt{22.5}}{5}$
 $A = 1024.58 \text{ SQ. FT. (USE 1073.31 SQ. FT.)}$

FOR PIPE & GRAVEL BED SYSTEM
 4 ROWS @ 4 FT. ON CENTER
 BED LENGTH = 70 FT.
 BED WIDTH = 15 FT. - 4 IN.
 BED CONTACT AREA = 1073.31 SQ. FT.
 MINIMUM TANK SIZE = 1,250 GALLONS

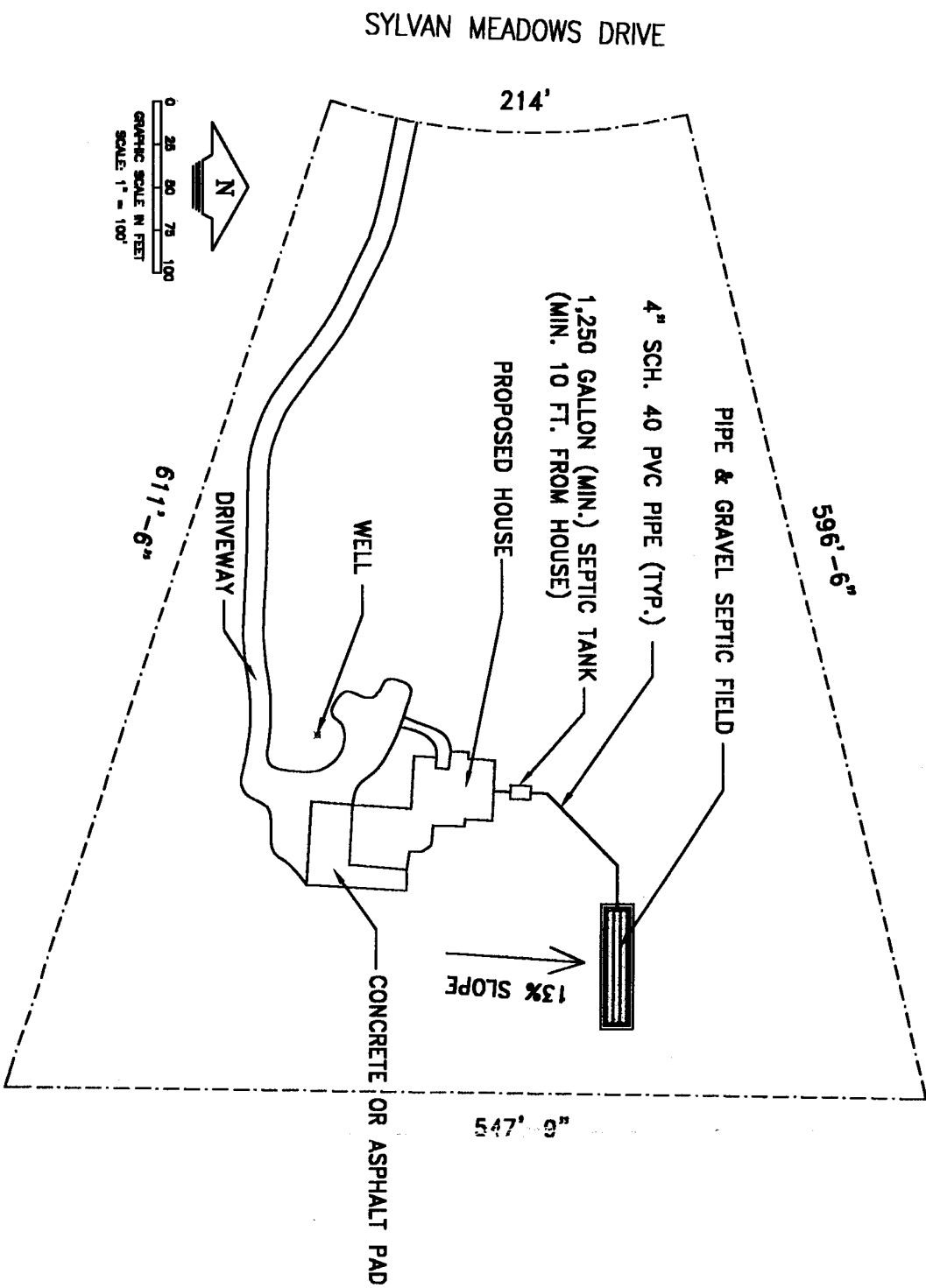

FRONT RANGE GEOTECHNICAL, INC.
 267 N. WASHINGTON STREET
 MONTUMENT, CO 80132
 OFFICE: (719) 481-4580
 FAX (719) 481-9204

ALL BENDS LIMITED TO 45 DEGREE ELLS OR LONG SWEEP QUARTER BENDS
 4" SCH 40 PVC PIPE. AREAS UNDER DRIVEWAYS SHALL BE PROTECTED AS
 PER EL PASO COUNTY REGULATIONS
 BUILDING SEWER CLEAN-OUTS SHALL BE INSTALLED AT INTERVALS NOT TO EXCEED
 50 FEET IN STRAIGHT RUNS AND WHEN THE CUMULATIVE CHANGE IN DIRECTION
 EXCEEDS 135 DEGREES.
 SOIL CONDITIONS TO BE VERIFIED BY SOIL ENGINEER AT TIME OF INSTALLATION

NOTES:

ALL WORK PER EL PASO COUNTY HEALTH
 DEPARTMENT CRITERIA
 GRADE SURROUNDING AREA TO DRAIN AWAY
 FROM FIELD.
 MAINTAIN 2.0% MIN AND 3.0% MAX GRADE ON
 PIPE FEEDING SEPTIC TANK. MAINTAIN 2.0%
 MIN GRADE ON PIPE FEEDING FIELD.
 CONTRACTOR/HOMEOWNER IS RESPONSIBLE FOR PERMIT.
 CONTRACTOR/HOMEOWNER MUST OBTAIN APPROVAL OF
 ENGINEERED SYSTEM FROM EL PASO COUNTY
 HEALTH DEPARTMENT. CONTRACTOR/HOMEOWNER
 MUST VERIFY SETBACKS AND OBTAIN UTILITY
 CLEARANCES PRIOR TO CONSTRUCTION.
 VEHICULAR OR HOOFED ANIMAL TRAFFIC OF
 ANY KIND OVER ANY PART OF SYSTEM MAY
 CAUSE PREMATURE FAILURE AND IS PROHIBITED.
 REFER TO SHEET 2 FOR DETAILS.

A SUMP & PUMP MAY BE REQUIRED IF
 GRAVITY FEED TO FIELD CAN NOT BE
 ESTABLISHED.

INSPECTIONS REQUIRED ARE AS FOLLOWS:

- 1.) ENGINEER TO VERIFY FIELD LOCATION
 AT TIME OF CONSTRUCTION.
- 2.) ENGINEER WILL INSPECT THE INSTALLATION
 OF PIPE & GRAVEL BED, SEPTIC TANK ETC.
 PRIOR TO BACKFILL.
- 3.) ENGINEER TO INSPECT THE FIELD AFTER
 BACKFILL TO INSURE MIN. COVER AND
 PROPER DRAINAGE AWAY FROM FIELD.



Project: 01017	Project Name and Address
Sheet: 1 of 2	RON & JANE OHOLENDT
Date: 8/21/2001	LOT 21, FILING 2,
FRG Job#: 884-1	SYLVAN MEADOWS SUBDIVISION
Drawn by: MRK	12643 FULLFORD COURT
Checked by: MRR	EL PASO COUNTY, CO

NOTES:
 ALL WORK PER EL PASO COUNTY HEALTH DEPARTMENT CRITERIA.

ABSORPTION FIELD SHALL BE CROWNED AND COVERED WITH A MINIMUM OF 6 INCHES OF SELECT TOPSOIL TO PROVIDE A BASE FOR GOOD VEGETATIVE COVER.

CONTACT SOIL CONSERVATION SERVICE OR COUNTY EXTENSION AGENT FOR VEGETATION BEST SUITED FOR THE AREA. VEGETATION SHALL BE MAINTAINED AND MOWED TO PREVENT FORMATION OF BIO-MATting ON MOUND

PROVIDE 2.0% MIN & 3.0% MAX GRADE ON PIPE TO SEPTIC TANK. PROVIDE 2.0% MIN GRADE ON PIPE TO FIELD.

PROVIDE DRAINAGE SWALE AROUND UPHILL SIDE OF FIELD.

SPECIAL NOTE:
 SAND FOR ABSORPTION BED TO BE IMPORTED FROM OFF SITE AS NECESSARY TO PLACE UNDER BED; ENGINEER TO APPROVE.
 SEE COUNTY REGULATIONS FOR SAND AND GRAVEL (ROCK) SPECIFICATIONS

PROVIDE MIN. OF 18" (30" MAX.) COVER OVER PIPE AND GRAVEL BED
 CROWN TOP OF MOUND COVERING PIPE AND GRAVEL BED TO PREVENT PONDING OF WATER
 MAINTAIN 3 TO 1 SLOPE AT BOTTOM OF BED

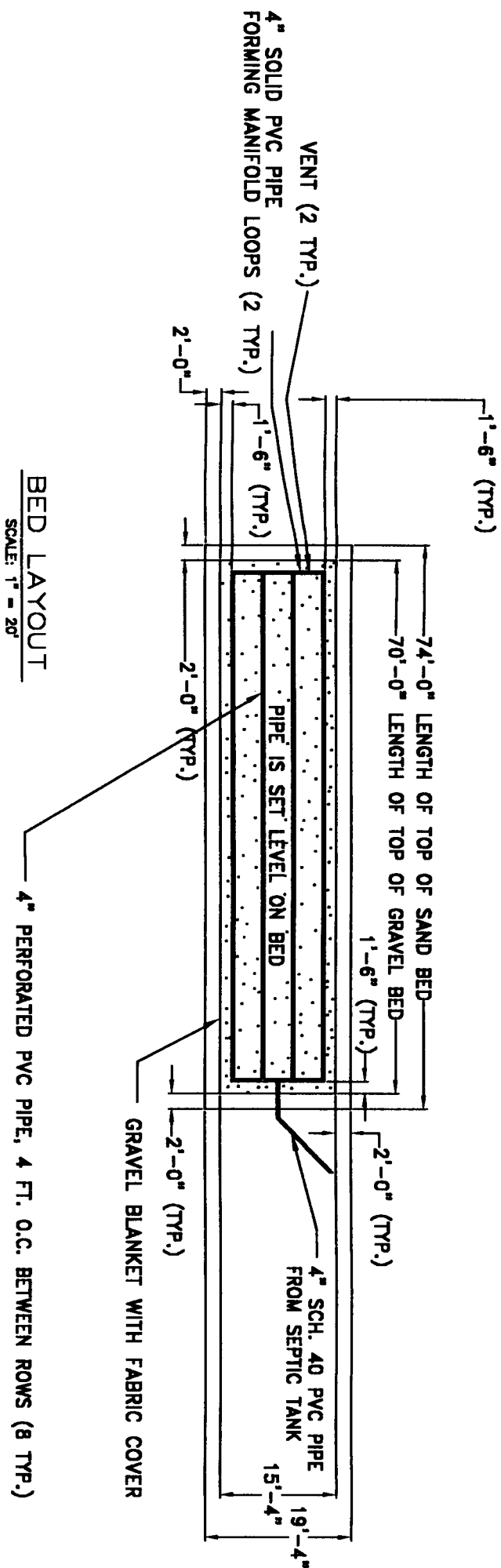

MOUND OVER ALL PIPE AS NECESSARY TO MAINTAIN 18" MINIMUM COVER

19'-4" WIDTH OF TOP OF SAND BED
 15'-4" WIDTH OF TOP OF GRAVEL BED
 MUST PLANT W/NATIVE GRASSES AND MAINTAINED (SEE NOTES)
 6" TOPSOIL ABOVE FILL SAND

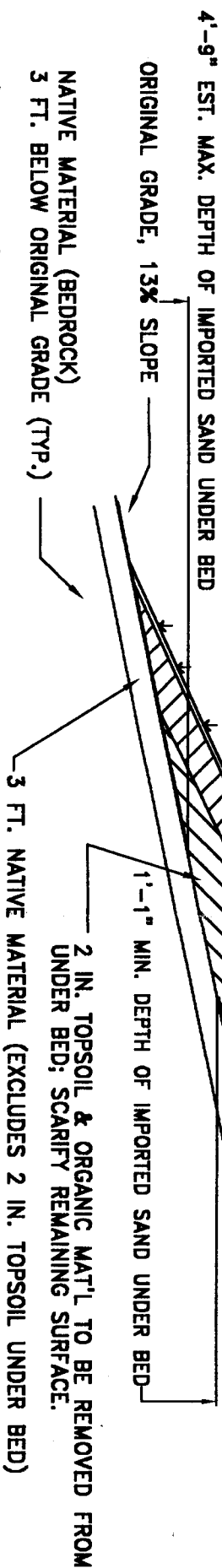

USE SAND FILL ABOVE NATIVE (NON-BEDROCK) SOIL TO MAINTAIN A MINIMUM OF FOUR FEET OF SOIL BETWEEN BOTTOM OF THE PIPE AND GRAVEL BED AND THE TOP OF THE BEDROCK LAYER.
 PIPE SHALL BE SET LEVEL IN GRAVEL BED CONSISTING OF:

- 2 IN. GRAVEL ABOVE PIPES IN BED
- 4 IN. GRAVEL AROUND PIPES IN BED
- 6 IN. GRAVEL BELOW PIPES IN BED

SAND FILL SHALL BE USED UNDER GRAVEL BED TO LEVEL BED.

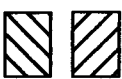

IMPORTED SAND COVER ABOVE PIPE & GRAVEL BED AND PIPES AS REQUIRED TO COVER
 IMPORTED SAND FILL UNDER PIPE & GRAVEL BED AS REQUIRED TO LEVEL BED

BED SECTION

SCALE: 1" = 20'



FRONT RANGE GEOTECHNICAL, INC.
 267 N. WASHINGTON STREET
 MONTUMENT, CO 80132
 OFFICE: (719) 481-4560
 FAX (719) 481-9204

Project: 01017	Project Name and Address
Sheet: 2 of 2	RON & JANE HOLENDT
Date: 8/21/2001	LOT 21, FILING 2,
FRG Job#: 9474	SYLVAN MEADOWS SUBDIVISION
Drawn by: MRK	12643 FULLFORD COURT
Checked by: MFR	EL PASO COUNTY, CO