

EROSION AND STORMWATER QUALITY CONTROL PERMIT (ESQCP) EL PASO COUNTY APPLICATION AND PERMIT

APPLICANT INFORMATION

PERMIT NUMBER

| Owner Information | |
|--|--|
| Owner | COLA, LLC |
| Name (person of responsibility) | Kevin Hart |
| Company/Agency | COLA, LLC |
| Position of Applicant | Manager |
| Address (physical address, not PO Box) | 555 Middle Creek Parkway, Suite 380 |
| City | Colorado Springs |
| State | Colorado |
| Zip Code | 80921 |
| Mailing address, if different from above | |
| Telephone | 719.382.9433 |
| FAX number | |
| Email Address | khart@aspviewhomes.com |
| Cellular Phone number | |
| Contractor/Operator Information | |
| Name (person of responsibility) | Unknown |
| Company | Unknown |
| Address (physical address, not PO Box) | |
| City | |
| State | Colorado |
| Zip Code | |
| Mailing address, if different from above | |
| Telephone | |
| FAX number | |
| Email Address | |
| Cellular Phone number | |
| Erosion Control Supervisor (ECS)* | |
| ECS Phone number* | |
| ECS Cellular Phone number* | |

*Required for all applicants. May be provided at later date pending securing a contract when applicable.

PROJECT INFORMATION

| Project Information | |
|--|---|
| Project Name | Trails at Aspen Ridge Filing No. 2 |
| Legal Description | See attached |
| Address (or nearest major cross streets) | Powers Boulevard and Bradley Road |
| Acreage (total and disturbed) | Total: 24 acres Disturbed: 25 acres |
| Schedule | Start of Construction: November 2019 Completion of Construction: Unknown Final Stabilization: Unknown |
| Project Purpose | 98 Single Family Lots |
| Description of Project | Grading, Utilities and drainage for 98 single family lots |
| Tax Schedule Number | 5500000412 |

FOR OFFICE USE ONLY

The following signature from the ECM Administrator signifies the approval of this ESQCP. All work shall be performed in accordance with the permit, the El Paso County Engineering Criteria Manual (ECM) Standards, City of Colorado Springs Drainage Criteria Manual, Volume 2 (DCM2) as adopted by El Paso County Addendum, approved plans, and any attached conditions. The approved plans are an enforceable part of the ESQCP. Construction activity, except for the installation of initial construction BMPs is not permitted until issuance of a Construction permit and Notice to Proceed.

Signature of ECM Administrator: _____

Date _____

1.1 REQUIRED SUBMISSIONS

In addition to this completed and signed application, the following items must be submitted to obtain an ESQCP:

- Permit fees
- Stormwater Management Plan (SWMP) meeting the requirements of DCM2 and ECM either as part of the plan set or as a separate document;
- Cost estimates of construction and maintenance of construction and permanent stormwater control measures (Cost estimates shall be provided on a unit cost basis for all stormwater BMPs);
- Financial surety in an amount agreeable to the ECM Administrator based on the cost estimates of the stormwater quality protection measures provided. The financial surety shall be provided in the form of a Letter of Credit, Surety with a Bonding Company, or other forms acceptable to El Paso County;
- Operation and Maintenance Plan for any proposed permanent stormwater control measures; and
- Signed Private Detention Basin/Stormwater Quality Best Management Practice Maintenance Agreement and Easement, if any permanent stormwater control measures are to be located on site.

1.2 RESPONSIBILITY FOR DAMAGE

The County and its officers and employees, including but not limited to the ECM Administrator, shall not be answerable or accountable in any manner, for injury to or death of any person, including but not limited to a permit holder, persons employed by the permit holder, persons acting in behalf of the permit holder, or for damage to property resulting from any activities undertaken by a permit holder or under the direction of a permit holder. The permit holder shall be responsible for any liability imposed by law and for injuries to or death of any person, including but not limited to the permit holder, persons employed by the permit holder, persons acting in behalf of the permit holder, or damage to property arising out of work or other activity permitted and done by the permit holder under a permit, or arising out of the failure on the permit holder's part to perform the obligations under any permit in respect to maintenance or any other obligations, or resulting from defects or obstructions, or from any cause whatsoever during the progress of the work, or other activity, or at any subsequent time work or other activity is being performed under the obligations provided by and contemplated by the permit.

To the extent allowed by law, the permit holder shall indemnify, save, and hold harmless the County and its officers and employees, including but not limited to the BOCC and ECM Administrator, from all claims, suits or actions of every name, kind and description brought for or on account of injuries to or death of any person, including but not limited to the permit holder, persons employed by the permit holder, persons acting in behalf of the permit holder and the public, or damage to property resulting from the performance of work or other activity under the permit, or arising out of the failure on the permit holder's part to perform his obligations under any permit in respect to maintenance or any other obligations, or resulting from defects or obstructions, or from any cause whatsoever during the progress of the work, or other activity or at any subsequent time work or other activity is being performed under the obligations provided by and contemplated by the permit, except as otherwise provided by state law. The permit holder waives any and all rights to any type of expressed or implied indemnity against the County, its officers or employees.

1.3 APPLICATION CERTIFICATION

We, as the Applicants or the representative of the Applicants, hereby certify that this application is correct and complete as per the requirements presented in this application and the El Paso County Engineering Criteria Manual and Drainage Criteria Manual, Volume 2 and El Paso County Addendum.

We, as the Applicants or the representatives of the Applicants, have read and will comply with all of the requirements of the specified Stormwater Management Plan and any other documents specifying stormwater best management practices to be used on the site including permit conditions that may be required by the ECM Administrator. We understand that the stormwater control measures are to be maintained on the site and revised as necessary to protect stormwater quality as the project progresses. We further understand that a Construction Permit must be obtained and all necessary stormwater quality control measures are to be installed in accordance with the SWMP, the El Paso County Engineering Criteria Manual, Drainage Criteria Manual, Volume 2 and El Paso County Addendum before land disturbance begins and that failure to comply will result in a Stop Work Order and may result in other penalties as allowed by law. We further understand and agree to indemnify, save, and hold harmless the County and its officers and employees, including but not limited to the BOCC and ECM Administrator, from all claims, suits or actions of every name, kind and description as outlined in Section 1.2 Responsibility for Damage.



Date: 10.25.19

Signature of Owner or Representative

TIM BUSCHAR

Print Name of Owner or Representative

Date: _____

Signature of Operator or Representative

Print Name of Operator or Representative

Permit Fee \$ _____

Surcharge \$ _____

Financial Surety \$ _____

Type of Surety _____

Total \$ _____

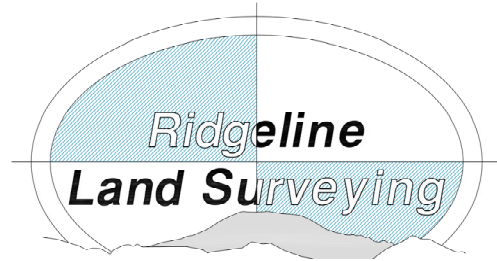

31. E Platte Ave., Ste 206
Colorado Springs, CO 80903
719-238-2917

THE TRAILS AT ASPEN RIDGE FILING NO.2 LEGAL DESCRIPTION:

ALL OF TRACT Q AND TRACT R, THE TRAILS AT ASPEN RIDGE FILING NO.1, RECORDED AT RECEPTION NO. 220714541 OF THE RECORDS OF THE EL PASO COUNTY CLERK AND RECORDERS OFFICE, LOCATED IN A PORTION OF THE WEST 1/2 OF SECTION 9, TOWNSHIP 15 SOUTH, RANGE 65 WEST OF THE 6TH P.M., EL PASO COUNTY, COLORADO.

THE ABOVE TRACTS OF LAND CONTAIN 112.968 ACRES, MORE OR LESS.