

WATER DEMAND AND WASTEWATER DISPOSAL REPORT

FOR

**CARRIAGE MEADOWS NORTH
FILING NO. 1**

FINAL PLAT

December 7, 2017

Prepared for:

Lorson. LLC
212 N. Wahsatch, Suite 301
Colorado Springs, Colorado 80903
Contact: Jeff Mark
(719) 635-3200

Prepared by:

Core Engineering Group
15004 1st Avenue S.
Burnsville, MN 55306
719-570-1100

Project No. 100.002

TABLE OF CONTENTS

1.0 INTRODUCTION.....	1
2.0 WATER SUPPLY AND WASTEWATER COLLECTION.....	2
3.0 SUMMARY AND CONCLUSIONS.....	3

APPENDIX A

VICINITY MAP

WATER SUPPLY INFORMATION SUMMARY

COMMITMENT LETTER

APPENDIX B

2016 WWSD ANNUAL WATER AND WASTEWATER REPORT, JDS
HYDRO

1.0 INTRODUCTION

The proposed 1361.4 acre Lorson Ranch is located in El Paso County and is bounded on the west by Marksheffel Road, the east by existing ranch land and the future Meridian Road, the north by Banning Lewis Ranch and unplatted property, and on the south by Peaceful Valley Estates, a rural and urban residential subdivision and the Appletree golf course. **Carriage Meadows North Filing No. 1** is a 48.2acre site within Lorson Ranch. The site is located in the NE corner of Fontaine Boulevard and Marksheffel Road. The legal description for this site is:

BASIS OF BEARING: THE EAST-WEST CENTERLINE OF SECTION 14, T15S, R65W, OF THE 6TH P.M. EL PASO COUNTY, COLORADO AS MONUMENTED. THE QUARTER CORNER COMMON TO SECTION 14 AND SECTION 15 IS A 3.25 INCH ALUMINUM CAP STAMPED "J.R. DEVELOPERS, T15S R65W, E1/4 S15 W1/4 S14, 1986, PLS 10377" FROM WHICH THE CENTER OF SECTION 14 BEARS N89°42'02"E, 2646.02 FEET AND IS MONUMENTED BY A 3.25 IN ALUMINUM CAP STAMPED "KM, T15S R65W, S14, C1/4, 2004, LS 16109".

A PARCEL OF LAND IN THE SOUTHEAST QUARTER (SE 1/4) OF SECTION 15 AND IN THE SOUTHWEST QUARTER (SW 1/4) OF SECTION 14, T15S, R65W OF THE 6TH PRINCIPAL MERIDIAN, EL PASO COUNTY, COLORADO, MORE PARTICULARLY DESCRIBED AS:

BEGINNING AT A POINT ON THE SOUTHERLY LINE OF PARCEL NO. 21 AS DESCRIBED IN WARRANTY DEED UNDER RECEPTION NO. 214104176 IN THE RECORDS OF EL PASO COUNTY, COLORADO SAID POINT BEING THE QUARTER CORNER COMMON TO SECTION 14 AND SECTION 15, T15S, R65W OF THE 6TH P.M., EL PASO COUNTY COLORADO;
THENCE N89-42-02E ALONG SAID SOUTHERLY LINE, 192.66 FEET;
THENCE ALONG THE ARC OF A CURVE TO THE RIGHT, SAID CURVE HAVING A RADIUS OF 2030.00 FEET, A CENTRAL ANGLE OF 05°03'38", (THE CHORD OF WHICH BEARS S19-09-08W A DISTANCE OF 179.24 FEET), AN ARC DISTANCE OF 179.30 FEET;
THENCE ALONG THE ARC OF A CURVE TO THE LEFT, SAID CURVE HAVING A RADIUS OF 1240.00 FEET, A CENTRAL ANGLE OF 21°57'25", (THE CHORD OF WHICH BEARS S10-42-15W A DISTANCE OF 472.29 FEET), AN ARC DISTANCE OF 475.19 FEET;
THENCE S00-16-28E A DISTANCE OF 850.78 FEET;
THENCE ALONG THE ARC OF A CURVE TO THE LEFT, SAID CURVE HAVING A RADIUS OF 930.00 FEET, A CENTRAL ANGLE OF 30°42'13", (THE CHORD OF WHICH BEARS S15-37-34E A DISTANCE OF 492.43 FEET), AN ARC DISTANCE OF 498.37 FEET;
THENCE S30-58-32E A DISTANCE OF 128.77 FEET;
THENCE ALONG THE ARC OF A CURVE TO THE RIGHT, SAID CURVE HAVING A RADIUS OF 580.00 FEET, A CENTRAL ANGLE OF 34°19'25", (THE CHORD OF WHICH BEARS S13-48-49E A DISTANCE OF 342.28 FEET), AN ARC DISTANCE OF 347.45 FEET;
THENCE S03-20-53W A DISTANCE OF 189.10 FEET;
THENCE S89-27-28W A DISTANCE OF 183.12 FEET;
THENCE N87-28-23W A DISTANCE OF 87.83 FEET;
THENCE N47-38-17W A DISTANCE OF 61.43 FEET;
THENCE N83-57-54W A DISTANCE OF 90.63 FEET;
THENCE S43-43-48W A DISTANCE OF 49.76 FEET;
THENCE N84-44-11W A DISTANCE OF 81.43 FEET;
THENCE S89-27-28W A DISTANCE OF 679.00 FEET;
THENCE N35-13-35W A DISTANCE OF 113.92 FEET;
THENCE N14-49-54E A DISTANCE OF 298.16 FEET;
THENCE ALONG THE ARC OF A CURVE TO THE LEFT, SAID CURVE HAVING A RADIUS OF 12070.00 FEET, A CENTRAL ANGLE OF 01°57'34", (THE CHORD OF WHICH BEARS N13-51-07E A DISTANCE OF 412.74 FEET), AN ARC DISTANCE OF 412.76 FEET;

THENCE N14-51-00E A DISTANCE OF 109.41 FEET;
THENCE ALONG THE ARC OF A CURVE TO THE LEFT, SAID CURVE HAVING A RADIUS OF 5809.75 FEET, A CENTRAL ANGLE OF 00°58'38", (THE CHORD OF WHICH BEARS N14-21-44E A DISTANCE OF 99.09 FEET), AN ARC DISTANCE OF 99.09 FEET;
THENCE N76-07-58W A DISTANCE OF 8.19 FEET;
THENCE ALONG THE ARC OF A CURVE TO THE LEFT, SAID CURVE HAVING A RADIUS OF 12070.00 FEET, A CENTRAL ANGLE OF 05°31'33", (THE CHORD OF WHICH BEARS N09-06-53E A DISTANCE OF 1163.65 FEET), AN ARC DISTANCE OF 1164.10 FEET;
THENCE S89-53-02E A DISTANCE OF 62.40 FEET;
THENCE N00-41-16E A DISTANCE OF 57.06 FEET;
THENCE N89-53-02W A DISTANCE OF 56.87 FEET;
THENCE ALONG THE ARC OF A CURVE TO THE LEFT, SAID CURVE HAVING A RADIUS OF 12070.00 FEET, A CENTRAL ANGLE OF 01°47'06", (THE CHORD OF WHICH BEARS N05-11-13E A DISTANCE OF 376.01 FEET), AN ARC DISTANCE OF 376.02 FEET TO THE NORTH LINE OF THE SOUTHEAST QUARTER OF SECTION 15;
THENCE N89-28-36E ALONG SAID NORTH LINE 6.30 FEET TO THE SOUTHWEST CORNER OF AFORESAID PARCEL NO. 21 AS DESCRIBED IN WARRANTY DEED UNDER RECEPTION NO. 214104176;
THENCE N89-28-36E ALONG THE SOUTHERLY LINE THEREOF 496.10 FEET TO THE POINT OF BEGINNING.

SAID PARCEL CONTAINS A CALCULATED AREA OF 2,096,822 SQUARE FEET (48.136 ACRES), MORE OR LESS.
TOGETHER WITH A PARCEL OF LAND IN THE SOUTHWEST QUARTER OF SECTION 15, BEING A PORTION OF "EXHIBIT C" AS DESCRIBED IN THE POSSESSION AND USE AGREEMENT UNDER RECEPTION NO. 216022299 IN THE EL PASO COUNTY RECORDS, MORE PARTICULARLY DESCRIBED AS FOLLOWS;

COMMENCING AT THE QUARTER CORNER COMMON TO SECTION 14 AND SECTION 15, T15S, R65W OF THE 6TH P.M., EL PASO COUNTY COLORADO;
THENCE S54°45'03"W, 656.79 FEET TO THE EASTERLY LINE OF SAID "EXHIBIT C" BEING A POINT ON THE EASTERLY RIGHT-OF-WAY LINE OF MARKSHEFFEL ROAD;
THENCE SOUTHWESTERLY ALONG THE ARC OF A CURVE TO THE RIGHT, SAID CURVE HAVING A RADIUS OF 12070.00 FEET, A CENTRAL ANGLE OF 00°16'21", (THE CHORD OF WHICH BEARS S06°-13'-04"W, 57.38 FEET), AN ARC DISTANCE OF 57.38 FEET;
THENCE S89-53-02E A DISTANCE OF 62.40 FEET;
THENCE N00-41-16E A DISTANCE OF 57.06 FEET;
THENCE N89-53-02W A DISTANCE OF 56.87 FEET TO THE POINT OF BEGINNING;

SAID PORTION OF "EXHIBIT C" CONTAINS 3,401 S.F. MORE OR LESS.

SAID TRACT OF LAND CONTAINS 48.21 ACRES OF LAND, MORE OR LESS.

This site contains 155 new single family lots and several tracts for open space and future commercial development.

2.0 WATER SUPPLY AND WASTEWATER COLLECTION

The development is located within the service boundary of the Widfield Water and Sanitation District (WWSD). A commitment letter is included in Appendix A from WWSD for this project.

Existing Infrastructure

The WWSD has an existing 16" diameter potable water main located on the west side of Marksheffel Road directly adjacent to Lorson Ranch. In addition, a 24" water main is constructed from the Goldfield tanks (Powers Blvd.) to Lorson Ranch. On-site watermain consists of a 24" watermain in Fontaine Boulevard and a 12" watermain in Old Glory Drive. One 12" watermain stub has been provided at Fontaine/Carriage Meadows Drive. This main will provide potable water service to this site.

The WWSD has a regional lift station south of Lorson Ranch at Marksheffel Road and Mesa Ridge Parkway that will be used to provide wastewater gravity service to Lorson Ranch. Sewer infrastructure currently exists in Fontaine Boulevard and at the southern property line of this site.

Water Serviceability

The WWSD's has a current developed physical water supply of 5246 ac-ft of water per year and the current demand is 2248 ac-ft per year which is roughly 43% of the existing physical supply.

Wastewater Serviceability

The WWSD collects and treats wastewater from users within its service area at the WWCD treatment plant located near Hwy 16 and Fountain Creek. The treatment plant has a current hydraulic capacity of **2.5 MGD**. Currently, the plant is operating at a capacity of **1.43 MGD**. The District has the capability to treat an additional **1.07 MGD** with its existing plant.

Water Demand

Water Demand calculations were completed based on the proposed zoning and densities. Water demand is 0.35 ac-ft/year for each single family lot. This subdivision also includes irrigation for landscaping along Marksheffel Road which has been estimated at 5 single family equivalents.

The new water commitments are 54.25 ac-ft per year for the 155 lots and 1.75 ac-ft for the landscaping for a total new commitment of 56.00ac-ft.

Wastewater Demand

Sewer loading calculations were completed based on the proposed zoning and densities. Sanitary loads of 211.6 Gal/Unit for single family residential lots can be expected.

Based on the wastewater loading, the total wastewater load projected for this site is 0.0328MGD for the 155 lots.

3.0 SUMMARY AND CONCLUSIONS

The maximum allowable water demand and the anticipated wastewater contributions from the proposed Carriage Meadows North Filing No. 1 are as follows:

<u>Item</u>	<u>ac. ft./yr</u>	<u>Avg. Daily Flow (gpd)</u>
Water Demand	56.00	49,985
Wastewater Flow		32,800

The Widefield Water and Sanitation District has an excess capacity in their existing water supply system to serve this subdivision

The WWSD has excess capacity at their existing wastewater treatment plant to treat an additional **1.07 MGD** of wastewater effluent. The proposed development will only contribute an additional **0.049 MGD** of flow to the existing plant.

Construction costs of proposed off-site infrastructure have not been included in this report since there isn't any.

In conclusion, the proposed development is within the limits of the District's ability to serve it both with water and wastewater collection. Water and wastewater infrastructure is onsite, thus, no unusual costs will be incurred by the district or the Developer in developing this project.

**APPENDIX A –
VICINITY MAP, WATER SUPPLY INFORMATION, COMMITMENT LETTER**

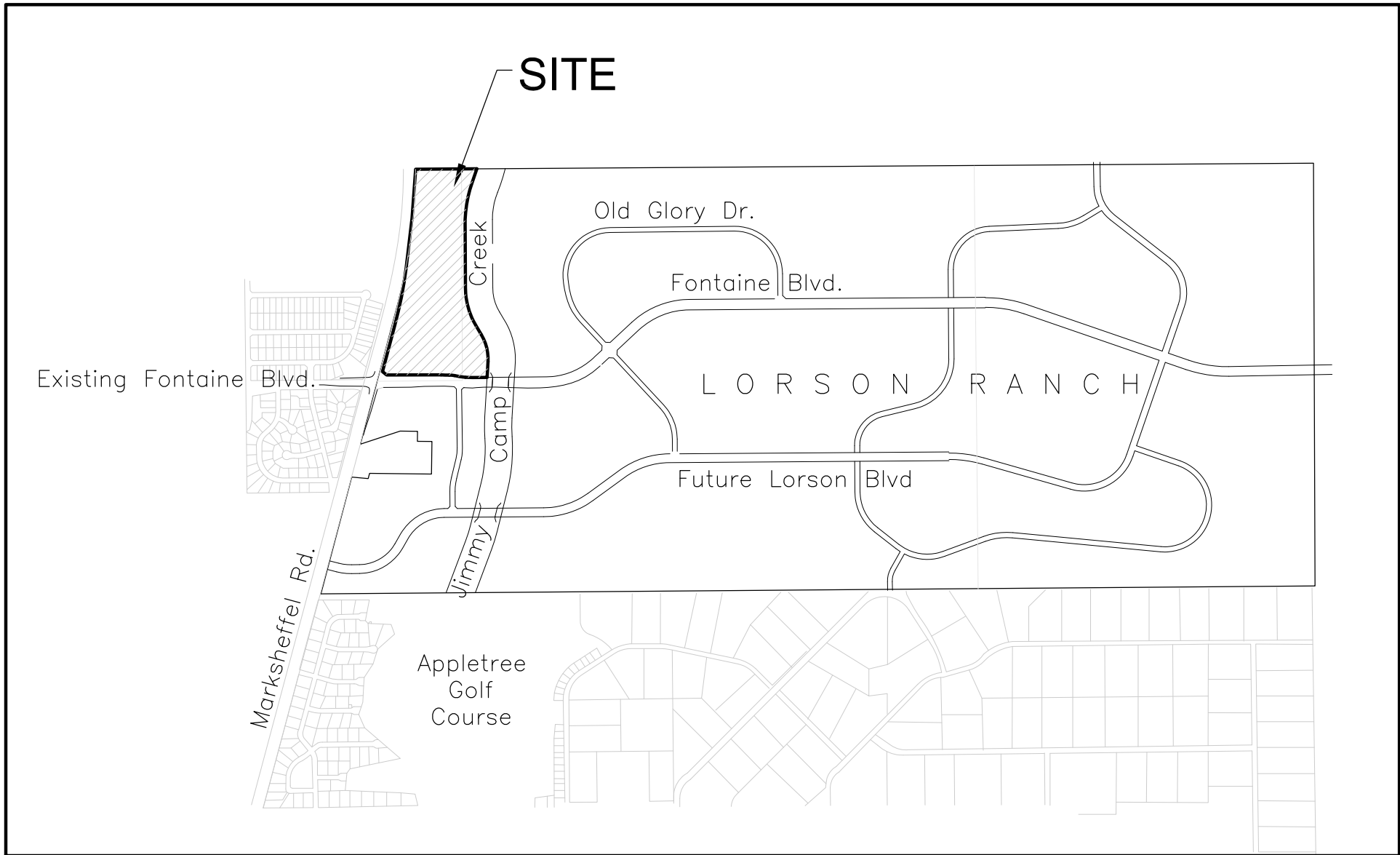

VICINITY MAP

NO SCALE

WATER SUPPLY INFORMATION SUMMARY

Section 30-28-133(d), C.R.S. requires that the applicant submit to the County, "Adequate evidence that a water supply that is sufficient in terms of quantity, quality and dependability will be available to ensure an adequate supply of water."

1. NAME OF DEVELOPMENT AS PROPOSED Carriage Meadows North Filing No. 1					
2. LAND USE ACTION Final Plat					
3. NAME OF EXISTING PARCEL AS RECORDED					
SUBDIVISION	FILING	BLOCK	LOT		
4. TOTAL ACREAGE 48.21	5. NUMBER OF LOTS PROPOSED 155	PLAT MAP ENCLOSED <input type="checkbox"/> YES			
6. PARCEL HISTORY - Please attach copies of deeds, plats or other evidence or documentation.					
A. Was parcel recorded with county prior to June 1, 1972? <input type="checkbox"/> YES <input checked="" type="checkbox"/> NO					
B. Has the parcel ever been part of a division of land action since June 1, 1972? <input type="checkbox"/> YES <input type="checkbox"/> NO					
If yes, describe the previous action _____					
7. LOCATION OF PARCEL - Include a map delineating the project area and tie to a section corner.					
SE 1/4 OF SECTION 15 AND SW 1/4 of Section 14 SECTION 15 TOWNSHIP 15 <input type="checkbox"/> N <input checked="" type="checkbox"/> S RANGE 65 <input type="checkbox"/> E <input checked="" type="checkbox"/> W					
PRINCIPAL MERIDIAN: <input checked="" type="checkbox"/> 6TH <input type="checkbox"/> N.M. <input type="checkbox"/> UTE <input type="checkbox"/> COSTILLA					
8. PLAT - Location of all wells on property must be plotted and permit numbers provided. Surveyors plat <input type="checkbox"/> Yes <input type="checkbox"/> No If not, scaled hand drawn sketch <input type="checkbox"/> Yes <input type="checkbox"/> No					
9. ESTIMATED WATER REQUIREMENTS - Gallons per Day or Acre Feet per Year		10. WATER SUPPLY SOURCE			
HOUSEHOLD USE # 155 of units 48,423 GPD 54.25 AF	COMMERCIAL USE # _____ of S.F. _____ GPD _____ AF	<input type="checkbox"/> EXISTING WELLS WELL PERMIT NUMBERS _____ <input type="checkbox"/> DEVELOPED SPRING _____ <input type="checkbox"/> NEW WELLS - PROPOSED AQUIFERS - (CHECK ONE) <input type="checkbox"/> ALLUVIAL <input type="checkbox"/> UPPER ARAPAHOE <input type="checkbox"/> UPPER DAWSON <input type="checkbox"/> LOWER ARAPAHOE <input type="checkbox"/> LOWER DAWSON <input type="checkbox"/> LARAMIE FOX HILLS <input type="checkbox"/> DENVER <input type="checkbox"/> DAKOTA <input type="checkbox"/> OTHER _____	WATER COURT DECREE CASE NO.'S _____ _____ _____		
IRRIGATION # _____ of acres _____ GPD _____ AF	STOCK WATERING # _____ of head _____ GPD _____ AF				
OTHER Irrigation 1,562 GPD 1.75 AF	TOTAL 49,985 GPD 56.00 AF				
<input type="checkbox"/> MUNICIPAL <input type="checkbox"/> ASSOCIATION <input type="checkbox"/> COMPANY <input checked="" type="checkbox"/> DISTRICT NAME Widefield W+S				LETTER OF COMMITMENT FOR SERVICE <input type="checkbox"/> YES <input type="checkbox"/> NO	
11. ENGINEER'S WATER SUPPLY REPORT <input type="checkbox"/> YES <input type="checkbox"/> NO IF YES, PLEASE FORWARD WITH THIS FORM. (This may be required before our review is completed.)					
12. TYPE OF SEWAGE DISPOSAL SYSTEM					
<input type="checkbox"/> SEPTIC TANK/LEACH FIELD		<input checked="" type="checkbox"/> CENTRAL SYSTEM - DISTRICT NAME Widefield W+S District			
<input type="checkbox"/> LAGOON		<input type="checkbox"/> VAULT - LOCATION SEWAGE HAULED TO _____			
<input type="checkbox"/> ENGINEERED SYSTEM (Attach a copy of engineering design)		<input type="checkbox"/> OTHER _____			



8495 Fontaine Boulevard, Colorado Springs, Colorado 80925

December 7, 2017

Jeff Mark
Landhuis Company
212 North Wahsatch, Suite 301
Colorado Springs, Colorado 80903

Cole Emmons
County Attorney's Office
27 East Vermijo Avenue
Colorado Springs, Colorado 80903

Re: Commitment Letter for Carriage Meadows North Filing No. 1—Final Plat

Dear Jeff and Cole:

This commitment is for a subdivision which was committed to in 2007. The original commitment letter expired due to time and is being re-instated and modified as follows;

Widefield Water and Sanitation District commits to and will serve water and sewer to the above named PUD subdivision which includes approximately **155 single family lots and partial active landscaping within Tract B. The water commitment is based on the recently revised Widefield standard of 0.35 AF/SFE and is 56.00 AF-year.** The expected **wastewater loads are 32,800 gallons/day** on an average daily-maximum monthly basis.

Sincerely,
Widefield Water and Sanitation District

A handwritten signature in blue ink that reads "Rob Bannister".

Rob Bannister, District Engineer

C: Steve Wilson, General Manager
Brandon Bernard, Water Superintendent
Mark McCormick, Wastewater Superintendent
John McGinn, PE,

**APPENDIX B –
2016 WWSD ANNUAL WATER AND WASTEWATER REPORT, JDS HYDRO**

WIDEFIELD WATER AND SANITATION DISTRICT

37 Widefield Blvd

Security, CO 80911

District Water and Wastewater Report

Annual Update

Date of Update January 1, 2016

Update Author John P. McGinn, PE;

District Engineer for Widefield Water and Sanitation District,
JDS-Hydro Consultants, Inc.

Attachments

- Widefield Water Facilities Map (2 sheets)
- Widefield 2015 Water Quality Consumer Confidence Report
- End of 2015 Year Commitment Balance Sheet

1. Water General

The Widefield Water and Sanitation District's Water System was originally created in the 1960's and has been expanded for nearly 50 years. The system serves approximately 8000 single family equivalent households.

All water supply is based on surface water rights, renewable groundwater, and a mix of various sources. The system does not rely on any non-renewable water sources.

The current Legal Water Supply Holdings of the District are estimated at 9495 annual acre-feet.

The current Developed Physical Supply is 5246 annual acre-feet. The three year running average actual use is 2248 acre-feet which is roughly 43% of the existing available physical supply.

A revised table of active commitments, and completed subdivisions is attached. This table is valid as of January 1, 2016.

2. **Recent Water Volumes Used** The recent three years water use and tap data are as follows;

Year	Annual Use (Acre-feet)	Single Family Equivalent (Taps in SFE)
2013	2318	7632 (corrected)
2014	2309.	7797 (corrected)
2015	2117	8058

3. **Water Supply**

Changes in Water Supply There have been NO RECENT CHANGES in the Widefield Water Supply Inventory in the last 3 years, since the last Full Report. All existing sources have been previously documented on file at County Attorney’s office.

Listing of Water Supplies:

Renewable Groundwater; All sources previously documented at County Attorney’s office

- Widefield Aquifer; Widefield is allocated the use of 2575 annual acre-feet through the Widefield Aquifer Stipulation
- Jimmy Camp Aquifer; Widefield is allocated 650 annual acre-feet through the Widefield Aquifer Stipulation
- Vennetucci Lease: Widefield is perpetually leased an allocation of 596 annual acre-feet through a Public Trust Partnership which provides for funding of the Vennetucci Trust Farm through water revenues on a perpetual basis. This is currently subleased to the City of Fountain through the year 2017.

Surface Water Supplies: Sources documented at County Attorney’s Office

- Widefield owns 1500 annual acre-feet of the Fountain Valley Authority Project which safely yields 1425 annual acre-feet of fully consumable water.
- Widefield has 812 shares of Fountain Mutual Irrigation Water and is the owner/operator of the Crews Gulch Augmentation Station as this supply is used in augmentation or leased out on an annual basis, as it has never been fully needed.

- Widefield owns roughly 1025 annual acre-feet of return flows from CSU's portion of the FVA project. This is used in augmentation, but is mostly leased out annually because demand has not required the need.
- Widefield owns a mix of senior surface water supplies and out-of-priority water supplies that total 1351 annual acre-feet. This is the fully consumable portion and this water is leased out and has not been developed into physical supply.

Potential or intended Future Supplies

Although Widefield does have active cases that are intended to extend supplies, the District does not wish to disclose the volumes or nature of those supplies that are in active acquisition states.

Legal Documentation accompanying new water acquisitions and augmentations plans

None

4. Widefield Water Quality

The water quality provided by the Widefield Water and Sanitation District meets or exceeds all required State and Federal Drinking Water Standards. For a detailed water quality report, please see the Widefield Consumer Confidence Report which is updated annually and accessible at <http://wwsdonline.com/index.php?page=consumer-confidence-report>. A 2015 copy is attached.

5. Widefield Physical Water System

The Widefield System is too large to show all lines and facilities, the attachment shows the major facilities. The Widefield Water System consists of:

Service area of roughly 10 square miles.

Pipelines over 550,000 linear feet varying in size from 4 to 30 inches in diameter

Seven Water Tanks totaling roughly 10.0 Million Gallons

Five Pressure Zones

Three Booster Stations

24 Inch Transmission from FVA

Participation in Pueblo Reservoir and Frying Pan Arkansas Water project

Two Water Treatment Plants

Eleven Active Wells (not including inactive or the Vennetucci System)

6. Major capital improvements accomplished during recent years and anticipated improvements for the upcoming years

- Most Recent Three Years Upgrades to water facilities include the following:
 - Begin Development of West to East Transmission Line: This project includes certain transmission line upgrades which will continue over the next 10 years
 - Replacement of well equipment in three Widefield and Jimmy Camp wells. (No addition to sources)
 - Repair and Rehabilitation of a 2.1 MG Tank
- Expected Upcoming 3 Years Improvements - These are all system-wide capital projects.
 - No additional Sources
 - Phase IV West to East Transmission System
 - Repair and changes to Well C-1
 - Demolition of two older tanks and reconstruction of one tank
 - Relocation of JHW-2 Well
 - Well Manifolding

Wastewater Report Update

1. Wastewater General

The Widefield Water and Sanitation District's Wastewater System was originally created in the 1960's and has been expanded for nearly 50 years. The system serves over 8000 single family equivalent households.

The current hydraulic capacity of the Widefield Wastewater Treatment Plant is 2.50 MGD. *Note—WWTP are rated on the basis of Average daily Maximum Monthly Flow, which differs from Max Day Flow.* There have been no increases to plant capacity since 2001.

The treatment plant discharges to Lower Fountain Creek.

Current 3 year running average loading is 1.43 MGD which is roughly 58% of Plant Capacity.

Current projected use plus active commitments are projected to be roughly 1.69 MGD which represents about 66% of Current Hydraulic Plant Capacity. *Note—WWTP are rated on the basis of Average daily Maximum Monthly Flow, which differs from Max Day Flow.*

2. Actual Wastewater Volumes Treated

The recent three years wastewater plant loads and tap data are as follows:

Year	Average Daily Flow (MGD)	Single Family Equivalent (Taps in SFE)
2013	1.47	7724 (Corrected)
2014	1.44	7885 (Corrected)
2015	1.40	8131

Note; Widefield provided wastewater treatment to Colorado Centre Metropolitan District from late 2011 through mid 2014.

3. Existing Widefield Wastewater System

The Widefield Water System consists of:

Service area of roughly 10 square miles.

Pipelines over 570,000 linear feet varying in size from 8 to 24 inches in diameter

Five Lift Stations

Wastewater Treatment Plant—2.5 MGD Capacity

The existing wastewater plant remains in compliance with CDPHE Discharge Standards.

4. Major capital improvements accomplished during the past year and anticipated improvements for the upcoming year

- Most Recent Three Years: Upgrades to wastewater facilities include the following:

Some replacement of older lines in older areas of the District

- Expected Upcoming Three Years Improvements

Upgrade of Treatment systems to meet future Regulation 85 requirements. This upgrade includes Bio-nutrient Removal required by 2019. This is not expected to include increases in capacity.

Continued Line replacement of older lines

Upgrades of solids handling

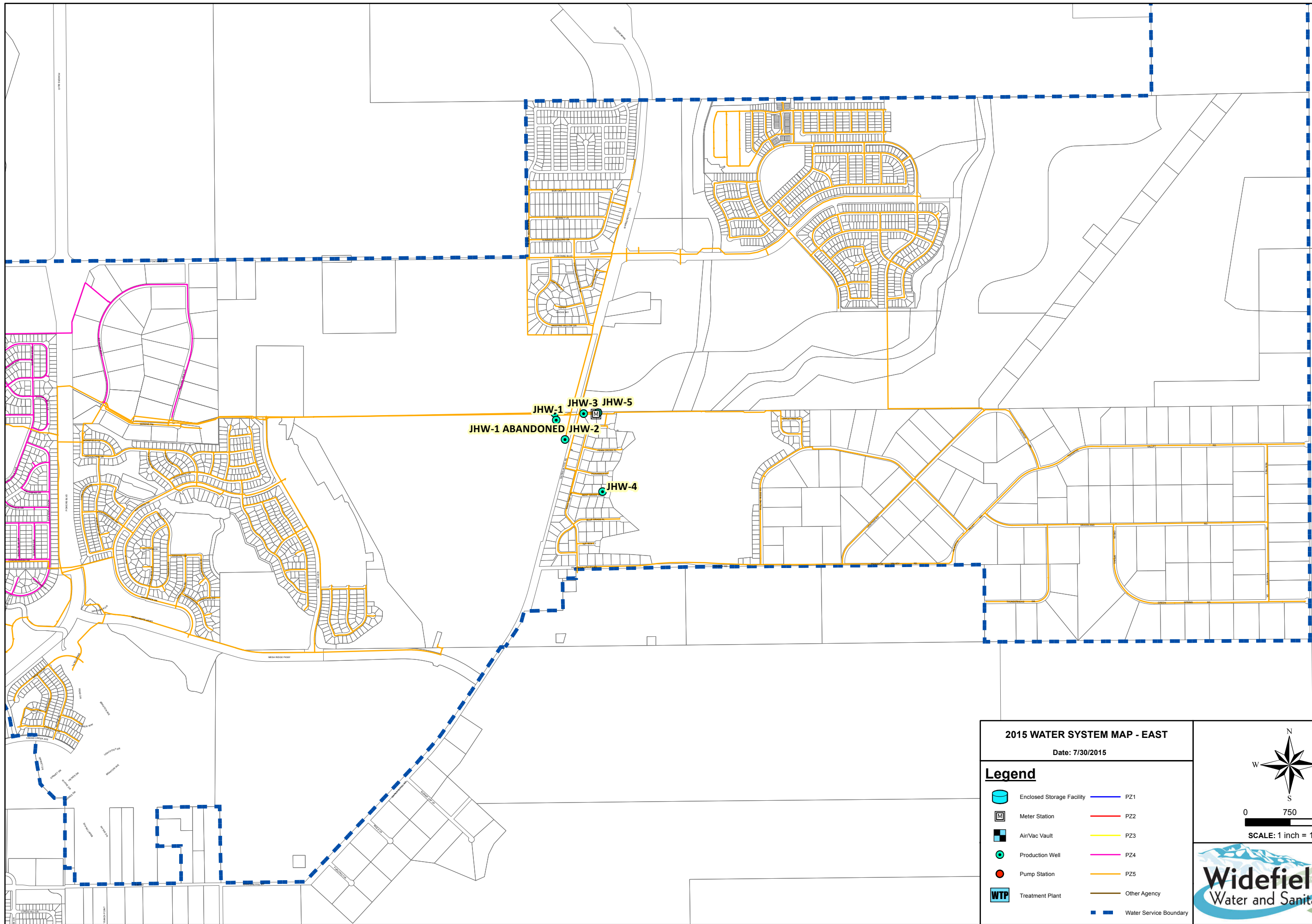

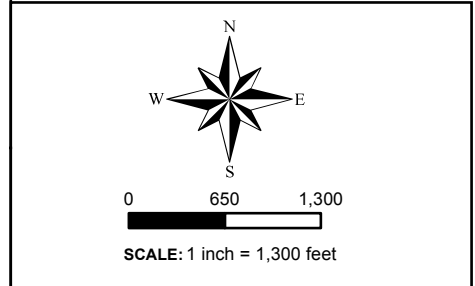
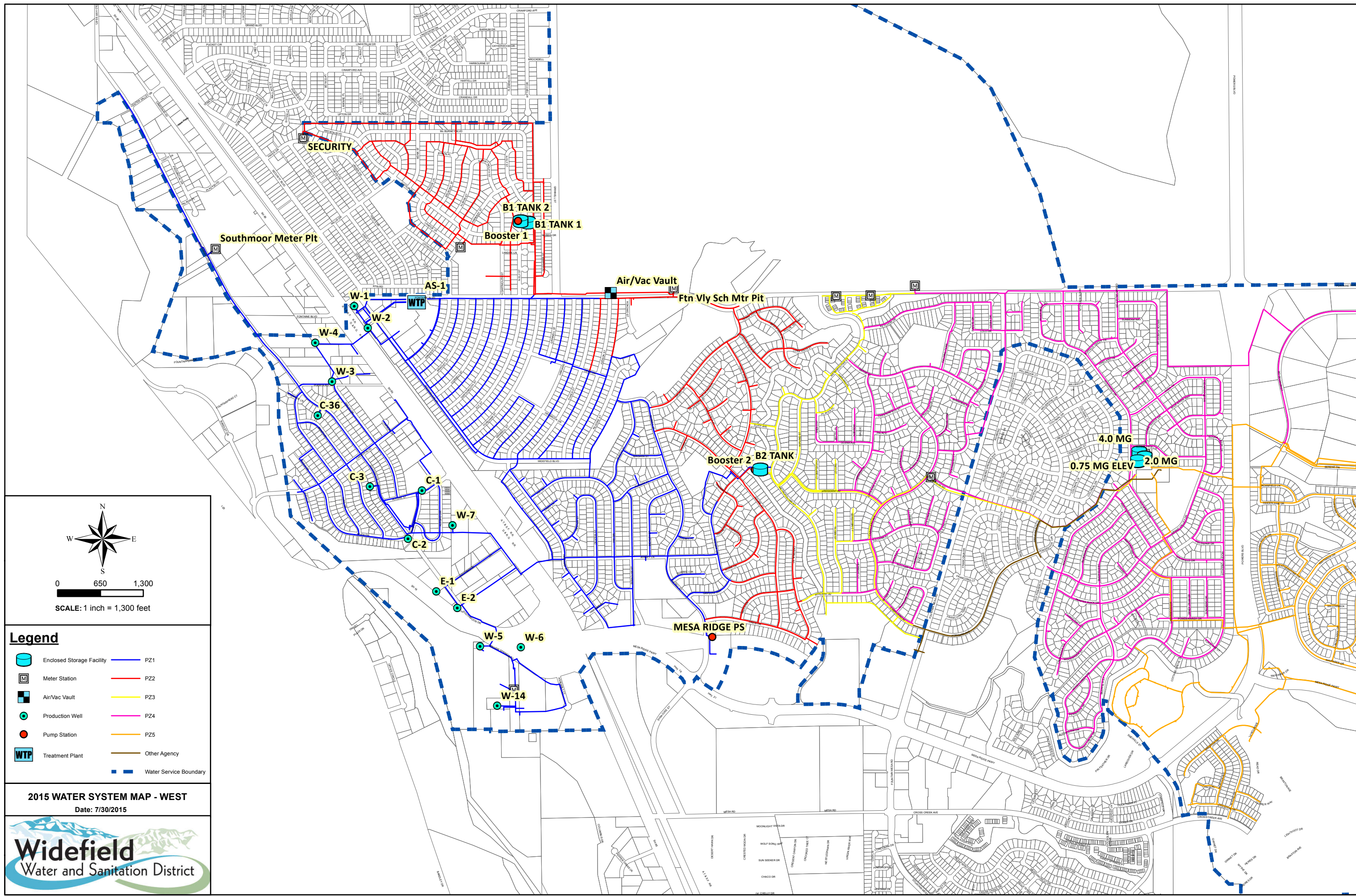

Legend

	Enclosed Storage Facility		PZ1
	Meter Station		PZ2
	Air/Vac Vault		PZ3
	Production Well		PZ4
	Pump Station		PZ5
	Treatment Plant		Other Agency
			Water Service Boundary

2015 WATER SYSTEM MAP - WEST
 Date: 7/30/2015



WIDEFIELD Water and Sanitation District's 2016 Drinking Water Quality Report For Calendar Year 2015

Public Water System ID: CO0121900

Esta es información importante. Si no la pueden leer, necesitan que alguien se la traduzca.

We are pleased to present you with this year's water quality report. Our constant goal is to provide you with a safe and dependable supply of drinking water. Please contact BRANDON BERNARD at 719-955-0548 with any questions about the Drinking Consumer Confidence Rule (CCR) or for public participation opportunities that may affect the water quality.

General Information

All drinking water, including bottled water, may reasonably be expected to contain at least small amounts of some contaminants. The presence of contaminants does not necessarily indicate that the water poses a health risk. More information about contaminants and potential health effects can be obtained by calling the Environmental Protection Agency's Safe Drinking Water Hotline (1-800-426-4791) or by visiting <http://water.epa.gov/drink/contaminants>.

Some people may be more vulnerable to contaminants in drinking water than the general population. Immunocompromised persons such as persons with cancer undergoing chemotherapy, persons who have undergone organ transplants, people with HIV-AIDS or other immune system disorders, some elderly, and infants can be particularly at risk of infections. These people should seek advice about drinking water from their health care providers. For more information about contaminants and potential health effects, or to receive a copy of the U.S. Environmental Protection Agency (EPA) and the U.S. Centers for Disease Control (CDC) guidelines on appropriate means to lessen the risk of infection by Cryptosporidium and microbiological contaminants call the EPA Safe Drinking Water Hotline at (1-800-426-4791).

The sources of drinking water (both tap water and bottled water) include rivers, lakes, streams, ponds, reservoirs, springs, and wells. As water travels over the surface of the land or through the ground, it dissolves naturally occurring minerals and, in some cases, radioactive material, and can pick up substances resulting from the presence of animals or from human activity. Contaminants that may be present in source water include:

-) **Microbial contaminants:** viruses and bacteria that may come from sewage treatment plants, septic systems, agricultural livestock operations, and wildlife.
-) **Inorganic contaminants:** salts and metals, which can be naturally-occurring or result from urban stormwater runoff, industrial or domestic wastewater discharges, oil and gas production, mining, or farming.
-) **Pesticides and herbicides:** may come from a variety of sources, such as agriculture, urban stormwater runoff, and residential uses.
-) **Radioactive contaminants:** can be naturally occurring or be the result of oil and gas production and mining activities.
-) **Organic chemical contaminants:** including synthetic and volatile organic chemicals, which are byproducts of industrial processes and petroleum production, and also may come from gas stations, urban storm water runoff, and septic systems.

In order to ensure that tap water is safe to drink, the Colorado Department of Public Health and Environment prescribes regulations limiting the amount of certain contaminants in water provided by public water systems. The Food and Drug Administration regulations establish limits for contaminants in bottled water that must provide the same protection for public health.

Lead in Drinking Water

If present, elevated levels of lead can cause serious health problems (especially for pregnant women and young children). It is possible that lead levels at your home may be higher than other homes in the community as a result of materials used in your home's plumbing. If you are concerned about lead in your water, you may wish to have your water tested. When your water has been sitting for several hours, you can minimize the potential for lead exposure by flushing your tap for 30 seconds to 2 minutes before using water for drinking or cooking. Additional information on lead in drinking water, testing methods, and steps you can take to minimize exposure is available from the Safe Drinking Water Hotline (1-800-426-4791) or at <http://www.epa.gov/safewater/lead>.

Source Water Assessment and Protection (SWAP)

The Colorado Department of Public Health and Environment has provided us with a Source Water Assessment Report for our water supply. For general information or to obtain a copy of the report please visit <http://wqcdcompliance.com/ccr>. The report is located under "Source Water Assessment Reports", and then "Assessment Report by County". Select EL PASO County and find 121900; WIDEFIELD WSD or by contacting BRANDON BERNARD at 719-955-0548. The Source Water Assessment Report provides a screening-level evaluation of potential contamination that **could** occur. It **does not** mean that the contamination **has or will** occur. We can use this information to evaluate the need to improve our current water treatment capabilities and prepare for future contamination threats. This can help us ensure that quality finished water is delivered to your homes. In addition, the source water assessment results provide a starting point for developing a source water protection plan. Potential sources of contamination in our source water area are listed on the next page.

Please contact us to learn more about what you can do to help protect your drinking water sources, any questions about the Drinking Water Consumer Confidence Report, to learn more about our system, or to attend scheduled public meetings. We want you, our valued customers, to be informed about the services we provide and the quality water we deliver to you every day.

Our Water Sources

<u>Source</u>	<u>Source Type</u>	<u>Water Type</u>	<u>Potential Source(s) of Contamination</u>
W4 WELL	Well	Groundwater	Environment, Industry
W2 WELL	Well	Groundwater	Environment, Industry
W3 WELL	Well	Groundwater	Environment, Industry
WELL C1	Well	Groundwater	Environment, Industry
W7 WELL	Well	Groundwater	Environment, Industry
WELL E2	Well	Groundwater	Environment, Industry
WELL C3	Well	Groundwater	Environment, Industry
WELL C36	Well	Groundwater	Environment, Industry

JHW5R WELL	Well	Groundwater	Environment, Prairie
JHW4R WELL	Well	Groundwater	Environment, Prairie
W1 WELL	Well	Groundwater	Environment, Industry
PURCHASED FOUNTAIN VALLEY 121300 SW	Consecutive Connection	Surface Water	Soil runoff, erosion of natural deposits.

Terms and Abbreviations

- J **Maximum Contaminant Level (MCL)** – The highest level of a contaminant allowed in drinking water.
- J **Treatment Technique (TT)** – A required process intended to reduce the level of a contaminant in drinking water.
- J **Action Level (AL)** – The concentration of a contaminant which, if exceeded, triggers treatment and other regulatory requirements.
- J **Maximum Residual Disinfectant Level (MRDL)** – The highest level of a disinfectant allowed in drinking water. There is convincing evidence that addition of a disinfectant is necessary for control of microbial contaminants.
- J **Maximum Contaminant Level Goal (MCLG)** – The level of a contaminant in drinking water below which there is no known or expected risk to health. MCLGs allow for a margin of safety.
- J **Maximum Residual Disinfectant Level Goal (MRDLG)** – The level of a drinking water disinfectant, below which there is no known or expected risk to health. MRDLGs do not reflect the benefits of the use of disinfectants to control microbial contaminants.
- J **Violation (No Abbreviation)** – Failure to meet a Colorado Primary Drinking Water Regulation.
- J **Formal Enforcement Action (No Abbreviation)** – Escalated action taken by the State (due to the risk to public health, or number or severity of violations) to bring a non-compliant water system back into compliance.
- J **Variance and Exemptions (V/E)** – Department permission not to meet a MCL or treatment technique under certain conditions.
- J **Gross Alpha (No Abbreviation)** – Gross alpha particle activity compliance value. It includes radium-226, but excludes radon 222, and uranium.
- J **Picocuries per liter (pCi/L)** – Measure of the radioactivity in water.
- J **Nephelometric Turbidity Unit (NTU)** – Measure of the clarity or cloudiness of water. Turbidity in excess of 5 NTU is just noticeable to the typical person.
- J **Compliance Value (No Abbreviation)** – Single or calculated value used to determine if regulatory contaminant level (e.g. MCL) is met. Examples of calculated values are the 90th Percentile, Running Annual Average (RAA) and Locational Running Annual Average (LRAA).
- J **Average (x-bar)** – Typical value.
- J **Range (R)** – Lowest value to the highest value.
- J **Sample Size (n)** – Number or count of values (i.e. number of water samples collected).
- J **Parts per million = Milligrams per liter (ppm = mg/L)** – One part per million corresponds to one minute in two years or a single penny in \$10,000.
- J **Parts per billion = Micrograms per liter (ppb = ug/L)** – One part per billion corresponds to one minute in 2,000 years, or a single penny in \$10,000,000.
- J **Not Applicable (N/A)** – Does not apply or not available.



Detected Contaminants

WIDEFIELD Water and Sanitation District routinely monitors for contaminants in your drinking water according to Federal and State laws. The following table(s) show all detections found in the period of January 1 to December 31, 2015 unless otherwise noted. The State of Colorado requires us to monitor for certain contaminants less than once per year because the concentrations of these contaminants are not expected to vary significantly from year to year, or the system is not considered vulnerable to this type of contamination. Therefore, some of our data, though representative, may be more than one year old. Violations and Formal Enforcement Actions, if any, are reported in the next section of this report.

Note: Only detected contaminants sampled within the last 5 years appear in this report. If no tables appear in this section then no contaminants were detected in the last round of monitoring.

Lead and Copper Sampled in the Distribution System								
Contaminant Name	Time Period	90 th Percentile	Sample Size	Unit of Measure	90 th Percentile AL	Sample Sites Above AL	90 th Percentile AL Exceedance	Typical Sources
Copper	08/05/2014 to 08/21/2014	0.32	30	ppm	1.3	0	No	Corrosion of household plumbing systems; Erosion of natural deposits
Lead	08/05/2014 to 08/21/2014	5	30	ppb	15	1	No	Corrosion of household plumbing systems; Erosion of natural deposits

Disinfection Byproducts Sampled in the Distribution System										
Name	Year	Average	Range Low – High	Sample Size	Unit of Measure	MCL	MCLG	Highest Compliance Value	MCL Violation	Typical Sources
Total Haloacetic Acids (HAA5)	2015	11.66	1.6 to 29.3	16	ppb	60	N/A	29.3	No	Byproduct of drinking water disinfection
Total Trihalomethanes (TTHM)	2015	30.72	6.27 to 61.4	16	ppb	80	N/A	61.4	No	Byproduct of drinking water disinfection

Radionuclides Sampled at the Entry Point to the Distribution System									
Contaminant Name	Year	Average	Range Low – High	Sample Size	Unit of Measure	MCL	MCLG	MCL Violation	Typical Sources
Gross Alpha	2014	1.31	0 to 2.63	2	pCi/L	15	0	No	Erosion of natural deposits
Combined Radium	2014	0.05	0 to 0.1	2	pCi/L	5	0	No	Erosion of natural deposits
Combined Uranium	2014	12.5	11 to 14	2	ppb	30	0	No	Erosion of natural deposits

Inorganic Contaminants Sampled at the Entry Point to the Distribution System

Contaminant Name	Year	Average	Range Low – High	Sample Size	Unit of Measure	MCL	MCLG	MCL Violation	Typical Sources
Barium	2015	0.08	0.05 to 0.1	4	ppm	2	2	No	Discharge of drilling wastes; discharge from metal refineries; erosion of natural deposits
Fluoride	2015	1.05	0.66 to 1.5	4	ppm	4	4	No	Erosion of natural deposits; water additive which promotes strong teeth; discharge from fertilizer and aluminum factories
Nitrate	2015	5.27	0.76 to 7.8	10	ppm	10	10	No	Runoff from fertilizer use; leaching from septic tanks, sewage; erosion of natural deposits

Nitrate: *Nitrate in drinking water at levels above 10 ppm* is a health risk for infants of less than six months of age. High nitrate levels in drinking water can cause blue baby syndrome. Nitrate levels may rise quickly for short periods of time because of rainfall or agricultural activity. If you are caring for an infant you should ask advice from your health care provider.

Volatile Organic Contaminants Sampled at the Entry Point to the Distribution System

Contaminant Name	Year	Average	Range Low – High	Sample Size	Unit of Measure	MCL	MCLG	MCL Violation	Typical Sources
Tetrachloroethylene	2015	0.5	0 to 1.5	10	ppb	5	0	No	Discharge from factories and dry cleaners

Secondary Contaminants**

**Secondary standards are non-enforceable guidelines for contaminants that may cause cosmetic effects (such as skin, or tooth discoloration) or aesthetic effects (such as taste, odor, or color) in drinking water.

Contaminant Name	Year	Average	Range Low – High	Sample Size	Unit of Measure	Secondary Standard
Total Dissolved Solids	2014	1105	1100 to 1110	2	ppm	500

Unregulated Contaminants***

EPA has implemented the Unregulated Contaminant Monitoring Rule (UCMR) to collect data for contaminants that are suspected to be present in drinking water and do not have health-based standards set under the Safe Drinking Water Act. EPA uses the results of UCMR monitoring to learn about the occurrence of unregulated contaminants in drinking water and to decide whether or not these contaminants will be regulated in the future. We performed monitoring and reported the analytical results of the monitoring to EPA in accordance with its Third Unregulated Contaminant Monitoring Rule (UCMR3). Once EPA reviews the submitted results, the results are made available in the EPA's National Contaminant Occurrence Database (NCOD) (<http://www.epa.gov/dwucmr/national-contaminant-occurrence-database-ncod>) Consumers can review UCMR results by accessing the NCOD. Contaminants that were detected during our UCMR3 sampling and the corresponding analytical results are provided below.

Contaminant Name	Year	Average	Range Low – High	Sample Size	Unit of Measure
1,4-Dioxane	2014-2015	0.059	0.07-0.13	17	ppb
Chlorate	2014-2015	45	25-390	49	ppb
Chromium	2014-2015	0.19	0.2-1.1	49	ppb
Hexavalent Chromium (Dissolved)	2014-2015	0.14	0.032-0.62	53	ppb
Molybdenum	2014-2015	3.5	1.3-6.0	49	ppb
PFOS	2014-2015	0.033	0.042-0.21	18	ppb
PFHxS	2014-2015	0.098	0.046-0.33	18	ppb
PFHpA	2014-2015	0.0096	0.011-0.024	18	ppb
PFOA	2014-2015	0.017	0.021-0.048	18	ppb
Strontium	2014-2015	447	300-570	49	ppb

Unregulated Contaminants***

EPA has implemented the Unregulated Contaminant Monitoring Rule (UCMR) to collect data for contaminants that are suspected to be present in drinking water and do not have health-based standards set under the Safe Drinking Water Act. EPA uses the results of UCMR monitoring to learn about the occurrence of unregulated contaminants in drinking water and to decide whether or not these contaminants will be regulated in the future. We performed monitoring and reported the analytical results of the monitoring to EPA in accordance with its Third Unregulated Contaminant Monitoring Rule (UCMR3). Once EPA reviews the submitted results, the results are made available in the EPA's National Contaminant Occurrence Database (NCOD) (<http://www.epa.gov/dwucmr/national-contaminant-occurrence-database-ncod>) Consumers can review UCMR results by accessing the NCOD. Contaminants that were detected during our UCMR3 sampling and the corresponding analytical results are provided below.

Contaminant Name	Year	Average	Range Low – High	Sample Size	Unit of Measure
Vanadium	2014- 2015	0.45	0.2-0.96	49	ppb

***More information about the contaminants that were included in UCMR3 monitoring can be found at: <http://www.drinktap.org/water-info/whats-in-my-water/unregulated-contaminant-monitoring-rule.aspx>. Learn more about the EPA UCMR at: <http://www.epa.gov/dwucmr/learn-about-unregulated-contaminant-monitoring-rule> or contact the Safe Drinking Water Hotline at (800) 426-4791 or <http://water.epa.gov/drink/contact.cfm>.



Violations, Significant Deficiencies, and Formal Enforcement Actions

No Violations or Formal Enforcement Actions



Fountain Valley Authority (PWSID # CO0121300)
2016 Water Quality Report Information for:
City of Fountain (PWSID # CO0121275)
Colorado Springs Utilities (PWSID # CO0121150)
Security Water District (PWSID # CO0121775)
Stratmoor Hills Water District (PWSID # CO0121800)
Widefield Water District (PWSID # CO0121900)

WATER SOURCE INFORMATION

Fountain Valley Authority treats surface water received from the Fryingpan-Arkansas Project. The Fryingpan-Arkansas Project is a system of pipes and tunnels that collects water in the Hunter-Fryingpan Wilderness Area near Aspen. Waters collected from the system are diverted to the Arkansas River, near Buena Vista, and then flow approximately 150 miles downstream to Pueblo Reservoir. From Pueblo Reservoir, the water travels through a pipeline to the water treatment plant.

STATE SOURCE WATER ASSESSMENT

The **Colorado Source Water Assessment and Protection (SWAP)** program is a preventative approach to protecting public drinking water supplies. The Colorado Department of Public Health & Environment (CDPHE) provided us with a Water Assessment Report for our water source.

Potential sources of contamination to our source water area:

- EPA Superfund Sites
- EPA Abandoned Contaminated Sites
- EPA Hazardous Waste Generators
- EPA Chemical Inventory/Storage Sites
- EPA Toxic Release Inventory Sites
- Permitted Wastewater Discharge Sites
- Aboveground, Underground and Leaking Storage Tank Sites
- Solid Waste Sites
- Existing/Abandoned Mine Sites
- Concentrated Animal Feeding Operations
- Other Facilities
- Commercial/Industrial Transportation
- High and Low Intensity Residential
- Urban Recreational Grasses
- Quarries/Strip Mines/Gravel Pits
- Agricultural land (row crops, small grain, pasture/hay, orchards/vineyards, fallow & other)
- Forest
- Septic Systems
- Oil/Gas Wells
- Road Miles

Fountain Valley Authority is dedicated to protecting our source water and ensuring quality treated water is delivered to our customers. The results of the source water assessment are not a reflection of our treated water quality received at the system connections, but rather a rating of the susceptibility of contamination under the guidelines of the Colorado SWAP program.

For source water assessment information or to download a complete report, visit the CDPHE's website at <https://www.colorado.gov/pacific/cdphe/source-water-assessment-and-protection-swap>. The report is located under "Source Water Assessment Reports by County".

POSSIBLE WATER CONTAMINANTS

The sources of drinking water (both tap water and bottled water) include rivers, lakes, streams, ponds, reservoirs, springs, and wells. As water travels over the surface of the land or through the ground, it dissolves naturally occurring minerals and, in some cases, radioactive material, and can pick up substances resulting from the presence of animals or from human activity. Contaminants that may be present in source water include:

- Microbial contaminants, such as viruses and bacteria that may come from sewage treatment plants, septic systems, agricultural livestock operations, and wildlife.
- Inorganic contaminants, such as salts and metals, which can be naturally occurring or result from urban stormwater runoff, industrial or domestic wastewater discharges, oil and gas production, mining, or farming.
- Pesticides and herbicides that may come from a variety of sources, such as agriculture, urban stormwater runoff, and residential uses.
- Organic chemical contaminants, including synthetic and volatile organic chemicals, which are byproducts of industrial processes and petroleum production, and also may come from gas stations, urban stormwater runoff, and septic systems.
- Radioactive contaminants, that can be naturally occurring or be the result of oil and gas production and mining activities.

In order to ensure that tap water is safe to drink, the Environmental Protection Agency (EPA) prescribes regulations which limit the amount of certain contaminants in water provided by public water systems. The US Food and Drug Administration (FDA) regulations establish limits for contaminants in bottled water that must provide the same protection for public health.

FLUORIDE INFORMATION

Fluoride is a compound found naturally in many places, including soil, food, plants, animals and the human body. It is also found naturally in Fountain Valley Authority's water source. Fountain Valley Authority does not add additional fluoride to the treated water. Any fluoride in the treated water results from what occurs naturally in the source water.

LEAD INFORMATION

If present, elevated levels of lead can cause serious health problems, especially for pregnant women and young children. Lead in drinking water is primarily from materials and components associated with service lines and home plumbing. Fountain Valley Authority is responsible for providing high quality drinking water, but cannot control the variety of materials used in plumbing components. When water has been sitting for several hours, minimize the potential for lead exposure by flushing the tap for 30 seconds to 2 minutes before using the water for drinking or cooking. If there is a concern about lead in the water, the water may be tested. Information on lead in drinking water, testing methods, and steps to take to minimize exposure is available from the EPA Safe Drinking Water Hotline at 1-800-426-4791 or visit www.epa.gov.

MICROBIOLOGICAL INFORMATION

Fountain Valley Authority performs a Microscopic Particulate Analysis (MPA) at its treatment plant. The MPA determines particulate removal, expressed as a log reduction, between the source water entering the filters and the treated water exiting the filters. For 2015, the log reduction for Fountain Valley Authority was 4.5, which can be equivalently expressed as 100%.

Cryptosporidium is a microbial pathogen found in surface water throughout the United States. Although filtration removes cryptosporidium, the most commonly used filtration methods cannot guarantee 100 percent removal. No cryptosporidia were detected in the treated water distributed from our water treatment plant. Current test methods do not allow us to determine if the organisms found in the source water are dead or if they are capable of causing disease. Ingestion of cryptosporidium may cause cryptosporidiosis, an abdominal infection. Symptoms of infection include nausea, diarrhea and abdominal cramps. Most healthy individuals can overcome the disease within a few weeks. However, immunocompromised people are at greater risk of developing the life-threatening illness. We encourage immunocompromised individuals to consult their doctor regarding appropriate precautions to take to avoid infection. Cryptosporidium must be ingested to cause disease, and it may be spread through means other than drinking water.

VULNERABLE POPULATIONS ADVISORY

Some individuals may be more vulnerable to contaminants in drinking water than the public in general. All drinking water, including bottled water, may reasonably be expected to contain at least small amounts of some contaminants. The presence of contaminants does not necessarily indicate that the water poses a health risk. Immunocompromised persons such as persons with cancer undergoing chemotherapy, persons who have undergone organ transplants, people with HIV-AIDS or other immune system disorders, some elderly, and infants can be particularly at risk of infections. These people should seek advice about drinking water from their health care providers. For more information about contaminants and potential health effects, or to receive a copy of the EPA and Centers for Disease Control (CDC) guidelines on appropriate means to lessen the risk of infection by Cryptosporidium and microbiological contaminants, call the EPA Safe Drinking Water Hotline at 1-800-426-4791 or visit www.epa.gov.

WANT MORE INFORMATION

For questions concerning this report, please call (719) 668-4560.

DEFINITIONS

- ❖ Maximum Contaminant Level (MCL): The “maximum allowed” is the highest level of a contaminant that is allowed in drinking water. The MCL is set as close to the MCLG as feasible using the best available treatment technology.
- ❖ Maximum Contaminant Level Goal (MCLG): The “goal” is the level of a contaminant in drinking water, below which there is no known or expected risk to health. The MCLG allows for a margin of safety.
- ❖ N/A: Not applicable
- ❖ Nephelometric Turbidity Unit (NTU): Nephelometric turbidity unit is a measure of the clarity of water. Turbidity (cloudiness) in excess of five NTU is just visible to the average person.
- ❖ Parts per billion (ppb) or micrograms per liter ($\mu\text{g/L}$): One part per billion corresponds to one minute in 2,000 years or one penny in \$10,000,000.
- ❖ Parts per million (ppm) or milligrams per liter (mg/L): One part per million corresponds to one minute in two years or one penny in \$10,000.
- ❖ Picocuries per liter (pCi/L): A measure of radioactivity in water.
- ❖ Running Annual Average (RAA): Based on the monitoring requirements, the average of 12 consecutive monthly averages or the average of 4 consecutive quarter averages.
- ❖ Treatment Technique (TT): A treatment technique is a required process intended to reduce the level of a contaminant in drinking water to comply with regulations.
- ❖ Waiver: State permission not to test for a specific contaminant.

TABLE OF DETECTED CONTAMINANTS

Fountain Valley Authority is required to monitor for certain contaminants less than once a year because the concentration of the contaminants are not expected to vary significantly from year to year, or the drinking water system is not considered vulnerable to this type of contamination. Some of the data, though representative, may be more than one year old.

Fountain Valley Authority has been issued waivers for asbestos, cyanide, dioxin, glyphosate, nitrite and all unregulated inorganic contaminants. The table on the following page shows the results of our monitoring for the period of January 1 through December 31, 2015, unless otherwise noted.

Detected Contaminants Table

Fountain Valley Authority (PWSID CO0121300)

Monitored at the Treatment Plant (entry point to the transmission system)

Contaminant	MCL	MCLG	Units	Level Detected	MCL Violation	Sample Dates	Possible Source(s) of Contamination
Barium	2	2	ppm	0.0580	No	April 2015	Discharge of drilling wastes; discharge from metal refineries; erosion of natural deposits
Chromium	100	100	ppb	1.1	No	April 2015	Discharge from steel and pulp mines; Erosion of natural deposits
Fluoride	4	4	ppm	0.43	No	April 2015	Erosion of natural deposits; discharge from fertilizer and aluminum factories
Nickel	N/A	N/A	ppb	1.0	N/A	April 2015	Erosion of natural deposits; discharge from industries; discharge from refineries and steel mills
Nitrate (as Nitrogen)	10	10	ppm	0.33	No	April 2015	Runoff from fertilizer use; leaching from septic tanks, sewage; erosion of natural deposits
Radium, Combined 226, 228	5	0	pCi/L	0.1	No	Mar 2011	Erosion of natural deposits
Selenium	50	50	ppb	3.9	No	April 2015	Discharge from petroleum and metal refineries; erosion of natural deposits; discharge from mines
Sodium	N/A	N/A	ppm	15.5	No	April 2015	Erosion of natural deposits
Thallium	2	0.5	ppb	0.2	No	April 2015	Leaching from ore processing sites; discharge from electronics, glass and drug factories
Total Organic Carbon (TOC)¹	TT	N/A	N/A	N/A	No	Running Annual Average	Naturally present in the environment
Turbidity²	TT ≤0.3 in 95% of monthly samples	N/A	NTU	Highest turbidity 0.33 (Mar 2015) 100% of samples ≤0.3	No	Jan – Dec 2015	Soil Runoff
Uranium	30	0	ppb	1.1	No	Mar 2011	Erosion of natural deposits

¹The Disinfectants and Disinfection Byproducts Rule provides several alternative compliance criteria besides the TOC removal ratios. We did not report TOC removal ratios because we demonstrated compliance with alternative criteria. The alternative compliance criteria that we use is 40CFR §141.135(a)(2)(ii); our treated water TOC levels are <2.0ppm calculated quarterly as a running annual average.

²Turbidity is a measure of the cloudiness of the water and has no known health effects. We monitor turbidity because it is a good indicator of the effectiveness of our filtration system. Compliance with the TT of 95% of samples ≤0.3NTU is calculated using combined filter effluent turbidity results taken 6 times per day at 1:00, 5:00 and 9:00 a.m. and p.m.

Long Term 2 Enhanced Surface Water Treatment Rule Monitoring

Monitored raw source water right before it enters the Treatment Plant

Contaminant	MCL	MCLG	Units	Level Detected Range	MCL Violation	Sample Dates	Possible Source(s) of Contamination
Turbidity	N/A	N/A	NTU	1.1 - 50	N/A	Apr. – Dec. 2015	Soil Runoff

CITY OF FOUNTAIN 2016 DRINKING WATER QUALITY REPORT

(WATER TESTING PERFORMED IN 2015)



CONSUMER CONFIDENCE
REPORT
PUBLIC WATER SYSTEM
ID# CO0121275

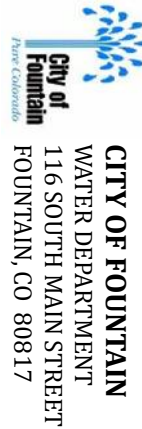

Fountain is pleased to present to you its 2016 Drinking Water Quality/Consumer Confidence Report (CCR) for Calendar Year 2015. In 2015, Fountain's Water Department distributed 826,433,000 gallons of water to our customers. The City of Fountain's Water Department works around the clock to provide top quality water to every tap. We ask that all our customers help us protect our water sources. To better keep our community informed, we encourage and welcome you to attend Fountain's City Council Meetings held on the 2nd and 4th Tuesday of each month, at 6:00 p.m., in Fountain's Council Chambers, located at City Hall, 116 South Main Street. If you would like more information concerning this CCR report or for public participation opportunities that may affect the water quality, please contact the City of Fountain's Water Department (Ron Woolsey at 719-322-2071 or Nick Zaiger at 719-322-2073) or write to: City of Fountain Water Department, 116 South Main Street, Fountain, CO 80817 or visit the City of Fountain Water Department's website located at: www.fountaincolorado.org/department/?fDD=17-0 for more information related specifically to our water quality. **Español (Spanish)** Esta es información importante. Si no la pueden leer, necesitan que alguien se la traduzca.

Vulnerable Populations Advisory:

Some individuals may be more vulnerable to contaminants in drinking water than the general population. Immuno-compromised persons such as persons with cancer undergoing chemotherapy, persons who have undergone organ transplants, people with HIV-AIDS or other immune system disorders, some elderly, and infants can be particularly at risk of infections. These people should seek advice about drinking water from their health care providers. All drinking water, including bottled water, may reasonably be expected to contain at least small amounts of some contaminants. The presence of contaminants does not necessarily indicate that the water poses a health risk. For more information about contaminants and potential health effects, or to receive a copy of the EPA and CDC guidelines on appropriate means to lessen the risk of infection by Cryptosporidium and microbiological contaminants, you may call the EPA Safe Drinking Water Hotline at 1-800-426-4791 or you can visit their website at <http://water.epa.gov/drink/contaminants> or at www.epa.gov for additional EPA resources.

Lead Information:

If present, elevated levels of lead can cause serious health problems (especially for pregnant women and young children). It is possible that lead levels at your home may be higher than other homes in the community as a result of materials used in your home's plumbing. If you are concerned about lead in your water, you may wish to have your water tested. When your water has been sitting for several hours, you can minimize the potential for lead exposure by flushing your tap for 30 seconds to 2 minutes before using water for drinking or cooking. Additional information on lead in drinking water, testing methods, and steps you can take to minimize exposure is available from the Safe Drinking Water Hotline (1-800-426-4791) or on their website at: <http://www.epa.gov/safewater/lead>.

Sources of Drinking Water

The sources of drinking water (both tap water and bottled water) include rivers, lakes, streams, ponds, reservoirs, springs, and wells. As water travels over the surface of the land or through the ground, it dissolves naturally occurring minerals and, in some cases, radioactive material, and can pick up substances resulting from the presences of animals or from human activity. In order to ensure tap water is safe to drink, the Colorado Department of Public Health & Environment prescribes regulations, limiting the amount of certain contaminants in water provided by public water systems. The Food & Drug Administration regulations establish limits for contaminants in bottled water that must provide the same protection for public health. Contaminants that may be present in source water include:

Microbial contaminants, such as viruses and bacteria, which may come from sewage treatment plants, septic systems, agricultural livestock operations, and wildlife.

Inorganic contaminants, such as salts and metals, which can be naturally-occurring or result from urban storm water runoff, industrial or domestic wastewater discharges, oil and gas production, mining, or farming.

Pesticides and herbicides, which may come from a variety of sources such as agriculture, urban storm water runoff, and residential uses.

Radioactive contaminants, which can be naturally occurring or be the result of oil and gas production and mining activities.

Organic chemical contaminants, including synthetic and volatile organic chemicals, which are by-products of industrial processes and petroleum production, and can also come from gas stations, urban storm water runoff, and septic systems.

2015 Monitoring Results for City of Fountain

The table below displays the levels of contaminants detected from water samples taken throughout the 2015 calendar year from the City of Fountain's (COF) four (4) of five (5) well sites. This table also reflects Fountain Valley (FVA) Authority's (PWSID #CO0121300) test results for 2015 as the City of Fountain purchases 70% of its drinking water from Fountain Valley Authority (FVA). If you have any questions regarding FVA's results, please call (719) 668-4403. The City of Fountain joined with Security Water District and Widefield Water & Sanitation District on a water exchange joint project; therefore, Security and Widefield's CCR information has also been included. If you would like a complete copy of their CCR, you are welcome to contact them directly at: Security Water District (PWSID #CO0121775) at (719) 392-3475; or Widefield Water & Sanitation District (PWSID #CO0121900) at (719) 955-0548. If you would like to view all test results for the City of Fountain's Water Department, they are available at 301 East Iowa Avenue, Fountain, CO during normal business hours, 8:00 a.m. to 4:30 p.m., Monday thru Friday with the exception of holidays and weekends. NOTE: Only detected contaminants sampled within the last 5 years appear in this report. If no tables appear in this section, that means the City of Fountain did not detect any contaminants in the last round of monitoring.

INORGANIC CONTAMINANTS (Sampled at the Entry Point to the Distribution System)	Unit	Date	Average	MCLG	MCL	Sample Size	COF Range Low to High	Security Range Low to High	FVA Range Low to High	Widefield Range Low to High	Violation (Yes/No)	Typical Source
BARIUM	ppm	2014 – 2015	0.04 – 0.05	2	2	4	0.04 to 0.05	0.07 to 0.12	0.0580	0.05 to 0.1	NO	Discharge of drilling wastes; discharge from metal refineries; erosion of natural deposits.
CHROMIUM	ppb	2014 – 2015	0.9 – 1.4	100	100	4	0 to 1.4	1 – 1.1	1.1	N/A	NO	Discharge from steel and pulp mills; erosion of natural deposits.
FLUORIDE	ppm	2014 – 2015	0.43 – 1.83	4	4	4	1.6 – 2	1.2 – 2	0.43	0.66 – 1.5	NO	Erosion of natural deposits; Water additive to promote strong teeth; Discharge from fertilizer and aluminum factories.
NICKEL	ppb	2015	1.0	N/A	N/A	N/A	N/A	N/A	1.0	N/A	NO	Erosion of natural deposits; discharge from industries, refineries and steel mills.
NITRATE	ppm	2015	0.33 – 1.41	10	10	7	0.7 – 2.4	3.8 – 7.9	0.33	0.76 – 7.8	NO	Runoff from fertilizer use; leaching from septic tanks, sewage; erosion of natural deposits.
NITRATE-NITRITE	ppm	2015	4.65	10	10	2	N/A	4.5 – 4.8	N/A	N/A	NO	Runoff from fertilizer use; leaching from septic tanks, sewage; erosion of natural deposits.
SELENIUM	ppb	2014 – 2015	5.88	50	50	4	3.1 – 8.4	2.8 – 3.9	3.9	N/A	NO	Discharge from petroleum and metal refineries; erosion of natural deposits; discharge from mines.
SODIUM	ppm	2015	15.5	N/A	N/A	N/A	N/A	N/A	15.5	N/A	NO	Erosion of natural deposits.
THALLIUM	ppb	2015	0.2	0.5	2	N/A	N/A	N/A	0.2	N/A	NO	Leaching from one processing sites; discharge from electronics, glass and drug factories.
TETRACHLOROETHYLENE	ppb	2015	0.5 – 1.5	0	5	72	N/A	0 – 1.5	N/A	0 – 1.5	NO	Discharge from factories and dry cleaners.
TRICHLOROETHYLENE	ppb	2015	0.03	0	5	72	N/A	0 – 0.6	N/A	N/A	NO	Discharge from metal degreasing sites and other factories.
RADIONUCLIDES (Sampled at the Entry Point to the Distribution System)	Unit	Date	Average	MCL	MCLG	Sample Size	COF Range Low to High	Security Range Low to High	FVA Range Low to High	Widefield Range Low to High	Violation (Yes/No)	Typical Source
GROSS ALPHA	pCi/L	2014	4.28	15	0	4	2.8 – 7.8	0 – 6.7	N/A	0 – 2.63	NO	Erosion of natural deposits.
RADIUM, COMBINED (226, 228)	pCi/L	2012	0.99	5	0	4	0.62 – 1.38	0.24 – 2.9	0.1	0 – 0.1	NO	Erosion of natural deposits.
URANIUM – COMBINED	ppb	2014	5.7	30	0	4	2.6 – 7.2	3.1 – 15	1.1	11 – 14	NO	Erosion of natural deposits.
GROSS BETA PARTICLE ACTIVITY*	pCi/L*	2011	5.85	50	0	4	4.4 – 8.7	5.8 – 5.8	N/A	N/A	NO	Decay of natural and man-made deposits. Erosion of natural deposits. *The MCL for Gross Beta Particle Activity is 4 mrem/year. Since there is no simple conversion between mrem/year and pCi/L EPA considers 50 pCi/L to be the level of concern for Gross Beta Particle Activity.
DISINFECTION BY-PRODUCTS (Sampled in the Distribution System)	Unit	Date	MCL EPA'S Limits	AVERAGE		Samples Size	COF Range Low to High	Security Range Low to High	FVA Range Low to High	Widefield Range Low to High	Violation (Yes/No)	Typical Source
TOTAL HALOACETIC ACIDS (HAA5)	ppb	2015	60	37.01		21	3.9 – 86	0 – 65	N/A	1.6 – 29.3	NO	By-product of drinking water disinfection.
TOTAL TRIHALOMETHANES (TTHM)	ppb	2015	80	50.43		21	19.5 – 91.2	7 – 75.8	N/A	6.27 – 61.4	NO	By-product of drinking water disinfection.
LEAD & COPPER (Sampled in the Distribution System)	Unit	Date	90th Percentile AL Exceedance		Sample Size	Sample Sites Above AL	COF 90th Percentile AL	Security 90th Percentile	FVA 90th Percentile	Widefield 90th Percentile	Violation (Yes/No)	Typical Source
COPPER	ppm	2013 – 2014	1.3		30	1	0.49	0.56	N/A	0.32	NO	Corrosion of household plumbing systems; erosion of natural deposits.
LEAD	ppb	2013 - 2014	15		30	3	14	1.4	N/A	5	NO	Corrosion of household plumbing systems; erosion of natural deposits.

DETECTED CONTAMINANTS: The State of Colorado requires all water distributors to list any detected contaminants that appear; reason of detected contaminants; and, corrective measures taken to prevent from reoccurring. The following water providers were given the notification of the State's findings regarding any and all violations, if any, with the results listed below:

- THE CITY OF FOUNTAIN HAD NO (0) VIOLATIONS FOR 2015 WATER TESTING PERIOD.
- FOUNTAIN VALLEY AUTHORITY HAD NO (0) VIOLATIONS FOR 2015 WATER TESTING PERIOD.
- SECURITY WATER DISTRICT HAD NO (0) VIOLATIONS FOR 2015 WATER TESTING PERIOD.
- WIDEFIELD WATER DISTRICT HAD NO (0) VIOLATIONS FOR 2015 WATER TESTING PERIOD.

ADDITIONAL HEALTH INFORMATION:

FLUORIDE: Fluoride is a compound found naturally in many places including soil, food, plants, animals and the human body. It is also found naturally in Fountain Valley Authority's water source. The City of Fountain and Fountain Valley Authority do not add additional fluoride to your drinking water. Any fluoride in the drinking water results from what occurs naturally in the source water. At low levels, fluoride can help prevent cavities, but children under nine years old drinking water containing more than 2 milligrams per liter (mg/L) of fluoride may develop cosmetic discoloration and/or pitting of their permanent teeth (Dental Fluorosis). This problem occurs only in developing teeth, before they erupt from the gums. Children under nine years of age should be provided with alternative sources of drinking water or water that has been treated to remove the fluoride to avoid the possibility of staining and pitting of their permanent teeth. You may also want to contact your dentist about proper use by young children of fluoride-containing products. Older children and adults may safely drink the water. Drinking water containing more than 4 mg/L of fluoride can increase your risk of developing bone disease. Your drinking water does not contain more than 4 mg/L of fluoride, but we're required to notify you when we discover that the fluoride levels in your drinking water exceed 2 mg/L because of this cosmetic dental problem. Some home water treatment units are also available to remove fluoride from drinking water. To learn more about available home water treatment units, you may call NSF International at 1-877-8-NSF-HELP.

NITRATE:

Nitrate in drinking water at levels above 10 ppm is a health risk for infants of less than six months of age. High nitrate levels in drinking water can cause blue baby syndrome. Nitrate levels may rise quickly for short periods of time because of rainfall or agricultural activity. If you are caring for an infant you should ask advice from your health care provider.

CITY OF FOUNTAIN'S WATER SOURCES

SOURCE	SOURCE TYPE	WATER TYPE	LOCATION
Goldfield CC – Received from Widefield	Consecutive Connection	Surface Water	N/A
Mesa Ridge CC – Received from Widefield	Consecutive Connection	Surface Water	N/A
Purchased FVA 121300 SW Pueblo Reservoir via Pipeline	Consecutive Connection	Surface Water	Ray Nixon Road
Rice Lane CC – Received from Security	Consecutive Connection	Surface Water	N/A
Well No. 1 North Park Well	Well	Groundwater	North end of Park; 507 El Paso St.
Well No. 2 South Park Well	Well	Groundwater	South end of Park; 213 W. Alabama
Well No. 3 Shop Well	Well	Groundwater	South Main St. & Missouri Ave.; 120 E. Missouri Ave.
Well No. 4 Dale Street	Well	Groundwater	Corner of Dale St./Linda Vista: 625 Dale St.

The City of Fountain routinely monitors for contaminants in your drinking water according to Federal and State laws. The table(s) show detections found in the period of January 1 through December 31, 2015 unless otherwise noted. The State of Colorado requires us to monitor for certain contaminants less than once per year because the concentrations of these contaminants are not expected to vary significantly from year to year, or the system is not considered vulnerable to this type of contamination. Therefore, some of our data, though representative, may be more than one year old. Violations and Formal Enforcement Actions, if any, are reported in the next section of this report. **Note:** Only detected contaminants sampled within the last 5 years appear in this report. If no tables appear in this section then no contaminants were detected in the last round of monitoring.

Fountain's Water Sources

The City of Fountain purchases 70% of its water from the Frypan-Arkansas Project via Pueblo Reservoir through a system of pipes and tunnels that collects water in the Hunter-Frypan Wilderness area near Aspen. Water collected from the system is diverted to the Arkansas River, near Buena Vista, and then flows approximately 150 miles downstream to Pueblo Reservoir. From Pueblo Reservoir, the water travels through a pipeline to the water treatment facility where it is treated by Fountain Valley Authority and then sent via pipeline to Fountain's water storage tanks. 30% of Fountain's water comes from the City's four (4) of five (5) groundwater wells, which draw from the Fountain Creek Alluvium. Our purchased pretreated surface water comes from Fountain Valley Authority (FVA - PWSID #CO0121300), and they are required to attach/include water quality data in this report. The City also occasionally purchases additional water during peak water demands from Security and Widefield Water Districts; therefore, their testing results is also included in this report. The City's five (5) well water sources come specifically from: Well No. 1 (North Park Well) is groundwater; Well No. 2 (South Park Well) is groundwater; Well No. 3 (Shop Well) is groundwater; Well No. 4 (Dale Street) is groundwater; and, Well No. 5 is inactivated. In order to ensure that the tap water is safe to drink, the Colorado Department of Public Health & Environment prescribes regulations limiting the amount of certain contaminants in water provided by public water systems. The Food & Drug Administration regulations establish limits for contaminants in order to provide the same protection for public health. All water systems must complete a Source Water Assessment Plan (SWAP). The SWAP provides a screening level evaluation of potential contamination that could occur, **which does not mean that the contamination has or will occur.** Your water is treated using disinfection and filtration to remove or reduce harmful contaminants that may come from our water source. The Source Water Assessment Plan (SWAP) indicates the potential sources of contamination in our source water area to include: aboveground, underground and leaking storage tank sites; exiting/abandoned mine sites; facilities; commercial/ industrial/transportation; high intensity residential; low intensity residential; urban recreational grasses; row crops; pasture/hay; septic systems and road miles. If you would like a copy of the SWAP Report, please visit: <http://wgcdcompliance.com/ccr> clicking on El Paso County and selecting website #121275 for the City of Fountain.

Definitions:

- Maximum Contaminant Level (MCL):** The "maximum allowed" is the highest level of a contaminant that is allowed in drinking water. The MCL is set as close to the MCLG as feasible using the best available treatment technology.
- Maximum Contaminant Level Goal (MCLG):** The level of a contaminant in drinking water below which there is no known or expected risk to health. MCLGs allow for a margin of safety.
- Action Level (AL):** The concentration of a contaminant, which, if exceeded, triggers treatment or other requirements.
- Maximum Residual Disinfectant Level Goal (MRDLG):** The highest level of a disinfectant allowed in drinking water. There is convincing evidence that addition of a disinfectant is necessary for control of microbial contaminants.
- Average (x-bar):** Typical value.
- Range (R):** The lowest value to the highest value.
- Sample Size (n):** Number or count of values (i.e., number of water samples collected).
- Nephelometric Turbidity Units (NTU):** Measure of the clarity or cloudiness of water. Turbidity in excess of 5 NTU is just noticeable to the typical person.
- Running Annual Average (RAA):** an average of monitoring results for the previous 12 calendar months.
- Picocuries per liter (pCi/L):** Measure of the radioactivity in water.
- Violation (No Abbreviation):** Failure to meet a Colorado Primary Drinking Water Regulation.
- Treatment Technique (TT):** A required process intended to reduce the level of a contaminant in drinking water.

- Maximum Residual Disinfectant Level Goal (MRDLG):** The level of a drinking water disinfectant, below which there is no known or expected risk to health. MRDLGs do not reflect the benefits of the use of disinfectants to control microbial contaminants.
- Not Applicable (N/A):** Does not apply.
- Parts per Million = Milligrams per liter (ppm – mg/L):** One part per million corresponds to one minute in two years or a single penny in \$10,000.
- Parts per Billion = Micrograms per liter (ppb – ug/L):** One part per billion corresponds to one minute in 2,000 years, or a single penny in \$10,000,000.
- Parts per Trillion = Nanograms per liter (ppt – ng/L):** One part per trillion corresponds to one minute in 2,000,000 years or a single penny in \$10,000,000,000.
- Parts per Quadrillion = Picograms per liter (ppg = pg/L):** One part per quadrillion corresponds to one minute in 2,000,000,000 years or one penny in \$10,000,000,000,000.
- Fountain Valley Authority (FVA):** Water treatment facilitator.
- City of Fountain (COF):** Fountain water provider.
- Waiver:** State permission not to test for a specific contaminant.
- Gross Alpha (No Abbreviation):** Gross alpha particle activity compliance value. It includes radium-226, but excludes radon 222 and uranium.
- Variance and Exemptions (V/E):** Department permission not to meet an MCL or a treatment technique under certain conditions.
- Formal Enforcement Action (No Abbreviation):** An escalated action taken by the State (due to the number and/or severity of violations) to bring a non-compliant water system back into compliance.
- Compliance Value (No Abbreviation):** Single or calculated value used to determine if regulatory contaminant level (e.g., MCL) is met. Examples of calculated values are the 90th Percentile, Running Annual Average (RAA) and Locational Running Annual Average (LRAA).

CITY OF FOUNTAIN - SYNTHETIC ORGANIC CONTAMINANTS SAMPLED AT THE ENTRY POINT TO THE DISTRIBUTION SYSTEM

CONTAMINANT NAME	UNIT	DATE	AVERAGE OF INDIV. SAMPLES	NUMBER OF SAMPLES	COF Range LOW - HIGH	MCL	MCLG	VIOLATIONS	TYPICAL SOURCES
OXAMYL (VYDATE)	ppb	2014	0.01	8	0 to 0.1	200	200	NO	Runoff/leaching from insecticide used on apples, potatoes and tomatoes.
PENTACHLOROPHENOL	ppb	2014	0.04	8	0 to 0.1	1	0	NO	Discharge from wood preserving factories.

FOUNTAIN VALLEY AUTHORITY (FVA) MICROBIOLOGICAL CONTAMINANTS

MICROBIOLOGICAL CONTAMINANTS	UNITS OF MEASURE	AVERAGE	SAMPLE SIZE	DATE	TT REQUIREMENTS	RANGE LOW - HIGH	FOUNTAIN VALLEY AUTHORITY INFORMATION / TESTING		VIOLATIONS	TYPICAL SOURCE
TURBIDITY	NTU	---	---	Dec. 2015	Max 1 NTU for any single measurement	Mar. 2015 Highest Single Measurement 0.33 NTU	100% of Samples 0.3 NTU Turbidity is a measure of the cloudiness of the water. We monitor turbidity because it is a good indicator of the effectiveness of our filtration system.		NO	Soil runoff.
TURBIDITY	NTU	---	---	Apr. - Dec. 2015	Level Found: Lowest monthly percentage of samples meeting TT requirement for our technology: 100%		1.1 to 50 NTU		NO	Soil Runoff
URANIUM, COMBINED	ppb	1.1	1	Mar. 2011	30	1.1 to 1.1	<u>MCL</u> 30	<u>MCLG</u> 0	NO	Erosion of natural deposits.
COMBINED RADIUM	pCi/L	0.1	1	2011	---	0.1 to 0.1	5	0	NO	Erosion of natural deposits.

WIDEFIELD WSD SECONDARY CONTAMINANTS**

CONTAMINANT NAME	DATE	AVERAGE	SAMPLE SIZE	UNIT OF MEASURE	SECONDARY STANDARD	RANGE	VIOLATION	TYPICAL SOURCES	
TOTAL DISSOLVED SOLIDS	2014	1105	2	ppm	500	1100 TO 1110	NO	**See Note Below	
CONTAMINANT NAME	DATE	AVERAGE	SAMPLE SIZE	UNIT OF MEASURE	SECONDARY STANDARD	CITY OF FOUNTAIN RANGE LOW - HIGH	SECURITY RANGE LOW - HIGH	VIOLATION	TYPICAL SOURCES
SULFATE	2014	73	1	Ppm	250	N/A	73 TO 73	NO	**See Note Below

**Secondary standards are non-enforceable guidelines for contaminants that may cause cosmetic effects (such as skin, or tooth discoloration) or aesthetic effects (such as taste, odor, or color) in drinking water.

2015 UNREGULATED CONTAMINANTS***

EPA has implemented the Unregulated Contaminant Monitoring Rule (UCMR) to collect data for contaminants that are suspected to be present in drinking water and do not have health-based standards set under the Safe Drinking Water Act. EPA uses the results of UCMR monitoring to learn about the occurrence of unregulated contaminants in drinking water and to decide whether or not these contaminants will be regulated in the future. We performed monitoring and reported the analytical results of the monitoring to EPA in accordance with its Third Unregulated Contaminant Monitoring Rule (UCMR3). Once EPA reviews the submitted results, the results are made available in the EPA's [National Contaminant Occurrence Database \(NCOD\)](http://www.epa.gov/dwucmr/national-contaminant-occurrence-database-ncod) (<http://www.epa.gov/dwucmr/national-contaminant-occurrence-database-ncod>). Consumers can review UCMR results by accessing the NCOD. Contaminants that were detected during our UCMR3 sampling and the corresponding analytical results are provided below.

CONTAMINANT NAME	Unit of Measure	Year	Average	Sample Size	COF Range Low to High	Security Range Low to High	FVA Range Low to High	Widefield Range Low to High
1, 4 DIOXANE	ppb	2014 – 2015	0.059	17	0 – 0.19	0 – 0.17	N/A	0.07 – 0.13
CHLORATE	ppb	2014 – 2015	45	49	N/A	0 – 1200	N/A	25 – 390
CHROMIUM	ppb	2014 – 2015	0.19	49	0 – 0.2	0 – 0.9	N/A	0.2 – 1.1
COBALT	ppb	2014 - 2015	0.03	48	0 – 1.35	0 – 1.1	N/A	N/A
HEXAVALENT CHROMINUM (DISSOLVED)	ppb	2014 – 2015	0.14	53	0 – 0.05	0.11 – 0.89	N/A	0.032 – 0.62
MOLYBDENUM	ppb	2014 – 2015	3.5	49	0 – 7.07	0 – 5.8	N/A	1.3 – 6.0
PFOS	ppb	2014 – 2015	0.033	18	0 – 0.1	0 – 1.3	N/A	0.042 – 0.21
PFHxS	ppb	2014 – 2015	0.098	18	0 – 0.06	0 – 0.44	N/A	0.046 – 0.33
PFHPA	ppb	2014 – 2015	0.0096	18	0 – 0.01	0 – 0.07	N/A	0.011 – 0.024
PFOA	ppb	2014 – 2015	0.017	18	0.02 – 0.04	0 – 0.09	N/A	0.021 – 0.048
STRONTIUM	ppb	2014 – 2015	447	49	460 – 640	110 – 520	N/A	300 – 570
VANADIUM	ppb	2014 – 2015	0.45	49	0 – 0.05	0 – 0.8	N/A	0.2 – 0.96

More information about the contaminants that were included in UCMR3 monitoring can be found at: <http://www.drinktap.org/water-info/whats-in-my-water/unregulated-contaminant-monitoring-rule.aspx>

Learn more about the EPA UCMR at: <http://www.epa.gov/dwucmr/learn-about-unregulated-contaminant-monitoring-rule> or contact the Safe Drinking Water Hotline at (800) 426-4791 or <http://water.epa.gov/drink/contact.cfm>

Appendix C Water Commitment Summary

Widefield Water and Sanitation District

Tabulation of Water Supply vs Active Subdivisions⁵

Existing Water Use ¹	Current Water (Acre-Feet)	Current SFE Dec 31 2015		Comments
	2248	8058		
Development		Subdivisions		
		Commitment SFE	Unused Commitment Acre-Feet	
Lorson--Complete				
Pioneer Landing 1	Done	118		
Ponderosa 1	Done	102		
Ponderosa 2	Done	102		
Allegiant	Done	97		
Townhomes at Lorson Filing #1-Phase One	Done	46		
Buffalo Crossing Filing #1	Done	55		
Buffalo Crossing Filing #2	Done	145		
Meadows at Lorson Filing #1	Done	97		
Meadows at Lorson Filing #2	Done	110		
Meadows at Lorson Filing #3	Done	138		plus Pocket Park
Glen--Complete				
Glen 6A	Done	68		
Glen 6B	Done	77		
<u>In Construction/Buildout</u>				
The Glen 6C		81	31.59	Issuing Taps
Meadows at Lorson Filing #4		241	46.02	Issuing Taps
<u>In for Final Platting</u>				
Peaceful Valley Ridge	Re-activated ²	275	107.25	
Widefield Commercial Center Filing #1		22.5	8.78	
Residence at Widfield Park	INACTIVE	27	10.53	No Activity since 2010
Glen 7		0	0.00	Part of Glen East
Glen 8	New	0	0.00	Part of Glen East
Pioneer Landing 2	New	170	66.30	Lorson
<u>Preliminary Plan</u>				
Glen East		603	235.17	
Carriage Meadows	INACTIVE	161	62.79	No Activity since 2007
Rolling Hills Ranch Phase I	ABANDONED ³	671.18	261.76	No Activity since 2007
Totals	2,248	1,393	418	Inactive units not included in Totals
Actual SFE plus Active Commitments		9,451	3686	3686 based on 0.39 AF/SFE ⁴
Current System Water Supply	5,246		5246	
Excess Water Supply			1560	

Note 1; The 3 year running average dropped from 2464 Acre-feet (2012, 2013, 2014) to 2248 Acre-feet (2013, 2014, 2015)

Record low usage in 2015, due to continued conservation awareness and extremely wet year

Note 2; Peaceful Valley Ridge returned to active status in January, 2015. Lines under construction in 2016

Note 3; Rolling Hills Ranch Phase I was mostly abandoned in 2012 due to large portion transferred to US for future VA Cemetery

Note 4; Widefield continues to use the planning figure of 0.39 Acre-feet per SFE as a planning figure.

However, Widefield's unit use characteristic continues to drop with conservation awareness. Widefield's current

10 year running average unit user characteristic is 0.328 acre-feet per SFE. We expect to make a change in planning figures within the next few years

Note 5; Water use and completed/uncompleted subdivision completions--as of December 31, 2015. Additional 2016 commitments are noted in blue

JDS-Hydro Consultants, Inc