

EL PASO

COMMISSIONERS:
DARRYL GLENN (PRESIDENT)
MARK WALLER (PRESIDENT PRO TEMPORE)



COUNTY

STAN VANDERWERF
LONGINOS GONZALEZ
PEGGY LITTLETON

PLANNING AND COMMUNITY DEVELOPMENT DEPARTMENT
CRAIG DOSSEY, EXECUTIVE DIRECTOR

May 21, 2018

This letter is to inform you of the following petition which has been submitted to El Paso County:

BOA-18-001

KENDALL

**BOARD OF ADJUSTMENT
REIGNING HOPE LOT AREA VARIANCE**

A request by the Chuckie's Place d/b/a Reigning Hope Therapy Services of Colorado, on behalf of Craig and Susanne Hoffman, for approval of a lot area variance of 4.15 acres where 10 acres are required for a commercial stable in the RR-5 (Residential Rural) zoning district. The property is located on Holmes Road approximately 1.87 miles north of Shoup Road. (Parcel No. 52060-00-040)

	For	Against	No Opinion
Comments:	<hr/> <hr/> <hr/>		

(FOR ADDITIONAL COMMENTS, PLEASE ATTACH ANOTHER SHEET.)

This item is scheduled to be heard by the El Paso County Board of Adjustment on June 13, 2018.

The meeting begins at **9:00 A.M.** and will be conducted in the Second Floor Hearing Room of the Pikes Peak Regional Development Center, 2880 International Circle, Colorado Springs, Colorado. You are welcome to appear in person at the hearing to further express your opinion on this matter.

If we can be of any assistance, please contact me at the Planning and Community Development Department at (719) 520-6300.

Thank you,

Len Kendall, Project Manager/Planner I

COPY
mailed 5/22/18

Your Name: _____
(printed) (signature)

Address: _____

Property Location: _____ Phone: _____

2880 INTERNATIONAL CIRCLE, SUITE 110
PHONE: (719) 520-6300



COLORADO SPRINGS, CO 80910-3127
FAX: (719) 520-6695

www.ELPASOCO.com

----- El Paso County Parcel Information -----

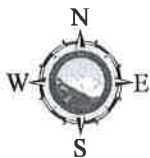
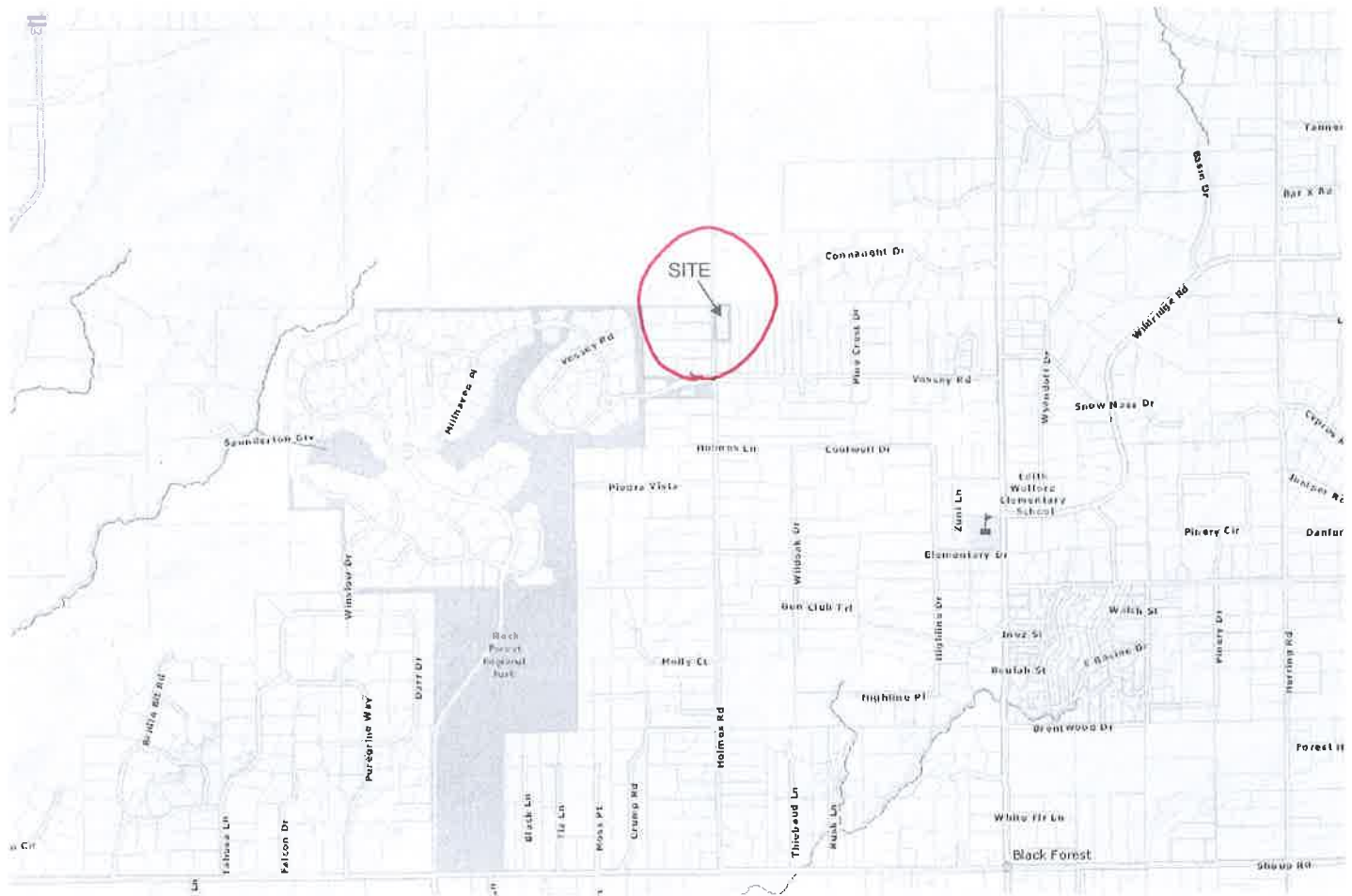

COPYRIGHT 2018 by the Board of County Commissioners, El Paso County, Colorado. All rights reserved. No part of this document or data contained hereon may be reproduced; used to prepare derivative products; or distributed without the specific written approval of the Board of County Commissioners, El Paso County, Colorado. This document was prepared from the best data available at the time of printing. El Paso County, Colorado, makes no claim as to the completeness or accuracy of the data contained hereon.

Parcel: 5206000040

Name: HOFFMAN CRAIG
HOFFMAN SUSANNE

City: Colorado Springs

State: CO

Zip: 80908-3344

Filename: BOA-18-001

Zone Map Number: 55192

Date: December 28, 2017

Please report any parcel discrepancies to:
El Paso County Assessor
1675 W. Garden of the Gods Rd.
Colorado Springs, CO 80907
(719) 520-6600

6201000002
ERNST CHARLES H
14410 HOLMES RD
COLORADO SPRINGS, CO 80908

5206000040
HOFFMAN CRAIG
14090 HOLMES RD
COLORADO SPRINGS, CO 80908

5206000039
HOFFPAUIR DAN W JR
14495 HOLMES RD
COLORADO SPRINGS, CO 80908

5100000437
JONES INGRID L
5940 VESSEY RD
COLORADO SPRINGS, CO 80908

5206000041
MCGOWAN PATRICK J JR
14355 HOLMES RD
COLORADO SPRINGS, CO 80908

6100000075
PRI #2 LLC
6385 CORPORATE DR
COLORADO SPRINGS, CO 80919

6201003001
THOMAS JOHN K
PO BOX 88193
COLORADO SPRINGS, CO 80908

6201003006
THOMAS JOHN K
PO BOX 88193
COLORADO SPRINGS, CO 80908

6201000003
VEREECKE JEREMY
14350 HOLMES RD
COLORADO SPRINGS, CO 80908

BOA-18-001