

- NOTES:
1. NON-STANDARD STREET SECTION PER DEVIATION NO. DEV134 APPROVED BY EL PASO COUNTY PCD.
 2. EPC OPTIONAL TYPE C CURB USED ON ALL RESIDENTIAL STREETS UNLESS OTHERWISE NOTED.
 3. CLEAR ZONES MUST BE MAINTAINED AT ALL TIMES. ALL STRUCTURAL COMPONENTS LARGER THAN 4\"/>

**60' R.O.W.
RESIDENTIAL ROAD
(TYPICAL)**
URBAN LOCAL &
URBAN LOCAL LOW-VOLUME
SCALE : N.T.S.

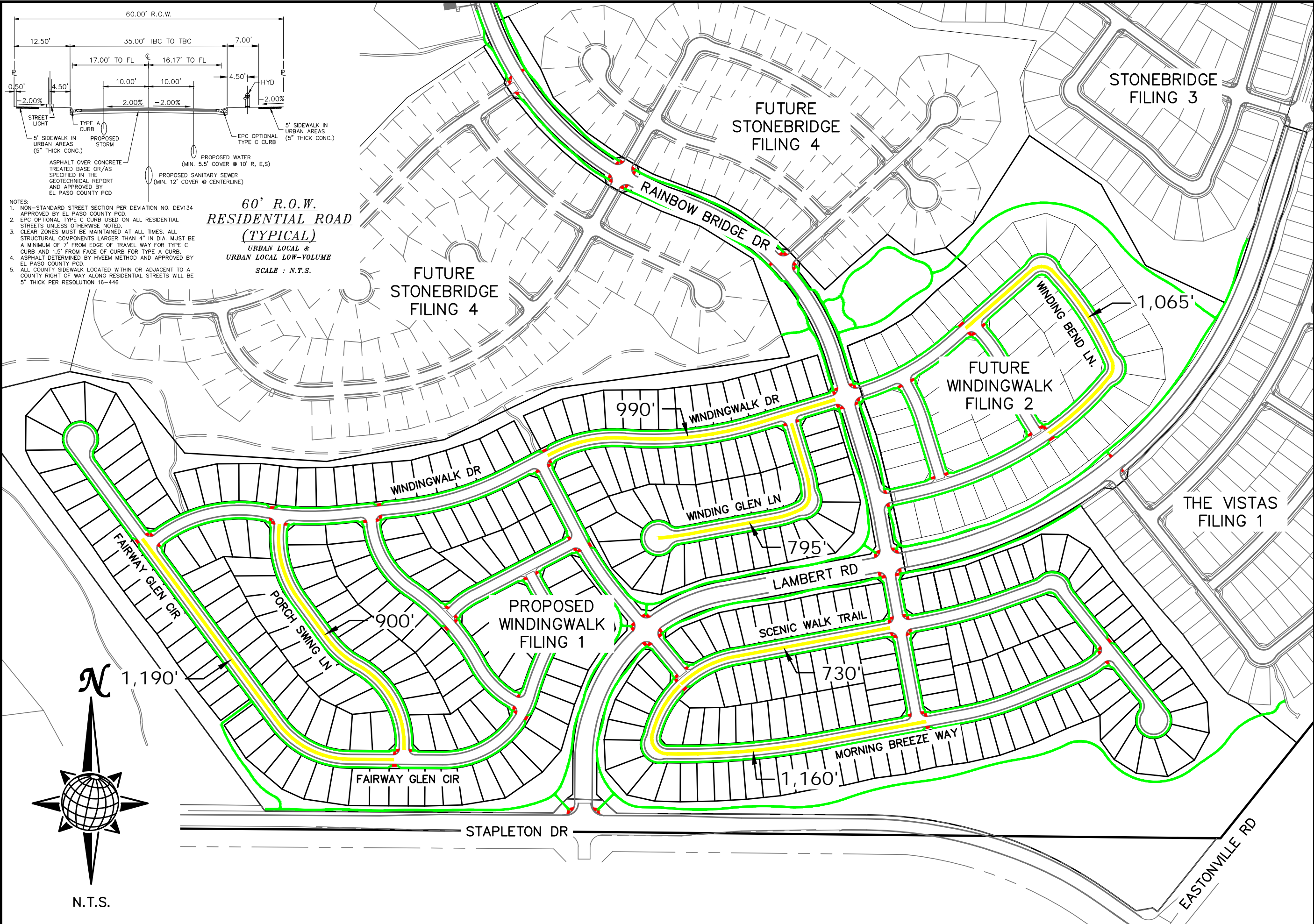

| | | | |
|---|--------|---|-----------|
| TECH CONTRACTORS 11886 STAPLETON DRIVE FALCON, CO 80831 TELEPHONE: 719.495.7444 FAX: 719.495.3349 | | MID-BLOCK PED RAMP WAIVER VARIOUS – FILINGS 1 & 2 WINDINGWALK PUD | |
| Scale | N.T.S. | Drawn by | - |
| Sheet Number | EXH B | Checked by | - |
| | | Date | JUNE 2018 |