

- LEGEND:**
- — — — — PROPERTY BOUNDARY
 - — — — — LOT LINE
 - — — — — EXISTING EASEMENT
 - W — — — — — EXISTING WATER LINE & VALVE
 - WW — — — — — EXISTING WASTEWATER LINE & CLEANOUT
 - FO — — — — — EXISTING FIBER OPTIC LINE
 - UG — — — — — EXISTING GAS LINE
 - OHE — — — — — EXISTING OVERHEAD ELECTRIC
 - UE — — — — — EXISTING UNDERGROUND ELECTRIC
 - — — — — — EXISTING IRON FENCE
 - X — — — — — EXISTING WOOD FENCE
 - SF — — — — — PROPOSED SILT FENCE
 - - - - - XXXX - - - - - EXISTING MAJOR CONTOUR
 - - - - - XXXX - - - - - EXISTING MINOR CONTOUR
 - - - - - XXXX - - - - - PROPOSED MAJOR CONTOUR
 - - - - - XXXX - - - - - PROPOSED MINOR CONTOUR

- GRADING SPOT LABELS:**
- FG FINISHED GRADE
 - SW SIDEWALK
 - LP LOW POINT
 - HP HIGH POINT
 - ME MATCH EXISTING

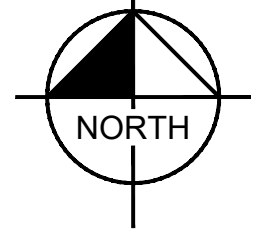
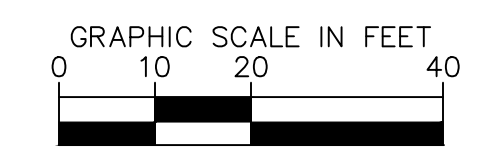
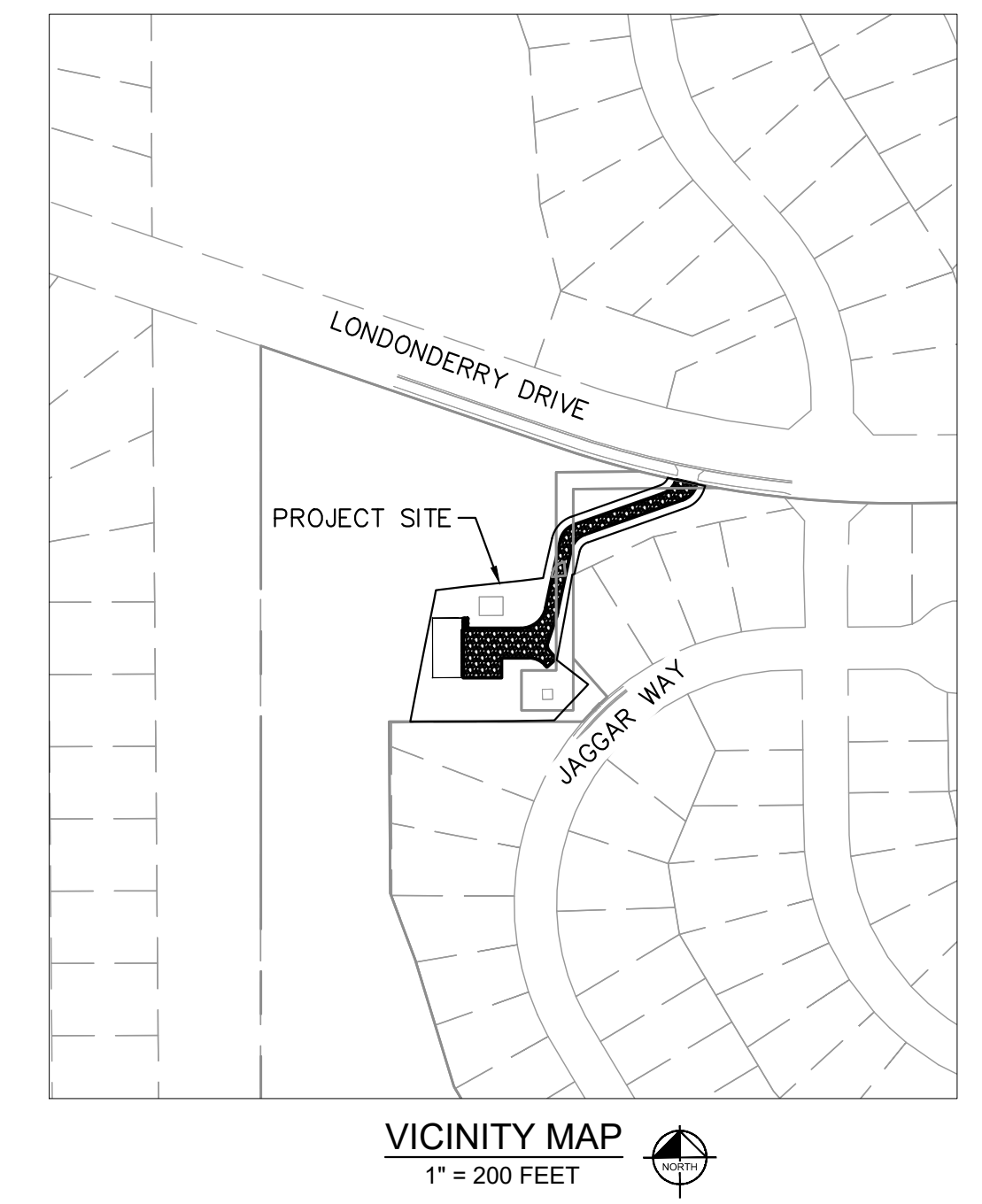

CAUTION: NOTICE TO CONTRACTOR

THE CONTRACTOR IS SPECIFICALLY CAUTIONED THAT THE LOCATION AND/OR ELEVATION OF EXISTING UTILITIES AS SHOWN ON THESE PLANS IS BASED ON RECORDS OF THE VARIOUS UTILITY COMPANIES AND, WHERE POSSIBLE, MEASUREMENTS TAKEN IN THE FIELD. THE INFORMATION IS NOT TO BE RELIED ON AS BEING EXACT OR COMPLETE. THE CONTRACTOR SHALL CALL UTILITY NOTIFICATION CENTER OF COLORADO (UNCC) AT 1-800-922-1987 OR DIAL 811 FOR UTILITY LOCATES 48 HOURS PRIOR TO ANY EXCAVATION WORK. IT SHALL BE THE RESPONSIBILITY OF THE CONTRACTOR TO RELOCATE ALL EXISTING UTILITIES WHICH CONFLICT WITH THE PROPOSED IMPROVEMENTS SHOWN ON THE PLANS.

DATE	DESCRIPTION

Kimley»Horn
 6200 South Syracuse Way, Suite 200 | Greenwood Village, CO 80111 | Tel. No. (303) 228-2300

GRADING AND EROSION CONTROL PLAN
SITE DEVELOPMENT PLAN FOR THE EQUIPMENT STORAGE FACILITY
 EL PASO COUNTY, COLORADO

DRAWN BY: JHJ	DESIGNED BY: RKR	CHECKED BY: ATM	DATE: 06/30/2023
PROJECT No.: 196766000			SCALE: AS SHOWN

PRELIMINARY
 FOR REVIEW ONLY
 NOT FOR CONSTRUCTION
Kimley»Horn
 Kimley-Horn and Associates, Inc.

SHEET
 5