

SITUATED IN SECTION 22, TOWNSHIP 13 SOUTH, RANGE 68 WEST OF THE 6TH P.M.,
CITY OF COLORADO SPRINGS, COUNTY OF EL PASO, STATE OF COLORADO

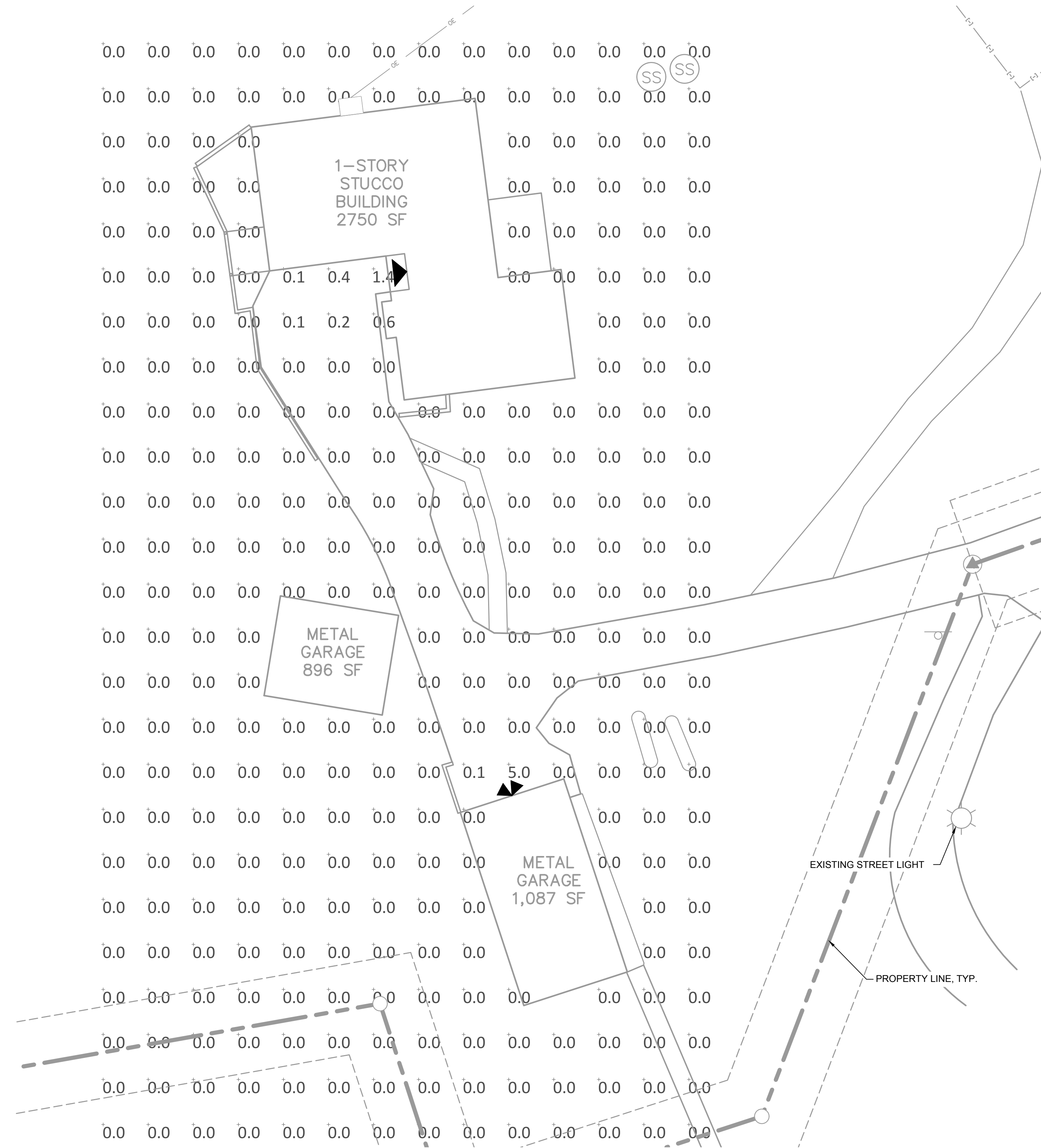



A **PHOTOMETRIC SITE PLAN**
SCALE: 1" = 15'

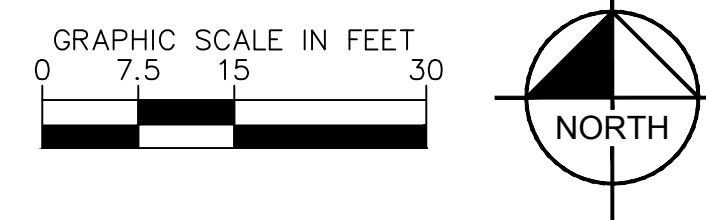

© 2020 KIMLEY-HORN AND ASSOCIATES, INC.
2 NORTH NEVADA AVENUE, SUITE 300
COLORADO SPRINGS, COLORADO 80903 (719) 453-0180



LEGEND

<u>SYMBOL</u>	<u>QTY</u>	<u>MODEL NUMBER</u>	<u>DESCRIPTION</u>	<u>MOUNTING TYPE</u>	<u>MOUNTING HEIGHT</u>	<u>LUMENS/FIXT.</u>
	1	SATW091508L30ENBK	SCNCE	WALL MOUNT	8 FT	725
	1	2L80D2	TWIN FLOODLIGHT	WALL MOUNT TILTED DOWN 25°	14 FT	160

NOTE: THE LIGHT FIXTURES THAT HAVE BEEN MODELED ARE NOT THE EXACT LIGHT FIXTURES INSTALLED ON SITE AND ARE ONLY AN ESTIMATED REPRESENTATION OF THE EXISTING LIGHT FIXTURES ON SITE.

CALCULATION SUMMARY

SITE SUMMARY

ILLUMINANCE (Fc)

MINIMUM = 0.0

MAXIMUM = 5.0

AVERAGE = 0.03

MAX/MIN = N/A

Stratford LED Outdoor Sconce SATW Series

Features

Modern Outdoor LED wall lantern with clear crackle glass.
Dusk-to-Dawn Photocell turns light on at night and off in the morning. The lantern mounts to a standard junction box (not included).

Construction

All aluminum die-cast housing. Power supply connections must be made inside a junction box (not included).

Finish

Black powder coat finish.

Diffuser

Clear 'beehive' glass diffuser features a crackle pattern for an attractive light dispersion.

Electrical

Input 120 VAC / 60 Hz .08A
PhotoCell control light operation switching on at dusk and shut off at dawn.
Not compatible with dimmers.
Minimum starting temp. -4° F/-20° C

LED

Integrated LED module capable of producing:
110W = 1100 source lumens, 725 delivered lumens
3000K (CCT). Rated for 50,000 Hrs. 90 CRI

Certification

All fixtures are cETLus listed for wet locations.
Title 24/LAB Compliant

Warranty

Limited warranty: This fixture is free from defects in materials and workmanship for a period of 5 years from date of purchase.

Specifications and dimensions

subject to change without notice.

LOCATION	DATE
PREPARED BY	QUANTITY
COMMENTS	FIXTURE TYPE
CATALOG NUMBER	

Technical drawings of the Stratford LED Outdoor Sconce SATW Series fixture. The front view shows a width (W) of 11 1/2 inches and a height (H) of 11 inches. The side view shows a depth (D) of 6 1/2 inches and a height (H) of 11 inches. The mounting arm is labeled 2 1/2 inches. The mounting bracket is labeled 1 1/2 inches. The mounting hole is labeled 1 1/2 inches. The mounting bracket is labeled 1 1/2 inches. The mounting hole is labeled 1 1/2 inches.

Ordering Information:





Black	LED	Source Lumens	Delivered Lumens	CCT	H	W	D
SATW09050D_3000K	11W	1100	725	3000K	15 1/4"	8 1/2"	9 1/4"

2345 N. Erie Kluuger Circle • Visalia, CA, 93268 • P: 847.249.5970 • F: 847.249.2618 • AFXinc.com

R/121

Dry-Lite® Lampholders, Garden Lights & Accessories

Lampholders, Die Cast Zinc Zamak 3

	Cat. No.	Color	Lamp Max.	Description
Standard 	L-80	Silver	120W x P&S 38 or R40	Inside painted and ground cover
	D-PAK® DL-80 DL-80-BR DL-80-WHT	Silver Bronze White		
Gasketed 	L-80-D	Silver	120W x P&S 38 or R40	Heavy duty silicone gasket and ground cover
Deep-Shielded 	L-800	120W x P&S 38 or R40		Inside painted and ground cover
Wireguard 	LG-80			Mounts to L-80 series lampholders

Decorative Floodlight

Cat. No.	Color	Lamp Max.	Description
ZLB002	White	120W x P&S 38 or R40	Two lampholders mount cover, single gasket and ground screws
D-PAK® DLZB003	Silver		

Portable Spotlights

Cat. No.	Color	Lamp Max.	Description
K702	Silver	120W x P&S 38 or R40	Standard lampholder, ground hole, metal bracket, gasket, and screw
K700	Silver	120W x P&S 38 or R40	Deep shielded lampholder, ground hole, metal bracket, gasket, and screw

Compact Quartz Fixture

Cat. No.	Color	Lamp Max.	Description
HV-250-CFBR	Bronze	250W x Medium T4 quartz	"Mighty Light" Haze-free fixture includes mounting plate, wire nuts, and lamp

Lampholder Covers

Single Gang Lampholder Covers

Cat. No.	Color	Size	Description
Standard 	Jumbo (2PK x 4PK) LF11	1"	One hole. Dimple mount.
LC-11	—	1"	One hole. Dimple mount.
LC-31	LF31	1"	Three holes. Dimple mount.
Cat. No.	Color	Size	Description
D-PAK® DL-CL-31	Silver	1"	Three holes. Dimple mount.
DLCL-31-BR	Bronze	1"	Three holes. Dimple mount.
DLCL-31-WH	White	1"	Three holes. Dimple mount.

Round Lampholder Covers

Cat. No.	Color	Size	Description
Standard 	Jumbo (4PK diameter) S-1-RD	1 1/2"	One hole. Three holes
S-1-SI	Silver	1 1/2"	One hole. Three holes
S-1-B	Bronze	1 1/2"	One hole. Three holes
S-1-WT	White	1 1/2"	One hole. Three holes
Cat. No.	Color	Size	Description
D-PAK® DS-1	Silver	1 1/2"	One hole tapped hole
DS-1-BR	Bronze	1 1/2"	One hole tapped hole
DS-1-WT	White	1 1/2"	One hole tapped hole
DS-3	Silver	1 1/2"	Three tapped holes
DS-3-BR	Bronze	1 1/2"	Three tapped holes
DS-3-WT	White	1 1/2"	Three tapped holes

H34

© 2003 Thomas & Betts Corporation. Specifications are subject to change without notice. www.tnb.com

Thomas & Betts

B LIGHT FIXTURE CUTSHEETS

SCALE: N.T.S.

SANDSTONE CARE
DEVELOPMENT PLAN

SITUATED IN SECTION 22, TOWNSHIP 13 SOUTH, RANGE 68 WEST OF THE 6TH P.M.,
CITY OF COLORADO SPRINGS, COUNTY OF EL PASO, STATE OF COLORADO

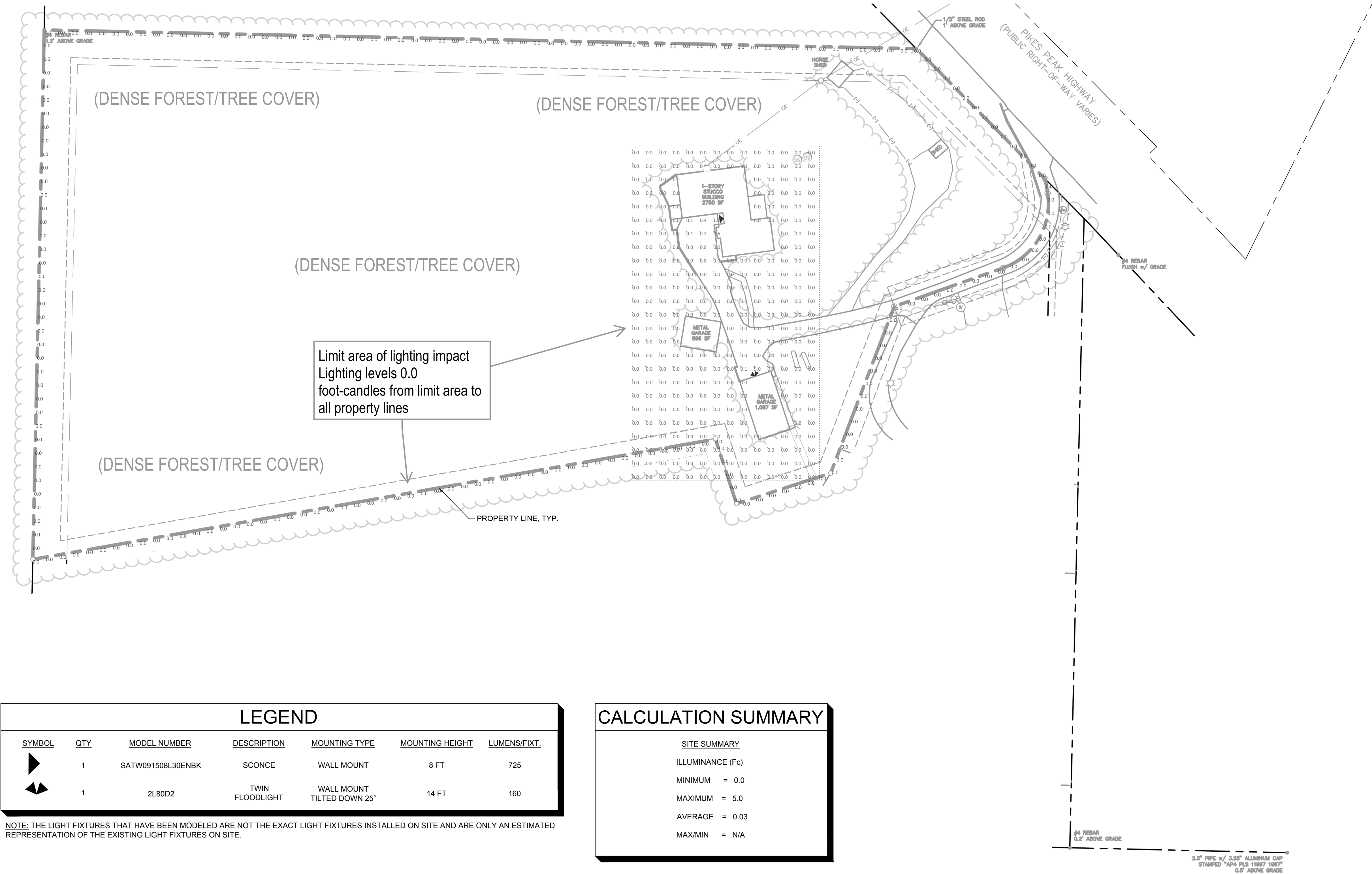

A PHOTOMETRIC SITE PLAN - PROPERTY LINE
SCALE: 1" = 40'

