NOTICE OF INTENT TO LEVY TAX FOR THE PROPOSED KETTLE CREEK
METROPOLITAN DISTRICT, CITY OF COLORADO SPRINGS, COUNTY OF EL PASO,
STATE OF COLORADO

TO: THE ASSESSOR AND THE BOARD OF COUNTY COMMISSIONERS, EL PASO
COUNTY, COLORADO

NOTICE IS HEREBY GIVEN pursuant to Section 39-1-110, C.R.S., and by Order of the proposed Board of Directors of Kettle Creek Metropolitan District, City of Colorado Springs, County of El Paso, Colorado (the “District”), that the Order and Decree of the District Court in and for the County of El Paso and the State of Colorado, creating the District is anticipated to be entered by the District Court and recorded with the Clerk and Recorder of El Paso County prior to December 15, 2026. By said Order and Decree, the District will have been duly formed and organized under the laws of the State of Colorado relating thereto. The legal description and a map showing the boundaries of the District are attached hereto as Exhibit A and incorporated herein by this reference.

NOTICE is further given that said District, once organized and therefore authorized to levy taxes for District purposes, have heretofore taken certain affirmative actions which will ultimately result in the levying of ad valorem taxes on all the taxable property in the District in the year **2026** and thereafter.

IN WITNESS WHEREOF, the proposed Board of Directors of the Kettle Creek Metropolitan District, City of Colorado Springs, El Paso County, Colorado, has caused this Notice to be given effective as of the 24th day of June, 2026.

KETTLE CREEK METROPOLITAN DISTRICT

/s/ Nicole R. Peykov, Esq.

Nicole R. Peykov, Counsel for the proposed District

Exhibit A
Legal Description and Map

LEGAL DESCRIPTION OF KETTLE CREEK METROPOLITAN DISTRICT

Pendleton Subdivision, filed for record on March 13, 1970, under Reception No. 719194 in the official records of the El Paso County Clerk and Recorder.

TOGETHER WITH

A portion of the Northwest Quarter of Section 28, Township 12 South, Range 66 West of the 6th P.M., County of El Paso, State of Colorado.

The above parcels being more particularly described as follows:

A portion of the Southwest Quarter of Section 21 and a portion of the Northwest Quarter of Section 28, Township 12 South, Range 66 West of the 6th P.M., County of El Paso, State of Colorado, being more particularly described as follows:

Bearings are based upon the North line of the Northeast Quarter of Section 28, Township 12 South, Range 66 West of the 6th P.M., monumented at the North Quarter Corner of Section 28 with a 1 1/4" brass cap on 1" diameter pipe, stamped "GLW LS 6359" and monumented at the Northeast Corner of Section 28 with a 3 1/4" aluminum cap, stamped "LS 10956", said line bears N 89°12'01" E, a measured distance of 2641.89 feet.

BEGINNING at a point on the East line of Pendleton Subdivision, filed for record on March 13, 1970, under Reception No. 719194 in the official records of the El Paso County Clerk and Recorder, said point also being the North Quarter Corner of said Section 28; thence S 00°15'21" E along said East line, a distance of 308.91 feet to an angle point on said East line; thence S 80°40'16" W along the South line of said Pendleton Subdivision, a distance of 872.71 feet to an angle point on said South line; thence S 01°10'01" W along the East line of said Pendleton Subdivision, a distance of 443.36 feet to an angle point on said East line; thence S 88°49'59" E, a distance of 92.62 feet; thence 50.04 feet along the arc of a 162.50 foot radius curve to the left, having a central angle of 17°38'31" and a chord that bears S 11°21'53" E, a distance of 49.84 feet; thence 90.58 feet along the arc of a 299.50 foot radius curve to the right, having a central angle of 17°19'42" and a chord that bears S 11°31'18" E, a distance of 90.23 feet; thence S 02°51'27" E, a distance of 49.13 feet; thence 40.33 feet along the arc of a 27.33 foot radius curve to the right, having a central angle of 84°34'21" and a chord that bears S 50°08'42" W, a distance of 36.77 feet; thence S 86°52'03" W, a distance of 539.07 feet; thence S 87°02'27" W, a distance of 86.63 feet; thence S 86°50'10" W, a distance of 137.13 feet; thence S 84°33'54" W, a distance of 177.23 feet to a point on the Southwesterly extension of the West line of said Pendleton Subdivision;

thence N 42°02'48" E along said West line, a distance of 1680.78 feet;
thence 157.00 feet along the arc of a 50.00 foot radius curve to the right, having a central angle of 179°54'37" and a chord that bears N 78°57'00" E, a distance of 100.00 feet;
thence N 42°03'52" E, a distance of 410.89 feet;
thence N 20°39'37" E, a distance of 118.28 feet;
thence N 89°29'01" E, a distance of 168.68 feet;
thence S 00°18'16" E, a distance of 520.84 feet to the POINT OF BEGINNING.

Containing a calculated area of 897,375 square feet (20.601 acres) of land, more or less.

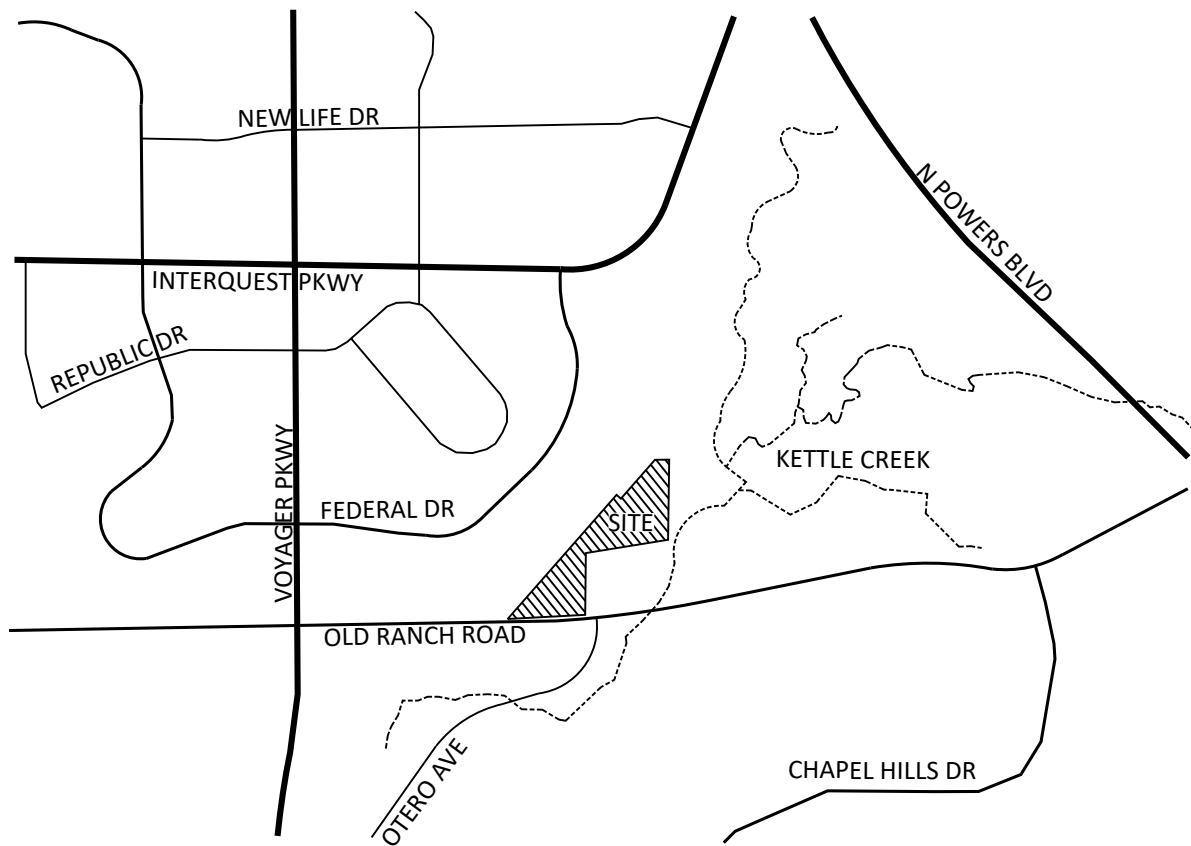

KETTLE CREEK FILING NO 1

DATE: 5-28-26

ISSUED FOR: VICINITY MAP

DRAWN BY: AR

DWG. REF.: PDZD-25-0034

SCALE: 1" = x'

DWG. #:



NORTH



SCALE: 1" = 2000'



N.E.S. Inc.
 619 N. Cascade Ave.
 Suite 200
 Colorado Springs, CO 80903
 Tel. 719.471.0073
 Fax 719.471.0267
 www.nescolorado.com