



Planning and Community Development  
2880 International Cir. Suite 110  
Colorado Springs, CO 80910

DENVER CO 802

2 APR 2025 PM 6 L

FIRST-CLASS



US POSTAGE PITNEY BOWES



ZIP 80910 \$ 000.690  
02 7H  
0001332609 MAR 31 2025

6503402010  
GARDELS JEFFREY M  
PO BOX 15588  
COLORADO SPRINGS, CO 80935-5588

*JAC*

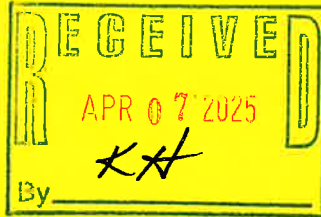

NOTICE OF ADMINISTRATION

NIXIE 808 DE 1 0004/06/25

RETURN TO SENDER  
VACANT  
UNABLE TO FORWARD

BC: 80910610799 \*1320-05388-02-30

VACANT  
0001000000

COPYRIGHT 2022 by the Board of County Commissioners, El Paso County, Colorado. All rights reserved. No part of this document or data contained herein may be reproduced, stored in a retrieval system, or transmitted in any form or by any means, electronic, mechanical, photocopying, recording, or by any information storage and retrieval system, without the prior written approval of the Board of County Commissioners, El Paso County, Colorado. This document was prepared from the best data available at the time of printing. El Paso County, Colorado, does not warrant as to the completeness or accuracy of the data contained herein.



Please report any parcel discrepancies to:  
El Paso County Assessor  
1675 W. Garden of the Gods Rd.  
Colorado Springs, CO 80907  
(719) 520-6600

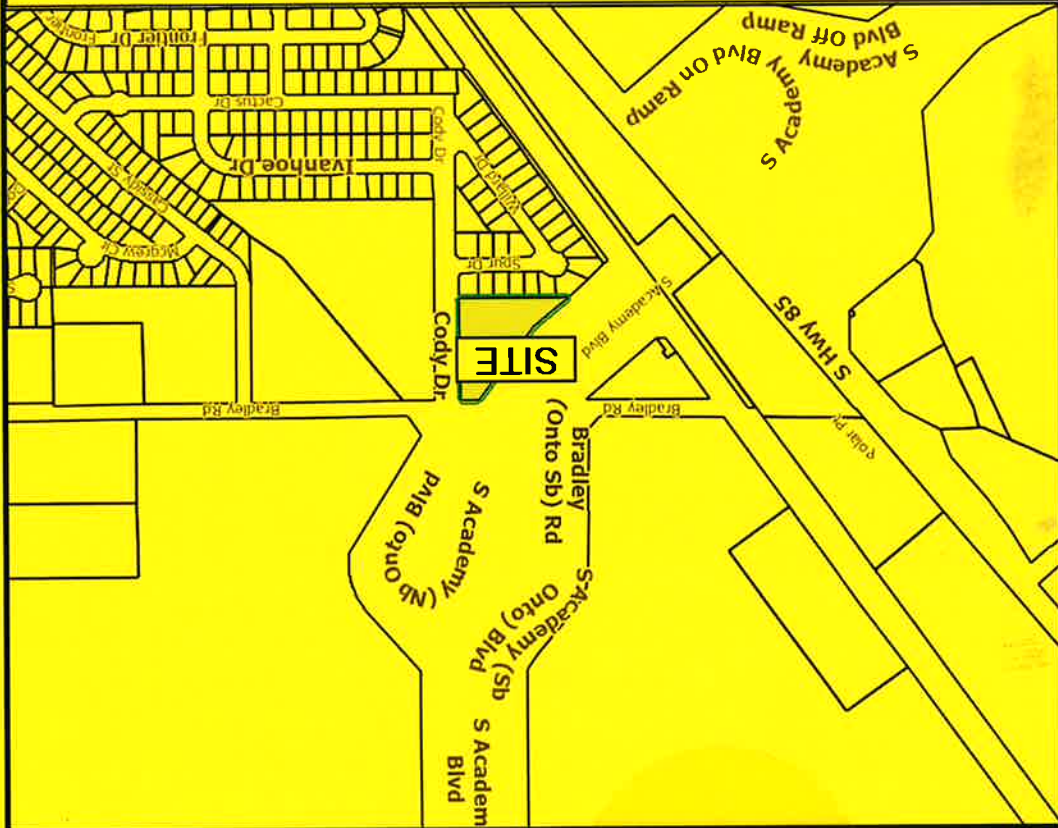

EL PASO COUNTY  
PARCEL INFORMATION

FILE NO.: AL251

PARCEL NO.: 6503401031

OWNER: James & Joan Willis

ADDRESS: 2620 Cody Drive