



March 13, 2018

Ms. Nina Ruiz  
El Paso County  
Planning and Community Development  
2880 International Parkway  
Colorado Springs, Colorado 80910

**RE: Widefield Commercial Center Subdivision Filing No. 1 Standalone Grading Request, Final Drainage Letter, El Paso County, Colorado (Kiowa Project No. 17044)**

Dear Ms. Ruiz:

As requested by the County, a Final Drainage Letter has been prepared in support of the standalone grading request for the Widefield Commercial Center Subdivision No. 1. The Owners of the property, Glen Investments II intend to complete overlot grading of the property in anticipation of future development of the site. The site was platted in 2009 and at that time it was proposed for commercial use, specifically mini-warehouses. The location of the site is shown on attached Figure 1.

The final drainage report entitled "Preliminary Drainage Report Widefield Commercial Center Subdivision Filing No. 1 and Final Drainage Report for Lot 1 and Tract A Widefield Commercial Center Subdivision Filing No. 1" was prepared by Kiowa Engineering in 2010 and subsequently approved by the County in July 2001. This report has been reviewed by Kiowa as part of preparing the overlot grading plan for the site. Based upon this review, the proposed overlot as proposed by the Owner grading will not alter or change the findings of the approved drainage report for this Subdivision. The completion of the grading as proposed will not prevent the stormwater management facilities constructed in the future from being in conformance with the approved final drainage report for the Subdivision.

If you have any questions, please do not hesitate to contact us.

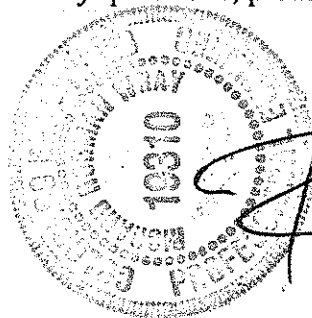

Sincerely,  
**KIOWA ENGINEERING CORPORATION**

Richard N. Wray, P.E.  
Principal

17044 fdl

[See the Grading and Erosion Control Plan which includes comments that affect the drainage letter](#)

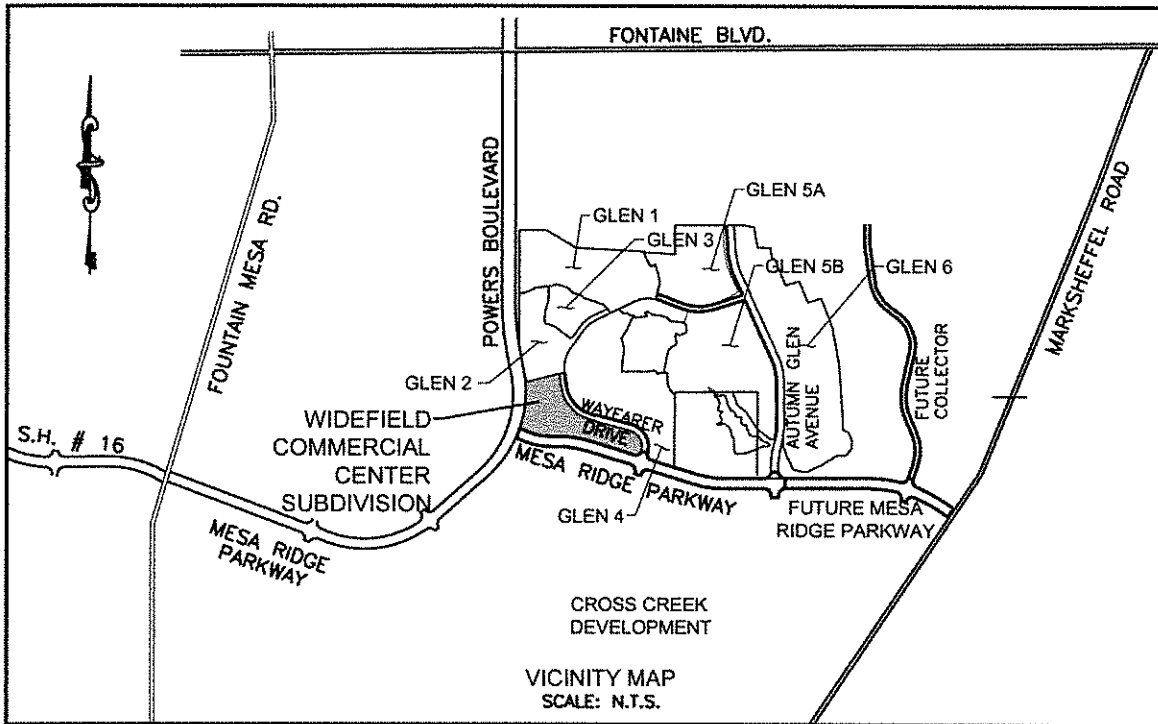

**FIGURE 1**  
**VICINITY MAP**  
**WIDEFIELD COMMERCIAL CENTER SUBDIVISION**  
 EL PASO COUNTY, COLORADO

DATE: 03/25/10  
 PROJECT NO. 09011

**Kiowa**  
 Engineering Corporation

1604 South 21st Street  
 Colorado Springs, Colorado 80904  
 (719) 630-7342

**STATEMENTS AND APPROVALS**

**ENGINEER'S STATEMENT:**

The attached drainage letter was prepared under my direction and supervision and are correct to the best of my knowledge and belief. Said drainage letter has been prepared according to the criteria established by the City/County for drainage reports and said report is in conformity with the master plan of the drainage basin. I accept responsibility for any liability caused by any negligent acts, errors or omissions on my part in preparing this drainage letter.

Kiowa Engineering Corporation, 1604 South 21st Street, Colorado Springs, Colorado 80904

\_\_\_\_\_  
Registered Engineer (PE #19310)  
For and on Behalf of Kiowa Engineering Corporation

\_\_\_\_\_  
Date

**DEVELOPER'S STATEMENT:**

I, the Developer, have read and will comply with all of the requirements specified in this drainage report and plan.

By: \_\_\_\_\_  
Ryan Watson, Principal  
Glen Investments II

\_\_\_\_\_  
Date

Print Name: \_\_\_\_\_  
Address: Glen Development  
3 Widefield Boulevard  
Colorado Springs, Colorado 80911

**EL PASO COUNTY:**

Filed in accordance with the requirements of the Drainage Criteria Manual, Volumes 1 & 2, El Paso County Engineering Criteria Manual, and Land Development Code, as amended.

\_\_\_\_\_  
Jennifer Irvine, P.E.  
El Paso County Engineer/ECM Administrator

\_\_\_\_\_  
Date