

EL PASO COUNTY



COMMISSIONERS:
DARRYL GLENN (PRESIDENT)
MARK WALLER (PRESIDENT PRO TEMPORE)

STAN VANDERWERF
LONGINOS GONZALEZ
PEGGY LITTLETON

PLANNING AND COMMUNITY DEVELOPMENT DEPARTMENT
CRAIG DOSSEY, EXECUTIVE DIRECTOR

4/09/2019

RE: Administrative Special Use Request for 2420 Wayland Place Development

File: AL197
Parcel ID: 5406204027

*Copies
mailed
4/12/2019*

To Whom It May Concern:

This letter is to inform property owners adjacent to 2420 Wayland Place that the applicant has requested a special use to allow for a contractor equipment yard within the I-2 CAD-O zoning district. The request includes grading for the contractor equipment yard. The Planning and Community Development Director may make a formal decision regarding the request on April 25, 2019 at 4:30 P.M. Any comments or questions may be forwarded to me prior to that decision. At the discretion of the Planning and Community Development Director, the approval process may be elevated to the Board of County Commissioners for consideration. Administrative approval by the Planning and Community Development Director is subject to the appeal provisions of the Land Development Code.

You may view the application documents online at www.epcdevplanreview.com. Please feel free to contact me with any questions, comments, or concerns you may have prior to the decision.

Respectfully,

Lindsay Darden, Planner II
El Paso County Planning and Community Development
719-520-6302
LindsayDarden@elpasoco.com

2880 INTERNATIONAL CIRCLE, SUITE 110
PHONE: (719) 520-6300



COLORADO SPRINGS, CO 80910-3127
FAX: (719) 520-6695

www.ELPASOCO.com

El Paso County Parcel Information

File Name:

PARCEL	NAME
5406204027	2425 WAYLAND PLACE LLC

Zone Map No.

ADDRESS	CITY	STATE
PO BOX 8040	FORT WAYNE	IN

ZIP	ZIPLUS
46898	8040

Date:

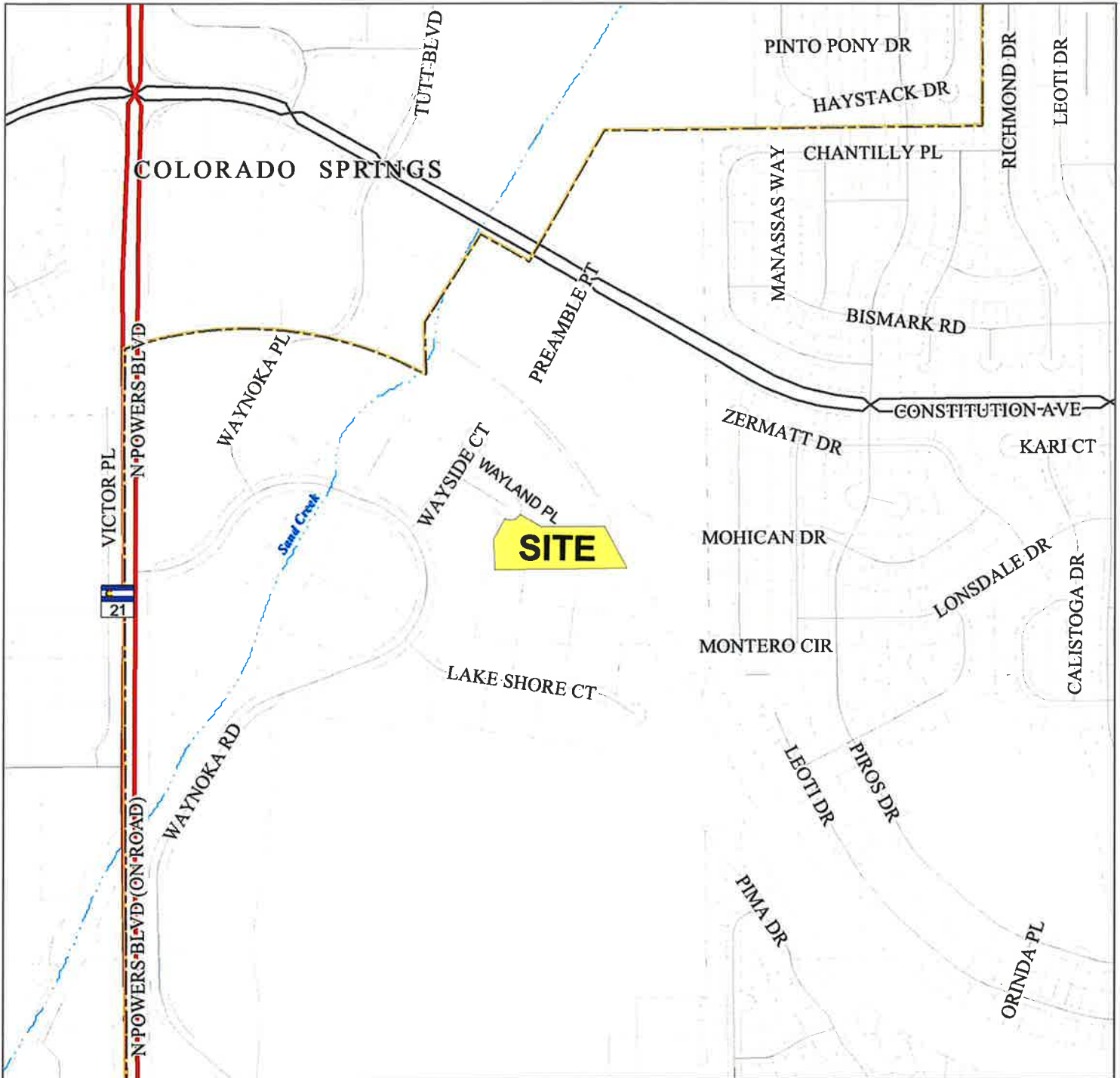

Please report any parcel discrepancies to:
 El Paso County Assessor
 1675 W. Garden of the Gods Rd.
 Colorado Springs, CO 80907
 (719) 520-6600



COPYRIGHT 2018 by the Board of County Commissioners, El Paso County, Colorado. All rights reserved. No part of this document or data contained hereon may be reproduced; used to prepare derivative products; or distributed without the specific written approval of the Board of County Commissioners, El Paso County, Colorado. This document was prepared from the best data available at the time of printing. El Paso County, Colorado, makes no claim as to the completeness or accuracy of the data contained hereon.

5406200004
COLORADO SPRINGS CITY OF
30 S NEVADA AVE STE 701
COLORADO SPRINGS, CO 80903

5406204025
SIG WAYNOKA LLC
1185 GOLDEN HILLS RD
COLORADO SPRINGS, CO 80919

5406204037
SPRINGS INDUSTRIAL GROUP LLC
1185 GOLDEN HILLS RD
COLORADO SPRINGS, CO 80919

5406204026
ACKERMAN TRACY E
2407 WARWICK LN
COLORADO SPRINGS, CO 80909

5406204042
OUTLOOK INVESTMENTS LLC
6160 LAKE SHORE CT
COLORADO SPRINGS, CO 80915

5406204040
SBR PROPERTIES L L C
7273 COTTONWOOD TREE DR
COLORADO SPRINGS, CO 80927

5406204028
2425 WAYLAND PLACE LLC
3902 MAIZELAND RD
COLORADO SPRINGS, CO 80909

5406204027
2425 WAYLAND PLACE LLC
PO BOX 8040
FORT WAYNE, IN 46898