

SWAN RD

# Field & Treed Property

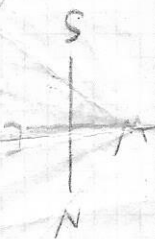

Herring RD

Burms Die into Natural Hillside

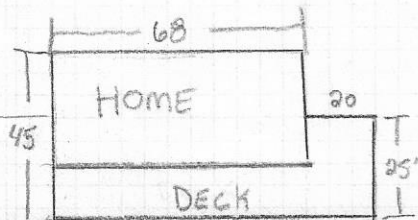

HLS STA OMTS



Adjacent Property  
Constance Porace  
7710 Swan Rd

CRUSHED ASPHALT DRIVE

PROPOSED WOOD FENCE TO MATCH Frontgate

PROPOSED YARD

outside storage to be stacked along masonry wall

GRASS

FIELD (Volleyball/Soccer)

PROPOSED SHOP

Burms

Adjacent Property  
Teresa Owen  
13650 Herring rd

Approved

By: Craig Dossey, Executive Director

Date: 12/03/2019



El Paso County Planning & Community Development