

SOUTHMOOR RIDGE

VICINITY MAP

A TRACT OF LAND LOCATED IN A PORTION OF THE NORTH HALF OF THE NORTHWEST QUARTER OF SECTION 24, AND IN A PORTION OF THE SOUTH HALF OF THE SOUTHWEST QUARTER OF SECTION 13, ALL IN TOWNSHIP 15 SOUTH, RANGE 66 WEST OF THE 6TH P.M., COUNTY OF EL PASO, STATE OF COLORADO

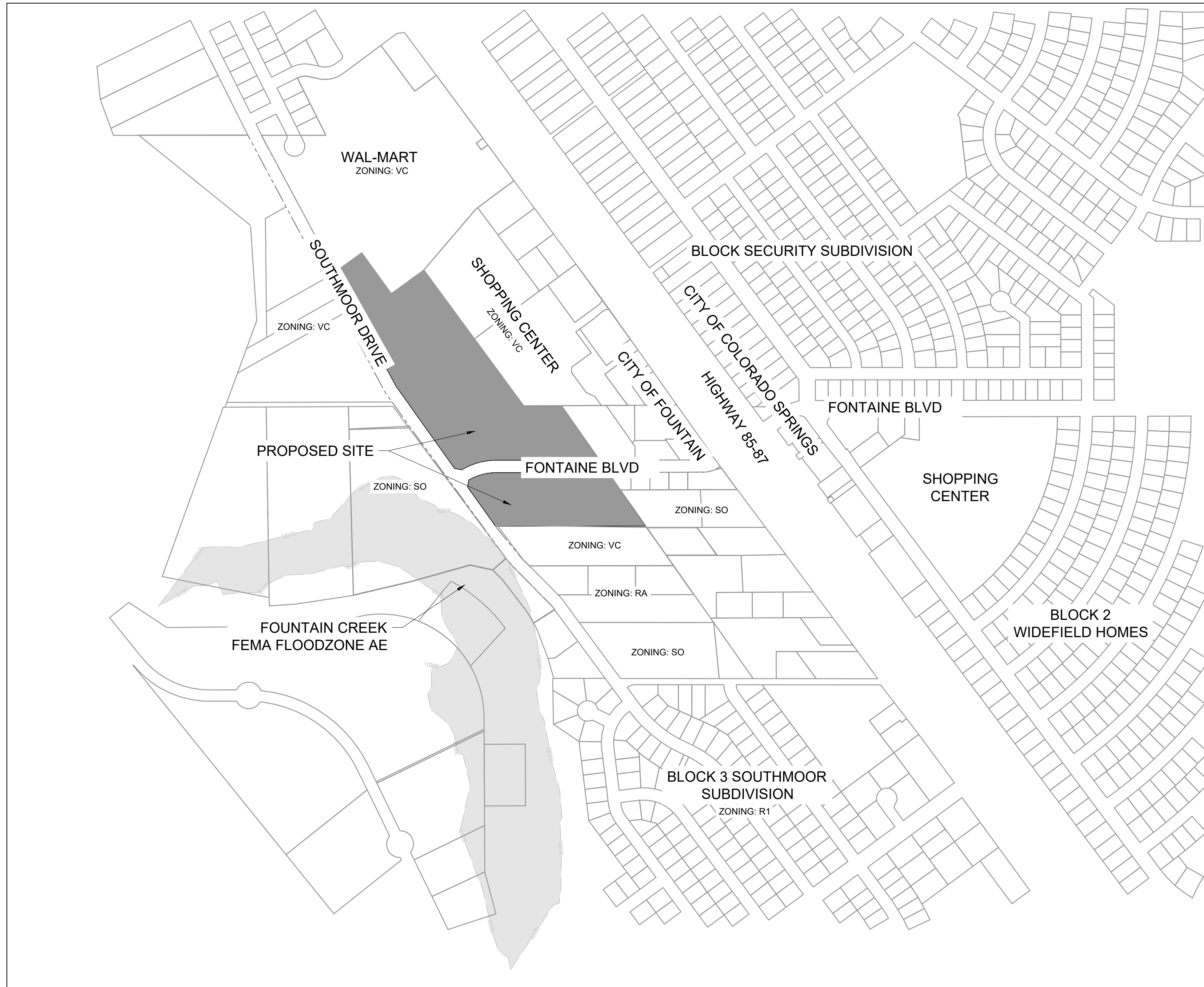

VICINITY MAP
SCALE: 1"=1,000'

LYON, RICHELIE, 2/12/2024, 2:12 PM

HR GREEN Xref: xc-dgn; xgt-1-d01_24x36; xc-uti; xv-row-3146; xc-row; xv-dgn-3146; rony_tpcals; xv-uti-3146; Legend_ODP; Vicinity_Map

DRAWN BY: DLH JOB DATE: 2/12/2024
 APPROVED: RDL JOB NUMBER: 2303146
 CAD DATE: 1/5/2024
 CAD FILE: J:\2023\2303146\CAD\Drawings\Civility_Map\Vicinity-Map_2303146

BAR IS ONE INCH ON OFFICIAL DRAWINGS.
 0 1"
 IF NOT ONE INCH, ADJUST SCALE ACCORDINGLY.

NO.	DATE	BY	REVISION DESCRIPTION



HR GREEN - COLORADO SPRINGS
 7222 COMMERCE CENTER DR. SUITE 220
 COLORADO SPRINGS CO 80919
 PHONE: 719.622.6222
 FAX: 844.273.1057

SOUTHMOOR RIDGE
 DHN DEVELOPMENT INC.
 FOUNTAIN, COLORADO

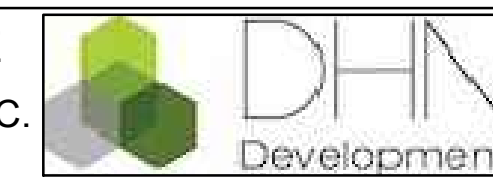

CONCEPT PLAN & OVERALL DEVELOPMENT PLAN
 VICINITY MAP

SHEET
 VM

1