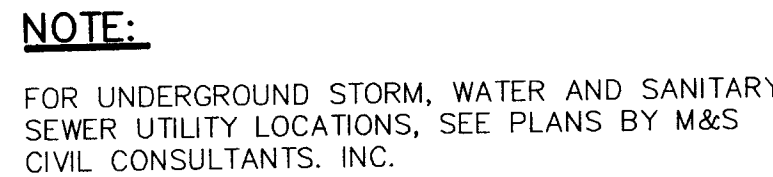

File: C:\09002A\Sterling Ranch District\dwg\Const Dwg\Street\Waller Rd\Waller Temp Tie-In Set\S01.dwg Plotstamp: 2/1/2019 3:34 PM

[illegible]

STRIPING LEGEND		
STRIPE	PAVEMENT MARKINGS	MARKING DESCRIPTION
①	2-WAY LEFT TURN LANE MARKINGS (EPOXY)	OUTSIDE: SOLID YELLOW, 4" WIDE, INSIDE: BROKEN YELLOW, 4" WIDE, 10' SEGMENTS WITH 30" GAPS
②	2-WAY CENTERLINE LANE MARKINGS (EPOXY)	PARALLEL SOLID YELLOW, 4" WIDE, 12' APART
③	LANE LINES (EPOXY)	BROKEN YELLOW, 4" WIDE, 10' SEGMENTS WITH 30" GAPS
④	BROKEN EDGE/BIKE LANE LINES (EPOXY)	BROKEN WHITE, 4" WIDE, 5' SEGMENTS WITH 15" GAPS
⑤	EDGE/BIKE LANE LINES (EPOXY)	SOLID WHITE, 4" WIDE
⑥	CHANNELIZING LINES (EPOXY)	SOLID WHITE, 8" WIDE
⑦	STOP LINES (THERMO PLASTIC)	SOLID WHITE, 24" WIDE
⑧	CROSS HATCHING LINES (EPOXY)	SOLID WHITE, 8" WIDE

NOTE TO CONTRACTOR:

1. ALL 4" AND 8" SOLID OR SKIP PAVEMENT MARKINGS ARE TO BE EPOXY.
2. SIGNS AND POLES SHALL BE PER CDOT STANDARDS S-614-8, S-1614-2, AND S-614-3, LATEST REVISION.
3. ALL SIGNAGE INSTALLATION IS TO BE IN COMPLIANCE WITH THE MANUAL ON UNIFORM TRAFFIC CONTROL DEVICES (MUTCD).

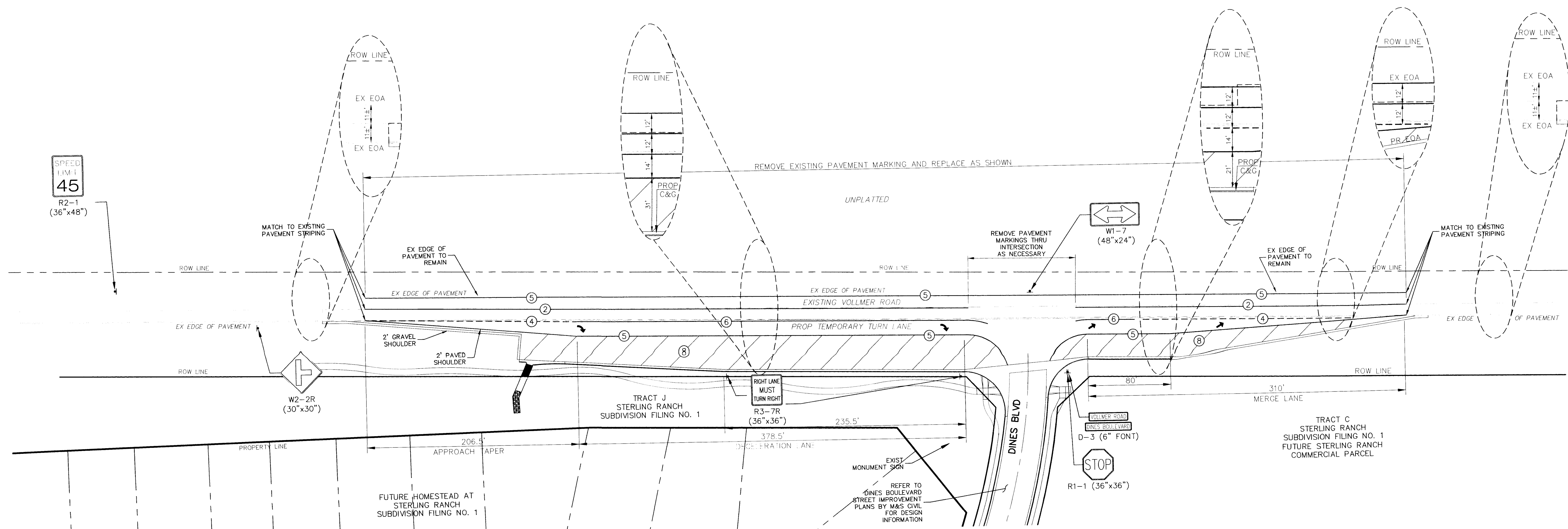
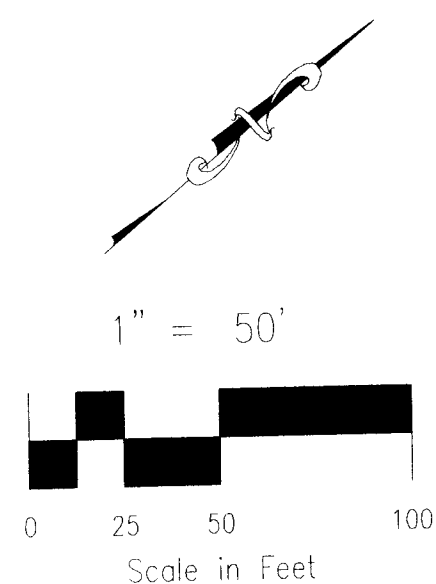
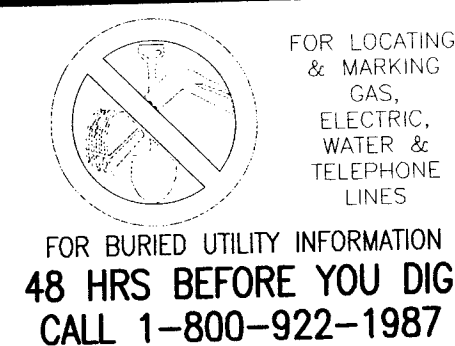

VOLLMER ROAD - PHASE 1 -INTERIM
AT DINES BLVD INTERSECTION

PROPOSED PAVEMENT
PHASE 1

EXISTING VOLLMER PAVEMENT

200 BOULDER CRESCENT, SUITE 110
COLORADO SPRINGS, CO 80903
PHONE: 719.955.5485

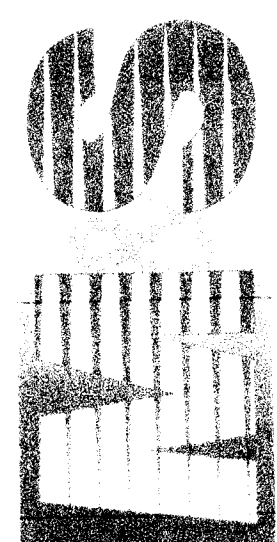

VIRGIL A. SANCHEZ, COLORADO P.E. NO. 37160

FOR AND ON
BEHALF OF
M&S CIVIL
CONSULTANTS,
INC.

Aug 24. 1864

[illegible]

CAUTION