

NEW TRAFFIC CONTROL SIGNAL PLAN Mast-Arm Traffic Signal Plan Sheet Marksheffel Road & Lorson Boulevard

LSC TRANSPORTATION CONSULTANTS
10000 Highway 100, Suite 100
Houston, Texas 77055
713.465.1234
www.lsc-transportation.com
Any reproduction, dissemination or use of these plans or any part thereof without the written permission of LSC Transportation Consultants, INC. is prohibited and will be prosecuted to the fullest extent of the law.

Prepared By:
JAMES C. KOSKOWSKI

REVISIONS DATE
Cals Spg Comments 5/16/23

DATE: 5/16/23
SCALE: 1" = 40'-0"
DRAWN BY: JAMES C. KOSKOWSKI
JOB NO.: 20230001
DWG. NO.: 01 of 1

SHT NO.: 2

OF 3

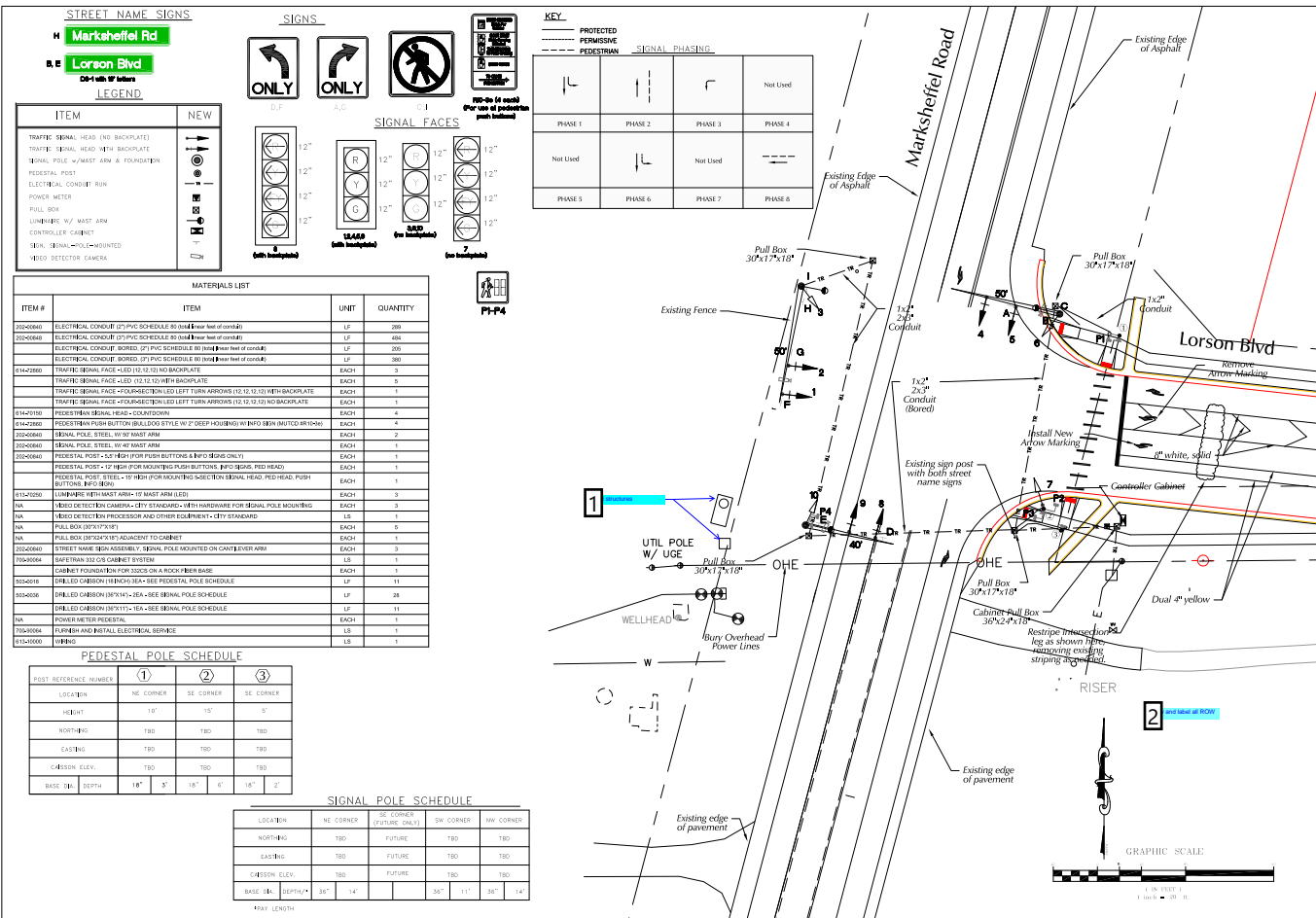

LSC Responses to Comments

Marksheffel Road_Lorson Blvd. - Signal Design

Page: 2

 Number: 1 Author: CDurham Subject: Callout Date: 6/12/2023 17:32:59

[Label structures](#)

 Author: jchodsdon Subject: Sticky Note Date: 7/2/2023 23:16:40

LSC Response: Added as requested.

 Number: 2 Author: CDurham Subject: Text Box Date: 6/12/2023 17:33:06

[Show and label all ROW](#)

 Author: jchodsdon Subject: Sticky Note Date: 7/2/2023 23:17:00

LSC Response: Added as requested.