

Schedule											
Symbol	Label	Image	Quantity	Manufacturer	Catalog Number	Description	Number Lamps	Lumens Per Lamp	Light Loss Factor	Wattage	Plot
□	WP1		6	Lithonia Lighting	WDGE2 LED P5 40K 80CRI VF	WDGE2 LED WITH P5 - PERFORMANCE PACKAGE, 4000K, 80CRI, VISUAL COMFORT FORWARD OPTIC	1	5996	0.92	48.44	
○	D		4	Lithonia Lighting	LDN6 40/15 L06AR LSS	6IN LDN, 4000K, 1500LM, CLEAR, SEMI-SPECULAR REFLECTOR, CRI80	1	1516	0.9	17.52	

Statistics						
Description	Symbol	Avg	Max	Min	Max/Min	Avg/Min
Site	+	0.8 fc	8.6 fc	0.0 fc	N/A	N/A

THIS DOCUMENT AND ITS CONTENTS ARE THE WORK PRODUCT AND PROPERTY OF 51EC, INC., WHICH RETAINS ALL COMMON LAW, STATUTORY AND OTHER RESERVED RIGHTS, INCLUDING THE COPYRIGHT.

**PHOTOMETRICS**  
7920 INDUSTRY ROAD  
COLORADO SPRINGS, CO 80939

REV	DESCRIPTION	DRAWN	CHECK	APPR	DATE

ISSUANCE:	<b>ISSUED FOR REVIEW</b>
CLIENT:	HAMMERS CONSTRUCTION 1411 WOOLSEY HEIGHTS COLORADO SPRINGS, CO 80915
ARCHITECT:	HAMMERS CONSTRUCTION 1411 WOOLSEY HEIGHTS COLORADO SPRINGS, CO 80915
PROJECT NO:	5151-22-03
TITLE:	<b>SITE PHOTOMETRICS PLAN</b>
SHEET NO:	<b>E-100</b>

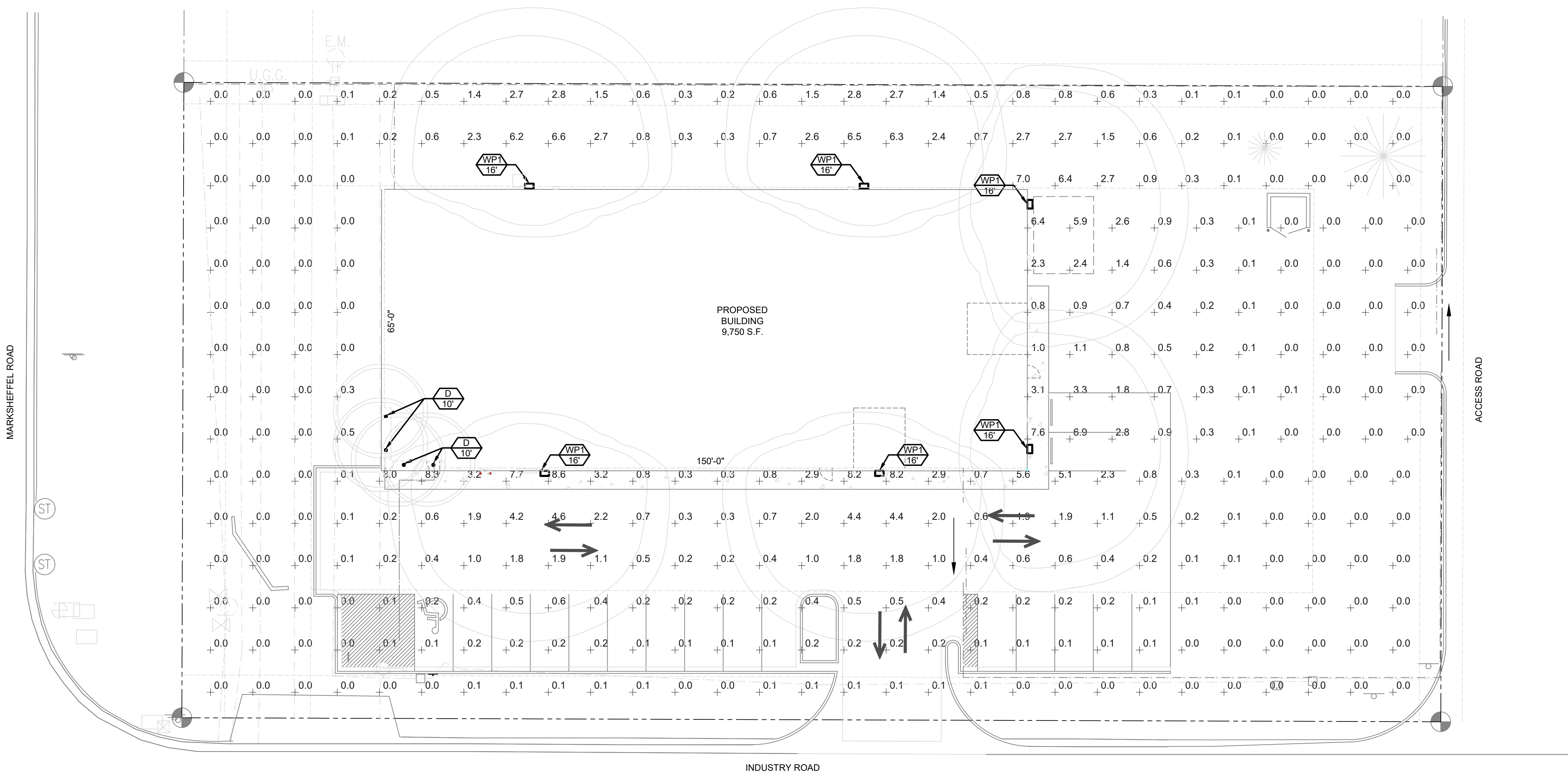

**SITE PHOTOMETRICS PLAN**  
SCALE: 1/16" = 1'-0"

### WDGE2 LED Architectural Wall Sconce Visual Comfort Optic



WDGE2 LED P5 40K 80CRI VF

QTY: 6

Type: WP1

Buy American

#### Specifications

Depth (D1): 7" Depth (D2): 1.5" Width: 9" Weight (without options): 13.5 lbs

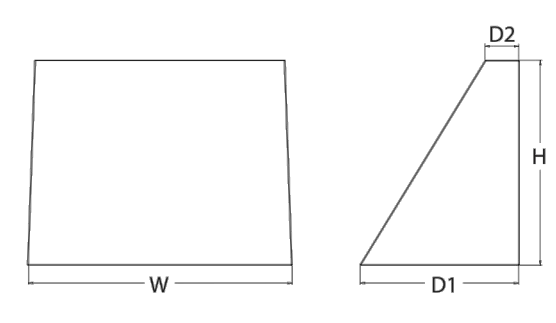

#### WDGE LED Family Overview

Luminaire	Optics	Standard EM, D.C.	Cold EM, 20°C	Sensor	PS	P1	P2	P3	P4	P5	P6
WDGE1 LED	Visual Comfort	4W	-	-	750	1,200	2,000	-	-	-	-
WDGE2 LED	Visual Comfort	10W	18W	Standalone / r/light	-	1,200	2,000	3,000	4,500	6,000	-
WDGE3 LED	Precision Reflective	10W	18W	Standalone / r/light	700	1,200	2,000	3,200	4,200	-	-
WDGE4 LED	Precision Reflective	15W	18W	Standalone / r/light	-	7,500	8,500	10,000	12,000	-	-
WDGE4 LED	Precision Reflective	-	-	Standalone / r/light	-	12,000	16,000	18,000	20,000	22,000	25,000

#### Ordering Information

EXAMPLE: WDGE2 LED P3 40K 80CRI VF MVOLT SRM DDBXD

Series	Package	Color Temperature	CRI	Distribution	Voltage	Mounting	Shipped separately
WDGE2 LED	P1*	P1SW	27K / 2700K	80CRI	VF	Visual comfort forward throw	MVOLT
	P2*	P2SW	30K / 3000K	90CRI	VF	Visual comfort forward throw	SM
	P3*	P3SW	35K / 3500K	90CRI	YW	Visual comfort wide	KW
	P4*		40K / 4000K				Indirect Canopy/Ceiling
	P5		50K / 5000K				Whiteboard/dry/erase locutions only

Options: E4WH, E10WH, E20WC, PE1, DS1, DMG4, NL10A2, NL10A2 PIR, NL10A2 PIR1, BAA

Options: Standalone Sensors/Controls, Networked Sensors/Controls

Options: DDBXD, DDBLX, DNAXD, DNAXD, DWHXD, DSSXD, DSRXD, DTRXD, DNAXD, DWHXD, DSSXD, DSRXD, DTRXD

LITHONIA LIGHTING COMMERCIAL OUTDOOR One Lithonia Way • Conyers, Georgia 30012 • Phone: 1-800-705-SERV (7378) • www.lithonia.com WDGE2 LED Rev. 03/01/22

#### Accessories

Default configuration with no sensors/controls. Power Packages: P1, P2, P3, P4, P5

#### Performance Data

#### Lumen Output

Performance Package	System Watts	DLG Type	27K (2700K, 80 CRI)					30K (3000K, 90 CRI)					35K (3500K, 90 CRI)					40K (4000K, 90 CRI)												
Package	Watts	Type	Lumens	lm/w	h	h	h	h	h	Lumens	lm/w	h	h	h	h	Lumens	lm/w	h	h	h	Lumens	lm/w	h	h	h	h				
P1 / P1SW	10W	VF	1,166	119	0	0	0	0	0	1,209	123	0	0	0	0	1,251	128	0	0	0	1,293	131	0	0	0	1,335	134			
			1,197	122	0	0	0	0	0	1,241	126	0	0	0	0	1,284	131	0	0	0	1,326	131	0	0	0	1,368	131	0	0	
P2 / P2SW	15W	VF	1,878	129	1	0	0	0	0	1,947	134	1	0	0	0	2,015	139	1	0	0	2,083	139	1	0	0	2,151	139	1	0	
			1,927	133	1	0	0	0	0	1,997	137	1	0	0	0	2,067	142	1	0	0	2,135	143	1	0	0	2,203	143	1	0	
P3 / P3SW	23W	VF	2,908	129	1	0	0	0	0	3,015	134	1	0	0	0	3,119	138	1	0	0	3,223	139	1	0	0	3,326	139	1	0	
			2,983	132	1	0	0	0	0	3,093	137	1	0	0	0	3,200	142	1	0	0	3,313	143	1	0	0	3,426	142	1	0	
P4	35W	VF	4,096	117	1	0	1	0	1	4,247	121	1	0	1	4,394	126	1	1	0	1	4,542	126	1	1	0	1	4,690	126	1	1
			4,202	120	1	0	1	0	1	4,357	125	1	0	1	4,508	129	1	0	1	4,626	129	1	0	1	4,747	129	1	0		
P5	48W	VF	5,567	115	1	0	1	0	1	5,772	119	1	0	1	5,976	124	1	0	1	6,180	124	1	0	1	6,384	124	1	0	1	
			5,711	118	1	0	1	0	1	5,921	122	1	0	1	6,127	126	1	0	1	6,331	127	1	0	1	6,535	127	1	0	1	

#### Electrical Load

Performance Package	System Watts	Current (A)
P1 / P1SW	10W	0.082 / 0.049 / 0.043 / 0.038
	15W	0.132 / 0.081 / 0.072 / 0.064
P2 / P2SW	15W	0.132 / 0.081 / 0.072 / 0.064
	23W	0.195 / 0.114 / 0.100 / 0.088
P3 / P3SW	23W	0.195 / 0.114 / 0.100 / 0.088
	35W	0.302 / 0.175 / 0.152 / 0.134
P4	35W	0.302 / 0.175 / 0.152 / 0.134
	48W	0.434 / 0.241 / 0.211 / 0.184
P5	48W	0.434 / 0.241 / 0.211 / 0.184
	52W	0.466 / 0.262 / 0.228 / 0.200

#### Lumen Multiplier for 90CRI

LED	Multiplier
27K	0.845
30K	0.867
35K	0.845
40K	0.858
50K	0.898

#### Lumen Output in Emergency Mode (4000K, 80 CRI)

Optics	Rev. Type	Lumens
E4WH	VF	646
E10WH	VF	647
	VF	1,658
	VF	1,701
E20WC	VF	2,840
	VF	2,913

#### Projected LED Lumen Maintenance

Use these factors to determine relative lumen output for average ambient temperatures from 40°C (104°F) to 25°C (77°F).

Operating Hours	0	25,000	50,000	100,000
Lumen Maintenance Factor	1.0	>0.96	>0.95	>0.91

One Lithonia Way • Conyers, Georgia 30012 • Phone: 1-800-705-SERV (7378) • www.lithonia.com WDGE2 LED Rev. 03/01/22

### LITHONIA LIGHTING

## LDN6

#### Features & Specifications

6" Open and Wall Wash LED Non-IC New Construction Downlight

LDN6 40/15 LOBAR LSS

QTY: 4

Type: D

APPLICABLE OPTIONS INDICATED BY THIS COLOR BACKGROUND

Series	Color Temperature	Lumens*	Aperture/Trim Color		Finish	Voltage	
LDN6	6" round	27 / 2700K	85	500 lumens	LD6 Downlight	AR Clear	MVOLT Multi-volt
		30 / 3000K	87	750 lumens	LD6 Downlight	WR? White	120V
		35 / 3500K	10	1000 lumens	LD6 Downlight	BR? Black	277 / 277V
		40 / 4000K	15	1500 lumens	LW6 Wall Wash	LS Specular	347 / 347V
		50 / 5000K	20	2000 lumens	LW6 Wall Wash	LS Specular	347 / 347V

#### Options

Driver	Options
G210	0-10V driver dims to 10%
G211	0-10V driver dims to 1%
D10	Minimum dimming 10% driver for use with .01
D1	Minimum dimming 1% driver for use with .01
E210	0-10V eLED driver with smooth and flicker-free dimming performance down to 10%
E21	0-10V eLED driver with smooth and flicker-free dimming performance down to 1%
E210D	0-10V eLED driver with dim-to-dark

#### Accessories

Order as separate catalog number.

P50SSCP: FMC Power Sentry battery pack, T20 compliant, field installable, 10w constant power

ELC63M-275: Compact Interchangeable emergency AC power system

ELC63M-325: Compact Interchangeable emergency AC power system

GRAB-EZ: Over-sized trim ring with 6" outside diameter

SC6: Sloped Ceiling Adapter. Degree of slope must be specified (0, 100, 150, 200, 250, 300). Ex SC6A 100

Notes: 1. Overall height varies based on lumens package; refer to dimensional cut on page 2. 2. Not available with finishes. 3. Not available with emergency options. 4. Must specify voltage 120V or 277V. 5. Available with Clear (AR) reflector only. 6. 125° of lumens depth on axis required for battery pack maintenance. 7. Specify voltage if in use with generator/utility power. Will require an emergency hot lead and normal lead. 8. Fixture requires 60Hz light level. Must be specified with NPSRZE2 or NPSRZE3R. Only available with E21 and E210 drivers.

Downlighting LDN6



THIS DOCUMENT AND ITS CONTENTS ARE THE WORK PRODUCT AND PROPERTY OF 51EC, INC., WHICH RETAINS ALL COMMON LAW, STATUTORY AND OTHER RESERVED RIGHTS, INCLUDING THE COPYRIGHT.

PHOTOMETRICS  
7920 INDUSTRY ROAD  
COLORADO SPRINGS, CO 80939

REV	DESCRIPTION	DRAWN	CHECK	APPR	DATE

ISSUANCE:  
**ISSUED FOR REVIEW**

CLIENT:  
HAMMERS CONSTRUCTION  
1411 WOOLSEY HEIGHTS  
COLORADO SPRINGS, CO 80915

ARCHITECT:  
HAMMERS CONSTRUCTION  
1411 WOOLSEY HEIGHTS  
COLORADO SPRINGS, CO 80915

PROJECT NO:  
5151-22-03

TITLE:  
LIGHTING CUT SHEETS

SHEET NO:  
E-101