

LANDSCAPE MATERIAL SCHEDULE	
SMOKE/ SITE CALCULATIONS	NOTE: To be Foothills Mix. See table below. Area: 52,300 sq. ft.
ROCK MULCH	To be 4 River Rock installed to a depth of 4" in all planting beds. Submit sample for approval prior to installation. 2678 sq. ft.
STEEL EDGE	STEEL EDGE: Steel edge to be Ryerson (or approved equal) 1/2" thick x 4" wide Rolled Top Steel Edge.

SITE CATEGORY CALCULATIONS					
LANDSCAPE SETBACKS					
Street Name	Classification	Width (Req/Prov)	Linear Footage	Trees/Req.	No. Trees Req/Prov
Electronic Drive (North Side) - (Ns)	Non-Arterial	10'11"	291.00 Ft	1 per 30'	10 Req/0 Prov
				Shrub Substitutes	20 Req/20 Prov
West Side Buffer - (Ws)	Buffer between non-residential and residential use	15'10"	337.00 Ft	1 per 25'	14 Req/14 Prov
Motor Vehicle Lots					
No. Spaces Provided	Trees Req/Prov (1 per 15) Symbol (M)	Footage	Length	Footage	Provided screen
9	0 Req/0 Prov				
Screening/Plants Req/Prov					
	50% Evergreen	Symbol			
Load/In Area (Northwest side) Req/Prov					
	100%	La			
Internal Landscaping					
Net Site Area	% Min Internal Area	Internal Area Req/Prov	Internal Trees Req/Prov	Symbol	
98,079 sq. ft.	Nonresidential 5%	4902 Req/ 5,872 Prov	10 Req/10 Prov	(I)	
Release Collection Screen					
	(Screen)				
8 Req/8 Prov	6' Height Req	15' Height Prov.	100% Evergreen Trees	(S)	

LANDSCAPE SCHEDULE								
SYMBOL	CODE	QUANTITY	BOTANICAL NAME	COMMON NAME	KEY #	WIDTH	SIZE	NOTES
TREES								
	Cc	3	Celtis occidentalis	Common Hackberry	3457DA	40'-0"	2'-1/2" B&B	
	Cg	5	Crataegus crus-galli	Cockspur Hawthorn	235AD	15'-0"	1'-1/2" B&B	Thornless
	Aq	2	Acer glabrate	Amur Maple	407A	15'-0"	1'-1/2" B&B	
	Jk	12	Juniperus scopulorum 'Gray Clean'	Gray Clean Juniper	12567BD	5'-0"	10 Gal	6'-0" min Height
	Jv	4	Juniperus virginiana 'Skyrocket'	Skyrocket Juniper	2568A	3'-0"	10 gal	6'-0" min Height
	Ph	19	Pinus edulis	Pinon Pine	1256D	10'-0"	6'-0" B&B	
			Total Trees 45	Signature Trees 100%				
SHRUBS								
	Jh	16	Juniperus horizontalis 'Blue Chip'	Blue Chip Juniper	2568A		5 Gal	
	Pf	29	Potentilla fruticosa 'Gold Drop'	Gold Drop Potentilla	4567E		5 Gal	
			Total Shrubs 45	100% Signature Shrubs				

PROJECT DATA
 Legal Description: See Site Plan
 TSN: 5332002019
 Owner: D. Stefano Building and Restoration Inc.
 520 West 21st Street Unit C-2 #710
 Norfolk, VA 23517
 Site Area: 2.25 Acre
 Zoning: Industrial
 Proposed Use: Self Storage
 Lot Coverage: 41%
 Parking Spaces: 9 Spaces including 1 handicapped

LANDSCAPE NOTES

Climate Zone: Foothills-Plains
Plant Communities: Foothills Shrublands
Irrigation: An irrigation system with drip components to be used to irrigate all plants and a pop up spray system will be used to irrigate all seeded areas (temporary)
 A final landscape and irrigation plan shall be submitted and reviewed concurrent with the building permit submittal and approved prior to the issuance of a building permit.
 All shrub beds and tree wells to be covered with 4" rock mulch over fabric weed barrier unless noted.
Edging: All planting beds adjacent to native grass to be edged with steel edging.
Soil Treatment: A soils report will be submitted with Final Landscape Plan. Fertilizer to be tilled into top 6" of soil.
Seed Mix: Fresh, clean, dry, new-crop seed complying with AOSA's Journal of Seed Technology. Rules for testing seeds for purity and germination tolerance.
Maintenance: Landscape improvements and maintenance shall be the responsibility of the owner and/or their assigns.
Underground Utilities: Contractor is required to locate all utilities prior to construction.

"Foothills Mix"		
COMMON NAME	SCIENTIFIC NAME	lbs PLS/Acre
Annual Ryegrass	Lolium multiflorum Lamark	3.0
Slender Wheatgrass	Elymus trachycaulus	3.75
Mountain Brome	Bromus marginatus	2.5
Pubescent Wheatgrass	Agropyron trichophorum	2.5
Hard Fescue	Festuca brevipila	2.5
Canada Bluegrass	Poa compressa	2.0
Indian Grass	Sorghastrum nutans	2.0
Sideoats Grama	Bouteloua curtipendula	1.75
Blue Grama	Bouteloua gracilis	1.25
Saltgrass	Panicum virgatum	1.25
TOTAL PLS PER ACRE		25

Plant Communities
 3 - Prairie
 4 - Lower Elev
 Riparian
 5 - Foothills
 Shrublands

Hydrozones
 L - Low 17-15"
 M - Moderate 15-25"
 H - High +25"

SCHEMATIC LANDSCAPE DESIGN

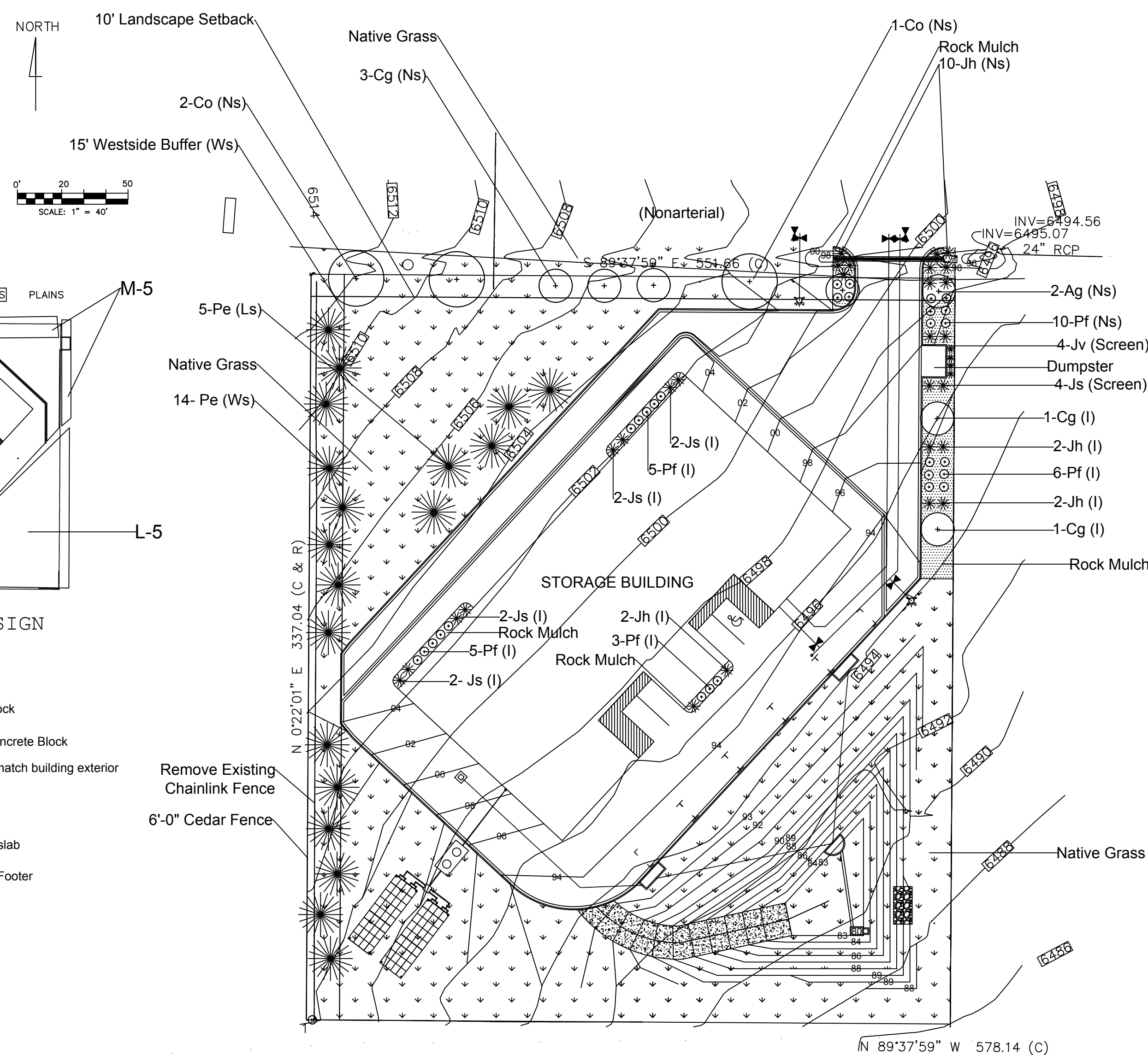
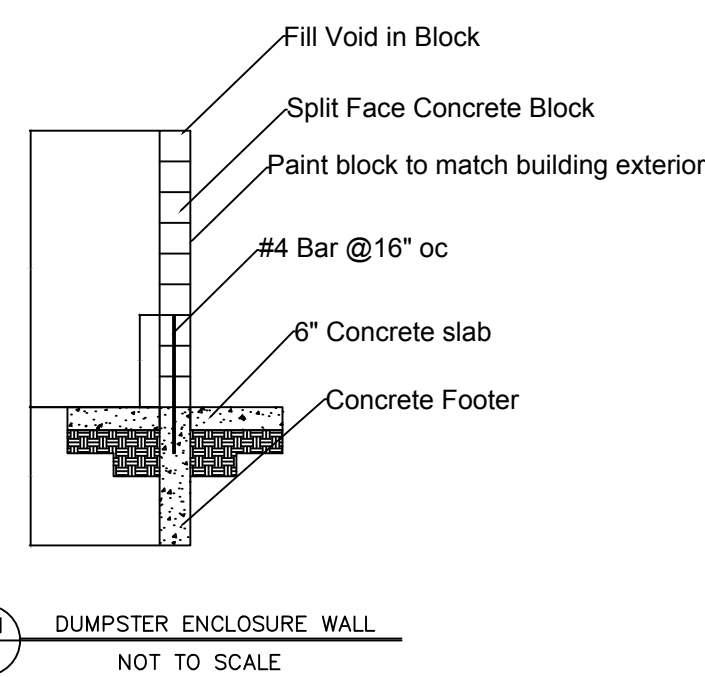

- Notes:**
1. Mark the north side of the tree in the nursery, and rotate to face north at the site
 2. At the time of planting, do not remove or cut leader or broken branches, cross over branches, and weak or narrow crotches. Some interior legs and lateral branches may be pruned, however, do not remove the terminal buds of branches that extend to the edge of the crown.
 3. Structural pruning should not begin until after establishment period, usually two growing seasons.
 4. Keep plants moist and shaded until planting
 5. Do not fertilize for at least one growing season
 6. Amended backfill shall be 1/3 compost (class 1 Biocomp by A-1 Organics or equal) and 2/3 native and/or imported topsoil
 7. Wrap trunk on exposed sites and species with thin bark. Use electrical or duct tape. Not tape
 8. Coordinate with City Forestry for current insect and disease recommendations prior to planting
 9. Deep water all plants at time of planting

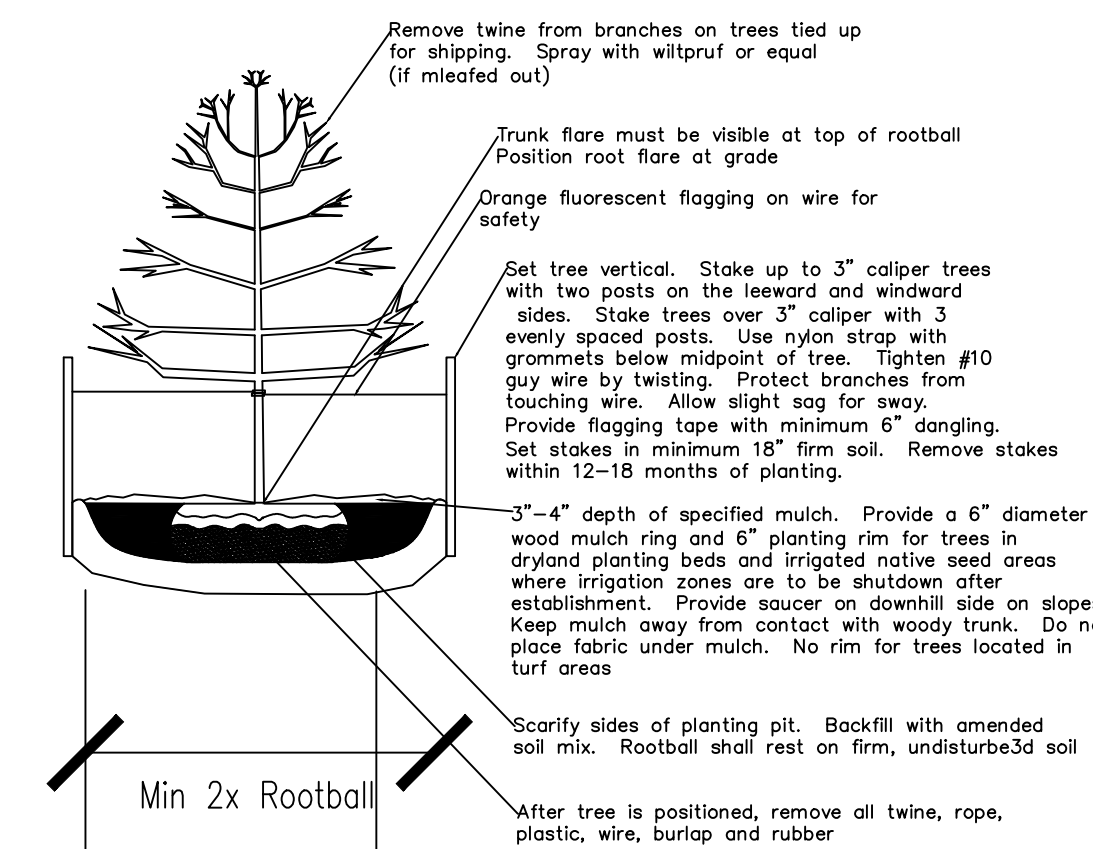

- NOTES**
1. Prune only dead or broken branches and weak or narrow crotches
 2. Keep plants moist and shaded until planting
 3. Do not fertilize for at least one growing season
 4. Amended backfill shall be 1/3 class 1 compost and 2/3 native and/or imported soil
 5. All shrubs in rock areas to receive shredded mulch rings
 6. Deep water all plants at time of planting

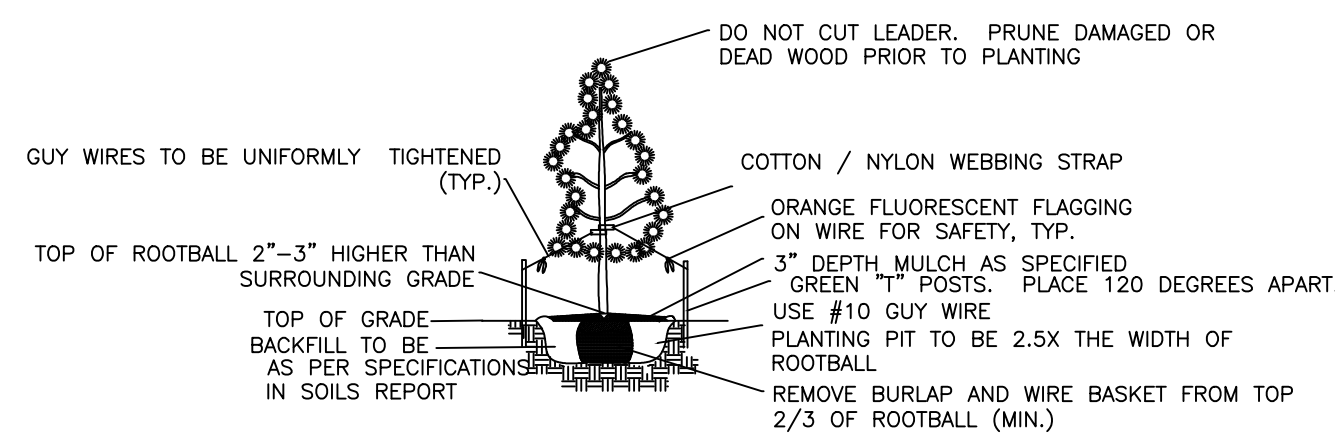
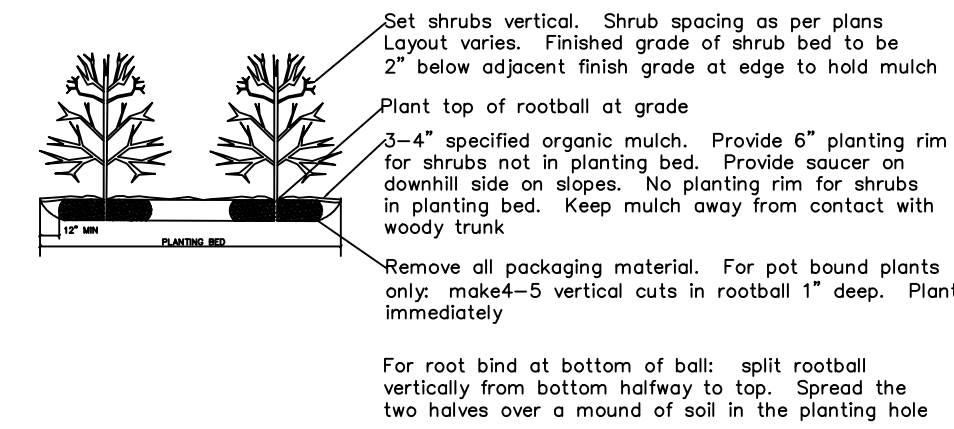

FINAL LANDSCAPE PLAN

PCD File # PPR-20-020

ELECTRONIC DRIVE SELF STORAGE
 LANDSCAPE PLAN
 7765 ELECTRONIC DRIVE
 Colorado Springs, CO 80907

1	Review 1	8/7/20
2	Revised Base	8/17/20

James W. Rees
 Landscape Architect
 520 Silver Spring Cr
 Colorado Springs, CO
 80919

STAMP BOX

Project	2005	Sheet	L-1
Date	3/16/20		of
Scale	1"=40'		