

Luminaire Schedule						
Symbol	Qty	Label	Arrangement	LLF	Description	Lum. Lumens
☐	5	673-37-WP-XX-UNV-GRM-2VTBPC	Single	1.000	673-37-WP-XX-UNV-GRM-2VTBPC	716
☐	1	VNTLEDS010724SNDIM520XXXXHO	SINGLE	0.900	VNTLEDS010724SNDIM520XXXXHO	10954
☐	4	VNTLEDS010723MNDIM520XXXXHO	SINGLE	0.900	VNTLEDS010723MNDIM520XXXXHO	10779
☐	9	VNTW-3500L-50K-DIM-4S-BZ	SINGLE	0.900	VNTW-3500L-50K-DIM-4S-BZ	3483

Calculation Summary							
Label	CalcType	Units	Avg	Max	Min	Avg/Min	Max/Min
Drive thru	Illuminance	Fc	2.20	5.3	0.5	4.40	10.60
Parking	Illuminance	Fc	2.00	4.7	0.4	5.00	11.75

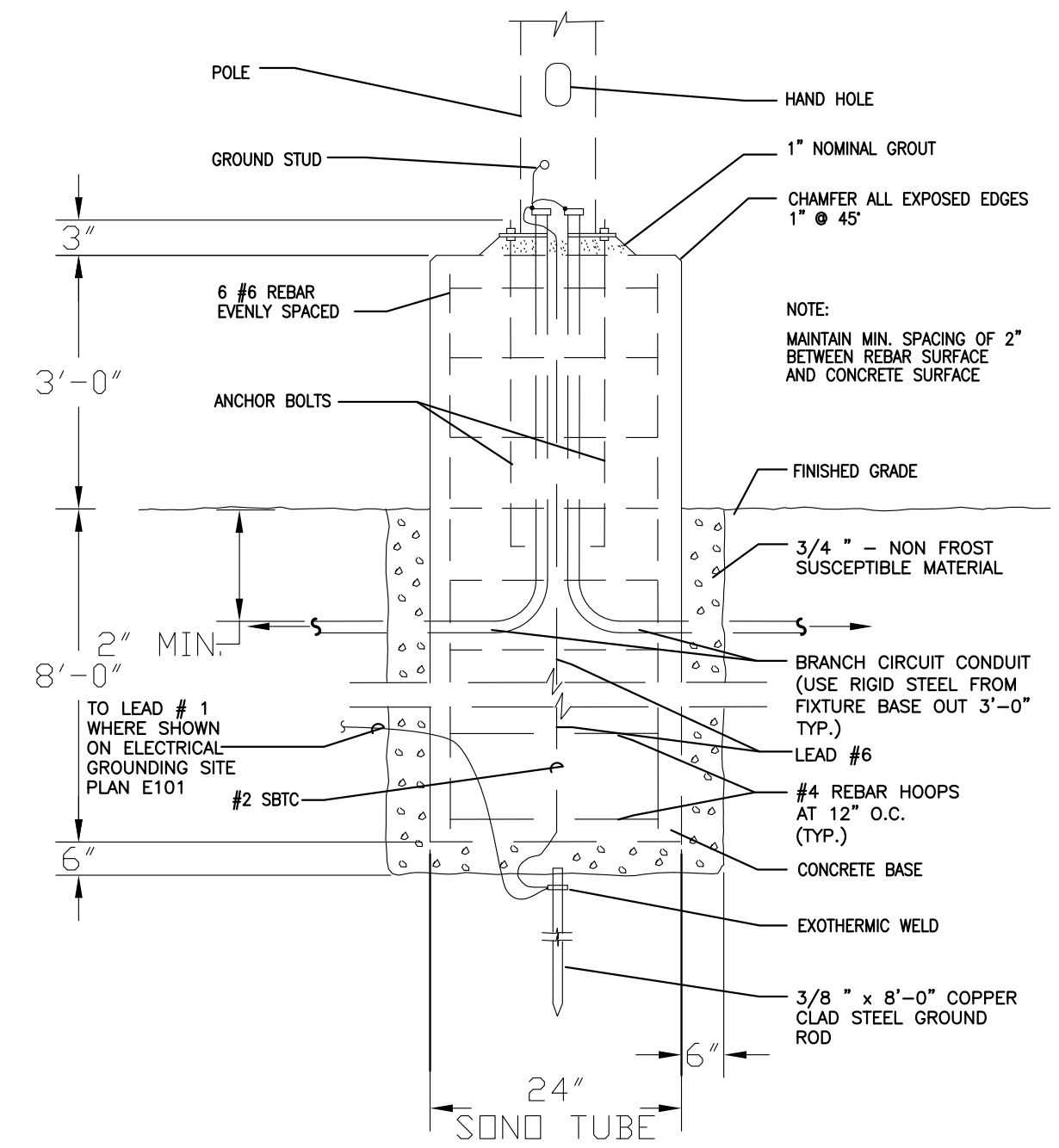

DETAIL NOTES
 1. AE MUST DETERMINE POLE BASE DEPTH.

2 TYPICAL POLE BASE DETAIL
 SCALE: E3.0

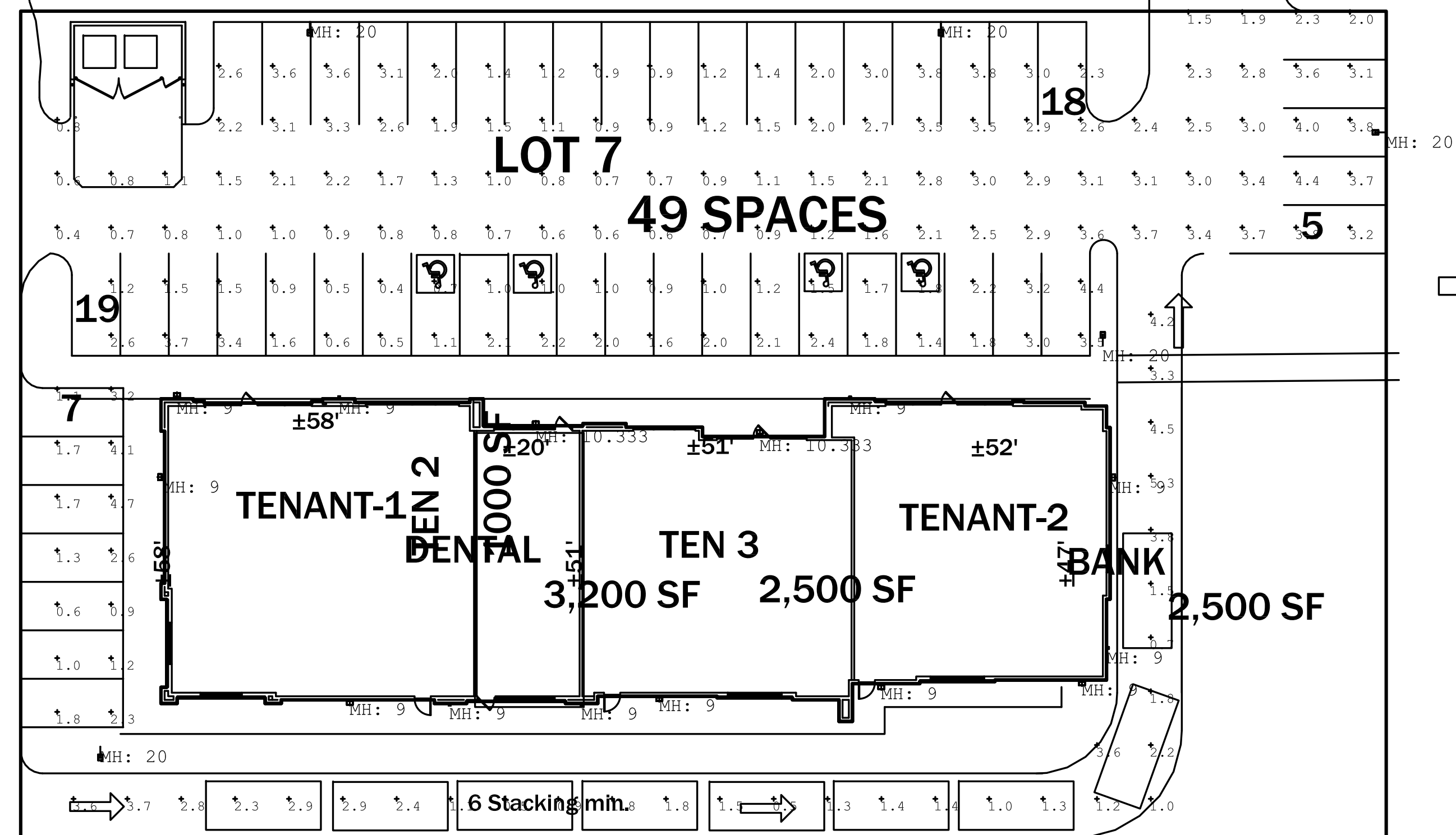

1 ELECTRICAL SITE PHOTOMETRIC PLAN
 SCALE: 1"=20'

XtraLight
LED Lighting Solutions

VIENTO AREA SITE LED SMALL LUMINAIRE
VNT LED SMALL

PROJECT INFORMATION

Project Name	Date
Catalog #	Type

APPLICATIONS

- Auto Dealership Sales Lots
- Parking Lots
- Educational/Business Campuses
- Parks & Recreation Areas
- Security Areas
- Mall & Retail Spaces
- Pedestrian Walkways

APPROVALS

- ETL listed
- Complies with UL 1598 and CSA C22.2#250.0.0.2008
- Suitable for wet locations
- 3G Vibration Rated for Bridge/Overpass Applications per ANSI C136.31-2010, Test Level 2
- IP66 Optics and Housing
- BAA Compliant
- RoHS Compliant
- Appropriate parts/test guidelines were performed by ATAL www.atal-labs.com
- Select models DLC Qualified For a complete list of DLC Qualified products, please visit www.xtralight.com/dlc or www.designlights.org/qpl

FEATURES

- Outstanding photometric performance results in sites with excellent uniformity, optimal pole spacing and lower power density.
- Optics are completely sealed against moisture and environmental contaminants (IP66).
- Low profile architectural design offers a contemporary appearance with excellent light output and is night sky friendly.
- Controls ready luminaire for independent operation or remote management.
- Zero uplight (UO) is night sky friendly, reduces wasted light.
- Operating temperature: -40°C to +50°C (-40°F to +122°F)
- Custom colors available

CONSTRUCTION

- Housing: One-piece die-cast aluminum has integral heat sink fins to optimize thermal management through conductive and convective cooling.
- The LED driver is mounted in direct contact with the casting to promote low operating temperature and long life.
- Housing and door are protected with a thermoset TGIC-polyester powder coat finish using a tightly controlled multi-stage process to a uniform 3 mil thickness (min). This finish provides superior protection from corrosion and maximum environmental durability.
- Powder coat finish in bronze, white or custom colors (consult factory).

MOUNTING

- Integral arm with key hole slot facilitates quick and easy installation.

WARRANTY

- Backed by XtraLight's industry leading 10-year warranty.

FEATURES

- Nut plate eliminates loose hardware in the pole and reduces installation labor.
- Precision molded optics for superior uniformity, minimal light trespass and maximum pole spacing.
- Optical grade polymer is UV stabilized and impact resistant.
- IP66 rated LED light engines prevent dust and moisture from degrading performance.
- Distributions: Type II, Type III, Type IV and Type V. Types II, III, and IV available rotated right or left 90°, factory installed.
- Best in class LEDs with 3000K, 4000K and 5000K CCT (min 70 CRI).
- Lumen Maintenance: >100,000hrs L70 @ 25°C.

ELECTRICAL

- Voltage: 120-277V 50/60Hz driver (standard); 347-480V 50/60Hz driver (optional).
- Class 2 electronic drivers are designed to have a power factor >90%, THD <20%, and an expected life of 100,000 hours with <1% failure rate.
- Housing and door are protected with a thermoset TGIC-polyester powder coat finish using a tightly controlled multi-stage process to a uniform 3 mil thickness (min). This finish provides superior protection from corrosion and maximum environmental durability.
- Surge Protection: 20KA standard.
- NEMA twist-lock receptacle available as an option. NOTE: Photocontrol or shorting cap required for operation (not included).
- Dimming: 0-10v dimmable driver standard.
- Passive Infrared (PIR) Photo/Motion Sensor option available.

WARRANTY

- Backed by XtraLight's industry leading 10-year warranty.

10 YEAR WARRANTY

ATL **DLC** **IP66 RATED** **3G** **ATAL** **RoHS** **PROUDLY ENGINEERED & MANUFACTURED IN HOUSTON, TX** **BAA**

VNT LED SMALL www.XLM.com • (800) 678-6960 • customerservice@XLM.com
 All information is believed to be accurate at the time of publication. Please contact customer service or visit www.XLM.com for the most updated product specifications. XtraLight® reserves the right to change specifications without notice.

COVENANT
REAL
ESTATE
GROUP

2460 PASEO VERDE PKWY #145 HENDERSON, NV 89074 | 714.845.8500

Conceptual Site Plan Falcon Marketplace- Lot 7

NWC E. Woodmen Road & Meridian Road
Falcon, CO 80831



E3.0 PHOTOMETRIC PLAN

June 25, 2021 SCALE: 1"= 20'-0"
 LOCATION- BOX / 2021/ COVENANT/ FALCON/ CITY/ PLANNING SUB/ DESIGN SITE
 The plans, ideas, arrangements and designs indicated or represented by this drawing are owned by, and are the property of COVENANT GROUP, and were created and developed solely for use on, and in connection with this specific project, and shall not be used, in whole or in part, for any purpose for which they were not originally intended without written permission from COVENANT GROUP@2021.