

POLE

HAND HOLE

1" NOMINAL GROUT

CHAMFER ALL EXPOSED EDGES
1" ϕ 45°

NOTE:
MAINTAIN MIN. SPACING OF 2"
BETWEEN REBAR SURFACE
AND CONCRETE SURFACE

6 #6 REBAR
EVENLY SPACED

ANCHOR BOLTS

FINISHED GRADE

3/4" - NON FROST
SUSCEPTIBLE MATERIAL

BRANCH CIRCUIT CONDUIT
(USE RIGID STEEL FROM
FITTING BASE OUT 3'-0"
TYP.)

LEAD #6

#4 REBAR HOOPS
AT 12" O.C.
(TYP.)

CONCRETE BASE

EXOTHERMIC WELD

3/8" x 8'-0" COPPER
CLAD STEEL GROUND
ROD

24"

SOUND TUBE

3'-0"

8'-0" MIN.

TO LEAD #1
WHERE SHOWN
ON ELECTRICAL
GROUNDING SITE
PLAN E101

#2 SBCT

6"

DETAIL NOTES

1. AE MUST DETERMINE POLE BASE DETPH.

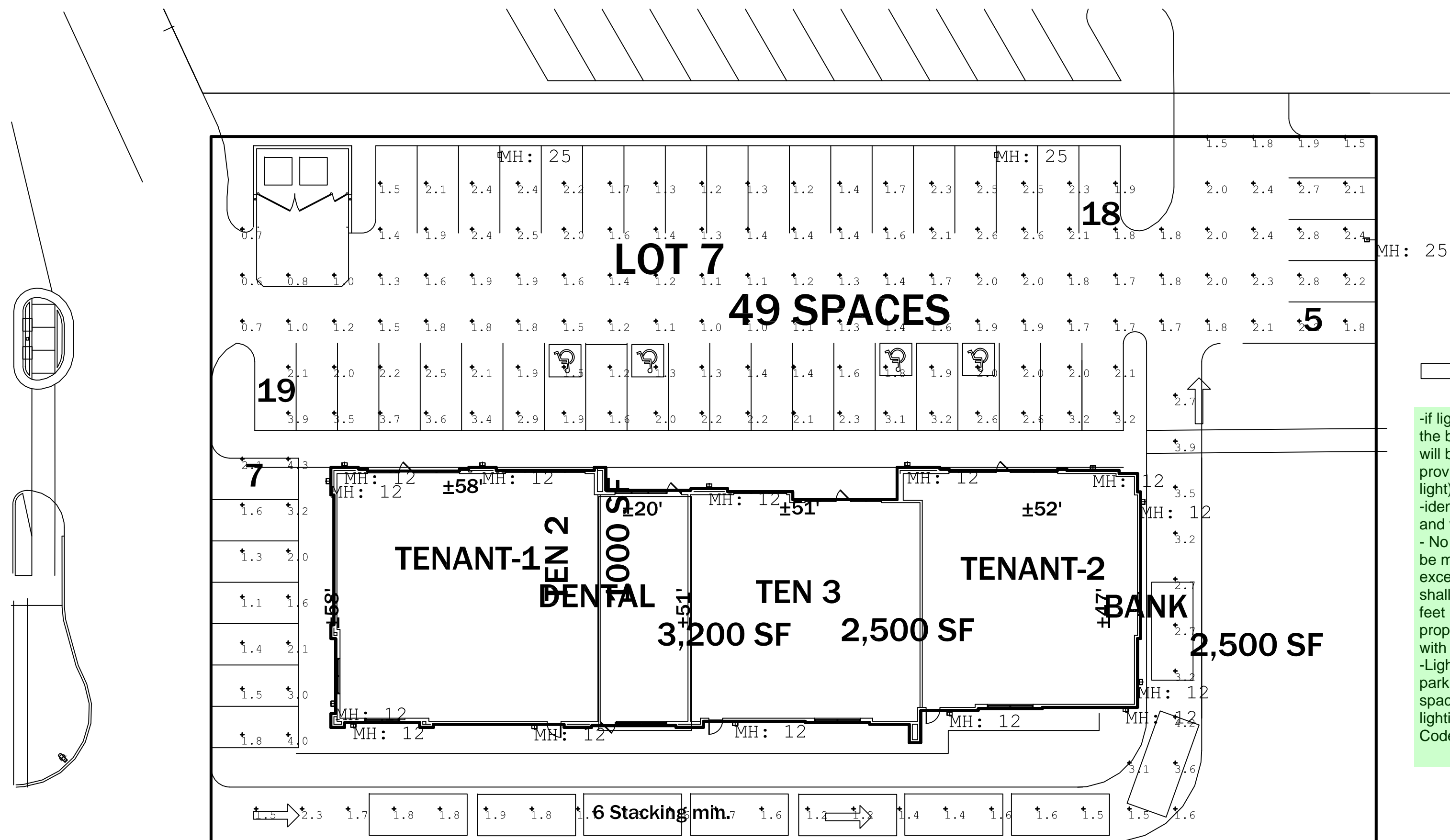



PROJECT INFORMATION

Project Name		Date	
Catalog #		Type	

VIENTO AREA SITE LED SMALL LUMINAIRE



Viento

area site

FEATURES

- Outstanding photometric performance results in areas with excellent uniformity, optimal pole spacing and lower power density.
- Optics are completely sealed against moisture and environmental contaminants (IP66).
- Low profile architectural design offers a contemporary appearance with excellent light output and is night sky friendly.
- Controls readily luminare for independent operation or remote management.
- Zero uplight (0°) is night sky friendly, reduces wasted light.
- Operating temperature: -40°C to +50°C (-40°F to +122°F)
- Custom colors available

CONSTRUCTION

- Housing: One piece die-cast aluminum has integral heat sink fins to optimize thermal management through convection and conductive cooling.
- The LED driver is mounted in direct contact with the casting to promote low operating temperature and long life.
- Housing and door are protected with a thermoset TGC polymeric powder coat finish using a tightly controlled multi-stage process to a uniform 3 mil thickness (min). This finish provides superior protection from corrosion and maximum environmental durability.
- Powder coat finish in bronze, white or custom colors (consult factory).

MOUNTING

- Integral arm with key hole slot facilitates quick and easy installation.

APPLICATIONS

- Auto Dealership Sales Lots
- Parking Lots
- Educational/Business Campuses
- Parks & Recreation Areas
- Security Areas
- Mall & Retail Spaces
- Pedestrian Walkways

APPROVALS

- ETL listed.
- Complies with UL 1598 and CSA C22.2#250.0-0.2008
- Suitable for wet locations.
- 3G Vibration Rated for Bridge/Overpass Applications per ANSI C136.31-2010, Test Level 2.
- IP66 Optics and Housing.
- BAA Compliant
- RoHS Compliant.
- Appropriate parts/Test guidelines were performed by ATAL www.atalabs.com
- Select models DLC Qualified. For a complete list of DLC Qualified products, visit: www.xtralight.com/dlc or www.dcsignlights.org/gsl/

FEATURES

- Nut plate eliminates loose hardware in the pole and reduces installation labor.

OPTICS

- Precision molded optics for superior uniformity, minimal light trespass and maximum pole spacing.
- Optical grade polymer is UV stabilized and impact resistant.
- IP66 rated LED light engines prevent dust and moisture from degrading performance.
- Distributions: Type II, Type III, Type IV and Type V, Types II, III, and IV available rated below or right or 90°, factory installed.
- Best in class LEDs with: 3000K, 4000K and 5000K CRI (min 70 CRI).
- Lumen Maintenance: >100,000hrs L70 @ 25°C.

ELECTRICAL

- Voltage: 120-277V 50/60Hz driver (standard); 347-480V 50/60Hz driver (optional).
- Class 2 electronic drivers are designed to have a power factor >90%, THD <20%, and an expected life of 100,000 hours with <1% L70 rate.
- Surge Protection: ZKSA Standalone.
- NEMA twist-lock receptacle available as an option. NOTE: Photocoupler or shorting cap required for operation (not included).
- Dimming: 0-10v dimmable driver standard
- Passive Infrared (PIR) Photo/Motion Sensor option available.

WARRANTY

- Backed by XtraLight's industry leading 10-year warranty.

















VNT LED SMALL
201413

All information is believed to be accurate at the time of publication. Please contact customer service or visit www.xlml.com for the most updated product specifications. XtraLight reserves the right to change specifications without notice.

www.xlml.com (800) 678-6560 • customerservice@xlml.com

PROUDLY ENGINEERED & MANUFACTURED IN HOUSTON, TX

The logo for Covenant Real Estate Group features three stylized vertical bars of varying heights and widths, arranged in a staggered fashion. To the left of these bars, the words "COVENANT", "REAL", "ESTATE", and "GROUP" are stacked vertically in a clean, sans-serif font.

June 25, 2021 SCALE: 1"= 20'-0"

LOCATION- BOX / 2021/ COVENANT/ FALCON/ CITY / PLANNING SUB/ DESIGN SITE

The plans, ideas, arrangements and designs indicated or represented by this drawing are owned by, and are the property of COVENANT GROUP, and were created and developed solely for use on, and in connection with this specific project, and shall not be used, in whole or in part, for any purpose for which they were not originally intended without written permission from COVENANT GROUP©2021.