**CITY OF FOUNTAIN ELECTRIC DEPARTMENT
REVIEW COMMENTS**

TO: KRISTY MARTINEZ
FROM: TRACY TILLMAN DISTRIBUTION SYSTEM DESIGNER
SUBJECT: A REQUEST FROM EL PASO COUNTY TO REVIEW THE COTTAGES AT MESA RIDGE FINAL PLAT (AKA MESA RIDGE SUBDIVISION FILING NO. 10).
DATE: 3-22-22
CC: DAN BLANKENSHIP; CARL CHRISTIAN; CODY CLARK; RANDAL BURROWS; GILBERT JAIME; GABY SERRANO; MELANIE ESTRADA

Please be advised this document is to serve as the City Of Fountain Electric Department Review Comments for the Final Plat at Cottages at Mesa Ridge project, generally located west of the Powers Boulevard and Mesa Ridge Parkway intersection.

Upon reviewing the materials submitted for this project the City of Fountain Electric Department has determined we will be pleased to serve this project as it falls within our electric service territory.

Please note that the developer will be required to provide all on site and off site easements to serve this development, to include easements that will provide a redundant loop feed to ensure reliable service for the entire project. The developer will also be responsible for and costs associated with all on site and off-site improvements including line extensions and street lighting, etc.

Response: Plat updated with easments based on preliminary electrical design provided by COF Electrical Dept. (attached)

A CAD copy of the Final Plat will be required to assist in planning the additional power load for this new project.

Response: CAD provided to COF Electrical Dept.

For any further questions or concerns please contact Tracy Tillman at 322-2061.

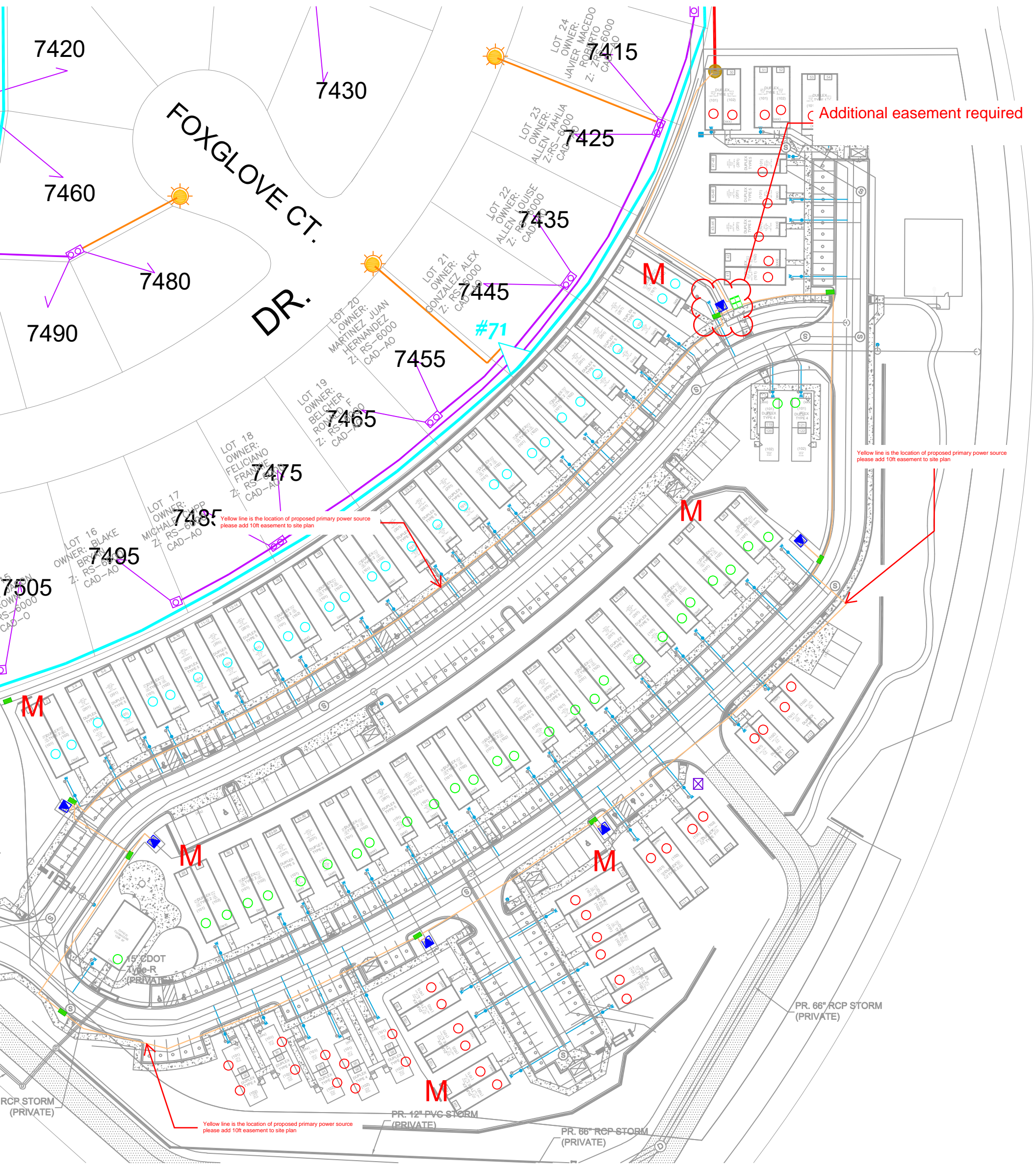

Additional easement required

Yellow line is the location of proposed primary power source please add 10ft easement to site plan

Yellow line is the location of proposed primary power source please add 10ft easement to site plan

Yellow line is the location of proposed primary power source please add 10ft easement to site plan

PR. 66" RCP STORM (PRIVATE)

PR. 12" PVC STORM (PRIVATE)

PR. 66" RCP STORM (PRIVATE)

RCP STORM (PRIVATE)

15" CDOT Type-R (PRIVATE)