

- BMP NOTES:**
- EXISTING VEGETATION CONSISTS OF NATIVE GRASSES AND SCATTERED SHRUBS.
 - EXISTING SANITARY SEWER MAINLINE IS LOCATED WITHIN THE LIMITS OF ON-SITE GRADING.
 - CONCRETE WASHOUT LOCATION PER FILING TO BE DETERMINED BY DEVELOPER/CONTRACTOR.
 - DIVERSION SWALES AND EARTH Dikes TO BE INSTALLED BY DEVELOPER / CONTRACTOR IN LOCATIONS THAT WON'T CONFLICT WITH SEWER, WATER AND STORM SEWER MAINLINE INSTALLATIONS.
 - IF DISTURBANCE TO ROADWAY BMP'S OCCUR DURING UTILITY CONSTRUCTION, THE CONTRACTOR WILL IMMEDIATELY REPAIR / REPLACE BMP'S.

NOTES:

AT LEAST TEN DAYS PRIOR TO THE ANTICIPATED START OF CONSTRUCTION, FOR PROJECTS THAT WILL DISTURB 1 ACRE OR MORE, THE OWNER OR OPERATOR OF THE CONSTRUCTION ACTIVITY SHALL SUBMIT A PERMIT APPLICATION FOR STORMWATER DISCHARGE TO THE COLORADO DEPARTMENT OF PUBLIC HEALTH AND ENVIRONMENT, WATER QUALITY DIVISION. THE APPLICATION CONTAINS CERTIFICATION OF COMPLETION OF A STORMWATER MANAGEMENT PLAN (SWMP), OF WHICH THIS GRADING AND EROSION CONTROL PLAN MAY BE A PART. FOR INFORMATION OR APPLICATION MATERIALS CONTACT:

COLORADO DEPARTMENT OF PUBLIC HEALTH AND ENVIRONMENT
 WATER QUALITY CONTROL DIVISION
 WQCD - PERMITS
 4300 CHERRY CREEK DRIVE SOUTH
 DENVER, CO 80246-1530
 ATTN: PERMITS UNIT

NO PORTION OF THIS SITE IS LOCATED WITHIN A FLOODPLAIN AS DETERMINED BY THE FLOOD INSURANCE RATE MAPS (F.I.R.M.) MAP NUMBER 08041C0752F AND EFFECTIVE DATE, MARCH 17, 1997.

THE AVERAGE SOIL CONDITION REFLECTS PRING COURSE SANDY LOAM AS DETERMINED BY THE "SOIL SURVEY OF EL PASO COUNTY AREA" PREPARED BY THE U.S. SOIL CONSERVATION SERVICE.

EXISTING VEGETATION CONSISTS OF TALL NATIVE GRASSES AND WEEDS WITH SPORADIC CACTI AND YUCCAS THROUGH-OUT THE SITE.

EMERGENCY OVERFLOW SWALES FOR INLETS IN THE INTERIM UNTIL CURB AND ASPHALT IS INSTALLED WILL BE THE LOTS, FINAL WILL BE TO OVERTOP THE HIGH POINT IN ROADWAY TO THE NEXT AVAILABLE INLET OR TO PROPOSED POND.

STOCKPILE LOCATIONS FOR HOMEBUILDING TO BE ON EACH INDIVIDUAL LOT THAT IS BEING BUILT UPON.

LIMITS OF DISTURBANCE FOR THIS PLAN INCLUDE UTILITY INSTALLATION AND ROADWAY CONSTRUCTION WITHIN THE R.O.W., AND OVERLOT GRADING FOR DEVELOPMENT THEN INDIVIDUAL LOTS FOR HOMEBUILDING ONCE CONSTRUCTION OF THE HOME BEGINS.

GRADING WITHIN THIS PHASE WILL BE FULLY DEVELOPED WITH HOME BUILDING OPERATIONS.

LOCATION OF STORAGE FOR MAINTENANCE EQUIPMENT AND TEMPORARY DISPOSAL AREAS WILL BE ADDED TO THIS PLAN BY SWMP ADMINISTRATOR UPON COORDINATION WITH SELECTED CONTRACTOR.

ALL AREAS ARE TO BE RESEEDED OUTSIDE OF THE FILING NO. 5, 6 AND 7 AREA. RESEED ALL AREAS AS NEEDED TO PREVENT EROSION AND SEDIMENT RUNOFF ONTO CONSTRUCTION ACTIVITIES.

ALL RETAINING WALLS TO BE STACKED BLOCK WALLS. BUILDING PERMIT REQUIRED FOR WALLS 4' OR TALLER.

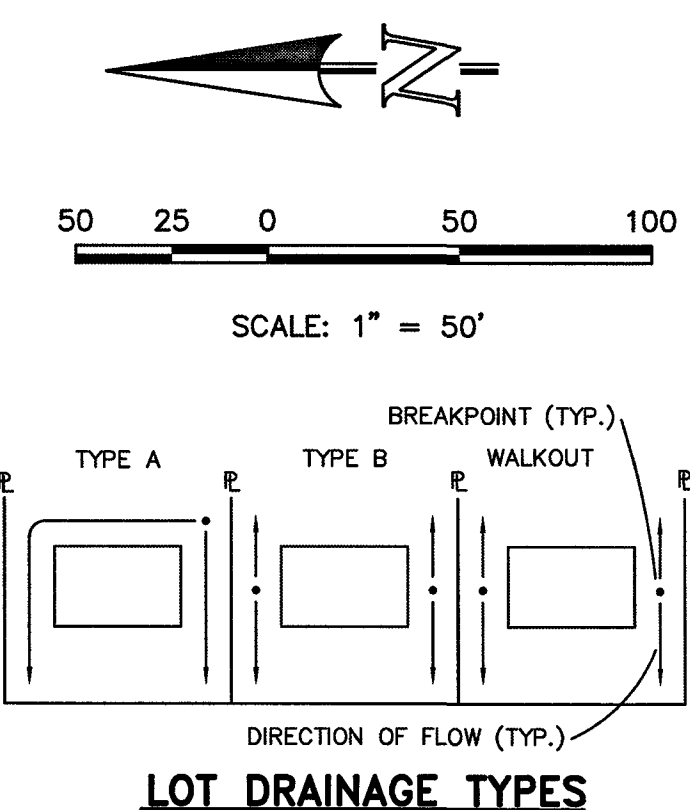

NOTE:
SIDE LOT LINE SWALES ARE REQUIRED FOR ALL LOTS.

THE PROPOSED CHANNEL IMPROVEMENTS AND CONCRETE BOX CULVERT WILL BE INSTALLED WITHIN THE FILING NO. 5 CDS. THE PROPOSED STORMWATER QUALITY FACILITY WILL BE INSTALLED WITHIN THE FILING NO. 7 CDS. THE FILING NO. 6 CDS DO NOT INCLUDE STORM SEWER IMPROVEMENTS. FILING NO. 5, 6 AND 7 WILL BE OVERLOT GRADED CONCURRENTLY. FILING NO. 7 WILL BE CONSTRUCTED INITIALLY IN 3 SEPARATE PHASES (SWQ FACILITY INSTALLED WITHIN PHASE 1). FILING NO. 6 WILL BE CONSTRUCTED FOLLOWING PHASE 3, FILING NO. 7, FILING NO. 5 WILL BE CONSTRUCTED FOLLOWING FILING NO. 6. THE FILING NO. 7 STORMWATER QUALITY FACILITY WILL BE UTILIZED AS A SEDIMENT TRAP INITIALLY. ONCE THE SITE IS STABILIZED AND HOME BUILDING BEGINS THE STORMWATER QUALITY FACILITY WILL BE FINALIZED.

LOCATION OF STAGING AREAS, STORAGE FOR MAINTENANCE EQUIPMENT, CONCRETE WASHOUT AREAS AND TEMPORARY DISPOSAL AREAS WILL BE ADDED TO THIS PLAN BY SWMP ADMINISTRATOR UPON COORDINATION WITH SELECTED CONTRACTOR AND SHALL BE WITHIN CONSTRUCTION SITE BOUNDARIES AS SHOWN.

LEGEND

- (6770) --- EXISTING CONTOUR
- 6770 --- PROPOSED CONTOUR
- FILING LINE
- BOUNDARY/R.O.W. LINE
- EXISTING FLOW DIRECTION
- PROPOSED FLOW
- "A" A LOT
- "B" B LOT
- "W/O" WALKOUT LOT
- "T" TRANSITION LOT
- "G" GARDEN LOT
- PROPOSED INLET
- PROPOSED STORM SEWER PIPE
- HP PROPOSED HIGH POINT
- LP PROPOSED LOW POINT
- PROPOSED RETAINING WALL
- (TSB) TEMPORARY SEDIMENT BASIN
- (SF) SILT FENCE
- (IP) INLET PROTECTION
- (VTC) VEHICLE TRACKING CONTROL

NOTE:
SEE SHEET 5 FOR LOT TEMPLATES
SEE SHEET 5 FOR EROSION CONTROL DETAILS
SF-18-038, 039, 040

48 HOURS BEFORE YOU DIG, CALL UTILITY LOCATORS 811 UTILITY NOTIFICATION CENTER OF COLORADO IT'S THE LAW	NO. REVISION	DATE
THE LOCATIONS OF EXISTING UNDERGROUND UTILITIES ARE SHOWN IN AN APPROXIMATE WAY ONLY. THE CONTRACTOR SHALL DETERMINE THE EXACT LOCATION OF ALL EXISTING UTILITIES BEFORE COMMENCING WORK. THE CONTRACTOR SHALL BE FULLY RESPONSIBLE FOR ANY AND ALL DAMAGES WHICH MIGHT BE CAUSED BY HIS FAILURE TO EXACTLY LOCATE AND PRESERVE ANY AND ALL UNDERGROUND UTILITIES.		

REVIEW:

PREPARED UNDER MY DIRECT SUPERVISION FOR AND ON BEHALF OF CLASSIC CONSULTING ENGINEERS AND SURVEYORS, LLC

[Signature]
KYLE R. CAMPBELL, COLORADO P.E. 29794

DATE: 10/12/18

CLASSIC CONSULTING ENGINEERS & SURVEYORS

619 N. Cascade Avenue, Suite 200
Colorado Springs, Colorado 80903

(719) 785-0790
(719) 785-0799 (fax)

HANNAH RIDGE AT FEATHERGRASS
FILING NO. 5, 6 & 7
OVERLOT GRADING AND EROSION CONTROL PLAN

DESIGNED BY	KRC	SCALE	DATE	10/12/18
DRAWN BY	KC	(H) 1" = 50'	SHEET	2 OF 7
CHECKED BY	(V) 1" = NA	JOB NO.	1116.06	

N:\111605\DRAWINGS\CONSTRUCTION\FILING 5\02-111605-04G-01.dwg, 6/7/2019 1:37:27 PM, 11

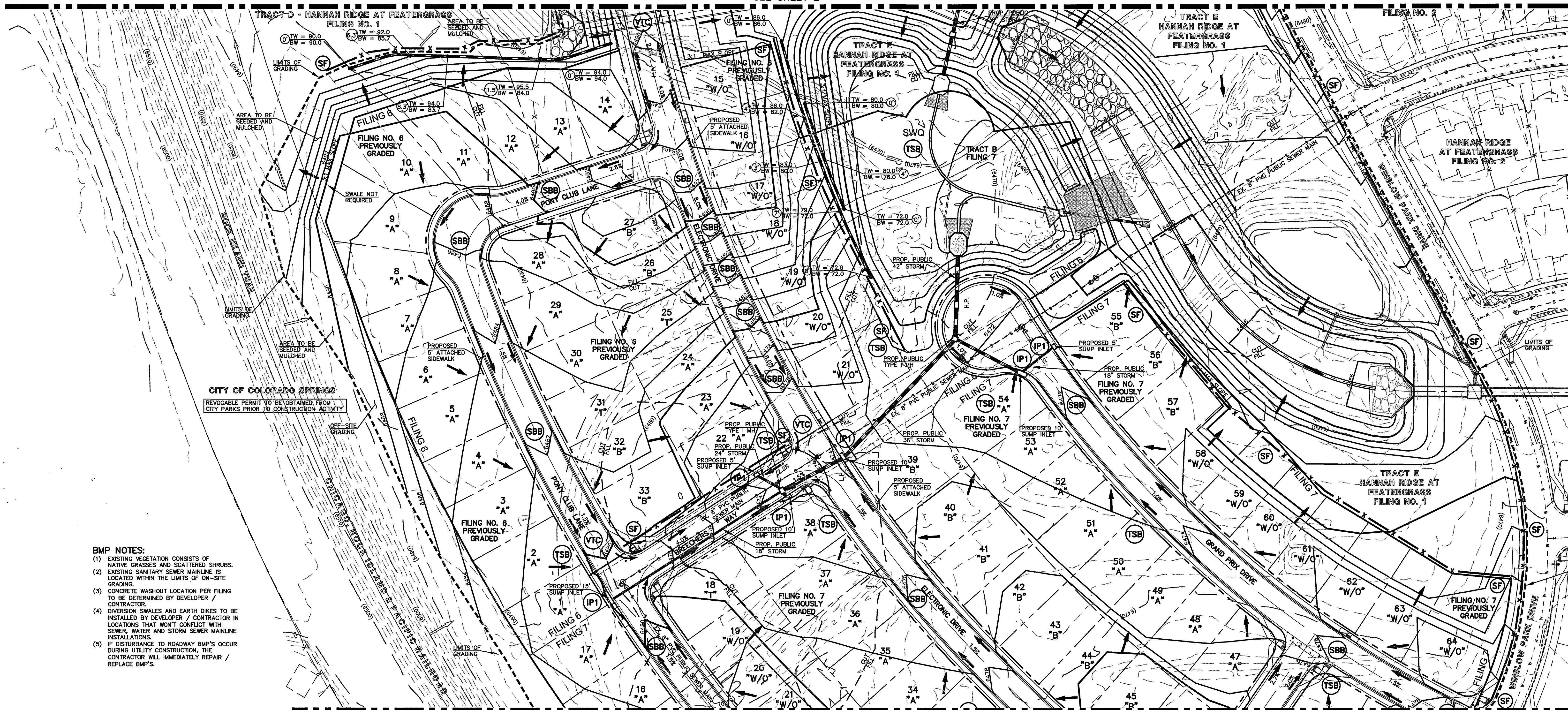

- BMP NOTES:**
- (1) EXISTING VEGETATION CONSISTS OF NATIVE GRASSES AND SCATTERED SHRUBS. EXISTING SANITARY SEWER MAINLINE IS LOCATED WITHIN THE LIMITS OF ON-SITE GRADING.
 - (2) CONCRETE WASHOUT LOCATION PER FILING TO BE DETERMINED BY DEVELOPER / CONTRACTOR.
 - (3) DIVERSION SWALES AND EARTH DIKES TO BE INSTALLED BY DEVELOPER / CONTRACTOR IN LOCATIONS THAT WON'T CONFLICT WITH SEWER, WATER AND STORM SEWER MAINLINE INSTALLATIONS.
 - (4) IF DISTURBANCE TO ROADWAY BMP'S OCCUR DURING UTILITY CONSTRUCTION, THE CONTRACTOR WILL IMMEDIATELY REPAIR / REPLACE BMP'S.

NOTES:

AT LEAST TEN DAYS PRIOR TO THE ANTICIPATED START OF CONSTRUCTION, FOR PROJECTS THAT WILL DISTURB 1 ACRE OR MORE, THE OWNER OR OPERATOR OF THE CONSTRUCTION ACTIVITY SHALL SUBMIT A PERMIT APPLICATION FOR STORMWATER DISCHARGE TO THE COLORADO DEPARTMENT OF PUBLIC HEALTH AND ENVIRONMENT, WATER QUALITY DIVISION. THE APPLICATION CONTAINS CERTIFICATION OF COMPLETION OF A STORMWATER MANAGEMENT PLAN (SWMP), OF WHICH THIS GRADING AND EROSION CONTROL PLAN MAY BE A PART. FOR INFORMATION OR APPLICATION MATERIALS CONTACT:

COLORADO DEPARTMENT OF PUBLIC HEALTH AND ENVIRONMENT
 WATER QUALITY CONTROL DIVISION
 WQCD - PERMITS
 4300 CHERRY CREEK DRIVE SOUTH
 DENVER, CO 80246-1530
 ATTN: PERMITS UNIT

NO PORTION OF THIS SITE IS LOCATED WITHIN A FLOODPLAIN AS DETERMINED BY THE FLOOD INSURANCE RATE MAPS (F.I.R.M.) MAP NUMBER 08041C0752F AND EFFECTIVE DATE, MARCH 17, 1997.

THE AVERAGE SOIL CONDITION REFLECTS PRING COURSE SANDY LOAM AS DETERMINED BY THE "SOIL SURVEY OF EL PASO COUNTY AREA" PREPARED BY THE U.S. SOIL CONSERVATION SERVICE.

EXISTING VEGETATION CONSISTS OF TALL NATIVE GRASSES AND WEEDS WITH SPORADIC CACTI AND YUCCAS THROUGH-OUT THE SITE.

EMERGENCY OVERFLOW SWALES FOR INLETS IN THE INTERIM UNTIL CURB AND ASPHALT IS INSTALLED WILL BE THE LOTS, FINAL WILL BE TO OVERTOP THE HIGH POINT IN ROADWAY TO THE NEXT AVAILABLE INLET OR TO PROPOSED POND.

STOCKPILE LOCATIONS FOR HOMEBUILDING TO BE ON EACH INDIVIDUAL LOT THAT IS BEING BUILT UPON.

LIMITS OF DISTURBANCE FOR THIS PLAN INCLUDE UTILITY INSTALLATION AND ROADWAY CONSTRUCTION WITHIN THE R.O.W., AND OVERLOT GRADING FOR DEVELOPMENT THEN INDIVIDUAL LOTS FOR HOMEBUILDING ONCE CONSTRUCTION OF THE HOME BEGINS.

GRADING WITHIN THIS PHASE WILL BE FULLY DEVELOPED WITH HOME BUILDING OPERATIONS.

LOCATION OF STORAGE FOR MAINTENANCE EQUIPMENT AND TEMPORARY DISPOSAL AREAS WILL BE ADDED TO THIS PLAN BY SWMP ADMINISTRATOR UPON COORDINATION WITH SELECTED CONTRACTOR.

ALL AREAS ARE TO BE RESEEDD OUTSIDE OF THE FILING NO. 5, 6 AND 7 AREA. RESEED ALL AREAS AS NEEDED TO PREVENT EROSION AND SEDIMENT RUNOFF ONTO CONSTRUCTION ACTIVITIES.

ALL RETAINING WALLS TO BE STACKED BLOCK WALLS. BUILDING PERMIT REQUIRED FOR WALLS 4' OR TALLER.

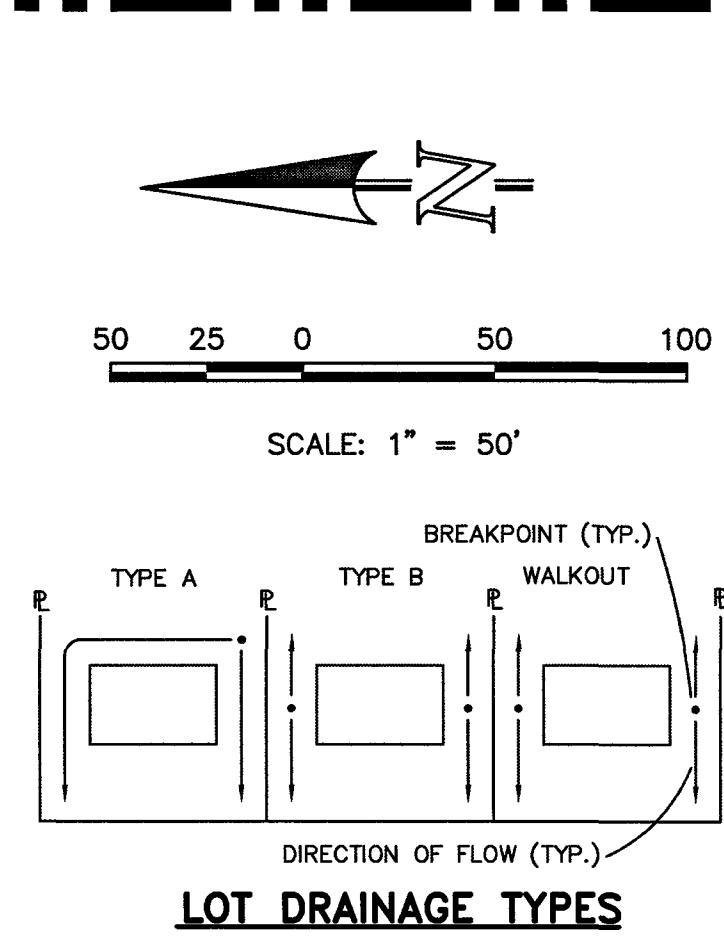

NOTE:
 SIDE LOT LINE SWALES ARE REQUIRED FOR ALL LOTS.

THE PROPOSED CHANNEL IMPROVEMENTS AND CONCRETE BOX CULVERT WILL BE INSTALLED WITHIN THE FILING NO. 5 CDS. THE PROPOSED STORMWATER QUALITY FACILITY WILL BE INSTALLED WITHIN THE FILING NO. 7 CDS. THE FILING NO. 6 CDS DO NOT INCLUDE STORM SEWER IMPROVEMENTS. FILING NO. 5, 6 AND 7 WILL BE OVERLOT GRADED CONCURRENTLY. FILING NO. 7 WILL BE CONSTRUCTED INITIALLY IN 3 SEPARATE PHASES (SWQ FACILITY INSTALLED WITHIN PHASE 1). FILING NO. 6 WILL BE CONSTRUCTED FOLLOWING PHASE 3, FILING NO. 7, FILING NO. 5 WILL BE CONSTRUCTED FOLLOWING FILING NO. 6. THE FILING NO. 7 STORMWATER QUALITY FACILITY WILL BE UTILIZED AS A SEDIMENT TRAP INITIALLY. ONCE THE SITE IS STABILIZED AND HOME BUILDING BEGINS THE STORMWATER QUALITY FACILITY WILL BE FINALIZED.

LOCATION OF STAGING AREAS, STORAGE FOR MAINTENANCE EQUIPMENT, CONCRETE WASHOUT AREAS AND TEMPORARY DISPOSAL AREAS WILL BE ADDED TO THIS PLAN BY SWMP ADMINISTRATOR UPON COORDINATION WITH SELECTED CONTRACTOR AND SHALL BE WITHIN CONSTRUCTION SITE BOUNDARIES AS SHOWN.

LEGEND

- (6770) EXISTING CONTOUR
- 6770 PROPOSED CONTOUR
- FILING LINE
- - - BOUNDARY/R.O.W. LINE
- EXISTING FLOW DIRECTION
- PROPOSED FLOW
- "A" A LOT
- "B" B LOT
- "W/O" WALKOUT LOT
- "T" TRANSITION LOT
- "G" GARDEN LOT
- PROPOSED INLET
- HP PROPOSED HIGH POINT
- LP PROPOSED LOW POINT
- TW = XX.XX
BW = XX.XX (X) PROPOSED RETAINING WALL
- (TSB) TEMPORARY SEDIMENT BASIN
- (SF) SILT FENCE
- (IP) INLET PROTECTION
- (VTC) VEHICLE TRACKING CONTROL
- (SBB) STRAW BALE BARRIER

NOTE:
 SEE SHEET 5 FOR LOT TEMPLATES
 SEE SHEET 5 FOR EROSION CONTROL DETAILS
 SF-18-038, 039, 040

48 HOURS BEFORE YOU DIG,
 CALL UTILITY LOCATORS
811
 UTILITY NOTIFICATION CENTER OF COLORADO
 IT'S THE LAW

THE LOCATIONS OF EXISTING UNDERGROUND UTILITIES ARE SHOWN IN AN APPROXIMATE WAY ONLY. THE CONTRACTOR SHALL DETERMINE THE EXACT LOCATION OF ALL EXISTING UTILITIES BEFORE COMMENCING WORK. THE CONTRACTOR SHALL BE FULLY RESPONSIBLE FOR ANY AND ALL DAMAGES WHICH MIGHT BE CAUSED BY HIS FAILURE TO EXACTLY LOCATE AND PRESERVE ANY AND ALL UNDERGROUND UTILITIES.

NO.	REVISION	DATE

REVIEW:

PREPARED UNDER MY DIRECT SUPERVISION FOR AND ON BEHALF OF CLASSIC CONSULTING ENGINEERS & SURVEYORS, LLC

Kyle M. Campbell
 KYLE M. CAMPBELL, COLORADO P.E. #29794

Wally
 DATE

CLASSIC
 CONSULTING
 ENGINEERS & SURVEYORS

619 N. Cascade Avenue, Suite 200
 Colorado Springs, Colorado 80903

(719) 785-0790
 (719) 785-0799 (Fax)

HANNAH RIDGE AT FEATHERGRASS
 FILING NO. 5, 6 & 7
 OVERLOT GRADING AND EROSION CONTROL PLAN

DESIGNED BY	KRC	SCALE	DATE	10/12/18
DRAWN BY	KC	(H) 1" = 50'	SHEET	3 OF 7
CHECKED BY	(V) 1" = NA	JOB NO.	1116.06	

N:\111605\DRAWINGS\CONSTRUCTION\FILING_5\03-111605-03-02.dwg, 6/7/2019 1:38:25 PM, 11

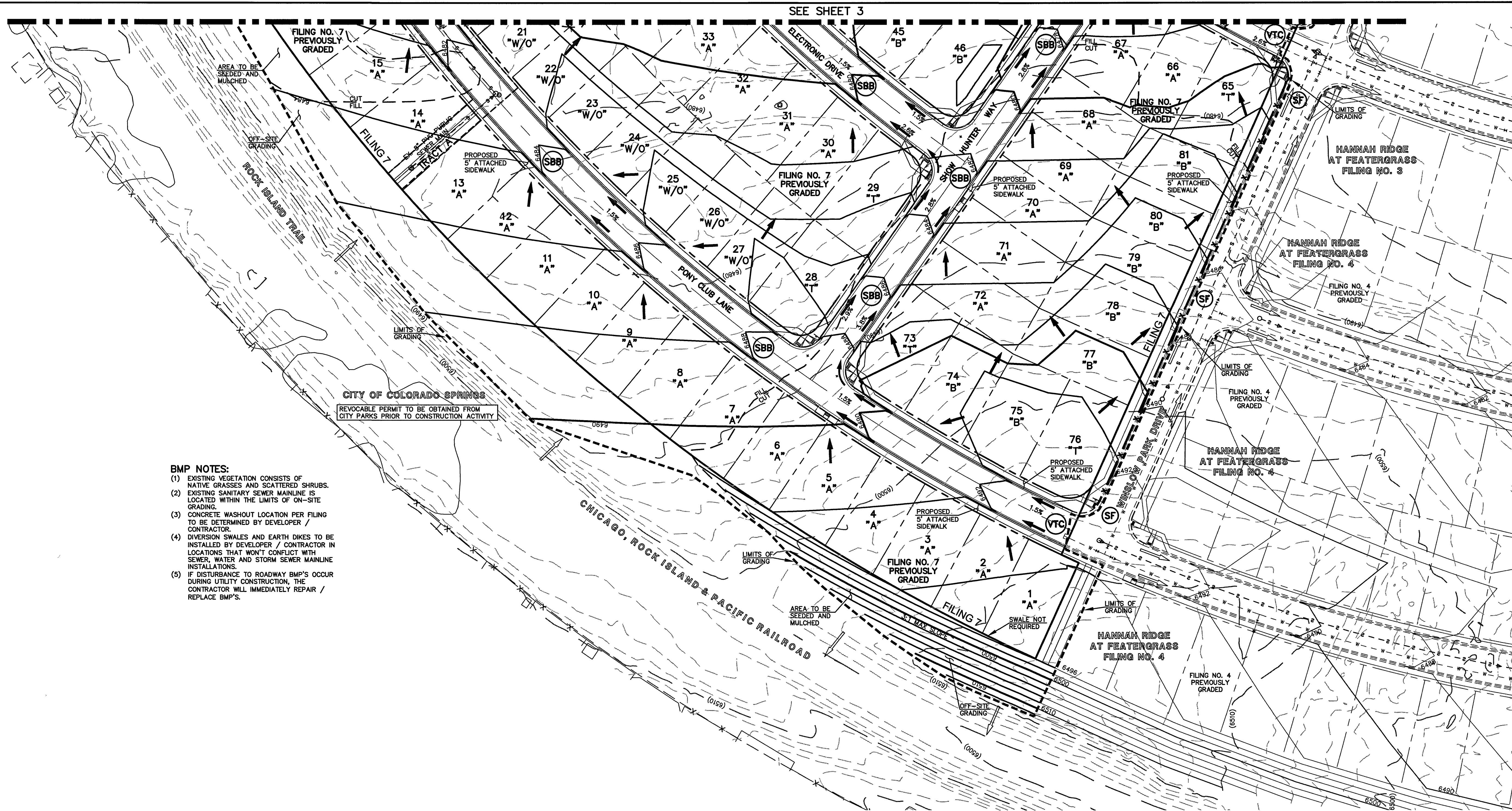

BMP NOTES:

- (1) EXISTING VEGETATION CONSISTS OF NATIVE GRASSES AND SCATTERED SHRUBS.
- (2) EXISTING SANITARY SEWER MAINLINE IS LOCATED WITHIN THE LIMITS OF ON-SITE GRADING.
- (3) CONCRETE WASHOUT LOCATION PER FILING TO BE DETERMINED BY DEVELOPER / CONTRACTOR.
- (4) DIVERSION SWALES AND EARTH DIKES TO BE INSTALLED BY DEVELOPER / CONTRACTOR IN LOCATIONS THAT WON'T CONFLICT WITH SEWER, WATER AND STORM SEWER MAINLINE INSTALLATIONS.
- (5) IF DISTURBANCE TO ROADWAY BMP'S OCCUR DURING UTILITY CONSTRUCTION, THE CONTRACTOR WILL IMMEDIATELY REPAIR / REPLACE BMP'S.

NOTES:

AT LEAST TEN DAYS PRIOR TO THE ANTICIPATED START OF CONSTRUCTION, FOR PROJECTS THAT WILL DISTURB 1 ACRE OR MORE, THE OWNER OR OPERATOR OF THE CONSTRUCTION ACTIVITY SHALL SUBMIT A PERMIT APPLICATION FOR STORMWATER DISCHARGE TO THE COLORADO DEPARTMENT OF PUBLIC HEALTH AND ENVIRONMENT, WATER QUALITY DIVISION. THE APPLICATION CONTAINS CERTIFICATION OF COMPLETION OF A STORMWATER MANAGEMENT PLAN (SWMP), OF WHICH THIS GRADING AND EROSION CONTROL PLAN MAY BE A PART. FOR INFORMATION OR APPLICATION MATERIALS CONTACT:

COLORADO DEPARTMENT OF PUBLIC HEALTH AND ENVIRONMENT
 WATER QUALITY CONTROL DIVISION
 WQCD - PERMITS
 4300 CHERRY CREEK DRIVE SOUTH
 DENVER, CO 80246-1530
 ATTN: PERMITS UNIT

NO PORTION OF THIS SITE IS LOCATED WITHIN A FLOODPLAIN AS DETERMINED BY THE FLOOD INSURANCE RATE MAPS (F.I.R.M.) MAP NUMBER 08041C0752F AND EFFECTIVE DATE, MARCH 17, 1997.

THE AVERAGE SOIL CONDITION REFLECTS PRING COURSE SANDY LOAM AS DETERMINED BY THE "SOIL SURVEY OF EL PASO COUNTY AREA" PREPARED BY THE U.S. SOIL CONSERVATION SERVICE.

EXISTING VEGETATION CONSISTS OF TALL NATIVE GRASSES AND WEEDS WITH SPORADIC CACTI AND YUCCAS THROUGH-OUT THE SITE.

EMERGENCY OVERFLOW SWALES FOR INLETS IN THE INTERIM UNTIL CURB AND ASPHALT IS INSTALLED WILL BE THE LOTS, FINAL WILL BE TO OVERTOP THE HIGH POINT IN ROADWAY TO THE NEXT AVAILABLE INLET OR TO PROPOSED POND.

STOCKPILE LOCATIONS FOR HOMEBUILDING TO BE ON EACH INDIVIDUAL LOT THAT IS BEING BUILT UPON.

LIMITS OF DISTURBANCE FOR THIS PLAN INCLUDE UTILITY INSTALLATION AND ROADWAY CONSTRUCTION WITHIN THE R.O.W., AND OVERLOT GRADING FOR DEVELOPMENT THEN INDIVIDUAL LOTS FOR HOMEBUILDING ONCE CONSTRUCTION OF THE HOME BEGINS.

GRADING WITHIN THIS PHASE WILL BE FULLY DEVELOPED WITH HOME BUILDING OPERATIONS.

LOCATION OF STORAGE FOR MAINTENANCE EQUIPMENT AND TEMPORARY DISPOSAL AREAS WILL BE ADDED TO THIS PLAN BY SWMP ADMINISTRATOR UPON COORDINATION WITH SELECTED CONTRACTOR.

ALL AREAS ARE TO BE RESEDED OUTSIDE OF THE FILING NO. 5, 6 AND 7 AREA. RESEED ALL AREAS AS NEEDED TO PREVENT EROSION AND SEDIMENT RUNOFF ONTO CONSTRUCTION ACTIVITIES.

ALL RETAINING WALLS TO BE STACKED BLOCK WALLS. BUILDING PERMIT REQUIRED FOR WALLS 4' OR TALLER.

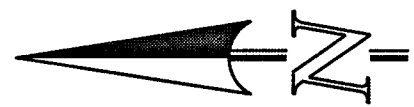

50 25 0 50 100

SCALE: 1" = 50'

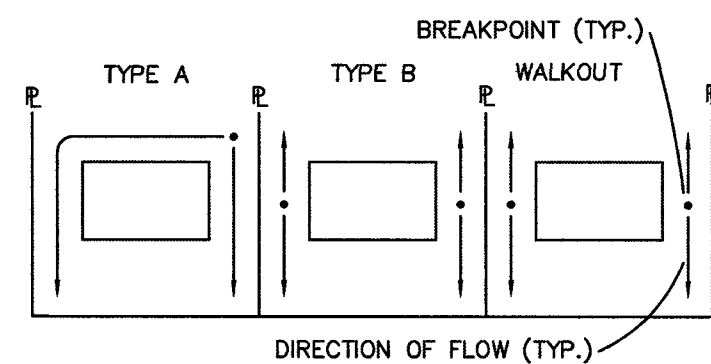

LOT DRAINAGE TYPES

NOTE:
 SIDE LOT LINE SWALES ARE REQUIRED FOR ALL LOTS.

THE PROPOSED CHANNEL IMPROVEMENTS AND CONCRETE BOX CULVERT WILL BE INSTALLED WITHIN THE FILING NO. 5 CDS. THE PROPOSED STORMWATER QUALITY FACILITY WILL BE INSTALLED WITHIN THE FILING NO. 7 CDS. THE FILING NO. 6 CDS DO NOT INCLUDE STORM SEWER IMPROVEMENTS. FILING NO. 5, 6 AND 7 WILL BE OVERLOT GRADED CONCURRENTLY. FILING NO. 7 WILL BE CONSTRUCTED INITIALLY IN 3 SEPARATE PHASES (SWQ FACILITY INSTALLED WITHIN PHASE 1). FILING NO. 6 WILL BE CONSTRUCTED FOLLOWING PHASE 3, FILING NO. 7. FILING NO. 5 WILL BE CONSTRUCTED FOLLOWING FILING NO. 6. THE FILING NO. 7 STORMWATER QUALITY FACILITY WILL BE UTILIZED AS A SEDIMENT TRAP INITIALLY. ONCE THE SITE IS STABILIZED AND HOME BUILDING BEGINS THE STORMWATER QUALITY FACILITY WILL BE FINALIZED.

LOCATION OF STAGING AREAS, STORAGE FOR MAINTENANCE EQUIPMENT, CONCRETE WASHOUT AREAS AND TEMPORARY DISPOSAL AREAS WILL BE ADDED TO THIS PLAN BY SWMP ADMINISTRATOR UPON COORDINATION WITH SELECTED CONTRACTOR AND SHALL BE WITHIN CONSTRUCTION SITE BOUNDARIES AS SHOWN.

LEGEND

- (6770) EXISTING CONTOUR
- 6770 PROPOSED CONTOUR
- FILING LINE
- BOUNDARY/R.O.W. LINE
- EXISTING FLOW DIRECTION
- PROPOSED FLOW
- "A" A LOT
- "B" B LOT
- "W/O" WALKOUT LOT
- "T" TRANSITION LOT
- "G" GARDEN LOT
- PROPOSED INLET
- PROPOSED STORM SEWER PIPE
- HP PROPOSED HIGH POINT
- LP PROPOSED LOW POINT
- PROPOSED RETAINING WALL
- (TSB) TEMPORARY SEDIMENT BASIN
- (SF) SILT FENCE
- (IP) INLET PROTECTION
- (VTC) VEHICLE TRACKING CONTROL
- (SBB) STRAW BALE BARRIER

NOTE:
 SEE SHEET 5 FOR LOT TEMPLATES
 SEE SHEET 5 FOR EROSION CONTROL DETAILS

SF-18-038, 039, 040

48 HOURS BEFORE YOU DIG, CALL UTILITY LOCATORS 811 UTILITY NOTIFICATION CENTER OF COLORADO IT'S THE LAW	NO. REVISION	DATE

REVIEW:

PREPARED UNDER MY DIRECT SUPERVISION FOR AND ON BEHALF OF CLASSIC CONSULTING ENGINEERS & SURVEYORS, LLC

Kyle M. Campbell
 KYLE M. CAMPBELL, COLORADO LICENSE # 29794
 DATE 6/9/19

CLASSIC
 CONSULTING ENGINEERS & SURVEYORS

619 N. Cascade Avenue, Suite 200
 Colorado Springs, Colorado 80903
 (719) 785-0790
 (719) 785-0799 (Fax)

HANNAH RIDGE AT FEATHERGRASS FILING NO. 5, 6 & 7 OVERLOT GRADING AND EROSION CONTROL PLAN			
DESIGNED BY	KRC	SCALE	DATE 10/12/18
DRAWN BY	KC	(H) 1" = 50'	SHEET 4 OF 7
CHECKED BY	(V) 1" = NA	JOB NO.	1116.056



Silt Fence (SF)

SC-1

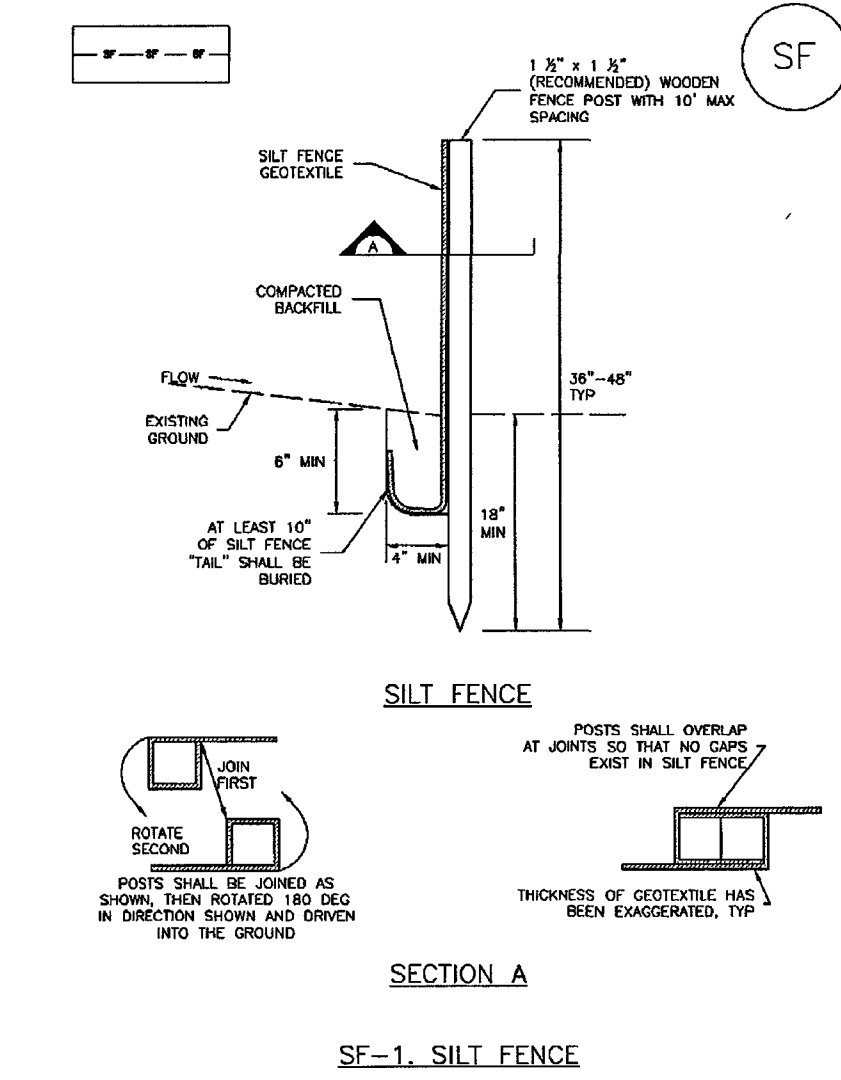

November 2010 Urban Drainage and Flood Control District Urban Storm Drainage Criteria Manual Volume 3 SF-3

Vehicle Tracking Control (VTC)

SM-4

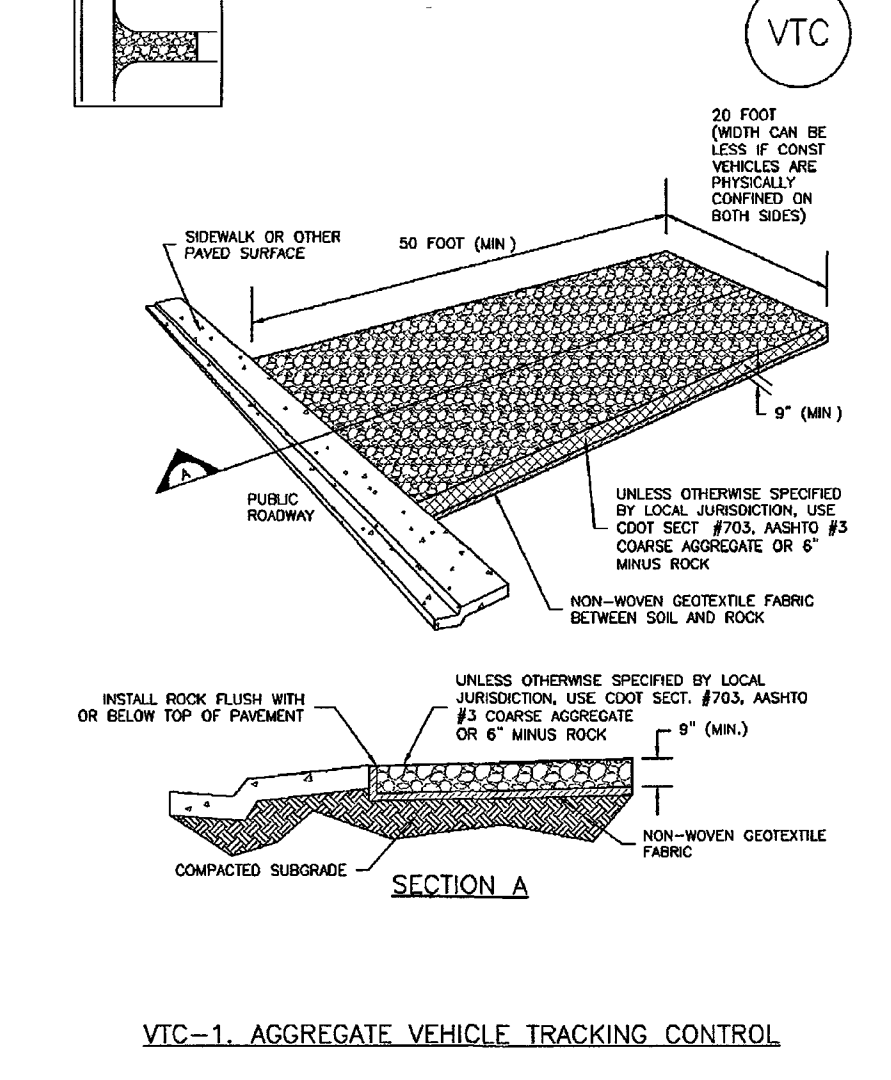

November 2010 Urban Drainage and Flood Control District Urban Storm Drainage Criteria Manual Volume 3 VTC-3

Inlet Protection (IP)

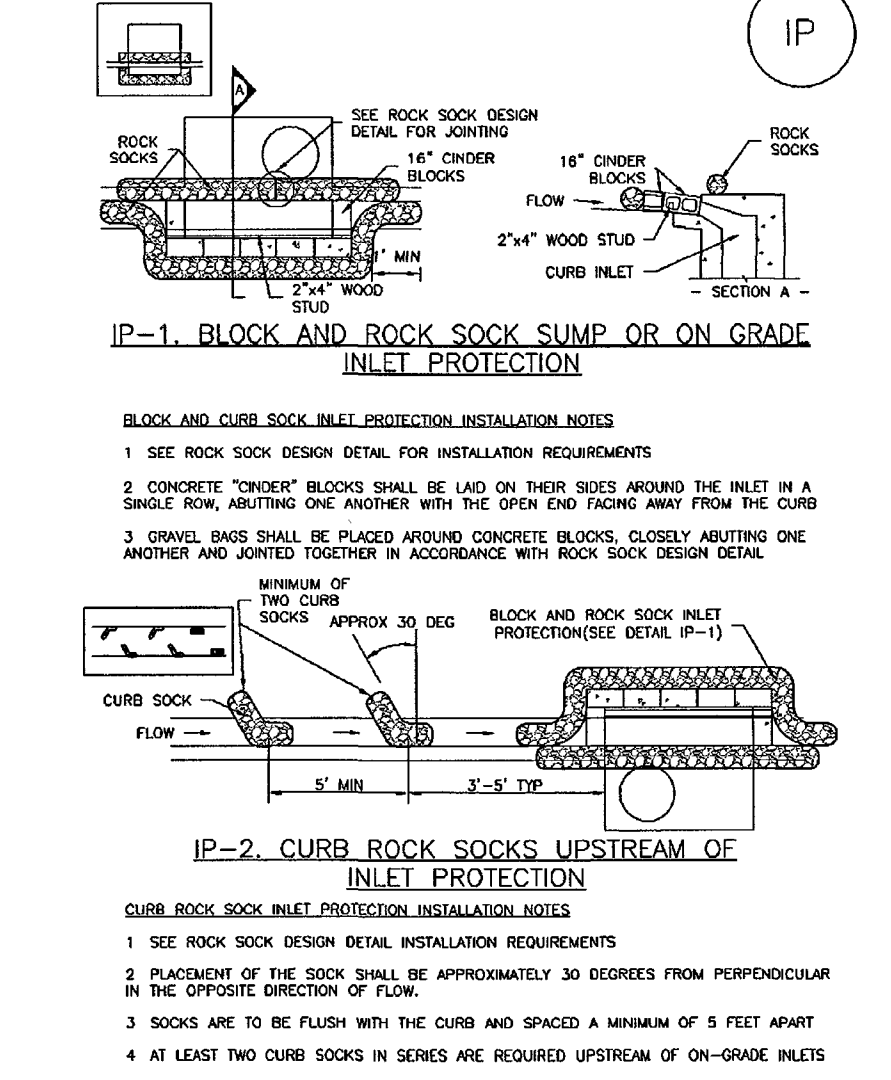

IP-4 Urban Drainage and Flood Control District Urban Storm Drainage Criteria Manual Volume 3 August 2013

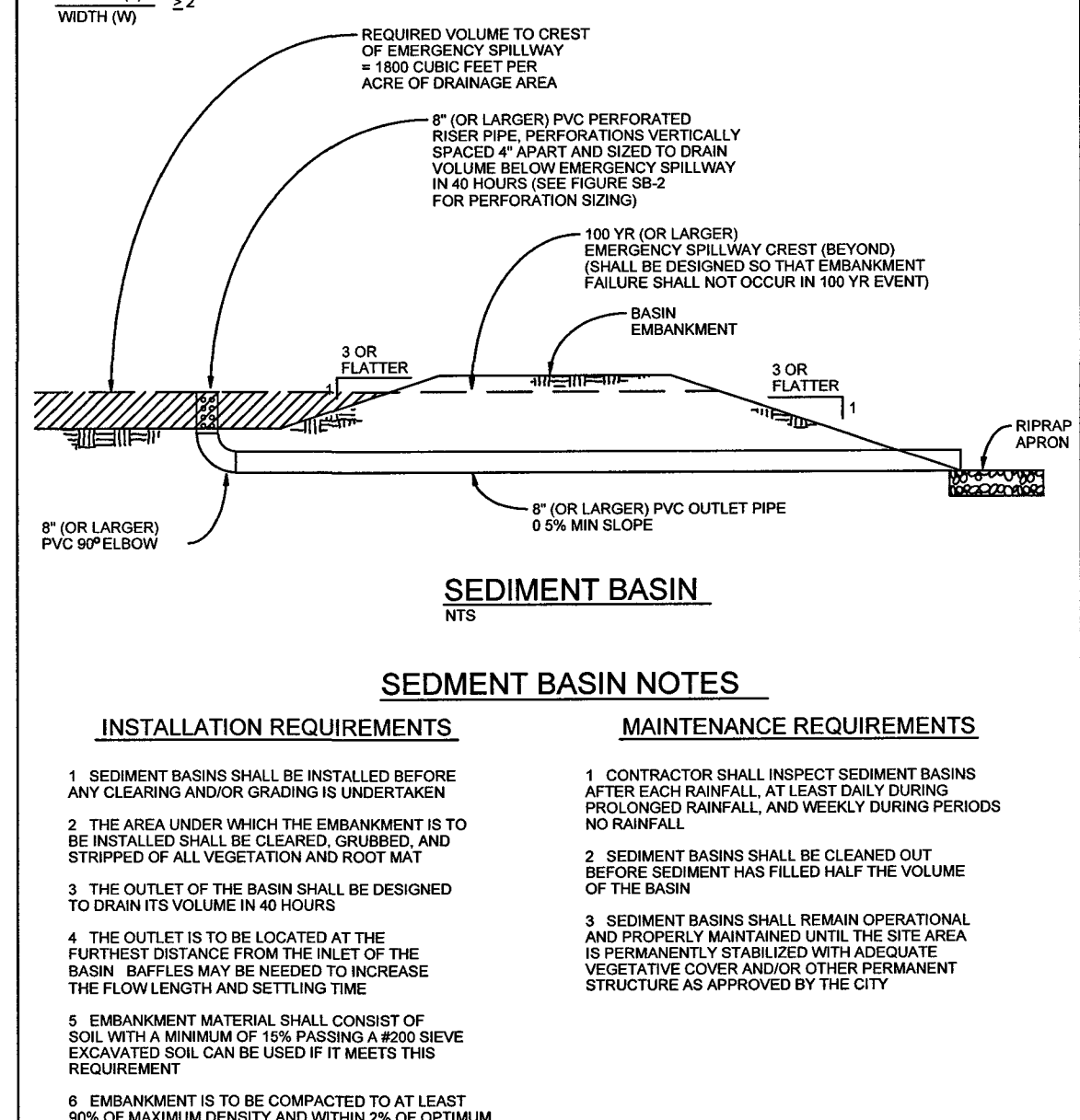

City of Colorado Springs Stormwater Quality Figure SB-1 Sediment Basin Construction Detail and Maintenance Requirements

TABLE SB-1

Required Area per Row (sq ft)	Depth at Outlet (ft)				
	1.0	1.5	2.0	2.5	3.0
1	15.04	7.71	5.10	3.76	2.95
2	15.04	7.71	5.10	3.76	2.95
3	15.04	7.71	5.10	3.76	2.95
4	15.04	7.71	5.10	3.76	2.95
5	15.04	7.71	5.10	3.76	2.95
6	15.04	7.71	5.10	3.76	2.95
7	15.04	7.71	5.10	3.76	2.95
8	15.04	7.71	5.10	3.76	2.95
9	15.04	7.71	5.10	3.76	2.95
10	15.04	7.71	5.10	3.76	2.95

TABLE SB-2

Circular Perforation Size (in)	Area per Row (sq ft)	Number of Columns of Perforations		
		1/4"	3/8"	1/2"
1/4"	0.0009	100	100	100
3/8"	0.0044	25	25	25
1/2"	0.0079	16	16	16
3/4"	0.0158	8	8	8
1"	0.0316	4	4	4
1 1/4"	0.0633	2	2	2
1 3/8"	0.0791	2	2	2
1 1/2"	0.0984	2	2	2
1 5/8"	0.1177	2	2	2
1 3/4"	0.1370	2	2	2
1 7/8"	0.1563	2	2	2
2"	0.1756	2	2	2

City of Colorado Springs Stormwater Quality Figure SB-2 Outlet Sizing Application Technique and Maintenance Requirements

Concrete Washout Area (CWA)

MM-1

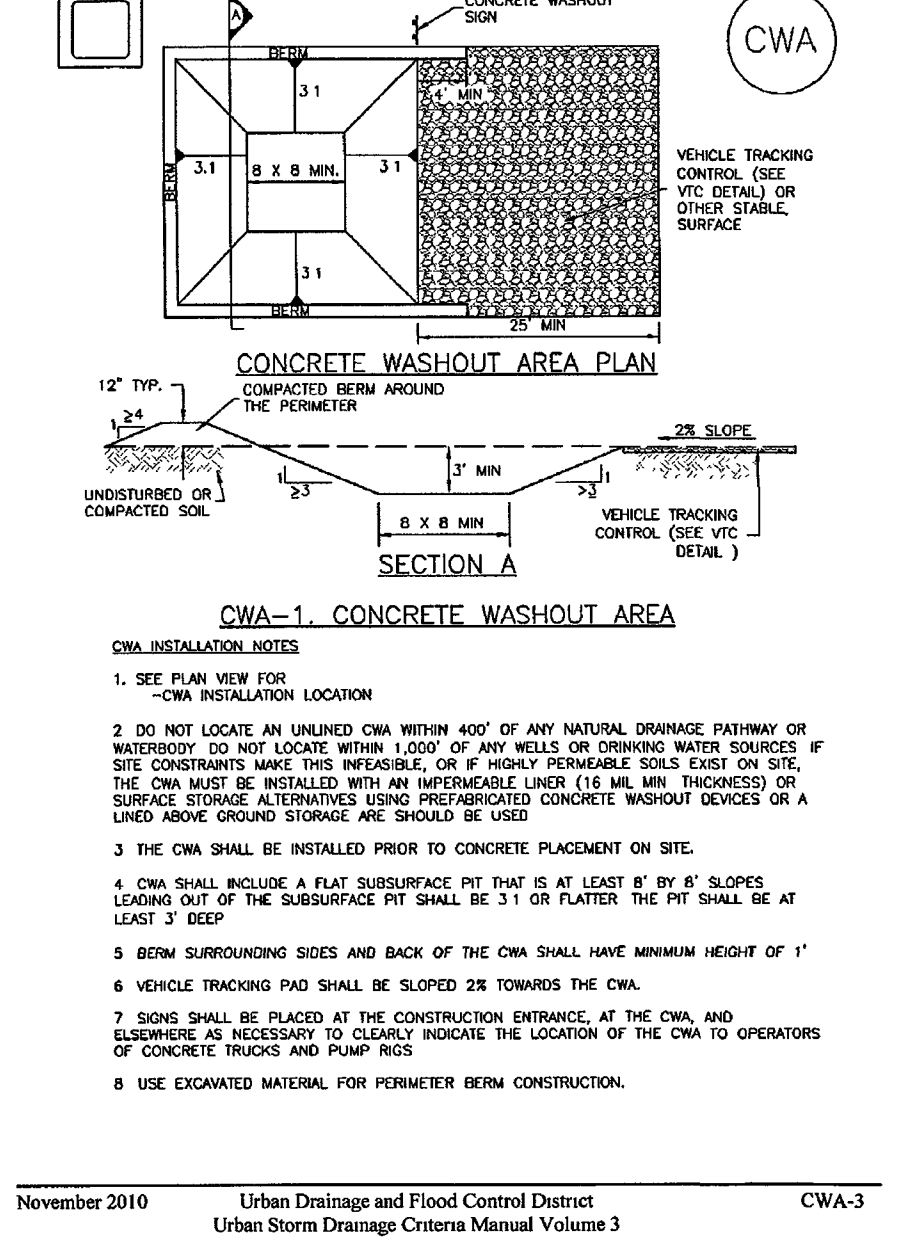

November 2010 Urban Drainage and Flood Control District Urban Storm Drainage Criteria Manual Volume 3 CWA-3

Concrete Washout Area (CWA)

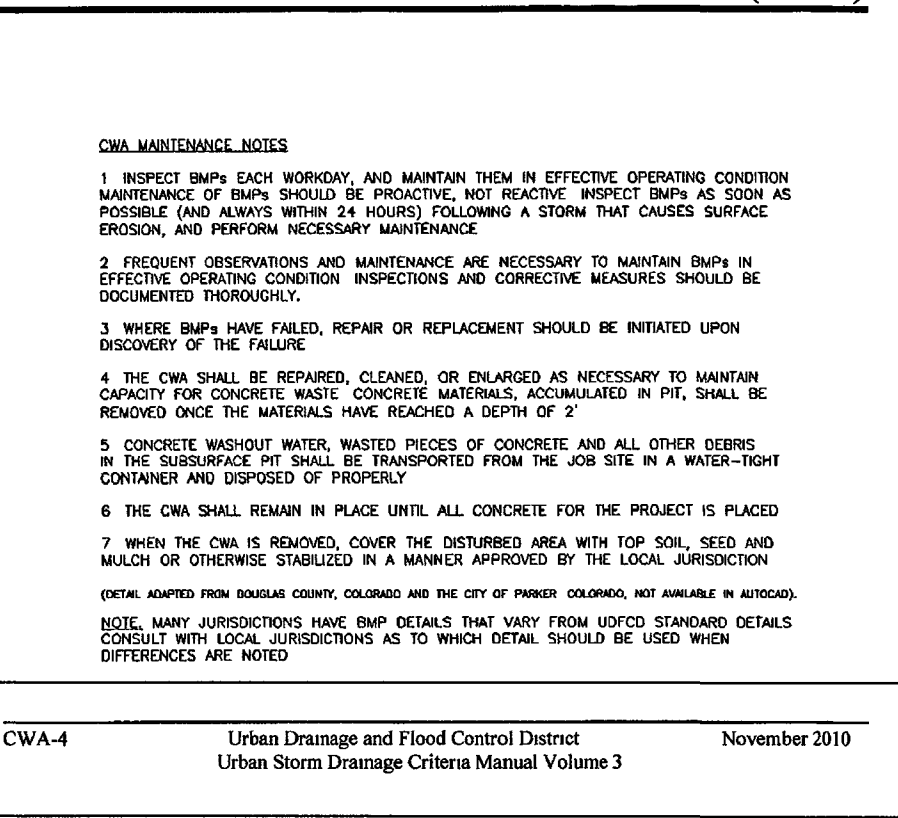

November 2010 Urban Drainage and Flood Control District Urban Storm Drainage Criteria Manual Volume 3 CWA-4

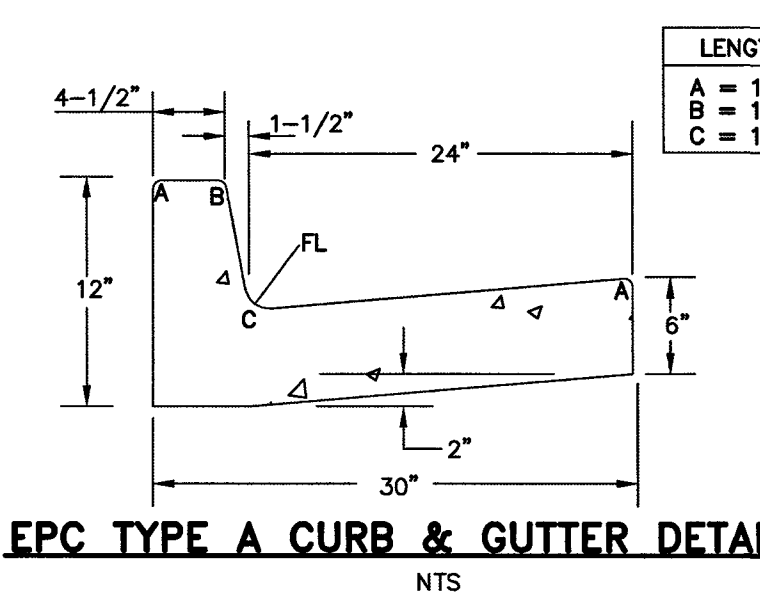
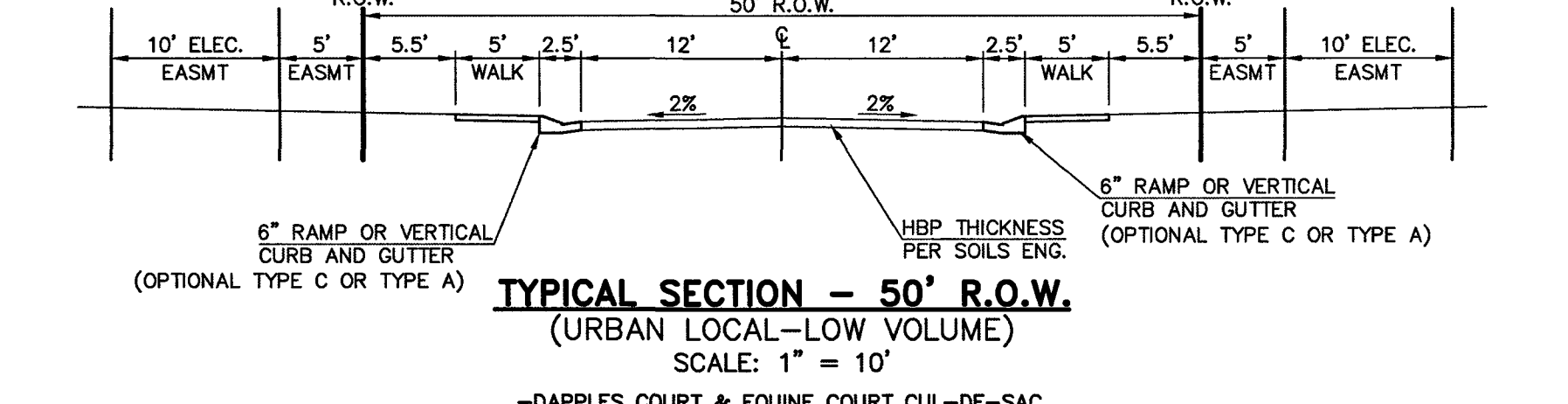
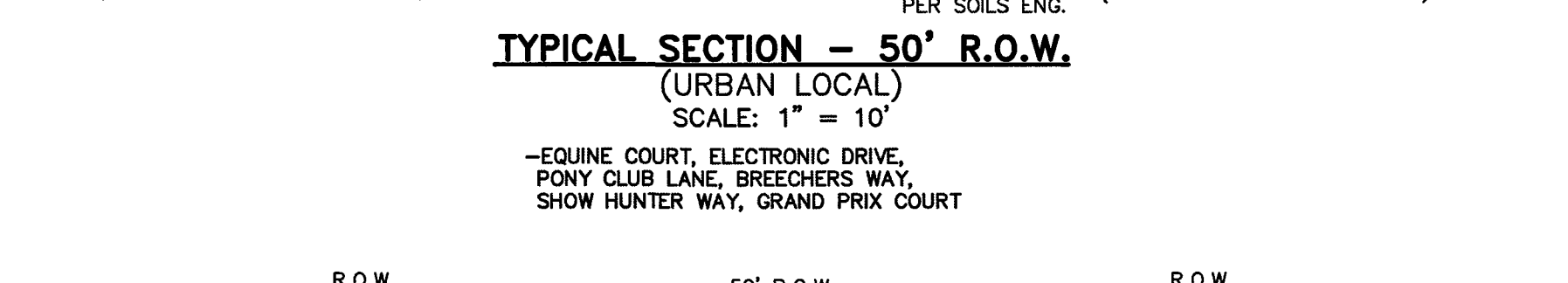
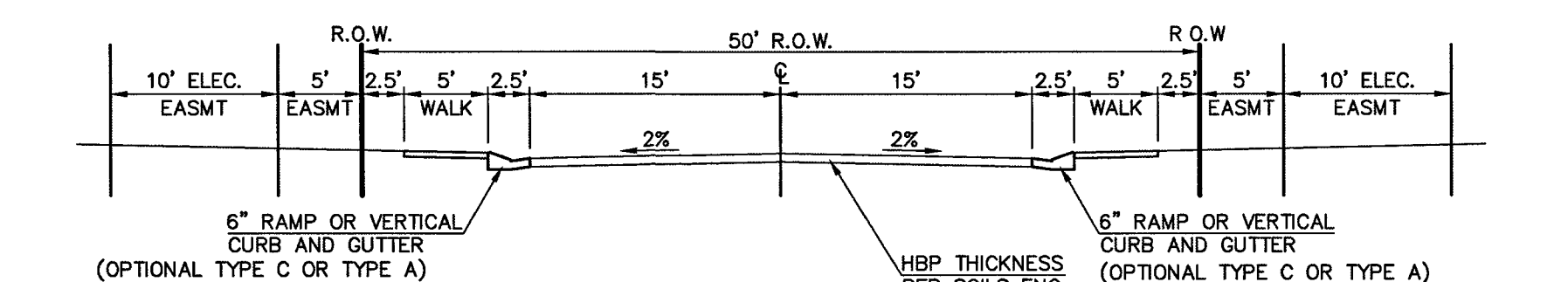
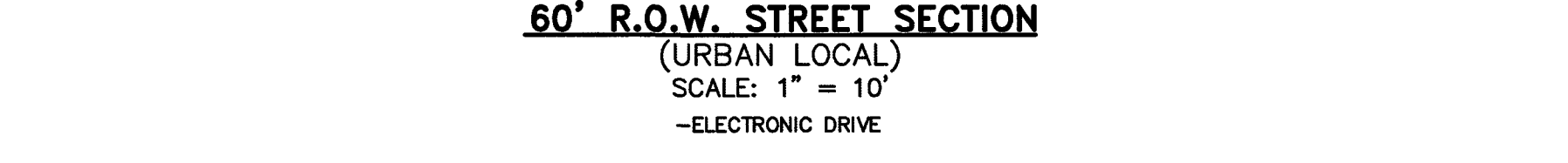
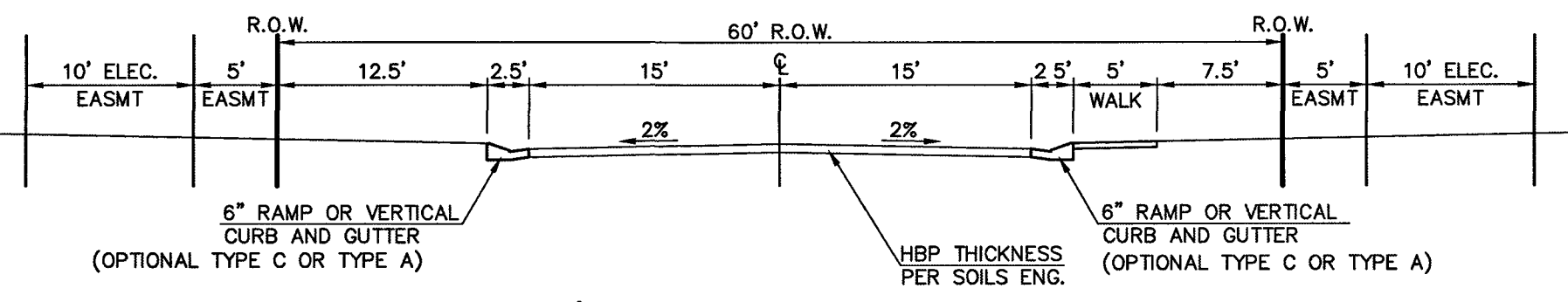

EPC TYPE A CURB & GUTTER DETAIL

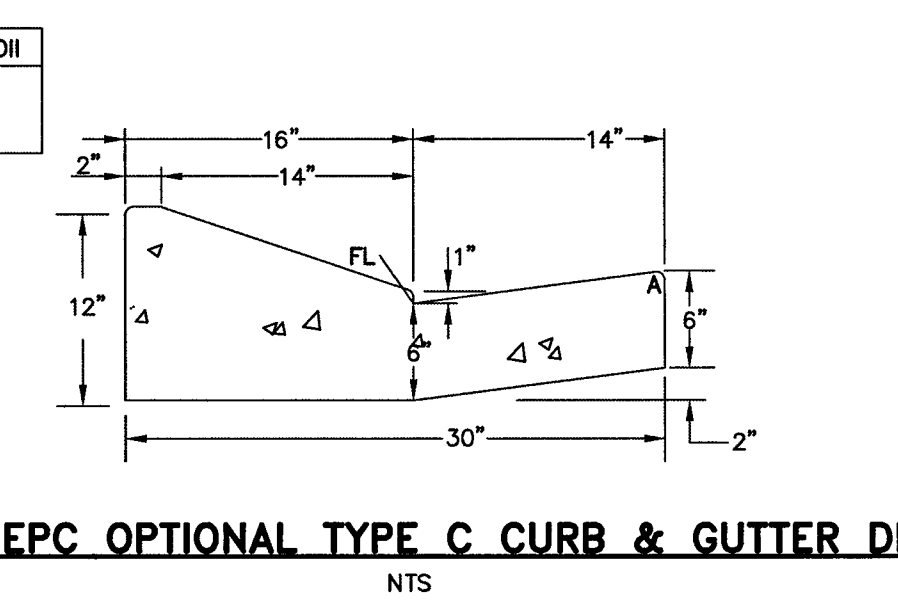

EPC OPTIONAL TYPE C CURB & GUTTER DETAIL

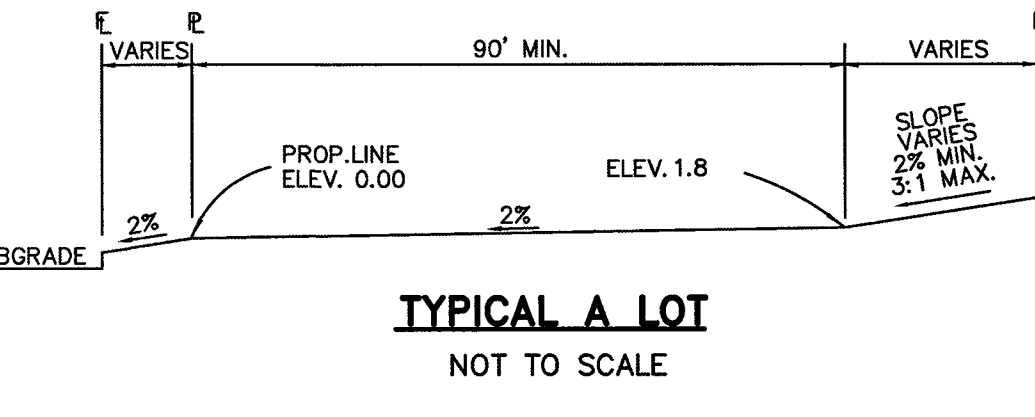

TYPICAL A LOT NOT TO SCALE

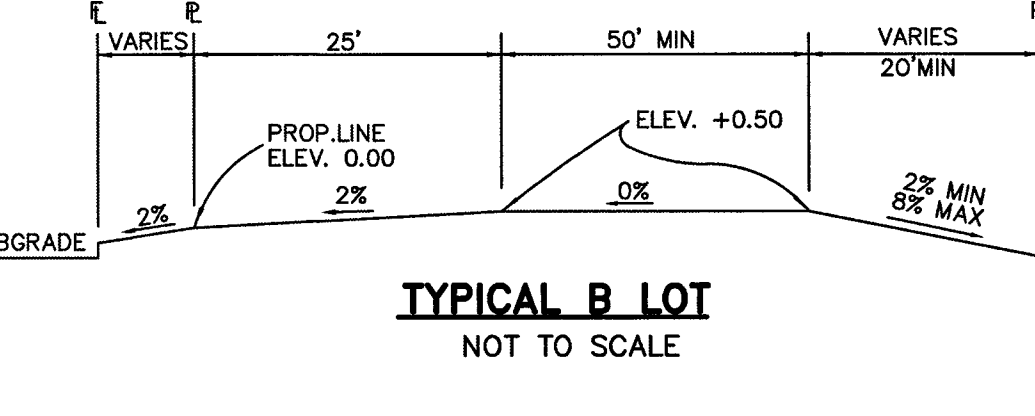

TYPICAL B LOT NOT TO SCALE

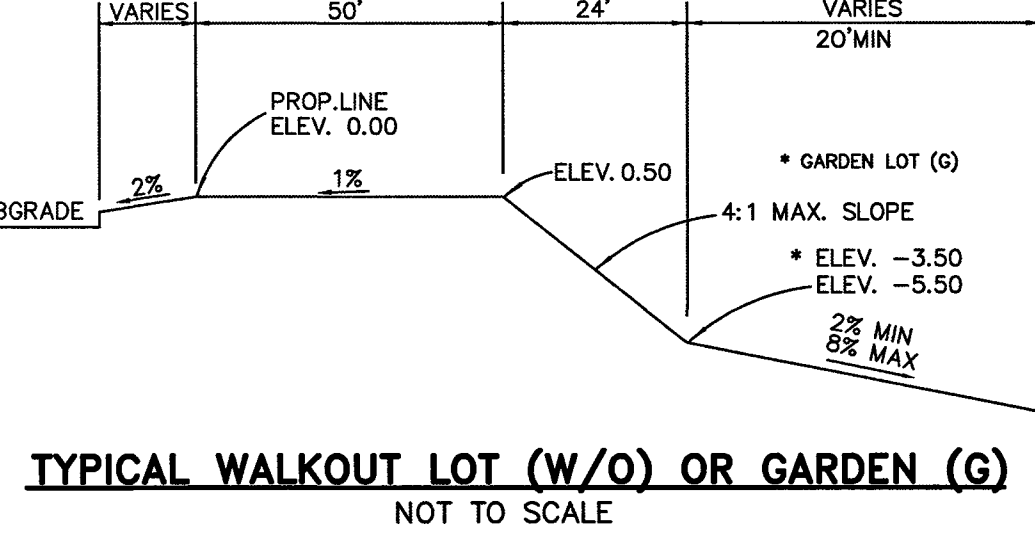

TYPICAL WALKOUT LOT (W/O) OR GARDEN (G) NOT TO SCALE

NOTE:
"T" LOTS OR "TRANSITION" LOTS OCCUR IN PLACES WHERE BOTH PROPERTY LINES CANNOT BE GRADED AS THE TYPICAL STANDARD LOT TEMPLATES SHOWN. THESE LOTS WILL BE GRADED TO CREATE POSITIVE DRAINAGE AWAY FROM THE STRUCTURE.

NOTE:
SIDE LOT SWALES WILL BE PROVIDED WHERE APPROPRIATE.

SEEDING GUIDELINES

- SEED PREPARATION**
THE SEEDBED SHOULD BE WELL-SETTLED AND FIRM, BUT FRAGILE ENOUGH THAT THE SEED CAN BE PLACED AT THE SPECIFIED DEPTHS. COMPETITIVE STANDS OF WEEDS THAT ARE PRESENT BEFORE SEEDING MUST BE CONTROLLED BY SHALLOW TILLAGE OR BY APPLICATION OF HERBICIDES. SOILS THAT HAVE BEEN OVER-COMPACTED BY TRAFFIC OR EQUIPMENT, ESPECIALLY WHEN WET, SHOULD BE TILLED TO BREAK UP ROOTING-RESTRICTIVE LAYERS, THAN HARROWED, ROLLED, OR PACKED TO PREPARE THE REQUIRED FIRM SEEDBED.
- FERTILIZER**
FERTILIZER SHOULD BE APPLIED AT A RATE OF 50 POUNDS OF AVAILABLE NITROGEN PER ACRE AND 40 POUNDS OF AVAILABLE PHOSPHATE PER ACRE. THE TIME OF APPLICATION SHOULD BE IMMEDIATELY PRIOR TO SEEDING, AT THE TIME OF SEEDING, OR IMMEDIATELY FOLLOWING SEEDING, DEPENDING ON THE KIND OF FERTILIZER AND TYPE OF EQUIPMENT USED.
- SEEDING**
SEED SHOULD BE PLANTED WITH A GRASS DRILL ON ALL SLOPES OF 3:1 (3:1) OR FLATTER. SEED MAY BE BROADCAST BY HAND, BY MECHANICAL SPREADER, OR BY HYDRAULIC EQUIPMENT ON AREAS THAT ARE SMALL, TOO STEEP, OR NOT ACCESSIBLE FOR SEED DRILL OPERATIONS. SEED PLANTED WITH A DRILL SHOULD BE COVERED WITH SOIL TO A DEPTH OF 1/4 TO 3/4 INCH. SEED PLANTED BY THE BROADCAST METHOD SHOULD BE INCORPORATED INTO THE SOIL SURFACE, NOT TO EXCEED A DEPTH OF 3/4 INCH, BY RAKING, HARROWING, OR OTHER PROVEN METHOD.
- MULCHING**
SEEDING AREAS SHOULD BE MULCHED TO CONSERVE MOISTURE, PREVENT SURFACE COMPACTION OR CRUSTING, REDUCE RUNOFF AND EROSION; CONTROL INSECTS; AND HELP ESTABLISH PLANT COVER.
- SUPPLEMENTAL WATER**
IN LOW RAINFALL AREAS, WHERE WATER IS AVAILABLE AND WHERE RAPID ESTABLISHMENT IS NEEDED, IRRIGATION OF NEW SEEDING SHOULD BE PERFORMED DURING THE FIRST GROWING SEASON. WATER SHOULD BE APPLIED AT APPROXIMATELY ONE WEEK INTERVALS, AT A RATE OF 3/4 TO 1 INCH PER APPLICATION, WHEN RAINFALL IS DEFICIENT FOR PLANT DEVELOPMENT.

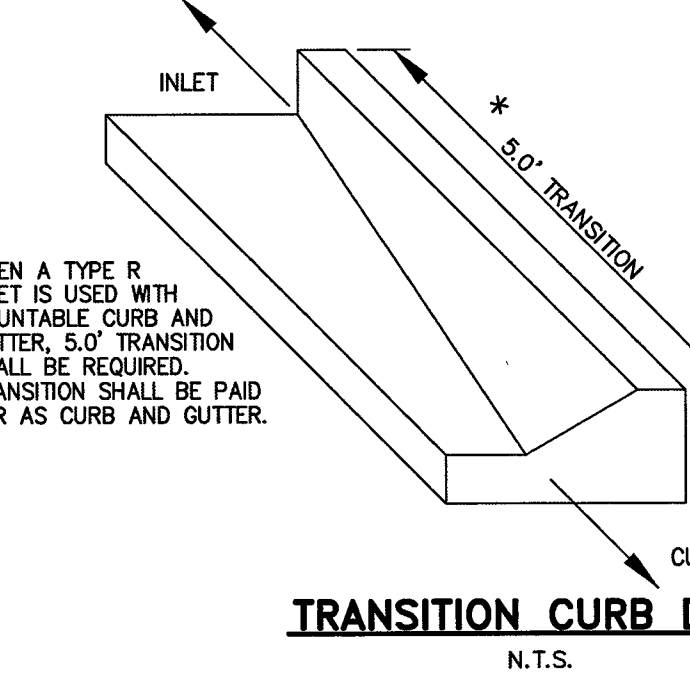

TRANSITION CURB DETAIL N.T.S.

EROSION CONTROL CRITERIA:

- EROSION CONTROL MEASURES SHALL BE IMPLEMENTED IN A MANNER THAT WILL PROTECT PROPERTIES AND PUBLIC FACILITIES FROM THE ADVERSE EFFECTS OF EROSION AND SEDIMENTATION AS A RESULT OF CONSTRUCTION AND EARTHWORK ACTIVITIES WITHIN THE PROJECT SITE.
- THE OMISSION FROM OR THE INCLUSION OF UTILITY LOCATIONS ON THE PLANS IS NOT TO BE CONSIDERED AS THE NON-EXISTENCE OF OR A DEFINITE LOCATION OF EXISTING UNDERGROUND UTILITIES.
 - DURING GRADING OPERATIONS, LOCATE AND SET THE STRAW BALE CHECK DAMS AND SILT FENCES AS SHOWN ON THE EROSION CONTROL PLAN. AT THIS TIME RESEED ALL DISTURBED AREAS WITH AN EL PASO COUNTY APPROVED SEED MIX.
 - SEEDING APPLICATION: DRILLED TO A DEPTH OF .25" TO .50" INTO SOIL WHERE POSSIBLE. BROADCAST AND RAKED TO COVER ON STEEPER THAN 3:1 SLOPES WHERE ACCESS IS LIMITED OR UNSAFE FOR EQUIPMENT.
 - MULCHING REQUIREMENT AND APPLICATION: 1.5 TONS PER ACRE NATIVE HAY MECHANICALLY CRIMPED INTO SOIL.
 - THE STRAW BALE CHECK DAMS AND SILT FENCES SHALL BE KEPT IN PLACE AND MAINTAINED UNTIL EROSION AND SEDIMENTATION POTENTIAL IS MITIGATED. REMOVAL OF SILT AND SEDIMENT COLLECTED BY THE STRAW BALES IS REQUIRED ONCE IT REACHES HALF THE HEIGHT OF THE STRAW BALES OR SILT FENCE.
 - DISTURBED SOIL SHALL BE VEGETATED WITHIN 60 DAYS AFTER SUBSTANTIAL FINAL GRADING IS COMPLETE. PROVIDE TEMPORARY VEGETATION TO DISTURBED AREAS THAT WILL HAVE A PERIOD OF EXPOSURE OF 6 MONTHS OR LONGER PRIOR TO FINAL STABILIZATION.
 - ALL FACILITIES, VEGETATION AND OTHER ITEMS REQUIRED BY THE APPROVED FINAL GRADING, EROSION CONTROL AND RECLAMATION PLAN SHALL BE PROPERLY MAINTAINED BY THE OWNERS OF THE PROPERTY. SUCH MAINTENANCE SHALL INCLUDE, BUT NOT BE LIMITED TO KEEPING ALL EROSION CONTROL FACILITIES IN GOOD ORDER AND FUNCTIONAL, REPAIRING ANY EROSION DAMAGE THAT OCCURS, KEEPING ALL VEGETATION HEALTHY AND IN GROWING CONDITION AND REPLACING ANY DEAD VEGETATION AS SOON AS PRACTICABLE.
 - ALL SILT FENCES ARE TO BE REGULARLY INSPECTED AND REPAIRED AS NEEDED.
 - THE CONTRACTOR SHALL PROVIDE VEHICLE TRACKING CONTROL FACILITIES FOR EACH ENTRANCE/EXIT TO THE SITE. THE CONTRACTOR SHALL SUBMIT A PLAN WHICH WILL ASSURE USAGE OF THIS FACILITY BY ALL VEHICLES LEAVING THE SITE.
 - EROSION CONTROL MEASURES SHALL BE CHECKED AFTER EACH STORM EVENT AND REPAIRED WHEN NECESSARY.
 - CONTRACTOR SHALL MAINTAIN ALL TEMPORARY EROSION CONTROL FACILITIES IN GOOD WORKING ORDER UNTIL SUCH TIME AS PERMANENT FACILITIES ARE IN PLACE AND THE CONSTRUCTION MANAGER HAS APPROVED THEIR REMOVAL.
 - ADDITIONAL EROSION CONTROL STRUCTURES MAY BE REQUIRED AT THE TIME OF CONSTRUCTION.
 - THE EROSION CONTROL MEASURES OUTLINED ON THE PLAN ARE THE RESPONSIBILITY OF THE DEVELOPER TO MONITOR AND REPLACE, REGRADE AND REBUILD AS NECESSARY UNTIL VEGETATION IS ESTABLISHED.
 - MAXIMUM ACREAGE OPEN AT ANY GIVEN TIME IS TO BE 30 ACRES.

SCHEDULE OF ANTICIPATED CONSTRUCTION ACTIVITY:

BEGIN CONSTRUCTION UPON APPROVAL	ACTIVITY ALL SITE ROADWAY GRADING AND UTILITY INSTALLATION	COMPLETION 6 MONTHS	EROSION CONTROL ALL SHOWN ON GRADING PLAN

SIDEWALK NOTES:

- INSTALL 5' ATTACHED SIDEWALK ONLY WHERE IDENTIFIED ON THE CONSTRUCTION PLANS.

48 HOURS BEFORE YOU DIG, CALL UTILITY LOCATORS

811
UTILITY NOTIFICATION CENTER OF COLORADO IT'S THE LAW

THE LOCATIONS OF EXISTING UNDERGROUND UTILITIES ARE SHOWN IN AN APPROXIMATE WAY ONLY. THE CONTRACTOR SHALL DETERMINE THE EXACT LOCATION OF ALL EXISTING UTILITIES BEFORE COMMENCING WORK. THE CONTRACTOR SHALL BE FULLY RESPONSIBLE FOR ANY AND ALL DAMAGES WHICH MIGHT BE CAUSED BY HIS FAILURE TO EXACTLY LOCATE AND PRESERVE ANY AND ALL UNDERGROUND UTILITIES.

NO.	REVISION	DATE

REVIEW: PREPARED UNDER MY DIRECT SUPERVISION FOR AND ON BEHALF OF CLASSIC CONSULTING ENGINEERS & SURVEYORS, LLC

DATE: 10/19/19
KYLE R. CAMPBELL, COLORADO LICENSE #29794

CLASSIC CONSULTING ENGINEERS & SURVEYORS

619 N. Cascade Avenue, Suite 200 Colorado Springs, Colorado 80903 (719)785-0790 (719)785-0799(fax)

HANNAH RIDGE AT FEATHERGRASS FILING NO. 5, 6 & 7 OVERLEAF GRADING AND EROSION CONTROL PLAN DETAILS

DESIGNED BY: KRC SCALE: (H) 1"= N/A DATE: 10/12/18
DRAWN BY: KC (H) 1"= N/A SHEET 5 OF 7
CHECKED BY: (V) 1"= N/A JOB NO.: 1116.06

SF-18-038, 039, 040