

SADDLEHORN RANCH - FILING 1

PERMANENT BMP APPLICABILITY MAP

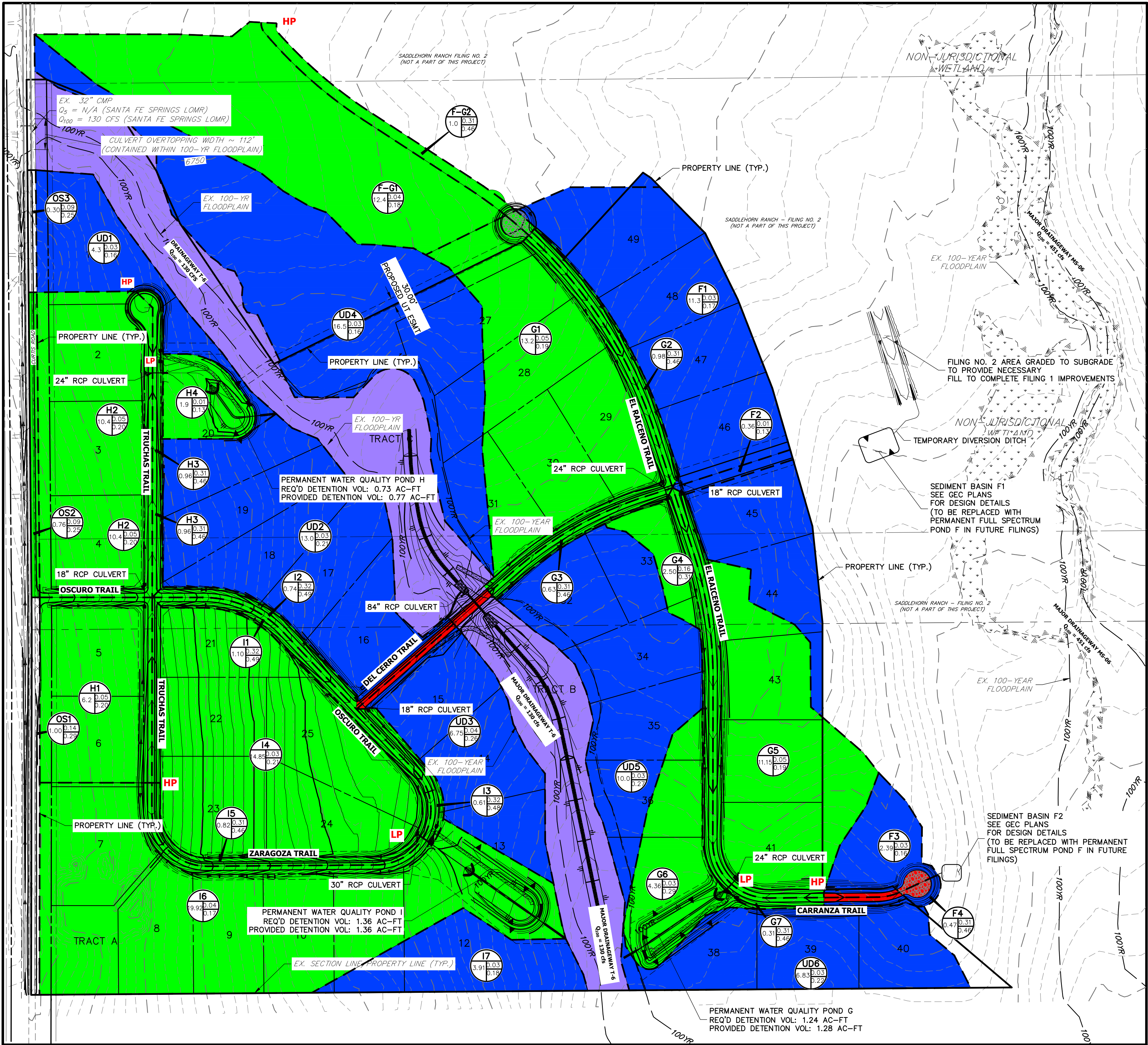

LEGEND

- BASIN DESIGNATION**
- I.D.: BASIN IDENTIFIER
A: BASIN AREA
B: C₅
C: C₁₀₀
- BASIN DELINEATION**
- 6100--- EXISTING INDEX CONTOURS
--- EXISTING INTERMEDIATE CONTOURS
---6100--- PROPOSED INDEX CONTOURS
--- PROPOSED INTERMEDIATE CONTOURS
- ⇨ EXISTING FLOW DIRECTION
➔ PROPOSED FLOW DIRECTION
- HP** PROPOSED HIGH POINT
LP PROPOSED LOW POINT
- AREA DETAINED IN PBMP**
- AREA NOT DETAINED IN PBMP**
PER SECTION 1.7.1.B.5
(RURAL 2.5+ ACRE LOTS W/
IMPERVIOUSNESS < 10%)
- AREA NOT DETAINED IN PBMP**
PER SECTION 1.7.1.C.1
(20% UP TO 1 AC. OF DEVELOPMENT
SITE CAN BE EXCLUDED --
DUE TO TOPOGRAPHY)
- AREA NOT DETAINED IN PBMP**
PER SECTION 1.7.1.B.7
(LAND DISTURBANCE TO UNDEV.
LAND THAT WILL REMAIN UNDEV.)

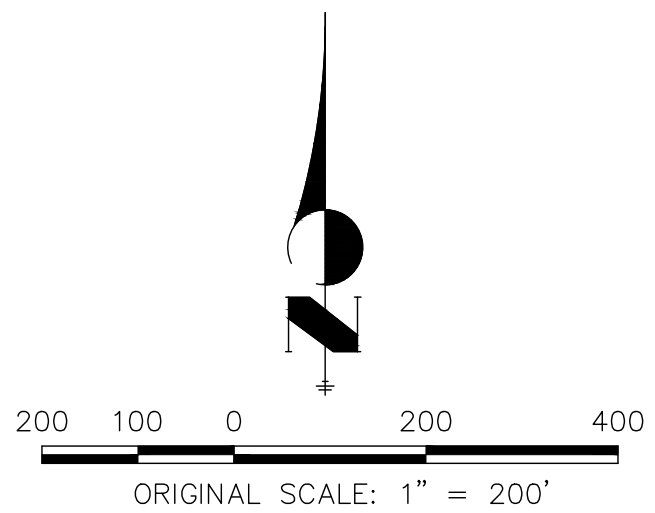

SADDLEHORN RANCH FILING 1
MS4 PERMIT EXCLUSION AREAS
2514202
01/09/20
SHEET 1 OF 1

J.R. ENGINEERING
A Westrian Company

Centennial 303-740-9393 • Colorado Springs 719-593-2593
Fort Collins 970-491-9888 • www.jrengineering.com