

D3-1 (Sheet 1 of 3)
Street Name Sign

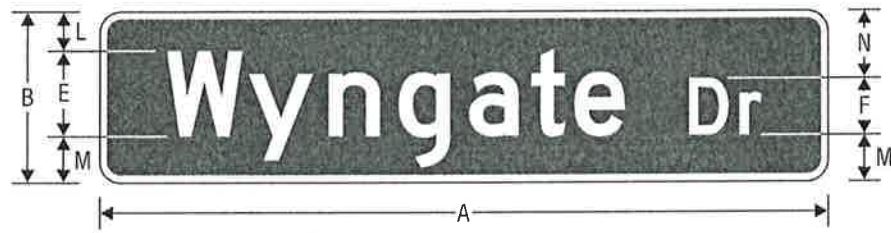

D3-1 – PRINCIPAL LEGEND WITH DESCENDING STROKES



D3-1 – WITHOUT BORDER, PRINCIPAL LEGEND WITH OR WITHOUT DESCENDING STROKES

| | A | B | C | D | E | F | G | H | J | K | L | M | N | |
|----------|-----|----|-------|---|------|--------|------|------------|-----|-------|------|------|------|-------|
| | VAR | 8 | 0.375 | 2 | 4 D | 3 D | 3 | 3 (MIN) | 3 | 1 | 1.75 | 2.25 | 2.75 | 1.5 D |
| C | VAR | 12 | 0.5 | 3 | 6 D | 4 D | 5 | 4.5 (MIN) | 4.5 | 1.5 | 2.75 | 3.25 | 4.75 | 3 D |
| | VAR | 18 | 0.75 | 5 | 8 D | 5.33 D | 7.67 | 5.33 (MIN) | 6 | 1.875 | 5 | 5 | 7.67 | |
| | VAR | 24 | 1 | 6 | 12 D | 8 D | 10 | 9 (MIN) | 9 | 2.25 | 5.5 | 6.5 | 9.5 | |

COLORS: LEGEND, BORDER – WHITE (RETROREFLECTIVE)
 BACKGROUND – GREEN (RETROREFLECTIVE)
 BACKGROUND (ALTERNATE) – BLUE OR BROWN (RETROREFLECTIVE)

O = PRIVATE ROAD

McCain ATC Cabinet

El Paso County Traffic Signal Component List 03-Feb-2022

Cabinet and Components List

1. McCain Cabinet, 350i ATC 24 Channel FITA 16 Channel FOTA and ADU
2. Controller, Flex, Rack Mount, C1 Connector, with Omni Software
3. Clary Uninterruptible Power Supply SP1250 LX, 6 Battery, 302C No SNMP, w/ Battery Drawer
4. DYMEC 3170 EMX Managed Industrial Ethernet Switch 8 x 10/100/100 TX Port
5. Microhard Bullet LTE-NA Cellular Gateway
6. iNS29UN1-B-ES - Black iNS-Universal Navigator, 9x12 R10-3b Sign, No Braille, w/ Custom Voice, External Speaker, 2-Wire Push Button Station 
- iNS23TN1-B-ES - Black iNS-Universal Navigator, 9x15 R10-3e Sign, No Braille, w/ Custom Voice, External Speaker, 2-Wire Push Button Station

External Components

delete
External Speaker

1. Intersector-SBE, Microwave Vehicle Presence Sensor 2.0
2. Intersector Interface Board, 4 Outputs, Single Cabinet Slot
3. Ethernet Surge Protection Citel, RJ45, MJ8-POE-A
4. CAT5E Outdoor Cable, CMXT 350 MHz, Solid, 24 AWG, Foil Waterproof Tape 1000 Ft/Roll
5. Signal Heads, 12", 1W3S, 1W4S, 1W5S with Visors, LED Balls and LED Arrows
6. Backplates w/ 1 1/2" Reflective Tape
7. Pedestrian Signal Head (16) with Countdown Module
8. Pelco Poles, Steel, Black, 5ft and 10ft with Base, Collar, Cap and Anchor Bolts
9. AXIS Q6074-E PTZ Network Camera
10. AXIS T91L61 Wall-and-Pole Mount and AXIS Steel Straps TX30

NO CHANGES ARE TO BE MADE TO THIS DRAWING WITHOUT WRITTEN PERMISSION OF HARRIS KOCHER SMITH.

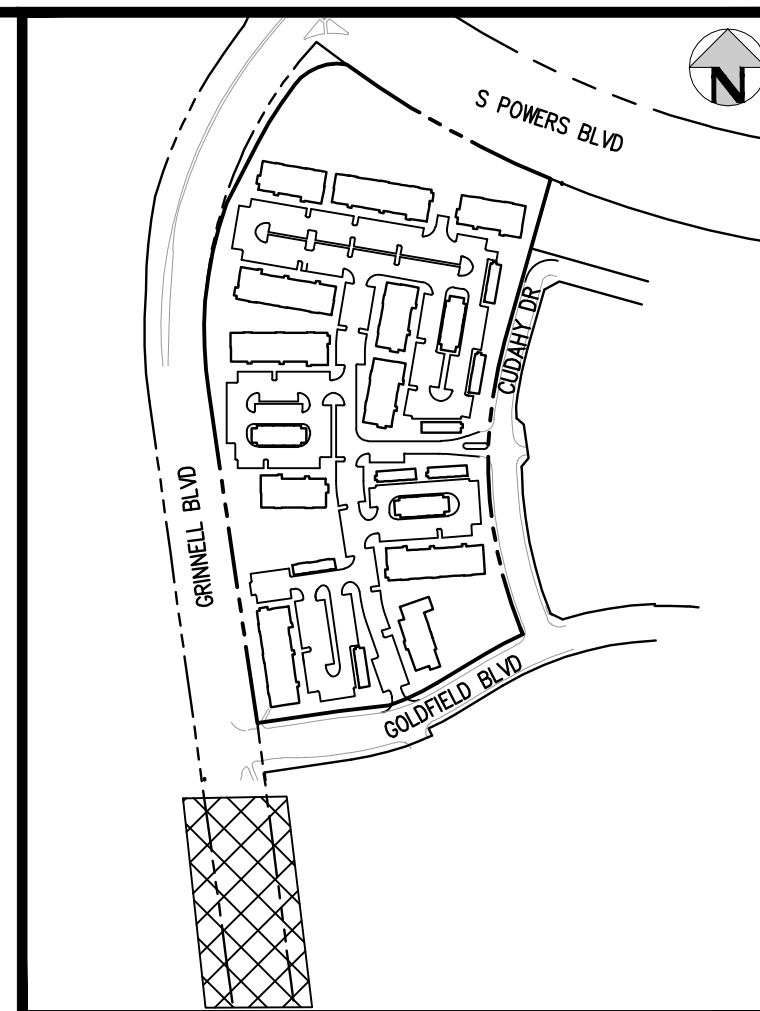

KEY MAP
SCALE: 1"=400'

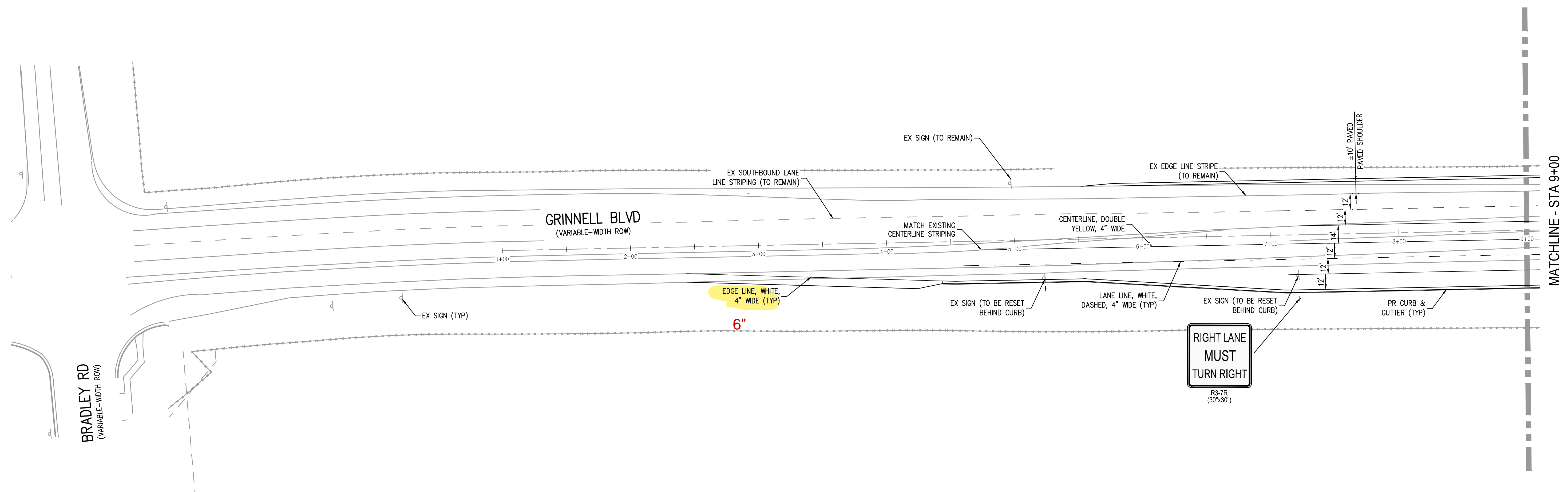
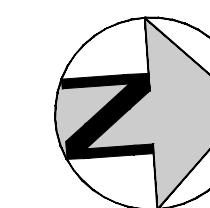

FILEPATH: J:\221206\ENGINEERING\ROADWAY\RW - SIGNAGE & STRIPING PLAN\DWG_LAYOUT.LAYOUT1
 PLOTTED: MON 05/08/23 4:45:07P BY: BEN LEECH



Know what's below.
Call before you dig.

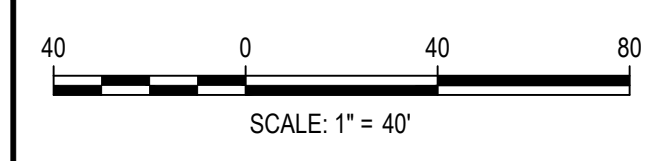

DESIGNED BY: MEK
 CHECKED BY: MEK
 DRAWN BY: BSL

| ISSUE DATE: 05-08-2023 | |
|------------------------|-------------------|
| DATE | REVISION COMMENTS |
| | |
| | |
| | |
| | |

HKS HARRIS KOCHER SMITH
 1120 Lincoln Street, Suite 1000
 Denver, Colorado 80203
 P: 303.623.6300 F: 303.623.6311
 HarrisKocherSmith.com

Evergreen
 Development | Services | Investments

OUTLOOK POWERS & GRINNELL
 SIGNAGE & STRIPING PLAN

PRELIMINARY
 NOT FOR
 CONSTRUCTION

| |
|-------------------|
| PROJECT #: 221206 |
| SHEET NUMBER |
| 27 |
| 27 OF 30 |

NO CHANGES ARE TO BE MADE TO THIS DRAWING WITHOUT WRITTEN PERMISSION OF HARRIS KOCHER SMITH.

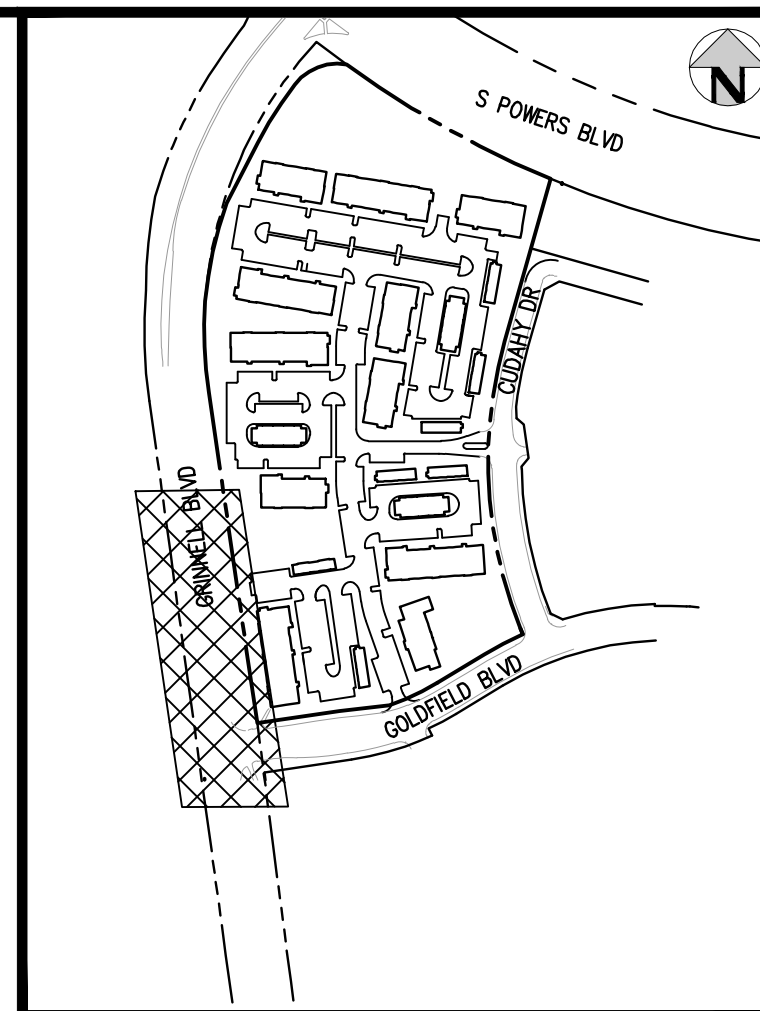

KEY MAP
SCALE: 1"=400'

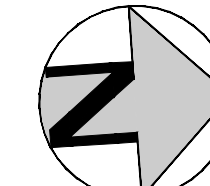
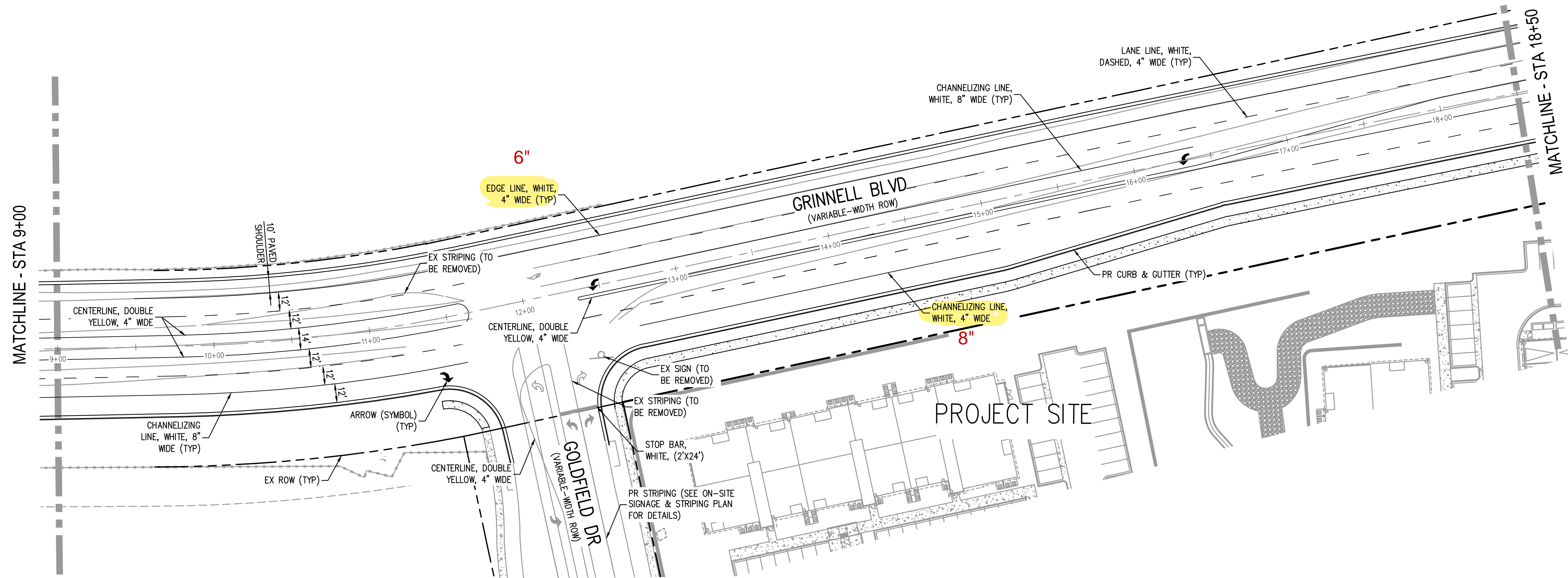

FILEPATH: J:\221206\ENGINEERING\ROADWAY\RW - SIGNAGE & STRIPING PLAN\DWG_LAYOUT.LAYOUT2
 PLOTTED: MON 05/08/23 4:45:58P BY: BEN LEECH



Know what's below.
Call before you dig.

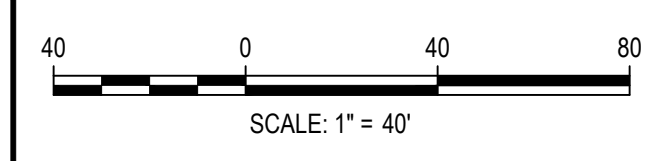

DESIGNED BY: MEK
 CHECKED BY: MEK
 DRAWN BY: BSL

| DATE | REVISION COMMENTS |
|------|-------------------|
| | |
| | |
| | |

HKS HARRIS KOCHER SMITH
 1120 Lincoln Street, Suite 1000
 Denver, Colorado 80203
 P: 303.623.6300 F: 303.623.6311
 HarrisKocherSmith.com

Evergreen
 Development | Services | Investments

OUTLOOK POWERS & GRINNELL
 SIGNAGE & STRIPING PLAN

PRELIMINARY
 NOT FOR
 CONSTRUCTION

| |
|-------------------|
| PROJECT #: 221206 |
| SHEET NUMBER |
| 28 |
| 28 OF 30 |

NO CHANGES ARE TO BE MADE TO THIS DRAWING WITHOUT WRITTEN PERMISSION OF HARRIS KOCHER SMITH.

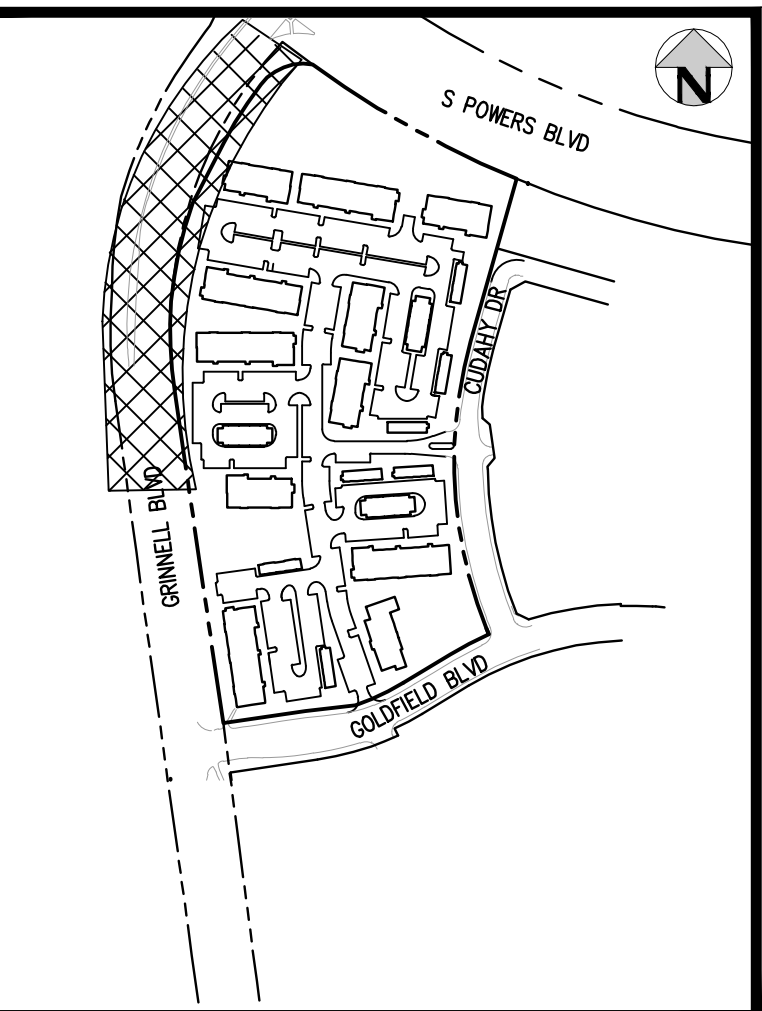

KEY MAP
SCALE: 1"=400'

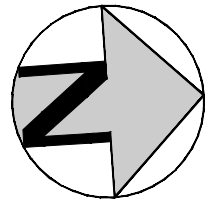
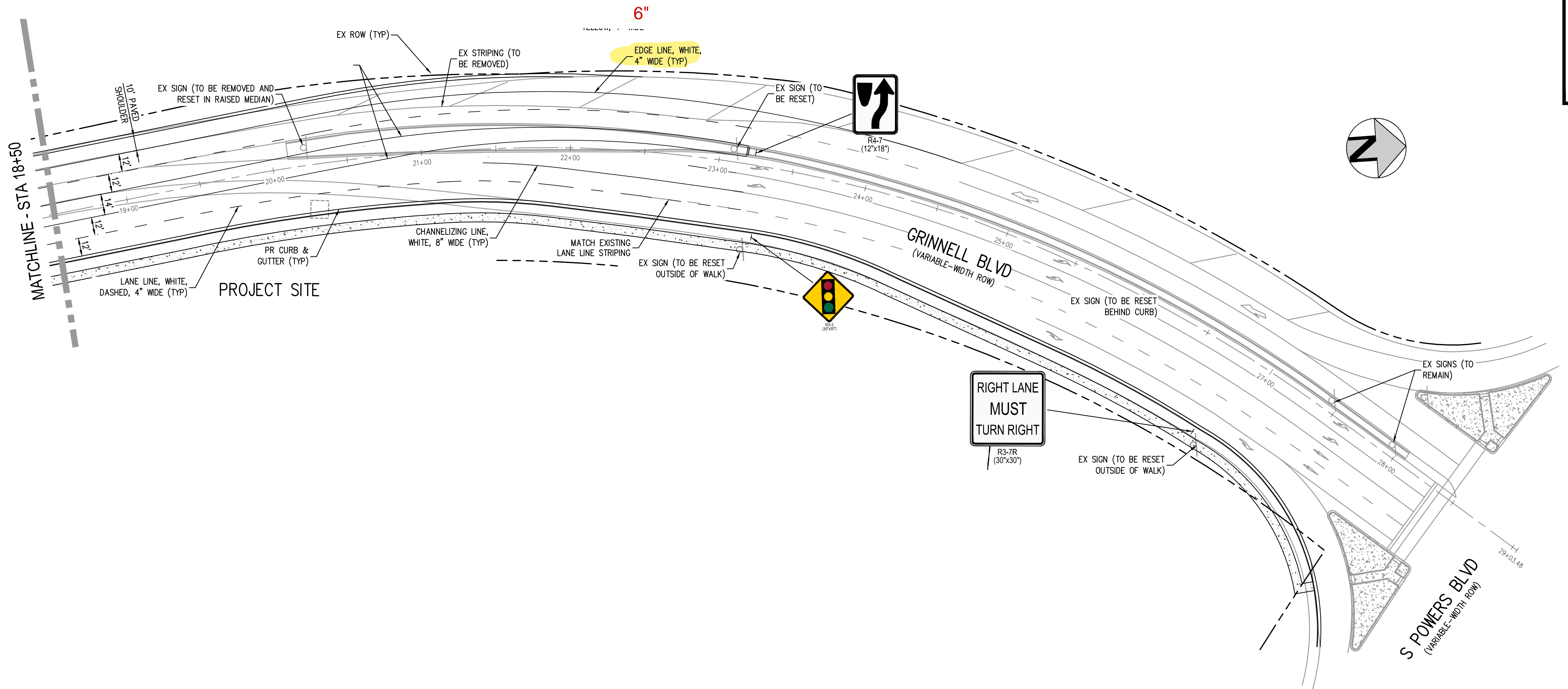

FILE PATH: J:\221206\ENGINEERING\ROADWAY\RW - SIGNAGE & STRIPING PLAN\DWG_LAYOUT\LAYOUT_LAYOUTS
 PLOTTED: MON 05/08/23 4:45:53 PM BY: BEN LEECH



Know what's below.
Call before you dig.

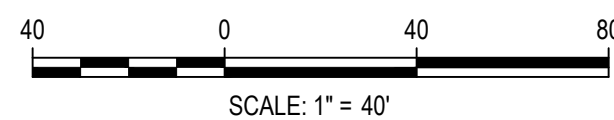

DESIGNED BY: MEK
 CHECKED BY: MEK
 DRAWN BY: BSL

ISSUE DATE: 05-08-2023

| DATE | REVISION COMMENTS |
|------|-------------------|
| | |
| | |
| | |
| | |

HKS HARRIS KOCHER SMITH
 1120 Lincoln Street, Suite 1000
 Denver, Colorado 80203
 P: 303.623.6300 F: 303.623.6311
 HarrisKocherSmith.com

Evergreen
 Development | Services | Investments

OUTLOOK POWERS & GRINNELL
 SIGNAGE & STRIPING PLAN

PRELIMINARY
 NOT FOR
 CONSTRUCTION

PROJECT #: 221206
 SHEET NUMBER

29

29 OF 30

NO CHANGES ARE TO BE MADE TO THIS DRAWING WITHOUT WRITTEN PERMISSION OF HARRIS KOCHER SMITH.

TRAFFIC SIGNAL LEGEND

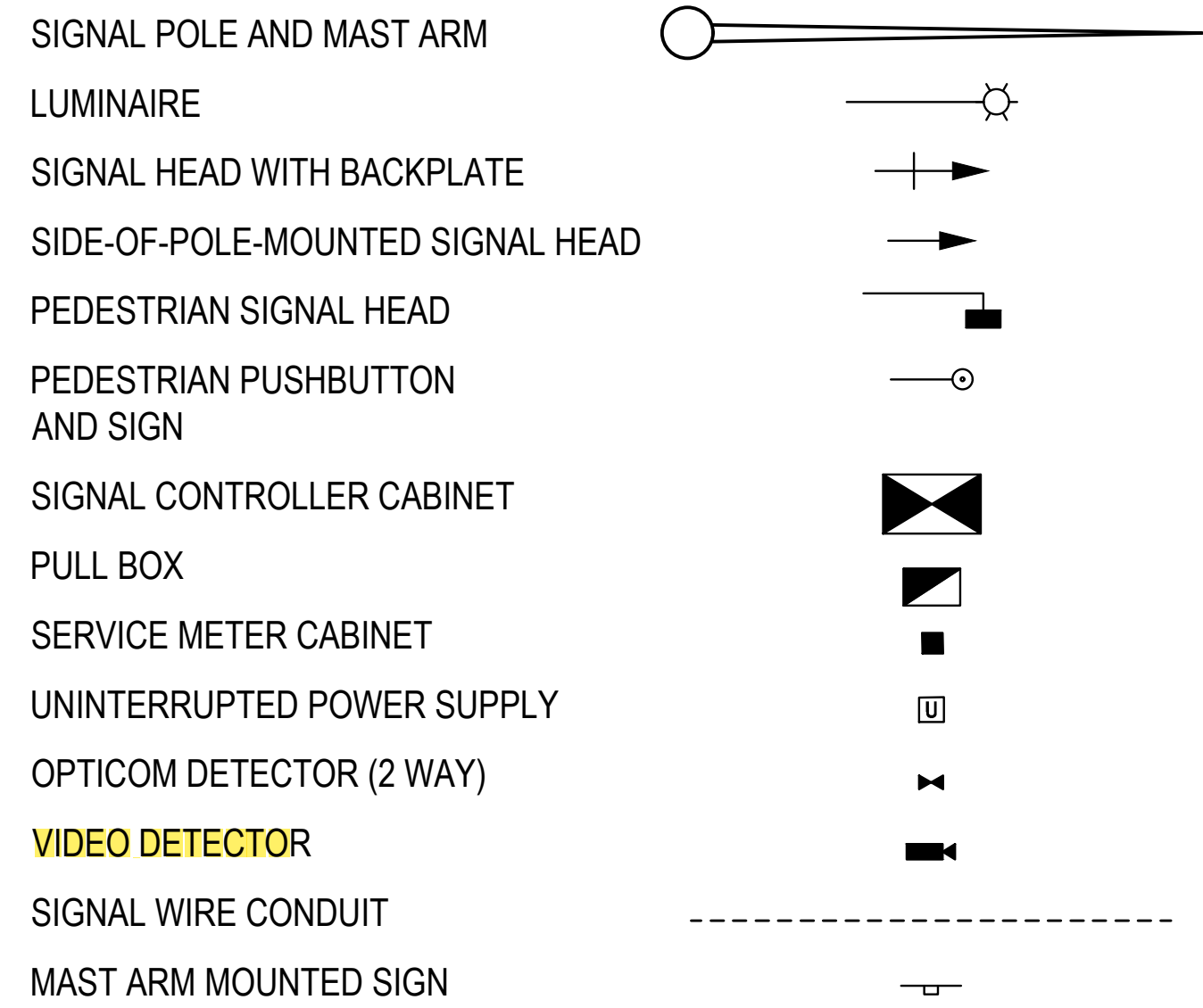

SIGNAL PHASING DIAGRAM

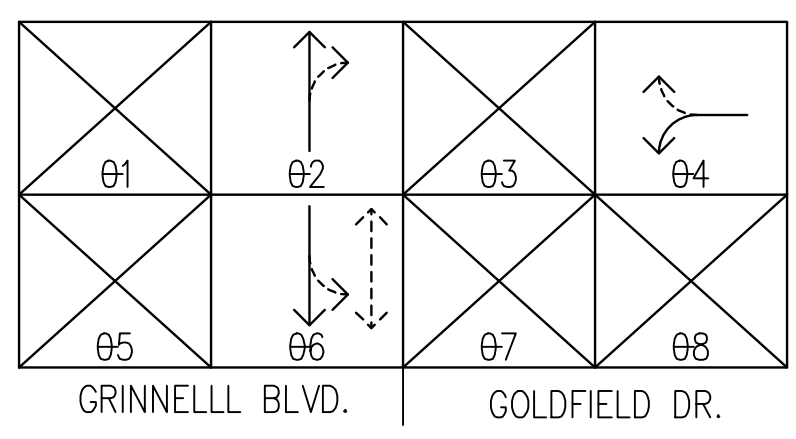

SIGNAL FACE DETAILS

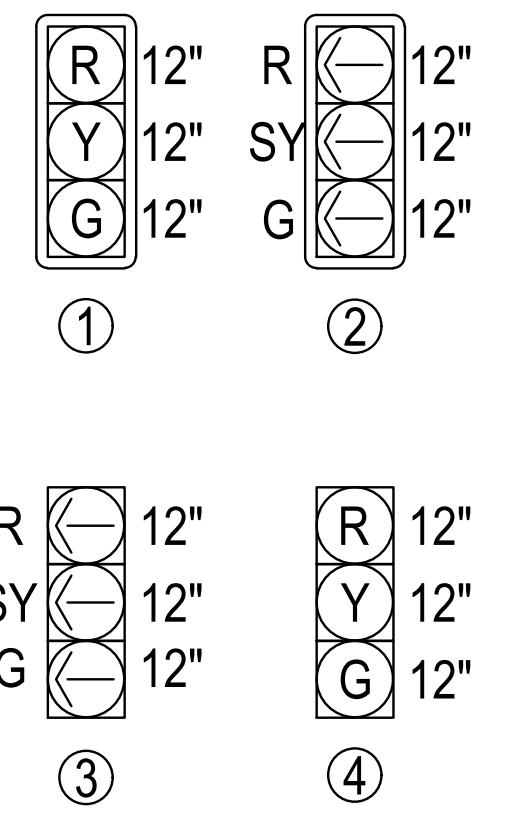

*ALL MAST ARM SIGNAL HEADS SHALL HAVE LOUVERED BACKPLATES.

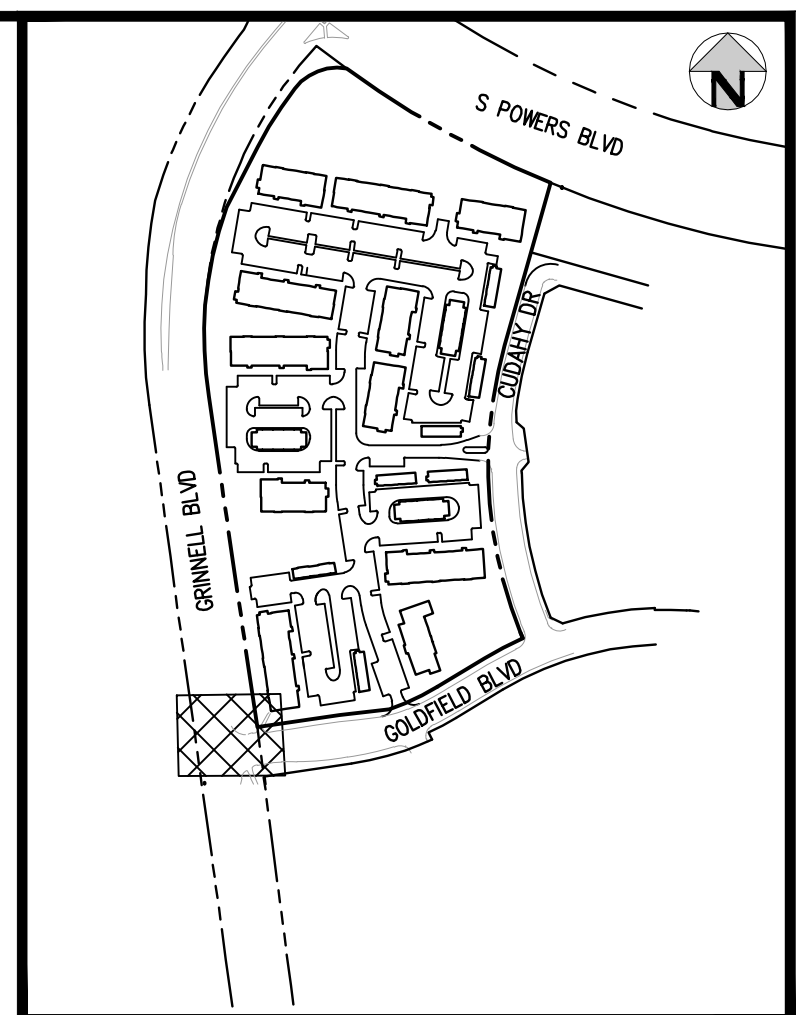
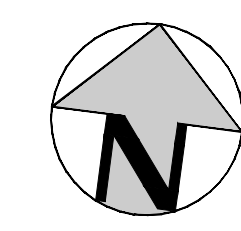
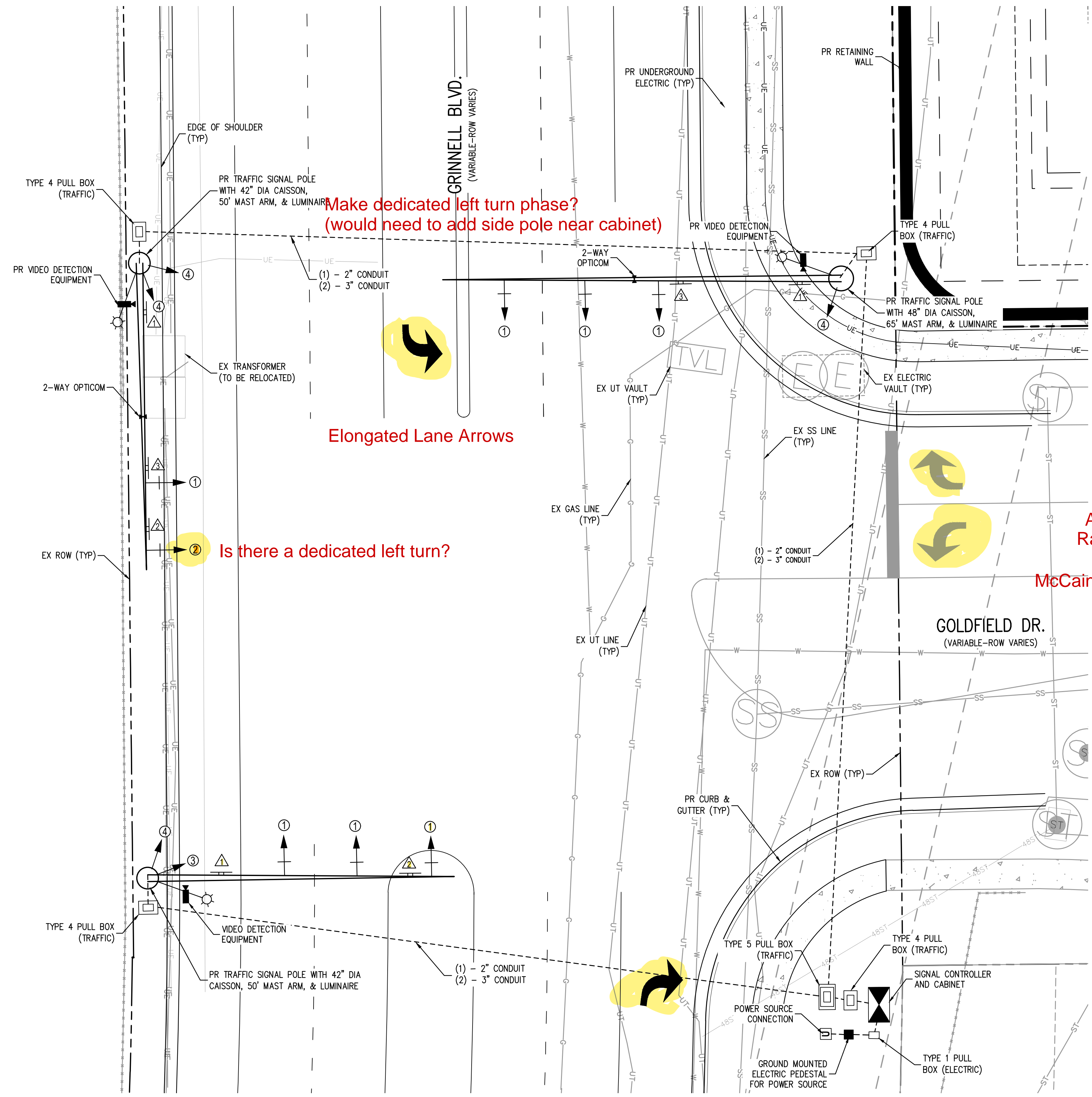

KEY MAP
SCALE: 1"=400'

SUMMARY OF QUANTITIES

| CDOT ITEM NO. | DESCRIPTION | UNIT | PLAN |
|---------------|---|------|-------|
| 503-00042 | DRILLED SHAFT (42 INCH) | LF | 33 |
| 503-00048 | DRILLED SHAFT (48 INCH) | LF | 20.50 |
| 613-00206 | 2 INCH ELECTRICAL CONDUIT (BORED) | LF | 350 |
| 613-00206 | 3 INCH ELECTRICAL CONDUIT (BORED) | LF | 750 |
| 613-07001 | CDOT TYPE ONE PULL BOX | EACH | 1 |
| 613-07004 | CDOT TYPE FOUR PULL BOX | EACH | 4 |
| 613-07005 | CDOT TYPE FIVE PULL BOX | EACH | 1 |
| 613-10000 | WIRING | LS | 1 |
| 613-13014 | LUMINAIRE (LED) (14,000 LUMENS) | EACH | 3 |
| 614-00011 | SIGN PANEL (CLASS I) | EACH | 7 |
| 614-10160 | SIGNAL HEAD BACKPLATES | EACH | 8 |
| 614-70336 | TRAFFIC SIGNAL FACE (12-12-12) | EACH | 13 |
| 614-72855 | TRAFFIC SIGNAL CONTROLLER CABINET | EACH | 1 |
| 614-72866 | FIRE PREEMPTION UNIT AND TIMER (TWO-WAY) | EACH | 2 |
| 614-72886 | INTERSECTION DETECTION SYSTEM (CAMERA) | EACH | 3 |
| 614-81150 | TRAFFIC SIGNAL-LIGHT POLE STEEL (1 - 50' MAST ARM) | EACH | 2 |
| 614-81165 | TRAFFIC SIGNAL-LIGHT POLE STEEL (1 - 65' MAST ARM) | EACH | 1 |
| 614-86232 | TRAFFIC SIGNAL CONTROLLER (SOLID STATE) (FULL-ACTUATED) (8 PHASE) | EACH | 1 |
| 614-87690 | ETHERNET SWITCH | EACH | 1 |
| 614-86800 | UNINTERRUPTED POWER SUPPLY | EACH | 1 |
| 626-00000 | MOBILIZATION | LS | 1 |
| 630-10005 | TRAFFIC CONTROL | LS | 1 |

MAST ARM MOUNTED SIGNS:

2' X ?



D3-1* (SPECIAL)
*STREET NAME SIGN SPECIFICATIONS TO BE PROVIDED BY EL PASO COUNTY.



R3-SR (30"x36")

3

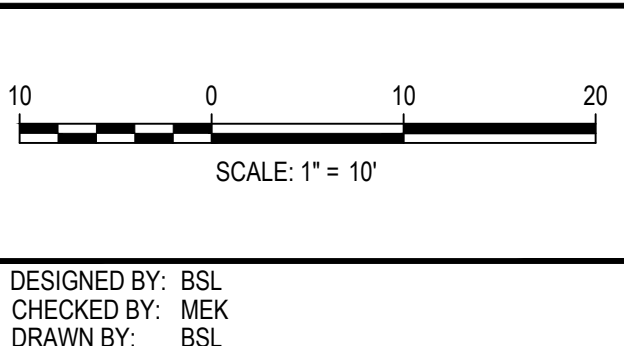

| DATE | REVISION COMMENTS |
|------|-------------------|
| | |
| | |
| | |

HKS HARRIS KOCHER SMITH
1120 Lincoln Street, Suite 1000
Denver, Colorado 80203
P: 303.623.6300 F: 303.623.6311
HarrisKocherSmith.com

Evergreen
Development | Services | Investments

OUTLOOK POWERS & GRINNELL
TRAFFIC SIGNAL PLAN

PRELIMINARY
NOT FOR
CONSTRUCTION

PROJECT #: 221206
SHEET NUMBER
30
30 OF 30