

Lot 3A NORTHCREST CENTER FILING NO. 1A SITE DEVELOPMENT PLAN EL PASO COUNTY, COLORADO.

BISMARK ROAD

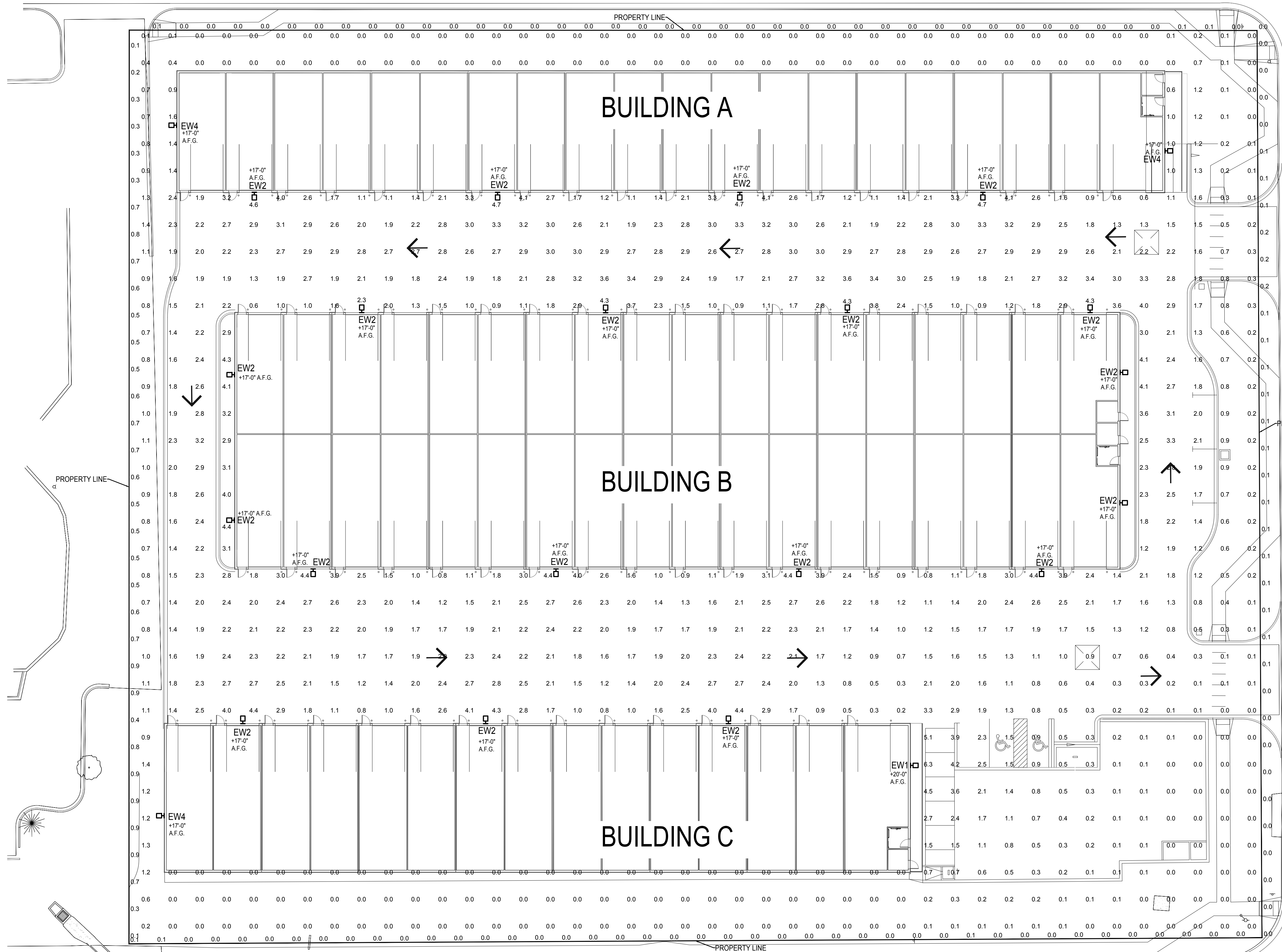

- GENERAL NOTES**
- VALUES SHOWN ARE MAINTAINED HORIZONTAL ILLUMINANCE VALUES MEASURED AT GRADE.
 - SITE LIGHTING DESIGN HAS BEEN COMPLETED TO PRODUCE EVEN ILLUMINATION OF PAVED AREAS WITH MINIMAL GLARE ONTO ADJACENT PROPERTIES.
 - ALL LIGHT FIXTURES SHALL BE FULLY SHIELDED AND DIRECT LIGHT DOWNWARDS. THERE WILL BE NO OFF-SITE GLARE ALLOWED.
 - ANY PROPOSED LIGHT FIXTURES INSTALLED ON PRIVATE PROPERTY, ADJACENT TO THE PUBLIC RIGHT OF WAY, SHALL BE ORIENTED IN SUCH A MANNER OR LIMITED IN LUMEN OUTPUT TO PREVENT GLARE PROBLEMS AND SHALL NOT EXCEED NATIONAL I.E.S. LIGHTING STANDARDS FOR 'DISABILITY GLARE'.
 - ALL EXTERIOR FIXTURES SHALL BE PHOTO CELL ON/OFF WITH INTEGRAL MOTION SENSOR.
 - EXTERIOR LIGHTING SHALL COMPLY WITH IECC, C405.2.7.3 LIGHTING SETBACK REQUIREMENTS.

STATISTICS

DESCRIPTION	AVG	MAX	MIN	MAX/MIN	AVG/MIN
SITE	1.4 FC	6.3 FC	0.0 FC	N/A	N/A
PROPERTY LINE	0.2 FC	0.9 FC	0.0 FC	N/A	N/A

LOT SIZE: 3.25 ACRES
CURRENT ZONING: CC

CANADA DRIVE



ELECTRICAL SITE PLAN
SCALE: 1" = 20'-0"

CONSTITUTION AVENUE



YOW ARCHITECTS PC
ARCHITECTURE & PLANNING
115 S. Weber Colorado Springs, Colorado 475-8133

Structural: ###
Electrical: ###
Mechanical: ###
Plumbing: ###

MyGarage @ Northcrest
2510 Canada Drive
COLORADO SPRINGS, CO 80915

Job No: 18-115
Directory: Planning
File: 24051 SDP
Drawn By: DBN
Date: 3/11/2024
Revised: Review Comments: 06-20-24

MEP PROJECT# 24051
DRAWN BY: BBC CHECKED BY: RCC
MEP ENGINEERING INC.
6402 S TROY CIRCLE, SUITE 100
CENTENNIAL, CO 80111
P (303) 936-1633 | MEP-ENG.COM

DRAWING NO.
E1
ELECTRICAL SITE
PHOTOMETRICS

Lot 3A NORTHCREST CENTER FILING NO. 1A SITE DEVELOPMENT PLAN EL PASO COUNTY, COLORADO.



YOW ARCHITECTS PC
ARCHITECTURE & PLANNING
115 S. Weber Colorado Springs, Colorado 475-8133

Structural: ###
Electrical: ###
Mechanical: ###
Plumbing: ###

MyGarage @ Northcrest
2510 Canada Drive
COLORADO SPRINGS, CO 80915

Job No. 18-115
Directory Planning
File 24051 SDP
Drawn By DBN
Date 3/11/2024
Revised
Review Comments 06-20-24

DRAWING NO.
E2
ELECTRICAL
SCHEDULES

LIGHTING FIXTURE SCHEDULE - EXTERIOR

LUMINAIRE										LAMPS				
ID	SYMBOL	MANUFACTURER	MODEL	CATALOG NUMBER	DESCRIPTION	DISTRIBUTION	VOLTAGE	DIMMING	MOUNTING	LAMP QTY	TYPE	WATTS	LUMENS	COLOR TEMP/CRI
EW1		LITHONIA	WDGE3	WDGE3LED-P4-30K-80CRI-RFT-MVOLT-SRM-E20WC-PIR1FC3V-DOBXD	WALL MOUNT FIXTURE WITH FORWARD THROW OPTIC IN BRONZE FINISH WITH INTEGRAL PHOTOCELL AND MOTION SENSOR AND 90 MINUTE BATTERY BACKUP	FORWARD THROW	120	0-10	WALL MOUNT AT 20'-0" AFG	1	LED	88	11295	3000K/80
EW2		LITHONIA	WDGE3	WDGE3LED-P1-30K-80CRI-R3-MVOLT-SRM-E20WC-PIR1FC3V-DOBXD	WALL MOUNT FIXTURE WITH TYPE III DISTRIBUTION IN BRONZE FINISH WITH INTEGRAL PHOTOCELL AND MOTION SENSOR AND 90 MINUTE BATTERY BACKUP	TYPE III	120	0-10V	WALL MOUNT AT 17'-0" AFG	1	LED	41	6071	3000K/80
EW4		LITHONIA	WDGE2	WDGE2LED-P2-30K-80CRI-T1S-MVOLT-SRM-E20WC-PIR1FC3V-DOBXD	WALL MOUNT FIXTURE WITH TYPE I DISTRIBUTION IN BRONZE FINISH WITH INTEGRAL PHOTOCELL AND MOTION SENSOR AND 90 MINUTE BATTERY BACKUP	TYPE I	120	0-10V	WALL MOUNT AT 17'-0" AFG	1	LED	19	1886	3000K/80



WDGE3 LED Architectural Wall Sconce



Specifications
Depth (D1): 8"
Depth (D2): 1.5"
Height: 9"
Width: 18"
Weight: 19.5 lbs (without options)

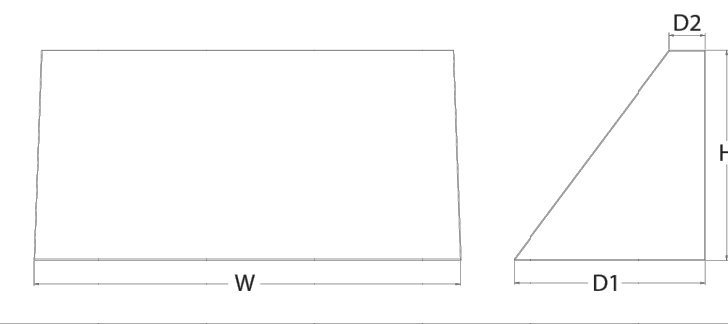

Catalog Number
Notes
Type

Introduction
The WDGE LED family is designed to meet specifier's every wall-mounted lighting need in a widely accepted shape that blends with any architecture. The clean rectilinear design comes in four sizes with lumen packages ranging from 1,200 to 25,000 lumens providing a true site-wide solution. Embedded with nLight® AIR wireless controls, the WDGE family provides additional energy savings and code compliance. WDGE3 has been designed to deliver up to 12,000 lumens through a precision refractive lens with wide distribution, perfect for augmenting the lighting from pole mounted luminaires.

WDGE LED Family Overview

Luminaire	Optics	Standard EM, 0°C	Cold EM, -20°C	Sensor	Approximate Lumens (4000K, 80CRI)						
					P0	P1	P2	P3	P4	P5	P6
WDGE1 LED	Visual Comfort	4W		--	750	1,200	2,000	--	--	--	--
WDGE2 LED	Visual Comfort	10W	18W	Standalone / nLight	--	1,200	2,000	3,000	4,500	6,000	--
WDGE2 LED	Precision Refractive	10W	18W	Standalone / nLight	700	1,200	2,000	3,200	4,200	--	--
WDGE3 LED	Precision Refractive	15W	18W	Standalone / nLight	6,000	7,500	8,500	10,000	12,000	--	--
WDGE4 LED	Precision Refractive			Standalone / nLight	--	12,000	16,000	18,000	20,000	22,000	25,000

Ordering Information

EXAMPLE: WDGE3 LED P3 40K 70CRI R3 MVOLT SRM DOBXD

Series	Package	Color Temperature	CRI	Distribution	Voltage	Mounting	Shipped included	Shipped separately
WDGE3 LED	P0	30K 3000K	70CRI	R2 Type 2	MVOLT	347'	SRM - surface mounting bracket	AWS 3/8inch Architectural wall spacer
	P1	40K 4000K	80CRI	R3 Type 3	480'	ICW	Indirect Canopy/Ceiling Washer bracket (dry/damp locations only)	PBBW Surface-mounted back box (top, left, right conduit entry). Use when there is no junction box available.
	P2	50K 5000K		R4 Type 4				
	P3			RFT Forward Throw				

TYPE EW1

Options	Finish
E15WH Emergency battery backup, Certified in CA Title 20 (MAGDS 152W, 53 min)	DOBXD Dark bronze
E20WC Emergency battery backup, Certified in CA Title 20 (MAGDS 18W, 20°C min)	DBLXD Black
PE Photocell, Button Type ²	DNAXD Natural aluminum
DMG 0-10V dimming wires pulled outside fixture (for use with an external control, ordered separately) ¹	DWHXD White
BCE Bottom conduit entry for back box (PBBW). Total of 4 entry points.	DSSXD Sandstone
SPD10KV 10KV Surge pack ³	DOBXTD Textured dark bronze
BAA Buy America(n) Act Compliant	DBLXTD Textured black
CCE Coastal Construction ⁴	DNATXD Textured natural aluminum
	DWHXTD Textured white
	DSSXTD Textured sandstone

Accessories

Accessories	Notes
WDGE3DOBXD WDGE3 Black Architectural Wall Spacer (specify finish)	1 347V and 480V not available with E15WH and E20WC.
WDGE3PBBW DOBXD U WDGE3 surface-mounted back box (specify finish)	2 Not qualified for DLC. Not available with emergency battery backup or sensors/controls
	3 PE not available in 480V and with sensors/controls.
	4 DMG option not available with sensors/controls.
	5 Not available with E20WC option.
	6 For PBBW and AWS require an RFA.
	7 Available with MVOLT only and only rated to 25C ambient.

LITHONIA LIGHTING COMMERCIAL OUTDOOR One Lithonia Way • Conyers, Georgia 30012 • Phone: 1-800-705-SERV (7378) • www.lithonia.com
© 2019-2024 Acuity Brands Lighting, Inc. All rights reserved. WDGE3 LED Rev. 03/27/24

Performance Data

Lumen Output

Lumen values are from photometric tests performed in accordance with IESNA LM-79-08. Data is considered to be representative of the configurations shown, within the tolerances allowed by Lighting Facts. Contact factory for performance data on any configurations not shown here.

Performance Package	System Watts	Dist. Type	30K (3000K, 70 CRI)				40K (4000K, 70 CRI)				50K (5000K, 70 CRI)			
			Lumens	LPW	B	U	Lumens	LPW	B	U	Lumens	LPW	B	U
P0	41W	R2	6,172	151	1	0	6,104	149	2	0	6,394	156	2	0
			6,071	148	1	0	6,004	146	1	0	6,290	153	1	0
			6,256	153	1	0	6,187	151	1	0	6,481	158	1	0
			6,126	149	1	0	6,058	148	1	0	6,347	155	1	0
P1	52W	R2	7,037	136	1	0	7,649	148	2	0	7,649	148	2	0
			6,922	134	1	0	7,524	145	1	0	7,524	145	1	0
			7,133	138	1	0	7,753	150	1	0	7,753	150	1	0
			6,985	135	1	0	7,592	147	1	0	7,592	147	1	0
P2	59W	R2	7,968	135	2	0	8,661	147	2	0	8,661	147	2	0
			7,838	133	1	0	8,519	144	1	0	8,519	144	1	0
			8,077	137	1	0	8,779	149	1	0	8,779	149	1	0
			7,909	134	1	0	8,597	146	2	0	8,597	146	2	0
P3	71W	R2	9,404	132	2	0	10,221	143	2	0	10,221	143	2	0
			9,250	130	2	0	10,054	141	2	0	10,054	141	2	0
			9,532	134	2	0	10,361	145	2	0	10,361	145	2	0
			9,334	131	2	0	10,146	142	2	0	10,146	142	2	0
P4	88W	R2	11,380	129	2	0	12,369	140	2	0	12,369	140	2	0
			11,194	127	2	0	12,167	138	2	0	12,167	138	2	0
			11,535	131	2	0	12,538	142	2	0	12,538	142	2	0
			11,295	128	2	0	12,277	139	2	0	12,277	139	2	0

Lumen Output in Emergency Mode (4000K, 70 CRI)

Option	Dist. Type	Lumens
E15WH	R2	3,185
	R3	3,133
	R4	3,229
	RFT	3,162
E20WC	R2	3,669
	R3	3,609
	R4	3,719
	RFT	3,642

Electrical Load

Performance Package	System Watts	Current (A)					
		120V	208V	240V	277V	480V	480V
P1	52W	0.437	0.246	0.213	0.186	0.150	0.110
P2	59W	0.498	0.287	0.251	0.220	0.175	0.126
P3	71W	0.598	0.344	0.300	0.262	0.210	0.152
P4	88W	0.727	0.424	0.373	0.333	0.260	0.190

Lumen Multiplier for 80CRI

CCT	Multiplier
30K	0.891
40K	0.906
50K	0.906

Lumen Ambient Temperature (LAT) Multipliers

Ambient	Lumen Multiplier	
0°C	32°F	1.05
10°C	50°F	1.03
20°C	68°F	1.01
25°C	77°F	1.00
30°C	86°F	0.99
40°C	104°F	0.97

Projected LED Lumen Maintenance

Data references the extrapolated performance projections for the platforms noted in a 25°C ambient, based on 10,000 hours of LED testing (tested per IESNA LM-80-08 and projected per IESNA TM-21-11). To calculate LMF, use the lumen maintenance factor that corresponds to the desired number of operating hours below. For other lumen maintenance values, contact factory.

Operating Hours	0	25,000	50,000	100,000
Lumen Maintenance Factor	1.0	>0.98	>0.97	>0.92

LITHONIA LIGHTING COMMERCIAL OUTDOOR One Lithonia Way • Conyers, Georgia 30012 • Phone: 1-800-705-SERV (7378) • www.lithonia.com
© 2019-2024 Acuity Brands Lighting, Inc. All rights reserved. WDGE3 LED Rev. 03/27/24

FIXTURE TYPES EW1, EW2 & EW3

MEP PROJECT # 24051
DRAWN BY: BBC CHECKED BY: RCC
MEP
ENGINEERING INC.
6402 S TROY CIRCLE, SUITE 100
CENTENNIAL, CO 80111
P (303) 936-1633 | MEP-ENG.COM

Lot 3A NORTHCREST CENTER FILING NO. 1A SITE DEVELOPMENT PLAN EL PASO COUNTY, COLORADO.



YOW ARCHITECTS PC
ARCHITECTURE & PLANNING
115 S. Weber Colorado Springs, Colorado 475-8133

MyGarage @ Northcrest
2510 Canada Drive
COLORADO SPRINGS, CO 80915

Structural: ###
Electrical: ###
Mechanical: ###
Plumbing: ###

Drawn By: DBN
Date: 3/11/2024
Review Comments: 06-29-24



Specifications

Depth (D1): 7"
Depth (D2): 1.5"
Height: 9"
Width: 11.5"
Weight: 13.5 lbs (without options)

WDGE2 LED

Architectural Wall Sconce
Precision Refractive Optic

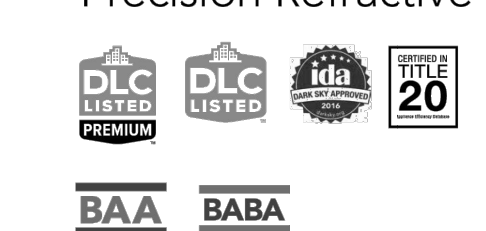
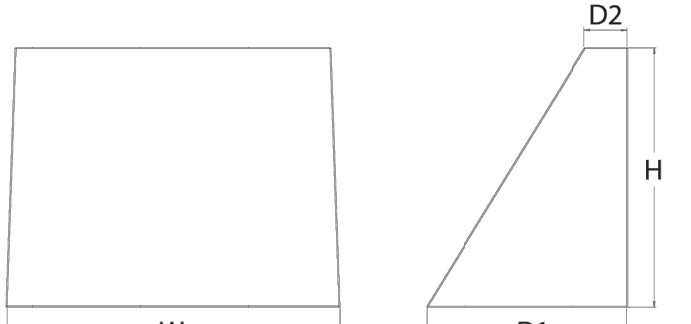
Catalog Number

Notes

Type

Hit the Tab key or mouse over the page to see all interactive elements.

Introduction

The WDGE LED family is designed to meet specifier's every wall-mounted lighting need in a widely accepted shape that blends with any architecture. The clean rectilinear design comes in four sizes with lumen packages ranging from 1,200 to 25,000 lumens, providing a true site-wide solution. Embedded with nLight® AIR wireless controls, the WDGE family provides additional energy savings and code compliance.

WDGE2 with industry leading precision refractive optics provides great uniform distribution and optical control. When combined with multiple integrated emergency battery backup options, including an 18W cold temperature option, the WDGE2 becomes the ideal wall-mounted lighting solution for pedestrian scale applications in any environment.

WDGE LED Family Overview

Luminaire	Optics	Standard EM, 0°C	Cold EM, -20°C	Sensor	Approximate Lumens (4000K, 80CRI)						
					P0	P1	P2	P3	P4	P5	P6
WDGE1 LED	Visual Comfort	4W	18W	Standalone / nLight	750	1,200	2,000	--	--	--	--
WDGE2 LED	Visual Comfort	10W	18W	Standalone / nLight	--	1,200	2,000	3,000	4,500	6,000	--
WDGE3 LED	Precision Refractive	10W	18W	Standalone / nLight	700	1,200	2,000	3,200	4,200	--	--
WDGE3 LED	Precision Refractive	15W	18W	Standalone / nLight	--	7,500	8,500	10,000	12,000	--	--
WDGE4 LED	Precision Refractive	--	--	Standalone / nLight	--	12,000	16,000	18,000	20,000	22,000	25,000

Ordering Information

EXAMPLE: WDGE2 LED P3 40K 80CRI T3M MVOLT SRM DDBXD

Series	Package	Color Temperature	CRI	Distribution	Voltage	Mounting
WDGE2 LED	P0¹ P1² P2³ P3² P4²	27K 2700K 30K 3000K 40K 4000K 50K 5000K AMB³ Amber	70CRI⁴ 80CRI LW³ Limited Wavelength	T1S Type I Short T2M Type II Medium T3M Type III Medium T4M Type IV Medium TF1M Forward Throw Medium	MVOLT¹ 347² 480²	Shipped included SRM Surface mounting bracket ICW Indirect Canopy/Ceiling Washer bracket (dry/damp locations only) Shipped separately AWS 3/8inch Architectural wall spacer PBBW 5 surface-mounted back box (top, left, right, conduit entry). Use when there is no junction box available.

Options

Options	Standalone Sensors/Controls	Networked Sensors/Controls	Finish
E10WH Emergency battery backup, Certified in CA Title 20 MAEDBS (10W, 5°C min)	PIR Bi-level (100/55%) motion sensor for 8-15' mounting heights. Intended for use on switched circuits with external dusk to dawn switching.	NLIAR2 PIR nLightAIR Wireless enabled bi-level motion/ambient sensor for 8-15' mounting heights.	DDBXD Dark bronze
E20WC Emergency battery backup, Certified in CA Title 20 MAEDBS (18W, -20°C min)	PIRH Bi-level (100/55%) motion sensor for 15-30' mounting heights. Intended for use on switched circuits with external dusk to dawn switching.	NLIAR2 PIRH nLightAIR Wireless enabled bi-level motion/ambient sensor for 15-30' mounting heights.	DBLXD Black
PE Photocell, Button Type	PIRHFCV Bi-level (100/55%) motion sensor for 8-15' mounting heights with photocell pre-programmed for dusk to dawn operation.	NLIAR2 PIRHFCV Bi-level (100/55%) motion sensor for 8-15' mounting heights with photocell pre-programmed for dusk to dawn operation.	DNAXD Natural aluminum
DMG² 0-10V dimming wires pulled outside fixture (for use with an external control, ordered separately)	PIRHFCV Bi-level (100/55%) motion sensor for 15-30' mounting heights with photocell pre-programmed for dusk to dawn operation.	NLIAR2 PIRHFCV Bi-level (100/55%) motion sensor for 15-30' mounting heights with photocell pre-programmed for dusk to dawn operation.	DWHXD White
BCE Bottom conduit entry for back box (PBBW), Total of 4 entry points.	PIRHFCV Bi-level (100/55%) motion sensor for 15-30' mounting heights with photocell pre-programmed for dusk to dawn operation.	NLIAR2 PIRHFCV Bi-level (100/55%) motion sensor for 15-30' mounting heights with photocell pre-programmed for dusk to dawn operation.	DSSXD Sandstone
BAA Buy America(®) Act Compliant	PIRHFCV Bi-level (100/55%) motion sensor for 15-30' mounting heights with photocell pre-programmed for dusk to dawn operation.	NLIAR2 PIRHFCV Bi-level (100/55%) motion sensor for 15-30' mounting heights with photocell pre-programmed for dusk to dawn operation.	DBRFXD Textured dark bronze
CCE Coastal Construction	PIRHFCV Bi-level (100/55%) motion sensor for 15-30' mounting heights with photocell pre-programmed for dusk to dawn operation.	NLIAR2 PIRHFCV Bi-level (100/55%) motion sensor for 15-30' mounting heights with photocell pre-programmed for dusk to dawn operation.	DBLFXD Textured black
	PIRHFCV Bi-level (100/55%) motion sensor for 15-30' mounting heights with photocell pre-programmed for dusk to dawn operation.	NLIAR2 PIRHFCV Bi-level (100/55%) motion sensor for 15-30' mounting heights with photocell pre-programmed for dusk to dawn operation.	DNATXD Textured natural aluminum
	PIRHFCV Bi-level (100/55%) motion sensor for 15-30' mounting heights with photocell pre-programmed for dusk to dawn operation.	NLIAR2 PIRHFCV Bi-level (100/55%) motion sensor for 15-30' mounting heights with photocell pre-programmed for dusk to dawn operation.	DWHGXD Textured white
	PIRHFCV Bi-level (100/55%) motion sensor for 15-30' mounting heights with photocell pre-programmed for dusk to dawn operation.	NLIAR2 PIRHFCV Bi-level (100/55%) motion sensor for 15-30' mounting heights with photocell pre-programmed for dusk to dawn operation.	DSSFXD Textured sandstone

Accessories

WDGEAWS DDBXD U WDGE 3/8inch Architectural Wall Spacer (specify finish)

WDGE2PBBW DDBXD U WDGE2 surface-mounted back box (specify finish)

Performance Data

Lumen Output

Lumen values are from photometric tests performed in accordance with IESNA LM-79-08. Data is considered to be representative of the configurations shown, within the tolerances allowed by Lighting Facts. Contact factory for performance data on any configurations not shown here.

Performance Package	System Watts	Dist. Type	27K (2700K, 80 CRI)				30K (3000K, 80 CRI)				40K (4000K, 80 CRI)				50K (5000K, 80 CRI)				Amber (Limited Wavelength)			
			Lumens	LPW	B	U	Lumens	LPW	B	U	Lumens	LPW	B	U	Lumens	LPW	B	U	Lumens	LPW	B	U
P0	7W	T1S	636	92	0	0	666	97	0	0	699	101	0	0	661	100	0	0	712	47	0	0
		T2M	662	96	0	0	693	101	0	0	728	106	0	0	719	104	0	0	741	48	0	0
		T3M	662	96	0	0	693	101	0	0	728	106	0	0	719	104	0	0	741	48	0	0
		TF1M	648	94	0	0	679	98	0	0	712	103	0	0	704	102	0	0	726	47	0	0
P1	11W	T1S	1,205	99	0	0	1,257	104	0	0	1,215	109	0	0	1,200	107	0	0	1,230	48	0	0
		T2M	1,150	103	0	0	1,204	108	0	0	1,264	113	0	0	1,249	112	0	0	1,279	49	0	0
		T3M	1,150	103	0	0	1,205	108	0	0	1,265	113	0	0	1,250	112	0	0	1,280	49	0	0
		TF1M	1,126	101	0	0	1,179	106	0	0	1,238	111	0	0	1,223	110	0	0	1,253	48	0	0
P2	19W	T1S	1,801	95	1	0	1,886	99	1	0	1,881	104	1	0	1,957	103	1	0	1,987	49	0	0
		T2M	1,875	99	1	0	1,963	103	1	0	1,961	109	1	0	1,203	107	1	0	1,233	49	0	0
		T3M	1,876	99	1	0	1,964	103	1	0	1,962	109	1	0	1,203	107	1	0	1,233	49	0	0
		TF1M	1,836	97	1	0	1,922	101	1	0	1,203	106	1	0	1,194	105	1	0	1,224	48	0	0
P3	32W	T1S	2,809	87	1	0	2,942	92	1	0	2,889	94	1	0	2,852	95	1	0	2,882	49	0	0
		T2M	2,924	91	1	0	3,062	95	1	0	3,215	100	1	0	3,176	99	1	0	3,206	49	0	0
		T3M	2,925	91	1	0	3,063	95	1	0	3,216	100	1	0	3,177	99	1	0	3,207	49	0	0
		TF1M	2,862	89	1	0	2,997	93	1	0	3,147	94	1	0	3,110	97	1	0	3,140	48	0	0
P4	47W	T1S	3,729	80	1	0	3,904	84	1	0	4,099	88	1	0	4,051	87	1	0	4,081	49	0	0
		T2M	3,881	83	1	0	4,063	87	1	0	4,267	91	1	0	4,216	90	1	0	4,246	49	0	0
		T3M	3,882	83	1	0	4,065	87	1	0	4,268	91	1	0	4,217	90	1	0	4,247	49	0	0
		TF1M	3,799	81	1	0	3,978	85	1	0	4,177	90	1	0	4,127	88	1	0	4,157	48	0	0

Performance Package	System Watts	Dist. Type	27K (2700K, 70 CRI)				30K (3000K, 70 CRI)				40K (4000K, 70 CRI)				50K (5000K, 70 CRI)			
			Lumens	LPW	B	U	Lumens	LPW	B	U	Lumens	LPW	B	U	Lumens	LPW	B	U
P0	7W	T3M	727	107	0	0	763	111	0	0	822	119	0	0	832	121	0	0
		T4M	721	105	0	0	746	108	0	0	804	117	0	0	814	118	0	0
P1	11W	T3M	1,280	115	0	0	1,325	119	0	0	1,427	128	0	0	1,445	129	0	0
		T4M	1,253	112	0	0	1,297	116	0	0	1,397	125	0	0	1,415	127	0	0
P2	19W	T3M	2,087	110	1	0	2,160	114	1	0	2,327	123	1	0	2,357	124	1	0
		T4M	2,042	108	1	0	2,114	111	1	0	2,278	120	1	0	2,306	121	1	0
P3	32W	T3M	3,254	101	1	0	3,369	105	1	0	3,629	113	1	0	3,645	114	1	0
		T4M	3,185	99	1	0	3,297	103	1	0	3,552	111	1	0	3,597	112	1	0
P4	47W	T3M	4,319	93	1	0	4,471	96	1	0	4,817	103	1	0	4,828	105	1	0
		T4M	4,227	91	1	0	4,376	94	1	0	4,714	101	1	0	4,724	102	1	0

Options

Options	Finish
E10WH Emergency battery backup, Certified in CA Title 20 MAEDBS (10W, 5°C min)	DDBXD Dark bronze
E20WC Emergency battery backup, Certified in CA Title 20 MAEDBS (18W, -20°C min)	DBLXD Black
PE Photocell, Button Type	DNAXD Natural aluminum
DMG² 0-10V dimming wires pulled outside fixture (for use with an external control, ordered separately)	DWHXD White
BCE Bottom conduit entry for back box (PBBW), Total of 4 entry points.	DSSXD Sandstone
BAA Buy America(®) Act Compliant	DBRFXD Textured dark bronze
CCE Coastal Construction	DBLFXD Textured black
	DNATXD Textured natural aluminum
	DWHGXD Textured white
	DSSFXD Textured sandstone

Notes

- P0 option not available with sensors/controls.
- P1-P4 not available with AMB and LW.
- AMB and LW always go together.
- 70CRI only available with T3M and T4M.
- 347V and 480V not available with E10WH or E20WC.
- Not qualified for DLC. Not available with emergency battery backup or sensors/controls.
- PE not available in 480V or with sensors/controls.
- DMG option not available with sensors/controls.

Accessories

WDGEAWS DDBXD U WDGE 3/8inch Architectural Wall Spacer (specify finish)

WDGE2PBBW DDBXD U WDGE2 surface-mounted back box (specify finish)

Performance Data

Lumen Output

Lumen values are from photometric tests performed in accordance with IESNA LM-79-08. Data is considered to be representative of the configurations shown, within the tolerances allowed by Lighting Facts. Contact factory for performance data on any configurations not shown here.

Performance Package	System Watts	Dist. Type	27K (2700K, 80 CRI)				30K (3000K, 80 CRI)				40K (4000K, 80 CRI)				50K (5000K, 80 CRI)				Amber (Limited Wavelength)			
			Lumens	LPW	B	U	Lumens	LPW	B	U	Lumens	LPW	B	U	Lumens	LPW	B	U	Lumens	LPW	B	U
P0	7W	T1S	636	92	0	0	666	97	0	0	699	101	0	0	661	100	0	0	712	47	0	0
		T2M	662	96	0	0	693	101	0	0	728	106	0	0	719	104	0	0	741	48	0	0
		T3M	662	96	0	0	693	101	0	0	728	106	0	0	719	104	0	0	741	48	0	0
		TF1M	648	94	0	0	679	98	0	0	712	103	0	0	704	102	0	0	726	47	0	0
P1	11W	T1S	1,205	99	0	0	1,257	104	0	0	1,215	109	0	0	1,200	107	0	0	1,230	48	0	0
		T2M	1,150	103	0	0	1,204	108	0	0	1,264	113	0	0	1,249	112	0	0	1,279	49	0	0
		T3M	1,150	103	0	0	1,205	108	0	0	1,265	113	0	0	1,250	112	0	0	1,280	49	0	0
		TF1M	1,126	101	0	0	1,179	106	0	0	1,238	111	0	0	1,223	110	0	0	1,253	48	0	0
P2	19W	T1S	1,801	95	1	0	1,886	99	1	0	1,881	104	1	0	1,957	103	1	0				

Lot 3A NORTHCREST CENTER
FILING NO. 1A
SITE DEVELOPMENT PLAN
EL PASO COUNTY, COLORADO.

YOW

YOW ARCHITECTS PC

ARCHITECTURE & PLANNING

115 S. Weber Colorado Springs, Colorado 475-8133

Structural: ###
Electrical: ###
Mechanical: ###
Plumbing: ###

MyGarage @ Northcrest

2510 Canada Drive
COLORADO SPRINGS, CO 80915

Job No: 18-115
Directory: Planning
File: 24051 SDP
Drawn By: DBN
Date: 3/11/2024
Revised:
Review Comments: 06-20-24

DRAWING NO.

E4

LIGHTING
CUTSHEETS

MEP PROJECT # 24051
DRAWN BY: BBC CHECKED BY: RCC
MEP
ENGINEERING INC.
6402 S TROY CIRCLE, SUITE 100
CENTENNIAL, CO 80111
P (303) 936-1633 | MEP-ENG.COM