

# Lot 3A NORTHCREST CENTER FILING NO. 1A SITE DEVELOPMENT PLAN EL PASO COUNTY, COLORADO.

BISMARK ROAD

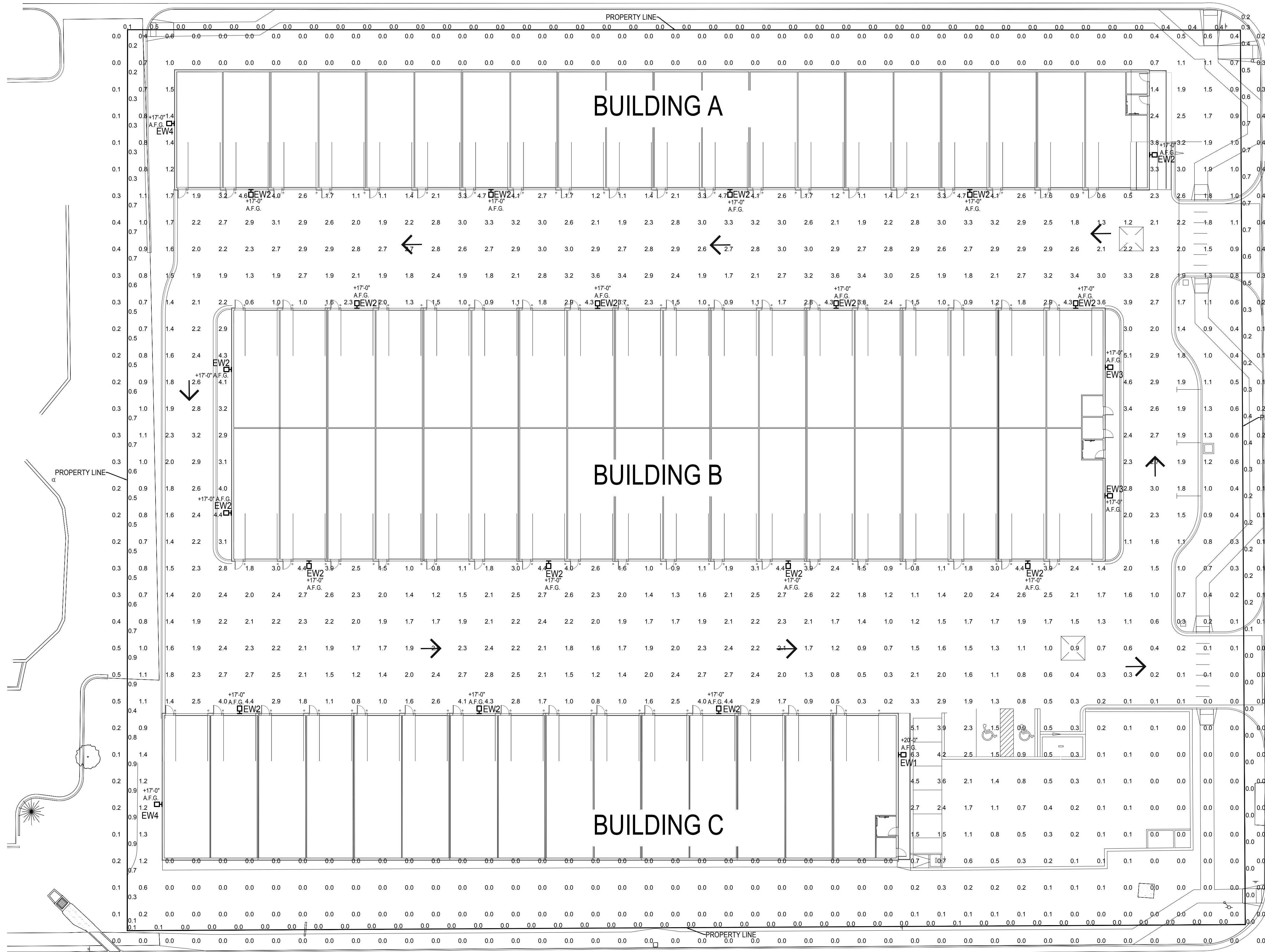

- ### GENERAL NOTES
- VALUES SHOWN ARE MAINTAINED HORIZONTAL ILLUMINANCE VALUES MEASURED AT GRADE.
  - SITE LIGHTING DESIGN HAS BEEN COMPLETED TO PRODUCE EVEN ILLUMINATION OF PAVED AREAS WITH MINIMAL GLARE ONTO ADJACENT PROPERTIES.
  - ALL LIGHT FIXTURES SHALL BE FULLY SHIELDED AND DIRECT LIGHT DOWNWARDS. THERE WILL BE NO OFF-SITE GLARE ALLOWED.
  - ANY PROPOSED LIGHT FIXTURES INSTALLED ON PRIVATE PROPERTY, ADJACENT TO THE PUBLIC RIGHT OF WAY, SHALL BE ORIENTED IN SUCH A MANNER OR LIMITED IN LUMEN OUTPUT TO PREVENT GLARE PROBLEMS AND SHALL NOT EXCEED NATIONAL I.E.S. LIGHTING STANDARDS FOR 'DISABILITY GLARE'.
  - ALL EXTERIOR FIXTURES SHALL BE PHOTO CELL ON/OFF WITH INTEGRAL MOTION SENSOR.
  - EXTERIOR LIGHTING SHALL COMPLY WITH IECC, C405.2.7.3 LIGHTING SETBACK REQUIREMENTS.

DESCRIPTION	AVG	MAX	MIN	MAX/MIN	AVG/MIN
SITE	1.3 FC	6.3 FC	0.0 FC	N/A	N/A
PROPERTY LINE	0.2 FC	0.9 FC	0.0 FC	N/A	N/A

CANADA DRIVE



**YOW ARCHITECTS PC**  
 ARCHITECTURE & PLANNING  
 115 S. Weber Colorado Springs, Colorado 475-8133

Structural: ###  
 Electrical: ###  
 Mechanical: ###  
 Plumbing: ###

**MyGarage @ Northcrest**  
 2510 Canada Drive  
 COLORADO SPRINGS, CO 80915

Job No: 18-115  
 Directory: Planning  
 File: 24051 SDP  
 Drawn By: DBN  
 Date: 3/11/2024  
 Revised:

DRAWING NO:  
**E1**  
 ELECTRICAL SITE  
 PHOTOMETRICS

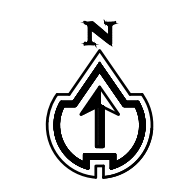

**ELECTRICAL SITE PLAN**  
SCALE: 1" = 20'-0"

CONSTITUTION AVENUE

MEP PROJECT# 24051  
 DRAWN BY: BBC CHECKED BY: RCC  
  
**MEP ENGINEERING INC.**  
 6402 S TROY CIRCLE, SUITE 100  
 CENTENNIAL, CO 80111  
 P (303) 936-1633 | MEP-ENG.COM



# Lot 3A NORTHCREST CENTER FILING NO. 1A SITE DEVELOPMENT PLAN EL PASO COUNTY, COLORADO.

**YOW**

YOW ARCHITECTS PC  
ARCHITECTURE & PLANNING  
115 S. Weber Colorado Springs, Colorado 475-8133

Structural: ###  
Electrical: ###  
Mechanical: ###  
Plumbing: ###

MyGarage @ Northcrest  
2510 Canada Drive  
COLORADO SPRINGS, CO 80915





Site No. 18-115  
Directory Planning  
File 24051 SDP  
Drawn By DBN  
Date 3/11/2024  
Revised



DRAWING NO.  
**E3**  
LIGHTING  
CUTSHEETS



## WDGE2 LED

### Architectural Wall Sconce Precision Refractive Optic

**Specifications**

**Depth (D1):** 7"

**Depth (D2):** 1.5"

**Height:** 9"

**Width:** 11.5"

**Weight:** 13.5 lbs (without options)

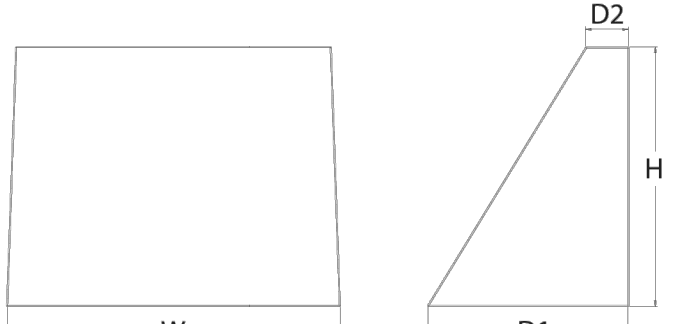

**Catalog Number**

---

**Notes**

---

**Type**

---

Hit the Tab key or mouse over the page to see all interactive elements.

**Introduction**

The WDGE LED family is designed to meet specifier's every wall-mounted lighting need in a widely accepted shape that blends with any architecture. The clean rectilinear design comes in four sizes with lumen packages ranging from 1,200 to 25,000 lumens, providing a true site-wide solution. Embedded with nLight® AIR wireless controls, the WDGE family provides additional energy savings and code compliance.

WDGE2 with industry leading precision refractive optics provides great uniform distribution and optical control. When combined with multiple integrated emergency battery backup options, including an 18W cold temperature option, the WDGE2 becomes the ideal wall-mounted lighting solution for pedestrian scale applications in any environment.

### WDGE LED Family Overview

Luminaire	Optics	Standard EM, 0°C	Cold EM, -20°C	Sensor	Approximate Lumens (4000K, 80CRI)						
					P0	P1	P2	P3	P4	P5	P6
WDGE1 LED	Visual Comfort	4W		--	750	1,200	2,000	--	--	--	--
WDGE2 LED	Visual Comfort	10W	18W	Standalone / nLight	--	1,200	2,000	3,000	4,500	6,000	--
WDGE2 LED	Precision Refractive	10W	18W	Standalone / nLight	700	1,200	2,000	3,200	4,200	--	--
WDGE3 LED	Precision Refractive	15W	18W	Standalone / nLight	--	7,500	8,500	10,000	12,000	--	--
WDGE4 LED	Precision Refractive			Standalone / nLight	--	12,000	16,000	18,000	20,000	22,000	25,000

### Accessories

Order and ship separately

WDGEAWS DDBX-U WDGE 3/8inch Architectural Wall Spacer (specify finish)

WDGE2PBBW DDBX-U WDGE2 surface-mounted back box (specify finish)

### Performance Data

**Lumen Output**

Lumen values are from photometric tests performed in accordance with IESNA LM-79-08. Data is considered to be representative of the configurations shown, within the tolerances allowed by Lighting Facts. Contact factory for performance data on any configurations not shown here.

Performance Package	System Watts	Dist. Type	27K (2700K, 80 CRI)				30K (3000K, 80 CRI)				40K (4000K, 80 CRI)				50K (5000K, 80 CRI)				Amber (Limited Wavelength)								
			Lumens	LPW	B	U	G	Lumens	LPW	B	U	G	Lumens	LPW	B	U	G	Lumens	LPW	B	U	G	Lumens	LPW	B	U	G
P0	7W	T1S	636	92	0	0	0	666	97	0	0	0	699	101	0	0	1	691	100	0	0	1	712	47	0	0	1
		T2M	662	96	0	0	0	693	101	0	0	0	728	106	0	0	0	719	104	0	0	0	741	48	0	0	0
		T3M	662	96	0	0	0	693	101	0	0	0	728	106	0	0	0	719	104	0	0	0	741	48	0	0	0
		T4M	648	94	0	0	0	679	98	0	0	0	712	103	0	0	0	704	102	0	0	0	726	47	0	0	0
P1	11W	T1S	652	95	0	0	0	683	99	0	0	0	717	104	0	0	0	708	103	0	0	0	730	48	0	0	1
		T2M	1,150	103	0	0	1	1,204	108	0	0	1	1,264	113	0	0	1	1,249	112	0	0	1					
		T3M	1,150	103	0	0	1	1,205	108	0	0	1	1,265	113	0	0	1	1,250	112	0	0	1					
		T4M	1,126	101	0	0	1	1,179	106	0	0	1	1,238	111	0	0	1	1,223	110	0	0	1					
P2	19W	T1S	1,801	95	1	0	1	1,886	99	1	0	1	1,981	104	1	0	1	1,957	103	1	0	1					
		T2M	1,875	99	1	0	1	1,963	103	1	0	1	2,061	109	1	0	1	2,037	107	1	0	1					
		T3M	1,876	99	1	0	1	1,964	103	1	0	1	2,062	109	1	0	1	2,038	107	1	0	1					
		T4M	1,836	97	1	0	1	1,922	101	1	0	1	2,018	106	1	0	1	1,994	105	1	0	1					
P3	32W	T1S	2,809	87	1	0	1	2,942	92	1	0	1	3,099	96	1	0	1	3,052	95	1	0	1					
		T2M	2,924	91	1	0	1	3,062	95	1	0	1	3,235	100	1	0	1	3,176	99	1	0	1					
		T3M	2,925	91	1	0	1	3,063	95	1	0	1	3,236	100	1	0	1	3,177	99	1	0	1					
		T4M	2,862	89	1	0	1	2,997	93	1	0	1	3,147	98	1	0	1	3,110	97	1	0	1					
P4	47W	T1S	2,880	90	1	0	1	3,015	94	1	0	1	3,166	99	1	0	1	3,128	97	1	0	1					
		T2M	3,279	80	1	0	1	3,404	84	1	0	1	4,099	88	1	0	1	4,051	87	1	0	1					
		T3M	3,881	83	1	0	1	4,063	87	1	0	1	4,267	91	1	0	1	4,216	90	1	0	1					
		T4M	3,882	83	1	0	1	4,065	87	1	0	1	4,268	91	1	0	1	4,217	90	1	0	1					

### Ordering Information

**EXAMPLE: WDGE2 LED P3 40K 80CRI T3M MVOLT SRM DDBXD**

Series	Package	Color Temperature	CRI	Distribution	Voltage	Mounting	Shipped included		Shipped separately	
WDGE2 LED	P0 <sup>1</sup>	27K 2700K	70CRI <sup>4</sup>	T1S Type I Short	MVOLT		SRM	Surface mounting bracket	AWS	3/8inch Architectural wall spacer
	P1 <sup>2</sup>	30K 3000K	80CRI	T2M Type II Medium	347 <sup>5</sup>		ICW	Indirect Canopy/Ceiling Washer bracket (dry/damp locations only) <sup>6</sup>	PBBW	Surface-mounted back box (top, left, right conduit entry). Use when there is no junction box available
	P2 <sup>2</sup>	40K 4000K	LWP Limited Wavelength	T3M Type III Medium	480 <sup>5</sup>					
	P3 <sup>2</sup>	50K 5000K		T4M Type IV Medium						
P4 <sup>2</sup>	AMB <sup>3</sup> Amber			TFTM Forward Throw Medium						

### Options

Options	Standalone Sensors/Controls	Finish
E10WH Emergency battery backup, Certified in CA Title 20 MAEDBS (10W, 5°C min)	PIR Bi-level (100/55%) motion sensor for 8-15' mounting heights. Intended for use on switched circuits with external dusk to dawn switching.	DDBXD Dark bronze
E20WC Emergency battery backup, Certified in CA Title 20 MAEDBS (18W, -20°C min)	PIRH Bi-level (100/55%) motion sensor for 15-30' mounting heights. Intended for use on switched circuits with external dusk to dawn switching.	DBLXD Black
PE <sup>7</sup> Photocell, Button Type	PIRHFCV Bi-level (100/55%) motion sensor for 8-15' mounting heights with photocell pre-programmed for dusk to dawn operation.	DNAXD Natural aluminum
DMG <sup>8</sup> 0-10V dimming wires pulled outside fixture (for use with an external control, ordered separately)	PIRHFCV Bi-level (100/55%) motion sensor for 15-30' mounting heights with photocell pre-programmed for dusk to dawn operation.	DWHXD White
BCE Bottom conduit entry for back box (PBBW), Total of 4 entry points.	PIRHFCV Bi-level (100/55%) motion sensor for 15-30' mounting heights with photocell pre-programmed for dusk to dawn operation.	DSSXD Sandstone
BAA Buy America(r) Act Compliant	Networked Sensors/Controls	DOBXD Textured dark bronze
CCE Coastal Construction	NLIAR2 PIR nLightAIR Wireless enabled bi-level motion/ambient sensor for 8-15' mounting heights.	DBLXD Textured black
	NLIAR2 PIRH nLightAIR Wireless enabled bi-level motion/ambient sensor for 15-30' mounting heights.	DNAXD Textured natural aluminum
	See page 4 for out of box functionality	DWHGXD Textured white
		DSSTXD Textured sandstone



COMMERCIAL OUTDOOR One Lithonia Way • Conyers, Georgia 30012 • Phone: 1-800-705-SERV (7378) • www.lithonia.com  
© 2019-2024 Acuity Brands Lighting, Inc. All rights reserved.



COMMERCIAL OUTDOOR One Lithonia Way • Conyers, Georgia 30012 • Phone: 1-800-705-SERV (7378) • www.lithonia.com  
© 2019-2024 Acuity Brands Lighting, Inc. All rights reserved.

**FIXTURE TYPE EW4**



COMMERCIAL OUTDOOR One Lithonia Way • Conyers, Georgia 30012 • Phone: 1-800-705-SERV (7378) • www.lithonia.com  
© 2019-2024 Acuity Brands Lighting, Inc. All rights reserved.



COMMERCIAL OUTDOOR One Lithonia Way • Conyers, Georgia 30012 • Phone: 1-800-705-SERV (7378) • www.lithonia.com  
© 2019-2024 Acuity Brands Lighting, Inc. All rights reserved.

**MEP ENGINEERING INC.**  
6402 S TROY CIRCLE, SUITE 100  
CENTENNIAL, CO 80111  
P (303) 936-1633 | MEP-ENG.COM