

# HOMESTEAD NORTH AT STERLING RANCH

## COUNTY OF EL PASO, STATE OF COLORADO EARLY GRADING AND EROSION CONTROL PLANS JANUARY, 2022

PCD FILING NO.: SP-20-008

### GRADING AND EROSION CONTROL STANDARD NOTES

1. STORMWATER DISCHARGES FROM CONSTRUCTION SITES SHALL NOT CAUSE OR THREATEN TO CAUSE POLLUTION, CONTAMINATION, OR DEGRADATION OF STATE WATERS. ALL WORK AND EARTH DISTURBANCE SHALL BE DONE IN A MANNER THAT MINIMIZES POLLUTION OF ANY ON-SITE OR OFF-SITE WATERS, INCLUDING WETLANDS.
2. NOTWITHSTANDING ANYTHING DEPICTED IN THESE PLANS IN WORDS OR GRAPHIC REPRESENTATION, ALL DESIGN AND CONSTRUCTION RELATED TO ROADS, STORM DRAINAGE AND EROSION CONTROL SHALL CONFORM TO THE STANDARDS AND REQUIREMENTS OF THE MOST RECENT VERSION OF THE RELEVANT ADOPTED EL PASO COUNTY STANDARDS, INCLUDING THE LAND DEVELOPMENT CODE, THE ENGINEERING CRITERIA MANUAL, THE DRAINAGE CRITERIA MANUAL, AND THE DRAINAGE CRITERIA MANUAL VOLUME 2. ANY DEVIATIONS FROM REGULATIONS AND STANDARDS MUST BE REQUESTED, AND APPROVED, IN WRITING.
3. A SEPARATE STORMWATER MANAGEMENT PLAN (SMWP) FOR THIS PROJECT SHALL BE COMPLETED AND AN EROSION AND STORMWATER QUALITY CONTROL PERMIT (ESQCP) ISSUED PRIOR TO COMMENCING CONSTRUCTION. MANAGEMENT OF THE SWMP DURING CONSTRUCTION IS THE RESPONSIBILITY OF THE DESIGNATED QUALIFIED STORMWATER MANAGER OR CERTIFIED EROSION CONTROL INSPECTOR. THE SWMP SHALL BE LOCATED ON SITE AT ALL TIMES DURING CONSTRUCTION AND SHALL BE KEPT UP TO DATE WITH WORK PROGRESS AND CHANGES IN THE FIELD.
4. ONCE THE ESQCP IS APPROVED AND A "NOTICE TO PROCEED" HAS BEEN ISSUED, THE CONTRACTOR MAY INSTALL THE INITIAL STAGE EROSION AND SEDIMENT CONTROL MEASURES AS INDICATED ON THE APPROVED GEC. A PRECONSTRUCTION MEETING BETWEEN THE CONTRACTOR, ENGINEER, AND EL PASO COUNTY WILL BE HELD PRIOR TO ANY CONSTRUCTION. IT IS THE RESPONSIBILITY OF THE APPLICANT TO COORDINATE THE MEETING TIME AND PLACE WITH COUNTY STAFF.
5. CONTROL MEASURES MUST BE INSTALLED PRIOR TO COMMENCEMENT OF ACTIVITIES THAT COULD CONTRIBUTE POLLUTANTS TO STORMWATER. CONTROL MEASURES FOR ALL SLOPES, CHANNELS, DITCHES, AND DISTURBED LAND AREAS SHALL BE INSTALLED IMMEDIATELY UPON COMPLETION OF THE DISTURBANCE.
6. ALL TEMPORARY SEDIMENT AND EROSION CONTROL MEASURES SHALL BE MAINTAINED AND REMAIN IN EFFECTIVE OPERATING CONDITION UNTIL PERMANENT SOIL EROSION CONTROL MEASURES ARE IMPLEMENTED AND FINAL STABILIZATION IS ESTABLISHED. ALL PERSONS ENGAGED IN LAND DISTURBANCE ACTIVITIES SHALL ASSESS THE ADEQUACY OF CONTROL MEASURES AT THE SITE AND IDENTIFY IF CHANGES TO THOSE CONTROL MEASURES ARE NEEDED TO ENSURE THE CONTINUED EFFECTIVE PERFORMANCE OF THE CONTROL MEASURES. ALL CHANGES TO TEMPORARY SEDIMENT AND EROSION CONTROL MEASURES MUST BE INCORPORATED INTO THE STORMWATER MANAGEMENT PLAN.
7. TEMPORARY STABILIZATION SHALL BE IMPLEMENTED ON DISTURBED AREAS AND STOCKPILES WHERE GROUND DISTURBING CONSTRUCTION ACTIVITY HAS PERMANENTLY CEASED OR TEMPORARILY CEASED FOR LONGER THAN 14 DAYS.
8. FINAL STABILIZATION MUST BE IMPLEMENTED AT ALL APPLICABLE CONSTRUCTION SITES. FINAL STABILIZATION IS ACHIEVED WHEN ALL GROUND DISTURBING ACTIVITIES ARE COMPLETE AND ALL DISTURBED AREAS EITHER HAVE A UNIFORM VEGETATIVE COVER WITH INDIVIDUAL PLANT DENSITY OF 70 PERCENT OF PRE-DISTURBANCE LEVELS ESTABLISHED OR EQUIVALENT PERMANENT ALTERNATIVE STABILIZATION METHOD IS IMPLEMENTED. ALL TEMPORARY SEDIMENT AND EROSION CONTROL MEASURES SHALL BE REMOVED UPON FINAL STABILIZATION AND BEFORE PERMIT CLOSURE.
9. ALL PERMANENT STORMWATER MANAGEMENT FACILITIES SHALL BE INSTALLED AS DESIGNED IN THE APPROVED PLANS. ANY PROPOSED CHANGES THAT AFFECT THE DESIGN OR FUNCTION OF PERMANENT STORMWATER MANAGEMENT STRUCTURES MUST BE APPROVED BY THE ECM ADMINISTRATOR PRIOR TO IMPLEMENTATION.
10. EARTH DISTURBANCES SHALL BE CONDUCTED IN SUCH A MANNER SO AS TO EFFECTIVELY MINIMIZE ACCELERATED SOIL EROSION AND RESULTING SEDIMENTATION. ALL DISTURBANCES SHALL BE DESIGNED, CONSTRUCTED, AND COMPLETED SO THAT THE EXPOSED AREA OF ANY DISTURBED LAND SHALL BE LIMITED TO THE SHORTEST PRACTICAL PERIOD OF TIME. PRE-EXISTING VEGETATION SHALL BE PROTECTED AND MAINTAINED WITHIN 50 HORIZONTAL FEET OF A WATERS OF THE STATE UNLESS SHOWN TO BE INFEASIBLE AND SPECIFICALLY REQUESTED AND APPROVED.
11. COMPACTION OF SOIL MUST BE PREVENTED IN AREAS DESIGNATED FOR INFILTRATION CONTROL MEASURES OR WHERE FINAL STABILIZATION WILL BE ACHIEVED BY VEGETATIVE COVER. AREAS DESIGNATED FOR INFILTRATION CONTROL MEASURES SHALL ALSO BE PROTECTED FROM SEDIMENTATION DURING CONSTRUCTION UNTIL FINAL STABILIZATION IS ACHIEVED. IF COMPACTION PREVENTION IS NOT FEASIBLE DUE TO SITE CONSTRAINTS, ALL AREAS DESIGNATED FOR INFILTRATION AND VEGETATION CONTROL MEASURES MUST BE LOOSENEED PRIOR TO INSTALLATION OF THE CONTROL MEASURE(S).
12. ANY TEMPORARY OR PERMANENT FACILITY DESIGNED AND CONSTRUCTED FOR THE CONVEYANCE OF STORMWATER AROUND, THROUGH, OR FROM THE EARTH DISTURBANCE AREA SHALL BE A STABILIZED CONVEYANCE DESIGNED TO MINIMIZE EROSION AND THE DISCHARGE OF SEDIMENT OFF SITE.
13. CONCRETE WASH WATER SHALL BE CONTAINED AND DISPOSED OF IN ACCORDANCE WITH THE SWMP. NO WASH WATER SHALL BE DISCHARGED TO OR ALLOWED TO ENTER STATE WATERS, INCLUDING ANY SURFACE OR SUBSURFACE STORM DRAINAGE SYSTEM OR FACILITIES. CONCRETE WASHOUTS SHALL NOT BE LOCATED IN AN AREA WHERE SHALLOW GROUNDWATER MAY BE PRESENT, OR WITHIN 50 FEET OF A SURFACE WATER BODY, CREEK OR STREAM.
14. DURING DEWATERING OPERATIONS OF UNCONTAMINATED GROUND WATER MAY BE DISCHARGED ON SITE, BUT SHALL NOT LEAVE THE SITE IN THE FORM OF SURFACE RUNOFF UNLESS AN APPROVED STATE DEWATERING PERMIT IS IN PLACE.
15. EROSION CONTROL BLANKETING OR OTHER PROTECTIVE COVERING SHALL BE USED ON SLOPES STEEPER THAN 3:1.
16. CONTRACTOR SHALL BE RESPONSIBLE FOR THE REMOVAL OF ALL WASTES FROM THE CONSTRUCTION SITE FOR DISPOSAL IN ACCORDANCE WITH LOCAL AND STATE REGULATORY REQUIREMENTS. NO CONSTRUCTION DEBRIS, TREE SLASH, BUILDING MATERIAL WASTES OR UNUSED BUILDING MATERIALS SHALL BE BURIED, DUMPED, OR DISCHARGED AT THE SITE.
17. WASTE MATERIALS SHALL NOT BE TEMPORARILY PLACED OR STORED IN THE STREET, ALLEY, OR OTHER PUBLIC WAY, UNLESS IN ACCORDANCE WITH AN APPROVED TRAFFIC CONTROL PLAN. CONTROL MEASURES MAY BE REQUIRED BY EL PASO COUNTY ENGINEERING IF DEEMED NECESSARY, BASED ON SPECIFIC CONDITIONS AND CIRCUMSTANCES.
18. TRACKING OF SOILS AND CONSTRUCTION DEBRIS OFF-SITE SHALL BE MINIMIZED. MATERIALS TRACKED OFF-SITE SHALL BE CLEANED UP AND PROPERLY DISPOSED OF IMMEDIATELY.
19. THE OWNER/DEVELOPER SHALL BE RESPONSIBLE FOR THE REMOVAL OF ALL CONSTRUCTION DEBRIS, DIRT, TRASH, ROCK, SEDIMENT, SOIL, AND SAND THAT MAY ACCUMULATE IN ROADS, STORM DRAINS AND OTHER DRAINAGE CONVEYANCE SYSTEMS AND STORMWATER APPURTENANCES AS A RESULT OF SITE DEVELOPMENT.
20. THE QUANTITY OF MATERIALS STORED ON THE PROJECT SITE SHALL BE LIMITED, AS MUCH AS PRACTICAL, TO THAT QUANTITY REQUIRED TO PERFORM THE WORK IN AN ORDERLY SEQUENCE. ALL MATERIALS STORED ON-SITE SHALL BE STORED IN A NEAT, ORDERLY MANNER, IN THEIR ORIGINAL CONTAINERS, WITH ORIGINAL MANUFACTURER'S LABELS.
21. NO CHEMICAL(S) HAVING THE POTENTIAL TO BE RELEASED IN STORMWATER ARE TO BE STORED OR USED ONSITE UNLESS PERMISSION FOR THE USE OF SUCH CHEMICAL(S) IS GRANTED IN WRITING BY THE ECM ADMINISTRATOR. IN GRANTING APPROVAL FOR THE USE OF SUCH CHEMICAL(S), SPECIAL CONDITIONS AND MONITORING MAY BE REQUIRED.
22. BULK STORAGE OF ALLOWED PETROLEUM PRODUCTS OR OTHER ALLOWED LIQUID CHEMICALS IN EXCESS OF 55 GALLONS SHALL REQUIRE ADEQUATE SECONDARY CONTAINMENT PROTECTION TO CONTAIN ALL SPILLS ONSITE AND TO PREVENT ANY SPILLED MATERIALS FROM ENTERING STATE WATERS, ANY SURFACE OR SUBSURFACE STORM DRAINAGE SYSTEM OR OTHER FACILITIES.
23. NO PERSON SHALL CAUSE THE IMPEDIMENT OF STORMWATER FLOW IN THE CURB AND GUTTER OR DITCH EXCEPT WITH APPROVED SEDIMENT CONTROL MEASURES.
24. OWNER/DEVELOPER AND THEIR AGENTS SHALL COMPLY WITH THE "COLORADO WATER QUALITY CONTROL ACT" (TITLE 25, ARTICLE 8, CRS), AND THE "CLEAN WATER ACT" (33 USC 1344), IN ADDITION TO THE REQUIREMENTS OF THE LAND DEVELOPMENT CODE, DCM VOLUME II AND THE ECM APPENDIX I. ALL APPROPRIATE PERMITS MUST BE OBTAINED BY THE CONTRACTOR PRIOR TO CONSTRUCTION (1041, NPDES, FLOODPLAIN, 404, FUGITIVE DUST, ETC.). IN THE EVENT OF CONFLICTS BETWEEN THESE REQUIREMENTS AND OTHER LAWS, RULES, OR REGULATIONS OF OTHER FEDERAL, STATE, LOCAL, OR COUNTY AGENCIES, THE MOST RESTRICTIVE LAWS, RULES, OR REGULATIONS SHALL APPLY.
25. ALL CONSTRUCTION TRAFFIC MUST ENTER/EXIT THE SITE ONLY AT APPROVED CONSTRUCTION ACCESS POINTS.
26. PRIOR TO CONSTRUCTION THE PERMITTEE SHALL VERIFY THE LOCATION OF EXISTING UTILITIES.
27. A WATER SOURCE SHALL BE AVAILABLE ON SITE DURING EARTHWORK OPERATIONS AND SHALL BE UTILIZED AS REQUIRED TO MINIMIZE DUST FROM EARTHWORK EQUIPMENT AND WIND.
28. THE SOILS REPORT FOR THIS SITE HAS BEEN PREPARED BY ENTECH (JULY 2020) AND SHALL BE CONSIDERED A PART OF THESE PLANS.
29. AT LEAST TEN (10) DAYS PRIOR TO THE ANTICIPATED START OF CONSTRUCTION, FOR PROJECTS THAT WILL DISTURB ONE (1) ACRE OR MORE, THE OWNER OR OPERATOR OF CONSTRUCTION ACTIVITY SHALL SUBMIT A PERMIT APPLICATION FOR STORMWATER DISCHARGE TO THE COLORADO DEPARTMENT OF PUBLIC HEALTH AND ENVIRONMENT, WATER QUALITY DIVISION, THE APPLICATION CONTAINS CERTIFICATION OF COMPLETION OF A STORMWATER MANAGEMENT PLAN (SWMP), OF WHICH THIS GRADING AND EROSION CONTROL PLAN MAY BE A PART. FOR INFORMATION OR APPLICATION MATERIALS CONTACT:

COLORADO DEPARTMENT OF PUBLIC HEALTH AND ENVIRONMENT  
WATER QUALITY CONTROL DIVISION  
WOOD - PERMITS  
4300 CHERRY CREEK DRIVE SOUTH  
DENVER, CO 80246-1530  
ATTN: PERMITS UNIT

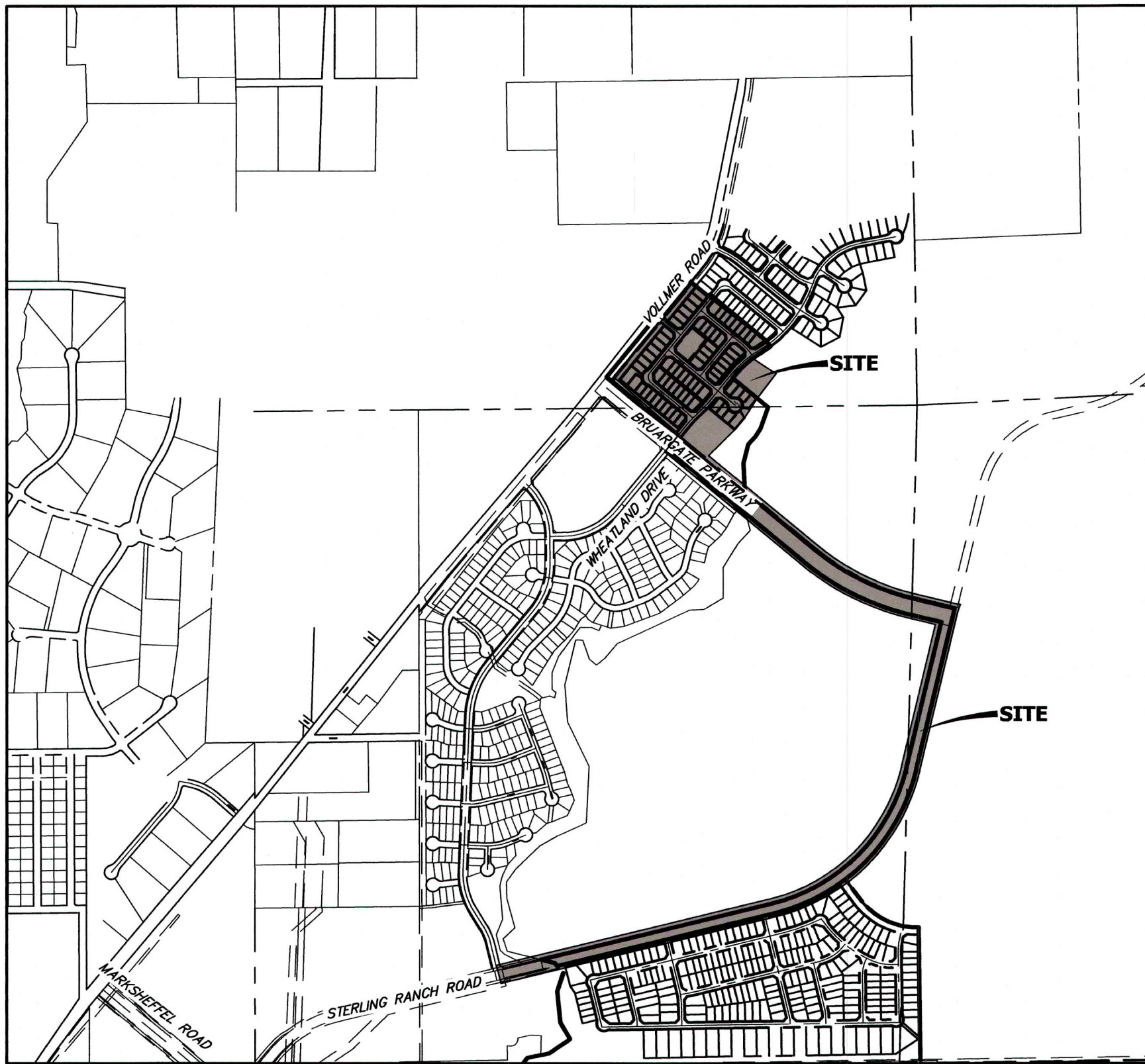

#### VICINITY MAP

SCALE: 1"=1,000'

#### SHEET INDEX

1 COVER  
2-8 GRADING PLAN  
9-12 DETAIL SHEET

### STANDARD NOTES FOR EL PASO COUNTY CONSTRUCTION PLANS

1. ALL DRAINAGE AND ROADWAY CONSTRUCTION SHALL MEET THE STANDARDS AND SPECIFICATIONS OF THE CITY OF COLORADO SPRINGS/EL PASO COUNTY DRAINAGE CRITERIA MANUAL, VOLUMES 1 AND 2, AND THE EL PASO COUNTY ENGINEERING CRITERIA MANUAL.
2. CONTRACTOR SHALL BE RESPONSIBLE FOR THE NOTIFICATION AND FIELD NOTIFICATION OF ALL EXISTING UTILITIES, WHETHER SHOWN ON THE PLANS OR NOT, BEFORE BEGINNING CONSTRUCTION. LOCATION OF EXISTING UTILITIES SHALL BE VERIFIED BY THE CONTRACTOR PRIOR TO CONSTRUCTION. CALL 811 TO CONTACT THE UTILITY NOTIFICATION CENTER OF COLORADO (UNCC).
3. CONTRACTOR SHALL KEEP A COPY OF THESE APPROVED PLANS, THE GRADING AND EROSION CONTROL PLAN, THE STORMWATER MANAGEMENT PLAN (SWMP), THE SOIL AND GEOTECHNICAL REPORT, AND THE APPROPRIATE DESIGN AND CONSTRUCTION STANDARDS AND SPECIFICATIONS AT THE JOB SITE AT ALL TIMES, INCLUDING THE FOLLOWING:
  - 3.1. EL PASO COUNTY ENGINEERING CRITERIA MANUAL (ECM)
  - 3.2. CITY OF COLORADO SPRINGS/ EL PASO COUNTY DRAINAGE CRITERIA MANUAL, VOLUMES 1 AND 2
  - 3.3. COLORADO DEPARTMENT OF TRANSPORTATION (CDOT) STANDARD SPECIFICATIONS AND BRIDGE CONSTRUCTION
  - 3.4. CDOT M&S STANDARDS
4. NOTWITHSTANDING ANYTHING DEPICTED IN THESE PLANS IN WORDS OR GRAPHIC REPRESENTATION, ALL DESIGN AND CONSTRUCTION RELATED TO ROADS, STORM DRAINAGE AND EROSION CONTROL SHALL CONFORM TO THE STANDARDS AND REQUIREMENTS OF THE MOST RECENT VERSIONS OF THE RELEVANT ADOPTED EL PASO COUNTY STANDARDS, INCLUDING THE LAND DEVELOPMENT CODE, THE ENGINEERING CRITERIA MANUAL, THE DRAINAGE CRITERIA MANUAL, AND THE DRAINAGE CRITERIA MANUAL VOLUME 2. ANY DEVIATIONS FROM REGULATIONS AND STANDARDS MUST BE REQUESTED, AND APPROVED, IN WRITING. ANY MODIFICATIONS NECESSARY TO MEET CRITERIA AFTER-THE-FACT WILL BE ENTIRELY THE DEVELOPER'S RESPONSIBILITY TO RECTIFY.
5. IT IS THE DESIGN ENGINEER'S RESPONSIBILITY TO ACCURATELY SHOW EXISTING CONDITIONS, BOTH ONSITE AND OFFSITE, ON THE CONSTRUCTION PLANS. ANY MODIFICATIONS NECESSARY DUE TO CONFLICTS, OMISSIONS, OR CHANGED CONDITIONS WILL BE ENTIRELY THE DEVELOPER'S RESPONSIBILITY TO RECTIFY.
6. CONTRACTOR SHALL SCHEDULE A PRE-CONSTRUCTION MEETING WITH EL PASO COUNTY PLANNING AND COMMUNITY DEVELOPMENT INSPECTIONS, PRIOR TO STARTING CONSTRUCTION.
7. IT IS THE CONTRACTOR'S RESPONSIBILITY TO UNDERSTAND THE REQUIREMENTS OF ALL JURISDICTIONAL AGENCIES TO OBTAIN ALL REQUIRED PERMITS, INCLUDING BUT NOT LIMITED TO EL PASO COUNTY EROSION AND STORMWATER QUALITY CONTROL PERMIT (ESQCP), REGIONAL BUILDING FLOODPLAIN DEVELOPMENT PERMIT, U.S. ARMY CORPS OF ENGINEERS-ISSUED 401 AND/OR 404 PERMITS, AND COUNTY AND STATE FUGITIVE DUST PERMITS.
8. CONTRACTOR SHALL NOT DEVIATE FROM THE PLANS WITHOUT FIRST OBTAINING WRITTEN APPROVAL FROM THE DESIGN ENGINEER AND PCD. CONTRACTOR SHALL NOTIFY THE DESIGN ENGINEER IMMEDIATELY UPON DISCOVERY OF ANY ERRORS OR INCONSISTENCIES.
9. CONTRACTOR SHALL COORDINATE GEOTECHNICAL TESTING PER ECM STANDARDS. PAVEMENT DESIGN SHALL BE APPROVED BY EL PASO COUNTY PCD PRIOR TO PLACEMENT OF CURB AND GUTTER AND PAVEMENT.
10. ALL CONSTRUCTION TRAFFIC MUST ENTER/EXIT THE SITE AT APPROVED CONSTRUCTION ACCESS POINTS.
11. SIGHT VISIBILITY TRIANGLES ARE IDENTIFIED IN THE PLANS SHALL BE PROVIDED AT ALL INTERSECTIONS. OBSTRUCTIONS GREATER THAN 18 INCHES ABOVE FLOWLINE ARE NOT ALLOWED IN SIGHT TRIANGLES.
12. SIGNING AND STRIPING SHALL COMPLY WITH EL PASO COUNTY DEPARTMENT OF PUBLIC WORKS AND MUTCD CRITERIA.
13. CONTRACTOR SHALL OBTAIN ANY PERMITS REQUIRED BY EL PASO COUNTY DEPARTMENT OF PUBLIC WORKS, INCLUDING WORK WITHIN THE RIGHT-OF-WAY AND SPECIAL TRANSPORT PERMITS.
14. THE LIMITS OF CONSTRUCTION SHALL REMAIN WITHIN THE PROPERTY LINE UNLESS OTHERWISE NOTED. THE OWNER/DEVELOPER SHALL OBTAIN WRITTEN PERMISSION AND EASEMENTS, WHERE REQUIRED, FROM ADJOINING PROPERTY OWNER(S) PRIOR TO ANY OFF-SITE DISTURBANCE, GRADING, OR CONSTRUCTION.

### AGENCIES

OWNER/DEVELOPER:	SR LAND, LLC 20 BOULDER CRESCENT, SUITE 201 COLORADO SPRINGS, CO 80903 JAMES F. MORLEY (719) 471-1742
CIVIL ENGINEER:	JR ENGINEERING, LLC 5475 TECH CENTER DRIVE COLORADO SPRINGS, CO 80919 MIKE BRAMLETT P.E. (303) 267-6240
COUNTY ENGINEERING:	EL PASO COUNTY PLANNING AND COMMUNITY DEVELOPMENT 2880 INTERNATIONAL CIRCLE, SUITE 110 COLORADO SPRINGS, CO 80910 JEFF RICE, P.E. (719) 520-6300
TRAFFIC ENGINEERING:	EL PASO COUNTY DEPARTMENT OF PUBLIC WORKS 3275 AKERS DRIVE COLORADO SPRINGS, CO 80922 JENNIFER IRVINE, P.E. (719) 520-6460
WATER RESOURCES:	STERLING RANCH METRO DISTRICT ENGINEERS JDS-HYDRO CONSULTANTS 545 E. PIKES PEAK AVE., SUITE 300 COLORADO SPRINGS, CO 80903 JOHN MCGINN (719) 668-8769
FIRE DISTRICT:	BLACK FOREST FIRE PROTECTION DISTRICT 11445 TEACHOUT ROAD COLORADO SPRINGS, CO 80908 CHIEF BRYAN JACK (719) 495-4300
GAS DEPARTMENT:	COLORADO SPRINGS UTILITIES 7710 DURANT DR. COLORADO SPRINGS, CO 80947 TIM WENDT (719) 668-3556
ELECTRIC DEPARTMENT:	MOUNTAIN VIEW ELECTRIC 11140 E. WOODMEN ROAD FALCON, CO 80831 (719) 495-2283
COMMUNICATIONS:	QWEST COMMUNICATIONS (U.N.C.C. LOCATORS) (800) 922-1987 AT&T (LOCATORS) (719) 635-3674

### EL PASO COUNTY STATEMENT

COUNTY PLAN REVIEW IS PROVIDED ONLY FOR GENERAL CONFORMANCE WITH COUNTY DESIGN CRITERIA. THE COUNTY IS NOT RESPONSIBLE FOR THE ACCURACY AND ADEQUACY OF THE DESIGN, DIMENSIONS, AND/OR ELEVATIONS WHICH SHALL BE CONFIRMED AT THE JOB SITE. THE COUNTY THROUGH THE APPROVAL OF THIS DOCUMENT ASSUMES NO RESPONSIBILITY FOR COMPLETENESS AND/OR ACCURACY OF THIS DOCUMENT.

FILED IN ACCORDANCE WITH THE REQUIREMENTS OF THE EL PASO COUNTY LAND DEVELOPMENT CODE, DRAINAGE CRITERIA MANUAL, VOLUMES 1 AND 2, AND ENGINEERING CRITERIA MANUAL AS AMENDED.

IN ACCORDANCE WITH ECM SECTION 1.12, THESE CONSTRUCTION DOCUMENTS WILL BE VALID FOR CONSTRUCTION FOR A PERIOD OF 2 YEARS FROM THE DATE SIGNED BY THE EL PASO COUNTY ENGINEER. IF CONSTRUCTION HAS NOT STARTED WITHIN THOSE 2 YEARS, THE PLANS WILL NEED TO BE RESUBMITTED FOR APPROVAL, INCLUDING PAYMENT OF REVIEW FEES AT THE PLANNING AND COMMUNITY DEVELOPMENT DIRECTORS DISCRETION.

#### APPROVED

Engineering Department

05/16/2022 2:51:40 PM

dmj/kang

EPC Planning & Community Development Department

DATE

JENNIFER IRVINE, P.E.

COUNTY ENGINEER/ECM ADMINISTRATOR

### OWNER/DEVELOPER STATEMENT

I, THE OWNER/DEVELOPER HAVE READ AND WILL COMPLY WITH THE REQUIREMENTS OF THE GRADING AND EROSION CONTROL PLAN.

JAMES F. MORLEY

1/31/2022

SR LAND, LLC  
20 BOULDER CRESCENT, SUITE 201  
COLORADO SPRINGS, CO 80903

### ENGINEER'S STATEMENT

THIS GRADING AND EROSION CONTROL PLAN WAS PREPARED UNDER MY DIRECTION AND SUPERVISION AND IS CORRECT TO THE BEST OF MY KNOWLEDGE AND BELIEF. SAID PLAN HAS BEEN PREPARED ACCORDING TO THE CRITERIA ESTABLISHED BY THE COUNTY FOR GRADING AND EROSION CONTROL PLANS. I ACCEPT RESPONSIBILITY FOR ANY LIABILITY CAUSED BY ANY NEGLIGENT ACTS, ERRORS OR OMISSIONS ON MY PART IN PREPARING THIS PLANS.

MIKE A. BRAMLETT, P.E.  
COLORADO P.E. 32314  
FOR AND ON BEHALF OF JR ENGINEERING, LLC



UNTIL SUCH TIME AS THESE DRAWINGS ARE APPROVED BY THE APPROPRIATE REVIEW AGENCIES, THE ENGINEERING CRITERIA MANUAL, AND THE DRAINAGE CRITERIA MANUAL, VOLUME 2. ANY DEVIATIONS FROM REGULATIONS AND STANDARDS MUST BE REQUESTED, AND APPROVED, IN WRITING.

PREPARED FOR  
SR LAND, LLC  
20 BOULDER CRESCENT  
SUITE 201  
COLORADO SPRINGS, CO 80903  
JAMES F. MORLEY  
(719) 471-1742

J-R ENGINEERING  
A Western Company



Central 303-740-9883 • Colorado Springs 719-583-2683  
Fort Collins 970-469-9888 • www.jrengineering.com

NO.	REVISION	BY	DATE
1	ADDED SHEET FOR AREA BETWEEN SRR & BGP	DG	8/4/22
N/A	N/A	N/A	01/10/22
DESIGNED BY	BAB		
DRAWN BY	ARJ		
CHECKED BY			

HOMESTEAD NORTH AT  
STERLING RANCH  
COVER SHEET

SHEET 1 OF 12  
JOB NO. 25188.00



This topographic map illustrates a proposed sediment basin (PROPOSED SEDIMENT BASIN 1) and associated erosion control measures. The map includes contour lines, spot elevations, and property boundaries. Key features include:

- PROPOSED SEDIMENT BASIN 1:** A large, irregularly shaped basin with a spillway (TYPE M RIPRAP) and a 6" PVC riser pipe (W/ 1 3/4" HOLES) leading to Sand Creek.
- Erosion Control:** Permanent erosion control blankets (V MAX SC250 OR EQUIVALENT) are shown along the perimeter of the basin and along Briargate Parkway.
- Roads:** Briargate Parkway, Wheatland Drive, and Nat Love Dr. are shown. A 15'x30' riprap pad is located near Wheatland Dr.
- Water Features:** Sand Creek and its 100-year floodplain are shown on the right side of the map.
- Utilities:** A 20' electric easement (REC. NO. 218054763) and a 25' public improvement easement (SR COMMERCIAL LLC) are indicated.
- Other Features:** A 50' site visibility & public improvement easement (REC. NO. 218714151) is shown near the top left. A 160' access and utility easement (REC. NO. 2141044) is also present.

The map is labeled with various survey points (e.g., 7134.19, 7134.28, 7135.59) and elevations (e.g., 7130, 7120, 7110). It also includes a north arrow and a scale bar.

## LEGEND

CHECK DAM

ECB

EROSION C

THE EROSION CONTROL DELINEATED ON THIS PLAN  
SHALL BE REGULARLY UPDATED BY THE CONTRACTOR

TEMP SPILLWAY CROSS SECTION - NTS

NOT TO SCALE

NOT TO SCALE

NOT TO SCALE

**NOTE:** "T" LOTS OR "TRANSITION " LOTS OCCUR IN PLACES WHERE BOTH PROPERTY LINES CANNOT BE GRADED AS THE TYPICAL STANDARD LOT TEMPLATES SHOWN. THESE LOTS WILL STILL BE GRADED TO CREATE POSITIVE DRAINAGE AWAY FROM THE STRUCTURE.

SIDE LOT SWALES WILL BE PROVIDED WHEN APPROPRIATE.

60 30 0 60 120  
ORIGINAL SCALE: 1" = 60'

PROFESSIONAL ENGINEER

PREPARED UNDER MY DIRECT SUPERVISION AND ON BEHALF OF JR  
ENGINEERING

COLORADO P.E. 32314

## EARLY GRADING & EROSION CONTROL PLAN

SHEET 2 OF 12

JOB NO. 25188.00

PREPARED FOR  
SR LAND, LLC  
20 BOULDER CREST  
SUITE 201  
COLORADO SPRINGS, CO  
JAMES F. MORLEY  
(719) 471-1742

**J.R. ENGINEERING**  
A Westrian Company

 Centennial 303-740-9383 • Colorado Springs 719-593-2593  
Fort Collins 970-491-9888 • [www.jrengineering.com](http://www.jrengineering.com)

DATE	BY	REVISION	No.	1"=60'	H-SCALE	V-SCALE
				N/A		
				DATE	01/10/22	
				DESIGNED BY	BAB	
				DRAWN BY	ARJ	
				CHECKED BY		





SEE SHEET # 2

#### CONSTRUCTION NOTES:

NO WETLANDS ARE TO BE PERMANENTLY DISTURBED PER THIS GRADING PLAN.

NO EARLY GRADING IS TO OCCUR WITHIN THE 100 YEAR FLOODPLAIN.

ALL TEMPORARY RIPRAP SHOWN ON THE PLANS SHALL BE TYPE 'M'. RIPRAP SHALL BE PLACED IN THE LOCATIONS INDICATED BY THE PLAN OR IN AREAS AS THE CONTRACTOR SEES FIT TO CONTROL EROSION. ALL RIPRAP SHALL BE PLACED AT A MINIMUM THICKNESS OF 1.5' DEEP.

ALL TEMPORARY STORM SEWER SHOWN ON PLANS SHALL BE 24" DIA. HP POLYPROPYLENE BY ADS OR APPROVED EQUAL. ALL PIPE SHALL BE LAID TO ACHIEVE A MIN. SLOPE OF 0.5%.

#### ADDITIONAL NOTES:

EXISTING VEGETATION: AN AERIAL SURVEY WAS USED TO DETERMINE A 30% COVER OF NATIVE GRASSES.

STAGING AREA & STOCKPILE LOCATION TO BE DETERMINED BY CONTRACTOR IN THE FIELD. THE LOCATIONS SHALL BE DELINEATED ON THIS PLAN BY THE CONTRACTOR.

THE EROSION CONTROL DELINEATED ON THIS PLAN SHALL BE REGULARLY UPDATED BY THE CONTRACTOR.

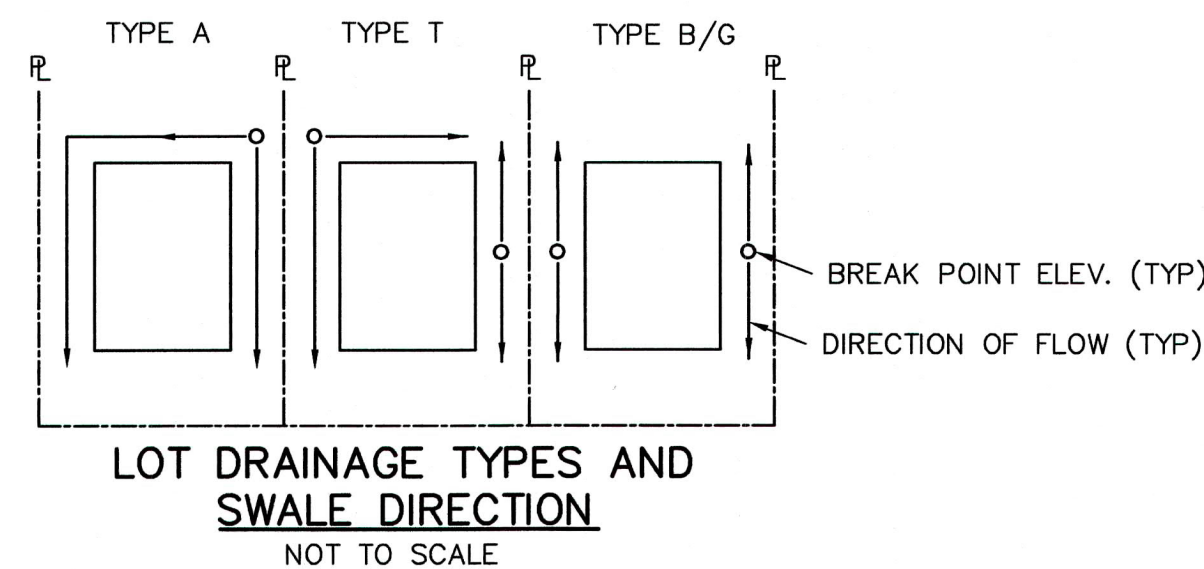

#### LEGEND

EXISTING STORM SEWER	EXISTING FLOW DIRECTION ARROW	INLET	ROCK SOCK
STORM SEWER PROPOSED	EMERGENCY OVERFLOW DIRECTION	LOW POINT/HIGH POINT	
PROPOSED R.O.W.	CONCRETE WASHOUT AREA	FLOW DIRECTION & SLOPE	
PROPOSED PROPERTY LINE	INLET PROTECTION	FLOW DIRECTION ARROW	
PROPOSED SIDEWALK	TEMPORARY SEDIMENT BASIN	EXISTING FLOW DIRECTION ARROW	
EXISTING PROPERTY LINE	SILT FENCE		
ROW EXISTING	VEHICLE TRACKING CONTROL		
FL EXISTING	STAGE STABILIZED AREA		
SIDEWALK EXISTING	TEMPORARY SEEDING		
DRAINAGE ACCESS & MAINTENANCE EASEMENT	EROSION CONTROL BLANKET		
SILT FENCE			
LIMITS OF CONSTRUCTION/DISTURBANCE			
EXISTING WETLAND BOUNDARY			
EXISTING 100 YEAR FLOODPLAIN			
CUT / FILL			
TEMPORARY DITCH			
EXISTING			
CHECK DAM			



KEY MAP  
SCALE: NTS

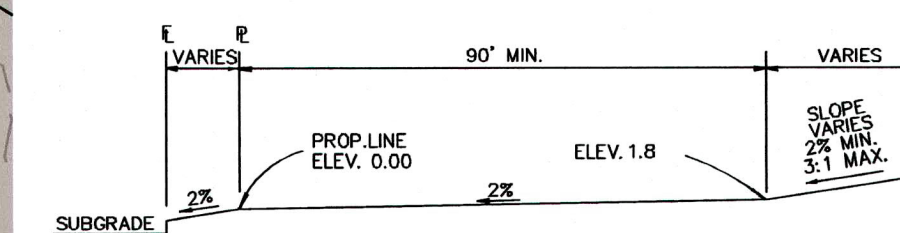

TYPICAL A LOT  
NOT TO SCALE

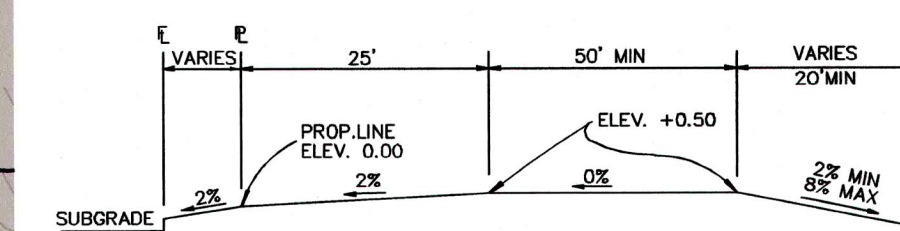

TYPICAL B LOT  
NOT TO SCALE

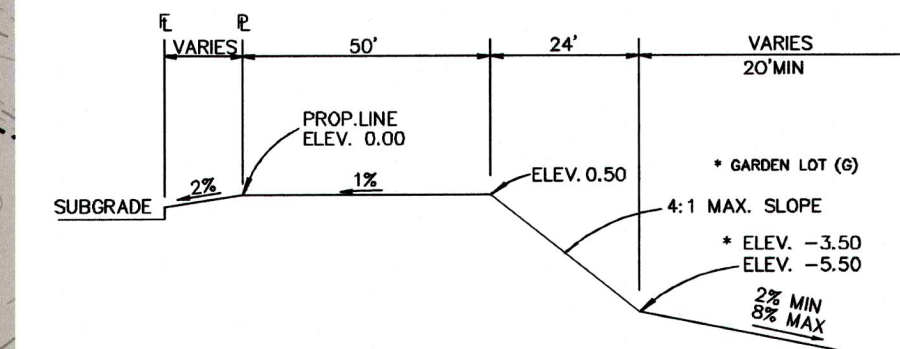

TYPICAL WALKOUT LOT (W/O) OR GARDEN (G)  
NOT TO SCALE

NOTE:  
"T" LOTS OR "TRANSITION" LOTS OCCUR IN PLACES WHERE BOTH PROPERTY LINES CANNOT BE GRADED AS THE TYPICAL STANDARD LOT TEMPLATES SHOWN. THESE LOTS WILL STILL BE GRADED TO CREATE POSITIVE DRAINAGE AWAY FROM THE STRUCTURE.

NOTE:  
SIDE LOT SWALES WILL BE PROVIDED WHEN APPROPRIATE.

60 30 0 60 120  
ORIGINAL SCALE: 1" = 60'

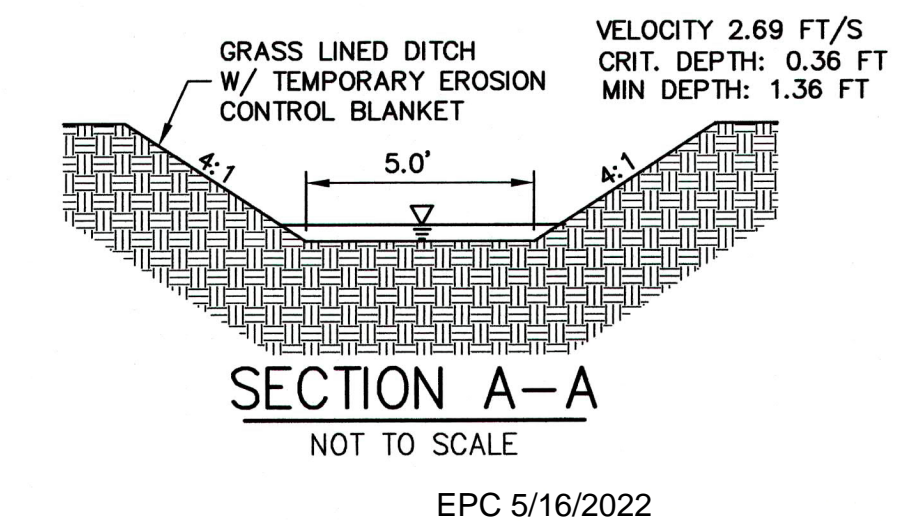

SECTION A-A  
NOT TO SCALE  
EPC 5/16/2022

#### ENGINEER'S STATEMENT

PREPARED UNDER MY DIRECT SUPERVISION AND ON BEHALF OF JR ENGINEERING

MIKE A. BRAMLETT, P.E.  
COLORADO P.E. 32314  
FOR AND ON BEHALF OF JR ENGINEERING, LLC

UNTIL SUCH TIME AS THESE DRAWINGS ARE APPROVED BY THE ENGINEERING AGENCIES, JR ENGINEERING APPROVES THEIR USE ONLY FOR THE PURPOSES DESIGNATED BY WRITTEN AUTHORIZATION.

PREPARED FOR  
**SR LAND, LLC**  
20 BOULDER CRESCENT  
SUITE 201  
COLORADO SPRINGS, CO 80903  
JAMES F. MORLEY  
(719) 471-1742

**J-R ENGINEERING**  
A Western Company  
Centennial 303-740-9888 • Colorado Springs 719-589-2583  
Fort Collins 970-491-9888 • www.jrengineering.com

H-SCALE		1"=60'	No.	REVISION	BY	DATE
V-SCALE		N/A				
DATE		01/10/22				
DESIGNED BY		BAB				
DRAWN BY		ARJ				
CHECKED BY						

HOMESTEAD NORTH AT  
STERLING RANCH  
EARLY GRADING & EROSION  
CONTROL PLAN

SHEET 3 OF 12  
JOB NO. 25188.00







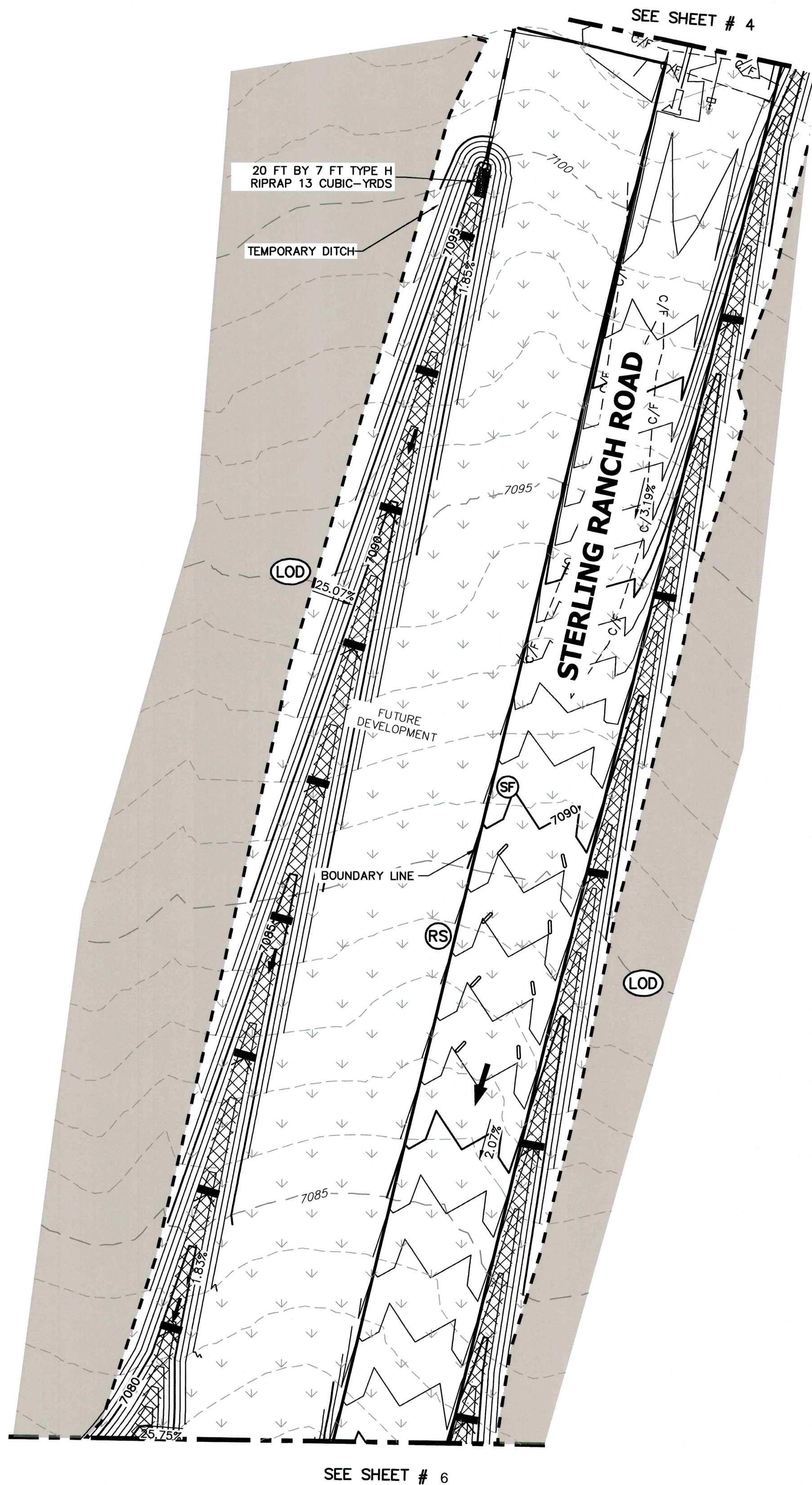

LEGEND

EXISTING STORM SEWER		L.P./H.P.	INLET	
STORM SEWER PROPOSED		(2.0)%	LOW POINT/HIGH POINT	
PROPOSED R.O.W.			FLOW DIRECTION & SLOPE	
PROPOSED PROPERTY LINE			FLOW DIRECTION ARROW	
PROPOSED SIDEWALK			EXISTING FLOW DIRECTION ARROW	
EXISTING PROPERTY LINE			EMERGENCY OVERFLOW DIRECTION	
ROW EXISTING			CONCRETE WASHOUT AREA	
FL EXISTING			INLET PROTECTION	
SIDEWALK EXISTING			TEMPORARY SEDIMENT BASIN	
DRAINAGE ACCESS & MAINTENANCE EASEMENT			SILT FENCE	
SILT FENCE			VEHICLE TRACKING CONTROL	
LIMITS OF CONSTRUCTION/DISTURBANCE			STAGE STABILIZED AREA	
EXISTING WETLAND BOUNDARY			TEMPORARY SEEDING	
EXISTING 100 YEAR FLOODPLAIN			EROSION CONTROL BLANKET	
CUT/ FILL				
TEMPORARY DITCH				
EXISTING				
PROPOSED				
CHECK DAM				

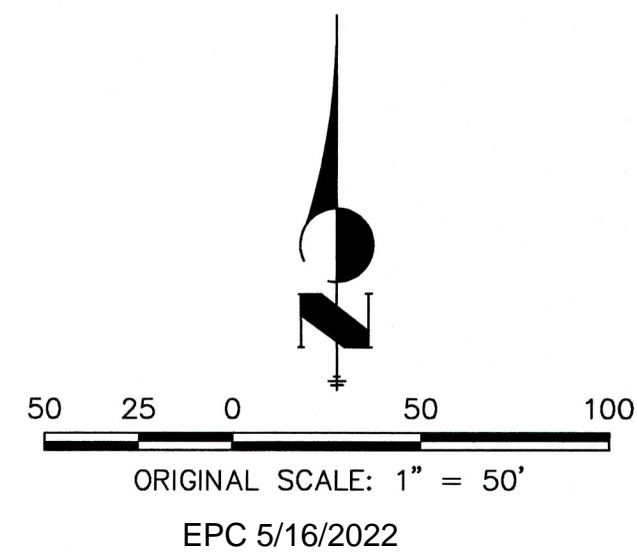
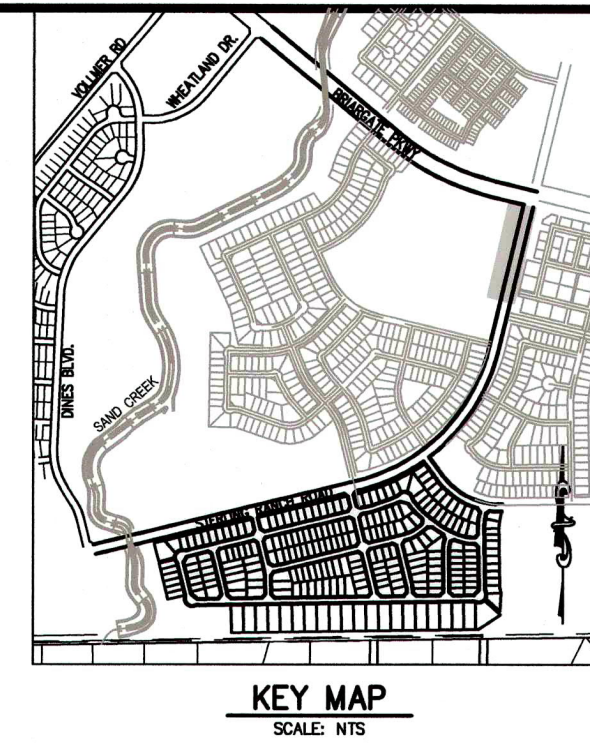

ENGINEER'S STATEMENT

PREPARED UNDER MY DIRECT SUPERVISION AND ON BEHALF OF JR ENGINEERING

MIKE A. BRAMLETT, P.E.  
COLORADO P.E. 32314  
FOR AND ON BEHALF OF JR ENGINEERING, LLC

DATE 1/3/22

HOMESTEAD NORTH AT  
STERLING RANCH  
EARLY GRADING & EROSION  
CONTROL PLAN

SHEET 5 OF 12

JOB NO. 25188.00

H-SCALE	V-SCALE	DATE	DESIGNED BY	DRAWN BY	CHECKED BY
1"=60'	N/A	01/10/22	RAB	CGV	

No. REVISION

BY DATE

JR ENGINEERING  
A Westman Company

Central 303-740-9333 • Colorado Springs 719-539-2533  
Fort Collins 970-491-9888 • www.jrengineering.com

PREPARED FOR  
SR LAND, LLC  
20 BOULDER CRESCENT  
SUITE 201  
COLORADO SPRINGS, CO 80903  
JAMES F. MORLEY  
(719) 471-1742

UNTIL SUCH TIME AS  
THESE DRAWINGS ARE  
APPROVED BY THE  
APPROPRIATE REVIEWING  
AGENCIES, JR ENGINEERING  
APPROVES THEIR USE  
ONLY FOR THE PURPOSES  
SPECIFIED BY THE  
AUTHORIZATION.



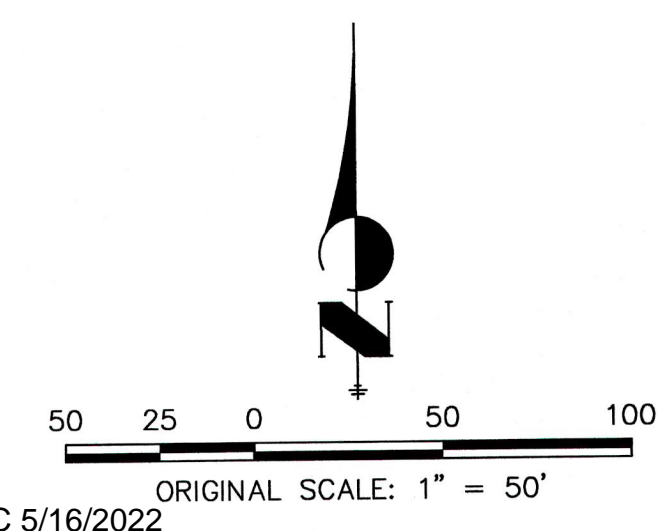
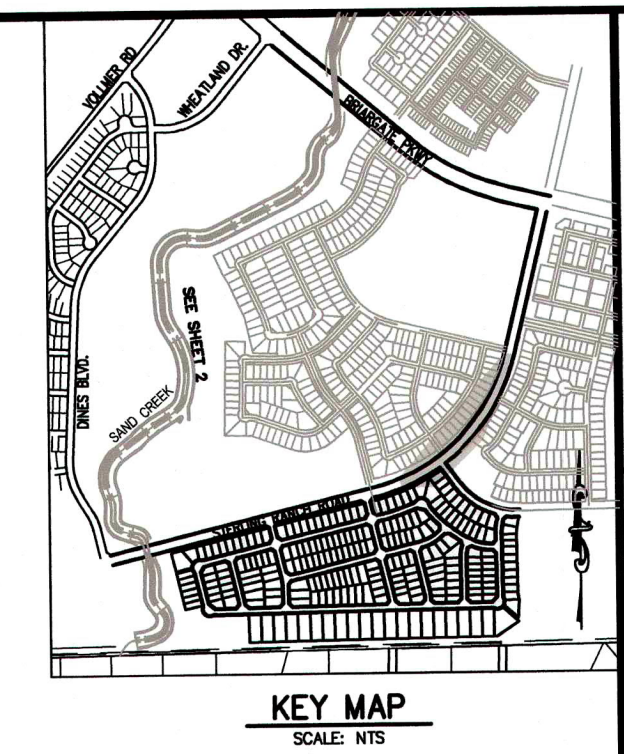
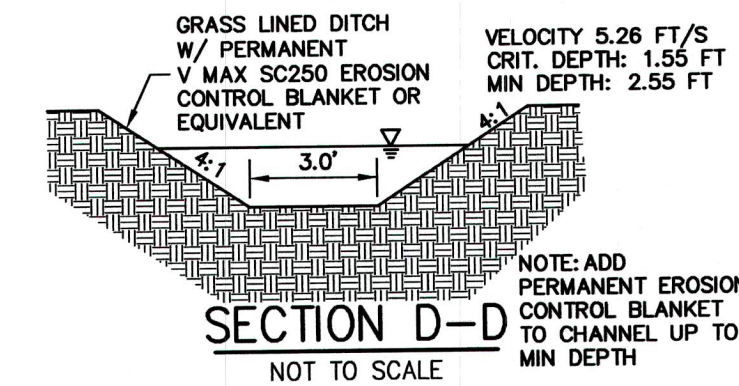

<b>LEGEND</b>				
EXISTING STORM SEWER			INLET	
STORM SEWER PROPOSED		L.P./H.P. (2.0)% 	LOW POINT/HIGH POINT	
PROPOSED R.O.W.			FLOW DIRECTION & SLOPE	ROCK SOCK
PROPOSED PROPERTY LINE			FLOW DIRECTION ARROW	
PROPOSED SIDEWALK			EXISTING FLOW DIRECTION ARROW	
EXISTING PROPERTY LINE			EMERGENCY OVERFLOW DIRECTION	
ROW EXISTING				
FL EXISTING			CONCRETE WASHOUT AREA	
SIDEWALK EXISTING			INLET PROTECTION	
DRAINAGE ACCESS & EASEMENT			TEMPORARY SEDIMENT BASIN	
SILT FENCE			SILT FENCE	
LIMITS OF CONSTRUCTION/ DISTURBANCE			VEHICLE TRACKING CONTROL	
EXISTING WETLAND BOUNDARY			STAGE STABILIZED AREA	
EXISTING 100 YEAR FLOODPLAIN			TEMPORARY SEEDING	
CUT/ FILL TEMPORARY DITCH			EROSION CONTROL BLANKET	
EXISTING				
PROPOSED				
7100				
CHECK DAM				

**ENGINEER'S STATEMENT**

PREPARED UNDER MY DIRECT SUPERVISION AND ON BEHALF OF JR  
ENGINEERING

*Mike Bramlett*

MIKE A. BRAMLETT, P.E.  
COLORADO P.E. 32314

FOR AND ON BEHALF OF JR ENGINEERING, LLC

1/31/22 DATE

1/31/22

PROFESSIONAL ENGINEER  
STATE OF COLORADO  
MIKE A. BRAMLETT  
P.E. 32314

SHEET	6	OF	12
HOMESTEAD NORTH AT STERLING RANCH			
EARLY GRADING & EROSION CONTROL PLAN			
H-SCALE	1"=60'	No.	REVISION
V-SCALE	N/A		
DATE	01/10/22		
DESIGNED BY	RAB		
DRAWN BY	CGV		
CHECKED BY			



**J-R ENGINEERING**  
A Western Company

Central 303-740-9888 • Colorado Springs 719-589-2588  
Fort Collins 970-491-9888 • [www.jrengineering.com](http://www.jrengineering.com)

PREPARED FOR  <b>SR LAND, LLC</b> 20 BOULDER CRESCENT SUITE 201 COLORADO SPRINGS, CO 80903 JAMES F. MORLEY (719) 471-1742	UNTIL SUCH TIME AS THESE DRAWINGS ARE APPROVED BY THE REVIEWING AGENCIES, JR ENGINEERING APPROVES THEIR USE ONLY FOR THE PURPOSES DESIGNATED BY WRITTEN AUTHORIZATION.

JOB NO.      25188.00





HOMESTEAD NORTH AT STERLING RANCH	
GRADING AND EROSION CONTROL PLAN	
SHEET	7 OF 12
JOB NO.	25188.00

SHEET	7	OF	12
JOB NO.	25188.00		

EPC 5/16/2022

MIKE A. BRAMLETT, P.E.  
COLORADO P.E. 32314  
FOR AND ON BEHALF OF JR ENGINEERING, LLC





**LEGEND**

EXISTING STORM SEWER

STORM SEWER PROPOSED

PROPOSED R.O.W.

PROPOSED PROPERTY LINE

PROPOSED SIDEWALK

EXISTING PROPERTY LINE

ROW EXISTING

FL EXISTING

SIDEWALK EXISTING

DRAINAGE ACCESS & MAINTENANCE EASEMENT

SILT FENCE

LIMITS OF CONSTRUCTION/ DISTURBANCE

EXISTING WETLAND BOUNDARY

EXISTING 100 YEAR FLOODPLAIN

CUT/ FILL

TEMPORARY DITCH

EXISTING

CHECK DAM

LOW POINT/HIGH POINT

FLOW DIRECTION & SLOPE

FLOW DIRECTION ARROW

EXISTING FLOW DIRECTION ARROW

EMERGENCY OVERFLOW DIRECTION

CONCRETE WASHOUT AREA

INLET PROTECTION

SEDIMENT STOCKPILE

SILT FENCE

VEHICLE TRACKING CONTROL

STAGE STABILIZED AREA

TEMPORARY SEEDING

EROSION CONTROL BLANKET

INLET

LOW POINT/HIGH POINT

FLOW DIRECTION & SLOPE

FLOW DIRECTION ARROW

EXISTING FLOW DIRECTION ARROW

EMERGENCY OVERFLOW DIRECTION

CONCRETE WASHOUT AREA

INLET PROTECTION

SEDIMENT STOCKPILE

SILT FENCE

VEHICLE TRACKING CONTROL

STAGE STABILIZED AREA

TEMPORARY SEEDING

EROSION CONTROL BLANKET

CS

CURB SOCK

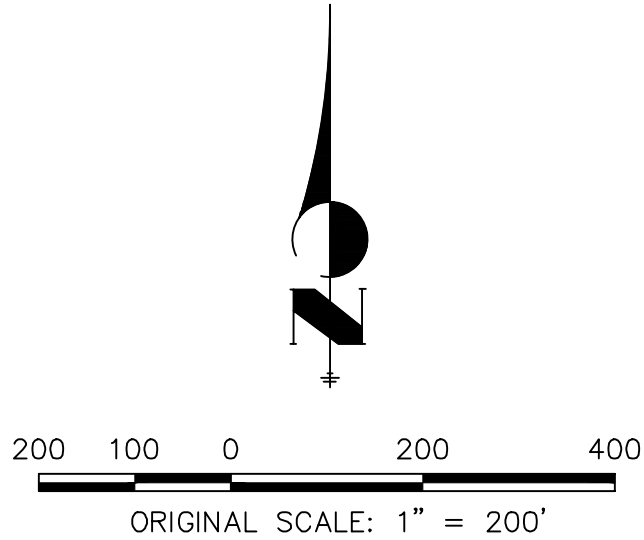

**ENGINEER'S STATEMENT**

PREPARED UNDER MY DIRECT SUPERVISION AND ON BEHALF OF JR ENGINEERING

DATE 3/25/22

FOR AND ON BEHALF OF JR ENGINEERING, LLC

**ENGINEERING**  
A Western Company

Centennial 303-740-9883 • Colorado Springs 719-583-2583  
Fort Collins 970-491-9888 • www.jrengineering.com

PREPARED FOR

**SR LAND, LLC**  
20 BOULDER CRESCENT  
SUITE 201  
COLORADO SPRINGS, CO 80903  
JAMES F. MORLEY  
(719) 471-1742

HOMESTEAD NORTH AT  
STERLING RANCH

EARLY GRADING & EROSION  
CONTROL PLAN

BY DG

DATE 8/4/22

1

ADD BMP TO AREA INBETWEEN SRR & BGP

1"=60'

N/A

3/25/22

RAB

CGV

SHEET 8 OF 12

JOB NO. 25188.00

UNTIL SUCH TIME AS THESE DRAWINGS ARE APPROVED BY THE APPROPRIATE REVIEWING AGENCIES, THESE DRAWINGS ARE NOT TO BE USED FOR ANY PURPOSES DESIGNATED BY WRITTEN AUTHORIZATION.

UNLESS OTHERWISE NOTED, ALL DIMENSIONS ARE IN FEET AND DECIMALS THEREOF.







## SC-1

**SM-4 Vehicle Tracking Control (VTC)**

(DETAILS ADAPTED FROM CITY OF BROOMFIELD, COLORADO, NOT AVAILABLE IN AUTOCAD)

VTC-6                      Urban Drainage and Flood Control District                      November 2010  
Urban Storm Drainage Criteria Manual Volume 3

### Silt Fence (SF)

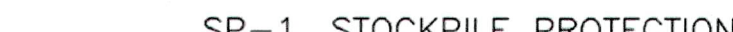
**Stockpile Management (SP)** **MM-2**

---

November 2010	Urban Drainage and Flood Control District Urban Storm Drainage Criteria Manual Volume 3	SP-3
---------------	--	------

**MM-2** **Stockpile Management (SM)**

---

SP-4
Urban Drainage and Flood Control District
November 2010

Urban Storm Drainage Criteria Manual Volume 3

## SM-6



November 2010	Urban Drainage and Flood Control District Urban Storm Drainage Criteria Manual Volume 3	SSA-3
---------------	--	-------

## SM-6 Stabilized Staging Area (SSA)

(DETAILS ADAPTED FROM DOUGLAS COUNTY, COLORADO, NOT AVAILABLE IN AUTOCAD)

---

SSA-4
Urban Drainage and Flood Control District
November 2010

Urban Storm Drainage Criteria Manual Volume 3

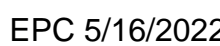

JOB NO.	25188.00	SHEET 9 OF 12		HOMESTEAD NORTH AT STERLING RANCH		H-SCALE	N/A	No.	REVISION	BY	DATE
						V-SCALE	N/A				
				DETAIL		DATE	01/10/22				
						DESIGNED BY	RAB				
						DRAWN BY	RAB				
						CHECKED BY					



[illegible]

Rock Sock (RS) SC-5

November 2010      Urban Drainage and Flood Control District      RS-3  
Urban Storm Drainage Criteria Manual Volume 3

The diagram illustrates the layout of a drainage ditch and the corresponding staking patterns for different ditch types and slopes.

**Top Diagram: Ditch Layout**

- DIVERSION DITCH TYPICALLY AT TOP OF SLOPE:** Points to the diversion ditch at the top of the slope.
- STAGGER OVERLAPS:** Points to the staggered overlaps of the staking pattern.
- OVERLAPPING JOINT:** Points to the overlapping joint of the staking pattern.
- PERIMETER ANCHOR TRENCH:** Points to the perimeter anchor trench.
- STAKING PATTERN PER MANUFACTURER SPEC. OR PATTERN BASED ON ECB AND/OR SLOPE TYPE (SEE STAKING PATTERN DETAIL):** Points to the staking pattern.

**ECB-3. OUTSIDE OF DRAINAGEWAY**

**Staking Patterns by ECB Type:**

- STRAW:** Shows a staking pattern with a 6' width, 3' height, and 1/2 W spacing. The pattern is labeled "ROLL WIDTH W, TYPE".
- STRAW-COCONUT:** Shows a staking pattern with a 6' width, 3' height, and 1/2 W spacing.
- COCONUT OR EXCELSIOR:** Shows a staking pattern with a 4' width, 3' height, and 1/2 W spacing.

**STAKING PATTERNS BY ECB TYPE**

**Staking Patterns by Slope or Channel Type:**

- LOW FLOW CHANNEL:** Shows a staking pattern with a 6' width, 3' height, and 1/2 W spacing. The pattern is labeled "4:1-3:1 SLOPES".
- HIGH FLOW CHANNEL:** Shows a staking pattern with a 6' width, 3' height, and 1/2 W spacing. The pattern is labeled "3:1-2:1 SLOPES".
- 2:1 AND STEEPER SLOPES:** Shows a staking pattern with a 4' width, 3' height, and 1/2 W spacing. The pattern is labeled "2:1 AND STEEPER SLOPES".

## EC-9 Rough Cut Street Control (RCS)

RCS-2      Urban Drainage and Flood Control District      November 2010  
Urban Storm Drainage Criteria Manual Volume 3

**CHECK DAM ELEVATION VIEW**

LENGTH, L  
CREST LENGTH, CL  
SECTION B (TYP.)  
SECTION A  
D (1' 6" MIN)  
1' 6" (MIN)  
1' 2"  
COMPACTED BACKFILL (TYP.)  
CHANNEL GRADE  
UPSTREAM AND DOWNSTREAM  
TOP OF CHECK DAM

**SECTION A**

2'  
6'  
1' 6" MIN.  
1' MIN.  
CHANNEL GRADE  
EXCAVATION TO NEAT LINE, AVOID OVER-EXCAVATION (TYP.)  
D50 = 12" RIPRAP, TYPE M OR TYPE L D50 = 9" (SEE TABLE MD-7, MAJOR DRAINAGE, VOL. 1 FOR GRADATION)

**SECTION B**

8'  
FLOW →  
1' MIN.  
CHANNEL GRADE  
EXCAVATION TO NEAT LINE, AVOID OVER-EXCAVATION (TYP.)  
D50 = 12" RIPRAP, TYPE M OR TYPE L D50 = 9" (SEE TABLE MD-7, MAJOR DRAINAGE, VOL. 1 FOR GRADATION)

**PROFILE**

SPACING BETWEEN CHECK DAMS SUCH THAT A AND B ARE EQUAL ELEVATION  
A  
B  
CHANNEL GRADE

**CD-1. CHECK DAM**

## Rough Cut Street Control (RCS) EC-9

November 2010      Urban Drainage and Flood Control District      RCS-3  
Urban Storm Drainage Criteria Manual Volume 3

RS

1 1/2" (MINUS) CRUSHED ROCK ENCLOSED IN WIRE MESH

WIRE TIE ENDS

6" ON BEDROCK OR HARD SURFACE, 2" IN SOIL

GROUND SURFACE

1 1/2" (MINUS) CRUSHED ROCK ENCLOSED IN WIRE MESH

4" TO 6" MAX AT CURBS, OTHERWISE 6" TO 10" DEPENDING ON SEDIMENT LOADS

### ROCK SOCK SECTION

### ROCK SOCK PLAN

ANY GAP AT JOINT SHALL BE FILLED WITH AN ADEQUATE AMOUNT OF 1 1/2" (MINUS) CRUSHED ROCK AND WRAPPED WITH ADDITIONAL WIRE MESH SECURED TO ENDS OF ROCK REINFORCED SOCK. AN ALTERNATIVE TO FILLING JOINTS BETWEEN ADJOINING ROCK SOCKS WITH CRUSHED ROCK AND ADDITIONAL WIRE WRAPPING, ROCK SOCKS SHALL BE OVERLAPPED (TYPICALLY 12-INCH OVERLAP) TO AVOID GAPS.

ROCK SOCK, TYP

12" 12"

GRADATION TABLE

SIEVE SIZE	MASS PERCENT PASSING SQUARE MESH SIZES
NO. 4	
2"	100
1 1/2"	80 - 100
1"	20 - 55
3/4"	0 - 15
3/8"	0 - 5

MATCHES SPECIFICATIONS FOR NO. 4 COARSE AGGREGATE FOR CONCRETE PER AASHTO M143. ALL ROCK SHALL BE FRACTURED FACE ALL SIZES.

### ROCK SOCK JOINTING

#### ROCK SOCK INSTALLATION NOTES

1. SEE PLAN VIEW FOR:
  - LOCATIONS OF ROCK SOCKS.
2. CRUSHED ROCK SHALL BE 1 1/2" (MINUS) IN SIZE WITH A FRACTURED FACE (ALL SIDES) AND SHALL COMPLY WITH GRADATION SHOWN ON THIS SHEET (1 1/2" MINUS).
3. WIRE MESH SHALL BE FABRICATED OF 1/2" GAGE POULTRY MESH, OR EQUIVALENT, WITH A MAXIMUM OPENING OF 3/8". RECOMMENDED MINIMUM ROLL WIDTH OF 48".
4. WIRE MESH SHALL BE SECURED USING "HOOK RINGS" OR WIRE TIES AT 6" CENTERS ALONG ALL JOINTS AND AT 2" CENTERS ON ENDS OF SOCKS.
5. SOME MUNICIPALITIES MAY ALLOW THE USE OF FILTER FABRIC AS AN ALTERNATIVE TO WIRE MESH FOR THE ROCK ENCLOSURE.

## RS-1. ROCK SOCK PERIMETER CONTROL

**SR LAND, LLC**  
20 BOULDER CRESCENT  
SUITE 201  
COLORADO SPRINGS, CO 80901  
JAMES F. MORLEY  
(719) 471-1742

 **J.R. ENGINEERING**  
A Westrian Company

Centennial 303-740-9383 • Colorado Springs 719-559-2583  
Fort Collins 970-491-9888 • [www.jrengineering.com](http://www.jrengineering.com)

		N/A		
V-SCALE		N/A		
DATE	O1 /10/22			
DESIGNED BY	RAB			
DRAWN BY	RAB			
CHECKED BY				

DETAIL

HEET 11 OF 12

DB NO. 25188.00

EPC 5/16/2022



