

N:\118330\DRAWINGS\CONSTRUCTION\GRADING-EROSION\A- ADDENDUM\GEC SHEET 4.dwg, 6/7/2024 10:24:05 AM, 1:1

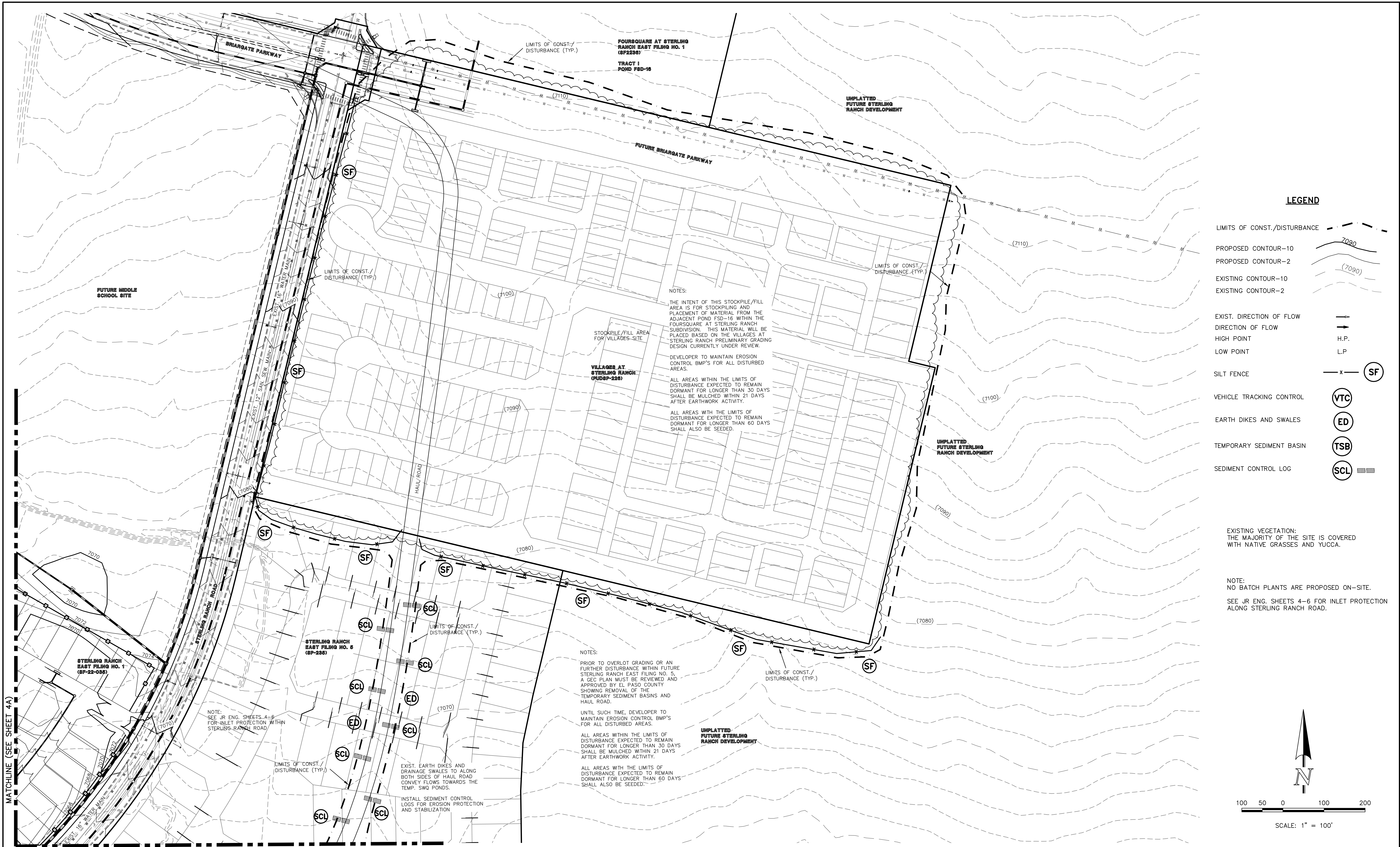

48 HOURS BEFORE YOU DIG,
CALL UTILITY LOCATORS
811

UTILITY NOTIFICATION CENTER OF COLORADO
IT'S THE LAW

THE LOCATIONS OF EXISTING UNDERGROUND UTILITIES ARE SHOWN IN AN APPROXIMATE WAY ONLY. THE CONTRACTOR SHALL DETERMINE THE EXACT LOCATION OF ALL EXISTING UTILITIES BEFORE COMMENCING WORK. THE CONTRACTOR SHALL BE FULLY RESPONSIBLE FOR ANY AND ALL DAMAGES WHICH MIGHT BE CAUSED BY HIS FAILURE TO EXACTLY LOCATE AND PRESERVE ANY AND ALL UNDERGROUND UTILITIES.

NO. REVISION

DATE

1 REVISED PER SW COMMENTS/ADDED VILLAGES STOCKPILE AREA 5/30/24

REVIEW:

PREPARED UNDER MY DIRECT SUPERVISION FOR AND ON BEHALF OF
CLASSIC CONSULTING ENGINEERS AND SURVEYORS, LLC

MARC A. WHORTON, COLORADO LICENSE #37155

6/7/2024

DATE



619 N. Cascade Avenue, Suite 200
Colorado Springs, Colorado 80903
(719) 785-0790
(719) 785-0799 (Fax)

STERLING RANCH RD & BRIARGATE PKWY.
SEGMENT 2 GESC

GRADING AND EROSION CONTROL PLAN
ADDENDUM

DESIGNED BY	MAW	SCALE	DATE	4/29/24
DRAWN BY	MAW	(H) 1" = 100'	SHEET	4B OF 9
CHECKED BY		(V) 1" = N/A	JOB NO.	1183.30

CLASSIC
CONSULTING