

LEGEND

- LIMITS OF CONST./DISTURBANCE
- PROPOSED CONTOUR-10
- PROPOSED CONTOUR-2
- EXISTING CONTOUR-10
- EXISTING CONTOUR-2
- EXIST. DIRECTION OF FLOW
- DIRECTION OF FLOW
- HIGH POINT
- LOW POINT
- SILT FENCE
- VEHICLE TRACKING CONTROL
- EARTH DIKES AND SWALES
- TEMPORARY SEDIMENT BASIN

EXISTING VEGETATION:
THE MAJORITY OF THE SITE IS COVERED
WITH NATIVE GRASSES AND YUCCA.

NOTE:
NO BATCH PLANTS ARE PROPOSED ON-SITE.
SEE JR. ENG. SHEETS 4-6 FOR INLET PROTECTION
ALONG STERLING RANCH ROAD.

NOTES:
PRIOR TO OVERLOT GRADING OR AN
FURTHER DISTURBANCE WITHIN FUTURE
STERLING RANCH EAST FILING NO. 3,
A SEC. PLAN MUST BE REVIEWED AND
APPROVED BY EL PASO COUNTY
SHOWING REMOVAL OF THE STOCKPILE
AREAS, HAUL ROAD AND BORROW PIT.
UNTIL SUCH TIME, DEVELOPER TO
MAINTAIN EROSION CONTROL BMP'S
FOR ALL DISTURBED AREAS.

INSTALL EARTH DIKES AND
DRAINAGE SWALES TO CONVEY
FLOWS TOWARDS THE TEMP.
SWQ POND TO THE WEST.

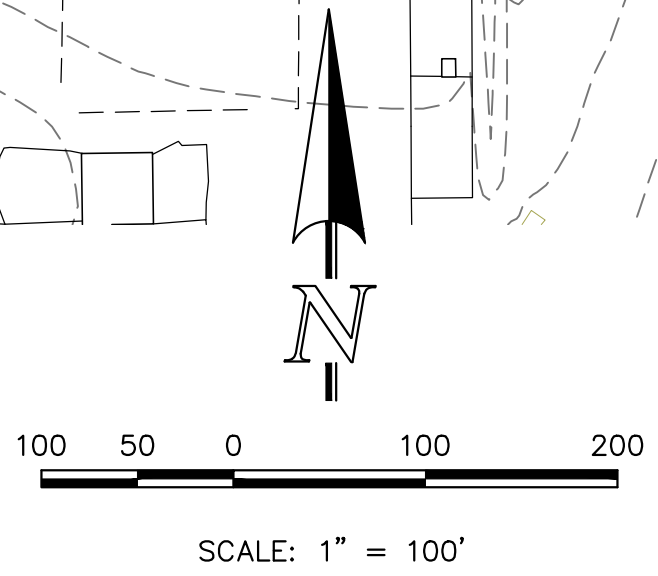

48 HOURS BEFORE YOU DIG,
CALL UTILITY LOCATORS
811
UTILITY NOTIFICATION CENTER OF COLORADO
IT'S THE LAW
THE LOCATIONS OF EXISTING UNDERGROUND UTILITIES ARE
SHOWN IN AN APPROXIMATE WAY ONLY. THE CONTRACTOR
SHALL DETERMINE THE EXACT LOCATION OF ALL EXISTING
UTILITIES BEFORE COMMENCING WORK. THE CONTRACTOR SHALL
BE FULLY RESPONSIBLE FOR ANY AND ALL DAMAGES WHICH
MIGHT BE CAUSED BY HIS FAILURE TO EXACTLY LOCATE AND
PRESERVE ANY AND ALL UNDERGROUND UTILITIES.

NO.	REVISION	DATE

REVIEW:
PREPARED UNDER MY DIRECT SUPERVISION FOR AND ON BEHALF OF
CLASSIC CONSULTING ENGINEERS AND SURVEYORS, LLC
MARC A. WHORTON, REGISTERED PROFESSIONAL ENGINEER #37155
5/6/2024
DATE



STERLING RANCH RD & BRIARGATE PKWY. SEGMENT 2 GESC GRADING AND EROSION CONTROL PLAN ADDENDUM			
DESIGNED BY	MAW	SCALE	DATE 4/29/24
DRAWN BY	MAW	(H) 1" = 100'	SHEET 4A OF 9
CHECKED BY	(V) 1" = N/A	JOB NO.	1183.30

V:\1833\DRAWINGS\CONSTRUCTIVE\GRAVING-EROSION\A\ADDENDUM\GESC SHEET 4.dwg, 5/6/2024 9:04:14 AM, 1:1

