

TEMPORARY SEDIMENT BASIN DESIGN INFO
 TEMPORARY SEDIMENT BASIN
 11.7 AC DRAINAGE AREA AT 500 CF./AC.
 TOTAL REQUIRED STORAGE 1350 CF = 0.13 AC.-FT.
 OUTLET = 6" PVC STANDPIPE W/ (1) COLUMN, (5) ROWS OF HOLES W/4" SPACING, 1" DIAMETER HOLES
 3.0' EXPOSED HEIGHT OF 6" STANDPIPE
 6" WIDE EMERGENCY SPILLWAY
 6" PVC OUTFALL PIPE TO DAYLIGHT DOWNSTREAM
 TOP OF EMBANKMENT 12" MIN. HIGHER THAN SPILLWAY CREST

TEMPORARY SEDIMENT BASIN DESIGN INFO
 TEMPORARY SEDIMENT BASIN
 3.9 AC DRAINAGE AREA AT 500 CF./AC.
 TOTAL REQUIRED STORAGE 1950 CF = 0.045 AC.-FT.
 OUTLET = 6" PVC STANDPIPE W/ (1) COLUMN, (5) ROWS OF HOLES W/4" SPACING, 9/16" DIAMETER HOLES
 3.0' EXPOSED HEIGHT OF 6" STANDPIPE
 6" WIDE EMERGENCY SPILLWAY
 6" PVC OUTFALL PIPE TO DAYLIGHT DOWNSTREAM
 TOP OF EMBANKMENT 12" MIN. HIGHER THAN SPILLWAY CREST

NOTE:
 SEE JR ENG. SHEETS 4-6
 FOR INLET PROTECTION WITHIN
 STERLING RANCH ROAD

NOTES:

PRIOR TO OVERLOT GRADING OR AN FURTHER DISTURBANCE WITHIN FUTURE STERLING RANCH EAST FILING NO. 3, A GEC PLAN MUST BE REVIEWED AND APPROVED BY EL PASO COUNTY SHOWING REMOVAL OF THE STOCKPILE AREAS, HAUL ROAD AND BORROW PIT.
 UNTIL SUCH TIME, DEVELOPER TO MAINTAIN EROSION CONTROL BMP'S FOR ALL DISTURBED AREAS.
 ALL AREAS WITHIN THE LIMITS OF DISTURBANCE EXPECTED TO REMAIN DORMANT FOR LONGER THAN 30 DAYS SHALL BE MULCHED WITHIN 21 DAYS AFTER EARTHWORK ACTIVITY.
 ALL AREAS WITH THE LIMITS OF DISTURBANCE EXPECTED TO REMAIN DORMANT FOR LONGER THAN 60 DAYS SHALL ALSO BE SEED.

LEGEND

- LIMITS OF CONST./DISTURBANCE
- PROPOSED CONTOUR-10
- PROPOSED CONTOUR-2
- EXISTING CONTOUR-10
- EXISTING CONTOUR-2
- EXIST. DIRECTION OF FLOW
- DIRECTION OF FLOW
- HIGH POINT
- LOW POINT
- SILT FENCE
- VEHICLE TRACKING CONTROL
- EARTH DIKES AND SWALES
- TEMPORARY SEDIMENT BASIN
- SEDIMENT CONTROL LOG

EXISTING VEGETATION:
 THE MAJORITY OF THE SITE IS COVERED WITH NATIVE GRASSES AND YUCCA.

NOTE:
 NO BATCH PLANTS ARE PROPOSED ON-SITE.
 SEE JR ENG. SHEETS 4-6 FOR INLET PROTECTION ALONG STERLING RANCH ROAD.

ALL AREAS TO BE RE-SEEDING SHOULD ALSO BE TEMPORARILY STABILIZED WITHIN 14 DAYS OF INACTIVITY VIA SURFACE ROUGHENING OR SOME OTHER MEANS.

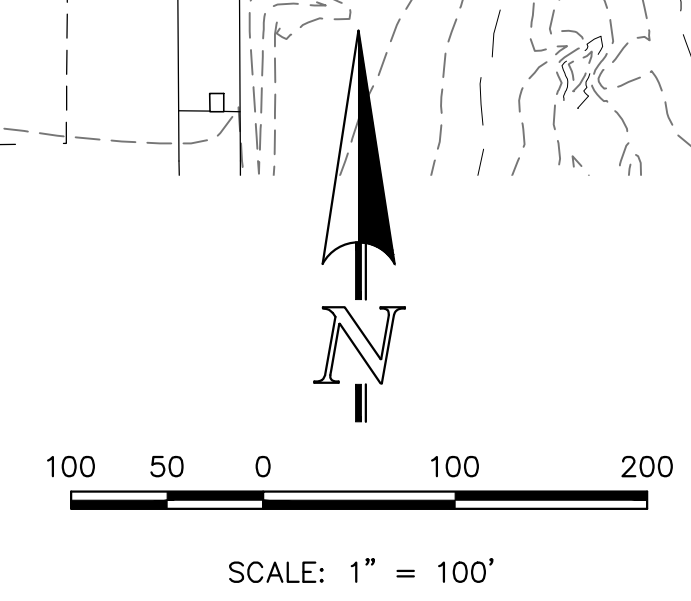

48 HOURS BEFORE YOU DIG,
 CALL UTILITY LOCATORS
811
 UTILITY NOTIFICATION CENTER OF COLORADO
 IT'S THE LAW
 THE LOCATIONS OF EXISTING UNDERGROUND UTILITIES ARE SHOWN IN AN APPROXIMATE WAY ONLY. THE CONTRACTOR SHALL DETERMINE THE EXACT LOCATION OF ALL EXISTING UTILITIES BEFORE COMMENCING WORK. THE CONTRACTOR SHALL BE FULLY RESPONSIBLE FOR ANY AND ALL DAMAGES WHICH MIGHT BE CAUSED BY HIS FAILURE TO EXACTLY LOCATE AND PRESERVE ANY AND ALL UNDERGROUND UTILITIES.

NO.	REVISION	DATE
1	REVISED PER SW COMMENTS/ADDED VILLAGES STOCKPILE AREA	5/30/24

REVIEW:
 PREPARED UNDER MY DIRECT SUPERVISION FOR AND ON BEHALF OF CLASSIC CONSULTING ENGINEERS AND SURVEYORS, LLC
 MARC A. WHORTON, COLORADO P.E. #37155 DATE



STERLING RANCH RD & BRIARGATE PKWY.
 SEGMENT 2 GESC
 GRADING AND EROSION CONTROL PLAN
 ADDENDUM
 DESIGNED BY MAW SCALE DATE 4/29/24
 DRAWN BY MAW (H) 1" = 100' SHEET 4A OF 9
 CHECKED BY (V) 1" = N/A JOB NO. 1183.30

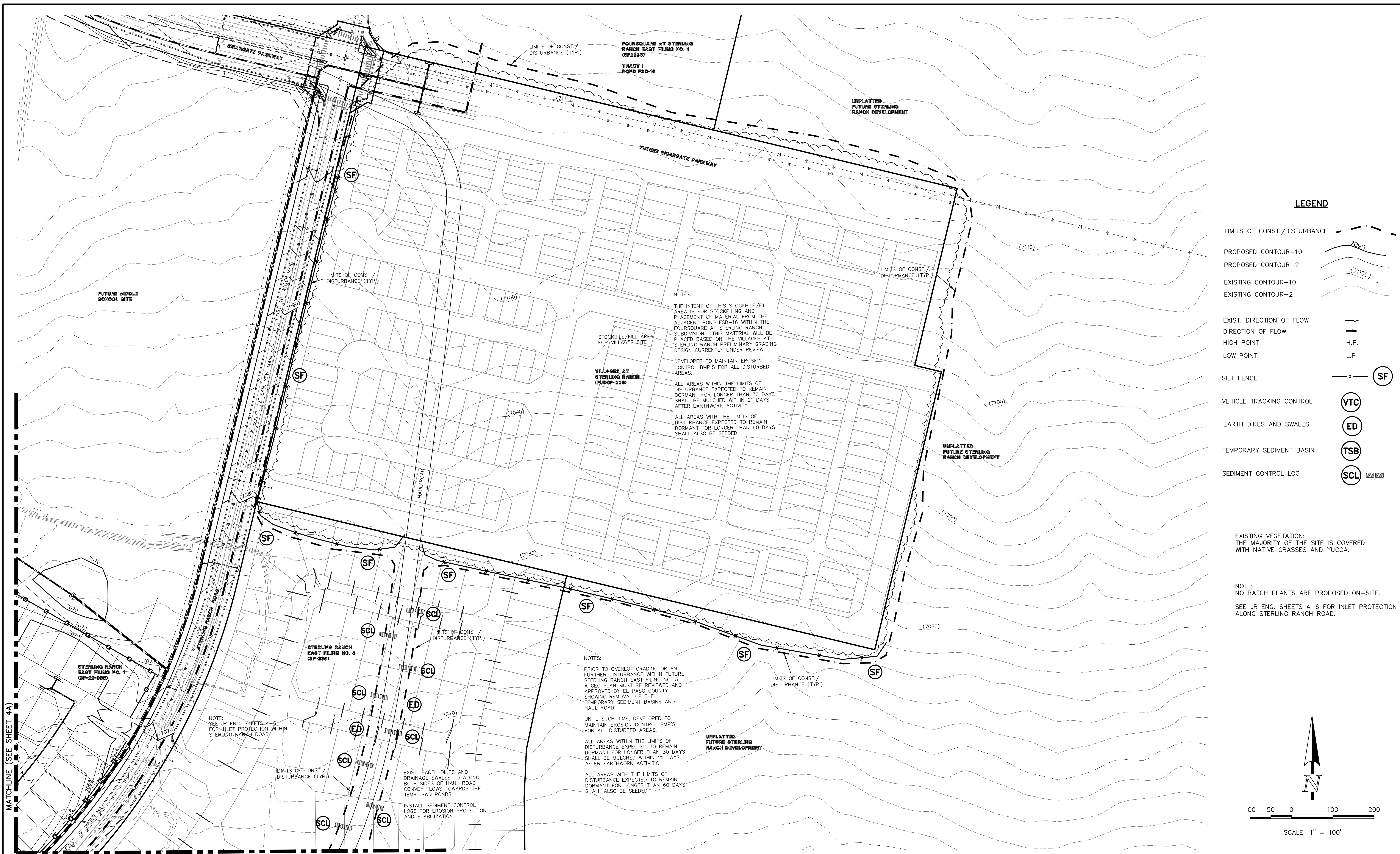

LEGEND

- LIMITS OF CONST./DISTURBANCE
- PROPOSED CONTOUR-10
- PROPOSED CONTOUR-2
- EXISTING CONTOUR-10
- EXISTING CONTOUR-2
- EXIST. DIRECTION OF FLOW
- DIRECTION OF FLOW
- HIGH POINT
- LOW POINT
- SILT FENCE
- VEHICLE TRACKING CONTROL
- EARTH DIKES AND SWALES
- TEMPORARY SEDIMENT BASIN
- SEDIMENT CONTROL LOG

EXISTING VEGETATION:
THE MAJORITY OF THE SITE IS COVERED
WITH NATIVE GRASSES AND YUCCA.

NOTE:
NO BATCH PLANTS ARE PROPOSED ON-SITE.
SEE JR ENG. SHEETS 4-6 FOR INLET PROTECTION
ALONG STERLING RANCH ROAD.

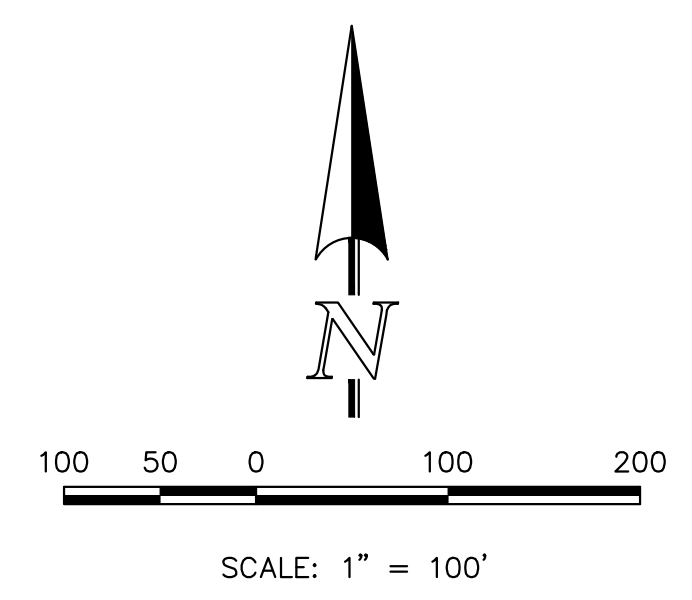

MATCHLINE (SEE SHEET 4A)

MATCHLINE (SEE SHEET 4A)

NOTES:
THE INTENT OF THIS STOCKPILE/FILL AREA IS FOR STOCKPILING AND PLACEMENT OF MATERIAL FROM THE ADJACENT POND FSD-16 WITHIN THE FOURSQUARE AT STERLING RANCH SUBDIVISION. THIS MATERIAL WILL BE PLACED BASED ON THE VILLAGES AT STERLING RANCH PRELIMINARY GRADING DESIGN CURRENTLY UNDER REVIEW.
DEVELOPER TO MAINTAIN EROSION CONTROL BMP'S FOR ALL DISTURBED AREAS.
ALL AREAS WITHIN THE LIMITS OF DISTURBANCE EXPECTED TO REMAIN DORMANT FOR LONGER THAN 30 DAYS SHALL BE MULCHED WITHIN 21 DAYS AFTER EARTHWORK ACTIVITY.
ALL AREAS WITH THE LIMITS OF DISTURBANCE EXPECTED TO REMAIN DORMANT FOR LONGER THAN 60 DAYS SHALL ALSO BE SEEDED.

NOTES:
PRIOR TO OVERLOT GRADING OR AN FURTHER DISTURBANCE WITHIN FUTURE STERLING RANCH EAST FILING NO. 5, A GEO PLAN MUST BE REVIEWED AND APPROVED BY EL PASO COUNTY SHOWING REMOVAL OF THE TEMPORARY SEDIMENT BASINS AND HAUL ROAD.
UNTIL SUCH TIME, DEVELOPER TO MAINTAIN EROSION CONTROL BMP'S FOR ALL DISTURBED AREAS.
ALL AREAS WITHIN THE LIMITS OF DISTURBANCE EXPECTED TO REMAIN DORMANT FOR LONGER THAN 30 DAYS SHALL BE MULCHED WITHIN 21 DAYS AFTER EARTHWORK ACTIVITY.
ALL AREAS WITH THE LIMITS OF DISTURBANCE EXPECTED TO REMAIN DORMANT FOR LONGER THAN 60 DAYS SHALL ALSO BE SEEDED.

NOTE:
SEE JR ENG. SHEETS 4-6 FOR INLET PROTECTION WITHIN STERLING RANCH ROAD.

EXIST. EARTH DIKES AND DRAINAGE SWALES TO ALONG BOTH SIDES OF HAUL ROAD CONVEY FLOWS TOWARDS THE TEMP. SWQ PONDS.
INSTALL SEDIMENT CONTROL LOGS FOR EROSION PROTECTION AND STABILIZATION

48 HOURS BEFORE YOU DIG,
CALL UTILITY LOCATORS
811
UTILITY NOTIFICATION CENTER OF COLORADO
IT'S THE LAW

THE LOCATIONS OF EXISTING UNDERGROUND UTILITIES ARE SHOWN IN AN APPROXIMATE WAY ONLY. THE CONTRACTOR SHALL DETERMINE THE EXACT LOCATION OF ALL EXISTING UTILITIES BEFORE COMMENCING WORK. THE CONTRACTOR SHALL BE FULLY RESPONSIBLE FOR ANY AND ALL DAMAGES WHICH MIGHT BE CAUSED BY HIS FAILURE TO EXACTLY LOCATE AND PRESERVE ANY AND ALL UNDERGROUND UTILITIES.

NO.	REVISION	DATE
1	REVISED PER SW COMMENTS/ADDED VILLAGES STOCKPILE AREA	5/30/24

REVIEW:
PREPARED UNDER MY DIRECT SUPERVISION FOR AND ON BEHALF OF CLASSIC CONSULTING AND SURVEYORS, LLC

MARC A. WHORTON
#37155

6/7/2024
DATE

STERLING RANCH RD & BRIARGATE PKWY. SEGMENT 2 GESC GRADING AND EROSION CONTROL PLAN ADDENDUM			
DESIGNED BY	MAW	SCALE	DATE 4/29/24
DRAWN BY	MAW	(H) 1" = 100'	SHEET 4B OF 9
CHECKED BY	(V) 1" = N/A	JOB NO.	1183.30