

EPC STORMWATER REVIEW COMMENTS  
IN ORANGE BOXES WITH BLACK TEXT

# GRADING AND EROSION CONTROL PLAN

## FOR 168 TRAINING FACILITY

A PORTION OF LAND LOCATED IN SECTION 7, TOWNSHIP 13 SOUTH, RANGE 61 WEST OF THE 6TH PRINCIPAL MERIDIAN,  
EL PASO COUNTY, COLORADO

### LEGEND

---	PROPERTY LINE		
- - - -	EASEMENT LINE - PUBLIC UTILITY & DRAINAGE 10' FRONT, 5' SIDE, 7' REAR (TYP)		
---	LOT LINE		
- - - -	BUILDING SETBACK LINE		
---	ADJACENT PROPERTY LINE		
<b>EXISTING</b>		<b>PROPOSED</b>	
---	INDEX CONTOUR	---	INDEX CONTOUR
---	INTERMEDIATE CONTOUR	---	INTERMEDIATE CONTOUR
[Pattern]	CONCRETE AREA	[Pattern]	CONCRETE AREA
[Pattern]	ASPHALT AREA	[Pattern]	ASPHALT AREA
[Pattern]	CURB AND GUTTER	[Pattern]	CURB AND GUTTER
- - - -	BUILDING/ BUILDING OVERHANG	- - - -	BUILDING/ BUILDING OVERHANG
---	DECK	---	DECK
[Pattern]	RETAINING WALL - SOLID/ ROCK	[Pattern]	RETAINING WALL - SOLID ROCK
○	SIGN	○	SIGN
δ	BOLLARD	δ	BOLLARD
○	WOOD FENCE	86.0 TW	TOP OF WALL/GRADE AT BOTTOM OF WALL
○	CHAIN LINK FENCE	86.85	TOP OF CURB/FLOWLINE
x	BARBED WIRE FENCE	84.24	SPOT ELEVATION
[Symbol]	TREE	FF = 5986.00	FL = FLOWLINE
[Symbol]	SHRUB		TSW = TOP OF SIDEWALK
[Symbol]	ROCK		FINISHED FLOOR ELEVATION
		→	FLOW DIRECTION

P.B., PG. (PLAT BOOK, PAGE)

### COMPANIES AND AGENCIES

- OWNER/DEVELOPER**  
JOHN TAYLOR  
WIGWAM DEVELOPMENT CO., LLC  
2565 MOUNT VERNON DR  
COLORADO SPRINGS, CO 80909  
(719) 896-0866
- CONSULTANT/ENGINEER**  
M.V.E., INC.  
1903 LELARAY STREET, STE 200  
COLORADO SPRINGS, CO 80909  
(719) 635-5736
- EL PASO COUNTY PLANNING  
EPCC PLANNING AND COMMUNITY DEVELOPMENT**  
2880 INTERNATIONAL CIRCLE, SUITE 110  
COLORADO SPRINGS, CO 80910  
(719) 520-6300
- STREETS AND RIGHTS-OF-WAY  
EPC DEPARTMENT OF PUBLIC WORKS**  
3275 AKERS DRIVE  
COLORADO SPRINGS, CO 80922  
(719) 520-6460

### ABBREVIATION LEGEND

- |           |                  |
|-----------|------------------|
| ASPH      | ASPHALT          |
| CONC      | CONCRETE         |
| C & G     | CURB & GUTTER    |
| DET.      | DETAIL           |
| ESMT      | EASEMENT         |
| ME        | MATCH EXISTING   |
| P.B., PG. | PLAT BOOK, PAGE  |
| P/MT      | PAVEMENT         |
| RET. WALL | RETAINING WALL   |
| REC. NO.  | RECEPTION NUMBER |
| R.O.W.    | RIGHT-OF-WAY     |
| SF        | SQUARE FOOT      |
| STBK      | SETBACK          |
| SW        | SIDEWALK         |
| UTIL      | UTILITY          |
| (C)       | CATCH CURB       |
| (S)       | SPILL CURB       |

### SITE DATA

**TAX SCHEDULE NO.**  
1300000712

**CURRENT ADDRESS**  
6954 S CALHAN HIGHWAY  
CALHAN, CO 80808

**CONSTRUCTION SCHEDULE**  
START: WINTER 2024  
FINISH: SPRING 2025

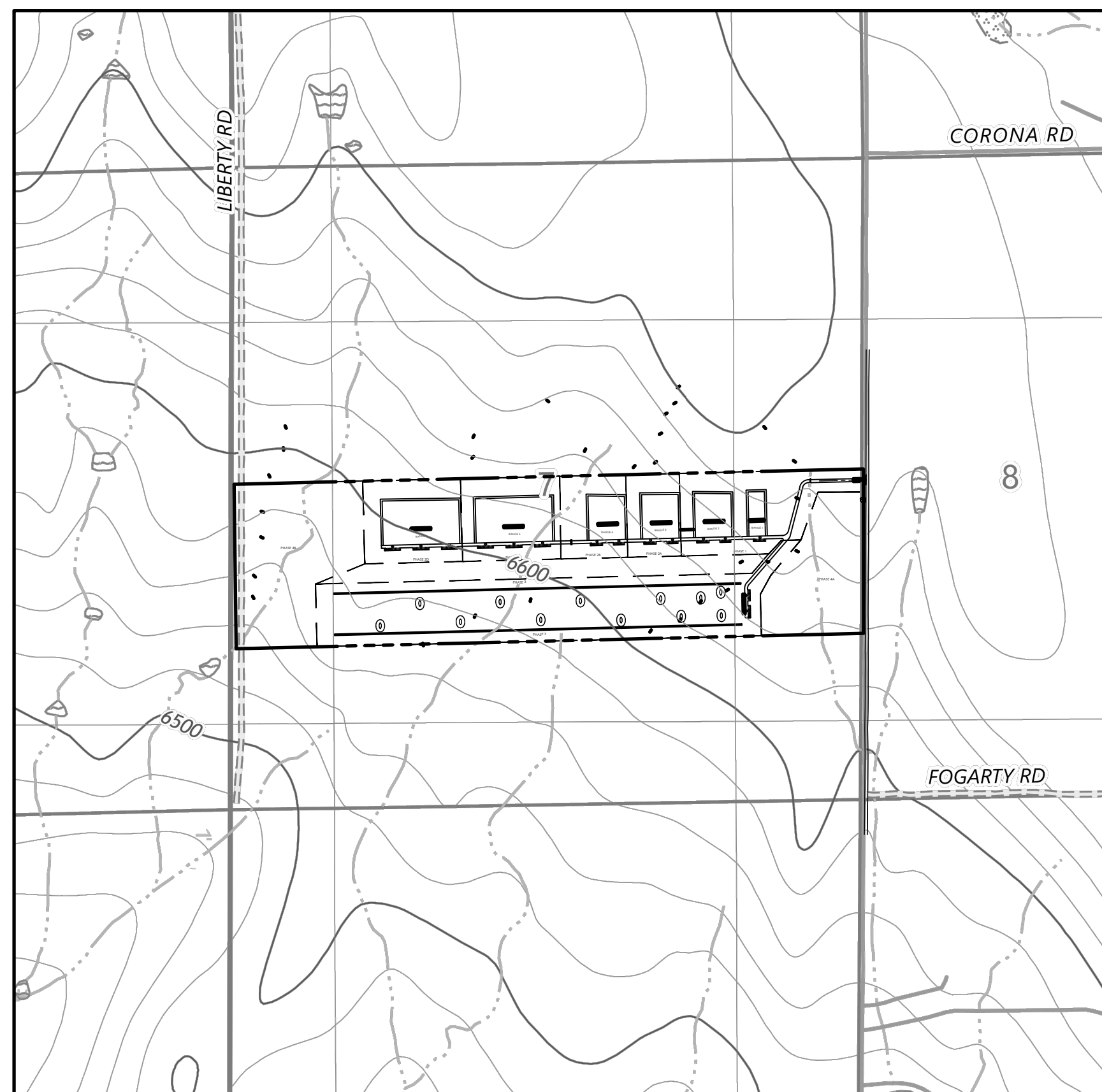

### SITE MAP

SCALE 1" = 100'



### OWNER/DEVELOPER STATEMENT

I, THE OWNER/DEVELOPER HAVE READ AND WILL COMPLY WITH THE REQUIREMENTS OF THE GRADING AND EROSION CONTROL PLAN.

K. MARC FITZWATER DATE  
168 CONSULTING, LLC

### DESIGN ENGINEER'S STATEMENT

THIS GRADING AND EROSION CONTROL PLAN WAS PREPARED UNDER MY DIRECTION AND SUPERVISION AND IS CORRECT TO THE BEST OF MY KNOWLEDGE AND BELIEF. SAID PLAN HAS BEEN PREPARED ACCORDING TO THE CRITERIA ESTABLISHED BY THE COUNTY FOR GRADING AND EROSION CONTROL PLANS. I ACCEPT RESPONSIBILITY FOR ANY LIABILITY CAUSED BY ANY NEGLIGENT ACTS, ERRORS OR OMISSIONS ON MY PART IN PREPARING THIS PLAN.

CHARLES C. CRUM, P.E.  
COLORADO NO. 13348  
FOR AND ON BEHALF OF M.V.E., INC.

### EL PASO COUNTY

COUNTY PLAN REVIEW IS PROVIDED ONLY FOR GENERAL CONFORMANCE WITH COUNTY DESIGN CRITERIA. THE COUNTY IS NOT RESPONSIBLE FOR THE ACCURACY AND ADEQUACY OF THE DESIGN, DIMENSIONS, AND/OR ELEVATIONS WHICH SHALL BE CONFIRMED AT THE JOB SITE. THE COUNTY THROUGH THE APPROVAL OF THIS DOCUMENT ASSUMES NO RESPONSIBILITY FOR COMPLETENESS AND/OR ACCURACY OF THIS DOCUMENT.

FILED IN ACCORDANCE WITH THE REQUIREMENTS OF THE EL PASO COUNTY LAND DEVELOPMENT CODE, DRAINAGE CRITERIA MANUAL, AND ENGINEERING CRITERIA MANUAL AS AMENDED.

IN ACCORDANCE WITH ECM SECTION 1.12, THESE CONSTRUCTION DOCUMENTS WILL BE VALID FOR CONSTRUCTION FOR A PERIOD OF 2 YEARS FROM THE DATE SIGNED BY THE EL PASO COUNTY ENGINEER. IF CONSTRUCTION HAS NOT STARTED WITHIN THOSE 2 YEARS, THE PLANS WILL NEED TO BE RESUBMITTED FOR APPROVAL, INCLUDING PAYMENT OF REVIEW FEES AT THE PLANNING AND COMMUNITY DEVELOPMENT DIRECTORS DISCRETION.

JOSHUA PALMER, P.E.  
COUNTY ENGINEER / ECM ADMINISTRATOR

DATE

PCD FILE NO. PPR2440

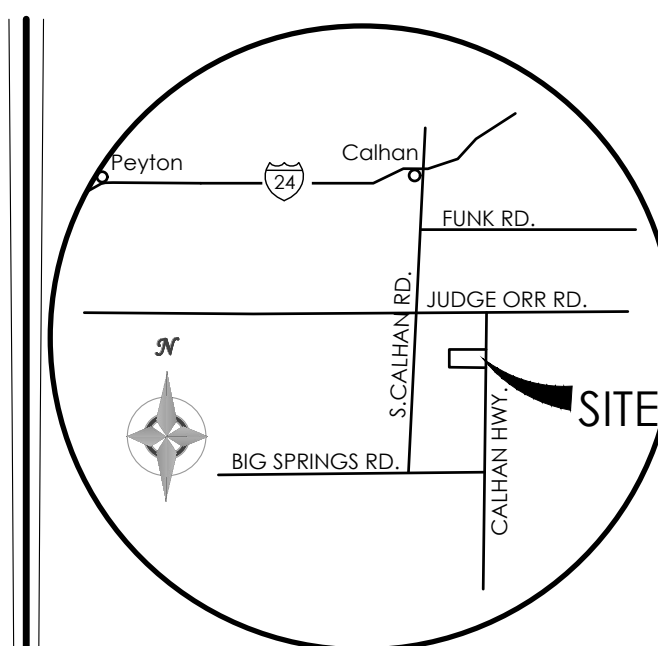

VICINITY MAP  
NOT TO SCALE

BENCHMARK

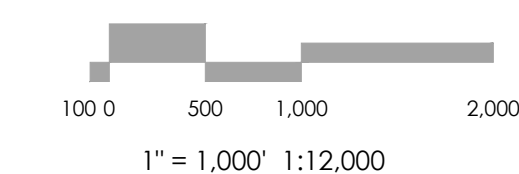
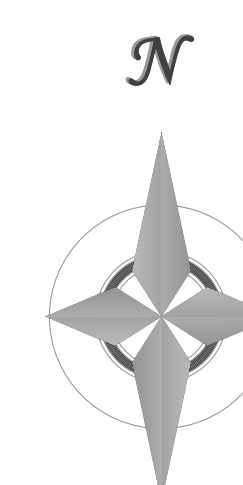

1" = 1,000' 1:12,000



1903 Lelaray Street, Suite 200 Colorado Springs CO 80909 719.635.5736

REVISIONS

DESIGNED BY  
DRAWN BY  
CHECKED BY  
AS-BUILTS BY  
CHECKED BY

+158 Acre Parcel  
168 Training Facility

### GRADING & EROSION CONTROL PLAN COVER SHEET

MVE PROJECT 61224

MVE DRAWING GRADING PLAN

DECEMBER 6, 2024  
SHEET 1 OF 3

### STANDARD EL PASO COUNTY GRADING & EROSION CONTROL PLAN NOTES

- STORMWATER DISCHARGES FROM CONSTRUCTION SITES SHALL NOT CAUSE OR THREATEN TO CAUSE POLLUTION, CONTAMINATION, OR DEGRADATION OF STATE WATERS. ALL WORK AND EARTH DISTURBANCE SHALL BE DONE IN A MANNER THAT MINIMIZES POLLUTION OF ANY ON-SITE OR OFF-SITE WATERS, INCLUDING WETLANDS.
- NOTWITHSTANDING ANYTHING DEPICTED IN THESE PLANS IN WORDS OR GRAPHIC REPRESENTATION, ALL DESIGN AND CONSTRUCTION RELATED TO ROADS, STORM DRAINAGE AND EROSION CONTROL SHALL CONFORM TO THE STANDARDS AND REQUIREMENTS OF THE MOST RECENT VERSION OF THE RELEVANT ADOPTED EL PASO COUNTY STANDARDS, INCLUDING THE LAND DEVELOPMENT CODE, THE ENGINEERING CRITERIA MANUAL, THE DRAINAGE CRITERIA MANUAL, AND THE DRAINAGE CRITERIA MANUAL VOLUME 2. ANY DEVIATIONS FROM REGULATIONS AND STANDARDS MUST BE REQUESTED, AND APPROVED, IN WRITING.
- A SEPARATE STORMWATER MANAGEMENT PLAN (SWMP) FOR THIS PROJECT SHALL BE COMPLETED AND AN EROSION AND STORMWATER QUALITY CONTROL PERMIT (ESQCP) ISSUED PRIOR TO COMMENCING CONSTRUCTION. MANAGEMENT OF THE SWMP DURING CONSTRUCTION IS THE RESPONSIBILITY OF THE DESIGNATED QUALIFIED STORMWATER MANAGER OR CERTIFIED EROSION CONTROL INSPECTOR. THE SWMP SHALL BE LOCATED ON SITE AT ALL TIMES DURING CONSTRUCTION AND SHALL BE KEPT UP TO DATE WITH WORK PROGRESS AND CHANGES IN THE FIELD.
- ONCE THE ESQCP IS APPROVED AND A "NOTICE TO PROCEED" HAS BEEN ISSUED, THE CONTRACTOR MAY INSTALL THE INITIAL STAGE EROSION AND SEDIMENT CONTROL MEASURES AS INDICATED ON THE APPROVED GEC. A PRE-CONSTRUCTION MEETING BETWEEN THE CONTRACTOR, ENGINEER, AND EL PASO COUNTY WILL BE HELD PRIOR TO ANY CONSTRUCTION. IT IS THE RESPONSIBILITY OF THE APPLICANT TO COORDINATE THE MEETING TIME AND PLACE WITH COUNTY STAFF.
- CONTROL MEASURES MUST BE INSTALLED PRIOR TO COMMENCEMENT OF ACTIVITIES THAT COULD CONTRIBUTE POLLUTANTS TO STORMWATER. CONTROL MEASURES FOR ALL SLOPES, CHANNELS, DITCHES, AND DISTURBED LAND AREAS SHALL BE INSTALLED IMMEDIATELY UPON COMPLETION OF THE DISTURBANCE.
- ALL TEMPORARY SEDIMENT AND EROSION CONTROL MEASURES SHALL BE MAINTAINED AND REMAIN IN EFFECTIVE OPERATING CONDITION UNTIL PERMANENT SOIL EROSION CONTROL MEASURES ARE IMPLEMENTED AND FINAL STABILIZATION IS ESTABLISHED. ALL PERSONS ENGAGED IN LAND DISTURBANCE ACTIVITIES SHALL ASSESS THE ADEQUACY OF CONTROL MEASURES AT THE SITE AND IDENTIFY IF CHANGES TO THOSE CONTROL MEASURES ARE NEEDED TO ENSURE THE CONTINUED EFFECTIVE PERFORMANCE OF THE CONTROL MEASURES. ALL CHANGES TO TEMPORARY SEDIMENT AND EROSION CONTROL MEASURES MUST BE INCORPORATED INTO THE STORMWATER MANAGEMENT PLAN.
- TEMPORARY STABILIZATION SHALL BE IMPLEMENTED ON DISTURBED AREAS AND STOCKPILES WHERE GROUND DISTURBING CONSTRUCTION ACTIVITY HAS PERMANENTLY CEASED OR TEMPORARILY CEASED FOR LONGER THAN 14 DAYS.
- FINAL STABILIZATION MUST BE IMPLEMENTED AT ALL APPLICABLE CONSTRUCTION SITES. FINAL STABILIZATION IS ACHIEVED WHEN ALL GROUND DISTURBING ACTIVITIES ARE COMPLETE AND ALL DISTURBED AREAS EITHER HAVE A UNIFORM VEGETATIVE COVER WITH INDIVIDUAL PLANT DENSITY OF 70 PERCENT OF PRE-DISTURBANCE LEVELS ESTABLISHED OR EQUIVALENT PERMANENT ALTERNATIVE STABILIZATION METHOD IS IMPLEMENTED. ALL TEMPORARY SEDIMENT AND EROSION CONTROL MEASURES SHALL BE REMOVED UPON FINAL STABILIZATION AND BEFORE PERMIT CLOSURE.
- ALL PERMANENT STORMWATER MANAGEMENT FACILITIES SHALL BE INSTALLED AS DESIGNED IN THE APPROVED PLANS. ANY PROPOSED CHANGES THAT EFFECT THE DESIGN OR FUNCTION OF PERMANENT STORMWATER MANAGEMENT STRUCTURES MUST BE APPROVED BY THE ECM ADMINISTRATOR PRIOR TO IMPLEMENTATION.
- EARTH DISTURBANCES SHALL BE CONDUCTED IN SUCH A MANNER SO AS TO EFFECTIVELY MINIMIZE ACCELERATED SOIL EROSION AND RESULTING SEDIMENTATION. ALL DISTURBANCES SHALL BE DESIGNED, CONSTRUCTED, AND COMPLETED SO THAT THE EXPOSED AREA OF ANY DISTURBED LAND SHALL BE LIMITED TO THE SHORTEST PRACTICAL PERIOD OF TIME. PRE-EXISTING VEGETATION SHALL BE PROTECTED AND MAINTAINED WITHIN 50 HORIZONTAL FEET OF A WATERBODIES OF THE STATE UNLESS SHOWN TO BE INFEASIBLE AND SPECIFICALLY REQUESTED AND APPROVED.
- COMPACTION OF SOIL MUST BE PREVENTED IN AREAS DESIGNATED FOR INFILTRATION CONTROL MEASURES OR WHERE FINAL STABILIZATION WILL BE ACHIEVED BY VEGETATIVE COVER. AREAS DESIGNATED FOR INFILTRATION CONTROL MEASURES SHALL ALSO BE PROTECTED FROM SEDIMENTATION DURING CONSTRUCTION UNTIL FINAL STABILIZATION IS ACHIEVED. IF COMPACTION PREVENTION IS NOT FEASIBLE DUE TO SITE CONSTRAINTS, ALL AREAS DESIGNATED FOR INFILTRATION AND VEGETATION CONTROL MEASURES MUST BE LOOSENEED PRIOR TO INSTALLATION OF THE CONTROL MEASURE(S).
- ANY TEMPORARY OR PERMANENT FACILITY DESIGNED AND CONSTRUCTED FOR THE CONVEYANCE OF STORMWATER AROUND, THROUGH, OR FROM THE EARTH DISTURBANCE AREA SHALL BE A STABILIZED CONVEYANCE DESIGNED TO MINIMIZE EROSION AND THE DISCHARGE OF SEDIMENT OFF SITE.
- CONCRETE WASH WATER SHALL BE CONTAINED AND DISPOSED OF IN ACCORDANCE WITH THE SWMP. NO WASH WATER SHALL BE DISCHARGED TO OR ALLOWED TO ENTER STATE WATERS, INCLUDING ANY SURFACE OR SUBSURFACE STORM DRAINAGE SYSTEM OR FACILITIES. CONCRETE WASHOUTS SHALL NOT BE LOCATED IN AN AREA WHERE SHALLOW GROUNDWATER MAY BE PRESENT, OR WITHIN 50 FEET OF A SURFACE WATER BODY, CREEK OR STREAM.
- DURING DEWATERING OPERATIONS OF UNCONTAMINATED GROUND WATER MAY BE DISCHARGED ON SITE, BUT SHALL NOT LEAVE THE SITE IN THE FORM OF SURFACE RUNOFF UNLESS AN APPROVED STATE DEWATERING PERMIT IS IN PLACE.
- EROSION CONTROL BLANKETING OR OTHER PROTECTIVE COVERINGS SHALL BE USED ON SLOPES STEEPER THAN 3:1.
- CONTRACTOR SHALL BE RESPONSIBLE FOR THE REMOVAL OF ALL WASTES FROM THE CONSTRUCTION SITE FOR DISPOSAL IN ACCORDANCE WITH LOCAL AND STATE REGULATORY REQUIREMENTS. NO CONSTRUCTION DEBRIS, TREE SLASH, BUILDING MATERIAL, WASTES OR UNUSED BUILDING MATERIALS SHALL BE BURIED, DUMPED, OR DISCHARGED AT THE SITE.
- WASTE MATERIALS SHALL NOT BE TEMPORARILY PLACED OR STORED IN THE STREET, ALLEY, OR OTHER PUBLIC WAY, UNLESS IN ACCORDANCE WITH AN APPROVED TRAFFIC CONTROL PLAN. CONTROL MEASURES MAY BE REQUIRED BY EL PASO COUNTY ENGINEERING IF DEMAED NECESSARY, BASED ON SPECIFIC CONDITIONS AND CIRCUMSTANCES.
- TRACKING OF SOILS AND CONSTRUCTION DEBRIS OFF-SITE SHALL BE MINIMIZED. MATERIALS TRACKED OFF-SITE SHALL BE CLEANED UP AND PROPERLY DISPOSED OF IMMEDIATELY.
- THE OWNER/DEVELOPER SHALL BE RESPONSIBLE FOR THE REMOVAL OF ALL CONSTRUCTION DEBRIS, DIRT, TRASH, ROCK, SEDIMENT, SOIL, AND SAND THAT MAY ACCUMULATE IN ROADS, STORM DRAINS AND OTHER DRAINAGE CONVEYANCE SYSTEMS AND STORMWATER APPURTENANCES AS A RESULT OF SITE DEVELOPMENT.
- THE QUANTITY OF MATERIALS STORED ON THE PROJECT SITE SHALL BE LIMITED, AS MUCH AS PRACTICAL, TO THAT QUANTITY REQUIRED TO PERFORM THE WORK IN AN ORDERLY SEQUENCE. ALL MATERIALS STORED ON-SITE SHALL BE STORED IN A NEAT, ORDERLY MANNER, IN THEIR ORIGINAL CONTAINERS, WITH ORIGINAL MANUFACTURER'S LABELS.
- NO CHEMICAL(S) HAVING THE POTENTIAL TO BE RELEASED IN STORMWATER ARE TO BE STORED OR USED ON-SITE UNLESS PERMISSION FOR THE USE OF SUCH CHEMICAL(S) IS OBTAINED IN WRITING BY THE ECM ADMINISTRATOR. IN GRANTING APPROVAL FOR THE USE OF SUCH CHEMICAL(S), SPECIAL CONDITIONS AND MONITORING MAY BE REQUIRED.
- BULK STORAGE OF ALLOWED PETROLEUM PRODUCTS OR OTHER ALLOWED LIQUID CHEMICALS IN EXCESS OF 55 GALLONS SHALL REQUIRE ADEQUATE SECONDARY CONTAINMENT PROTECTION TO CONTAIN ALL SPILLS ON-SITE AND TO PREVENT ANY SPILLED MATERIALS FROM ENTERING STATE WATERS, ANY SURFACE OR SUBSURFACE STORM DRAINAGE SYSTEM OR OTHER FACILITIES.
- NO PERSON SHALL CAUSE THE IMPEDIMENT OF STORMWATER FLOW IN THE CURB AND GUTTER OR DITCH EXCEPT WITH APPROVED SEDIMENT CONTROL MEASURES.
- OWNER/DEVELOPER AND THEIR AGENTS SHALL COMPLY WITH THE "COLORADO WATER QUALITY CONTROL ACT" (TITLE 25, ARTICLE 6, CRS), AND THE "CLEAN WATER ACT" (33 USC 1344), IN ADDITION TO THE REQUIREMENTS OF THE LAND DEVELOPMENT CODE, DCM VOLUME II AND THE ECM APPENDIX I. ALL APPROPRIATE PERMITS MUST BE OBTAINED BY THE CONTRACTOR PRIOR TO CONSTRUCTION (1041, NPDES, FLOODPLAIN, 404, FUGITIVE DUST, ETC.), IN THE EVENT OF CONFLICTS BETWEEN THESE REQUIREMENTS AND OTHER LAWS, RULES, OR REGULATIONS OF OTHER FEDERAL, STATE, LOCAL, OR COUNTY AGENCIES, THE MOST RESTRICTIVE LAWS, RULES, OR REGULATIONS SHALL APPLY.
- ALL CONSTRUCTION TRAFFIC MUST ENTER/EXIT THE SITE ONLY AT APPROVED CONSTRUCTION ACCESS POINTS.
- PRIOR TO CONSTRUCTION THE PERMITTEE SHALL VERIFY THE LOCATION OF EXISTING UTILITIES.
- A WATER SOURCE SHALL BE AVAILABLE ON SITE DURING EARTHWORK OPERATIONS AND SHALL BE UTILIZED AS REQUIRED TO MINIMIZE DUST FROM EARTHWORK EQUIPMENT AND WIND.
- THE SOILS REPORT FOR THIS SITE HAS BEEN PREPARED BY \_\_\_\_\_ AND SHALL BE CONSIDERED A PART OF THESE PLANS.
- AT LEAST TEN (10) DAYS PRIOR TO THE ANTICIPATED START OF CONSTRUCTION, FOR PROJECTS THAT WILL DISTURB ONE (1) ACRE OR MORE, THE OWNER OR OPERATOR OR CONSTRUCTION ACTIVITY SHALL SUBMIT A PERMIT APPLICATION FOR STORMWATER DISCHARGE TO THE COLORADO DEPARTMENT OF PUBLIC HEALTH AND ENVIRONMENT, WATER QUALITY DIVISION, THE COLORADO DEPARTMENT OF PUBLIC HEALTH AND ENVIRONMENT, WATER QUALITY DIVISION. THE APPLICATION CONTAINS CERTIFICATION OF COMPLETION OF A STORMWATER MANAGEMENT PLAN (SWMP), OF WHICH THIS GRADING AND EROSION CONTROL PLAN MAY BE A PART, FOR INFORMATION OR APPLICATION MATERIALS CONTACT:

COLORADO DEPARTMENT OF PUBLIC HEALTH AND ENVIRONMENT  
WATER QUALITY CONTROL DIVISION  
WQCD - PERMITS  
4300 CHERRY CREEK DRIVE SOUTH  
DENVER, CO 80246-1530  
ATTN: PERMITS UNIT

CALL BEFORE YOU DIG... COLORADO 811

48 HOURS BEFORE YOU DIG, CALL 811 OR 1-800-922-1987 FOR LOCATORS FOR LOCATING AND MARKING GAS, ELECTRIC, WATER AND WASTEWATER.

Unresolved from Submittal 1: Please provide ditch sizing including minimum depth required.

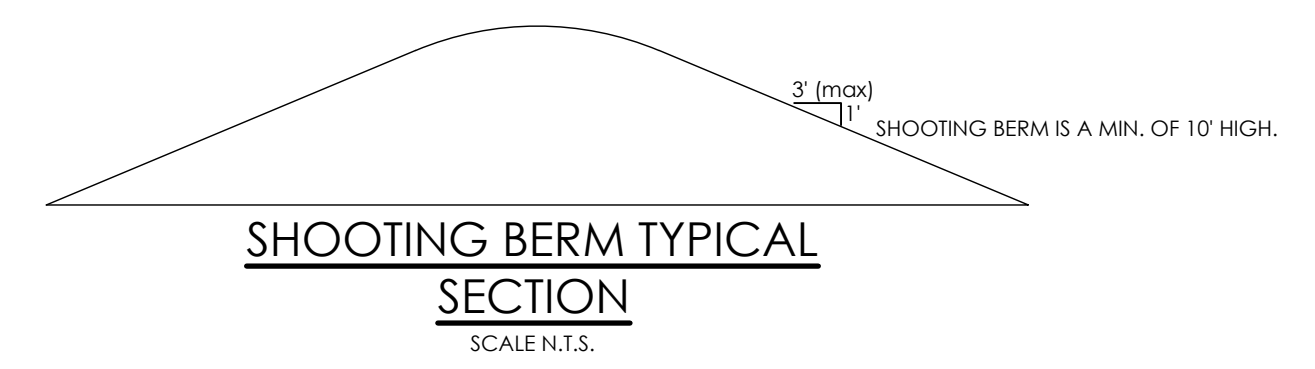
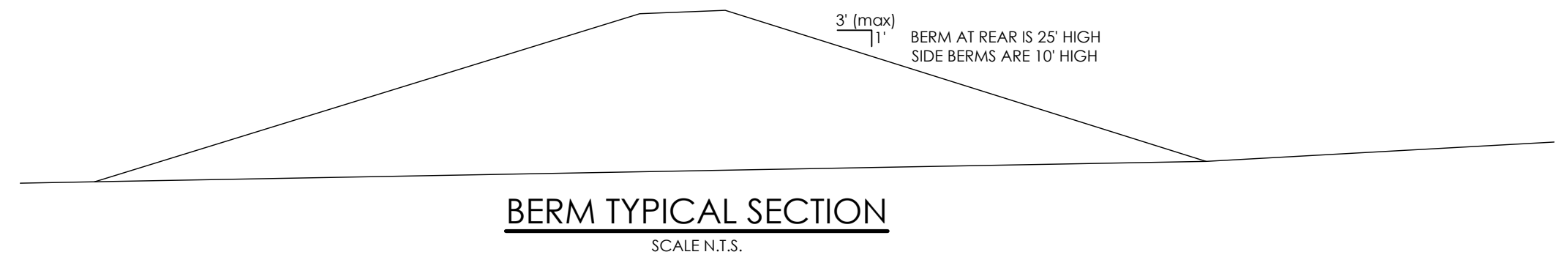
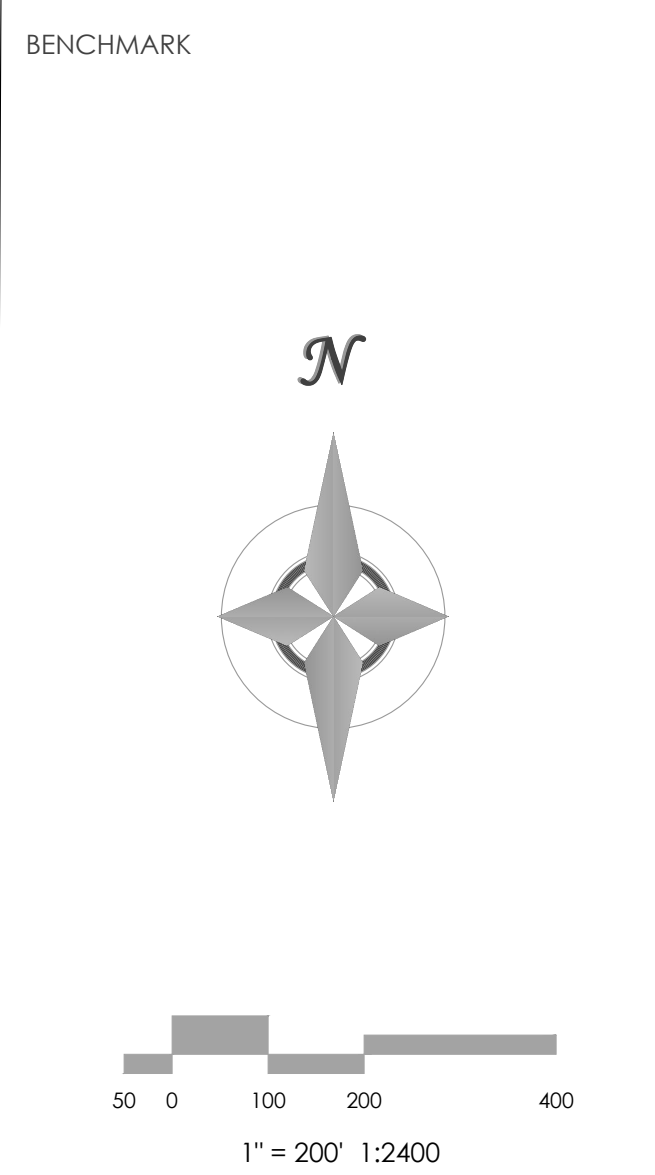
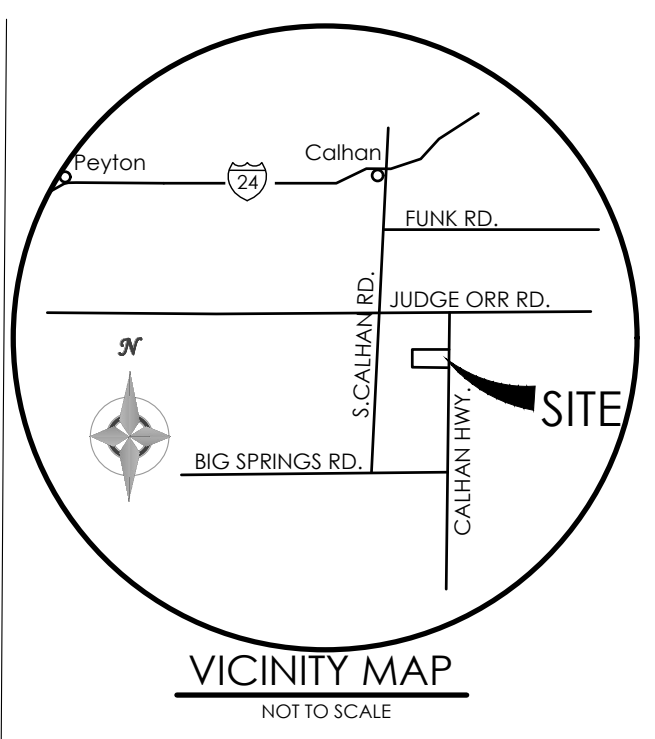
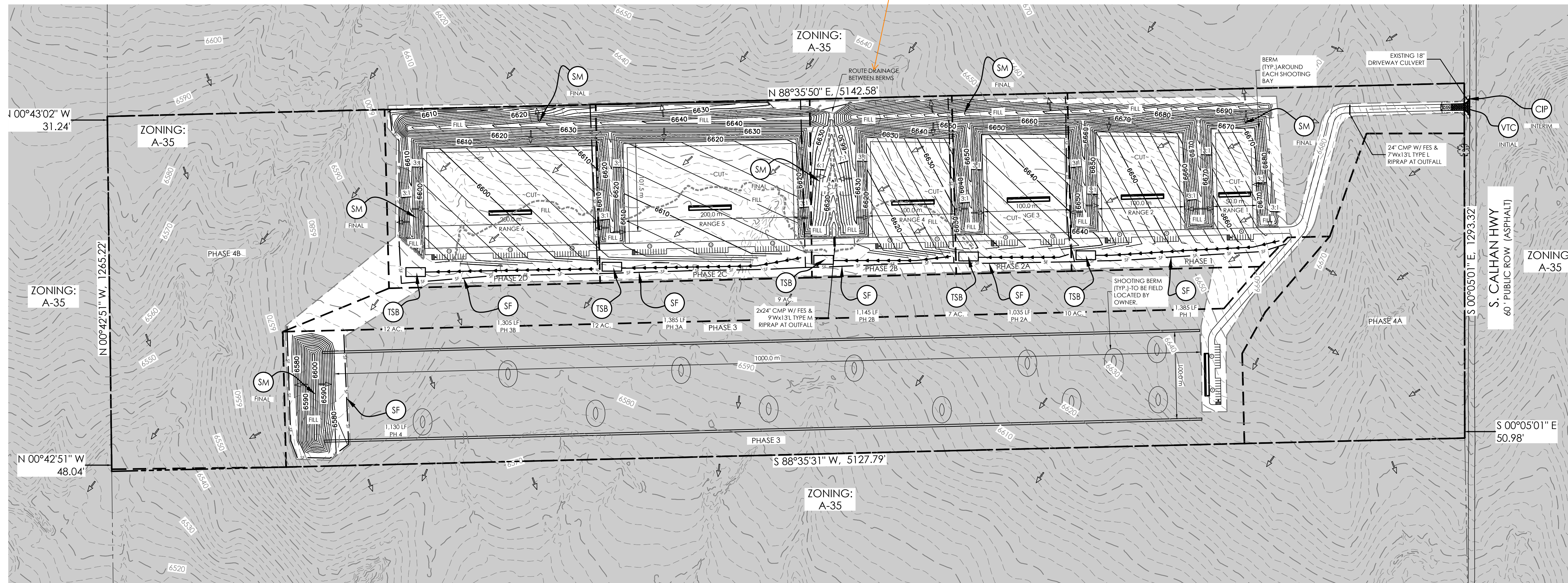

**GRADING NOTES**

- ALL AREAS TO BE GRADED SHALL BE STRIPPED OF TOPSOIL AND THE TOP SOIL SHALL BE STOCK PILED AND PROTECTED. THE TOP SOIL STOCK PILE LOCATION SHALL BE SELECTED BY OWNER.
- BERMS
  - AS PHASES ARE CONSTRUCTED, BERM SLOPES SHALL DAYLIGHT INTO THE EXISTING GROUND AS DIRECTED BY OWNER. FINAL GRADING ON BERM SLOPES SHALL BE 3:1.
  - REPLACE TOPSOIL ON FINAL GRADED BERMS.

**EROSION CONTROL NOTES**

- A STABILIZED STAGING AREA WILL BE DESIGNATED BY THE QUALIFIED STORMWATER MANAGER UPON THE BEGINNING OF CONSTRUCTION ACTIVITIES.
- A STOCKPILE MANAGEMENT PLAN WILL BE IDENTIFIED BY THE QUALIFIED STORMWATER MANAGER UPON THE BEGINNING OF CONSTRUCTION ACTIVITIES.
- THERE ARE NO DEDICATED ASPHALT OR BATCH PLANTS ASSOCIATED WITH THIS PROJECT.

**OTHER DATA**

**LAT/LONG COORDS:** 38°55'56.38"N / 104°15'31.44"W

**VEGETATION:**  
 EXISTING: NATIVE PRAIRIE GRASSES & WEEDS, 75%  
 COVERAGE  
 PROPOSED: PLANTINGS & RESEEDING PER LANDSCAPE PLAN

**APPROX. EARTHWORK QUANTITIES:**  
 175,054 CY CUT, 195,076 CY FILL

**BATCH PLANTS:** NONE

**DEWATERING:** NONE

**DISTURBED AREA:** 55± ACRES

**RECEIVING WATERS:** UPPER BIG SPRINGS CREEK

**SCHEDULE:** SPRING 2025-SUMMER 2025  
 FINAL STABILIZATION FALL 2025

BMP LEGEND		
MAP SYMBOL	KEY	DESCRIPTION
INITIAL BMPs		
	VTC	VEHICLE TRACKING CONTROL (Initial BMP)
	SF	SILT FENCE (Initial BMP)
	IP	CULVERT INLET PROTECTION (Initial BMP)
		LIMITS OF CONSTRUCTION/DISTURBANCE
INTERIM CMs		
	TSB	TEMPORARY SEDIMENT BASIN w/ TEMPORARY SWALE (INTERIM CM)
FINAL CMs		
	SM	SEEDING & MULCHING (FINAL CM)

SYMBOLS SHOWN IN LEGEND SHALL BE USED BY SWMP ADMINISTRATOR TO ANNOTATE ANY CHANGES AND/OR ADDITIONS TO THIS PLAN.

DESIGNED BY \_\_\_\_\_  
 DRAWN BY \_\_\_\_\_  
 CHECKED BY \_\_\_\_\_  
 AS-BUILTS BY \_\_\_\_\_  
 CHECKED BY \_\_\_\_\_

**+158 Acre Parcel**  
 168 Training Facility

**GRADING & EROSION CONTROL PLAN**  
**GRADING PLAN**

MVE PROJECT 61224  
 MVE DRAWING GRADING PLAN

**DECEMBER 6, 2024**  
**SHEET 2 OF 3**

PCD FILE NO. PPR2440



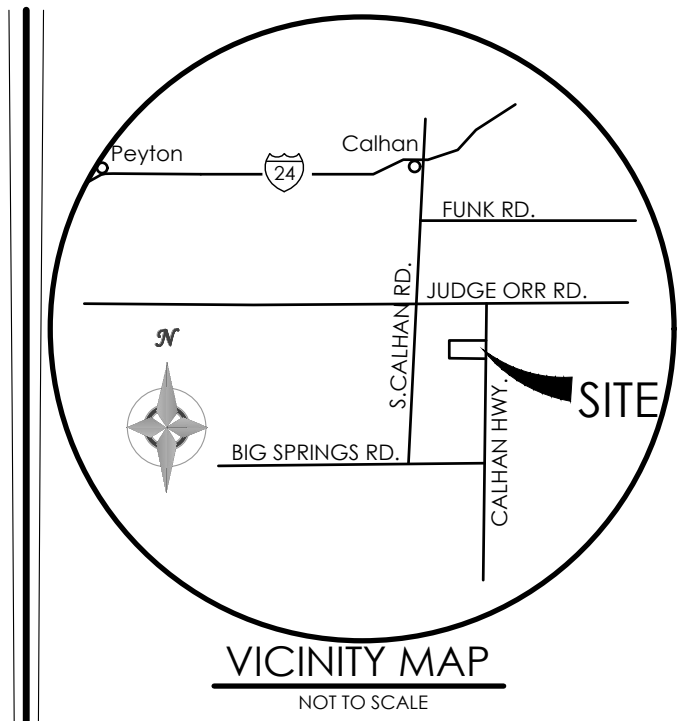
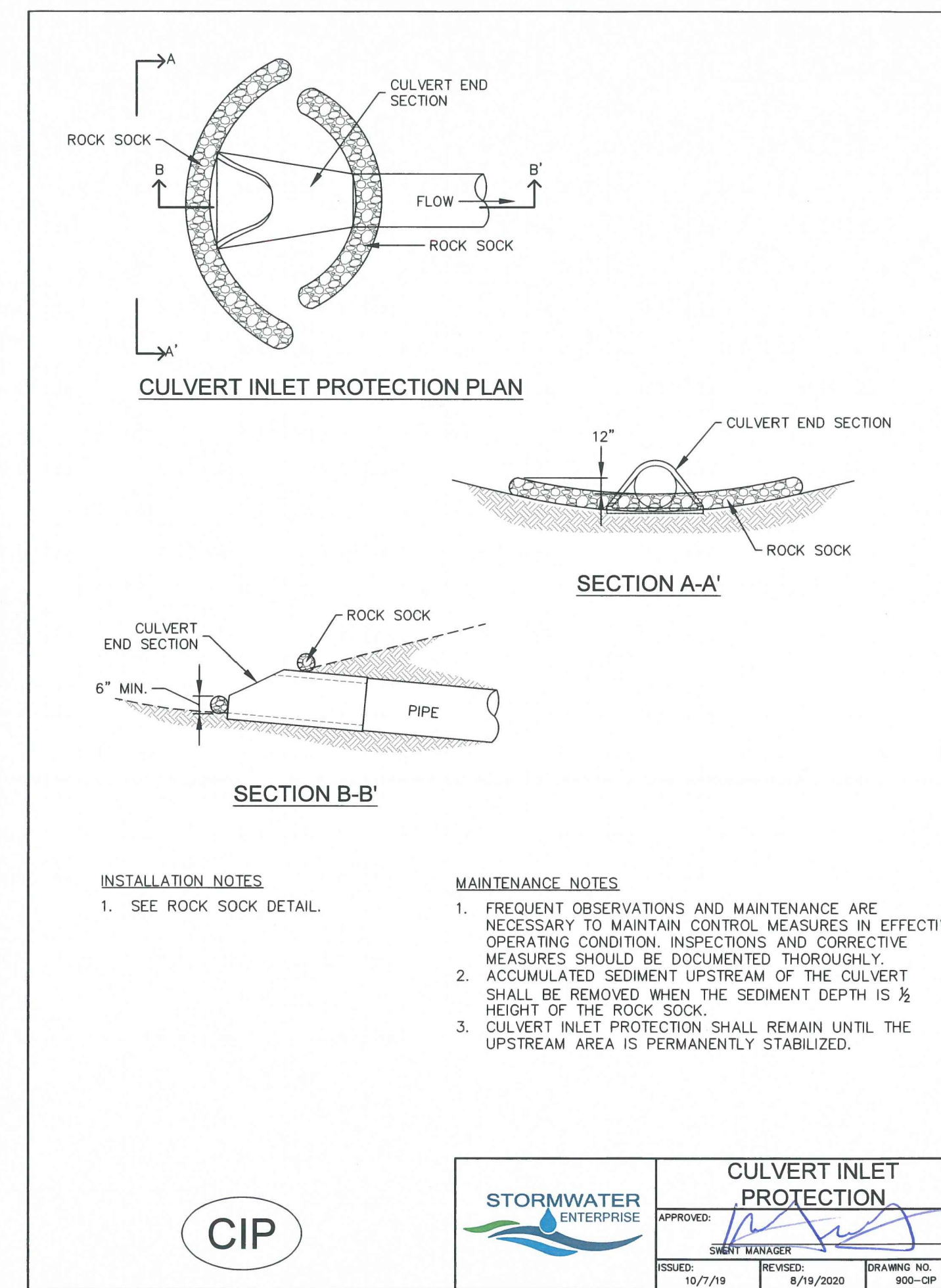
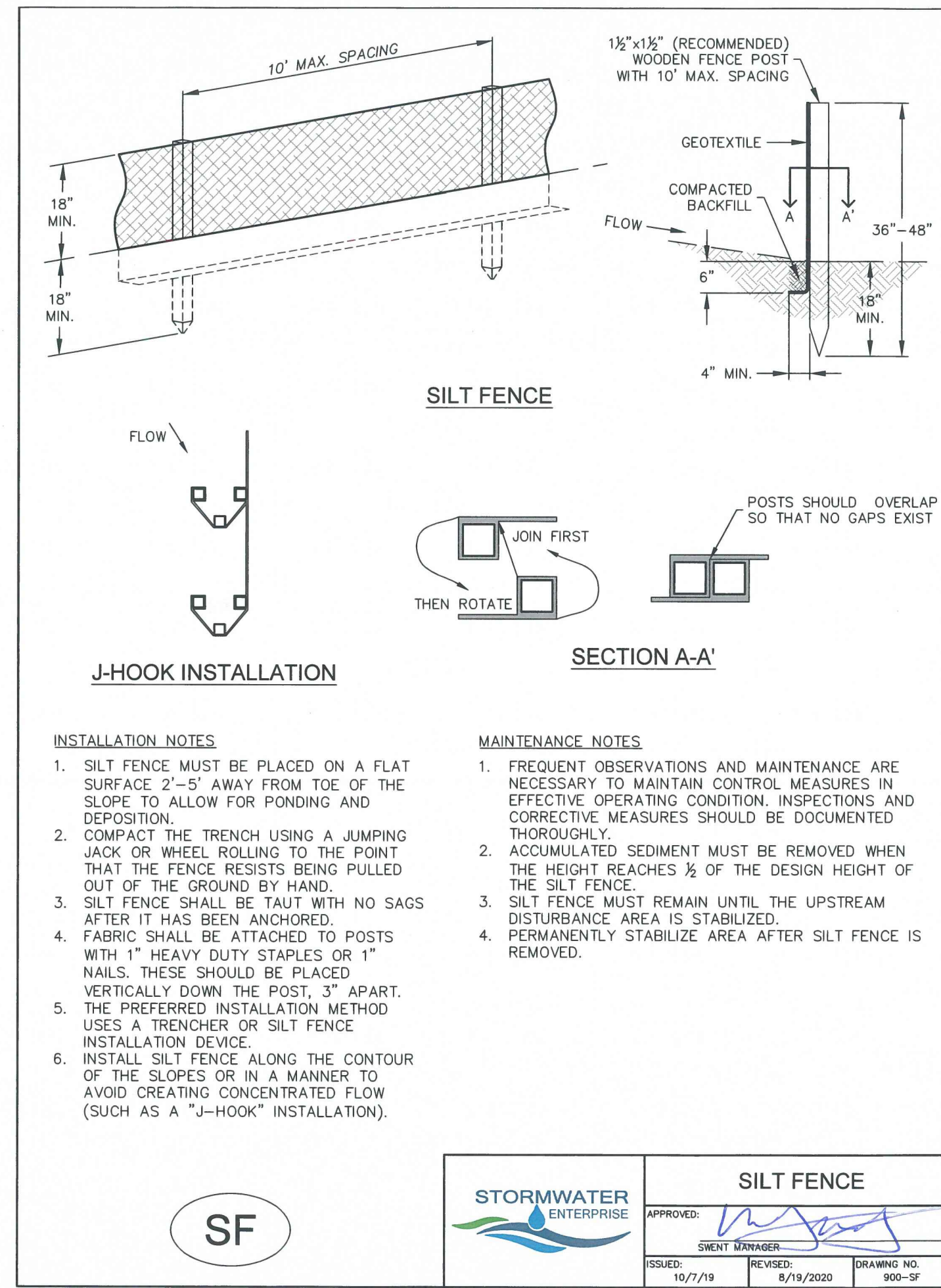
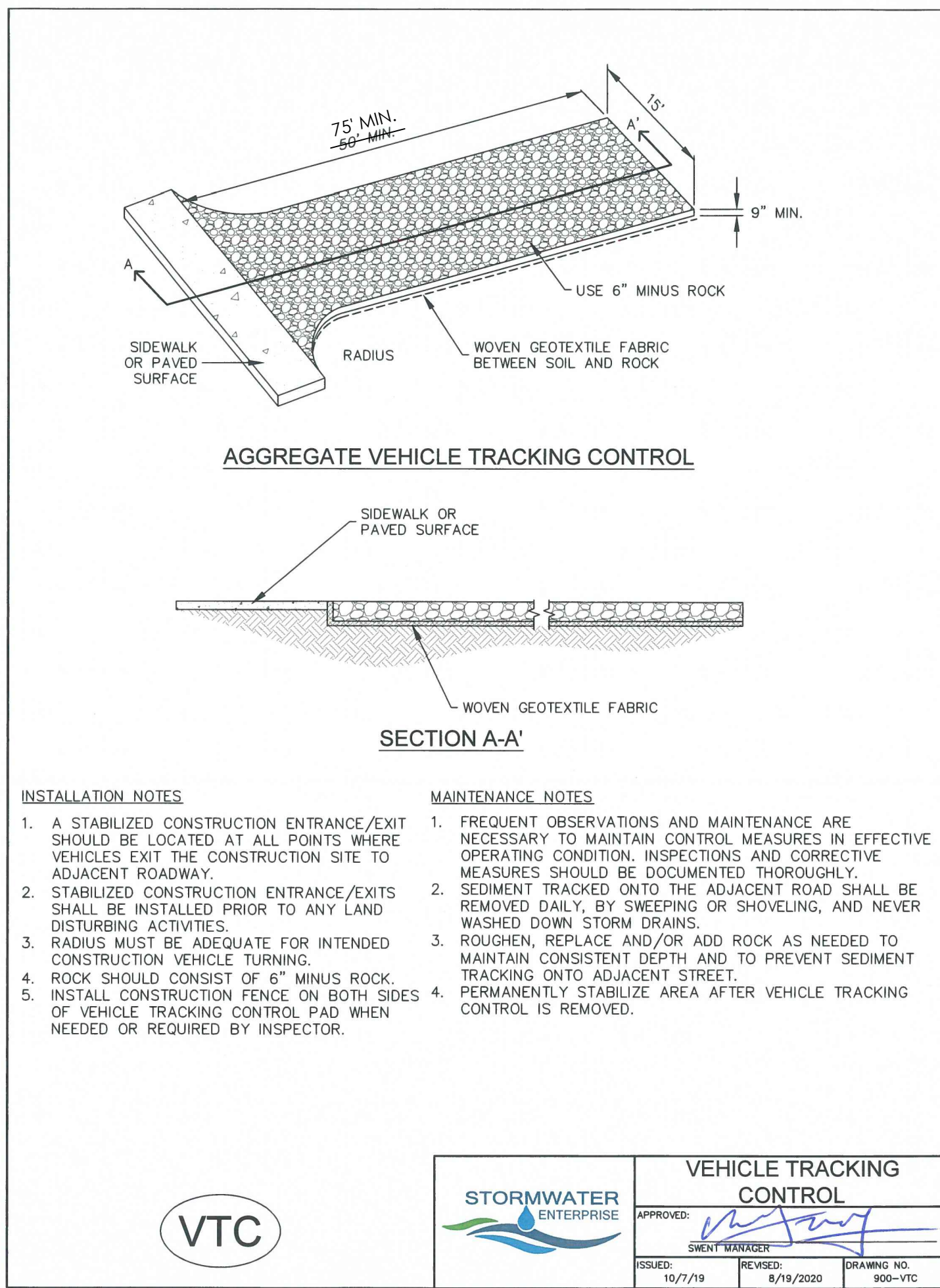

BENCHMARK

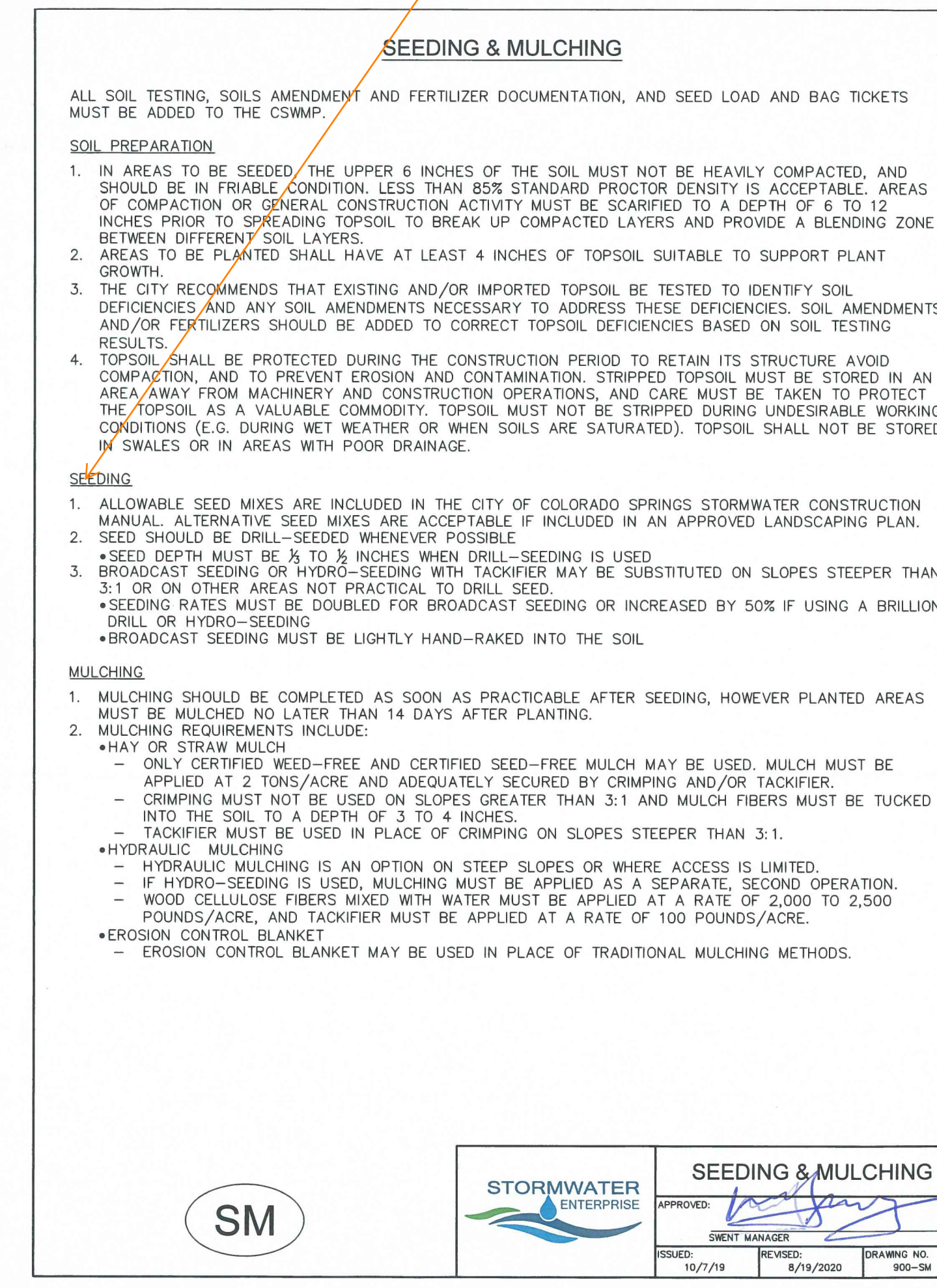
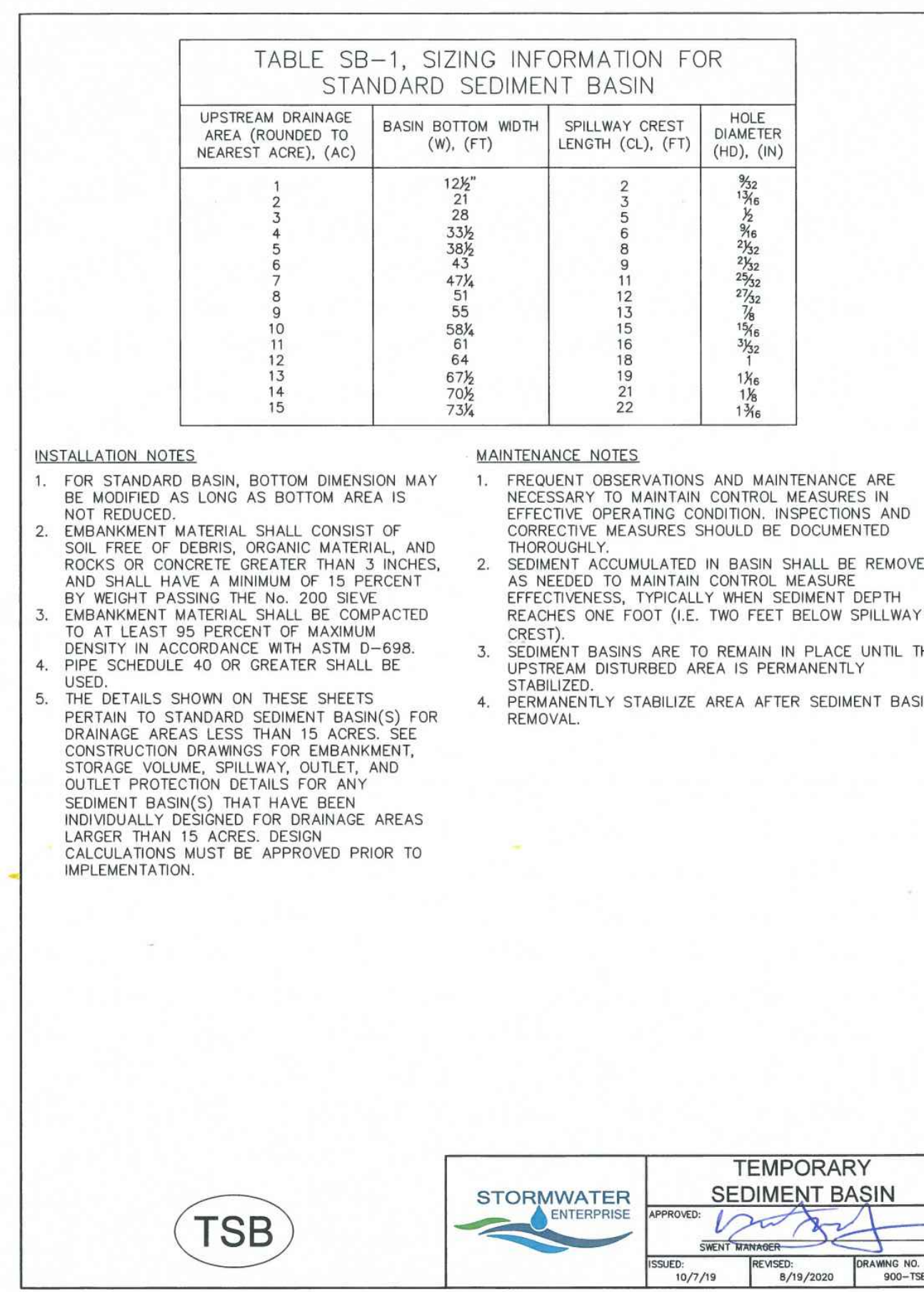
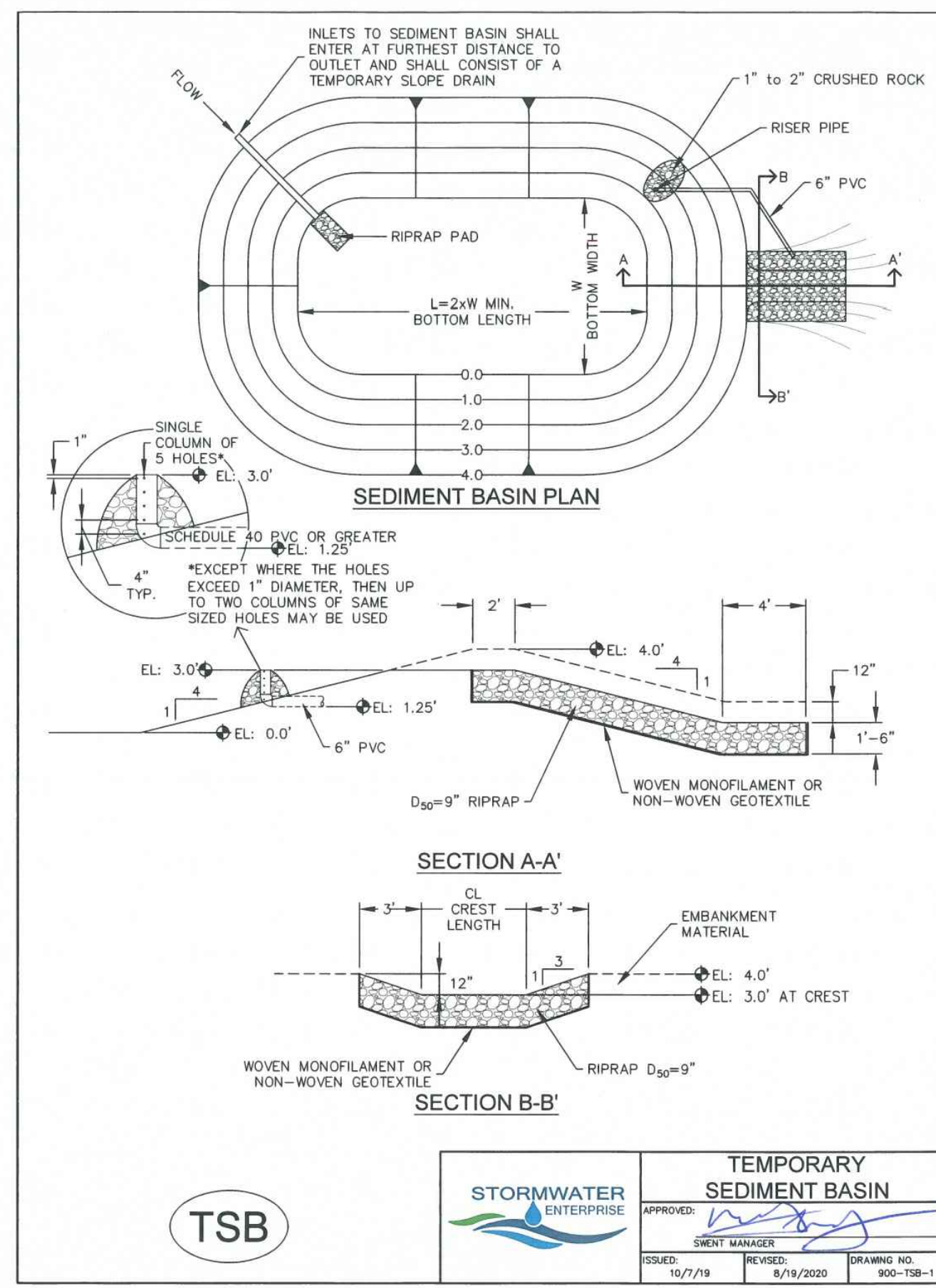
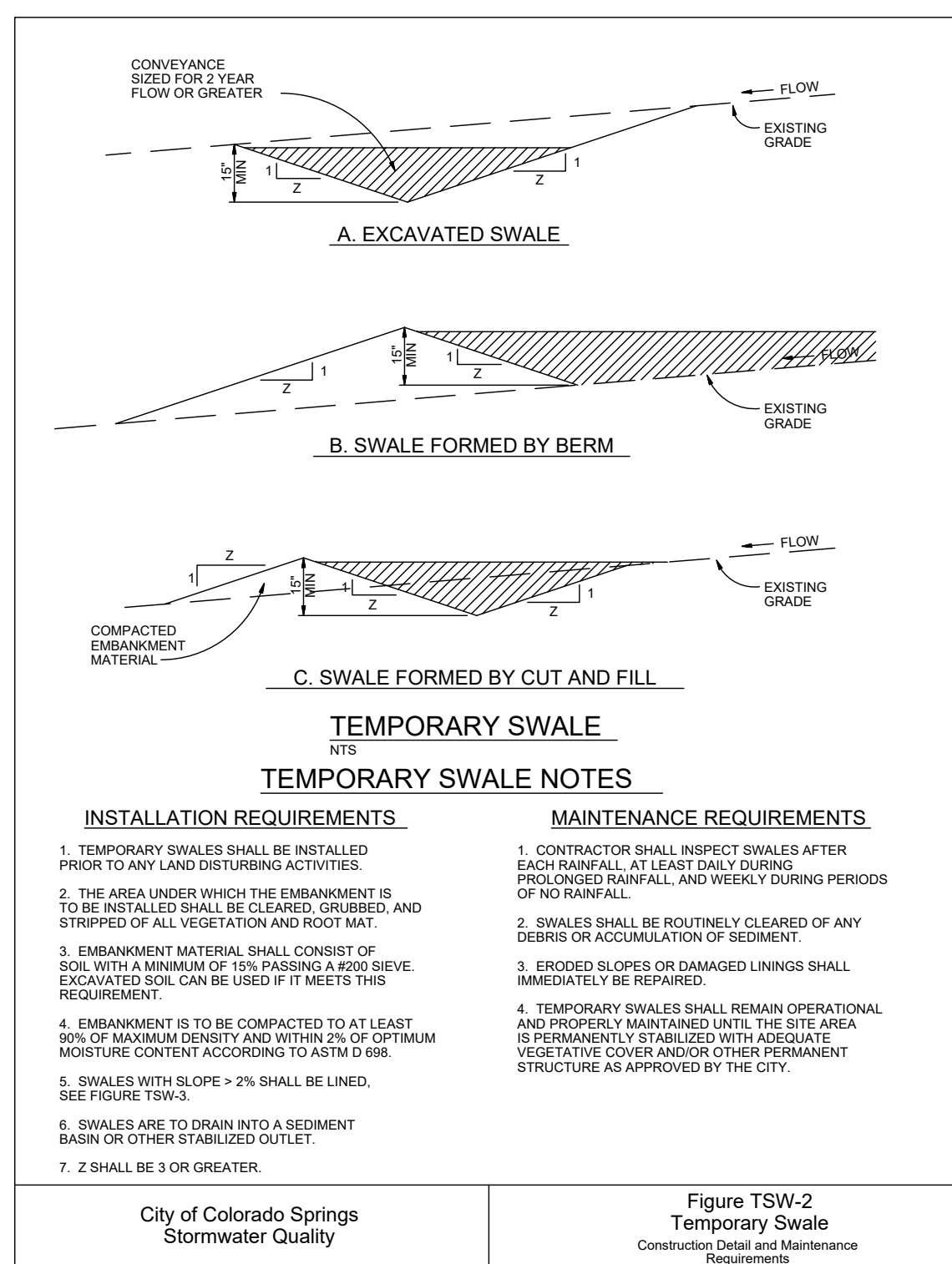
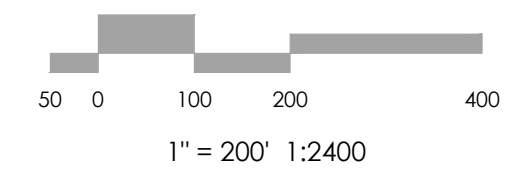
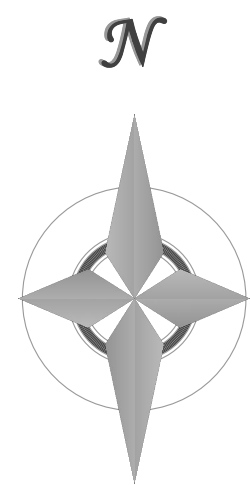

REVISIONS

DESIGNED BY  
DRAWN BY  
CHECKED BY  
AS-BUILT BY  
CHECKED BY

+158 Acre Parcel  
168 Training Facility

GRADING & EROSION  
CONTROL PLAN  
EROSION DETAILS

MVE PROJECT 61224  
MVE DRAWING GRADING PLAN

DECEMBER 6, 2024  
SHEET 3 OF 3

PCD FILE NO. PPR2440

