

EPC STORMWATER REVIEW COMMENTS  
IN ORANGE BOXES WITH BLACK TEXT

# GRADING AND EROSION CONTROL PLAN

## FOR 168 TRAINING FACILITY

6954 S CALHAN HIGHWAY

A PORTION OF LAND LOCATED IN SECTION 7, TOWNSHIP 13 SOUTH, RANGE 61 WEST OF THE 6TH PRINCIPAL MERIDIAN,  
EL PASO COUNTY, COLORADO

### LEGEND

-----	PROPERTY LINE	-----	PROPERTY LINE
- - - - -	EASEMENT LINE - PUBLIC UTILITY & DRAINAGE 10' FRONT, 5' SIDE, 7' REAR (TYP)	-----	EASEMENT LINE - PUBLIC UTILITY & DRAINAGE 10' FRONT, 5' SIDE, 7' REAR (TYP)
-----	LOT LINE	-----	LOT LINE
-----	BUILDING SETBACK LINE	-----	BUILDING SETBACK LINE
-----	ADJACENT PROPERTY LINE	-----	ADJACENT PROPERTY LINE
-----	<b>EXISTING</b>	-----	<b>PROPOSED</b>
-----	INDEX CONTOUR	-----	INDEX CONTOUR
-----	INTERMEDIATE CONTOUR	-----	INTERMEDIATE CONTOUR
[Pattern]	CONCRETE AREA	[Pattern]	CONCRETE AREA
[Pattern]	ASPHALT AREA	[Pattern]	ASPHALT AREA
[Pattern]	CURB AND GUTTER	[Pattern]	CURB AND GUTTER
-----	BUILDING/ BUILDING OVERHANG	-----	BUILDING/ BUILDING OVERHANG
-----	DECK	-----	DECK
-----	RETAINING WALL - SOLID/ ROCK	-----	RETAINING WALL - SOLID ROCK
[Symbol]	SIGN	[Symbol]	SIGN
[Symbol]	BOLLARD	[Symbol]	BOLLARD
[Symbol]	WOOD FENCE	[Symbol]	TOP OF WALL/GRADE AT BOTTOM OF WALL
[Symbol]	CHAIN LINK FENCE	[Symbol]	TOP OF CURB/FLOWLINE
[Symbol]	BARBED WIRE FENCE	[Symbol]	SPOT ELEVATION FL = FLOWLINE TSW = TOP OF SIDEWALK FINISHED FLOOR ELEVATION
[Symbol]	TREE (EVERGREEN/DECIDUOUS)	[Symbol]	FLOW DIRECTION
[Symbol]	SHRUB	[Symbol]	
[Symbol]	ROCK	[Symbol]	
[Symbol]	P.B., PG.	[Symbol]	

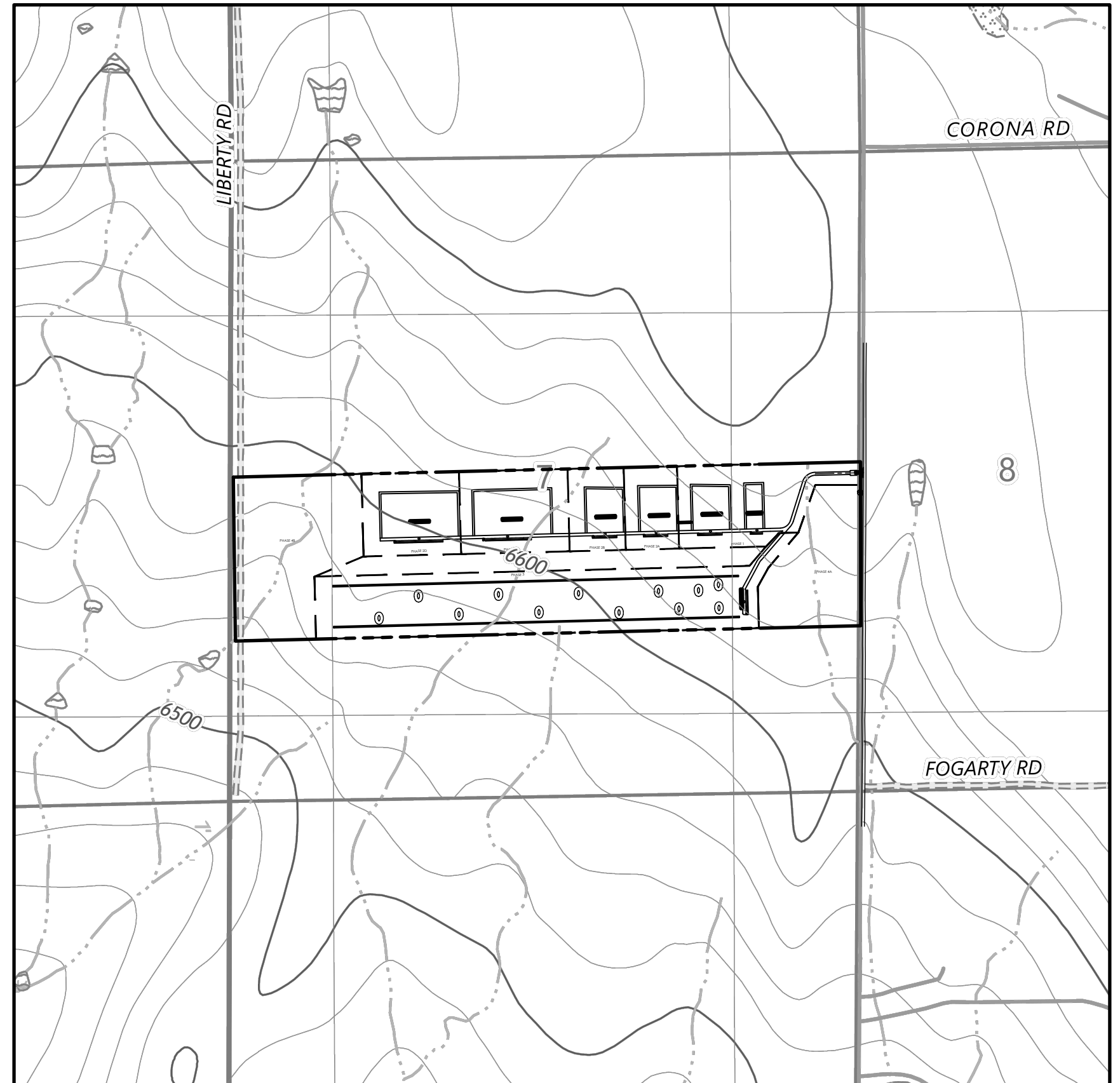

### SITE MAP

SCALE 1" = 100'



### STANDARD EL PASO COUNTY GRADING & EROSION CONTROL PLAN NOTES

- STORMWATER DISCHARGES FROM CONSTRUCTION SITES SHALL NOT CAUSE OR THREATEN TO CAUSE POLLUTION, CONTAMINATION, OR DEGRADATION OF STATE WATERS. ALL WORK AND EARTH DISTURBANCE SHALL BE DONE IN A MANNER THAT MINIMIZES POLLUTION OF ANY ON-SITE OR OFF-SITE WATERS, INCLUDING WETLANDS.
- NOTWITHSTANDING ANYTHING DEPICTED IN THESE PLANS IN WORDS OR GRAPHIC REPRESENTATION, ALL DESIGN AND CONSTRUCTION RELATED TO ROADS, STORM DRAINAGE AND EROSION CONTROL SHALL CONFORM TO THE STANDARDS AND REQUIREMENTS OF THE MOST RECENT VERSION OF THE RELEVANT ADOPTED EL PASO COUNTY STANDARDS, INCLUDING THE LAND DEVELOPMENT CODE, THE ENGINEERING CRITERIA MANUAL, THE DRAINAGE CRITERIA MANUAL, AND THE DRAINAGE CRITERIA MANUAL VOLUME 2. ANY DEVIATIONS FROM REGULATIONS AND STANDARDS MUST BE REQUESTED, AND APPROVED, IN WRITING.
- A SEPARATE STORMWATER MANAGEMENT PLAN (SWMP) FOR THIS PROJECT SHALL BE COMPLETED AND AN EROSION AND STORMWATER QUALITY CONTROL PERMIT (ESQCP) ISSUED PRIOR TO COMMENCING CONSTRUCTION. MANAGEMENT OF THE SWMP DURING CONSTRUCTION IS THE RESPONSIBILITY OF THE DESIGNATED QUALIFIED STORMWATER MANAGER OR CERTIFIED EROSION CONTROL INSPECTOR. THE SWMP SHALL BE LOCATED ON SITE AT ALL TIMES DURING CONSTRUCTION AND SHALL BE KEPT UP TO DATE WITH WORK PROGRESS AND CHANGES IN THE FIELD.
- ONCE THE ESQCP IS APPROVED AND A "NOTICE TO PROCEED" HAS BEEN ISSUED, THE CONTRACTOR MAY INSTALL THE INITIAL STAGE EROSION AND SEDIMENT CONTROL MEASURES AS INDICATED ON THE APPROVED GEC. A PRE-CONSTRUCTION MEETING BETWEEN THE CONTRACTOR, ENGINEER, AND EL PASO COUNTY WILL BE HELD PRIOR TO ANY CONSTRUCTION. IT IS THE RESPONSIBILITY OF THE APPLICANT TO COORDINATE THE MEETING TIME AND PLACE WITH COUNTY STAFF.
- CONTROL MEASURES MUST BE INSTALLED PRIOR TO COMMENCEMENT OF ACTIVITIES THAT COULD CONTRIBUTE POLLUTANTS TO STORMWATER. CONTROL MEASURES FOR ALL SLOPES, CHANNELS, DITCHES, AND DISTURBED LAND AREAS SHALL BE INSTALLED IMMEDIATELY UPON COMPLETION OF THE DISTURBANCE.
- ALL TEMPORARY SEDIMENT AND EROSION CONTROL MEASURES SHALL BE MAINTAINED AND REMAIN IN EFFECTIVE OPERATING CONDITION UNTIL PERMANENT SOIL EROSION CONTROL MEASURES ARE IMPLEMENTED AND FINAL STABILIZATION IS ESTABLISHED. ALL PERSONS ENGAGED IN LAND DISTURBANCE ACTIVITIES SHALL ASSESS THE ADEQUACY OF CONTROL MEASURES AT THE SITE AND IDENTIFY IF CHANGES TO THOSE CONTROL MEASURES ARE NEEDED TO ENSURE THE CONTINUED EFFECTIVE PERFORMANCE OF THE CONTROL MEASURES. ALL CHANGES TO TEMPORARY SEDIMENT AND EROSION CONTROL MEASURES MUST BE INCORPORATED INTO THE STORMWATER MANAGEMENT PLAN.
- TEMPORARY STABILIZATION SHALL BE IMPLEMENTED ON DISTURBED AREAS AND STOCKPILES WHERE GROUND DISTURBING CONSTRUCTION ACTIVITY HAS PERMANENTLY CEASED OR TEMPORARILY CEASED FOR LONGER THAN 14 DAYS.
- FINAL STABILIZATION MUST BE IMPLEMENTED AT ALL APPLICABLE CONSTRUCTION SITES. FINAL STABILIZATION IS ACHIEVED WHEN ALL GROUND DISTURBING ACTIVITIES ARE COMPLETE AND ALL DISTURBED AREAS EITHER HAVE A UNIFORM VEGETATIVE COVER WITH INDIVIDUAL PLANT DENSITY OF 70 PERCENT OF PRE-DISTURBANCE LEVELS ESTABLISHED OR EQUIVALENT PERMANENT ALTERNATIVE STABILIZATION METHOD IS IMPLEMENTED. ALL TEMPORARY SEDIMENT AND EROSION CONTROL MEASURES SHALL BE REMOVED UPON FINAL STABILIZATION AND BEFORE PERMIT CLOSURE.
- ALL PERMANENT STORMWATER MANAGEMENT FACILITIES SHALL BE INSTALLED AS DESIGNED IN THE APPROVED PLANS. ANY PROPOSED CHANGES THAT EFFECT THE DESIGN OR FUNCTION OF PERMANENT STORMWATER MANAGEMENT STRUCTURES MUST BE APPROVED BY THE ECM ADMINISTRATOR PRIOR TO IMPLEMENTATION.
- EARTH DISTURBANCES SHALL BE CONDUCTED IN SUCH A MANNER SO AS TO EFFECTIVELY MINIMIZE ACCELERATED SOIL EROSION AND RESULTING SEDIMENTATION. ALL DISTURBANCES SHALL BE DESIGNED, CONSTRUCTED, AND COMPLETED SO THAT THE EXPOSED AREA OF ANY DISTURBED LAND SHALL BE LIMITED TO THE SHORTEST PRACTICAL PERIOD OF TIME. PRE-EXISTING VEGETATION SHALL BE PROTECTED AND MAINTAINED WITHIN 50 HORIZONTAL FEET OF A WATERBODIES OF THE STATE UNLESS SHOWN TO BE INFEASIBLE AND SPECIFICALLY REQUESTED AND APPROVED.

### STANDARD EL PASO COUNTY CONSTRUCTION PLAN NOTES

- ALL DRAINAGE AND ROADWAY CONSTRUCTION SHALL MEET THE STANDARDS AND SPECIFICATIONS OF THE CITY OF COLORADO SPRINGS/EL PASO COUNTY DRAINAGE CRITERIA MANUAL, VOLUMES 1 AND 2, AND THE EL PASO COUNTY ENGINEERING CRITERIA MANUAL.
- CONTRACTOR SHALL BE RESPONSIBLE FOR THE NOTIFICATION AND FIELD NOTIFICATION OF ALL EXISTING UTILITIES, WHETHER SHOWN ON THE PLANS OR NOT, BEFORE BEGINNING CONSTRUCTION. LOCATION OF EXISTING UTILITIES SHALL BE VERIFIED BY THE CONTRACTOR PRIOR TO CONSTRUCTION. CALL 811 TO CONTACT THE UTILITY NOTIFICATION CENTER OF COLORADO (UNCCC).
- CONTRACTOR SHALL KEEP A COPY OF THESE APPROVED PLANS, THE GRADING AND EROSION CONTROL PLAN, THE STORMWATER MANAGEMENT PLAN (SWMP), THE SOILS AND GEOTECHNICAL REPORT, AND THE APPROVED DESIGN AND CONSTRUCTION STANDARDS AND SPECIFICATIONS AT THE JOB SITE AT ALL TIMES, INCLUDING THE FOLLOWING:
  - EL PASO COUNTY ENGINEERING CRITERIA MANUAL (ECM)
  - CITY OF COLORADO SPRINGS/EL PASO COUNTY DRAINAGE CRITERIA MANUAL, VOLUMES 1 AND 2
  - COLORADO DEPARTMENT OF TRANSPORTATION (CDOT) STANDARD SPECIFICATIONS FOR ROAD AND BRIDGE CONSTRUCTION
  - CDOT M & S STANDARDS
- NOTWITHSTANDING ANYTHING DEPICTED IN THESE PLANS IN WORDS OR GRAPHIC REPRESENTATION, ALL DESIGN AND CONSTRUCTION RELATED TO ROADS, STORM DRAINAGE AND EROSION CONTROL SHALL CONFORM TO THE STANDARDS AND REQUIREMENTS OF THE MOST RECENT VERSION OF THE RELEVANT ADOPTED EL PASO COUNTY STANDARDS, INCLUDING THE LAND DEVELOPMENT CODE, THE ENGINEERING CRITERIA MANUAL, THE DRAINAGE CRITERIA MANUAL, AND THE DRAINAGE CRITERIA MANUAL VOLUME 2. ANY DEVIATIONS FROM REGULATIONS AND STANDARDS MUST BE REQUESTED, AND APPROVED, IN WRITING. ANY MODIFICATIONS NECESSARY TO MEET CRITERIA AFTER-THE-FACT WILL BE ENTIRELY THE DEVELOPER'S RESPONSIBILITY TO RECTIFY.
- IT IS THE DESIGN ENGINEER'S RESPONSIBILITY TO ACCURATELY SHOW EXISTING CONDITIONS, BOTH ON-SITE AND OFF-SITE, ON THE CONSTRUCTION PLANS. ANY MODIFICATIONS NECESSARY DUE TO CONFLICTS, OMISSIONS, OR CHANGED CONDITIONS WILL BE ENTIRELY THE DEVELOPER'S RESPONSIBILITY TO RECTIFY.
- CONTRACTOR SHALL SCHEDULE A PRE-CONSTRUCTION MEETING WITH EL PASO COUNTY PLANNING AND COMMUNITY DEVELOPMENT DEPARTMENT (PCD) - INSPECTIONS, PRIOR TO STARTING CONSTRUCTION.
- IT IS THE CONTRACTOR'S RESPONSIBILITY TO UNDERSTAND THE REQUIREMENTS OF ALL JURISDICTIONAL AGENCIES AND TO OBTAIN ALL REQUIRED PERMITS, INCLUDING BUT NOT LIMITED TO EL PASO COUNTY EROSION AND STORMWATER QUALITY CONTROL PERMIT (ESQCP), REGIONAL BUILDING FLOODPLAIN DEVELOPMENT PERMIT, U.S. ARMY CORPS OF ENGINEERS-ISSUED 401 AND/OR 404 PERMITS, AND COUNTY AND STATE FUGITIVE DUST PERMITS.
- CONTRACTOR SHALL NOT DEVIATE FROM THE PLANS WITHOUT FIRST OBTAINING WRITTEN APPROVAL FROM THE DESIGN ENGINEER AND PCD. CONTRACTOR SHALL NOTIFY THE DESIGN ENGINEER IMMEDIATELY UPON DISCOVERY OF ANY ERRORS OR INCONSISTENCIES.
- ALL STORM DRAIN PIPE SHALL BE CLASS III RCP UNLESS OTHERWISE NOTED AND APPROVED BY PCD.
- CONTRACTOR SHALL COORDINATE GEOTECHNICAL TESTING PER ECM STANDARDS. PAVEMENT DESIGN SHALL BE APPROVED BY EL PASO COUNTY PCD PRIOR TO PLACEMENT OF CURB AND GUTTER AND PAVEMENT.
- ALL CONSTRUCTION TRAFFIC MUST ENTER/EXIT THE SITE AT APPROVED CONSTRUCTION ACCESS POINTS.
- SIGHT VISIBILITY TRIANGLES AS IDENTIFIED IN THE PLANS SHALL BE PROVIDED AT ALL INTERSECTIONS. OBSTRUCTIONS GREATER THAN 18 INCHES ABOVE FLOWLINE ARE NOT ALLOWED WITHIN SIGHT TRIANGLES.
- SIGNING AND STRIPING SHALL COMPLY WITH EL PASO COUNTY PCD AND MUTCD CRITERIA. (IF APPLICABLE, ADDITIONAL SIGNING AND STRIPING NOTES WILL BE PROVIDED.)
- CONTRACTOR SHALL OBTAIN ANY PERMITS REQUIRED BY EL PASO COUNTY PCD, INCLUDING WORK WITHIN THE RIGHT-OF-WAY AND SPECIAL TRANSPORT PERMITS.
- THE LIMITS OF CONSTRUCTION SHALL REMAIN WITHIN THE PROPERTY LINE UNLESS OTHERWISE NOTED. THE OWNER/DEVELOPER SHALL OBTAIN WRITTEN PERMISSION AND EASEMENTS, WHERE REQUIRED, FROM ADJOINING PROPERTY OWNER(S) PRIOR TO ANY OFF-SITE DISTURBANCE, GRADING, OR CONSTRUCTION.

### STANDARD EL PASO COUNTY SIGNING AND STRIPING NOTES

- ALL SIGNS AND PAVEMENT MARKINGS SHALL BE IN COMPLIANCE WITH THE CURRENT MANUAL ON UNIFORM TRAFFIC CONTROL DEVICES (MUTCD).
- REMOVAL OF EXISTING PAVEMENT MARKINGS SHALL BE ACCOMPLISHED BY A METHOD THAT DOES NOT MATERIALLY DAMAGE THE PAVEMENT. THE PAVEMENT MARKINGS SHALL BE REMOVED TO THE EXTENT THAT THEY WILL NOT BE VISIBLE UNDER DAY OR NIGHT CONDITIONS. AT NO TIME WILL IT BE ACCEPTABLE TO PAINT OVER EXISTING PAVEMENT MARKINGS.
- ANY DEVIATION FROM THE STRIPING AND SIGNING PLAN SHALL BE APPROVED BY EL PASO COUNTY PLANNING AND COMMUNITY DEVELOPMENT.
- ALL SIGNS SHOWN ON THE SIGNING AND STRIPING PLAN SHALL BE NEW SIGNS. EXISTING SIGNS MAY REMAIN OR BE REUSED IF THEY MEET CURRENT EL PASO COUNTY AND MUTCD STANDARDS.
- STREET NAME AND REGULATORY STOP SIGNS SHALL BE ON THE SAME POST AT INTERSECTIONS.
- ALL REMOVED SIGNS SHALL BE DISPOSED OF IN A PROPER MANNER BY THE CONTRACTOR.
- ALL STREET NAME SIGNS SHALL HAVE "C" SERIES LETTERS, WITH LOCAL ROADWAY SIGNS BEING 4" UPPER-LOWER CASE LETTERING ON 8" BLANK AND COLLECTOR ROADWAY SIGNS BEING 6" LETTERING, UPPER-LOWER CASE ON 12" BLANK, WITH 1/2" WHITE BORDER THAT IS NOT RECESSED.
- ALL TRAFFIC SIGNS SHALL HAVE A MINIMUM HIGH INTENSITY PRISMATIC GRADE SHEETING.
- ALL LOCAL RESIDENTIAL STREET SIGNS SHALL BE MOUNTED ON A 1.75" X 1.75" SQUARE TUBE SIGN POST AND STUB POST BASE. FOR OTHER APPLICATIONS, REFER TO THE CDOT STANDARD S-614-8 REGARDING USE OF THE P2 TUBULAR STEEL POST SUBBASE DESIGN.
- ALL SIGNS SHALL BE SINGLE SHEET ALUMINUM WITH 0.100" MINIMUM THICKNESS.
- ALL LIMIT LINES/TOP LINES, CROSSWALK LINES, PAVEMENT LEGENDS, AND ARROWS SHALL BE A MINIMUM 125 MIL THICKNESS PREFORMED THERMOPLASTIC PAVEMENT MARKINGS WITH TAPERED LEADING EDGES PER CDOT STANDARD S-627-1. WORDS AND SYMBOL MARKINGS SHALL BE THE NARROW TYPE. STOP BARS SHALL BE 24" IN WIDTH. CROSSWALK LINES SHALL BE 17" WIDE AND 8" LONG PER CDOT S-627-1.
- ALL LONGITUDINAL LINES SHALL BE A MINIMUM 15MIL THICKNESS EPOXY PAINT. ALL NON-LOCAL RESIDENTIAL ROADWAYS SHALL INCLUDE BOTH RIGHT AND LEFT LEGE LINE STRIPING AND ANY ADDITIONAL STRIPING AS REQUIRED BY CDOT S-627-1.
- THE CONTRACTOR SHALL NOTIFY EL PASO COUNTY PLANNING AND COMMUNITY DEVELOPMENT (719) 520-6819 PRIOR TO AND UPON COMPLETION OF SIGNING AND STRIPING.
- THE CONTRACTOR SHALL OBTAIN A WORK IN THE RIGHT OF WAY PERMIT FROM THE EL PASO COUNTY PLANNING AND COMMUNITY DEVELOPMENT DEPARTMENT OF TRANSPORTATION PRIOR TO ANY SIGNAGE OR STRIPING WORK WITHIN AN EXISTING EL PASO COUNTY ROADWAY.

### GENERAL GRADING NOTES

- UNDERGROUND FACILITIES, STRUCTURES AND UTILITIES HAVE BEEN DRAWN FROM AVAILABLE RECORDS AND/OR SURFACE EVIDENCE. THE LOCATION OF ALL UTILITIES MAY NOT BE SHOWN OR MAY NOT HAVE BEEN LOCATED. BELOW GROUND LOCATIONS HAVE NOT BEEN PERFORMED. THEREFORE, THE RELATIONSHIP BETWEEN PROPOSED WORK AND EXISTING FACILITIES, STRUCTURES AND UTILITIES MUST BE CONSIDERED APPROXIMATE. ALL UTILITIES SHALL BE LOCATED PRIOR TO ANY EARTH WORK OR DIGGING (1-800-922-1987). THE CONTRACTOR SHALL BE FULLY RESPONSIBLE FOR ANY AND ALL DAMAGES WHICH MAY BE OCCASIONED BY THE CONTRACTOR'S FAILURE TO EXACTLY LOCATE AND PRESERVE ANY AND ALL UTILITIES.
- CONTRACTOR SHALL BE RESPONSIBLE FOR CONTACTING ALL SUBSURFACE UTILITY OWNERS PRIOR TO BEGINNING WORK TO DETERMINE LOCATION OF UTILITY FACILITIES.
- EXISTING CONDITIONS SHALL BE VERIFIED BY THE GENERAL CONTRACTOR. DISCREPANCIES ARE TO BE REPORTED TO THE ENGINEER PRIOR TO CONSTRUCTION.
- M.V.E., INC. OR THE ENGINEER ASSUMES NO RESPONSIBILITY OR LIABILITY FOR USE OF THIS GRADING PLAN FOR ANY OTHER PURPOSE THAN OVER LOT GRADING OPERATIONS.
- ALL WEEDS, TRUSH, DEBRIS, RUBBLE, BROKEN ASPHALT, ORGANIC MATERIAL (EXCLUDING TOPSOIL) AND REFUSE, OR ANY OTHER MATERIAL WHICH WOULD NOT BE DELETTERED AS FILL MATERIAL OR INCAPABLE OF SUPPORTING THE BUILDING, VEHICULAR AND/OR OVERBURDEN LOADS TO BE IMPOSED SHALL BE CLEARED, GRABBED OR EXCAVATED AS THE CASE MAY DICTATE PRIOR TO GRADING AND SHALL BE REMOVED FROM SITE AND DISPOSED OF LEGALLY.
- CONTOUR INTERVAL FOR EXISTING AND PROPOSED CONTOUR LINES IS 1.0'.
- PROPOSED CONTOURS SHOWN ARE FINISH GRADES AND READ TO TOP OF PAVEMENT AND FINISH SOIL GRADE.
- THE CONTRACTOR SHALL BE RESPONSIBLE TO PROTECT FOUNDATION AREAS FROM, AND AS NECESSARY RESTORE TO GRADE, ANY RUTS, WASHES OR OTHER CHANGES FROM THE DESIGN ELEVATIONS SHOWN HEREON, UNTIL GRADING WORK IS ACCEPTED BY THE OWNER OR OWNER'S REPRESENTATIVE.
- THE CONTRACTOR SHALL ENDEAVOR NOT TO DISTURB ANY OFFSITE AREAS. THE CONTRACTOR SHALL RESTORE TO THE ORIGINAL CONDITION, ADJACENT (OFF-SITE) PROPERTY DISTURBED BY HIS OPERATIONS.
- THE GENERAL CONTRACTOR SHALL STRIP TOPSOIL FROM CONSTRUCTION AREAS AND STOCKPILE TOPSOIL AT AREA SHOWN ON THIS PLAN. PLACE TOPSOIL WITH APPROPRIATE EROSION CONTROL AND IN A MANNER SO AS TO NOT CONFLICT WITH OTHER TRADES AND CONSTRUCTION PROCESS.
- ALL GRADING SHALL BE DONE TO INSURE POSITIVE DRAINAGE AWAY FROM FOUNDATIONS AND STRUCTURES.
- THE GENERAL CONTRACTOR SHALL STRIP TOPSOIL FROM CONSTRUCTION AREAS AND STOCKPILE TOPSOIL AT AREA SHOWN ON THIS PLAN. PLACE TOPSOIL WITH APPROPRIATE EROSION CONTROL AND IN A MANNER SO AS TO NOT CONFLICT WITH OTHER TRADES AND CONSTRUCTION PROCESS.
- ALL GRADING SHALL BE DONE TO INSURE POSITIVE DRAINAGE AWAY FROM FOUNDATIONS AND STRUCTURES.
- MATERIAL OR IN ACCORDANCE WITH APPLICABLE CODES AND THE RECOMMENDATIONS OF THE OWNER'S GEOTECHNICAL ENGINEERING REPORT OR DESIGN.
- PERVIOUS EARTH SURFACES SHALL SLOPE AWAY FROM ALL FOUNDATION WALLS AT A MINIMUM RATE OF 6" IN 10 FEET (5%) FOR THE FIRST 10 FEET ADJACENT TO THE FOUNDATION OR IN ACCORDANCE WITH APPLICABLE CODES AND THE RECOMMENDATIONS OF THE OWNER'S GEOTECHNICAL ENGINEERING REPORT OR DESIGN.
- CONCRETE OR OTHER IMPERVIOUS SURFACES THAT CONTACT FOUNDATION WALLS SHALL SLOPE AWAY FROM ALL FOUNDATION WALLS AT A MINIMUM RATE OF 1/4" PER FOOT (2.00%) OR IN ACCORDANCE WITH APPLICABLE CODES AND THE RECOMMENDATIONS OF THE OWNER'S GEOTECHNICAL ENGINEERING REPORT OR DESIGN.
- ANY FILL MATERIAL REQUIRED TO BRING GRADES UP TO PROPOSED ELEVATIONS SHALL BE PROVIDED BY THE CONTRACTOR.
- THE CONTRACTOR SHALL BE RESPONSIBLE FOR DISTRIBUTING TOPSOIL THROUGHOUT THE LAWN AND PLANTING AREAS ACCORDING TO APPROVED LANDSCAPE PLANS, BY OTHERS.
- THE NATURE OF WORK PROPOSED BY THIS PLAN IS GRADING AND THE EXTENT OF SAID PROPOSED GRADING IS SHOWN BY THE EXISTING AND PROPOSED CONTOURS HEREON.
- CONTRACTOR SHALL USE MECHANICAL METHODS TO GO FROM THE EXISTING TO PROPOSED CONTOURS IN ACCORDANCE WITH THIS GRADING PLAN. QUALITY CONTROL OF SOILS AND GRADING OPERATION WILL BE AS DIRECTED BY OWNERS GEOTECHNICAL ENGINEER. ALL NEW CONSTRUCTION IN THE PUBLIC RIGHT-OF-WAY IS TO CONFORM TO THE SPECIFICATIONS OF EL PASO COUNTY.
- ALL NEW CONSTRUCTION IN THE PUBLIC RIGHT-OF-WAY IS TO CONFORM TO THE SPECIFICATIONS OF EL PASO COUNTY.
- ALL STORM DRAIN OUTSIDE OF THE PUBLIC RIGHT-OF-WAY SHALL BE HDPE WITH SMOOTH INTERIOR AND CORRUGATED EXTERIOR WITH PVC FITTINGS. ALL STORM DRAIN INLETS SHALL BE PRE-CAST. ALL STORM DRAIN CONSTRUCTION IN THE PUBLIC RIGHT-OF-WAY SHALL BE PLACED IN ACCORDANCE WITH EL PASO COUNTY SPECIFICATIONS.
- CONTRACTOR WILL BE RESPONSIBLE FOR SCHEDULING A PRE-CONSTRUCTION MEETING HELD PRIOR TO CONSTRUCTION WITH EPC-PCD, ENGINEER, AND CONTRACTOR IN ATTENDANCE.
- CONTRACTOR IS RESPONSIBLE FOR ALL OF HIS OPERATIONS ON THE SITE. CONTRACTOR SHALL OBSERVE ALL SAFETY AND OSHA REGULATIONS DURING CONSTRUCTION OPERATIONS. TRENCH WIDTHS AND SLOPE ANGLES SHALL BE DETERMINED BY THE CONTRACTOR IN THE FIELD AND ACCORDING TO SAFETY AND OSHA REGULATIONS.

COLORADO DEPARTMENT OF PUBLIC HEALTH AND ENVIRONMENT  
WATER QUALITY CONTROL DIVISION  
WQCD - PERMITS  
4300 CHERRY CREEK DRIVE SOUTH  
DENVER, CO 80246-1530  
ATTN: PERMITS UNIT

### COMPANIES AND AGENCIES

<b>OWNER/DEVELOPER</b>	JOHN TAYLOR WIGWAM DEVELOPMENT CO., LLC 2565 MOUNT VERNON DR COLORADO SPRINGS, CO 80909 (719) 896-0866
<b>CONSULTANT/ENGINEER</b>	M.V.E., INC. 1903 LELARAY STREET, STE 200 COLORADO SPRINGS, CO 80909 (719) 635-5736
<b>EL PASO COUNTY PLANNING</b>	EROSION AND COMMUNITY DEVELOPMENT 2880 INTERNATIONAL CIRCLE, SUITE 110 COLORADO SPRINGS, CO 80910 (719) 520-6300
<b>STREETS AND RIGHTS-OF-WAY</b>	EPC DEPARTMENT OF PUBLIC WORKS 3275 AKERS DRIVE COLORADO SPRINGS, CO 80922 (719) 520-6460

### ABBREVIATION LEGEND

ASPH	ASPHALT
CONC	CONCRETE
C & G	CURB & GUTTER
DET.	DETAIL
ESMT	EASEMENT
ME	MATCH EXISTING
P.B., PG.	PLAT BOOK, PAGE
PVMT	PAVEMENT
RET. WALL	RETAINING WALL
REC. NO.	RECEPTION NUMBER
R.O.W.	RIGHT-OF-WAY
SF	SQUARE FOOT
STBK	SETBACK
SW	SIDEWALK
UTIL	UTILITY
(C)	CATCH CURB
(S)	SPILL CURB

### SITE DATA

<b>TAX SCHEDULE NO.</b>	1300000712
<b>CURRENT ADDRESS</b>	6954 S CALHAN HIGHWAY CALHAN, CO 80808
<b>CONSTRUCTION SCHEDULE</b>	START: WINTER 2024 FINISH: SPRING 2025

### OWNER/DEVELOPER STATEMENT

I, THE OWNER/DEVELOPER HAVE READ AND WILL COMPLY WITH THE REQUIREMENTS OF THE GRADING AND EROSION CONTROL PLAN.

K. MARC FITZWATER DATE  
168 CONSULTING, LLC

### DESIGN ENGINEER'S STATEMENT

THIS GRADING AND EROSION CONTROL PLAN WAS PREPARED UNDER MY DIRECTION AND SUPERVISION AND IS CORRECT TO THE BEST OF MY KNOWLEDGE AND BELIEF. SAID PLAN HAS BEEN PREPARED ACCORDING TO THE CRITERIA ESTABLISHED BY THE COUNTY FOR GRADING AND EROSION CONTROL PLANS. I ACCEPT RESPONSIBILITY FOR ANY LIABILITY CAUSED BY ANY NEGLIGENCE ACTS, ERRORS OR OMISSIONS ON MY PART IN PREPARING THIS PLAN.

CHARLES C. CRUM, P.E.  
COLORADO NO. 13348  
FOR AND ON BEHALF OF M.V.E., INC.

### EL PASO COUNTY

COUNTY PLAN REVIEW IS PROVIDED ONLY FOR GENERAL CONFORMANCE WITH COUNTY DESIGN CRITERIA. THE COUNTY IS NOT RESPONSIBLE FOR THE ACCURACY AND ADEQUACY OF THE DESIGN, DIMENSIONS, AND/OR ELEVATIONS WHICH SHALL BE CONFIRMED AT THE JOB SITE. THE COUNTY THROUGH THE APPROVAL OF THIS DOCUMENT ASSUMES NO RESPONSIBILITY FOR COMPLETENESS AND/OR ACCURACY OF THIS DOCUMENT.

FILED IN ACCORDANCE WITH THE REQUIREMENTS OF THE EL PASO COUNTY LAND DEVELOPMENT CODE, DRAINAGE CRITERIA MANUAL, AND ENGINEERING CRITERIA MANUAL AS AMENDED.

IN ACCORDANCE WITH ECM SECTION 1.12, THESE CONSTRUCTION DOCUMENTS WILL BE VALID FOR CONSTRUCTION FOR A PERIOD OF 2 YEARS FROM THE DATE SIGNED BY THE EL PASO COUNTY ENGINEER. IF CONSTRUCTION HAS NOT STARTED WITHIN THOSE 2 YEARS, THE PLANS WILL NEED TO BE RESUBMITTED FOR APPROVAL, INCLUDING PAYMENT OF REVIEW FEES AT THE PLANNING AND COMMUNITY DEVELOPMENT DIRECTORS DISCRETION.

JOSHUA PALMER, P.E. DATE  
COUNTY ENGINEER / ECM ADMINISTRATOR

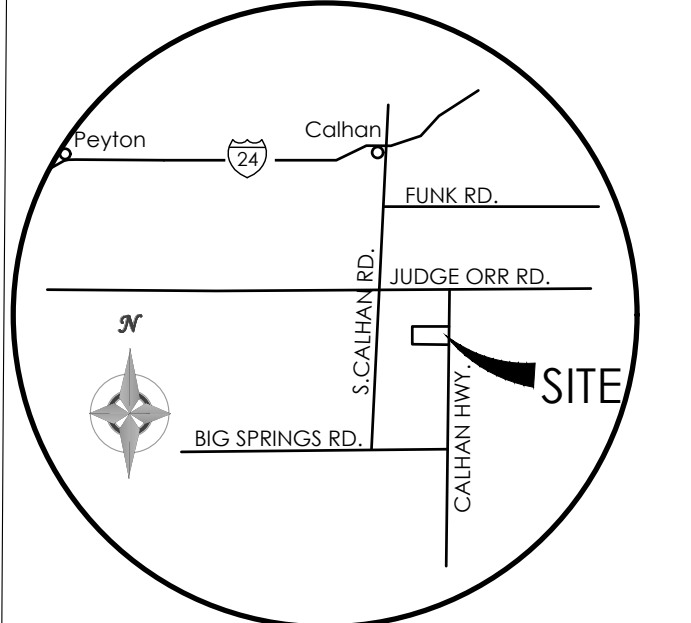

VICINITY MAP  
NOT TO SCALE

BENCHMARK

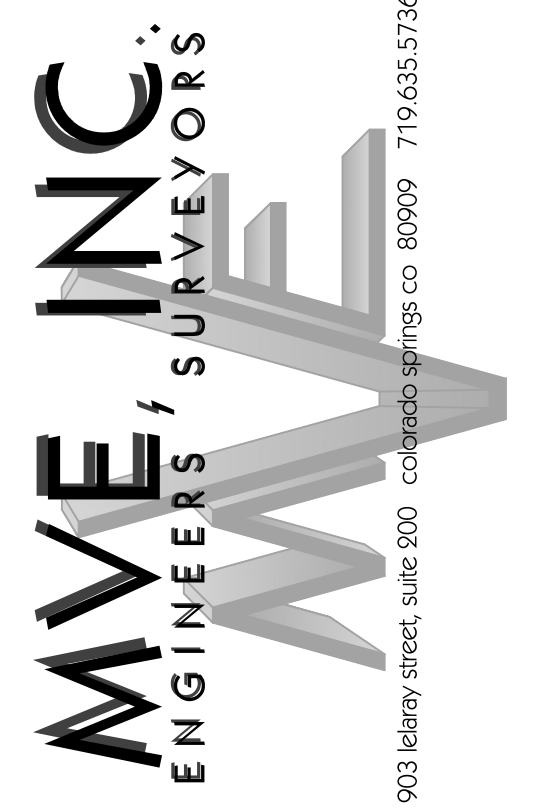
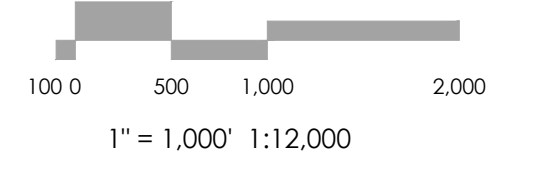
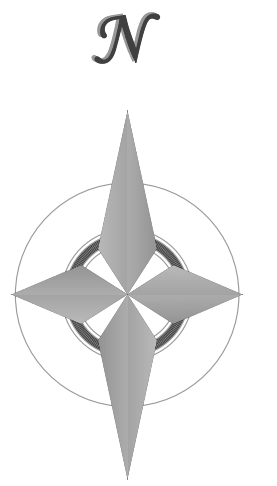

REVISIONS

DESIGNED BY \_\_\_\_\_  
DRAWN BY \_\_\_\_\_  
CHECKED BY \_\_\_\_\_  
AS-BUILTS BY \_\_\_\_\_  
CHECKED BY \_\_\_\_\_

+158 Acre Parcel  
168 Training Facility

## GRADING & EROSION CONTROL PLAN COVER SHEET

MVE PROJECT 61224  
MVE DRAWING GRADING PLAN

OCT. 30, 2024  
SHEET 1 OF 2

CALL BEFORE YOU DIG... COLORADO 811 48 HOURS BEFORE YOU DIG. CALL 811 OR 1-800-922-1987 FOR LOCATORS FOR LOCATING AND MARKING GAS, ELECTRIC, WATER AND WASTEWATER.

PCD FILE NO. PPR2440

GEC Checklist item p - identify areas of cut/fill  
 GEC Checklist item s - show stormwater flow direction arrows  
 GEC Checklist item x - Provide TSBs for disturbed areas greater than 1 ac

Please provide ditch sizing including minimum depth required.

Callout proposed culvert size and inverts. Provide culvert calcs in the drainage report and riprap at the outfall as needed for erosion protection.

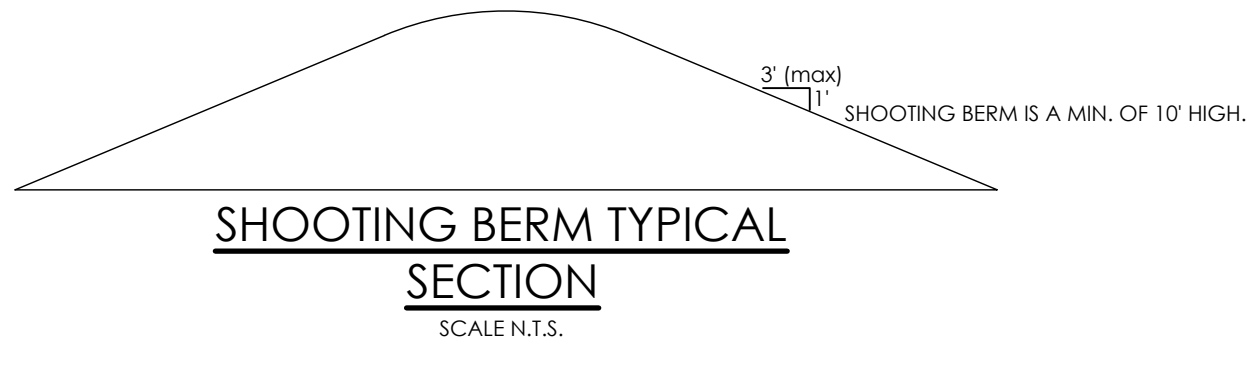
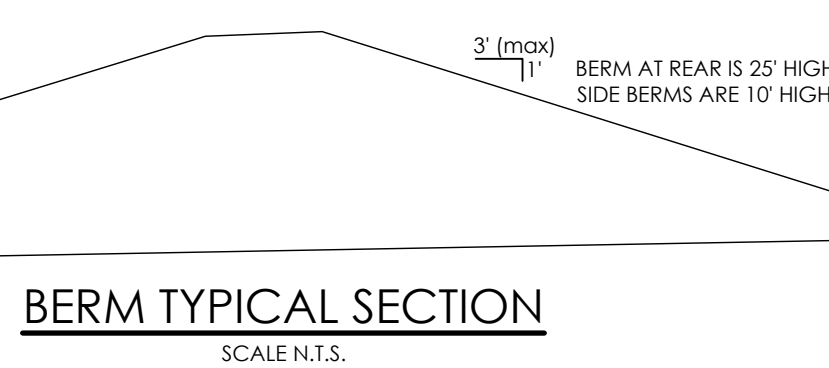
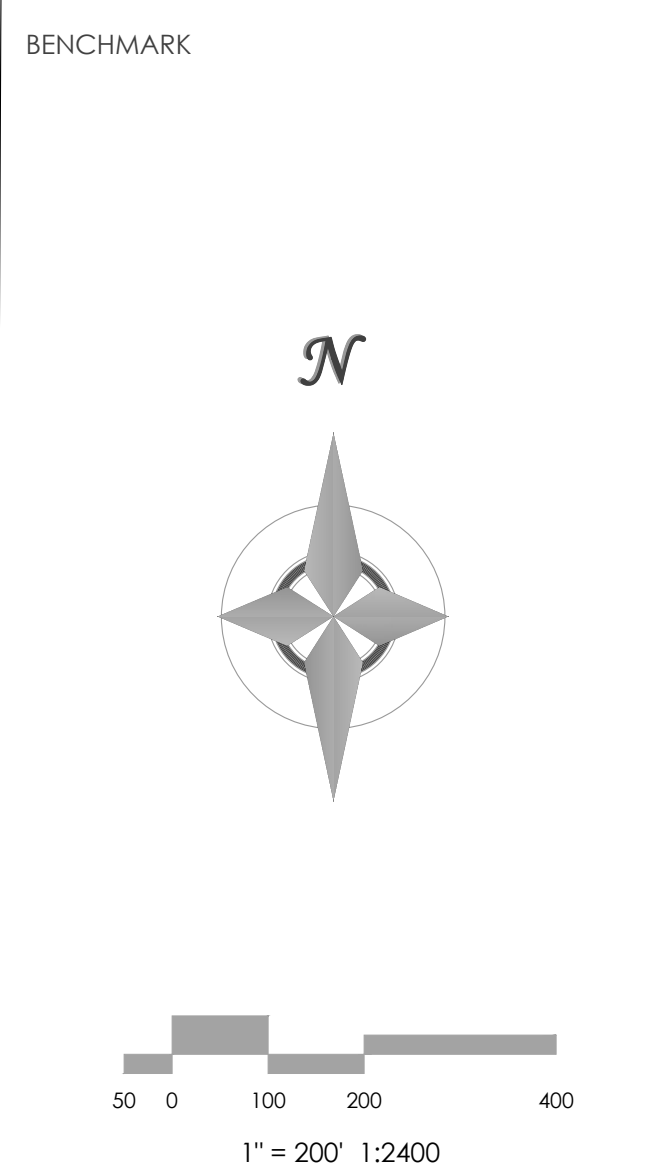
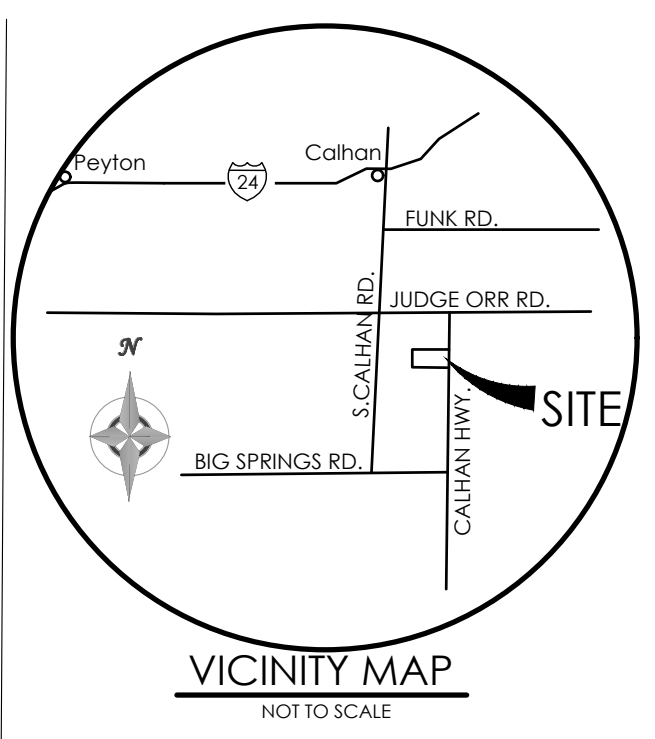
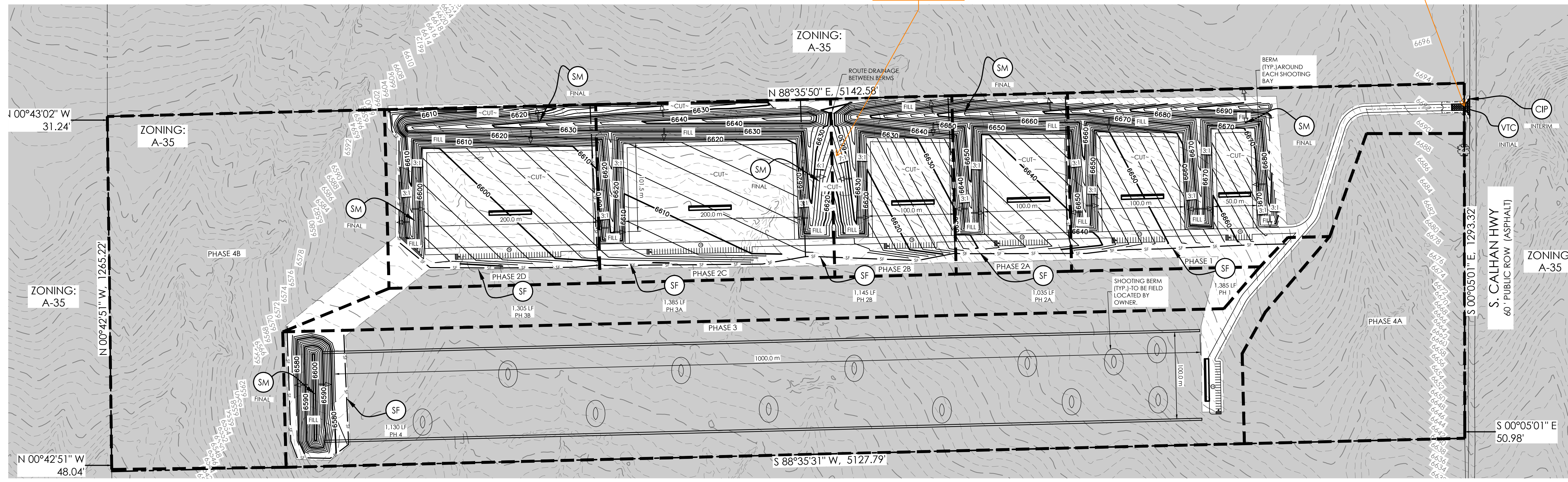

**GRADING NOTES**

- ALL AREAS TO BE GRADED SHALL BE STRIPPED OF TOPSOIL AND THE TOP SOIL SHALL BE STOCK PILED AND PROTECTED. THE TOP SOIL STOCK PILE LOCATION SHALL BE SELECTED BY OWNER.
- BERMS
- AS PHASES ARE CONSTRUCTED, BERM SLOPES SHALL DAYLIGHT INTO THE EXISTING GROUND AS DIRECTED BY OWNER. FINAL GRADING ON BERM SLOPES SHALL BE 3:1.
- REPLACE TOPSOIL ON FINAL GRADED BERMS.

**EROSION CONTROL NOTES**

- A STABILIZED STAGING AREA WILL BE DESIGNATED BY THE QUALIFIED STORMWATER MANAGER UPON THE BEGINNING OF CONSTRUCTION ACTIVITIES.
- A STOCKPILE MANAGEMENT PLAN WILL BE IDENTIFIED BY THE QUALIFIED STORMWATER MANAGER UPON THE BEGINNING OF CONSTRUCTION ACTIVITIES.

**BMP LEGEND**

MAP SYMBOL	KEY	DESCRIPTION
(Symbol)	VTC	VEHICLE TRACKING CONTROL (Initial BMP)
(Symbol)	SF	SILT FENCE (Initial BMP)
(Symbol)	IP	CULVERT INLET PROTECTION (Initial BMP)
(Symbol)	UNDISTURBED	LIMITS OF CONSTRUCTION/DISTURBANCE
(Symbol)	SM	SEEDING & MULCHING (FINAL CM)

SYMBOLS SHOWN IN LEGEND SHALL BE USED BY SWMP ADMINISTRATOR TO ANNOTATE ANY CHANGES AND/OR ADDITIONS TO THIS PLAN.

**OTHER DATA**

**LAT/LONG COORDS:** 38°55'56.38"N / 104°15'31.44"W  
**VEGETATION:** EXISTING: NATIVE PRAIRIE GRASSES & WEEDS, 75%  
 COVERAGE  
 PROPOSED: PLANTINGS & RESEEDING PER LANDSCAPE PLAN  
**APPROX. EARTHWORK QUANTITIES:** 175,054 CY CUT, 195,076 CY FILL  
**BATCH PLANTS:** NONE  
**DEWATERING:** NONE  
**DISTURBED AREA:** 55± ACRES  
**RECEIVING WATERS:** UPPER BIG SPRINGS CREEK  
**SCHEDULE:** SPRING 2025-SUMMER 2025  
 FINAL STABILIZATION FALL 2025

Replace with EPC approved VTC detail (VT-1 and VT-2 in DCMv2, Chap 3.3) or revise to be 75ft min length.

**AGGREGATE VEHICLE TRACKING CONTROL**

**SECTION A-A'**

**INSTALLATION NOTES**

- A STABILIZED CONSTRUCTION ENTRANCE/EXIT SHOULD BE LOCATED AT ALL POINTS WHERE VEHICLES EXIT THE CONSTRUCTION SITE TO ADJACENT ROADWAY.
- STABILIZED CONSTRUCTION ENTRANCE/EXITS SHALL BE INSTALLED PRIOR TO ANY LAND DISTURBING ACTIVITIES.
- RADIUS MUST BE ADEQUATE FOR INTENDED CONSTRUCTION VEHICLE TURNING.
- ROCK SHOULD CONSIST OF 6" MINUS ROCK.
- INSTALL CONSTRUCTION FENCE ON BOTH SIDES OF VEHICLE TRACKING CONTROL PAD WHEN NEEDED OR REQUIRED BY INSPECTOR.

**MAINTENANCE NOTES**

- FREQUENT OBSERVATIONS AND MAINTENANCE ARE NECESSARY TO MAINTAIN CONTROL MEASURES IN EFFECTIVE OPERATING CONDITION. INSPECTIONS AND CORRECTIVE MEASURES SHOULD BE DOCUMENTED THOROUGHLY.
- SEDIMENT TRACKED ONTO THE ADJACENT ROAD SHALL BE REMOVED DAILY, BY SWEEPING OR SHOVELING, AND NEVER WASHED DOWN STORM DRAINS.
- ROUGHEN, REPLACE AND/OR ADD ROCK AS NEEDED TO MAINTAIN CONSISTENT DEPTH AND TO PREVENT SEDIMENT TRACKING ONTO ADJACENT STREET.
- PERMANENTLY STABILIZE AREA AFTER VEHICLE TRACKING CONTROL IS REMOVED.

**VEHICLE TRACKING CONTROL**

APPROVED: [Signature]  
 SHEET MANAGER: [Signature]  
 ISSUED: 10/7/19  
 REVISED: 8/19/2020  
 DRAWING NO. 900-VTC

**SILT FENCE**

**J-HOOK INSTALLATION**

**SECTION A-A'**

**INSTALLATION NOTES**

- SILT FENCE MUST BE PLACED ON A FLAT SURFACE 2'-5' AWAY FROM TOE OF THE SLOPE TO ALLOW FOR PONDING AND DEPOSITION.
- COMPACT THE TRENCH USING A JUMPING JACK OR WHEEL ROLLING TO THE POINT THAT THE FENCE RESISTS BEING PULLED OUT OF THE GROUND BY HAND.
- SILT FENCE SHALL BE TAUT WITH NO SAGS AFTER IT HAS BEEN ANCHORED.
- FABRIC SHALL BE ATTACHED TO POSTS WITH 1" HEAVY DUTY STAPLES OR 1" NAILS. THESE SHOULD BE PLACED VERTICALLY DOWN THE POST, 3" APART. THE PREFERRED INSTALLATION METHOD USES A TRENCHER OR SILT FENCE INSTALLATION DEVICE.
- INSTALL SILT FENCE ALONG THE CONTOUR OF THE SLOPES OR IN A MANNER TO AVOID CREATING CONCENTRATED FLOW (SUCH AS A "J-HOOK" INSTALLATION).

**MAINTENANCE NOTES**

- FREQUENT OBSERVATIONS AND MAINTENANCE ARE NECESSARY TO MAINTAIN CONTROL MEASURES IN EFFECTIVE OPERATING CONDITION. INSPECTIONS AND CORRECTIVE MEASURES SHOULD BE DOCUMENTED THOROUGHLY.
- ACCUMULATED SEDIMENT MUST BE REMOVED WHEN THE HEIGHT REACHES 1/2 OF THE DESIGN HEIGHT OF THE SILT FENCE.
- SILT FENCE MUST REMAIN UNTIL THE UPSTREAM DISTURBANCE AREA IS STABILIZED.
- PERMANENTLY STABILIZE AREA AFTER SILT FENCE IS REMOVED.

**SILT FENCE**

APPROVED: [Signature]  
 SHEET MANAGER: [Signature]  
 ISSUED: 10/7/19  
 REVISED: 8/19/2020  
 DRAWING NO. 900-SF

**CULVERT INLET PROTECTION PLAN**

**SECTION A-A'**

**SECTION B-B'**

**INSTALLATION NOTES**

- SEE ROCK SOCK DETAIL.

**MAINTENANCE NOTES**

- FREQUENT OBSERVATIONS AND MAINTENANCE ARE NECESSARY TO MAINTAIN CONTROL MEASURES IN EFFECTIVE OPERATING CONDITION. INSPECTIONS AND CORRECTIVE MEASURES SHOULD BE DOCUMENTED THOROUGHLY.
- ACCUMULATED SEDIMENT UPSTREAM OF THE CULVERT SHALL BE REMOVED WHEN THE SEDIMENT DEPTH IS 1/2 HEIGHT OF THE ROCK SOCK.
- CULVERT INLET PROTECTION SHALL REMAIN UNTIL THE UPSTREAM AREA IS PERMANENTLY STABILIZED.

**CULVERT INLET PROTECTION**

APPROVED: [Signature]  
 SHEET MANAGER: [Signature]  
 ISSUED: 10/7/19  
 REVISED: 8/19/2020  
 DRAWING NO. 900-CIP

Landscaping plans do not show seeding limits or specify seed mix, clarify.

PERMANENT SEEDING AND MULCHING PER LANDSCAPE ARCHITECT DESIGN, SEE APPROVED LANDSCAPING PLANS FOR ADDITIONAL SEEDING AND MULCHING INFORMATION.

DESIGNED BY \_\_\_\_\_  
 DRAWN BY \_\_\_\_\_  
 CHECKED BY \_\_\_\_\_  
 AS-BUILT BY \_\_\_\_\_  
 CHECKED BY \_\_\_\_\_

**+158 Acre Parcel**  
 168 Training Facility

**GRADING & EROSION CONTROL PLAN**

MVE PROJECT 61224  
 MVE DRAWING GRADING PLAN

**OCT. 30, 2024**  
**SHEET 2 of 2**

