



PERMIT TO WORK IN THE RIGHT-OF-WAY

Permit Type: Encroachment Permit

Permit No: 40746

Issue Date: 12/19/2023

Permit Fee: \$3,411.00

ESQCP No:

The undersigned applicant, being familiar with the requirements of the El Paso County resolution of July 1, 2008, does hereby agree to perform all work in compliance with the regulations and specifications as set forth in said resolution and to adhere to the requirements specified below.

Company: Araco Concrete	Project Address: 304 Main Street
Phone: 7192439918	Address: 3390 Drennen Industrial Loop S Colorado Springs, CO 80910
Applicant Name: Joey Burgos	Email: Jose@aracogroupllc.com
Application Date: 12/12/2023	Date to Begin Work: 12/19/2023
	Date of Completion: 01/19/2024
Work Being Performed for: Hansen	Subcontractor: Bradley Excavating

Road #1: Security Blvd	For Purpose of: Installing	HMA Age: 0
Utility Type: Sidewalk, Curb/Gutter	Cut Location: HMA	Shoulder Cut Width: 0
Activity: Cut	Width (ft): 1	Length: 0
Bore Location:	Length (ft): 120	
Width (ft):	Length (ft):	

Road #2: Main St	For Purpose of: Installing	HMA Age: 2
Utility Type: Sidewalk, Curb/Gutter	Cut Location: HMA	Shoulder Cut Width: 0
Activity: Cut	Width (ft): 1	Length: 0
Bore Location:	Length (ft): 60	
Width (ft):	Length (ft):	

Road #3:	For Purpose of:	HMA Age:
Utility Type:	Cut Location:	Shoulder Cut Width: 0
Activity:	Width (ft): 0	Length: 0
Bore Location:	Length (ft): 0	
Width (ft):	Length (ft):	

Road #4:	For Purpose of:	HMA Age:
Utility Type:	Cut Location:	Shoulder Cut Width: 0
Activity:	Width (ft): 0	Length: 0
Bore Location:	Length (ft): 0	
Width (ft):	Length (ft):	

Road #5:	For Purpose of:	HMA Age:
Utility Type:	Cut Location:	Shoulder Cut Width: 0
Activity:	Width (ft): 0	Length: 0
Bore Location:	Length (ft): 0	
Width (ft):	Length (ft):	

REQUIREMENTS:

1. State Law requires that notice of commencement, extent, and duration of any excavation work be given to the owner or operator of underground facilities (utilities) at least two (2) business days in advance.
2. Work zone traffic control shall be provided in accordance with the approved Traffic Control Plan.
3. It is the responsibility of the contractor to contact Emergency Services, School Districts (if bus route), and other interested parties if road closure has been approved
4. All backfill shall be compacted to 90% of AASHTO T-180.
5. All work sites shall be left clean and orderly to include removal of locate flags.
6. See attached requirements.

EPC Remarks: Please contact Samantha Sherman (719-352-9601) for inspection. ROW permit and traffic control plans must be on site during project construction. County Engineer approval needed for road closures.

NOTICE:

1. It is understood that should it become necessary for El Paso County to provide sign, light, and barricade hazardous areas or restore the Right-of-Way to its original condition that all costs of said work shall be borne by the Applicant.
2. Issuance of this permit does not relieve the applicant from satisfying El Paso County Land Development Code and Engineering Criteria Manual requirements. In the event of conflict, this permit shall be considered NULL and VOID.
3. Utilities or other facilities installed under this permit are subject to relocation, adjustment, and modification at the owner's expense, in the event El Paso County determines such is necessary in order to perform road, bridge, drainage repairs, or any modifications and/or improvements.
4. All permanent road repairs shall be completed within seven (7) calendar days of initial disturbance.
5. Roadway closure will not be permitted unless approved by El Paso County Traffic Engineer at time of application.
6. All underground utility installations are to be placed in accordance with ECM Chapter 4.
7. All overhead utility installations are to be at a nineteen (19) foot minimum height.

Permit not valid until signed.

Summary of Fees	
Degradation	\$2,970.00
Traffic Mgmt	\$26.00
Administration	\$390.00
Surcharge	\$25.00
Investigation	\$
Total Fee	\$3,411.00

Applicant:

Subcontractor changes made by SS 12/26/2023



PERMIT TO WORK IN THE RIGHT-OF-WAY Additional Requirements

Roadway Patching/Potholing/Core Hole Requirements:

1. All core holes must be temporarily filled using a granular material within 24 hours of being drilled into a hard or soft surface. If the core holes need to remain open longer than 24 hours, it is acceptable to cover the holes using a metal plate plug; however, the permit holder will be responsible for any damage caused to El Paso County snow plows or other equipment by the metal plate plugs.
2. All core holes located in an asphalt roadway must be permanently filled using hot mix asphalt and/or grout within seven (7) days of being drilled into the surface.
3. All cuts located in an asphalt roadway must be temporarily patched with cold-patch asphalt until permanently patched with hot mix asphalt. Permanent patching with hot mix asphalt must be completed within seven days of completion of roadway cut backfill. Asphalt must be "T" capped as shown on El Paso County Engineering Criteria Manual detail sheet SD_4-20.
4. All core holes located in an asphalt roadway should be marked indicating the company that completed the work.
5. All core holes located within a gravel or dirt roadway and/or shoulder must be permanently filled using a native material similar those that were removed within seven days of being drilled into the surface.
6. All trenches and cuts located within a gravel or dirt roadway and/or shoulder must be permanently backfilled and compacted with native material similar to those that were removed immediately after installation of underground utilities.
7. Contractor must provide the Right-of-Way Inspector with the total number of core holes created during the project.
8. Contractor must provide the Right-of-Way Inspector with a site plan indicating the locations of the core holes created during the project.
9. Any core holes, trenches, cuts left open past the above specified time frames will incur investigative fees and or the permit holder will be denied future permits until all restoration work is completed.



1459 Q and Ave
 Denver, CO 80202
 P: 888-458-6646

2232 - EL PASO, COLORADO
 304 MAIN STREET
 DETAILED GRADING PLAN - SOUTH

40 PROJECT TIME EES
 RDM: RP
 DATE: 08/26/16

REVISIONS	DATE	REVISION DESCRIPTION



GRADING PLAN LEGEND

- PROPOSED PROPERTY BOUNDARY
- PROPOSED EASEMENT
- CONSTRICTION / OBSTACLE LIMITS
- EXISTING FLOODPLAIN
- EXISTING FLOODPLAIN
- EXISTING MINOR CONTOUR
- PROPOSED MAJOR CONTOUR
- PROPOSED MINOR CONTOUR
- PROPOSED BUILDING OUTLINE
- PROPOSED INTEGRAL CURB
- PROPOSED CURB AND GUTTER
- PROPOSED RETAINING WALL
- PROPOSED ACCESSIBLE ROUTE
- PROPOSED SURFACE FLOW LINE
- PROPOSED EXISTING STORMWATER
- EXISTING STORMWATER
- EXISTING STREET LIGHTING
- EXISTING FIRE HYDRANT
- EXISTING SEWERAGE
- PROPOSED STREET LIGHTING
- PROPOSED FLOWLINE ELEVATION
- PROPOSED EXTERIOR GRADE AT FOUNDATION
- PROPOSED SIDEWALK ELEVATION
- PROPOSED GRADE TO MATCH EXISTING
- PROPOSED FINISHED GRADE
- PROPOSED HIGHPOINT ELEVATION
- PROPOSED TOP OF WALL
- PROPOSED BOTTOM OF WALL
- PROPOSED TOP OF CURB
- FLOOR AREA AND GRADE

GRADING NOTES:

- NO WORKS TO BE UNTIL ALL PERMITS HAVE BEEN OBTAINED
- FINAL GRADES ARE SUBJECT TO UNDER CHANGE BY CONTRACTOR. NO GRADE CHANGES IN EXCESS OF 0.25 WITHOUT ENGINEER APPROVAL
- ANY FILL MATERIAL REQUIRED TO BRING THE SITE TO GRADE SHALL BE CLEAN FILL APPROVED BY GEOTECHNICAL ENGINEER. SEE SOIL PREPARATION NOTE ON THIS SHEET.
- GENERAL CONTRACTOR SHALL BE RESPONSIBLE FOR OBTAINING PERMITS AND OBTAINING NECESSARY SURROUNDING PUBLIC STREET TO BE OPEN FOR CONSTRUCTION
- SEE THE SITE SURVEY FOR SURVEY INFORMATION
- GRADES SHOWN ARE FLOWLINE UNLESS OTHERWISE NOTED
- GUTTER GRADES SHALL BE A MINIMUM 0.50%
- CONTRACTOR TO ENSURE SMOOTH TRANSITION BETWEEN PRIVATE DRIVE AND TRASH ENCLOSURE
- RETAINING WALL HEIGHTS AND GRADES SHOWN ARE FROM FINISHED GRADE AT TOP OF EXISTING CURB UNLESS OTHERWISE NOTED. SEE STRUCTURAL PLANS UNDER
- SEPARATE COVER



CONFIDENTIAL DOCUMENT. THIS DOCUMENT IS THE PROPERTY OF KUM & GO, INC. AND IS NOT TO BE REPRODUCED OR DISTRIBUTED.

BENCHMARK:
 ELEVATIONS ARE BASED UPON COORDINATE SPRINGS UTILITIES ALUMINUM CAP STAMPED 2" X 1" CONTROL SET ON THE NORTHWEST CORNER OF 304 MAIN STREET AND DEPT. OF TRANSPORTATION FINISHED GRADE. REFER TO STRUCTURAL PLANS UNDER SEPARATE COVER.

SEE SHEET 8
 MATCHLINE

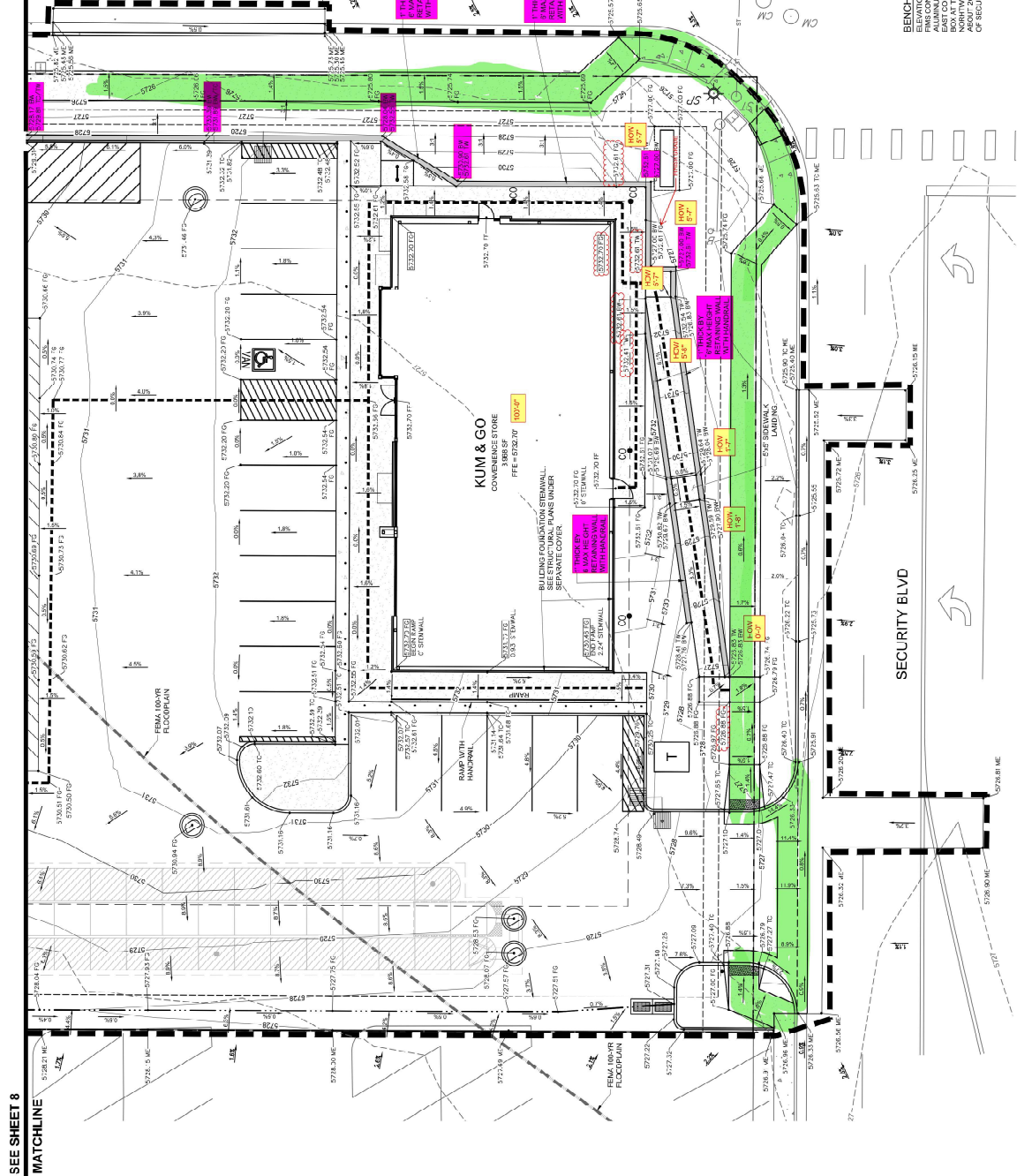

SEE SHEET 8
 MATCHLINE