

EL PASO

COMMISSIONERS:
DARRYL GLENN (PRESIDENT)
MARK WALLER (PRESIDENT PRO TEMPORE)



COUNTY

STAN VANDERWERF
LONGINOS GONZALEZ
PEGGY LITTLETON

PLANNING AND COMMUNITY DEVELOPMENT DEPARTMENT
CRAIG DOSSEY, EXECUTIVE DIRECTOR

December 11, 2018

RE: Administrative Special Use Request for Sand Place Special Use Amendment

File: AL-18-028

Parcel ID: 4330001019

To Whom It May Concern:

This letter is to inform property owners adjacent to 11980 Sand Place that they have requested a special use amendment to allow for an extended family dwelling to be 1,612 square feet in size whereas 1,500 square feet were previously approved within the RR-5 (Residential Rural) zoning district. The Planning and Community Development Director may make a formal decision regarding the request on December 26, 2018 at 4:30 P.M. Any comments or questions may be forwarded to me prior to that decision. At the discretion of the Planning and Community Development Director, the approval process may be elevated to the Board of County Commissioners for consideration. Administrative approval by the Planning and Community Development Director is subject to the appeal provisions of the Land Development Code.

You may view the application documents online at www.epcdevplanreview.com. Please feel free to contact me with any questions, comments, or concerns you may have prior to the decision.

Respectfully,

Nina Ruiz, Planner II
El Paso County Planning and Community Development
719-520-6313
Ninaruiz@elpasoco.com

*copied, mailed
12/12/2018 JR*

2880 INTERNATIONAL CIRCLE, SUITE 110
PHONE: (719) 520-6300



COLORADO SPRINGS, CO 80910-3127
FAX: (719) 520-6695

www.ELPASOCO.COM

El Paso County Parcel Information

File Name: AL-18-028

PARCEL	NAME
4330001019	NOGLE THOMAS

Zone Map No.: --

ADDRESS	CITY	STATE
11980 SAND PL	PEYTON	CO

ZIP	ZIPLUS
80831	7785

Date: December 12, 2018

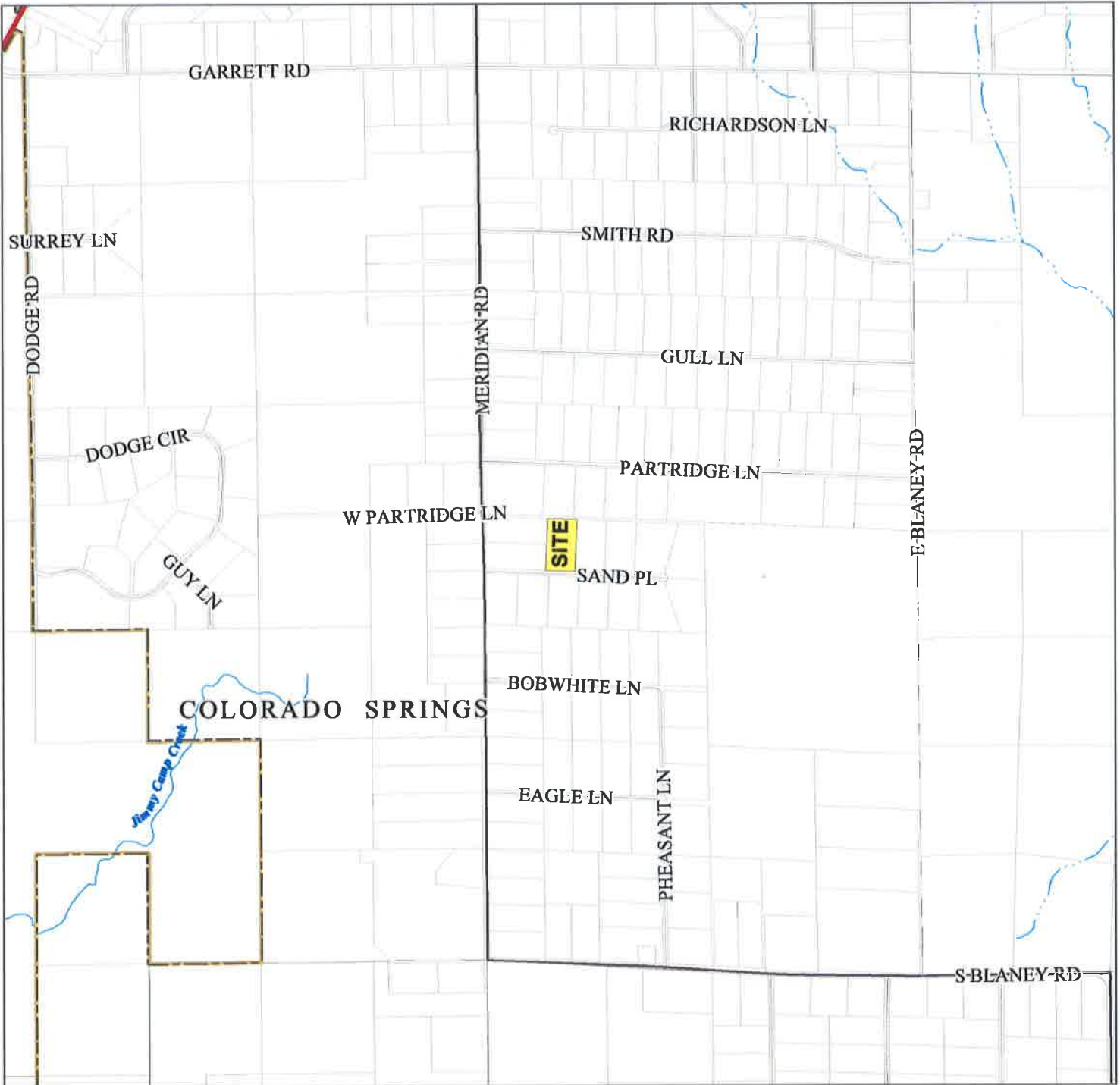

Please report any parcel discrepancies to:
 El Paso County Assessor
 1675 W. Garden of the Gods Rd.
 Colorado Springs, CO 80907
 (719) 520-6600



COPYRIGHT 2018 by the Board of County Commissioners, El Paso County, Colorado. All rights reserved. No part of this document or data contained hereon may be reproduced; used to prepare derivative products; or distributed without the specific written approval of the Board of County Commissioners, El Paso County, Colorado. This document was prepared from the best data available at the time of printing. El Paso County, Colorado, makes no claim as to the completeness or accuracy of the data contained hereon.

4330001010
CHANEY MARK A
2692 S KLINE CIR
DENVER, CO 80227

4330001021
HEIN RONALD L
4475 N MERIDIAN RD
PEYTON, CO 80831

4330001018
HILLEGASS FREDDIE &
2085 POTEAE CIR
COLORADO SPRINGS, CO 80915

4330001009
JOHNSON JOSIAH J
11925 SAND PL
PEYTON, CO 80831

4319004020
MARRIOTT JERRY D
4525 MERIDIAN RD
PEYTON, CO 80831

4330001020
MITCHELL RICKY W
11870 SAND PL
PEYTON, CO 80831

4330001019
NOGLE THOMAS
11980 SAND PL
PEYTON, CO 80831

4319004011
ROMINE WILLIAM L
12075 PARTRIDGE LN
PEYTON, CO 80831

4319004012
SMITH MAURICE A
11995 PARTRIDGE LN
PEYTON, CO 80831

4330001011
WILSON CHARLES J
12055 SAND PL
PEYTON, CO 80831