

El Paso County Parcel Information

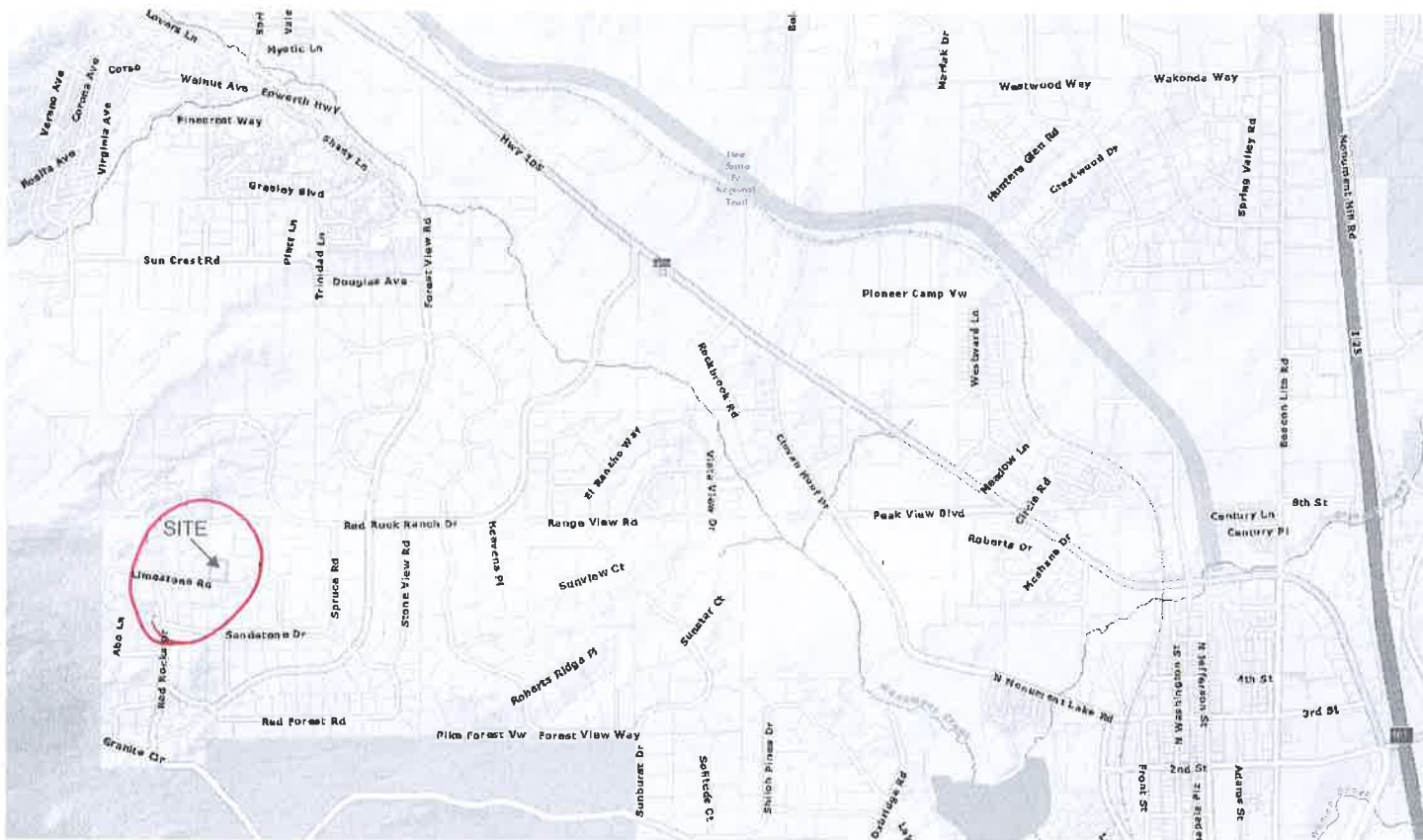

COPYRIGHT 2018 by the Board of County Commissioners, El Paso County, Colorado. All rights reserved. No part of this document or data contained hereon may be reproduced; used to prepare derivative products; or distributed without the specific written approval of the Board of County Commissioners, El Paso County, Colorado. This document was prepared from the best data available at the time of printing. El Paso County, Colorado, makes no claim as to the completeness or accuracy of the data contained hereon.

Parcel: 7117005006

Name: OWENS THOMAS P
OWENS LESA E

City: MONUMENT

State: CO

Zip: 80132-8256

Filename: BOA-18-003

Zone Map Number: 71170

Date: March 29, 2018

Please report any parcel discrepancies to:
El Paso County Assessor
1675 W. Garden of the Gods Rd.
Colorado Springs, CO 80907
(719) 520-6600

7117005036
BENZELESKI TAMARA
4430 EVANS RD
MONUMENT, CO 80132

7117005007
BOHN DAVID P
4710 LIMESTONE RD
MONUMENT, CO 80132

7117007003
COTTRELL SUSAN M
4675 LIMESTONE RD
MONUMENT, CO 80132

7117005008
LEE LIVING TRUST
4750 LIMESTONE RD
MONUMENT, CO 80132

7117007005
MCDONALD DENNIS J & KIMBERLY A
4755 LIMESTONE RD
MONUMENT, CO 80132

7117007004
MCKEAN PAUL G
4715 LIMESTONE RD
MONUMENT, CO 80132

7117005006
OWENS THOMAS P
4670 LIMESTONE RD
MONUMENT, CO 80132

BOA-18-003