

FILE NO: PPR-20-014

PLANS PREPARED FOR:



at&t

PLANS PREPARED BY:

INFINIGY

ENGINEERING, PLLC

2500 W. HIGGINS RD, SUITE 500
HOFFMAN ESTATES, IL 60169
Office # (847) 648-4068

JOB NUMBER: 674-003

PROJECT MANAGER:

md7

10590 W. OCEAN AIR DRIVE, SUITE 300
SAN DIEGO, CA 92130

ENGINEERING LICENSE:



DRAWING NOTICE:

THESE DOCUMENTS ARE CONFIDENTIAL AND ARE THE SOLE PROPERTY OF AT&T AND MAY NOT BE REPRODUCED, DISSEMINATED OR REDISTRIBUTED WITHOUT THE EXPRESS WRITTEN CONSENT OF AT&T.

REVISIONS:

DESCRIPTION	DATE	BY	REV
REVISED PER JX	07/02/20	CAP	2
REVISED PER JX	05/06/20	CAP	1
FINAL CD	03/31/20	CAP	0
REVISED /ISSUED FOR REVIEW	02/10/20	CAP	D
REVISED /ISSUED FOR REVIEW	01/30/20	CAP	C
REVISED /ISSUED FOR REVIEW	11/26/19	CAP	B

AT&T SITE NAME:

CALHAN

AT&T SITE NUMBER:

COL02031

AT&T FA NUMBER:

10093755

SITE ADDRESS:

11598 HAHN ROAD
CALHAN, CO 80808

SHEET DESCRIPTION:

PARCEL PLAN

SHEET NUMBER:

P-1

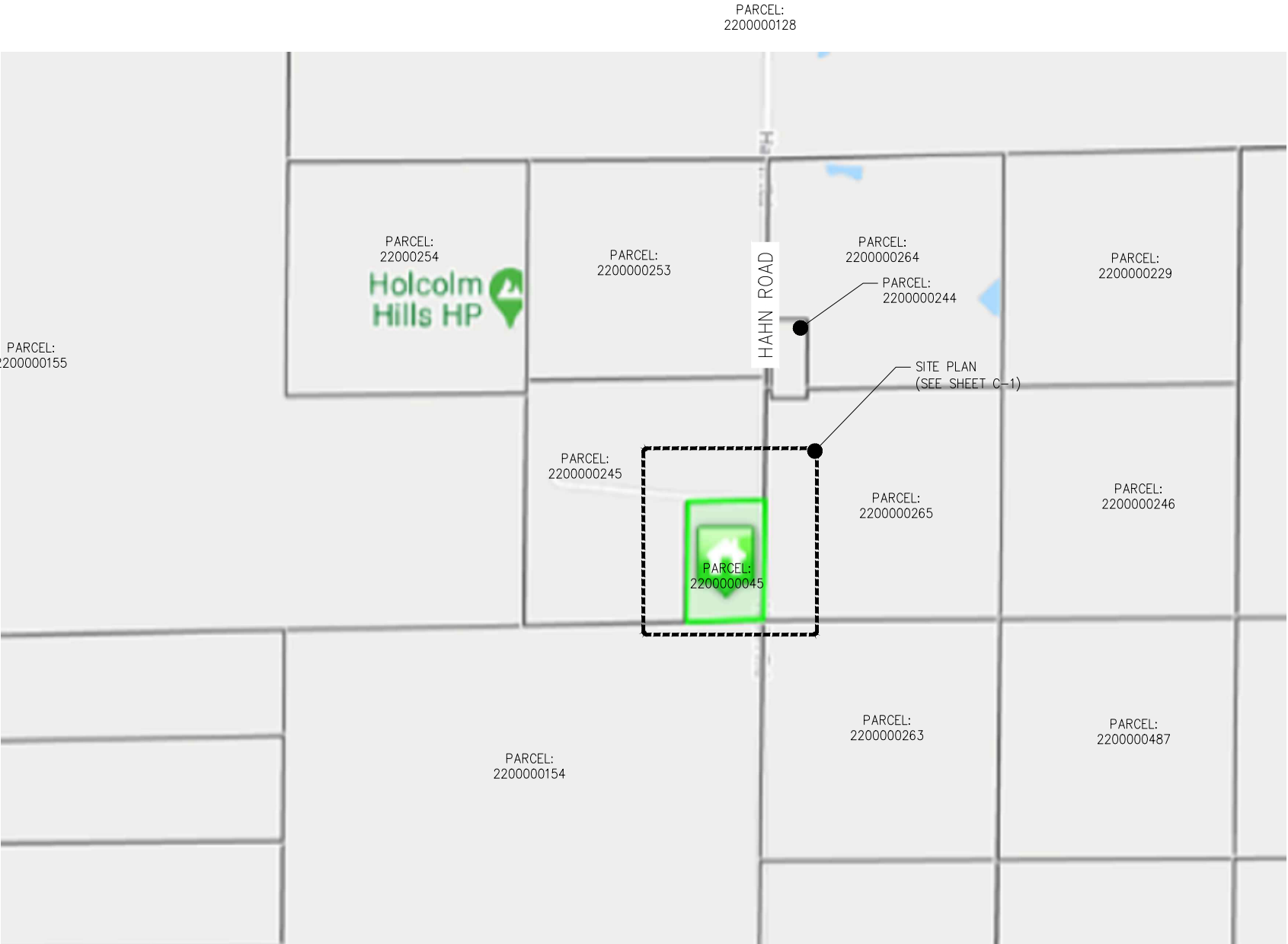

PARCEL PLAN

SCALE: NTS

1